

KERR-MCGEE OIL & GAS ONSHORE LP (LAMBERT STATE PLANE COORD)

Location: COLORADO Slot: SLOT#42 TAIPAN 27C-15HZ (2192'FSL & 530'FEL, SEC.22)
 Field: WELD COUNTY (KERR MCGEE) Well: TAIPAN 27C-15HZ
 Facility: SEC.22-T2N-R67W Wellbore: TAIPAN 27C-15HZ PWB

Plot reference wellpath is TAIPAN 27C-15HZ (REV-B.0) PWP

True vertical depths are referenced to XTREME 24 (16KB) (RKB)	Grid System: NAD83 / Lambert Colorado SP, Northern Zone (501), US feet
Measured depths are referenced to XTREME 24 (16KB) (RKB)	North Reference: True north
XTREME 24 (16KB) (RKB) to Mean Sea Level: 5014 feet	Scale: True distance
Mean Sea Level to Mud line (At Slot: SLOT#42 TAIPAN 27C-15HZ (2192'FSL & 530'FEL, SEC.22)): 0 feet	Depths are in feet
Coordinates are in feet referenced to Slot	Created by: robiale01 on 2/9/2015

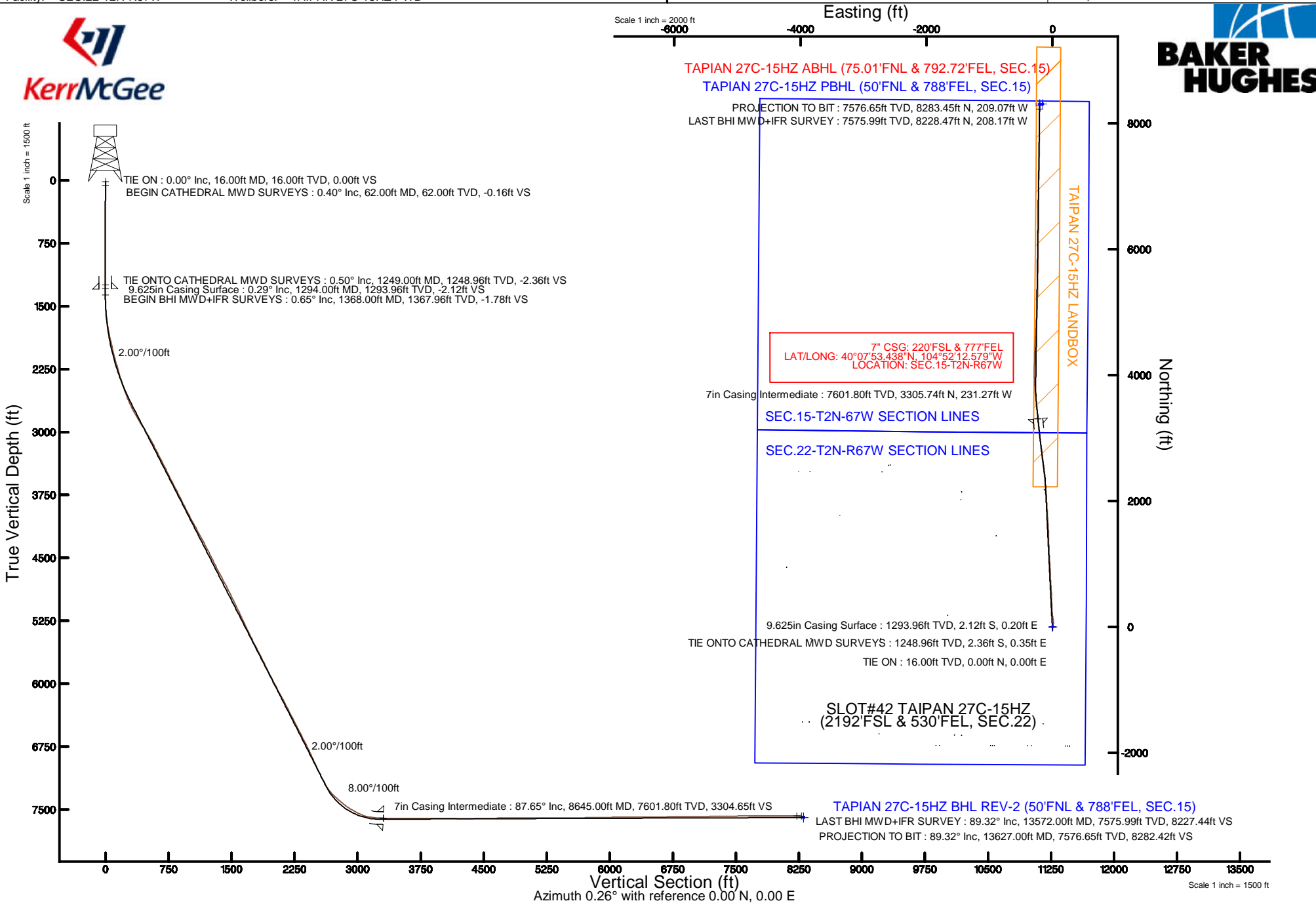

REFERENCE WELLPATH IDENTIFICATION

Operator	KERR-MCGEE OIL & GAS ONSHORE LP (LAMBERT STATE PLANE COORD)	Slot	SLOT#42 TAIPAN 27C-15HZ (2192'FSL & 530'FEL, SEC.22)
Area	COLORADO	Well	TAIPAN 27C-15HZ
Field	WELD COUNTY (KERR MCGEE)	Wellbore	TAIPAN 27C-15HZ AWB <62-13627>
Facility	SEC.22-T2N-R67W		

REPORT SETUP INFORMATION

Projection System	NAD83 / Lambert Colorado SP, Northern Zone (501), US feet	Software System	WellArchitect® 4.1.1
North Reference	True	User	Robiale01
Scale	0.999959	Report Generated	2/9/2015 at 9:21:20 AM
Convergence at slot	0.41° East	Database/Source file	WellArchitectDB/TAIPAN_27C-15HZ_AWB_62-13627_.xml

WELLPATH LOCATION

	Local coordinates		Grid coordinates		Geographic coordinates	
	North[ft]	East[ft]	Easting[US ft]	Northing[US ft]	Latitude	Longitude
Slot Location	-2573.61	2576.55	3176364.68	1288074.57	40°07'20.770"N	104°52'09.602"W
Facility Reference Pt			3173770.27	1290629.95	40°07'46.204"N	104°52'42.769"W
Field Reference Pt			3197771.84	1268891.29	40°04'09.600"N	104°47'36.000"W

WELLPATH DATUM

Calculation method	Minimum curvature	XTREME 24 (16'KB) (RKB) to Facility Vertical Datum	5014.00ft
Horizontal Reference Pt	Slot	XTREME 24 (16'KB) (RKB) to Mean Sea Level	5014.00ft
Vertical Reference Pt	XTREME 24 (16'KB) (RKB)	XTREME 24 (16'KB) (RKB) to Mud Line at Slot (SLOT#42 TAIPAN 27C-15HZ (2192'FSL & 530'FEL, SEC.22))	5014.00ft
MD Reference Pt	XTREME 24 (16'KB) (RKB)	Section Origin	N 0.00, E 0.00 ft
Field Vertical Reference	Mean Sea Level	Section Azimuth	358.55°

REFERENCE WELLPATH IDENTIFICATION

Operator	KERR-MCGEE OIL & GAS ONSHORE LP (LAMBERT STATE PLANE COORD)	Slot	SLOT#42 TAIPAN 27C-15HZ (2192'FSL & 530'FEL, SEC.22)
Area	COLORADO	Well	TAIPAN 27C-15HZ
Field	WELD COUNTY (KERR MCGEE)	Wellbore	TAIPAN 27C-15HZ AWB <62-13627>
Facility	SEC.22-T2N-R67W		

WELLPATH DATA (162 stations) † = interpolated/extrapolated station

MD [ft]	Inclination [°]	Azimuth [°]	TVD [ft]	Vert Sect [ft]	North [ft]	East [ft]	Latitude	Longitude	DLS [°/100ft]	Comments
0.00†	0.000	192.400	0.00	0.00	0.00	0.00	40°07'20.770"N	104°52'09.602"W	0.00	
16.00	0.000	192.400	16.00	0.00	0.00	0.00	40°07'20.770"N	104°52'09.602"W	0.00	TIE ON
62.00	0.400	192.400	62.00	-0.16	-0.16	-0.03	40°07'20.768"N	104°52'09.602"W	0.87	BEGIN CATHEDRAL MWD SURVEYS
172.00	0.100	151.900	172.00	-0.61	-0.62	-0.07	40°07'20.764"N	104°52'09.603"W	0.30	
250.00	0.300	146.600	250.00	-0.85	-0.85	0.07	40°07'20.762"N	104°52'09.601"W	0.26	
330.00	0.300	131.400	330.00	-1.17	-1.16	0.35	40°07'20.759"N	104°52'09.598"W	0.10	
410.00	0.400	173.800	410.00	-1.59	-1.58	0.53	40°07'20.754"N	104°52'09.595"W	0.34	
490.00	0.600	168.000	489.99	-2.28	-2.26	0.65	40°07'20.748"N	104°52'09.594"W	0.26	
570.00	0.900	159.000	569.99	-3.28	-3.26	0.96	40°07'20.738"N	104°52'09.590"W	0.40	
650.00	0.800	169.800	649.98	-4.43	-4.40	1.29	40°07'20.727"N	104°52'09.585"W	0.24	
730.00	0.100	98.400	729.97	-4.99	-4.96	1.45	40°07'20.721"N	104°52'09.583"W	0.97	
810.00	0.200	344.400	809.97	-4.87	-4.83	1.49	40°07'20.722"N	104°52'09.583"W	0.32	
890.00	0.300	353.100	889.97	-4.52	-4.49	1.42	40°07'20.726"N	104°52'09.584"W	0.13	
970.00	0.500	326.200	969.97	-4.02	-3.99	1.20	40°07'20.731"N	104°52'09.587"W	0.34	
1050.00	0.300	4.900	1049.97	-3.52	-3.49	1.03	40°07'20.735"N	104°52'09.589"W	0.41	
1130.00	0.300	302.400	1129.97	-3.19	-3.17	0.87	40°07'20.739"N	104°52'09.591"W	0.39	
1210.00	0.600	340.500	1209.97	-2.68	-2.66	0.55	40°07'20.744"N	104°52'09.595"W	0.51	
1249.00	0.500	310.900	1248.96	-2.37	-2.36	0.35	40°07'20.747"N	104°52'09.597"W	0.76	TIE ONTO CATHEDRAL MWD SURVEYS
1368.00	0.650	69.310	1367.96	-1.80	-1.78	0.59	40°07'20.752"N	104°52'09.594"W	0.83	BEGIN BHI MWD+IFR SURVEYS
1462.00	2.600	38.420	1461.92	0.02	0.08	2.42	40°07'20.771"N	104°52'09.571"W	2.20	
1557.00	4.610	18.750	1556.73	5.25	5.38	4.98	40°07'20.823"N	104°52'09.538"W	2.45	
1651.00	7.260	13.190	1650.22	14.55	14.74	7.55	40°07'20.916"N	104°52'09.505"W	2.88	
1746.00	9.190	10.520	1744.24	27.78	28.05	10.31	40°07'21.047"N	104°52'09.469"W	2.07	
1840.00	11.450	5.820	1836.71	44.38	44.71	12.63	40°07'21.212"N	104°52'09.439"W	2.56	
1934.00	13.100	2.410	1928.56	64.26	64.64	14.02	40°07'21.409"N	104°52'09.422"W	1.92	
2029.00	14.430	351.350	2020.85	86.75	87.10	12.69	40°07'21.631"N	104°52'09.439"W	3.10	
2121.00	14.370	350.930	2109.96	109.44	109.71	9.17	40°07'21.854"N	104°52'09.484"W	0.13	
2214.00	15.510	353.100	2199.81	133.26	133.45	5.86	40°07'22.089"N	104°52'09.527"W	1.37	
2307.00	16.340	352.710	2289.24	158.65	158.77	2.70	40°07'22.339"N	104°52'09.567"W	0.90	
2400.00	17.380	351.610	2378.24	185.45	185.49	-0.99	40°07'22.603"N	104°52'09.615"W	1.17	
2493.00	19.100	353.380	2466.57	214.40	214.35	-4.77	40°07'22.888"N	104°52'09.663"W	1.94	
2586.00	20.460	356.050	2554.08	245.79	245.68	-7.64	40°07'23.198"N	104°52'09.700"W	1.76	
2679.00	23.540	357.560	2640.30	280.61	280.46	-9.55	40°07'23.542"N	104°52'09.725"W	3.37	
2772.00	26.610	357.920	2724.52	320.01	319.84	-11.10	40°07'23.931"N	104°52'09.745"W	3.31	
2865.00	30.230	358.630	2806.30	364.27	364.07	-12.41	40°07'24.368"N	104°52'09.762"W	3.91	
2958.00	32.300	358.190	2885.79	412.53	412.32	-13.76	40°07'24.845"N	104°52'09.779"W	2.24	
3051.00	31.910	357.820	2964.57	461.96	461.71	-15.48	40°07'25.333"N	104°52'09.801"W	0.47	
3144.00	30.280	356.790	3044.21	509.97	509.69	-17.73	40°07'25.807"N	104°52'09.830"W	1.84	
3237.00	28.340	357.440	3125.30	555.48	555.15	-20.03	40°07'26.256"N	104°52'09.860"W	2.11	
3329.00	27.320	356.890	3206.65	598.42	598.05	-22.15	40°07'26.680"N	104°52'09.887"W	1.14	
3413.00	26.530	355.640	3281.55	636.42	636.00	-24.62	40°07'27.055"N	104°52'09.919"W	1.16	
3498.00	27.380	356.030	3357.31	674.91	674.43	-27.42	40°07'27.435"N	104°52'09.955"W	1.02	
3584.00	26.360	355.290	3434.03	713.73	713.19	-30.35	40°07'27.818"N	104°52'09.993"W	1.25	
3669.00	26.290	356.390	3510.21	751.38	750.78	-33.09	40°07'28.189"N	104°52'10.028"W	0.58	
3754.00	26.820	358.320	3586.25	789.36	788.74	-34.83	40°07'28.564"N	104°52'10.050"W	1.19	

Actual Wellpath Report

TAIPAN 27C-15HZ AWP

Page 3 of 6

REFERENCE WELLPATH IDENTIFICATION

Operator	KERR-MCGEE OIL & GAS ONSHORE LP (LAMBERT STATE PLANE COORD)	Slot	SLOT#42 TAIPAN 27C-15HZ (2192'FSL & 530'FEL, SEC.22)
Area	COLORADO	Well	TAIPAN 27C-15HZ
Field	WELD COUNTY (KERR MCGEE)	Wellbore	TAIPAN 27C-15HZ AWP <62-13627>
Facility	SEC.22-T2N-R67W		

WELLPATH DATA (162 stations)

MD [ft]	Inclination [°]	Azimuth [°]	TVD [ft]	Vert Sect [ft]	North [ft]	East [ft]	Latitude	Longitude	DLS [°/100ft]	Comments
3839.00	27.030	357.810	3662.03	827.85	827.20	-36.13	40°07'28.945"N	104°52'10.067"W	0.37	
3924.00	27.700	358.110	3737.52	866.92	866.25	-37.52	40°07'29.330"N	104°52'10.085"W	0.80	
4009.00	26.510	357.570	3813.19	905.65	904.95	-38.98	40°07'29.713"N	104°52'10.104"W	1.43	
4095.00	26.540	357.250	3890.13	944.04	943.32	-40.72	40°07'30.092"N	104°52'10.126"W	0.17	
4180.00	27.530	357.390	3965.84	982.67	981.91	-42.52	40°07'30.473"N	104°52'10.149"W	1.17	
4265.00	27.660	355.880	4041.18	1022.02	1021.21	-44.83	40°07'30.862"N	104°52'10.179"W	0.84	
4350.00	28.430	356.550	4116.19	1061.95	1061.09	-47.47	40°07'31.256"N	104°52'10.213"W	0.98	
4435.00	28.580	356.450	4190.89	1102.49	1101.58	-49.95	40°07'31.656"N	104°52'10.245"W	0.19	
4520.00	28.650	356.000	4265.51	1143.16	1142.20	-52.63	40°07'32.057"N	104°52'10.279"W	0.27	
4605.00	28.040	357.410	4340.32	1183.49	1182.48	-54.95	40°07'32.455"N	104°52'10.309"W	1.07	
4690.00	26.540	356.640	4415.86	1222.45	1221.40	-56.97	40°07'32.840"N	104°52'10.335"W	1.81	
4775.00	26.860	358.020	4491.79	1260.63	1259.55	-58.74	40°07'33.217"N	104°52'10.358"W	0.82	
4860.00	25.790	359.150	4567.98	1298.32	1297.23	-59.68	40°07'33.589"N	104°52'10.370"W	1.39	
4945.00	27.800	0.140	4643.85	1336.63	1335.54	-59.91	40°07'33.968"N	104°52'10.373"W	2.42	
5031.00	28.170	359.610	4719.79	1376.97	1375.90	-59.99	40°07'34.367"N	104°52'10.374"W	0.52	
5116.00	27.760	358.380	4794.87	1416.83	1415.75	-60.69	40°07'34.761"N	104°52'10.383"W	0.83	
5201.00	26.830	357.120	4870.40	1455.80	1454.70	-62.21	40°07'35.145"N	104°52'10.403"W	1.29	
5286.00	26.210	356.840	4946.46	1493.74	1492.60	-64.21	40°07'35.520"N	104°52'10.429"W	0.74	
5371.00	25.950	356.630	5022.80	1531.09	1529.90	-66.34	40°07'35.889"N	104°52'10.456"W	0.32	
5456.00	25.760	356.960	5099.29	1568.14	1566.91	-68.41	40°07'36.254"N	104°52'10.483"W	0.28	
5541.00	25.560	356.310	5175.91	1604.93	1603.66	-70.57	40°07'36.618"N	104°52'10.511"W	0.41	
5626.00	25.010	356.420	5252.77	1641.21	1639.89	-72.88	40°07'36.976"N	104°52'10.540"W	0.65	
5711.00	25.650	355.740	5329.60	1677.54	1676.17	-75.36	40°07'37.334"N	104°52'10.572"W	0.83	
5796.00	25.700	356.050	5406.20	1714.33	1712.90	-78.00	40°07'37.697"N	104°52'10.606"W	0.17	
5881.00	26.010	357.440	5482.70	1751.37	1749.91	-80.10	40°07'38.063"N	104°52'10.633"W	0.80	
5966.00	27.940	357.700	5558.44	1789.92	1788.43	-81.73	40°07'38.443"N	104°52'10.654"W	2.27	
6052.00	27.350	356.810	5634.63	1829.81	1828.28	-83.64	40°07'38.837"N	104°52'10.679"W	0.84	
6137.00	25.810	355.540	5710.64	1867.81	1866.23	-86.17	40°07'39.212"N	104°52'10.711"W	1.93	
6222.00	26.490	355.320	5786.94	1905.22	1903.57	-89.15	40°07'39.581"N	104°52'10.750"W	0.81	
6306.00	27.020	357.320	5861.95	1943.00	1941.30	-91.57	40°07'39.954"N	104°52'10.781"W	1.24	
6391.00	27.460	358.310	5937.52	1981.90	1980.18	-93.05	40°07'40.338"N	104°52'10.800"W	0.74	
6476.00	27.090	357.490	6013.07	2020.85	2019.11	-94.48	40°07'40.723"N	104°52'10.818"W	0.62	
6561.00	27.910	355.390	6088.47	2060.06	2058.27	-96.93	40°07'41.110"N	104°52'10.850"W	1.49	
6646.00	28.840	355.540	6163.26	2100.40	2098.54	-100.12	40°07'41.508"N	104°52'10.891"W	1.10	
6731.00	27.290	354.070	6238.26	2140.30	2138.36	-103.73	40°07'41.902"N	104°52'10.937"W	2.00	
6816.00	27.590	355.270	6313.70	2179.38	2177.36	-107.36	40°07'42.287"N	104°52'10.984"W	0.74	
6901.00	27.000	357.140	6389.23	2218.32	2216.25	-109.95	40°07'42.671"N	104°52'11.017"W	1.22	
6987.00	27.020	354.800	6465.86	2257.33	2255.20	-112.69	40°07'43.056"N	104°52'11.053"W	1.24	
7071.00	27.400	353.100	6540.56	2295.61	2293.40	-116.75	40°07'43.434"N	104°52'11.105"W	1.03	
7156.00	27.030	353.600	6616.15	2334.32	2332.01	-121.25	40°07'43.815"N	104°52'11.163"W	0.51	
7241.00	27.890	354.570	6691.57	2373.40	2370.99	-125.28	40°07'44.200"N	104°52'11.215"W	1.14	
7326.00	25.940	353.780	6767.36	2411.76	2409.27	-129.18	40°07'44.579"N	104°52'11.265"W	2.33	
7412.00	24.570	354.820	6845.14	2448.35	2445.78	-132.83	40°07'44.939"N	104°52'11.312"W	1.67	
7497.00	24.270	353.640	6922.54	2483.39	2480.74	-136.36	40°07'45.285"N	104°52'11.358"W	0.67	
7582.00	24.780	355.870	6999.87	2518.59	2515.87	-139.58	40°07'45.632"N	104°52'11.399"W	1.24	

REFERENCE WELLPATH IDENTIFICATION

Operator	KERR-MCGEE OIL & GAS ONSHORE LP (LAMBERT STATE PLANE COORD)	Slot	SLOT#42 TAIPAN 27C-15HZ (2192'FSL & 530'FEL, SEC.22)
Area	COLORADO	Well	TAIPAN 27C-15HZ
Field	WELD COUNTY (KERR MCGEE)	Wellbore	TAIPAN 27C-15HZ AWP <62-13627>
Facility	SEC.22-T2N-R67W		

WELLPATH DATA (162 stations) † = interpolated/extrapolated station

MD [ft]	Inclination [°]	Azimuth [°]	TVD [ft]	Vert Sect [ft]	North [ft]	East [ft]	Latitude	Longitude	DLS ["/100ft]	Comments
7667.00	27.120	353.390	7076.30	2555.68	2552.89	-143.09	40°07'45.998"N	104°52'11.444"W	3.03	
7752.00	27.690	352.590	7151.76	2594.62	2591.72	-147.87	40°07'46.382"N	104°52'11.506"W	0.80	
7795.00	27.060	353.060	7189.94	2614.29	2611.33	-150.34	40°07'46.575"N	104°52'11.537"W	1.55	
7880.00	35.140	351.620	7262.67	2657.90	2654.80	-156.25	40°07'47.005"N	104°52'11.614"W	9.55	
7965.00	47.780	353.800	7326.24	2713.77	2710.52	-163.25	40°07'47.556"N	104°52'11.704"W	14.97	
8050.00	48.740	353.370	7382.83	2776.96	2773.54	-170.33	40°07'48.178"N	104°52'11.795"W	1.19	
8135.00	50.080	353.500	7438.13	2841.25	2837.67	-177.71	40°07'48.812"N	104°52'11.890"W	1.58	
8219.00	58.830	351.620	7486.92	2909.14	2905.36	-186.61	40°07'49.481"N	104°52'12.004"W	10.57	
8305.00	62.370	352.310	7529.13	2983.56	2979.54	-197.08	40°07'50.214"N	104°52'12.139"W	4.18	
8390.00	67.770	353.790	7564.95	3060.26	3056.02	-206.38	40°07'50.970"N	104°52'12.259"W	6.55	
8475.00	80.760	353.740	7587.95	3141.61	3137.18	-215.25	40°07'51.772"N	104°52'12.373"W	15.28	
8560.00	86.450	354.910	7597.42	3225.82	3221.20	-223.59	40°07'52.602"N	104°52'12.481"W	6.83	
8598.00	86.970	354.870	7599.60	3263.68	3258.99	-226.97	40°07'52.976"N	104°52'12.524"W	1.37	
8645.00†	87.647	354.619	7601.80	3310.52	3305.74	-231.27	40°07'53.438"N	104°52'12.579"W	1.54	7" CASING POINT
8714.00	88.640	354.250	7604.04	3379.31	3374.38	-237.96	40°07'54.116"N	104°52'12.666"W	1.54	
8799.00	90.150	354.640	7604.94	3464.08	3458.97	-246.19	40°07'54.952"N	104°52'12.772"W	1.83	
8884.00	90.950	354.060	7604.12	3548.85	3543.55	-254.55	40°07'55.788"N	104°52'12.879"W	1.16	
8969.00	90.270	354.710	7603.22	3633.62	3628.14	-262.87	40°07'56.624"N	104°52'12.986"W	1.11	
9055.00	89.690	355.470	7603.25	3719.46	3713.82	-270.23	40°07'57.470"N	104°52'13.081"W	1.11	
9140.00	90.240	355.530	7603.30	3804.34	3798.56	-276.90	40°07'58.308"N	104°52'13.167"W	0.65	
9225.00	89.750	356.670	7603.30	3889.26	3883.36	-282.68	40°07'59.146"N	104°52'13.241"W	1.46	
9310.00	89.690	358.440	7603.72	3974.24	3968.28	-286.31	40°07'59.985"N	104°52'13.288"W	2.08	
9395.00	89.380	359.950	7604.41	4059.23	4053.27	-287.50	40°08'00.825"N	104°52'13.304"W	1.81	
9480.00	88.920	1.300	7605.67	4144.16	4138.25	-286.57	40°08'01.665"N	104°52'13.292"W	1.68	
9565.00	88.980	0.830	7607.23	4229.07	4223.22	-284.99	40°08'02.504"N	104°52'13.271"W	0.56	
9650.00	90.300	1.910	7607.76	4313.96	4308.19	-282.96	40°08'03.344"N	104°52'13.245"W	2.01	
9735.00	91.260	3.050	7606.61	4398.75	4393.10	-279.29	40°08'04.183"N	104°52'13.198"W	1.75	
9820.00	90.270	2.710	7605.47	4483.50	4477.98	-275.01	40°08'05.022"N	104°52'13.143"W	1.23	
9905.00	91.630	3.760	7604.06	4568.20	4562.83	-270.22	40°08'05.860"N	104°52'13.081"W	2.02	
9991.00	91.200	3.300	7601.94	4653.85	4648.64	-264.93	40°08'06.708"N	104°52'13.013"W	0.73	
10075.00	90.360	3.160	7600.79	4737.56	4732.50	-260.19	40°08'07.537"N	104°52'12.952"W	1.01	
10161.00	91.040	2.980	7599.74	4823.29	4818.37	-255.59	40°08'08.386"N	104°52'12.893"W	0.82	
10246.00	90.700	2.810	7598.45	4908.03	4903.25	-251.30	40°08'09.224"N	104°52'12.837"W	0.45	
10331.00	90.490	1.980	7597.57	4992.84	4988.17	-247.74	40°08'10.064"N	104°52'12.792"W	1.01	
10415.00	90.300	1.370	7596.99	5076.71	5072.14	-245.29	40°08'10.893"N	104°52'12.760"W	0.76	
10501.00	90.030	2.240	7596.74	5162.57	5158.09	-242.58	40°08'11.743"N	104°52'12.725"W	1.06	
10586.00	89.500	2.000	7597.09	5247.40	5243.03	-239.44	40°08'12.582"N	104°52'12.685"W	0.68	
10671.00	89.040	1.120	7598.18	5332.28	5327.99	-237.12	40°08'13.422"N	104°52'12.655"W	1.17	
10756.00	89.100	0.050	7599.55	5417.21	5412.98	-236.25	40°08'14.262"N	104°52'12.644"W	1.26	
10841.00	90.330	1.000	7599.98	5502.16	5497.97	-235.47	40°08'15.101"N	104°52'12.634"W	1.83	
10926.00	91.540	1.380	7598.59	5587.06	5582.94	-233.71	40°08'15.941"N	104°52'12.611"W	1.49	
11011.00	90.670	0.660	7596.95	5671.96	5667.91	-232.20	40°08'16.781"N	104°52'12.592"W	1.33	
11097.00	91.010	0.360	7595.69	5757.90	5753.89	-231.43	40°08'17.631"N	104°52'12.582"W	0.53	
11182.00	90.490	359.960	7594.58	5842.86	5838.89	-231.19	40°08'18.470"N	104°52'12.579"W	0.77	
11267.00	91.070	0.090	7593.42	5927.82	5923.88	-231.16	40°08'19.310"N	104°52'12.578"W	0.70	

REFERENCE WELLPATH IDENTIFICATION

Operator	KERR-MCGEE OIL & GAS ONSHORE LP (LAMBERT STATE PLANE COORD)	Slot	SLOT#42 TAIPAN 27C-15HZ (2192'FSL & 530'FEL, SEC.22)
Area	COLORADO	Well	TAIPAN 27C-15HZ
Field	WELD COUNTY (KERR MCGEE)	Wellbore	TAIPAN 27C-15HZ AWB <62-13627>
Facility	SEC.22-T2N-R67W		

WELLPATH DATA (162 stations)

MD [ft]	Inclination [°]	Azimuth [°]	TVD [ft]	Vert Sect [ft]	North [ft]	East [ft]	Latitude	Longitude	DLS ["/100ft]	Comments
11352.00	91.140	1.120	7591.78	6012.75	6008.86	-230.26	40°08'20.150"N	104°52'12.567"W	1.21	
11437.00	90.490	0.670	7590.57	6097.67	6093.84	-228.93	40°08'20.990"N	104°52'12.550"W	0.93	
11522.00	91.070	1.230	7589.42	6182.59	6178.82	-227.52	40°08'21.830"N	104°52'12.532"W	0.95	
11607.00	90.240	0.850	7588.44	6267.50	6263.80	-225.98	40°08'22.669"N	104°52'12.512"W	1.07	
11777.00	90.060	1.170	7588.00	6437.35	6433.77	-222.98	40°08'24.349"N	104°52'12.473"W	0.22	
11862.00	89.380	0.290	7588.41	6522.28	6518.76	-221.90	40°08'25.189"N	104°52'12.459"W	1.31	
11947.00	90.860	0.240	7588.24	6607.24	6603.76	-221.51	40°08'26.029"N	104°52'12.454"W	1.74	
12032.00	91.410	0.270	7586.55	6692.19	6688.74	-221.13	40°08'26.869"N	104°52'12.449"W	0.65	
12117.00	90.330	359.720	7585.26	6777.15	6773.73	-221.14	40°08'27.709"N	104°52'12.449"W	1.43	
12202.00	90.770	359.910	7584.45	6862.12	6858.72	-221.41	40°08'28.549"N	104°52'12.453"W	0.56	
12288.00	90.430	0.890	7583.55	6948.07	6944.71	-220.81	40°08'29.398"N	104°52'12.445"W	1.21	
12372.00	91.110	0.350	7582.42	7032.01	7028.70	-219.90	40°08'30.228"N	104°52'12.434"W	1.03	
12457.00	89.870	0.310	7581.69	7116.97	7113.69	-219.41	40°08'31.068"N	104°52'12.427"W	1.46	
12543.00	90.360	1.380	7581.52	7202.90	7199.68	-218.14	40°08'31.918"N	104°52'12.411"W	1.37	
12628.00	89.960	0.680	7581.28	7287.81	7284.67	-216.62	40°08'32.758"N	104°52'12.391"W	0.95	
12713.00	91.230	1.590	7580.40	7372.72	7369.64	-214.93	40°08'33.598"N	104°52'12.370"W	1.84	
12798.00	91.780	1.160	7578.16	7457.59	7454.59	-212.89	40°08'34.437"N	104°52'12.343"W	0.82	
12883.00	90.760	1.470	7576.28	7542.47	7539.55	-210.94	40°08'35.277"N	104°52'12.318"W	1.25	
12968.00	90.180	1.140	7575.58	7627.37	7624.52	-209.01	40°08'36.116"N	104°52'12.293"W	0.79	
13053.00	89.720	0.460	7575.66	7712.30	7709.51	-207.82	40°08'36.956"N	104°52'12.278"W	0.97	
13138.00	91.010	0.970	7575.12	7797.24	7794.50	-206.76	40°08'37.796"N	104°52'12.264"W	1.63	
13223.00	90.550	359.660	7573.96	7882.19	7879.49	-206.29	40°08'38.636"N	104°52'12.258"W	1.63	
13308.00	89.590	0.240	7573.86	7967.16	7964.49	-206.37	40°08'39.476"N	104°52'12.259"W	1.32	
13393.00	89.960	359.850	7574.19	8052.13	8049.49	-206.30	40°08'40.316"N	104°52'12.259"W	0.63	
13478.00	89.220	359.360	7574.80	8137.11	8134.48	-206.89	40°08'41.156"N	104°52'12.266"W	1.04	
13572.00	89.320	359.070	7575.99	8231.10	8228.47	-208.17	40°08'42.084"N	104°52'12.283"W	0.33	LAST BHI MWD+IFR SURVEY
13627.00	89.320	359.070	7576.65	8286.09	8283.45	-209.07	40°08'42.628"N	104°52'12.294"W	0.00	PROJECTION TO BIT

HOLE & CASING SECTIONS - Ref Wellbore: TAIPAN 27C-15HZ AWB <62-13627> Ref Wellpath: TAIPAN 27C-15HZ AWP

String/Diameter	Start MD [ft]	End MD [ft]	Interval [ft]	Start TVD [ft]	End TVD [ft]	Start N/S [ft]	Start E/W [ft]	End N/S [ft]	End E/W [ft]
13.5in Open Hole	16.00	1294.00	1278.00	16.00	1293.96	0.00	0.00	-2.12	0.20
9.625in Casing Surface	16.00	1294.00	1278.00	16.00	1293.96	0.00	0.00	-2.12	0.20
8.75in Open Hole	1294.00	8657.00	7363.00	1293.96	7602.28	-2.12	0.20	3317.68	-232.40
7in Casing Intermediate	16.00	8645.00	8629.00	16.00	7601.80	0.00	0.00	3305.74	-231.27
6.125in Open Hole	8657.00	13627.00	4970.00	7602.28	7576.65	3317.68	-232.40	8283.45	-209.07

WELLPATH COMPOSITION - Ref Wellbore: TAIPAN 27C-15HZ AWB <62-13627> Ref Wellpath: TAIPAN 27C-15HZ AWP

Start MD [ft]	End MD [ft]	Positional Uncertainty Model	Log Name/Comment	Wellbore
16.00	1249.00	ISCWSA MWD, Rev. 2 (Standard)	CATHEDRAL MWD SURVEYS <62-1249>	TAIPAN 27C-15HZ AWB <62-13627>
1249.00	8598.00	NaviTrak (MAGCORR,IFR)	BHI NAVITRAK MWD+IFR 8 3/4" <1368-8598>	TAIPAN 27C-15HZ AWB <62-13627>
8598.00	13572.00	NaviTrak (MAGCORR,IFR)	BHI NAVITRAK MWD+IFR 6 1/8" <8714-13572>	TAIPAN 27C-15HZ AWB <62-13627>
13572.00	13627.00	Blind Drilling (std)	Projection to bit	TAIPAN 27C-15HZ AWB <62-13627>

REFERENCE WELLPATH IDENTIFICATION

Operator	KERR-MCGEE OIL & GAS ONSHORE LP (LAMBERT STATE PLANE COORD)	Slot	SLOT#42 TAIPAN 27C-15HZ (2192'FSL & 530'FEL, SEC.22)
Area	COLORADO	Well	TAIPAN 27C-15HZ
Field	WELD COUNTY (KERR MCGEE)	Wellbore	TAIPAN 27C-15HZ AWB <62-13627>
Facility	SEC.22-T2N-R67W		

WELLPATH COMMENTS

MD [ft]	Inclination [°]	Azimuth [°]	TVD [ft]	Comment
16.00	0.000	192.400	16.00	TIE ON
62.00	0.400	192.400	62.00	BEGIN CATHEDRAL MWD SURVEYS
1249.00	0.500	310.900	1248.96	TIE ONTO CATHEDRAL MWD SURVEYS
1368.00	0.650	69.310	1367.96	BEGIN BHI MWD+IFR SURVEYS
8645.00	87.647	354.619	7601.80	7" CASING POINT
13572.00	89.320	359.070	7575.99	LAST BHI MWD+IFR SURVEY
13627.00	89.320	359.070	7576.65	PROJECTION TO BIT