



## Grizzly 3-36H & Peterson Ridge 3-36H Access Road Map

Map to Accompany  
APPLICATION FOR PERMIT TO DRILL  
Access Road Map

EE3 LLC  
Grizzly 3-36H/Peterson Ridge 3-36H Wellpad  
Sec. 36 T8N R81W  
Jackson County, Colorado  
Surface: Fee

LEGEND

-  New Construction (Fee)  
 Existing Access (Fee)  
 Existing Access (State)

Revised by Upstream Petroleum Management, Inc.

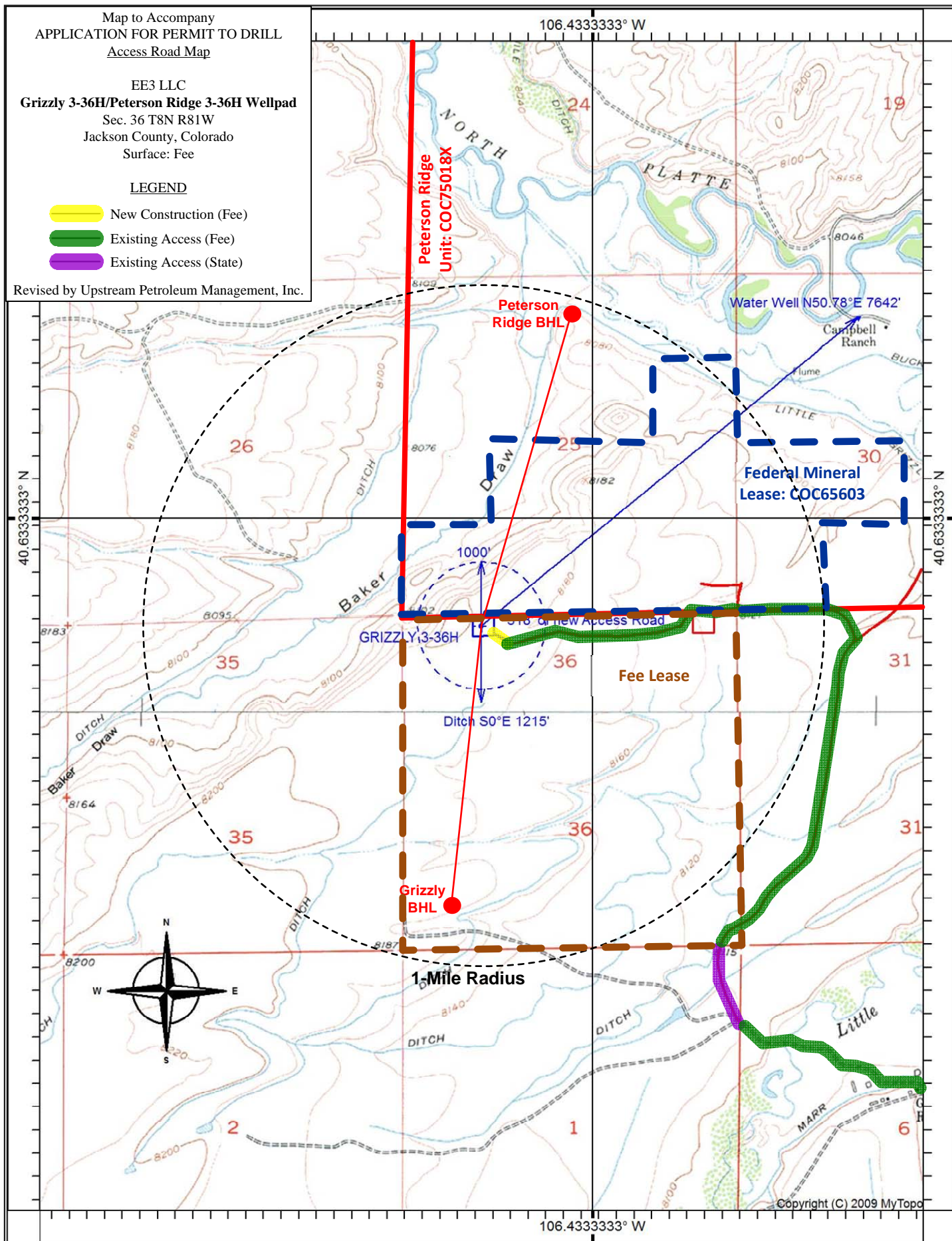



# GRIZZLY 3-36H 100k Map

Map to Accompany  
APPLICATION FOR PERMIT TO DRILL  
Area Map

EE3 LLC  
Grizzly 3-36H/Peterson Ridge 3-36H Wellpad  
Sec. 36 T8N R81W  
Jackson County, Colorado  
Surface: Fee

## LEGEND

- New Construction (Fee)
- Existing Access (Fee)
- Existing Access (State)
- State Highway 14

Revised by Upstream Petroleum Management, Inc.

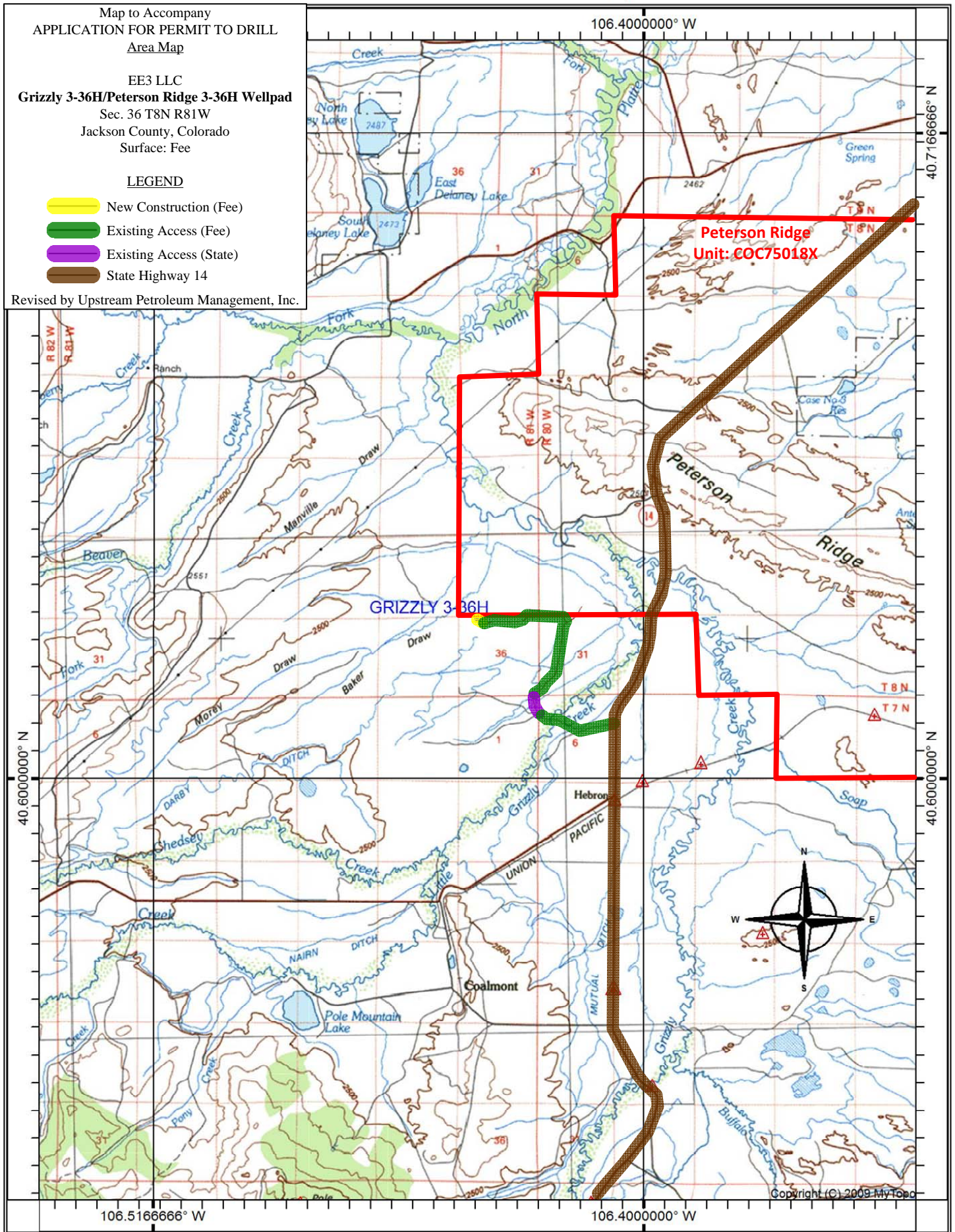

SCALE 1:100000

0 10000 20000  
FEET

Copyright (C) 2009 MyTopo