

Layers

- ☒ Points
- ☒ Buffer 1
- ☒ DEM_10m
- ☒ O&G Facilities
 - ☒ Wells
 - ☐ Well Name
 - ☐ Well API #
 - ☐ Misc Facilities
 - ☐ Pits
 - ☐ Active
 - ☐ Closed
 - ☐ Unknown
 - ☐ Permits
 - ☒ Pending Permits
 - ☐ Pending2As (Diamond)
 - ☐ Well Status
 - ☐ Spud Notice
 - ☐ UIC Active
 - ☐ SC Anomalies
 - ☐ Surface Casing
- ☒ COGCC Data
 - ☒ COGCCAlert_v4
 - ☒ COGCCAlert
 - ☒ COGCCOnsite
 - ☐ Samples
 - ☐ Remediation
- ☐ O&G Locations
- ☐ Directionals
- ☐ COGCC Rules
- ☐ O&G Fields
- ☐ Field Insp Unit
- ☐ SeismicPermits
- ☐ Historic Wells
- ☐ Roads & RRs
- ☐ Water Resources
- ☐ Environmental_Sites
- ☐ SecTwpRng
- ☐ LGDS
- ☐ Wildlife CPW
- ☐ State Lands
- ☐ Indian Lands
- ☐ BLM Lands
- ☐ Surface Lands

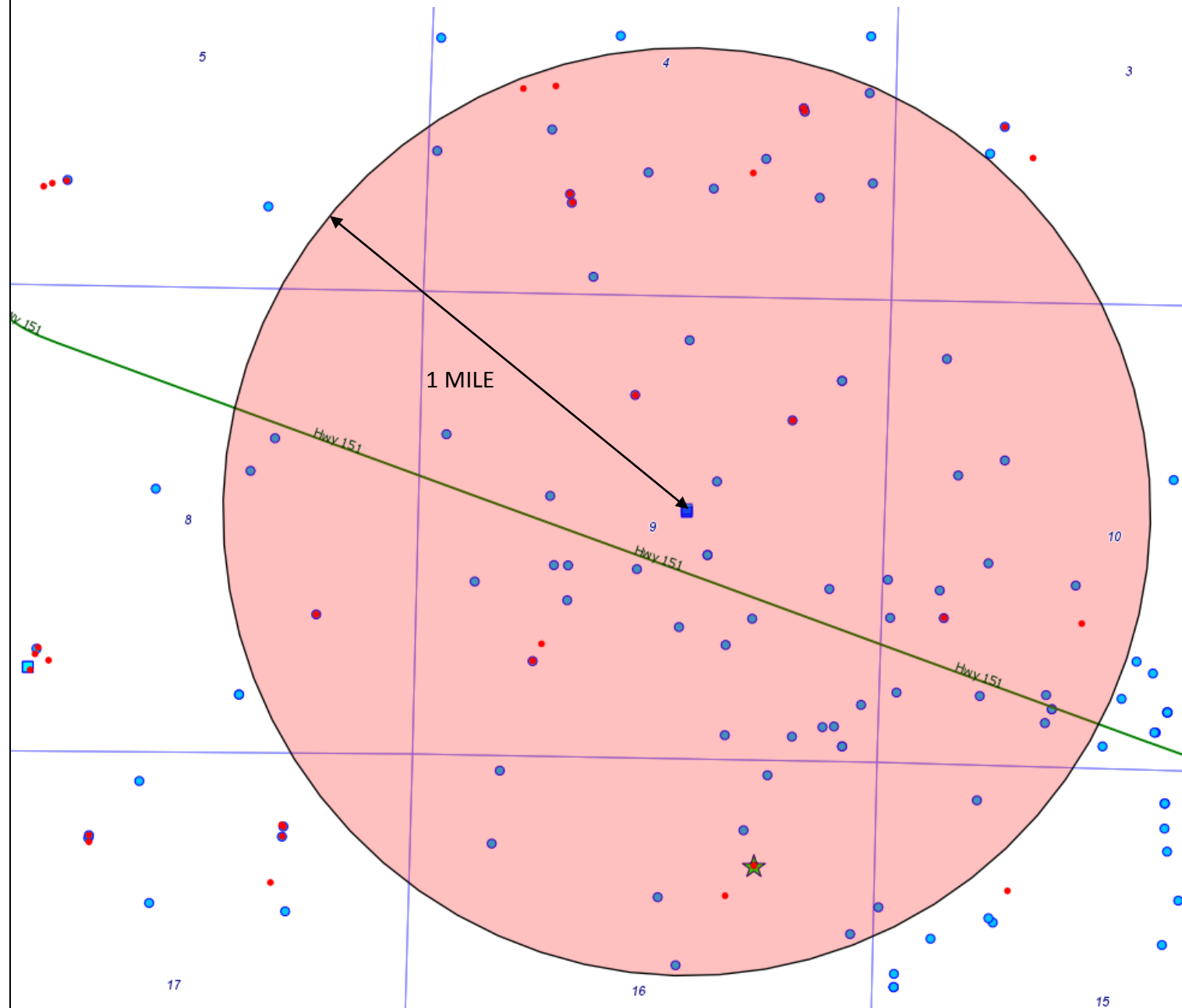

Selected Items Report

Oil and Gas Wells Selected

Filter Results by Formation

Include ▼

Filter

WELL DESCRIPTION

LOCATION ID

LOCATION

WELL INFORMATION

Water Wells Selected From Map

Filter Results by Depth

Greater than ▼

Filter

WELL DESCRIPTION

LOCATION

WELL INFORMATION

Depth

Top Perf

Bottom Perf

Aquifer

[Receipt=0271937A, Permit=0147137--](#)
RIDDLE JACK

NESE 4
32 N-6W

60

0

0

GW

[Receipt=1504910, Permit=0069250-F-](#)
ENERGEN RESOURCES CORPORATION

NESE 4
32 N-6W

0

0

0

GW

[Receipt=1504912, Permit=0069252-F-](#)
ENERGEN RESOURCES CORPORATION

NESE 4
32 N-6W

0

0

0

GW

[Receipt=9702370, Permit=0271519--](#)
ICE JR JOSEPH L

NESE 4
32 N-6W

140

50

140

GW

[Receipt=0439968F, Permit=0214649--](#)
CHARETTE ART AND MAUREEN

NWSE 4
32 N-6W

140

35

140

GW

[Receipt=0439968K, Permit=0214654--](#)
BIG ELK 2000 LLC

SESE 4
32 N-6W

0

0

0

GW

[Receipt=0439968G, Permit=0214650--](#)
BIG ELK 2000 LLC

SWSE 4
32 N-6W

240

25

240

GW

[Receipt=0439968D, Permit=0214647--](#)
BIG ELK 2000 LLC

NESW 4
32 N-6W

0

0

0

GW

[Receipt=0444300, Permit=0216226--](#)
GRACE A SOSSAMAN REVOCABLE TRUST

NESW 4
32 N-6W

240

25

240

GW

[Receipt=0439968E, Permit=0214648--](#)
BIG ELK 2000 LLC

NWSW 4
32 N-6W

0

0

0

GW

| | | | | | |
|---|-------------------|-----|-----|-----|----|
| Receipt=0439968H, Permit=0214651-- BIG ELK 2000 LLC | SESW 4 32 N-6W | 0 | 0 | 0 | GW |
| Receipt=1504945, Permit=0069285-F- ENERGEN RESOURCES CORPORATION | SESW 4 32 N-6W | 0 | 0 | 0 | GW |
| Receipt=1504947, Permit=0069287-F- ENERGEN RESOURCES CORPORATION | SESW 4 32 N-6W | 0 | 0 | 0 | GW |
| Receipt=0434827, Permit=0211887-- HOLCOMB ROBERT & GRACE | SWNE 8 32 N-6W | 0 | 0 | 0 | GW |
| Receipt=0229021B, Permit=0127140-- PHELPS R | SWNE 8 32 N-6W | 200 | 12 | 190 | GW |
| Receipt=1503816, Permit=0070160-F- BP AMERICA PRODUCTION CO | NESE 8 32 N-6W | 0 | 0 | 0 | GW |
| Receipt=9702256, Permit=0269713-- ARTHUR THOMAS E | NENE 9 32 N-6W | 240 | 100 | 220 | GW |
| Receipt=0439968J, Permit=0214653-- BIG ELK 2000 LLC | NENE 9 32 N-6W | 0 | 0 | 0 | GW |
| Receipt=0439968I, Permit=0214652-- BIG ELK 2000 LLC | NWNE 9 32 N-6W | 240 | 30 | 240 | GW |
| Receipt=1503182, Permit=0070062-F- BP AMERICA PRODUCTION CO | SENE 9 32 N-6W | 0 | 0 | 0 | GW |
| Receipt=0246097, Permit=0135716-- SERNA A | SWNE 9 32 N-6W | 195 | 95 | 195 | GW |
| Receipt=1503847, Permit=0070197-F- BP AMERICA PRODUCTION CO | NENW 9 32 N-6W | 0 | 0 | 0 | GW |
| Receipt=0211591, Permit=0118315-- NOSSAMAN B | SENW 9 32 N-6W | 130 | 30 | 110 | GW |
| Receipt=9124069, Permit=0118732-- ENGLER RICHARD C. & SHIRLEY | SWNW 9 32 N-6W | 140 | 0 | 0 | GW |
| Receipt=0447988B, Permit=0218549-- GLOVER EDWIN | NESE 9 32 N-6W | 0 | 0 | 0 | GW |
| Receipt=0411635, Permit=0200471-- SIVERS ROBERT | NWSE 9 32 N-6W | 258 | 100 | 258 | GW |
| Receipt=0285967, Permit=0150837-- KINNIBRUGH CLYDE | NWSE 9 32 N-6W | 200 | 130 | 200 | KM |
| Receipt=0372774, Permit=0181058-- FREIER JOHN C & DEBORAH K | NWSE 9 32 N-6W | 140 | 0 | 0 | GW |
| Receipt=0447988A, Permit=0181058--A GLOVER EDWIN | NWSE 9 32 N-6W | 0 | 0 | 0 | GW |

| | | | | | |
|---|---------------------------|------------|------------|------------|---------------------|
| Receipt=9701128, Permit=0248739-- YOUNG EARL C AND BETTY L | SESE 9 32 N-6W | 0 | 0 | 0 | GW |
| Receipt=9702160, Permit=0267938-- GOSNEY SHELDON AND SHAMRA | SESE 9 32 N-6W | 120 | 60 | 80 | GW |
| Receipt=0408695, Permit=0199076-- BREDE JAMES ERWIN | SESE 9 32 N-6W | 77 | 22 | 77 | GW |
| Receipt=0298189, Permit=0153794-- BUTZKE A H | SESE 9 32 N-6W | 0 | 0 | 0 | GW |
| Receipt=0316812, Permit=0158120-- GILLIS THEODORE J | SESE 9 32 N-6W | 0 | 0 | 0 | GW |
| Receipt=0370153, Permit=0179310-- BUTZKE WESLEY A | SESE 9 32 N-6W | 90 | 40 | 90 | GW |
| Receipt=0362771, Permit=0175437-- SIVERS BRUCE K | SWSE 9 32 N-6W | 140 | 40 | 140 | GW |
| Receipt=1505264, Permit=0075322-F- BP AMERICA PRODUCTION COMPANY | SWSE 9 32 N-6W | 0 | 0 | 0 | GW |
| Receipt=0411634A, Permit=0200470-- SIVERS ROBERT | NESW 9 32 N-6W | 0 | 0 | 0 | GW |
| Receipt=0259477, Permit=0141608-- SIVERS R.R. | NESW 9 32 N-6W | 0 | 0 | 0 | KD |
| Receipt=0261125, Permit=0142526-- SIVERS R.R. | NESW 9 32 N-6W | 0 | 0 | 0 | KD |
| Receipt=0263985, Permit=0143733-- SIVERS ROBERT R. | NESW 9 32 N-6W | 600 | 480 | 600 | KD 5670' |
| Receipt=9122666, Permit=0047377-- BEATY JOHN A | NWSW 9 32 N-6W | 0 | 0 | 0 | GW |
| Receipt=1503179, Permit=0070059-F- BP AMERICA PRODUCTION CO | SESW 9 32 N-6W | 0 | 0 | 0 | GW |
| Receipt=9702127, Permit=0267431-- KLINE CAROL | NWNW 10 32 N-6W | 200 | 80 | 180 | GW |
| Receipt=9122573, Permit=0045100-- SHOCK LAWRENCE | SENW 10 32 N-6W | 22 | 0 | 0 | GW |
| Receipt=0230016, Permit=0045100--A BROWN E.J. | SENW 10 32 N-6W | 150 | 50 | 150 | GW |
| Receipt=0293555, Permit=0152782-- YEAGER HARLEY | NESW 10 32 N-6W | 200 | 90 | 200 | GW |
| Receipt=1503012, Permit=0070033-F- BP AMERICA PRODUCTION CO | NWSW 10 32 N-6W | 0 | 0 | 0 | GW |

| | | | | | |
|--|--------------------|-----|----|-----|----|
| Receipt=0446422, Permit=0217771-- COX EARL | NWSW 10 32 N-6W | 160 | 25 | 160 | GW |
| Receipt=3618280, Permit=0065963-F- MOLINA MARIA ANITA | NWSW 10 32 N-6W | 160 | 25 | 160 | GW |
| Receipt=9121930, Permit=0002563-- ZIMERFIELD JOHN | NWSW 10 32 N-6W | 110 | 0 | 0 | GW |
| Receipt=9123356, Permit=0081564-- CUFFLIN WILLIAM H. III | NWSW 10 32 N-6W | 200 | 0 | 0 | GW |
| Receipt=9702378, Permit=0271645-- SIMONS JR LAURIE & ROBERT | SESW 10 32 N-6W | 16 | 0 | 0 | GW |
| Receipt=9122009, Permit=0007748-- WALTON WAYNE | SESW 10 32 N-6W | 64 | 0 | 0 | GW |
| Receipt=9122010, Permit=0007749-- WALKER JOHN | SESW 10 32 N-6W | 60 | 0 | 0 | GW |
| Receipt=0093547, Permit=0100088-- SIMONS ROBERT W | SESW 10 32 N-6W | 0 | 0 | 0 | KM |
| Receipt=0913930, Permit=0111113-- WILLINGHAM SHERMAN E | SWSW 10 32 N-6W | 0 | 0 | 0 | GW |
| Receipt=9123114, Permit=0073698-- MILLICH PETE & DELLA | SWSW 10 32 N-6W | 75 | 50 | 75 | GW |
| Receipt=9123137, Permit=0074233-- HANNA MARCIA N & ALFORD A | NENE 15 32 N-6W | 75 | 35 | 75 | GW |
| Receipt=9703506, Permit=0293650-- SHARP LIVING TRUST DOUG AND JAMIE | SWNW 15 32 N-6W | 100 | 50 | 90 | GW |
| Receipt=1503177, Permit=0070057-F- BP AMERICA PRODUCTION CO | NWNE 16 32 N-6W | 0 | 0 | 0 | GW |
| Receipt=0363562, Permit=0175910-- SUTTON JAMES & MARGARET | NWNE 16 32 N-6W | 0 | 0 | 0 | GW |
| Receipt=9702905, Permit=0280022-- SUTTON JAMES W AND MAGARET M | SENE 16 32 N-6W | 140 | 30 | 120 | GW |
| Receipt=9123425, Permit=0084267-- SUTTON JAMES | SWNE 16 32 N-6W | 236 | 0 | 0 | GW |
| Receipt=0365880, Permit=0176893-- SUTTON JAMES W | SWNE 16 32 N-6W | 160 | 40 | 160 | GW |
| Receipt=9122708, Permit=0048807-- PHELPS J W | NWNW 16 32 N-6W | 50 | 0 | 0 | GW |
| Receipt=9122711, Permit=0049042-- PHELPS J W | NWNW 16 32 N-6W | 70 | 0 | 0 | GW |

| | | | | | |
|--|--------------------|---|---|---|----|
| Receipt=1505261 , Permit=0075319-F- BP AMERICA PRODUCTION COMPANY | NWNW 16 32 N-6W | 0 | 0 | 0 | GW |
|--|--------------------|---|---|---|----|

Layers

- ☒ Buffer 1
- ☒ Points
- ☐ DEM_10m
- ☒ O&G Facilities
 - ☒ Wells
 - ☐ Well Name
 - ☐ Well API #
 - ☐ Misc Facilities
 - ☐ Pits
 - ☒ Active
 - ☒ Closed
 - ☐ Unknown
 - ☐ Permits
 - ☒ Pending Permits
 - ☐ Pending2As (Diamond)
 - ☐ Well Status
 - ☐ Spud Notice
 - ☐ UIC Active
 - ☐ SC Anomalies
 - ☐ Surface Casing
- ☒ COGCC Data
 - ☒ COGCCAlert_v4
 - ☒ COGCCAlert
 - ☒ COGCCOnsite
 - ☐ Samples
 - ☐ Remediation
- ☐ O&G Locations
- ☒ Directionals
- ☒ COGCC Rules
- ☐ O&G Fields
- ☒ Field Insp Unit
- ☐ SeismicPermits
- ☒ Historic Wells
- ☒ Roads & RRs
- ☒ Water Resources
- ☒ Environmental_Sites
- ☒ SecTwpRng
- ☒ LGDS
- ☒ Wildlife CPW
- ☒ State Lands
- ☒ Indian Lands
- ☒ RI M Lands

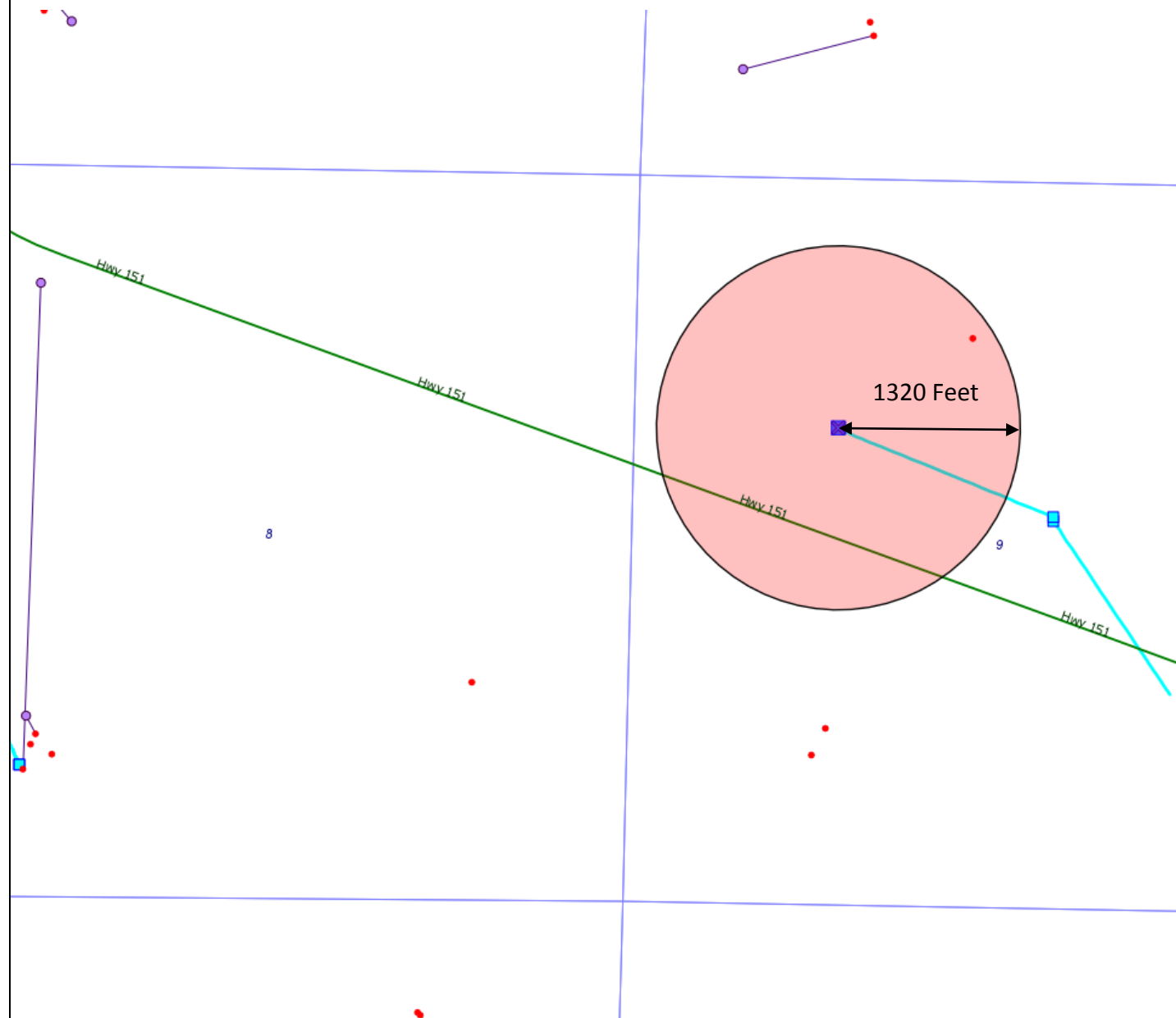

Selected Items Report

Oil and Gas Wells Selected

Filter Results by Formation

Include



FRLDC

Filter

| WELL DESCRIPTION | LOCATION ID | LOCATION | WELL INFORMATION | | | | | | | | |
|---|------------------------|-----------------------|---|-----------|----|-----------|--------|----|------|-------|----|
| 05-067-08955, TUBBS 32-6-9 B 2 BP AMERICA PRODUCTION COMPANY | 306882 | NENW 9 32N -6W (N) | <table> <tr> <th>Sidetrack</th><th>TD</th><th>Formation</th><th>Status</th></tr> <tr> <td>00</td><td>3150</td><td>FRLDC</td><td>PR</td></tr> </table> | Sidetrack | TD | Formation | Status | 00 | 3150 | FRLDC | PR |
| Sidetrack | TD | Formation | Status | | | | | | | | |
| 00 | 3150 | FRLDC | PR | | | | | | | | |