

**KGH OPERATING COMPANY**  
P.O. Box 2235, Billings, Montana 59101

**WELL PAD - LOCATION LAYOUT**

**MEAGHER 3-4**  
**3082' FNL & 730' FEL**  
**LOT 4 OF SECTION 3, T1S, R104W,**  
**6th P.M., RIO BLANCO COUNTY,**  
**COLORADO.**

PAD FOOTPRINT AREA = ±1.823 ACRES  
PAD DISTURBANCE AREA (Cut/Fill Slopes, Stockpiles) = ±2.996 ACRES  
AREA WITHIN SURFACE DISTURBANCE BOUNDARY = ±3.869 ACRES

**ESTIMATED EARTHWORK QUANTITIES**  
(No shrink or swell adjustments have been used)  
(Expressed in Cubic Yards)

6" Topsoil Stripping = 1,870  
Remaining Cut (Including Pit Material) = 15,450  
TOTAL CUT = 17,320  
FILL = 14,800  
Pit Backfill = 650, Excess Material = 0

REFERENCE POINTS:  
170' SOUTHERLY, EL = 6053.0'  
220' SOUTHERLY, EL = 6048.7'  
200' WESTERLY, EL = 6036.8'  
250' WESTERLY, EL = 6030.5'

**TIMBERLINE**

(435) 789-1365

**ENGINEERING & LAND SURVEYING, INC.**  
209 NORTH 300 WEST - VERNAL, UTAH 84078

DATE SURVEYED:  
1-06-15

DATE DRAWN:  
1-22-15

SCALE: 1" = 50'

SURVEYED BY: A.F.

DRAWN BY: A.P.

Date Last Revised:

SHEET NO:

4

OF 14

NOTE:  
PRODUCTION EQUIPMENT LOCATION  
COULD VARY DUE TO SITE AND OPERATION  
EFFECTIVENESS.

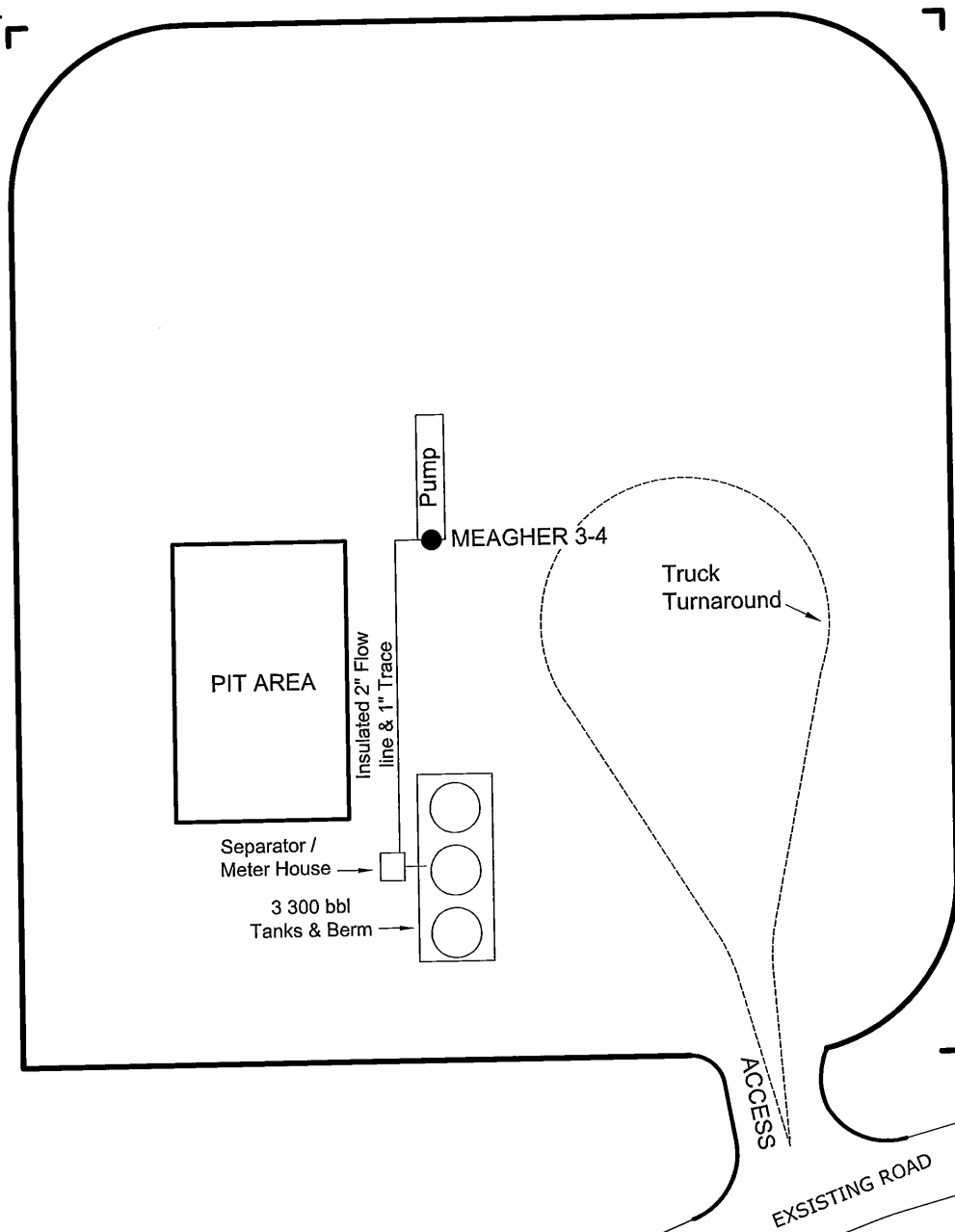

LEGEND

● = PROPOSED WELL LOCATION

**KGH OPERATING COMPANY**

P.O. Box 2235, Billings, Montana 59101

**WELL PAD - FACILITY DIAGRAM**

**MEAGHER 3-4**  
**3082' FNL & 730' FEL**  
**LOT 4 OF SECTION 3, T1S, R104W,**  
**6th P.M., RIO BLANCO COUNTY,**  
**COLORADO.**

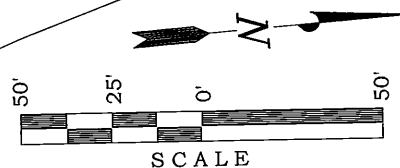

**TIMBERLINE**

(435) 789-1365

ENGINEERING & LAND SURVEYING, INC.  
209 NORTH 300 WEST - VERNAL, UTAH 84078

DATE SURVEYED:  
1-06-15

SURVEYED BY: A.F.

DATE DRAWN:  
1-22-15

DRAWN BY: A.P.

SCALE: 1" = 50'

Date Last Revised:

SHEET NO:

**5**

OF 14

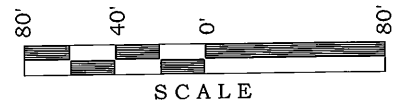
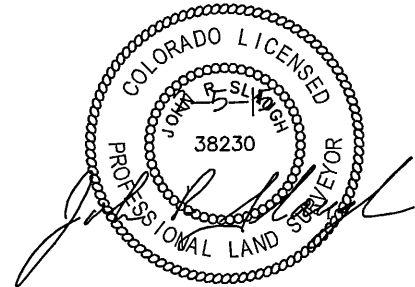
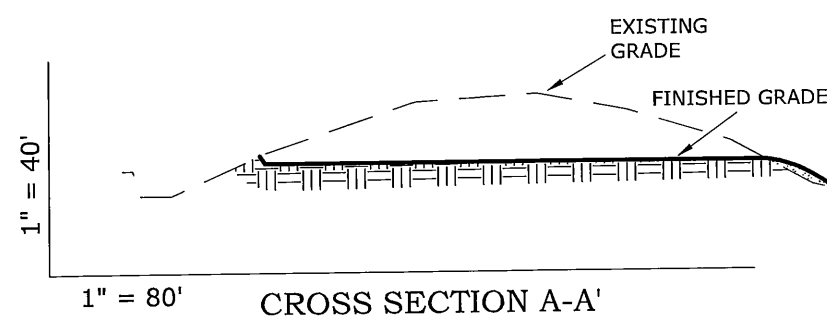
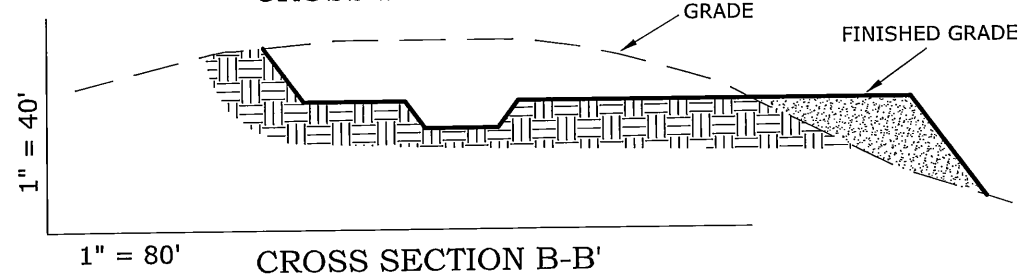
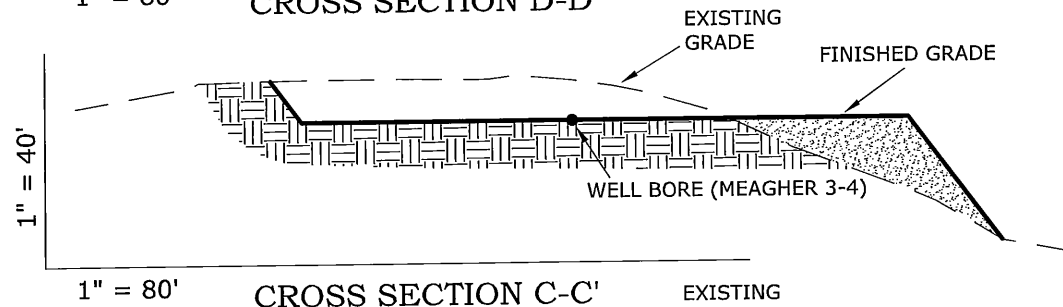
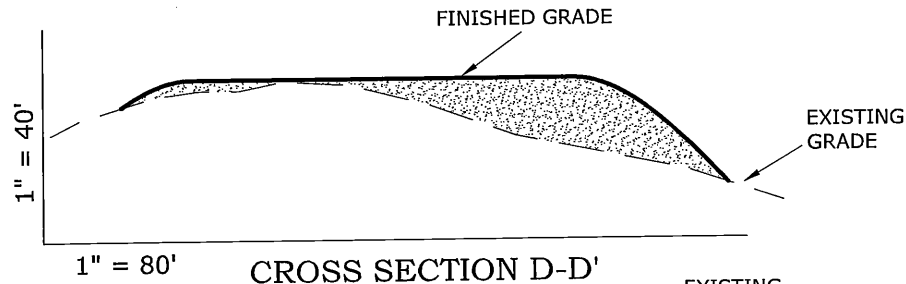
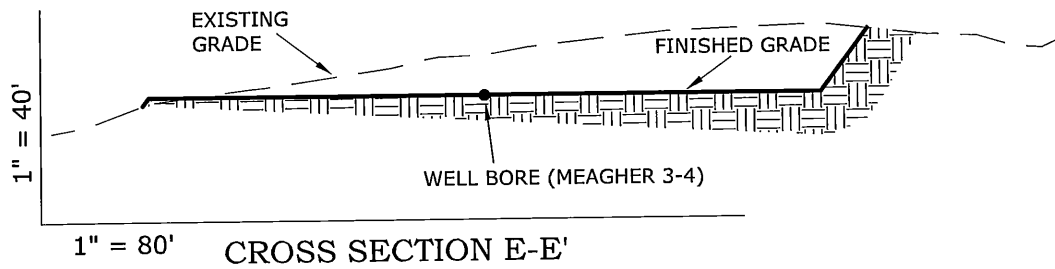

## KGH OPERATING COMPANY

P.O. Box 2235, Billings, Montana 59101

### WELL PAD - CROSS SECTION

#### MEAGHER 3-4

3082' FNL & 730' FEL  
LOT 4 OF SECTION 3, T1S, R104W,  
6th P.M., RIO BLANCO COUNTY,  
COLORADO.

### TIMBERLINE

(435) 789-1365

ENGINEERING & LAND SURVEYING, INC.  
209 NORTH 300 WEST - VERNAL, UTAH 84078

DATE SURVEYED: 1-06-15	SURVEYED BY: A.F.	SHEET NO: <b>6</b> OF 14
DATE DRAWN: 1-22-15	DRAWN BY: A.P.	
SCALE: 1" = 80'	Date Last Revised:	

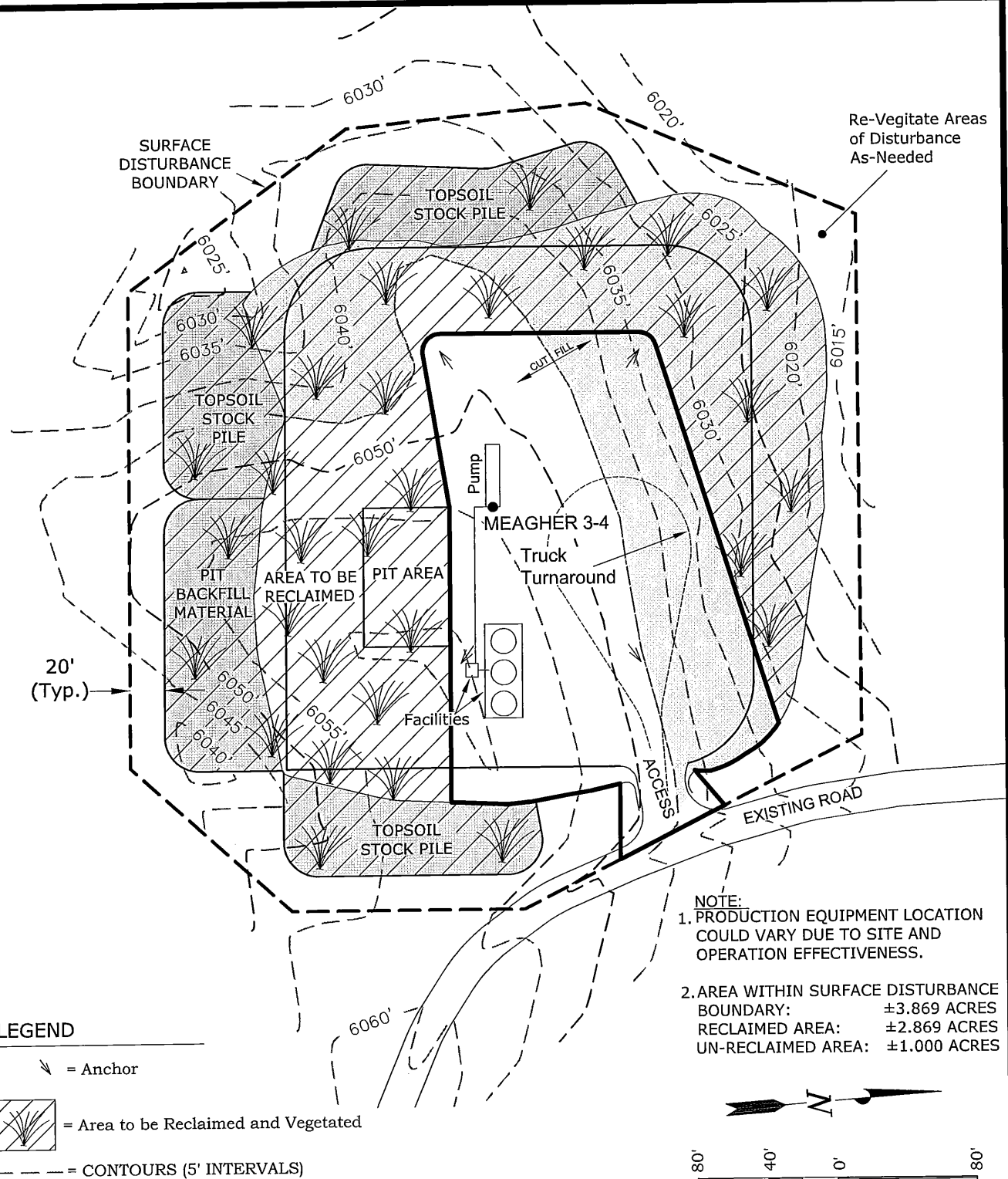

**KGH OPERATING COMPANY**  
P.O. Box 2235, Billings, Montana 59101

**INTERIM RECLAMATION DIAGRAM**

**MEAGHER 3-4**  
**3082' FNL & 730' FEL**  
**LOT 4 OF SECTION 3, T1S, R104W,**  
**6th P.M., RIO BLANCO COUNTY,**  
**COLORADO.**

**TIMBERLINE** (435) 789-1365  
ENGINEERING & LAND SURVEYING, INC.  
209 NORTH 300 WEST - VERNAL, UTAH 84078

DATE SURVEYED: 1-06-15	SURVEYED BY: A.F.	SHEET NO: <b>7</b> OF 14
DATE DRAWN: 1-22-15	DRAWN BY: A.P.	
SCALE: 1" = 80'	Date Last Revised:	