

Fox Creek 508-33H
 Sec.33-T12N-R63W
 Weld County, Colorado

Surface Location			
NAD 1927 (NADCON CONUS) Colorado North 501			
Ground Elevation: 5478.0 KB @ 5503.0usft (ACT GL+25')			
Northing	Easting	Latitude	Longitude
598839.54	2291057.79	40° 58' 20.835 N	104° 26' 45.784 W

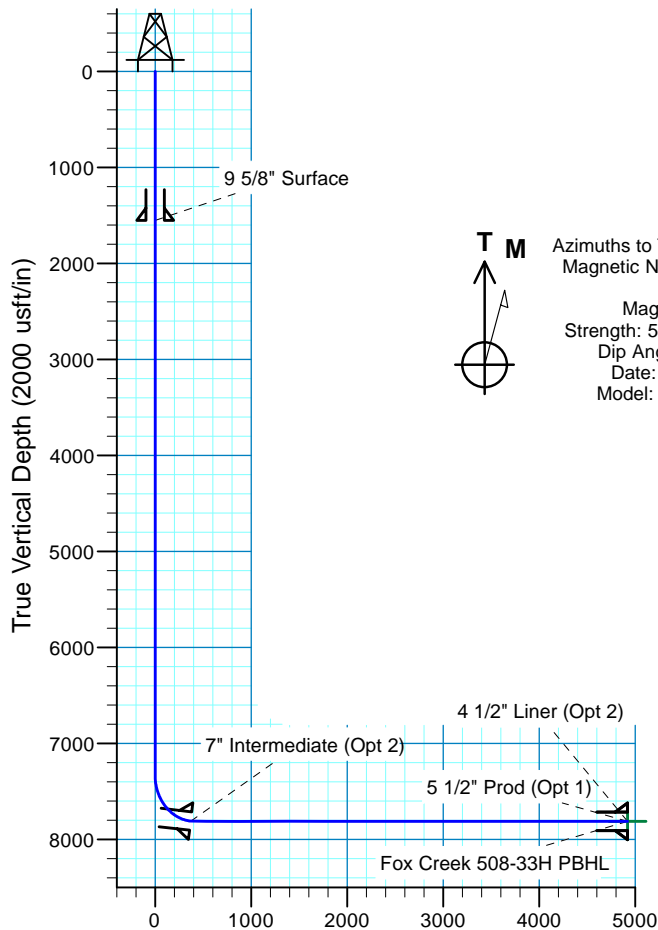

Vertical Section at 350.27° (2000 usft/in)

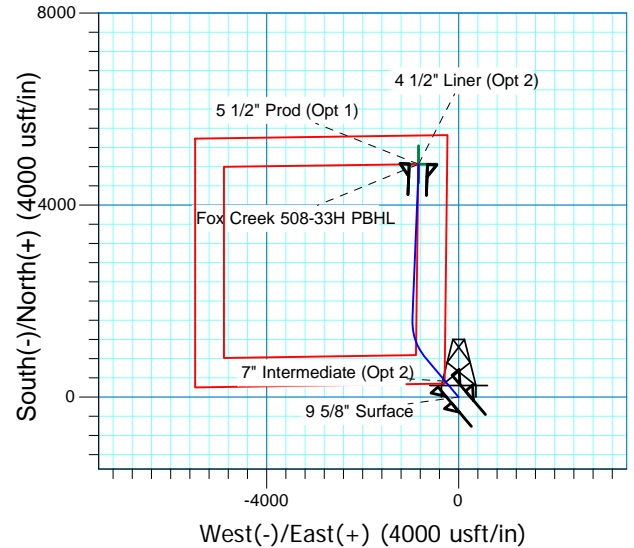

Project: DJ - Hereford Ranch
 Site: Fox Creek FC33 NWNW Pad
 Well: Fox Creek 508-33H
 Plan: APD Plan (Plat Cert 2/20/15)

SECTION DETAILS										
Sec	MD	Inc	Azi	TVD	+N/-S	+E/-W	Dleg	TFace	VSect	Target
1	0.0	0.00	0.00	0.0	0.0	0.0	0.00	0.00	0.0	
2	7335.5	0.00	0.00	7335.5	0.0	0.0	0.00	0.00	0.0	
3	8085.5	90.00	320.00	7813.0	365.8	-306.9	12.00	320.00	412.4	
4	8685.5	90.00	320.00	7813.0	825.4	-692.6	0.00	0.00	930.6	
5	9530.6	90.00	2.26	7813.0	1607.1	-959.8	5.00	90.00	1746.2	Fox Creek 508-33H PBHL
6	12776.3	90.00	2.26	7813.0	4850.3	-832.0	0.00	0.00	4921.1	Fox Creek 508-33H PBHL
TARGET DETAILS										
Name	TVD	+N/-S	+E/-W	Northing	Easting	Latitude	Longitude	Shape		
580-33H PBH 2-19-15	7773.0	4850.3	-832.0	603679.56	2290168.19	40° 59' 8.758 N	104° 26' 56.632 W	Point		
Fox Creek 508-33H PBHL	7813.0	4850.3	-832.0	603679.56	2290168.19	40° 59' 8.758 N	104° 26' 56.632 W	Point		

Denver Division- Colorado

**DJ - Hereford Ranch
Fox Creek FC33 NWNW Pad
Fox Creek 508-33H**

OH

Plan: APD Plan (Plat Cert 2/20/15)

Standard Planning Report

23 February, 2015

EOG Resources, Inc.

Planning Report

Database:	EDM_DENVER	Local Co-ordinate Reference:	Well Fox Creek 508-33H
Company:	Denver Division- Colorado	TVD Reference:	KB @ 5503.0usft (ACT GL+25')
Project:	DJ - Hereford Ranch	MD Reference:	KB @ 5503.0usft (ACT GL+25')
Site:	Fox Creek FC33 NWNW Pad	North Reference:	True
Well:	Fox Creek 508-33H	Survey Calculation Method:	Minimum Curvature
Wellbore:	OH		
Design:	APD Plan (Plat Cert 2/20/15)		

Project	DJ - Hereford Ranch, Weld County		
Map System:	US State Plane 1927 (Exact solution)	System Datum:	Mean Sea Level
Geo Datum:	NAD 1927 (NADCON CONUS)		
Map Zone:	Colorado North 501		

Site	Fox Creek FC33 NWNW Pad		
Site Position:		Northing:	598,750.00 usft
From:	Map	Easting:	2,291,850.00 usft
Position Uncertainty:	0.0 usft	Slot Radius:	13-3/16 "
		Latitude:	40° 58' 19.858 N
		Longitude:	104° 26' 35.472 W
		Grid Convergence:	0.68 °

Well	Fox Creek 508-33H		
Well Position	+N/-S	99.0 usft	Northing:
	+E/-W	-791.1 usft	Easting:
Position Uncertainty	0.0 usft		Wellhead Elevation:
			Latitude:
			Longitude:
			Ground Level:

Wellbore	OH		
Magnetics	Model Name	Sample Date	Declination
			(°)
	IGRF2015	2/17/2015	8.33
			Dip Angle
			(°)
			67.42
			Field Strength
			(nT)
			52,982

Design	APD Plan (Plat Cert 2/20/15)		
Audit Notes:			
Version:	Phase:	PROTOTYPE	Tie On Depth:
			0.0
Vertical Section:	Depth From (TVD)	+N/-S	+E/-W
	(usft)	(usft)	(usft)
	0.0	0.0	0.0
			Direction
			(°)
			350.27

Plan Sections										
Measured	Inclination	Azimuth	Vertical	+N/-S	+E/-W	Dogleg	Build	Turn	TFO	Target
Depth	(°)	(°)	Depth	(usft)	(usft)	Rate	Rate	Rate	(°)	
(usft)			(usft)			(°/100usft)	(°/100usft)	(°/100usft)		
0.0	0.00	0.00	0.0	0.0	0.0	0.00	0.00	0.00	0.00	
7,335.5	0.00	0.00	7,335.5	0.0	0.0	0.00	0.00	0.00	0.00	
8,085.5	90.00	320.00	7,813.0	365.8	-306.9	12.00	12.00	0.00	320.00	
8,685.5	90.00	320.00	7,813.0	825.4	-692.6	0.00	0.00	0.00	0.00	
9,530.6	90.00	2.26	7,813.0	1,607.1	-959.8	5.00	0.00	5.00	90.00	Fox Creek 508-33H P
12,776.3	90.00	2.26	7,813.0	4,850.3	-832.0	0.00	0.00	0.00	0.00	Fox Creek 508-33H P

EOG Resources, Inc.

Planning Report

Database:	EDM_DENVER	Local Co-ordinate Reference:	Well Fox Creek 508-33H
Company:	Denver Division- Colorado	TVD Reference:	KB @ 5503.0usft (ACT GL+25')
Project:	DJ - Hereford Ranch	MD Reference:	KB @ 5503.0usft (ACT GL+25')
Site:	Fox Creek FC33 NWNW Pad	North Reference:	True
Well:	Fox Creek 508-33H	Survey Calculation Method:	Minimum Curvature
Wellbore:	OH		
Design:	APD Plan (Plat Cert 2/20/15)		

Planned Survey									
Measured Depth (usft)	Inclination (°)	Azimuth (°)	Vertical Depth (usft)	+N/-S (usft)	+E/-W (usft)	Vertical Section (usft)	Dogleg Rate (°/100usft)	Build Rate (°/100usft)	Turn Rate (°/100usft)
0.0	0.00	0.00	0.0	0.0	0.0	0.0	0.00	0.00	0.00
100.0	0.00	0.00	100.0	0.0	0.0	0.0	0.00	0.00	0.00
200.0	0.00	0.00	200.0	0.0	0.0	0.0	0.00	0.00	0.00
300.0	0.00	0.00	300.0	0.0	0.0	0.0	0.00	0.00	0.00
400.0	0.00	0.00	400.0	0.0	0.0	0.0	0.00	0.00	0.00
500.0	0.00	0.00	500.0	0.0	0.0	0.0	0.00	0.00	0.00
600.0	0.00	0.00	600.0	0.0	0.0	0.0	0.00	0.00	0.00
700.0	0.00	0.00	700.0	0.0	0.0	0.0	0.00	0.00	0.00
800.0	0.00	0.00	800.0	0.0	0.0	0.0	0.00	0.00	0.00
900.0	0.00	0.00	900.0	0.0	0.0	0.0	0.00	0.00	0.00
1,000.0	0.00	0.00	1,000.0	0.0	0.0	0.0	0.00	0.00	0.00
1,100.0	0.00	0.00	1,100.0	0.0	0.0	0.0	0.00	0.00	0.00
1,200.0	0.00	0.00	1,200.0	0.0	0.0	0.0	0.00	0.00	0.00
1,300.0	0.00	0.00	1,300.0	0.0	0.0	0.0	0.00	0.00	0.00
1,400.0	0.00	0.00	1,400.0	0.0	0.0	0.0	0.00	0.00	0.00
1,500.0	0.00	0.00	1,500.0	0.0	0.0	0.0	0.00	0.00	0.00
1,553.0	0.00	0.00	1,553.0	0.0	0.0	0.0	0.00	0.00	0.00
9 5/8" Surface									
1,600.0	0.00	0.00	1,600.0	0.0	0.0	0.0	0.00	0.00	0.00
1,700.0	0.00	0.00	1,700.0	0.0	0.0	0.0	0.00	0.00	0.00
1,800.0	0.00	0.00	1,800.0	0.0	0.0	0.0	0.00	0.00	0.00
1,900.0	0.00	0.00	1,900.0	0.0	0.0	0.0	0.00	0.00	0.00
2,000.0	0.00	0.00	2,000.0	0.0	0.0	0.0	0.00	0.00	0.00
2,100.0	0.00	0.00	2,100.0	0.0	0.0	0.0	0.00	0.00	0.00
2,200.0	0.00	0.00	2,200.0	0.0	0.0	0.0	0.00	0.00	0.00
2,300.0	0.00	0.00	2,300.0	0.0	0.0	0.0	0.00	0.00	0.00
2,400.0	0.00	0.00	2,400.0	0.0	0.0	0.0	0.00	0.00	0.00
2,500.0	0.00	0.00	2,500.0	0.0	0.0	0.0	0.00	0.00	0.00
2,600.0	0.00	0.00	2,600.0	0.0	0.0	0.0	0.00	0.00	0.00
2,700.0	0.00	0.00	2,700.0	0.0	0.0	0.0	0.00	0.00	0.00
2,800.0	0.00	0.00	2,800.0	0.0	0.0	0.0	0.00	0.00	0.00
2,900.0	0.00	0.00	2,900.0	0.0	0.0	0.0	0.00	0.00	0.00
3,000.0	0.00	0.00	3,000.0	0.0	0.0	0.0	0.00	0.00	0.00
3,100.0	0.00	0.00	3,100.0	0.0	0.0	0.0	0.00	0.00	0.00
3,200.0	0.00	0.00	3,200.0	0.0	0.0	0.0	0.00	0.00	0.00
3,300.0	0.00	0.00	3,300.0	0.0	0.0	0.0	0.00	0.00	0.00
3,400.0	0.00	0.00	3,400.0	0.0	0.0	0.0	0.00	0.00	0.00
3,500.0	0.00	0.00	3,500.0	0.0	0.0	0.0	0.00	0.00	0.00
3,600.0	0.00	0.00	3,600.0	0.0	0.0	0.0	0.00	0.00	0.00
3,700.0	0.00	0.00	3,700.0	0.0	0.0	0.0	0.00	0.00	0.00
3,800.0	0.00	0.00	3,800.0	0.0	0.0	0.0	0.00	0.00	0.00
3,900.0	0.00	0.00	3,900.0	0.0	0.0	0.0	0.00	0.00	0.00
4,000.0	0.00	0.00	4,000.0	0.0	0.0	0.0	0.00	0.00	0.00
4,100.0	0.00	0.00	4,100.0	0.0	0.0	0.0	0.00	0.00	0.00
4,200.0	0.00	0.00	4,200.0	0.0	0.0	0.0	0.00	0.00	0.00
4,300.0	0.00	0.00	4,300.0	0.0	0.0	0.0	0.00	0.00	0.00
4,400.0	0.00	0.00	4,400.0	0.0	0.0	0.0	0.00	0.00	0.00
4,500.0	0.00	0.00	4,500.0	0.0	0.0	0.0	0.00	0.00	0.00
4,600.0	0.00	0.00	4,600.0	0.0	0.0	0.0	0.00	0.00	0.00
4,700.0	0.00	0.00	4,700.0	0.0	0.0	0.0	0.00	0.00	0.00
4,800.0	0.00	0.00	4,800.0	0.0	0.0	0.0	0.00	0.00	0.00
4,900.0	0.00	0.00	4,900.0	0.0	0.0	0.0	0.00	0.00	0.00
5,000.0	0.00	0.00	5,000.0	0.0	0.0	0.0	0.00	0.00	0.00
5,100.0	0.00	0.00	5,100.0	0.0	0.0	0.0	0.00	0.00	0.00

EOG Resources, Inc.

Planning Report

Database:	EDM_DENVER	Local Co-ordinate Reference:	Well Fox Creek 508-33H
Company:	Denver Division- Colorado	TVD Reference:	KB @ 5503.0usft (ACT GL+25')
Project:	DJ - Hereford Ranch	MD Reference:	KB @ 5503.0usft (ACT GL+25')
Site:	Fox Creek FC33 NWNW Pad	North Reference:	True
Well:	Fox Creek 508-33H	Survey Calculation Method:	Minimum Curvature
Wellbore:	OH		
Design:	APD Plan (Plat Cert 2/20/15)		

Planned Survey									
Measured Depth (usft)	Inclination (°)	Azimuth (°)	Vertical Depth (usft)	+N/-S (usft)	+E/-W (usft)	Vertical Section (usft)	Dogleg Rate (°/100usft)	Build Rate (°/100usft)	Turn Rate (°/100usft)
5,200.0	0.00	0.00	5,200.0	0.0	0.0	0.0	0.00	0.00	0.00
5,300.0	0.00	0.00	5,300.0	0.0	0.0	0.0	0.00	0.00	0.00
5,400.0	0.00	0.00	5,400.0	0.0	0.0	0.0	0.00	0.00	0.00
5,500.0	0.00	0.00	5,500.0	0.0	0.0	0.0	0.00	0.00	0.00
5,600.0	0.00	0.00	5,600.0	0.0	0.0	0.0	0.00	0.00	0.00
5,700.0	0.00	0.00	5,700.0	0.0	0.0	0.0	0.00	0.00	0.00
5,800.0	0.00	0.00	5,800.0	0.0	0.0	0.0	0.00	0.00	0.00
5,900.0	0.00	0.00	5,900.0	0.0	0.0	0.0	0.00	0.00	0.00
6,000.0	0.00	0.00	6,000.0	0.0	0.0	0.0	0.00	0.00	0.00
6,100.0	0.00	0.00	6,100.0	0.0	0.0	0.0	0.00	0.00	0.00
6,200.0	0.00	0.00	6,200.0	0.0	0.0	0.0	0.00	0.00	0.00
6,300.0	0.00	0.00	6,300.0	0.0	0.0	0.0	0.00	0.00	0.00
6,400.0	0.00	0.00	6,400.0	0.0	0.0	0.0	0.00	0.00	0.00
6,500.0	0.00	0.00	6,500.0	0.0	0.0	0.0	0.00	0.00	0.00
6,600.0	0.00	0.00	6,600.0	0.0	0.0	0.0	0.00	0.00	0.00
6,700.0	0.00	0.00	6,700.0	0.0	0.0	0.0	0.00	0.00	0.00
6,800.0	0.00	0.00	6,800.0	0.0	0.0	0.0	0.00	0.00	0.00
6,900.0	0.00	0.00	6,900.0	0.0	0.0	0.0	0.00	0.00	0.00
7,000.0	0.00	0.00	7,000.0	0.0	0.0	0.0	0.00	0.00	0.00
7,100.0	0.00	0.00	7,100.0	0.0	0.0	0.0	0.00	0.00	0.00
7,200.0	0.00	0.00	7,200.0	0.0	0.0	0.0	0.00	0.00	0.00
7,300.0	0.00	0.00	7,300.0	0.0	0.0	0.0	0.00	0.00	0.00
7,335.5	0.00	0.00	7,335.5	0.0	0.0	0.0	0.00	0.00	0.00
7,400.0	7.74	320.00	7,399.8	3.3	-2.8	3.8	12.00	12.00	0.00
7,500.0	19.74	320.00	7,496.8	21.5	-18.0	24.2	12.00	12.00	0.00
7,600.0	31.74	320.00	7,586.7	54.7	-45.9	61.7	12.00	12.00	0.00
7,700.0	43.74	320.00	7,665.6	101.5	-85.2	114.4	12.00	12.00	0.00
7,800.0	55.74	320.00	7,730.1	159.9	-134.1	180.2	12.00	12.00	0.00
7,900.0	67.74	320.00	7,777.4	227.2	-190.6	256.2	12.00	12.00	0.00
8,000.0	79.74	320.00	7,805.3	300.6	-252.2	338.9	12.00	12.00	0.00
8,038.0	84.30	320.00	7,810.6	329.4	-276.4	371.4	12.00	12.00	0.00
7" Intermediate (Opt 2)									
8,085.5	90.00	320.00	7,813.0	365.8	-306.9	412.4	12.00	12.00	0.00
8,100.0	90.00	320.00	7,813.0	376.9	-316.2	424.9	0.00	0.00	0.00
8,200.0	90.00	320.00	7,813.0	453.5	-380.5	511.3	0.00	0.00	0.00
8,300.0	90.00	320.00	7,813.0	530.1	-444.8	597.6	0.00	0.00	0.00
8,400.0	90.00	320.00	7,813.0	606.7	-509.1	684.0	0.00	0.00	0.00
8,500.0	90.00	320.00	7,813.0	683.3	-573.3	770.4	0.00	0.00	0.00
8,600.0	90.00	320.00	7,813.0	759.9	-637.6	856.8	0.00	0.00	0.00
8,685.5	90.00	320.00	7,813.0	825.4	-692.6	930.6	0.00	0.00	0.00
8,700.0	90.00	320.73	7,813.0	836.6	-701.8	943.2	5.00	0.00	5.00
8,800.0	90.00	325.73	7,813.0	916.6	-761.7	1,032.2	5.00	0.00	5.00
8,900.0	90.00	330.73	7,813.0	1,001.6	-814.3	1,124.9	5.00	0.00	5.00
9,000.0	90.00	335.73	7,813.0	1,090.9	-859.4	1,220.4	5.00	0.00	5.00
9,100.0	90.00	340.73	7,813.0	1,183.7	-896.4	1,318.2	5.00	0.00	5.00
9,200.0	90.00	345.73	7,813.0	1,279.4	-925.3	1,417.4	5.00	0.00	5.00
9,300.0	90.00	350.73	7,813.0	1,377.3	-945.7	1,517.3	5.00	0.00	5.00
9,400.0	90.00	355.73	7,813.0	1,476.5	-957.5	1,617.2	5.00	0.00	5.00
9,500.0	90.00	0.73	7,813.0	1,576.5	-960.6	1,716.2	5.00	0.00	5.00
9,530.6	90.00	2.26	7,813.0	1,607.1	-959.8	1,746.2	5.00	0.00	5.00
9,600.0	90.00	2.26	7,813.0	1,676.4	-957.1	1,814.1	0.00	0.00	0.00
9,700.0	90.00	2.26	7,813.0	1,776.3	-953.1	1,911.9	0.00	0.00	0.00
9,800.0	90.00	2.26	7,813.0	1,876.2	-949.2	2,009.7	0.00	0.00	0.00

EOG Resources, Inc.

Planning Report

Database:	EDM_DENVER	Local Co-ordinate Reference:	Well Fox Creek 508-33H
Company:	Denver Division- Colorado	TVD Reference:	KB @ 5503.0usft (ACT GL+25')
Project:	DJ - Hereford Ranch	MD Reference:	KB @ 5503.0usft (ACT GL+25')
Site:	Fox Creek FC33 NWNW Pad	North Reference:	True
Well:	Fox Creek 508-33H	Survey Calculation Method:	Minimum Curvature
Wellbore:	OH		
Design:	APD Plan (Plat Cert 2/20/15)		

Planned Survey									
Measured Depth (usft)	Inclination (°)	Azimuth (°)	Vertical Depth (usft)	+N/-S (usft)	+E/-W (usft)	Vertical Section (usft)	Dogleg Rate (°/100usft)	Build Rate (°/100usft)	Turn Rate (°/100usft)
9,900.0	90.00	2.26	7,813.0	1,976.2	-945.2	2,107.5	0.00	0.00	0.00
10,000.0	90.00	2.26	7,813.0	2,076.1	-941.3	2,205.4	0.00	0.00	0.00
10,100.0	90.00	2.26	7,813.0	2,176.0	-937.4	2,303.2	0.00	0.00	0.00
10,200.0	90.00	2.26	7,813.0	2,275.9	-933.4	2,401.0	0.00	0.00	0.00
10,300.0	90.00	2.26	7,813.0	2,375.9	-929.5	2,498.8	0.00	0.00	0.00
10,400.0	90.00	2.26	7,813.0	2,475.8	-925.6	2,596.6	0.00	0.00	0.00
10,500.0	90.00	2.26	7,813.0	2,575.7	-921.6	2,694.4	0.00	0.00	0.00
10,600.0	90.00	2.26	7,813.0	2,675.6	-917.7	2,792.3	0.00	0.00	0.00
10,700.0	90.00	2.26	7,813.0	2,775.5	-913.8	2,890.1	0.00	0.00	0.00
10,800.0	90.00	2.26	7,813.0	2,875.5	-909.8	2,987.9	0.00	0.00	0.00
10,900.0	90.00	2.26	7,813.0	2,975.4	-905.9	3,085.7	0.00	0.00	0.00
11,000.0	90.00	2.26	7,813.0	3,075.3	-901.9	3,183.5	0.00	0.00	0.00
11,100.0	90.00	2.26	7,813.0	3,175.2	-898.0	3,281.4	0.00	0.00	0.00
11,200.0	90.00	2.26	7,813.0	3,275.2	-894.1	3,379.2	0.00	0.00	0.00
11,300.0	90.00	2.26	7,813.0	3,375.1	-890.1	3,477.0	0.00	0.00	0.00
11,400.0	90.00	2.26	7,813.0	3,475.0	-886.2	3,574.8	0.00	0.00	0.00
11,500.0	90.00	2.26	7,813.0	3,574.9	-882.3	3,672.6	0.00	0.00	0.00
11,600.0	90.00	2.26	7,813.0	3,674.9	-878.3	3,770.4	0.00	0.00	0.00
11,700.0	90.00	2.26	7,813.0	3,774.8	-874.4	3,868.3	0.00	0.00	0.00
11,800.0	90.00	2.26	7,813.0	3,874.7	-870.4	3,966.1	0.00	0.00	0.00
11,900.0	90.00	2.26	7,813.0	3,974.6	-866.5	4,063.9	0.00	0.00	0.00
12,000.0	90.00	2.26	7,813.0	4,074.5	-862.6	4,161.7	0.00	0.00	0.00
12,100.0	90.00	2.26	7,813.0	4,174.5	-858.6	4,259.5	0.00	0.00	0.00
12,200.0	90.00	2.26	7,813.0	4,274.4	-854.7	4,357.4	0.00	0.00	0.00
12,300.0	90.00	2.26	7,813.0	4,374.3	-850.8	4,455.2	0.00	0.00	0.00
12,400.0	90.00	2.26	7,813.0	4,474.2	-846.8	4,553.0	0.00	0.00	0.00
12,500.0	90.00	2.26	7,813.0	4,574.2	-842.9	4,650.8	0.00	0.00	0.00
12,600.0	90.00	2.26	7,813.0	4,674.1	-839.0	4,748.6	0.00	0.00	0.00
12,700.0	90.00	2.26	7,813.0	4,774.0	-835.0	4,846.4	0.00	0.00	0.00
12,776.0	90.00	2.26	7,813.0	4,849.9	-832.0	4,920.8	0.00	0.00	0.00
5 1/2" Prod (Opt 1) - 4 1/2" Liner (Opt 2)									
12,776.3	90.00	2.26	7,813.0	4,850.3	-832.0	4,921.1	0.00	0.00	0.00

Design Targets									
Target Name	Dip Angle (°)	Dip Dir. (°)	TVD (usft)	+N/-S (usft)	+E/-W (usft)	Northing (usft)	Easting (usft)	Latitude	Longitude
- hit/miss target									
- Shape									
Fox Creek 508-33H PBI	0.00	0.00	7,813.0	4,850.3	-832.0	603,679.56	2,290,168.19	40° 59' 8.758 N	104° 26' 56.632 W
- plan hits target center									
- Point									

Casing Points					
Measured Depth (usft)	Vertical Depth (usft)	Name	Casing Diameter (")	Hole Diameter (")	
1,553.0	1,553.0	9 5/8" Surface	9-5/8	13-1/2	
8,038.0	7,810.6	7" Intermediate (Opt 2)	7	8-3/4	
12,776.0	7,813.0	5 1/2" Prod (Opt 1)	5-1/2	7-7/8	
12,776.0	7,813.0	4 1/2" Liner (Opt 2)	4-1/2	6-1/8	

EOG Resources, Inc.

Planning Report

Database:	EDM_DENVER	Local Co-ordinate Reference:	Well Fox Creek 508-33H
Company:	Denver Division- Colorado	TVD Reference:	KB @ 5503.0usft (ACT GL+25')
Project:	DJ - Hereford Ranch	MD Reference:	KB @ 5503.0usft (ACT GL+25')
Site:	Fox Creek FC33 NWNW Pad	North Reference:	True
Well:	Fox Creek 508-33H	Survey Calculation Method:	Minimum Curvature
Wellbore:	OH		
Design:	APD Plan (Plat Cert 2/20/15)		