

# **BONANZA CREEK ENERGY INC.**

**WELD COUNTY, COLORADO (NAD 83)**

**SW SW SEC. 21 T5N R62W 6th P.M.**

**ANTELOPE E-A-21HNB**

**ORIGINAL WELLBORE**

**30 December, 2014**

**Plan: PROPOSAL #1**





Project: WELD COUNTY, COLORADO (NAD 83)  
Site: SW SW SEC. 21 T5N R62W 6th P.M.  
Well: ANTELOPE E-A-21HNB  
Wellbore: ORIGINAL WELLBORE  
Design: PROPOSAL #1

ANNOTATIONS

TVD	MD	Inc	Azi	+N/-S	+E/-W	VSec	Dep	Annotation
600.0	600.0	0.00	0.00	0.0	0.0	0.0	0.0	START NUDGE (2°/100ft BUR)
1185.2	1189.4	11.79	238.74	-31.4	-51.6	-21.8	60.4	EOB TO 11.79° INC
5199.2	5289.8	11.79	238.74	-466.0	-767.7	-324.0	898.1	END OF TANGENT
5784.4	5879.2	0.00	0.00	-497.4	-819.3	-345.7	958.5	EOD TO VERTICAL
5814.4	5909.2	0.00	0.00	-497.4	-819.3	-345.7	958.5	KOP (12°/100ft BUR)
6275.6	6534.2	75.00	0.64	-143.5	-815.3	1.9	1312.4	START OF TANGENT
6301.5	6634.2	75.00	0.64	-46.9	-814.3	96.8	1408.9	END OF TANGENT
6317.7	6759.2	90.00	0.64	76.6	-812.9	218.2	1532.5	7" ICP *NEW* - ANTELOPE E-A-21HNB
6317.7	10975.9	90.00	0.63	4293.0	-766.0	4360.9	5749.2	BHL - ANTELOPE E-A-21HNB

PROPOSED LOCAL COORDINATES:

SHL:507ft FSL & 864ft FWL Sec 21  
7" ICP \*NEW\*: 589ft FSL & 50ft FWL Sec 21  
BHL: 470ft FNL & 50ft FWL Sec 21

WELLBORE TARGET DETAILS (LAT/LONG)

Name	TVD	+N/-S	+E/-W	Latitude	Longitude
KOP - ANTELOPE E-A-21HNB	5814.4	-497.4	-819.3	40.377951	-104.338013
7" ICP *NEW* - ANTELOPE E-A-21HNB	6317.7	76.6	-812.9	40.379526	-104.337990
BHL - ANTELOPE E-A-21HNB	6317.7	4293.0	-766.0	40.391100	-104.337822

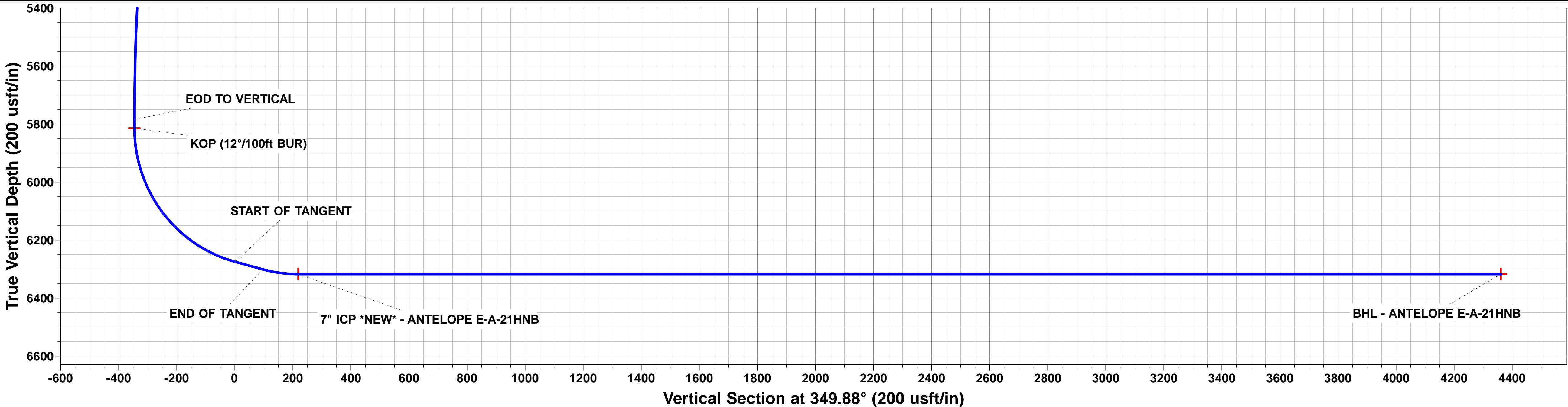
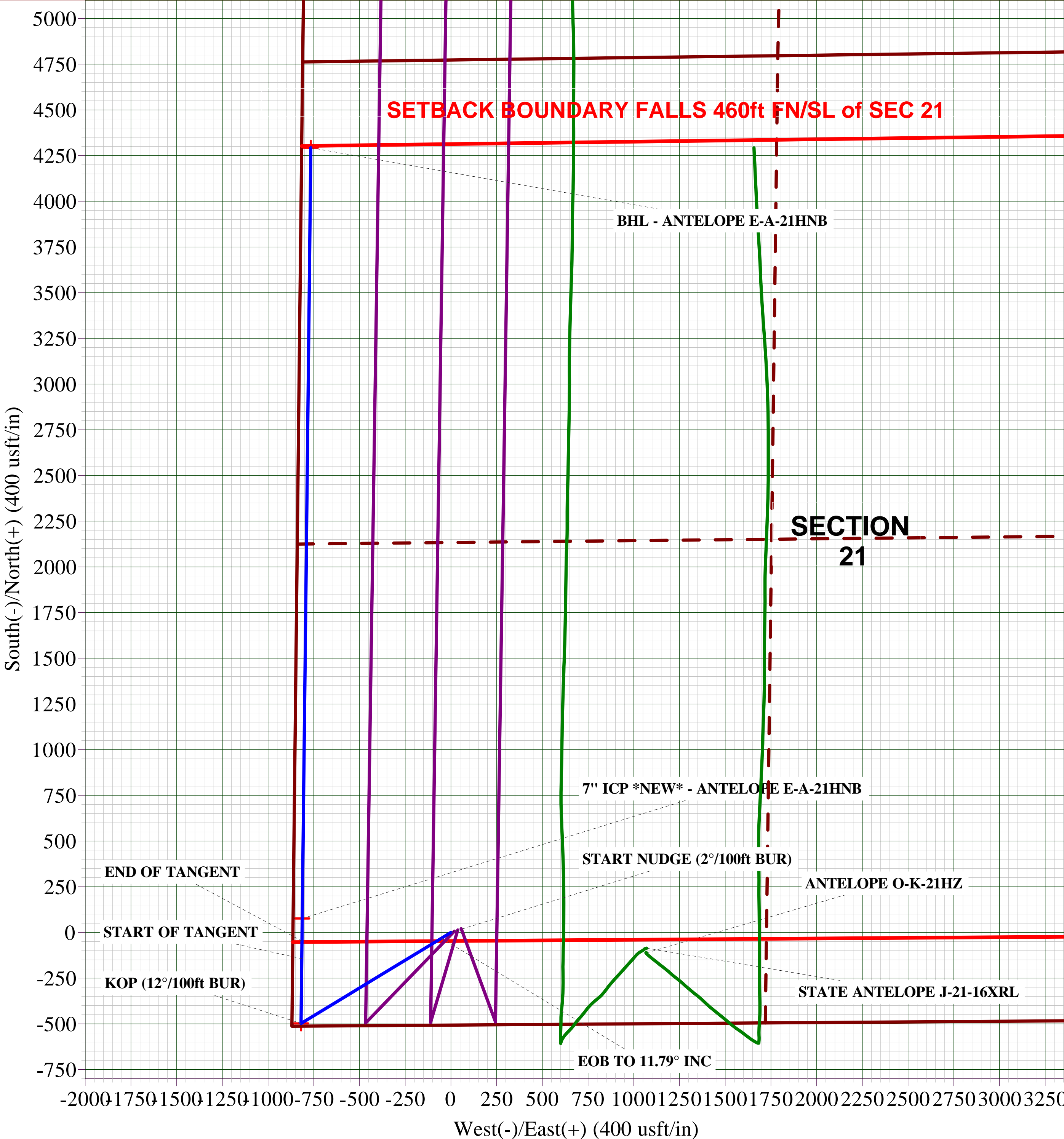
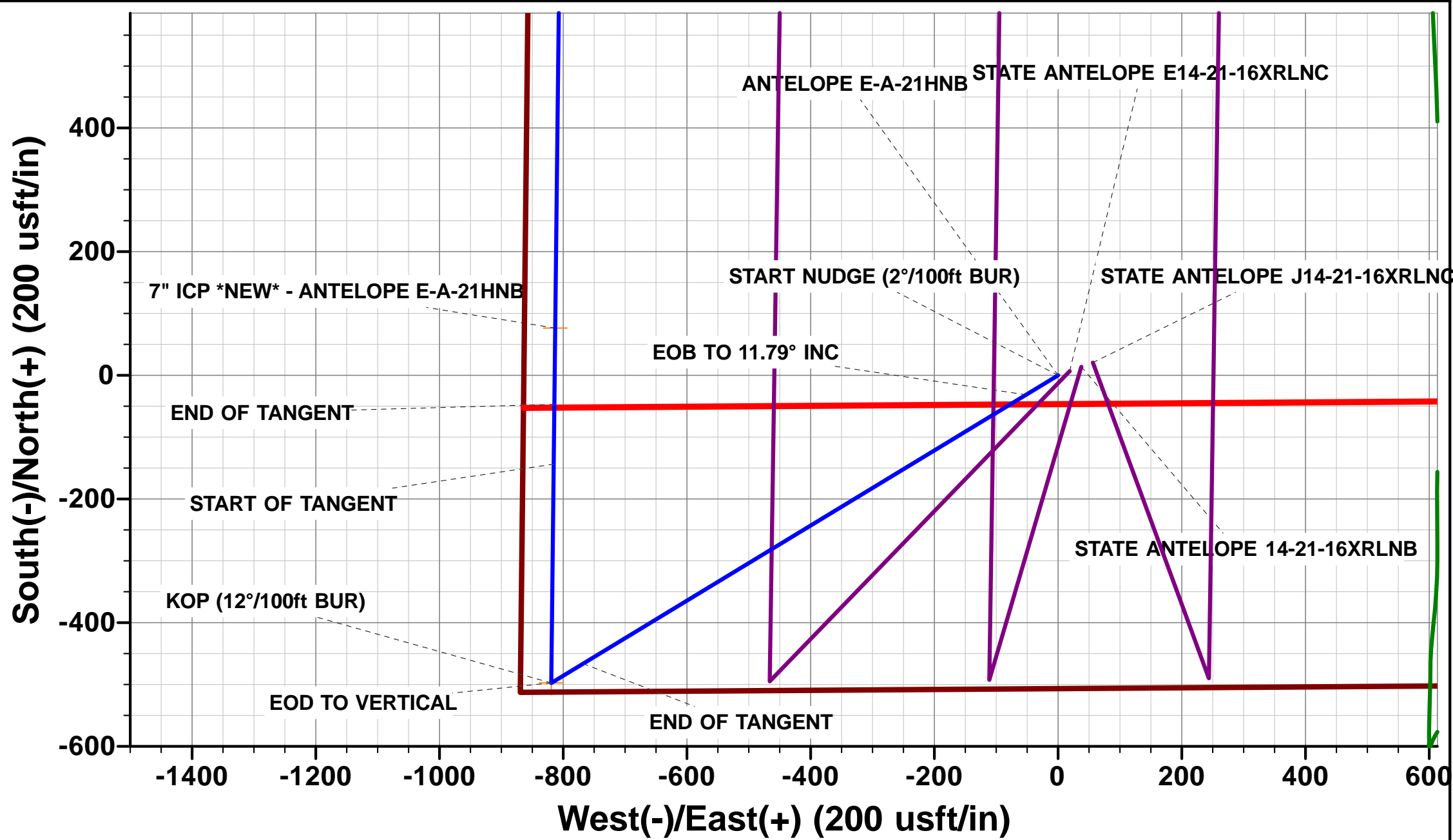
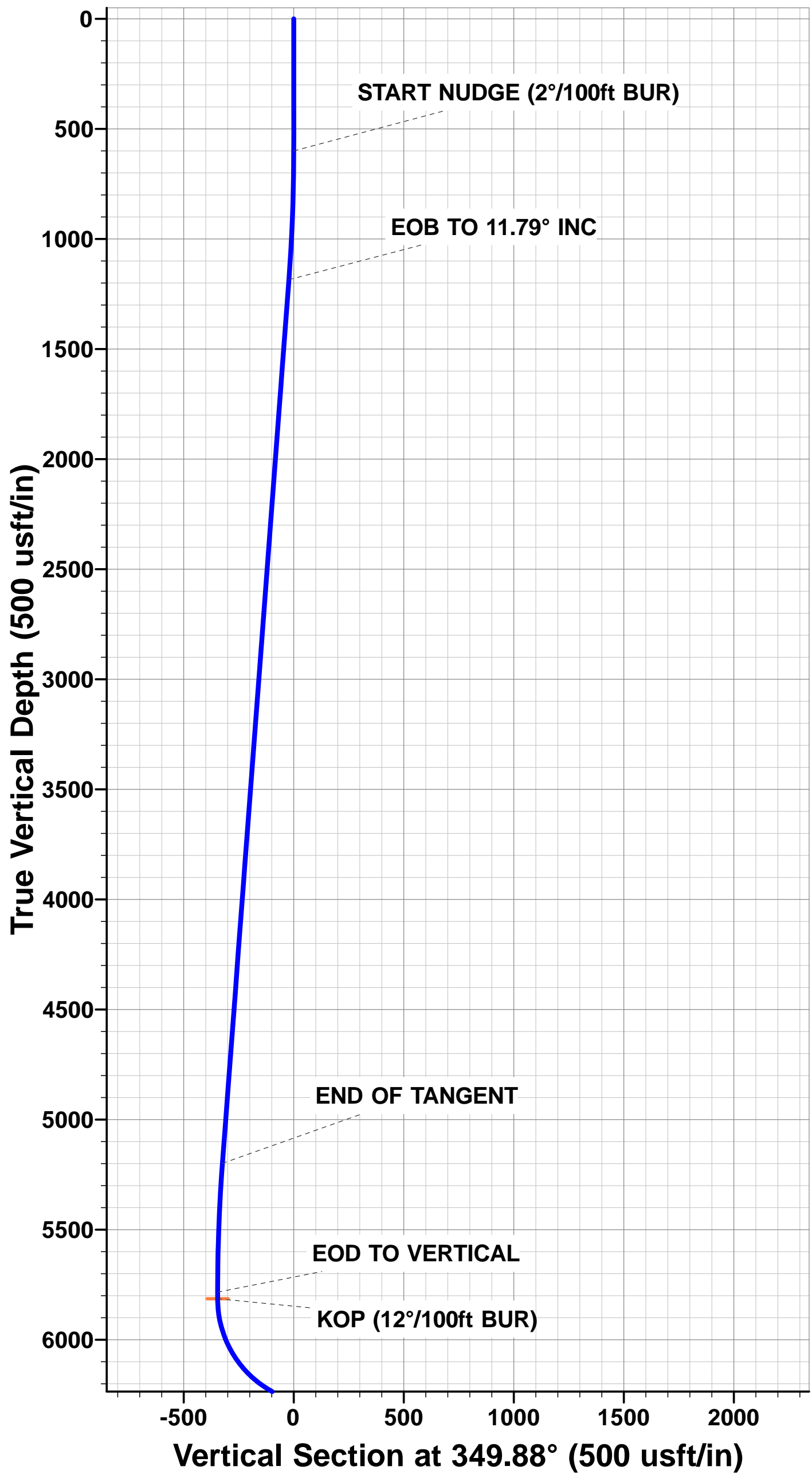

# Planning Report



<b>Database:</b>	EDM 5000.1 Single User Db	<b>Local Co-ordinate Reference:</b>	Well ANTELOPE E-A-21HNB
<b>Company:</b>	BONANZA CREEK ENERGY INC.	<b>TVD Reference:</b>	KB-EST @ 4657.7usft (Original Well Elev)
<b>Project:</b>	WELD COUNTY, COLORADO (NAD 83)	<b>MD Reference:</b>	KB-EST @ 4657.7usft (Original Well Elev)
<b>Site:</b>	SW SW SEC. 21 T5N R62W 6th P.M.	<b>North Reference:</b>	True
<b>Well:</b>	ANTELOPE E-A-21HNB	<b>Survey Calculation Method:</b>	Minimum Curvature
<b>Wellbore:</b>	ORIGINAL WELLBORE		
<b>Design:</b>	PROPOSAL #1		

<b>Project</b>	WELD COUNTY, COLORADO (NAD 83)		
<b>Map System:</b>	US State Plane 1983	<b>System Datum:</b>	Mean Sea Level
<b>Geo Datum:</b>	North American Datum 1983		
<b>Map Zone:</b>	Colorado Northern Zone		Using geodetic scale factor

<b>Site</b>	SW SW SEC. 21 T5N R62W 6th P.M.		
<b>Site Position:</b>		<b>Northing:</b>	1,383,157.04 usft
<b>From:</b>	Lat/Long	<b>Easting:</b>	3,324,534.17 usft
<b>Position Uncertainty:</b>	0.0 usft	<b>Slot Radius:</b>	1.10000ft
		<b>Latitude:</b>	40.379316
		<b>Longitude:</b>	-104.335072
		<b>Grid Convergence:</b>	0.75 °

<b>Well</b>	ANTELOPE E-A-21HNB		
<b>Well Position</b>	<b>+N/-S</b>	0.0 usft	<b>Northing:</b> 1,383,157.04 usft
	<b>+E/-W</b>	0.0 usft	<b>Easting:</b> 3,324,534.17 usft
<b>Position Uncertainty</b>	0.0 usft	<b>Wellhead Elevation:</b>	usft
		<b>Latitude:</b>	40.379316
		<b>Longitude:</b>	-104.335072
		<b>Ground Level:</b>	4,640.7 usft

<b>Wellbore</b>	ORIGINAL WELLBORE				
<b>Magnetics</b>	<b>Model Name</b>	<b>Sample Date</b>	<b>Declination (°)</b>	<b>Dip Angle (°)</b>	<b>Field Strength (nT)</b>
	IGRF2010	30/12/2014	8.15	66.98	52,793

<b>Design</b>	PROPOSAL #1			
<b>Audit Notes:</b>				
<b>Version:</b>	<b>Phase:</b>	PROTOTYPE	<b>Tie On Depth:</b>	0.0
<b>Vertical Section:</b>	<b>Depth From (TVD) (usft)</b>	<b>+N/-S (usft)</b>	<b>+E/-W (usft)</b>	<b>Direction (°)</b>
	6,317.7	0.0	0.0	349.88

<b>Plan Sections</b>											
MD (usft)	Inc (°)	Azi (°)	Vertical Depth	SS (usft)	+N/-S (usft)	+E/-W (usft)	Dogleg Rate (°/100usf)	Build Rate (°/100usf)	Turn Rate (°/100usf)	TFO (°)	Target
0.0	0.00	0.00	0.0	-4,657.7	0.0	0.0	0.00	0.00	0.00	0.00	
600.0	0.00	0.00	600.0	-4,057.7	0.0	0.0	0.00	0.00	0.00	0.00	
1,189.4	11.79	238.74	1,185.2	-3,472.5	-31.4	-51.6	2.00	2.00	0.00	238.74	
5,289.8	11.79	238.74	5,199.2	541.5	-466.0	-767.7	0.00	0.00	0.00	0.00	
5,879.2	0.00	0.00	5,784.4	1,126.7	-497.4	-819.3	2.00	-2.00	0.00	180.00	
5,909.2	0.00	0.00	5,814.4	1,156.7	-497.4	-819.3	0.00	0.00	0.00	0.00	KOP - ANTELOPE
6,534.2	75.00	0.64	6,275.6	1,617.9	-143.5	-815.3	12.00	12.00	0.00	0.64	
6,634.2	75.00	0.64	6,301.5	1,643.8	-46.9	-814.3	0.00	0.00	0.00	0.00	
6,759.2	90.00	0.64	6,317.7	1,660.0	76.6	-812.9	12.00	12.00	0.00	0.00	
10,975.9	90.00	0.63	6,317.7	1,660.0	4,293.0	-766.0	0.00	0.00	0.00	-79.29	BHL - ANTELOPE I

# Planning Report



<b>Database:</b>	EDM 5000.1 Single User Db	<b>Local Co-ordinate Reference:</b>	Well ANTELOPE E-A-21HNB
<b>Company:</b>	BONANZA CREEK ENERGY INC.	<b>TVD Reference:</b>	KB-EST @ 4657.7usft (Original Well Elev)
<b>Project:</b>	WELD COUNTY, COLORADO (NAD 83)	<b>MD Reference:</b>	KB-EST @ 4657.7usft (Original Well Elev)
<b>Site:</b>	SW SW SEC. 21 T5N R62W 6th P.M.	<b>North Reference:</b>	True
<b>Well:</b>	ANTELOPE E-A-21HNB	<b>Survey Calculation Method:</b>	Minimum Curvature
<b>Wellbore:</b>	ORIGINAL WELLBORE		
<b>Design:</b>	PROPOSAL #1		

Planned Survey										
MD (usft)	Inc (°)	Azi (°)	TVD (usft)	SS (usft)	+N/-S (usft)	+E/-W (usft)	Vertical Section (usft)	Dogleg Rate (°/100usft)	Build Rate (°/100usft)	Turn Rate (°/100usft)
0.0	0.00	0.00	0.0	4,657.70	0.0	0.0	0.0	0.00	0.00	0.00
100.0	0.00	0.00	100.0	4,557.70	0.0	0.0	0.0	0.00	0.00	0.00
200.0	0.00	0.00	200.0	4,457.70	0.0	0.0	0.0	0.00	0.00	0.00
300.0	0.00	0.00	300.0	4,357.70	0.0	0.0	0.0	0.00	0.00	0.00
400.0	0.00	0.00	400.0	4,257.70	0.0	0.0	0.0	0.00	0.00	0.00
500.0	0.00	0.00	500.0	4,157.70	0.0	0.0	0.0	0.00	0.00	0.00
START NUDGE (2°/100ft BUR)										
600.0	0.00	0.00	600.0	4,057.70	0.0	0.0	0.0	0.00	0.00	0.00
700.0	2.00	238.74	700.0	3,957.72	-0.9	-1.5	-0.6	2.00	2.00	0.00
800.0	4.00	238.74	799.8	3,857.86	-3.6	-6.0	-2.5	2.00	2.00	0.00
900.0	6.00	238.74	899.5	3,758.25	-8.1	-13.4	-5.7	2.00	2.00	0.00
1,000.0	8.00	238.74	998.7	3,659.00	-14.5	-23.8	-10.1	2.00	2.00	0.00
1,100.0	10.00	238.74	1,097.5	3,560.23	-22.6	-37.2	-15.7	2.00	2.00	0.00
EOB TO 11.79° INC										
1,189.4	11.79	238.74	1,185.2	3,472.47	-31.4	-51.6	-21.8	2.00	2.00	0.00
1,200.0	11.79	238.74	1,195.6	3,462.07	-32.5	-53.5	-22.6	0.00	0.00	0.00
1,300.0	11.79	238.74	1,293.5	3,364.18	-43.1	-71.0	-29.9	0.00	0.00	0.00
1,400.0	11.79	238.74	1,391.4	3,266.29	-53.7	-88.4	-37.3	0.00	0.00	0.00
1,500.0	11.79	238.74	1,489.3	3,168.40	-64.3	-105.9	-44.7	0.00	0.00	0.00
1,600.0	11.79	238.74	1,587.2	3,070.51	-74.9	-123.3	-52.1	0.00	0.00	0.00
1,700.0	11.79	238.74	1,685.1	2,972.62	-85.5	-140.8	-59.4	0.00	0.00	0.00
1,800.0	11.79	238.74	1,783.0	2,874.73	-96.1	-158.3	-66.8	0.00	0.00	0.00
1,900.0	11.79	238.74	1,880.9	2,776.83	-106.7	-175.7	-74.2	0.00	0.00	0.00
2,000.0	11.79	238.74	1,978.8	2,678.94	-117.3	-193.2	-81.5	0.00	0.00	0.00
2,100.0	11.79	238.74	2,076.6	2,581.05	-127.9	-210.7	-88.9	0.00	0.00	0.00
2,200.0	11.79	238.74	2,174.5	2,483.16	-138.5	-228.1	-96.3	0.00	0.00	0.00
2,300.0	11.79	238.74	2,272.4	2,385.27	-149.1	-245.6	-103.6	0.00	0.00	0.00
2,400.0	11.79	238.74	2,370.3	2,287.38	-159.7	-263.0	-111.0	0.00	0.00	0.00
2,500.0	11.79	238.74	2,468.2	2,189.49	-170.3	-280.5	-118.4	0.00	0.00	0.00
2,600.0	11.79	238.74	2,566.1	2,091.60	-180.9	-298.0	-125.7	0.00	0.00	0.00
2,700.0	11.79	238.74	2,664.0	1,993.70	-191.5	-315.4	-133.1	0.00	0.00	0.00
2,800.0	11.79	238.74	2,761.9	1,895.81	-202.1	-332.9	-140.5	0.00	0.00	0.00
2,900.0	11.79	238.74	2,859.8	1,797.92	-212.7	-350.4	-147.8	0.00	0.00	0.00
3,000.0	11.79	238.74	2,957.7	1,700.03	-223.3	-367.8	-155.2	0.00	0.00	0.00
3,100.0	11.79	238.74	3,055.6	1,602.14	-233.9	-385.3	-162.6	0.00	0.00	0.00
3,200.0	11.79	238.74	3,153.5	1,504.25	-244.5	-402.7	-170.0	0.00	0.00	0.00
3,300.0	11.79	238.74	3,251.3	1,406.36	-255.1	-420.2	-177.3	0.00	0.00	0.00
3,400.0	11.79	238.74	3,349.2	1,308.47	-265.7	-437.7	-184.7	0.00	0.00	0.00
3,500.0	11.79	238.74	3,447.1	1,210.58	-276.3	-455.1	-192.1	0.00	0.00	0.00
3,600.0	11.79	238.74	3,545.0	1,112.68	-286.9	-472.6	-199.4	0.00	0.00	0.00
3,700.0	11.79	238.74	3,642.9	1,014.79	-297.5	-490.0	-206.8	0.00	0.00	0.00
3,800.0	11.79	238.74	3,740.8	916.90	-308.1	-507.5	-214.2	0.00	0.00	0.00
3,900.0	11.79	238.74	3,838.7	819.01	-318.7	-525.0	-221.5	0.00	0.00	0.00
4,000.0	11.79	238.74	3,936.6	721.12	-329.3	-542.4	-228.9	0.00	0.00	0.00
4,100.0	11.79	238.74	4,034.5	623.23	-339.9	-559.9	-236.3	0.00	0.00	0.00
4,200.0	11.79	238.74	4,132.4	525.34	-350.5	-577.4	-243.6	0.00	0.00	0.00
4,300.0	11.79	238.74	4,230.3	427.45	-361.1	-594.8	-251.0	0.00	0.00	0.00
4,400.0	11.79	238.74	4,328.1	329.55	-371.7	-612.3	-258.4	0.00	0.00	0.00
4,500.0	11.79	238.74	4,426.0	231.66	-382.3	-629.7	-265.8	0.00	0.00	0.00
4,600.0	11.79	238.74	4,523.9	133.77	-392.9	-647.2	-273.1	0.00	0.00	0.00
4,700.0	11.79	238.74	4,621.8	35.88	-403.5	-664.7	-280.5	0.00	0.00	0.00
4,800.0	11.79	238.74	4,719.7	-62.01	-414.1	-682.1	-287.9	0.00	0.00	0.00
4,900.0	11.79	238.74	4,817.6	-159.90	-424.7	-699.6	-295.2	0.00	0.00	0.00
5,000.0	11.79	238.74	4,915.5	-257.79	-435.3	-717.1	-302.6	0.00	0.00	0.00

# Planning Report



<b>Database:</b>	EDM 5000.1 Single User Db	<b>Local Co-ordinate Reference:</b>	Well ANTELOPE E-A-21HNB
<b>Company:</b>	BONANZA CREEK ENERGY INC.	<b>TVD Reference:</b>	KB-EST @ 4657.7usft (Original Well Elev)
<b>Project:</b>	WELD COUNTY, COLORADO (NAD 83)	<b>MD Reference:</b>	KB-EST @ 4657.7usft (Original Well Elev)
<b>Site:</b>	SW SW SEC. 21 T5N R62W 6th P.M.	<b>North Reference:</b>	True
<b>Well:</b>	ANTELOPE E-A-21HNB	<b>Survey Calculation Method:</b>	Minimum Curvature
<b>Wellbore:</b>	ORIGINAL WELLBORE		
<b>Design:</b>	PROPOSAL #1		

## Planned Survey

MD (usft)	Inc (°)	Azi (°)	TVD (usft)	SS (usft)	+N/-S (usft)	+E/-W (usft)	Vertical Section (usft)	Dogleg Rate (°/100usft)	Build Rate (°/100usft)	Turn Rate (°/100usft)
5,100.0	11.79	238.74	5,013.4	-355.68	-445.9	-734.5	-310.0	0.00	0.00	0.00
5,200.0	11.79	238.74	5,111.3	-453.58	-456.5	-752.0	-317.3	0.00	0.00	0.00
<b>END OF TANGENT</b>										
<b>5,289.8</b>	<b>11.79</b>	<b>238.74</b>	<b>5,199.2</b>	<b>-541.47</b>	<b>-466.0</b>	<b>-767.7</b>	<b>-324.0</b>	<b>0.00</b>	<b>0.00</b>	<b>0.00</b>
5,300.0	11.58	238.74	5,209.2	-551.47	-467.1	-769.4	-324.7	2.00	-2.00	0.00
5,400.0	9.58	238.74	5,307.5	-649.76	-476.7	-785.1	-331.3	2.00	-2.00	0.00
5,500.0	7.58	238.74	5,406.3	-748.64	-484.4	-797.9	-336.7	2.00	-2.00	0.00
5,600.0	5.58	238.74	5,505.7	-847.97	-490.3	-807.7	-340.8	2.00	-2.00	0.00
5,700.0	3.58	238.74	5,605.3	-947.65	-494.5	-814.5	-343.7	2.00	-2.00	0.00
5,800.0	1.58	238.74	5,705.2	-1,047.54	-496.8	-818.4	-345.4	2.00	-2.00	0.00
<b>EOD TO VERTICAL</b>										
<b>5,879.2</b>	<b>0.00</b>	<b>0.00</b>	<b>5,784.4</b>	<b>-1,126.70</b>	<b>-497.4</b>	<b>-819.3</b>	<b>-345.7</b>	<b>2.00</b>	<b>-2.00</b>	<b>0.00</b>
5,900.0	0.00	0.00	5,805.2	-1,147.53	-497.4	-819.3	-345.7	0.00	0.00	0.00
<b>KOP (12°/100ft BUR)</b>										
<b>5,909.2</b>	<b>0.00</b>	<b>0.00</b>	<b>5,814.4</b>	<b>-1,156.70</b>	<b>-497.4</b>	<b>-819.3</b>	<b>-345.7</b>	<b>0.00</b>	<b>0.00</b>	<b>0.00</b>
6,000.0	10.90	0.64	5,904.7	-1,246.99	-488.8	-819.2	-337.3	12.00	12.00	0.00
6,100.0	22.90	0.64	6,000.2	-1,342.49	-459.8	-818.9	-308.8	12.00	12.00	0.00
6,200.0	34.90	0.64	6,087.6	-1,429.88	-411.5	-818.3	-261.4	12.00	12.00	0.00
6,300.0	46.90	0.64	6,163.0	-1,505.33	-346.2	-817.6	-197.2	12.00	12.00	0.00
6,400.0	58.90	0.64	6,223.2	-1,565.54	-266.6	-816.7	-119.0	12.00	12.00	0.00
6,500.0	70.90	0.64	6,265.6	-1,607.88	-176.2	-815.7	-30.2	12.00	12.00	0.00
<b>START OF TANGENT</b>										
<b>6,534.2</b>	<b>75.00</b>	<b>0.64</b>	<b>6,275.6</b>	<b>-1,617.90</b>	<b>-143.5</b>	<b>-815.3</b>	<b>1.9</b>	<b>12.00</b>	<b>12.00</b>	<b>0.00</b>
6,600.0	75.00	0.64	6,292.6	-1,634.93	-79.9	-814.6	64.4	0.00	0.00	0.00
<b>END OF TANGENT</b>										
<b>6,634.2</b>	<b>75.00</b>	<b>0.64</b>	<b>6,301.5</b>	<b>-1,643.78</b>	<b>-46.9</b>	<b>-814.3</b>	<b>96.8</b>	<b>0.00</b>	<b>0.00</b>	<b>0.00</b>
6,700.0	82.90	0.64	6,314.1	-1,656.39	17.6	-813.5	160.2	12.00	12.00	0.00
<b>7" ICP *NEW* - ANTELOPE E-A-21HNB</b>										
<b>6,759.2</b>	<b>90.00</b>	<b>0.64</b>	<b>6,317.7</b>	<b>-1,660.05</b>	<b>76.6</b>	<b>-812.9</b>	<b>218.2</b>	<b>12.00</b>	<b>12.00</b>	<b>0.00</b>
6,800.0	90.00	0.64	6,317.7	-1,660.05	117.5	-812.4	258.3	0.00	0.00	0.00
6,900.0	90.00	0.64	6,317.7	-1,660.05	217.4	-811.3	356.6	0.00	0.00	0.00
7,000.0	90.00	0.64	6,317.7	-1,660.05	317.4	-810.2	454.8	0.00	0.00	0.00
7,100.0	90.00	0.64	6,317.7	-1,660.05	417.4	-809.1	553.1	0.00	0.00	0.00
7,200.0	90.00	0.64	6,317.7	-1,660.05	517.4	-808.0	651.3	0.00	0.00	0.00
7,300.0	90.00	0.64	6,317.7	-1,660.05	617.4	-806.9	749.6	0.00	0.00	0.00
7,400.0	90.00	0.64	6,317.7	-1,660.05	717.4	-805.7	847.8	0.00	0.00	0.00
7,500.0	90.00	0.64	6,317.7	-1,660.05	817.4	-804.6	946.0	0.00	0.00	0.00
7,600.0	90.00	0.64	6,317.7	-1,660.04	917.4	-803.5	1,044.3	0.00	0.00	0.00
7,700.0	90.00	0.64	6,317.7	-1,660.04	1,017.4	-802.4	1,142.5	0.00	0.00	0.00
7,800.0	90.00	0.64	6,317.7	-1,660.04	1,117.4	-801.3	1,240.8	0.00	0.00	0.00
7,900.0	90.00	0.64	6,317.7	-1,660.04	1,217.4	-800.2	1,339.0	0.00	0.00	0.00
8,000.0	90.00	0.64	6,317.7	-1,660.04	1,317.4	-799.0	1,437.3	0.00	0.00	0.00
8,100.0	90.00	0.64	6,317.7	-1,660.04	1,417.4	-797.9	1,535.5	0.00	0.00	0.00
8,200.0	90.00	0.64	6,317.7	-1,660.04	1,517.4	-796.8	1,633.7	0.00	0.00	0.00
8,300.0	90.00	0.64	6,317.7	-1,660.04	1,617.4	-795.7	1,732.0	0.00	0.00	0.00
8,400.0	90.00	0.64	6,317.7	-1,660.04	1,717.4	-794.6	1,830.2	0.00	0.00	0.00
8,500.0	90.00	0.64	6,317.7	-1,660.04	1,817.3	-793.5	1,928.5	0.00	0.00	0.00
8,600.0	90.00	0.64	6,317.7	-1,660.04	1,917.3	-792.4	2,026.7	0.00	0.00	0.00
8,700.0	90.00	0.64	6,317.7	-1,660.04	2,017.3	-791.3	2,125.0	0.00	0.00	0.00
8,800.0	90.00	0.64	6,317.7	-1,660.04	2,117.3	-790.1	2,223.2	0.00	0.00	0.00
8,900.0	90.00	0.64	6,317.7	-1,660.03	2,217.3	-789.0	2,321.4	0.00	0.00	0.00
9,000.0	90.00	0.64	6,317.7	-1,660.03	2,317.3	-787.9	2,419.7	0.00	0.00	0.00
9,100.0	90.00	0.64	6,317.7	-1,660.03	2,417.3	-786.8	2,517.9	0.00	0.00	0.00



# Planning Report



<b>Database:</b>	EDM 5000.1 Single User Db	<b>Local Co-ordinate Reference:</b>	Well ANTELOPE E-A-21HNB
<b>Company:</b>	BONANZA CREEK ENERGY INC.	<b>TVD Reference:</b>	KB-EST @ 4657.7usft (Original Well Elev)
<b>Project:</b>	WELD COUNTY, COLORADO (NAD 83)	<b>MD Reference:</b>	KB-EST @ 4657.7usft (Original Well Elev)
<b>Site:</b>	SW SW SEC. 21 T5N R62W 6th P.M.	<b>North Reference:</b>	True
<b>Well:</b>	ANTELOPE E-A-21HNB	<b>Survey Calculation Method:</b>	Minimum Curvature
<b>Wellbore:</b>	ORIGINAL WELLBORE		
<b>Design:</b>	PROPOSAL #1		

Planned Survey										
MD (usft)	Inc (°)	Azi (°)	TVD (usft)	SS (usft)	+N/-S (usft)	+E/-W (usft)	Vertical Section (usft)	Dogleg Rate (°/100usft)	Build Rate (°/100usft)	Turn Rate (°/100usft)
9,200.0	90.00	0.64	6,317.7	-1,660.03	2,517.3	-785.7	2,616.2	0.00	0.00	0.00
9,300.0	90.00	0.64	6,317.7	-1,660.03	2,617.3	-784.6	2,714.4	0.00	0.00	0.00
9,400.0	90.00	0.64	6,317.7	-1,660.03	2,717.3	-783.5	2,812.7	0.00	0.00	0.00
9,500.0	90.00	0.64	6,317.7	-1,660.03	2,817.3	-782.4	2,910.9	0.00	0.00	0.00
9,600.0	90.00	0.64	6,317.7	-1,660.03	2,917.3	-781.3	3,009.2	0.00	0.00	0.00
9,700.0	90.00	0.64	6,317.7	-1,660.02	3,017.3	-780.2	3,107.4	0.00	0.00	0.00
9,800.0	90.00	0.64	6,317.7	-1,660.02	3,117.3	-779.1	3,205.6	0.00	0.00	0.00
9,900.0	90.00	0.63	6,317.7	-1,660.02	3,217.3	-777.9	3,303.9	0.00	0.00	0.00
10,000.0	90.00	0.63	6,317.7	-1,660.02	3,317.3	-776.8	3,402.1	0.00	0.00	0.00
10,100.0	90.00	0.63	6,317.7	-1,660.02	3,417.2	-775.7	3,500.4	0.00	0.00	0.00
10,200.0	90.00	0.63	6,317.7	-1,660.02	3,517.2	-774.6	3,598.6	0.00	0.00	0.00
10,300.0	90.00	0.63	6,317.7	-1,660.01	3,617.2	-773.5	3,696.9	0.00	0.00	0.00
10,400.0	90.00	0.63	6,317.7	-1,660.01	3,717.2	-772.4	3,795.1	0.00	0.00	0.00
10,500.0	90.00	0.63	6,317.7	-1,660.01	3,817.2	-771.3	3,893.4	0.00	0.00	0.00
10,600.0	90.00	0.63	6,317.7	-1,660.01	3,917.2	-770.2	3,991.6	0.00	0.00	0.00
10,700.0	90.00	0.63	6,317.7	-1,660.01	4,017.2	-769.1	4,089.8	0.00	0.00	0.00
10,800.0	90.00	0.63	6,317.7	-1,660.00	4,117.2	-768.0	4,188.1	0.00	0.00	0.00
10,900.0	90.00	0.63	6,317.7	-1,660.00	4,217.2	-766.9	4,286.3	0.00	0.00	0.00
<b>BHL - ANTELOPE E-A-21HNB</b>										
<b>10,975.9</b>	<b>90.00</b>	<b>0.63</b>	<b>6,317.7</b>	<b>-1,660.00</b>	<b>4,293.0</b>	<b>-766.0</b>	<b>4,360.9</b>	<b>0.00</b>	<b>0.00</b>	<b>0.00</b>

Plan Annotations				
MD (usft)	TVD (usft)	Local Coordinates		Comment
		+N/-S (usft)	+E/-W (usft)	
600.0	600.0	0.0	0.0	START NUDGE (2°/100ft BUR)
1,189.4	1,185.2	-31.4	-51.6	EOB TO 11.79° INC
5,289.8	5,199.2	-466.0	-767.7	END OF TANGENT
5,879.2	5,784.4	-497.4	-819.3	EOD TO VERTICAL
5,909.2	5,814.4	-497.4	-819.3	KOP (12°/100ft BUR)
6,534.2	6,275.6	-143.5	-815.3	START OF TANGENT
6,634.2	6,301.5	-46.9	-814.3	END OF TANGENT
6,759.2	6,317.7	76.6	-812.9	7" ICP *NEW* - ANTELOPE E-A-21HNB
10,975.9	6,317.7	4,293.0	-766.0	BHL - ANTELOPE E-A-21HNB