

\\ANADARKO\2014\2014_52_RESOLUTION_PROSPECT_WELLS_CO\PLATS\RESOLUTION 12-63-21-28CH.dwg, 1/14/2015 3:01:00 PM, ben

T12N, R63W

SW. COR.
SEC. 21, T12N, R63W
FOUND ALUM. CAP
L.S. NO. 17492

MATCH LINE
SEE SHEET 1

SE. COR.
SEC. 21, T12N, R63W
FOUND ALUM. CAP
L.S. NO. 17492

S 88°44'13" W 5184.68' (M)

SURFACE LOCATION
GROUND ELEVATION= 5503.2'
NAD 83
LATITUDE= 41.001015°
LONGITUDE= -104.440322°

BOTTOM HOLE LOCATION
NAD 83
LATITUDE= 40.974814°
LONGITUDE= -104.438175°

LATITUDE= 40°58'29.331"
LONGITUDE= -104°26'17.431"

S 04°14'18" E 9565' GRID
S 03°33'13" E TRUE
S 11°53'18" E MAGNETIC

28

S 89°09'14" W
2599.30' (C)

S 89°09'14" W
2586.20' (C)

SURFACE LOCATION
NAD 27
LATITUDE= 41.001032°
LONGITUDE= -104.439808°

BOTTOM HOLE LOCATION
NAD 27
LATITUDE= 40.974831°
LONGITUDE= -104.437662°

LATITUDE= 40°58'29.393"
LONGITUDE= -104°26'15.583"

E. 1/4 COR.
SEC. 28, T12N, R63W
FOUND STONE

SE. COR.
SEC. 28, T12N, R63W
FOUND ALUM. CAP
L.S. NO. 36073

S 89°39'17" W 5212.78' (M)

NOTES:

- ▲ INDICATES FOUND SECTION CORNER
- INDICATES CALCULATED CORNER
- ◆ INDICATES CALCULATED STATE LINE MONUMENT
- ELEVATION BASED ON NAVD88 (GEOID09)
- BASIS OF BEARING DERIVED FROM COLORADO COORDINATE SYSTEM 1983 NORTH ZONE UNLESS OTHERWISE NOTED.
- ALL MEASURED DISTANCES ARE GRID.
- COMBINED SCALE FACTOR: .99978352
- OPERATOR: ROB WILSON / PDOP = 1.4
- SEE ADDENDUM TO WELL LOCATION CERTIFICATE FOR EXISTING IMPROVEMENTS WITHIN 500' OF THE WELL PAD.
- WELL FOOTAGES ARE MEASURED AT RIGHT ANGLES TO THE STATE LINE AND SECTION LINES.
- THE BOTTOM OF HOLE BEARS S04°14'18"E 9565' FROM THE SURFACE LOCATION.

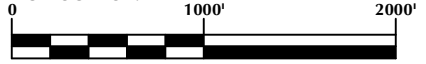

CERTIFICATE OF SURVEYOR:

THIS IS TO CERTIFY THAT THE ABOVE PLAT WAS PREPARED FROM FIELD NOTES OF ACTUAL SURVEY MADE BY ME OR UNDER MY SUPERVISION AND THAT THE SAME ARE TRUE AND CORRECT TO THE BEST OF MY KNOWLEDGE AND BELIEF. THIS CERTIFICATE DOES NOT REPRESENT A LAND SURVEY PLAT OR IMPROVEMENT SURVEY PLAT AS DEFINED BY C.S. 38-51-102 AND CANNOT BE RELIED UPON TO DETERMINE OWNERSHIP.

Benjamin J. Reenders
BENJAMIN J. REENDERS
PROFESSIONAL LAND SURVEYOR
COLORADO REGISTRATION NUMBER 48306 4/8/15

NOTICE:
ACCORDING TO COLORADO STATE LAW YOU MUST COMMENCE ANY LEGAL ACTION BASED UPON ANY DEFECT IN THIS SURVEY WITHIN THREE YEARS AFTER YOU FIRST DISCOVER SUCH DEFECT. IN NO EVENT MAY ANY ACTION BASED UPON ANY DEFECT IN THIS SURVEY BE COMMENCED MORE THAN TEN YEARS FROM THE DATE ON THE CERTIFICATION SHOWN HEREON.

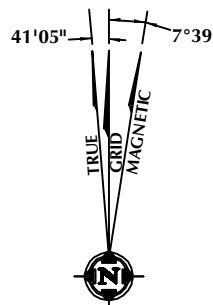

NOTE:
MAGNETIC NORTH IS CURRENT AS OF 1/8/2015.
MAGNETIC NORTH CHANGES WEST 0°06' PER YEAR.

WELL PAD - RESOLUTION 12-63-21-28-4NH

RESOLUTION 12-63-21-28-4NH
WELL LOCATION CERTIFICATE
238' FNL & 2115' FWL LOT 3 (NENW) (SURFACE)
LOCATED IN SECTION 21
600' FSL & 2596' FWL SE SW (BOTTOM)
LOCATED IN SECTION 28
T12N, R63W, 6TH P.M.
WELD COUNTY, COLORADO

Anadarko E&P
Onshore LLC
1099 18th Street
Denver, Colorado 80202



CONSULTING, LLC

SHERIDAN OFFICE
2155 North Main Street
Sheridan, Wyoming 82801
Phone 307-674-0609

LOVELAND OFFICE
1635 Foxtrail Drive, Suite 204
Loveland, Colorado 80538
Phone 970-776-4331

DRAFTED BY:	MDZ	CHECKED BY:	BJR	SHEET NO:
DATE DRAFTED:	1/8/15	DATE SURVEYED:	12/24/14	2
REVISED:		FILE NAME:	14-52	2 OF 2

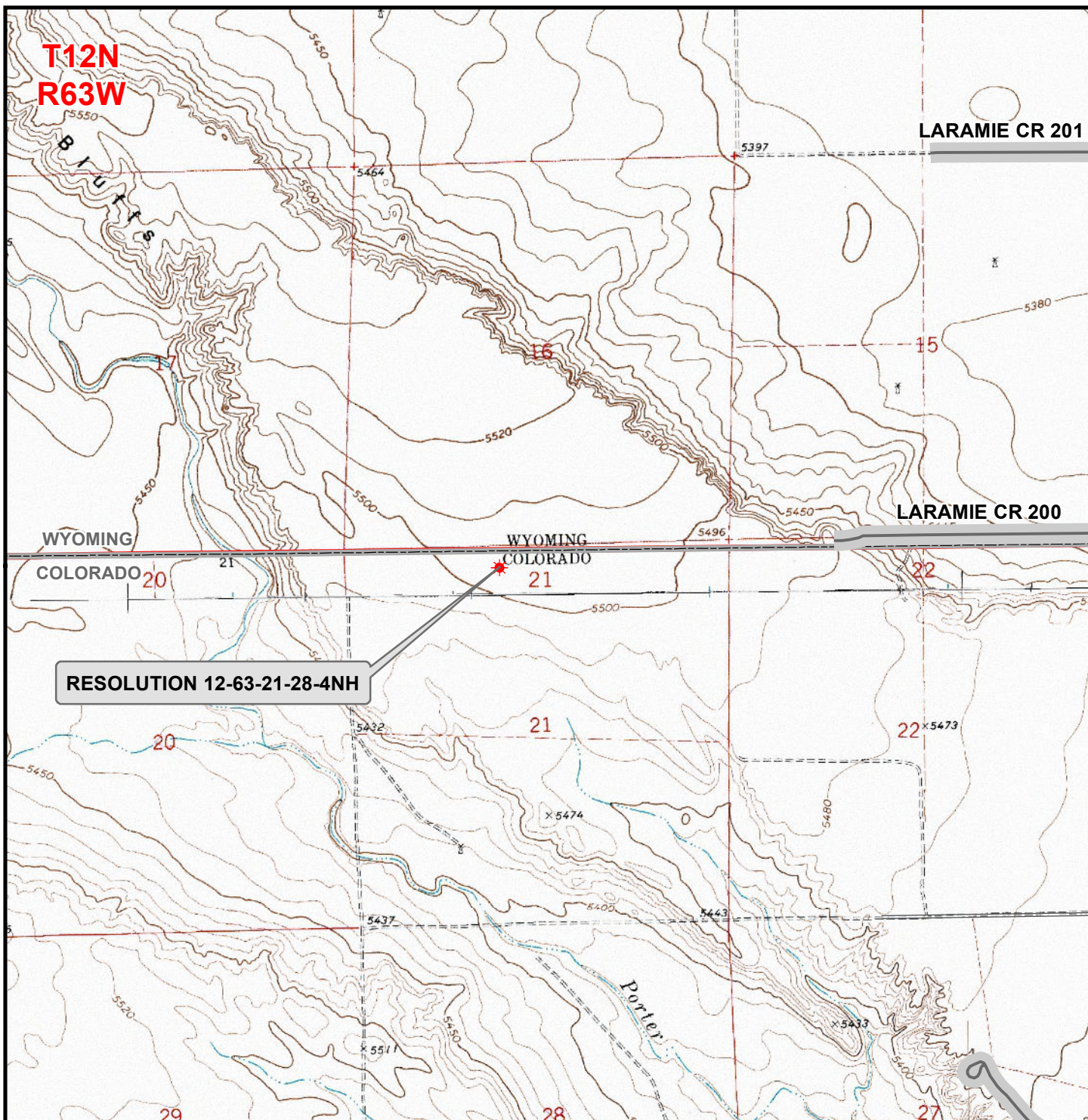

Legend

- ★ Well - Fee - Proposed
 Road - Primitive - Existing
 Road - County - Existing
 Road - Improved - Existing
 Road - Highway - Existing

WELL PAD - RESOLUTION 12-63-21-28-4NH

GENERAL LOCATION MAP
RESOLUTION 12-63-21-28-4NH
LOCATED IN SECTION 21
T12N, R63W, 6th P.M.
WELD COUNTY, COLORADO

Anadarko E&P
Onshore LLC

1099 18th Street
 Denver, CO 80202



CONSULTING, LLC

SHERIDAN OFFICE
 2155 North Main Street
 Sheridan, Wyoming 82801
 Phone 307-674-0609

LOVELAND OFFICE
 1635 Foxtail Drive, Suite 204
 Loveland, Colorado 80538
 Phone 970-776-4331



SCALE: 1" = 2,000ft

NAD83 CO-Nft

DRAWN: TL

DATE: 8 Jan 2015

REVISED:

DATE: