

3.25" BC BLM1974
LAT 40.36451°N
LONG 104.24219°W

3.25" BC BLM1974
LAT 40.36454°N
LONG 104.23288°W

1.5" BC ILLEGIBLE
LAT 40.36457°N
LONG 104.22358°W

NOTE: Under Colorado law,
you must commence any legal
action based upon any defect
in this certificate within three
years after defect is
discovered. In no event, may
any action based upon any
defect in this survey be
commenced more than ten
years after date of this
certificate shown hereon.
(13-80105 C.R.S.)

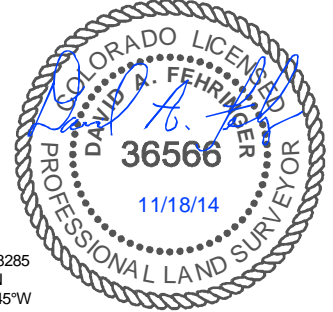

3.25" BC BLM1974
LAT 40.35722°N
LONG 104.24213°W

2.5" AC PELS28285
LAT 40.35728°N
LONG 104.22345°W

TARGET 1
1980'FSL; 531'FEL

SURFACE LOCATION

1107'

571'

3.25" BC BLM1974
LAT 40.34992°N
LONG 104.23269°W

3.25" BC BLM1974
LAT 40.34994°N
LONG 104.23269°W

3.25" BC BLM1949
LAT 40.34998°N
LONG 104.22331°W

CERTIFICATE OF SURVEYOR

I, David A. Fehring of Lander, Wyoming hereby certify that this well location certificate was prepared from notes taken during an actual survey on NOVEMBER 14, 2014; and that it correctly shows the drilling location of BONANZA CREEK ENERGY, INC., STATE PRONGHORN 43-32-31MRLNB as staked during said survey. This map does not represent a boundary survey or an improvement location plat and should not be used for the establishment of boundary lines.

WELL COORDINATES

	NAD 83		COLORADO NORTH NAD83	
	LATITUDE	LONGITUDE	NORTHING	EASTING
43-32-31MRLNB	40.35154	104.22731	1373451	3354698
SURFACE	40.35510	104.22532	1374870	3355234
TARGET 1	40.35532	104.24520	1374757	3349693
BOTTOM HOLE				

NOTES:

- All bearings are GRID based upon the Colorado State Plane Coordinate System, North Zone, NAD83(2011) derived from post-processed static GPS observations.
- Distances are at GRID
- Vertical Datum is NAVD88 based upon GPS observations
- PDOP value equals 1.4.
- GPS operator: Marc Mayer.
- Undisturbed ground elevation at wellhead = 4530.3'
- (M) Measured distance;
- Nearest Cultural Distances
 - Buildings: 5280'+
 - Building Unit: 5280'+
 - High Occupancy Building Unit: 5280'+
 - Designated Outside Activity Area: 5280'+
 - Public Road: 400'+/-
 - Above Ground Utility: 5280'+
 - Railroad: 5280'+
 - Property Line: 571' +/-



Drawn By: MAM
Checked By: DAF
Date: 11/17/14
Revision: 1
Date: 12/02/14
Explanation:
WELL LAYOUT

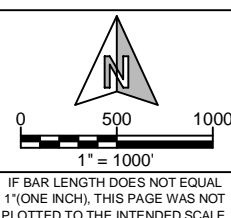

WELL LOCATION CERTIFICATE

STATE PRONGHORN
43-32-31MRLNB
SE $\frac{1}{4}$ SE $\frac{1}{4}$, SECTION 32,
T.5N., R.61W., 6th PM
WELD COUNTY, COLORADO



SHEET
1
OF
2

3.25" BC BLM1974
LAT 40.36432°N
LONG 104.26160°W

N88°28'23"E - 5402.67'(M)

3.25" BC BLM1974
LAT 40.36451°N
LONG 104.24219°W

N01°09'27"W - 2657.87'(M)

3.25" BC BLM1974
LAT 40.35722°N
LONG 104.24213°W

N01°09'24"W - 2658.00'(M)

3.25" BC BLM1974
LAT 40.34992°N

NOTE: Under Colorado law,
you must commence any legal
action based upon any defect
in this certificate within three
years after defect is
discovered. In no event, may
any action based upon any
defect in this survey be
commenced more than ten
years after date of this
certificate shown hereon.
(13-80105 C.R.S)

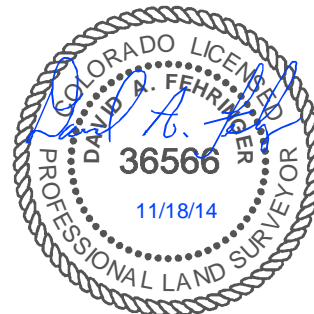

15N R.61W
31

BOTTOM HOLE LOCATION



860'

S88°49'38"W - 7058.91'(M)

1980'

CERTIFICATE OF SURVEYOR

I, David A. Fehring of Lander, Wyoming hereby certify that this well location certificate was prepared from notes taken during an actual survey on NOVEMBER 14, 2014; and that it correctly shows the drilling location of BONANZA CREEK ENERGY, INC., STATE PRONGHORN 43-32-31MRLNB as staked during said survey. This map does not represent a boundary survey or an improvement location plat and should not be used for the establishment of boundary lines.

WELL COORDINATES

43-32-31MRLNB	NAD 83		COLORADO NORTH NAD83	
	LATITUDE	LONGITUDE	NORTHING	EASTING
SURFACE	40.35154	104.22731	1373451	3354698
TARGET 1	40.35510	104.22532	1374870	3355234
BOTTOM HOLE	40.35532	104.24520	1374757	3349693

NOTES:

- All bearings are GRID based upon the Colorado State Plane Coordinate System, North Zone, NAD83(2011) derived from post-processed static GPS observations.
- Distances are at GRID
- Vertical Datum is NAVD88 based upon GPS observations
- PDOP value equals 1.4.
- GPS operator: Marc Mayer.
- Undisturbed ground elevation at wellhead = 4530.3'
- (M) Measured distance;
- Nearest Cultural Distances
 - Buildings: 5280'+
 - Building Unit: 5280'+
 - High Occupancy Building Unit: 5280'+
 - Designated Outside Activity Area: 5280'+
 - Public Road: 400' +/-
 - Above Ground Utility: 5280'+
 - Railroad: 5280'+
 - Property Line: 571' +/-



Drawn By: MAM
Checked By: DAF
Date: 11/17/14
Revision: 1
Date: 12/02/14
Explanation:
WELL LAYOUT

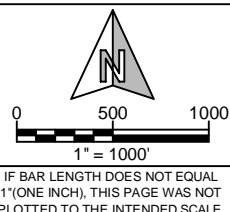

WELL LOCATION CERTIFICATE

STATE PRONGHORN
43-32-31MRLNB
(BOTTOM HOLE)
NE $\frac{1}{4}$ SE $\frac{1}{4}$, SECTION 31,
T.5N., R.61W., 6th PM
WELD COUNTY, COLORADO



410 17th Street
Denver, CO 80202
(720) 440-6100

SHEET
2
OF
2