



Lat40°, Inc. 6250 W. 10th Street, Unit 2, Greeley, CO 970-515-5294





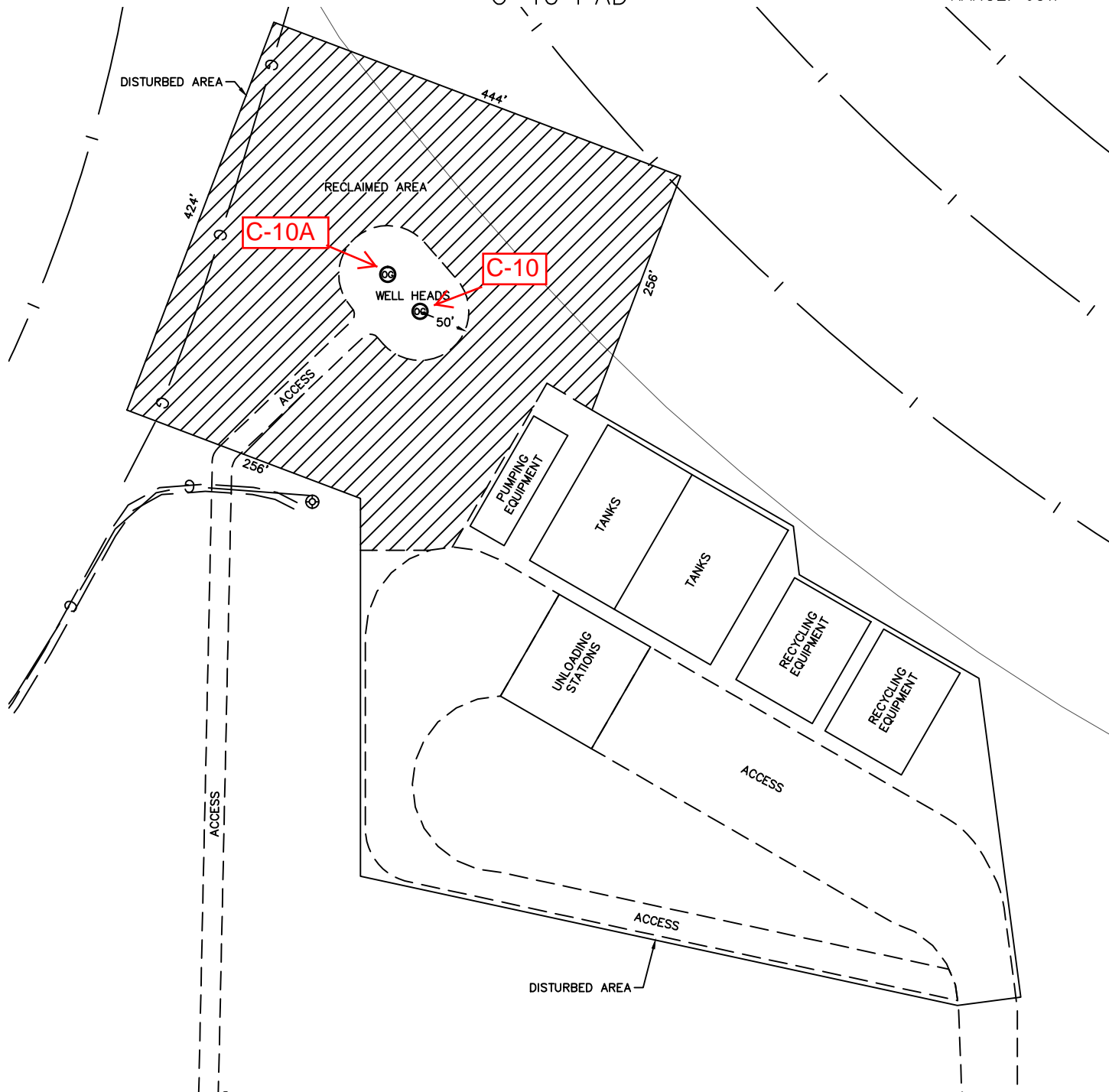

PROPOSED SCALED FACILITY DRAWING

SECTION: 35
TOWNSHIP: 7N
RANGE: 65W

C-10 PAD



LEGEND

-  PROPOSED WELL HEAD
-  TANK BATTERY
-  WATER TANK
-  WATER VAULT
-  SEPARATOR
-  ECD
-  METER
- VRU- VAPOR RECOVERY UNIT

TOTAL DISTURBED AREA OF LOCATION: ±10.5 ACRES
TOTAL SIZE OF LOCATION AFTER RECLAMATION: ±6.8 ACRES

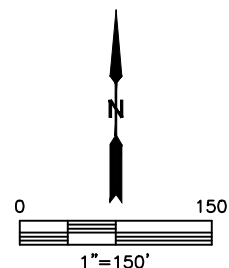

DATE: 11/24/2014
PROJECT#: 2014178