

BONANZA CREEK ENERGY INC.

WELD COUNTY, COLORADO (NAD 83)

NW NW SEC. 2 T5N R62W 6th P.M.

STATE ANTELOPE A11-U41-2HNC

ORIGINAL WELLBORE

19 November, 2014

Plan: PROPOSAL #2





Project: WELD COUNTY, COLORADO (NAD 83)
Site: NW NW SEC. 2 T5N R62W 6th P.M.
Well: STATE ANTELOPE A11-U41-2HNC
Wellbore: ORIGINAL WELLBORE
Design: PROPOSAL #2

ANNOTATIONS								
TVD	MD	Inc	Azi	+N/-S	+E/-W	VSect	Dep	Annotation
800.0	800.0	0.00	0.00	0.0	0.0	0.0	0.0	START NUDGE (2°/100ft BUR)
1481.6	1488.2	13.76	340.27	77.4	-27.8	-7.5	82.3	EOB TO 13.76° INC
5048.8	5160.9	13.76	340.27	900.0	-322.7	-87.6	956.1	END OF TANGENT
5730.4	5849.1	0.00	0.00	977.4	-350.5	-95.1	1038.3	EOD TO VERTICAL
5760.4	5879.1	0.00	0.00	977.4	-350.5	-95.1	1038.3	KOP (12°/100ft BUR)
6221.6	6504.1	75.00	87.85	990.7	3.2	250.6	1392.3	START OF TANGENT
6247.5	6604.1	75.00	87.85	994.3	99.7	345.0	1488.9	END OF TANGENT
6263.7	6729.1	90.00	87.85	998.9	223.2	465.7	1612.4	7" ICP *NEW* (P2) - STATE ANTELOPE A11-U41-2HNC
6263.7	11000.7	90.00	87.85	1159.3	4491.8	4639.0	5884.0	BHL (P2) - STATE ANTELOPE A11-U41-2HNC

WELLBORE TARGET DETAILS (LAT/LONG)					
Name	TVD	+N/-S	+E/-W	Latitude	Longitude
KOP (P2) - STATE ANTELOPE A11-U41-2HNC	5760.4	977.4	-350.5	40.435826	-104.299986
BHL (P2) - STATE ANTELOPE A11-U41-2HNC	6263.7	1159.3	4491.8	40.436324	-104.282591
7" ICP *NEW* (P2) - STATE ANTELOPE A11-U41-2HNC	6263.7	998.9	223.2	40.435885	-104.297925

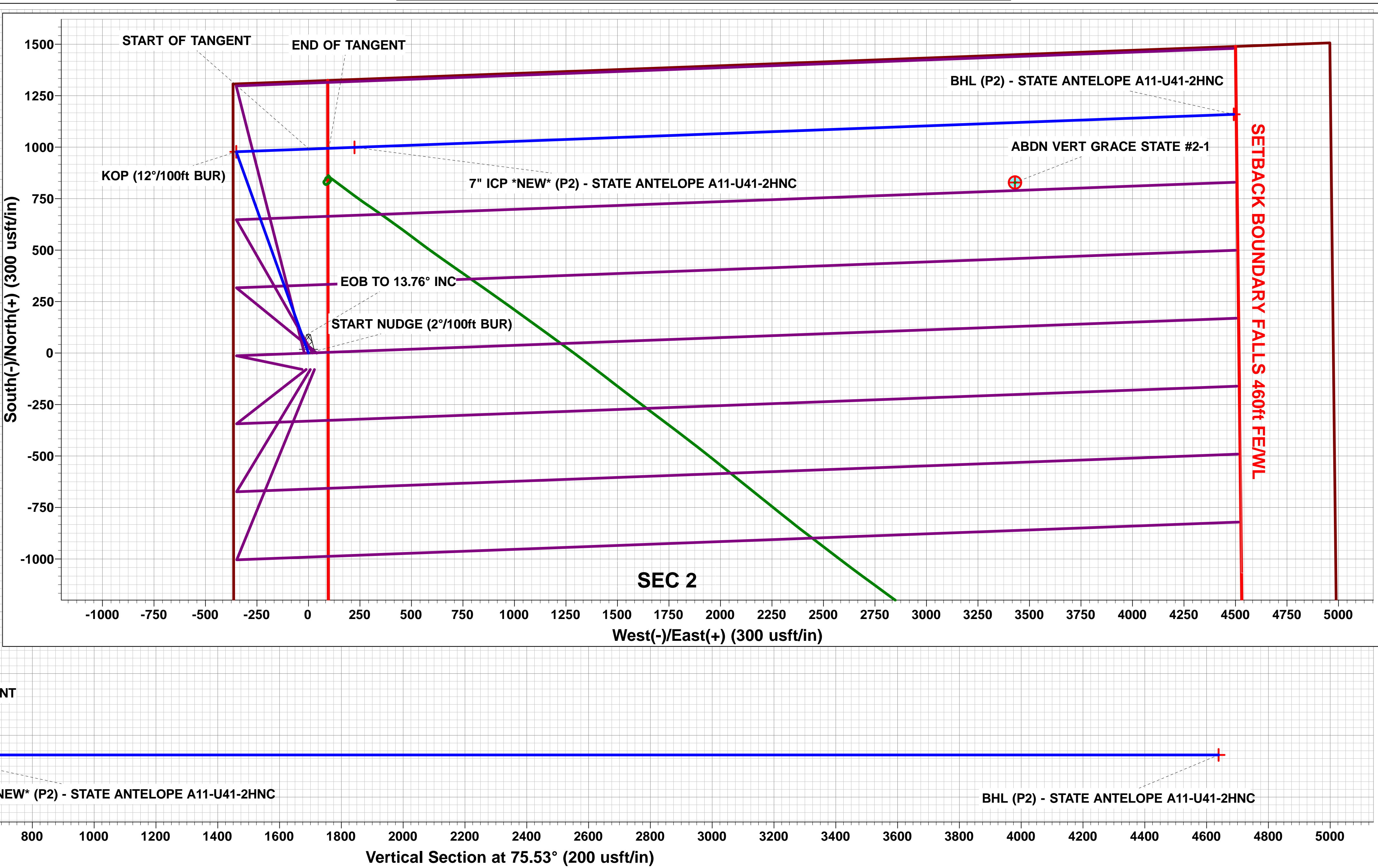
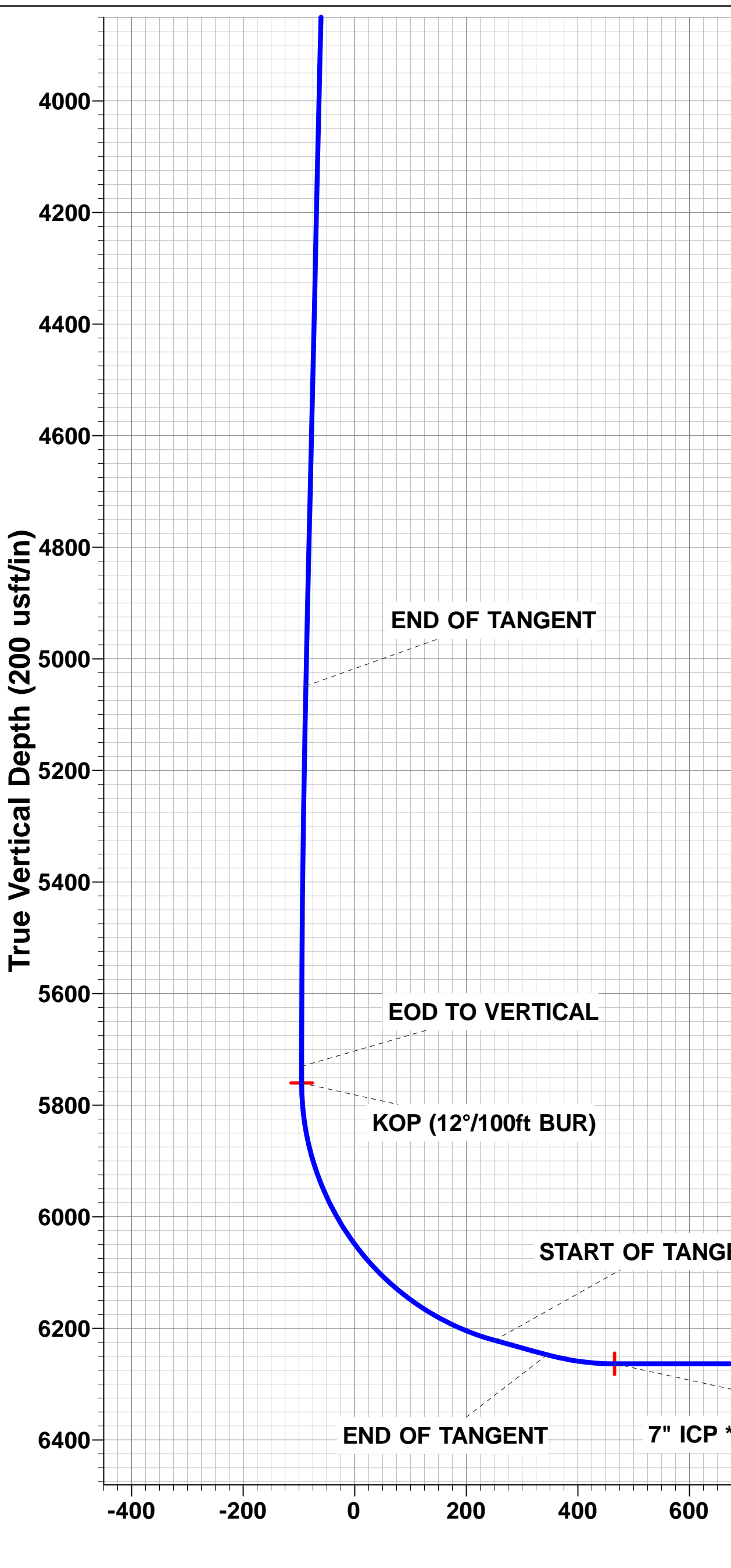
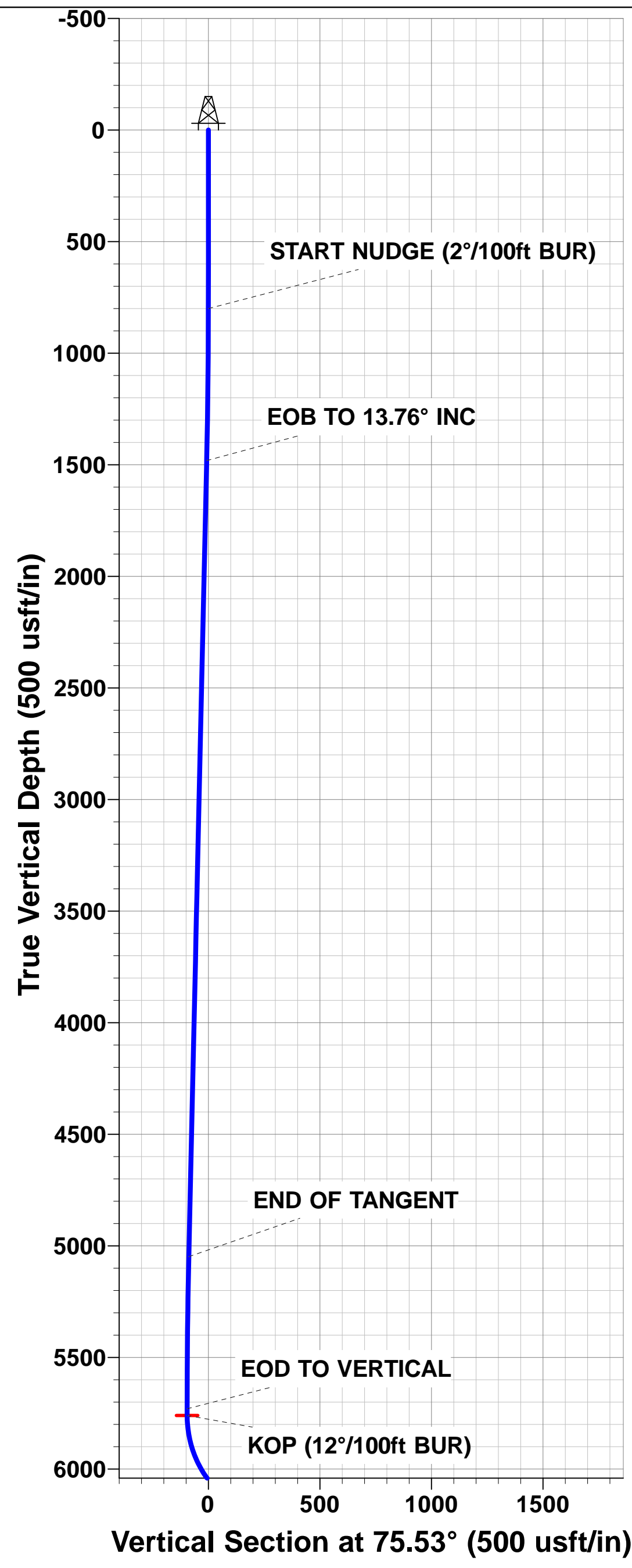
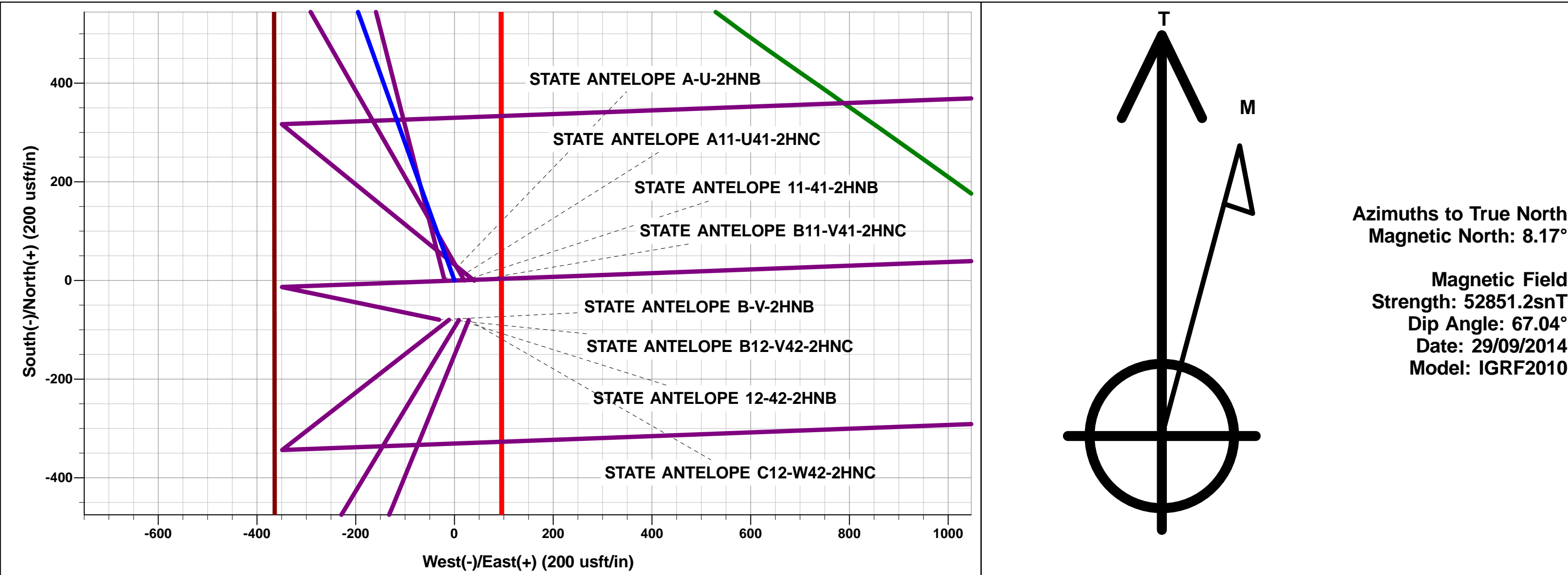

Planning Report



Database:	EDM 5000.1 Single User Db	Local Co-ordinate Reference:	Well STATE ANTELOPE A11-U41-2HNC
Company:	BONANZA CREEK ENERGY INC.	TVD Reference:	KB-EST @ 4663.7usft (Original Well Elev)
Project:	WELD COUNTY, COLORADO (NAD 83)	MD Reference:	KB-EST @ 4663.7usft (Original Well Elev)
Site:	NW NW SEC. 2 T5N R62W 6th P.M.	North Reference:	True
Well:	STATE ANTELOPE A11-U41-2HNC	Survey Calculation Method:	Minimum Curvature
Wellbore:	ORIGINAL WELLBORE		
Design:	PROPOSAL #2		

Project	WELD COUNTY, COLORADO (NAD 83)		
Map System:	US State Plane 1983	System Datum:	Mean Sea Level
Geo Datum:	North American Datum 1983		
Map Zone:	Colorado Northern Zone		Using geodetic scale factor

Site		NW NW SEC. 2 T5N R62W 6th P.M.			
Site Position:		Northing:	1,402,899.64 usft	Latitude:	40.433143
From:	Lat/Long	Easting:	3,334,413.22 usft	Longitude:	-104.298655
Position Uncertainty:	0.0 usft	Slot Radius:	1.10000 ft	Grid Convergence:	0.78 °

Well	STATE ANTELOPE A11-U41-2HNC					
Well Position	+N/-S	0.0 usft	Northing:	1,402,899.35 usft	Latitude:	40.433143
	+E/-W	-20.0 usft	Easting:	3,334,393.18 usft	Longitude:	-104.298727
Position Uncertainty		0.0 usft	Wellhead Elevation:	usft	Ground Level:	4,646.7 usft

Wellbore	ORIGINAL WELLBORE				
Magnetics	Model Name	Sample Date	Declination (°)	Dip Angle (°)	Field Strength (nT)
	IGRF2010	29/09/2014	8.17	67.04	52,851

Design	PROPOSAL #2			
Audit Notes:				
Version:	Phase:	PROTOTYPE	Tie On Depth:	0.0
Vertical Section:	Depth From (TVD) (usft)	+N/-S (usft)	+E/-W (usft)	Direction (°)
	6,263.7	0.0	0.0	75.53

Plan Sections											
MD (usft)	Inc (°)	Azi (°)	Vertical Depth	SS (usft)	+N/-S (usft)	+E/-W (usft)	Dogleg Rate (°/100usf)	Build Rate (°/100usf)	Turn Rate (°/100usf)	TFO (°)	Target
0.0	0.00	0.00	0.0	-4,663.7	0.0	0.0	0.00	0.00	0.00	0.00	
800.0	0.00	0.00	800.0	-3,863.7	0.0	0.0	0.00	0.00	0.00	0.00	
1,488.2	13.76	340.27	1,481.6	-3,182.1	77.4	-27.8	2.00	2.00	0.00	340.27	
5,160.9	13.76	340.27	5,048.8	385.1	900.0	-322.7	0.00	0.00	0.00	0.00	
5,849.1	0.00	0.00	5,730.4	1,066.7	977.4	-350.5	2.00	-2.00	0.00	180.00	
5,879.1	0.00	0.00	5,760.4	1,096.7	977.4	-350.5	0.00	0.00	0.00	0.00	KOP (P2) - STATE
6,504.1	75.00	87.85	6,221.6	1,557.9	990.7	3.1	12.00	12.00	0.00	87.85	
6,604.1	75.00	87.85	6,247.5	1,583.8	994.3	99.7	0.00	0.00	0.00	0.00	
6,729.1	90.00	87.85	6,263.7	1,600.0	998.9	223.2	12.00	12.00	0.00	0.00	
11,000.7	90.00	87.85	6,263.7	1,600.0	1,159.3	4,491.8	0.00	0.00	0.00	-67.27	BHL (P2) - STATE

Planning Report



Database:	EDM 5000.1 Single User Db	Local Co-ordinate Reference:	Well STATE ANTELOPE A11-U41-2HNC
Company:	BONANZA CREEK ENERGY INC.	TVD Reference:	KB-EST @ 4663.7usft (Original Well Elev)
Project:	WELD COUNTY, COLORADO (NAD 83)	MD Reference:	KB-EST @ 4663.7usft (Original Well Elev)
Site:	NW NW SEC. 2 T5N R62W 6th P.M.	North Reference:	True
Well:	STATE ANTELOPE A11-U41-2HNC	Survey Calculation Method:	Minimum Curvature
Wellbore:	ORIGINAL WELLBORE		
Design:	PROPOSAL #2		

Planned Survey										
MD (usft)	Inc (°)	Azi (°)	TVD (usft)	SS (usft)	+N/-S (usft)	+E/-W (usft)	Vertical Section (usft)	Dogleg Rate (°/100usft)	Build Rate (°/100usft)	Turn Rate (°/100usft)
0.0	0.00	0.00	0.0	4,663.70	0.0	0.0	0.0	0.00	0.00	0.00
100.0	0.00	0.00	100.0	4,563.70	0.0	0.0	0.0	0.00	0.00	0.00
200.0	0.00	0.00	200.0	4,463.70	0.0	0.0	0.0	0.00	0.00	0.00
300.0	0.00	0.00	300.0	4,363.70	0.0	0.0	0.0	0.00	0.00	0.00
400.0	0.00	0.00	400.0	4,263.70	0.0	0.0	0.0	0.00	0.00	0.00
500.0	0.00	0.00	500.0	4,163.70	0.0	0.0	0.0	0.00	0.00	0.00
600.0	0.00	0.00	600.0	4,063.70	0.0	0.0	0.0	0.00	0.00	0.00
700.0	0.00	0.00	700.0	3,963.70	0.0	0.0	0.0	0.00	0.00	0.00
START NUDGE (2°/100ft BUR)										
800.0	0.00	0.00	800.0	3,863.70	0.0	0.0	0.0	0.00	0.00	0.00
900.0	2.00	340.27	900.0	3,763.72	1.6	-0.6	-0.2	2.00	2.00	0.00
1,000.0	4.00	340.27	999.8	3,663.86	6.6	-2.4	-0.6	2.00	2.00	0.00
1,100.0	6.00	340.27	1,099.5	3,564.25	14.8	-5.3	-1.4	2.00	2.00	0.00
1,200.0	8.00	340.27	1,198.7	3,465.00	26.2	-9.4	-2.6	2.00	2.00	0.00
1,300.0	10.00	340.27	1,297.5	3,366.23	41.0	-14.7	-4.0	2.00	2.00	0.00
1,400.0	12.00	340.27	1,395.6	3,268.08	58.9	-21.1	-5.7	2.00	2.00	0.00
EOB TO 13.76° INC										
1,488.2	13.76	340.27	1,481.6	3,182.10	77.4	-27.8	-7.5	2.00	2.00	0.00
1,500.0	13.76	340.27	1,493.1	3,170.64	80.1	-28.7	-7.8	0.00	0.00	0.00
1,600.0	13.76	340.27	1,590.2	3,073.51	102.5	-36.7	-10.0	0.00	0.00	0.00
1,700.0	13.76	340.27	1,687.3	2,976.38	124.9	-44.8	-12.2	0.00	0.00	0.00
1,800.0	13.76	340.27	1,784.4	2,879.25	147.3	-52.8	-14.3	0.00	0.00	0.00
1,900.0	13.76	340.27	1,881.6	2,782.13	169.7	-60.8	-16.5	0.00	0.00	0.00
2,000.0	13.76	340.27	1,978.7	2,685.00	192.1	-68.9	-18.7	0.00	0.00	0.00
2,100.0	13.76	340.27	2,075.8	2,587.87	214.5	-76.9	-20.9	0.00	0.00	0.00
2,200.0	13.76	340.27	2,173.0	2,490.74	236.9	-84.9	-23.1	0.00	0.00	0.00
2,300.0	13.76	340.27	2,270.1	2,393.61	259.2	-93.0	-25.2	0.00	0.00	0.00
2,400.0	13.76	340.27	2,367.2	2,296.48	281.6	-101.0	-27.4	0.00	0.00	0.00
2,500.0	13.76	340.27	2,464.3	2,199.36	304.0	-109.0	-29.6	0.00	0.00	0.00
2,600.0	13.76	340.27	2,561.5	2,102.23	326.4	-117.1	-31.8	0.00	0.00	0.00
2,700.0	13.76	340.27	2,658.6	2,005.10	348.8	-125.1	-33.9	0.00	0.00	0.00
2,800.0	13.76	340.27	2,755.7	1,907.97	371.2	-133.1	-36.1	0.00	0.00	0.00
2,900.0	13.76	340.27	2,852.9	1,810.84	393.6	-141.2	-38.3	0.00	0.00	0.00
3,000.0	13.76	340.27	2,950.0	1,713.71	416.0	-149.2	-40.5	0.00	0.00	0.00
3,100.0	13.76	340.27	3,047.1	1,616.58	438.4	-157.2	-42.7	0.00	0.00	0.00
3,200.0	13.76	340.27	3,144.2	1,519.46	460.8	-165.2	-44.8	0.00	0.00	0.00
3,300.0	13.76	340.27	3,241.4	1,422.33	483.2	-173.3	-47.0	0.00	0.00	0.00
3,400.0	13.76	340.27	3,338.5	1,325.20	505.6	-181.3	-49.2	0.00	0.00	0.00
3,500.0	13.76	340.27	3,435.6	1,228.07	528.0	-189.3	-51.4	0.00	0.00	0.00
3,600.0	13.76	340.27	3,532.8	1,130.94	550.4	-197.4	-53.6	0.00	0.00	0.00
3,700.0	13.76	340.27	3,629.9	1,033.81	572.8	-205.4	-55.7	0.00	0.00	0.00
3,800.0	13.76	340.27	3,727.0	936.69	595.2	-213.4	-57.9	0.00	0.00	0.00
3,900.0	13.76	340.27	3,824.1	839.56	617.6	-221.5	-60.1	0.00	0.00	0.00
4,000.0	13.76	340.27	3,921.3	742.43	640.0	-229.5	-62.3	0.00	0.00	0.00
4,100.0	13.76	340.27	4,018.4	645.30	662.4	-237.5	-64.5	0.00	0.00	0.00
4,200.0	13.76	340.27	4,115.5	548.17	684.8	-245.6	-66.6	0.00	0.00	0.00
4,300.0	13.76	340.27	4,212.7	451.04	707.2	-253.6	-68.8	0.00	0.00	0.00
4,400.0	13.76	340.27	4,309.8	353.92	729.6	-261.6	-71.0	0.00	0.00	0.00
4,500.0	13.76	340.27	4,406.9	256.79	752.0	-269.7	-73.2	0.00	0.00	0.00
4,600.0	13.76	340.27	4,504.0	159.66	774.4	-277.7	-75.4	0.00	0.00	0.00
4,700.0	13.76	340.27	4,601.2	62.53	796.7	-285.7	-77.5	0.00	0.00	0.00
4,800.0	13.76	340.27	4,698.3	-34.60	819.1	-293.7	-79.7	0.00	0.00	0.00
4,900.0	13.76	340.27	4,795.4	-131.73	841.5	-301.8	-81.9	0.00	0.00	0.00
5,000.0	13.76	340.27	4,892.6	-228.85	863.9	-309.8	-84.1	0.00	0.00	0.00

Planning Report



Database:	EDM 5000.1 Single User Db	Local Co-ordinate Reference:	Well STATE ANTELOPE A11-U41-2HNC
Company:	BONANZA CREEK ENERGY INC.	TVD Reference:	KB-EST @ 4663.7usft (Original Well Elev)
Project:	WELD COUNTY, COLORADO (NAD 83)	MD Reference:	KB-EST @ 4663.7usft (Original Well Elev)
Site:	NW NW SEC. 2 T5N R62W 6th P.M.	North Reference:	True
Well:	STATE ANTELOPE A11-U41-2HNC	Survey Calculation Method:	Minimum Curvature
Wellbore:	ORIGINAL WELLBORE		
Design:	PROPOSAL #2		

Planned Survey										
MD (usft)	Inc (°)	Azi (°)	TVD (usft)	SS (usft)	+N/-S (usft)	+E/-W (usft)	Vertical Section (usft)	Dogleg Rate (°/100usft)	Build Rate (°/100usft)	Turn Rate (°/100usft)
5,100.0	13.76	340.27	4,989.7	-325.98	886.3	-317.8	-86.3	0.00	0.00	0.00
END OF TANGENT										
5,160.9	13.76	340.27	5,048.8	-385.13	900.0	-322.7	-87.6	0.00	0.00	0.00
5,200.0	12.98	340.27	5,086.9	-423.17	908.5	-325.8	-88.4	2.00	-2.00	0.00
5,300.0	10.98	340.27	5,184.7	-520.99	928.0	-332.8	-90.3	2.00	-2.00	0.00
5,400.0	8.98	340.27	5,283.2	-619.47	944.3	-338.6	-91.9	2.00	-2.00	0.00
5,500.0	6.98	340.27	5,382.2	-718.50	957.4	-343.3	-93.2	2.00	-2.00	0.00
5,600.0	4.98	340.27	5,481.6	-817.95	967.2	-346.8	-94.1	2.00	-2.00	0.00
5,700.0	2.98	340.27	5,581.4	-917.70	973.8	-349.2	-94.8	2.00	-2.00	0.00
5,800.0	0.98	340.27	5,681.3	-1,017.64	977.0	-350.4	-95.1	2.00	-2.00	0.00
EOD TO VERTICAL										
5,849.1	0.00	0.00	5,730.4	-1,066.73	977.4	-350.5	-95.1	2.00	-2.00	0.00
KOP (12°/100ft BUR)										
5,879.1	0.00	0.00	5,760.4	-1,096.73	977.4	-350.5	-95.1	0.00	0.00	0.00
5,900.0	2.51	87.85	5,781.3	-1,117.63	977.4	-350.0	-94.7	12.02	12.02	0.00
6,000.0	14.51	87.85	5,880.0	-1,216.35	978.0	-335.3	-80.2	12.00	12.00	0.00
6,100.0	26.51	87.85	5,973.5	-1,309.83	979.3	-300.3	-46.1	12.00	12.00	0.00
6,200.0	38.51	87.85	6,057.7	-1,394.01	981.3	-246.7	6.3	12.00	12.00	0.00
6,300.0	50.51	87.85	6,128.9	-1,465.19	983.9	-176.8	74.7	12.00	12.00	0.00
6,400.0	62.51	87.85	6,184.0	-1,520.26	987.0	-93.6	156.0	12.00	12.00	0.00
6,500.0	74.51	87.85	6,220.5	-1,556.83	990.5	-0.8	246.8	12.00	12.00	0.00
START OF TANGENT										
6,504.1	75.00	87.85	6,221.6	-1,557.90	990.7	3.2	250.6	11.90	11.90	0.00
6,600.0	75.00	87.85	6,246.4	-1,582.73	994.2	95.7	341.1	0.00	0.00	0.00
END OF TANGENT										
6,604.1	75.00	87.85	6,247.5	-1,583.79	994.3	99.7	345.0	0.00	0.00	0.00
6,700.0	86.51	87.85	6,262.9	-1,599.16	997.8	194.1	437.3	12.00	12.00	0.00
7" ICP *NEW* (P2) - STATE ANTELOPE A11-U41-2HNC										
6,729.1	90.00	87.85	6,263.7	-1,600.05	998.9	223.2	465.7	11.99	11.99	0.00
6,800.0	90.00	87.85	6,263.7	-1,600.05	1,001.6	294.0	535.0	0.00	0.00	0.00
6,900.0	90.00	87.85	6,263.7	-1,600.05	1,005.3	394.0	632.7	0.00	0.00	0.00
7,000.0	90.00	87.85	6,263.7	-1,600.05	1,009.1	493.9	730.4	0.00	0.00	0.00
7,100.0	90.00	87.85	6,263.7	-1,600.05	1,012.9	593.8	828.1	0.00	0.00	0.00
7,200.0	90.00	87.85	6,263.7	-1,600.05	1,016.6	693.8	925.8	0.00	0.00	0.00
7,300.0	90.00	87.85	6,263.7	-1,600.05	1,020.4	793.7	1,023.5	0.00	0.00	0.00
7,400.0	90.00	87.85	6,263.7	-1,600.05	1,024.1	893.6	1,121.2	0.00	0.00	0.00
7,500.0	90.00	87.85	6,263.7	-1,600.05	1,027.9	993.5	1,218.9	0.00	0.00	0.00
7,600.0	90.00	87.85	6,263.7	-1,600.04	1,031.6	1,093.5	1,316.6	0.00	0.00	0.00
7,700.0	90.00	87.85	6,263.7	-1,600.04	1,035.4	1,193.4	1,414.3	0.00	0.00	0.00
7,800.0	90.00	87.85	6,263.7	-1,600.04	1,039.1	1,293.3	1,512.0	0.00	0.00	0.00
7,900.0	90.00	87.85	6,263.7	-1,600.04	1,042.9	1,393.3	1,609.7	0.00	0.00	0.00
8,000.0	90.00	87.85	6,263.7	-1,600.04	1,046.6	1,493.2	1,707.4	0.00	0.00	0.00
8,100.0	90.00	87.85	6,263.7	-1,600.04	1,050.4	1,593.1	1,805.1	0.00	0.00	0.00
8,200.0	90.00	87.85	6,263.7	-1,600.04	1,054.1	1,693.1	1,902.8	0.00	0.00	0.00
8,300.0	90.00	87.85	6,263.7	-1,600.04	1,057.9	1,793.0	2,000.5	0.00	0.00	0.00
8,400.0	90.00	87.85	6,263.7	-1,600.04	1,061.6	1,892.9	2,098.2	0.00	0.00	0.00
8,500.0	90.00	87.85	6,263.7	-1,600.04	1,065.4	1,992.8	2,195.9	0.00	0.00	0.00
8,600.0	90.00	87.85	6,263.7	-1,600.04	1,069.1	2,092.8	2,293.6	0.00	0.00	0.00
8,700.0	90.00	87.85	6,263.7	-1,600.04	1,072.9	2,192.7	2,391.2	0.00	0.00	0.00
8,800.0	90.00	87.85	6,263.7	-1,600.04	1,076.7	2,292.6	2,488.9	0.00	0.00	0.00
8,900.0	90.00	87.85	6,263.7	-1,600.03	1,080.4	2,392.6	2,586.6	0.00	0.00	0.00
9,000.0	90.00	87.85	6,263.7	-1,600.03	1,084.2	2,492.5	2,684.3	0.00	0.00	0.00
9,100.0	90.00	87.85	6,263.7	-1,600.03	1,087.9	2,592.4	2,782.0	0.00	0.00	0.00

Planning Report



Database:	EDM 5000.1 Single User Db	Local Co-ordinate Reference:	Well STATE ANTELOPE A11-U41-2HNC
Company:	BONANZA CREEK ENERGY INC.	TVD Reference:	KB-EST @ 4663.7usft (Original Well Elev)
Project:	WELD COUNTY, COLORADO (NAD 83)	MD Reference:	KB-EST @ 4663.7usft (Original Well Elev)
Site:	NW NW SEC. 2 T5N R62W 6th P.M.	North Reference:	True
Well:	STATE ANTELOPE A11-U41-2HNC	Survey Calculation Method:	Minimum Curvature
Wellbore:	ORIGINAL WELLBORE		
Design:	PROPOSAL #2		

Planned Survey										
MD (usft)	Inc (°)	Azi (°)	TVD (usft)	SS (usft)	+N/-S (usft)	+E/-W (usft)	Vertical Section (usft)	Dogleg Rate (°/100usft)	Build Rate (°/100usft)	Turn Rate (°/100usft)
9,200.0	90.00	87.85	6,263.7	-1,600.03	1,091.7	2,692.3	2,879.7	0.00	0.00	0.00
9,300.0	90.00	87.85	6,263.7	-1,600.03	1,095.4	2,792.3	2,977.4	0.00	0.00	0.00
9,400.0	90.00	87.85	6,263.7	-1,600.03	1,099.2	2,892.2	3,075.1	0.00	0.00	0.00
9,500.0	90.00	87.85	6,263.7	-1,600.03	1,102.9	2,992.1	3,172.8	0.00	0.00	0.00
9,600.0	90.00	87.85	6,263.7	-1,600.03	1,106.7	3,092.1	3,270.5	0.00	0.00	0.00
9,700.0	90.00	87.85	6,263.7	-1,600.02	1,110.4	3,192.0	3,368.2	0.00	0.00	0.00
9,800.0	90.00	87.85	6,263.7	-1,600.02	1,114.2	3,291.9	3,465.9	0.00	0.00	0.00
9,900.0	90.00	87.85	6,263.7	-1,600.02	1,118.0	3,391.9	3,563.6	0.00	0.00	0.00
10,000.0	90.00	87.85	6,263.7	-1,600.02	1,121.7	3,491.8	3,661.3	0.00	0.00	0.00
10,100.0	90.00	87.85	6,263.7	-1,600.02	1,125.5	3,591.7	3,759.0	0.00	0.00	0.00
10,200.0	90.00	87.85	6,263.7	-1,600.02	1,129.2	3,691.6	3,856.7	0.00	0.00	0.00
10,300.0	90.00	87.85	6,263.7	-1,600.01	1,133.0	3,791.6	3,954.4	0.00	0.00	0.00
10,400.0	90.00	87.85	6,263.7	-1,600.01	1,136.7	3,891.5	4,052.1	0.00	0.00	0.00
10,500.0	90.00	87.85	6,263.7	-1,600.01	1,140.5	3,991.4	4,149.8	0.00	0.00	0.00
10,600.0	90.00	87.85	6,263.7	-1,600.01	1,144.2	4,091.4	4,247.5	0.00	0.00	0.00
10,700.0	90.00	87.85	6,263.7	-1,600.01	1,148.0	4,191.3	4,345.2	0.00	0.00	0.00
10,800.0	90.00	87.85	6,263.7	-1,600.00	1,151.8	4,291.2	4,442.9	0.00	0.00	0.00
10,900.0	90.00	87.85	6,263.7	-1,600.00	1,155.5	4,391.1	4,540.6	0.00	0.00	0.00
11,000.0	90.00	87.85	6,263.7	-1,600.00	1,159.3	4,491.1	4,638.3	0.00	0.00	0.00
BHL (P2) - STATE ANTELOPE A11-U41-2HNC										
11,000.7	90.00	87.85	6,263.7	-1,600.00	1,159.3	4,491.8	4,639.0	0.00	0.00	0.00

Plan Annotations					
MD (usft)	TVD (usft)	Local Coordinates		Comment	
		+N/-S (usft)	+E/-W (usft)		
800.0	800.0	0.0	0.0	START NUDGE (2°/100ft BUR)	
1,488.2	1,481.6	77.4	-27.8	EOB TO 13.76° INC	
5,160.9	5,048.8	900.0	-322.7	END OF TANGENT	
5,849.1	5,730.4	977.4	-350.5	EOD TO VERTICAL	
5,879.1	5,760.4	977.4	-350.5	KOP (12°/100ft BUR)	
6,504.1	6,221.6	990.7	3.2	START OF TANGENT	
6,604.1	6,247.5	994.3	99.7	END OF TANGENT	
6,729.1	6,263.7	998.9	223.2	7" ICP *NEW* (P2) - STATE ANTELOPE A11-U41-2HNC	
11,000.7	6,263.7	1,159.3	4,491.8	BHL (P2) - STATE ANTELOPE A11-U41-2HNC	