

# **BONANZA CREEK ENERGY INC.**

**WELD COUNTY, COLORADO (NAD 83)**

**NW NW SEC. 2 T5N R62W 6th P.M.**

**STATE ANTELOPE B-V-2HNB**

**ORIGINAL WELLBORE**

**26 November, 2014**

**Plan: PROPOSAL #3**





Project: WELD COUNTY, COLORADO (NAD 83)  
Site: NW NW SEC. 2 T5N R62W 6th P.M.  
Well: STATE ANTELOPE B-V-2HNB  
Wellbore: ORIGINAL WELLBORE  
Design: PROPOSAL #3

ANNOTATIONS									
TVD	MD	Inc	Azi	+N/-S	+E/-W	VSect	Dep	Annotation	
800.0	800.0	0.00	0.00	0.0	0.0	0.0	0.0	START NUDGE (2°/100ft BUR)	
1049.6	1049.9	5.00	281.75	2.2	-10.7	-10.5	10.9	EOB TO 5° INC	
4517.0	4530.6	5.00	281.75	64.0	-307.5	-303.6	314.1	END OF TANGENT	
4766.6	4780.5	0.00	0.00	66.2	-318.2	-314.1	325.0	EOD TO VERTICAL	
5671.6	5685.5	0.00	0.00	66.2	-318.2	-314.1	325.0	KOP (12°/100ft BUR)	
6132.8	6310.5	75.00	87.85	79.5	35.5	39.8	678.9	START OF TANGENT	
6158.7	6410.5	75.00	87.85	83.1	132.0	136.3	775.5	END OF TANGENT	
6174.9	6535.5	90.00	87.85	87.7	255.5	259.9	899.1	7" ICP (P3) *NEW* - STATE ANTELOPE B-V-2HNB	
6174.9	10817.3	90.00	87.85	248.5	4534.3	4541.1	5180.9	BHL (P3) - STATE ANTELOPE B-V-2HNB	

WELLBORE TARGET DETAILS (LAT/LONG)					
Name	TVD	+N/-S	+E/-W	Latitude	Longitude
KOP (P3) - STATE ANTELOPE B-V-2HNB	5671.6	66.2	-318.2	40.433107	-104.299982
BHL (P3) - STATE ANTELOPE B-V-2HNB	6174.9	248.5	4534.3	40.433606	-104.282551
7" ICP (P3) *NEW* - STATE ANTELOPE B-V-2HNB	6174.9	87.7	255.5	40.433166	-104.297921

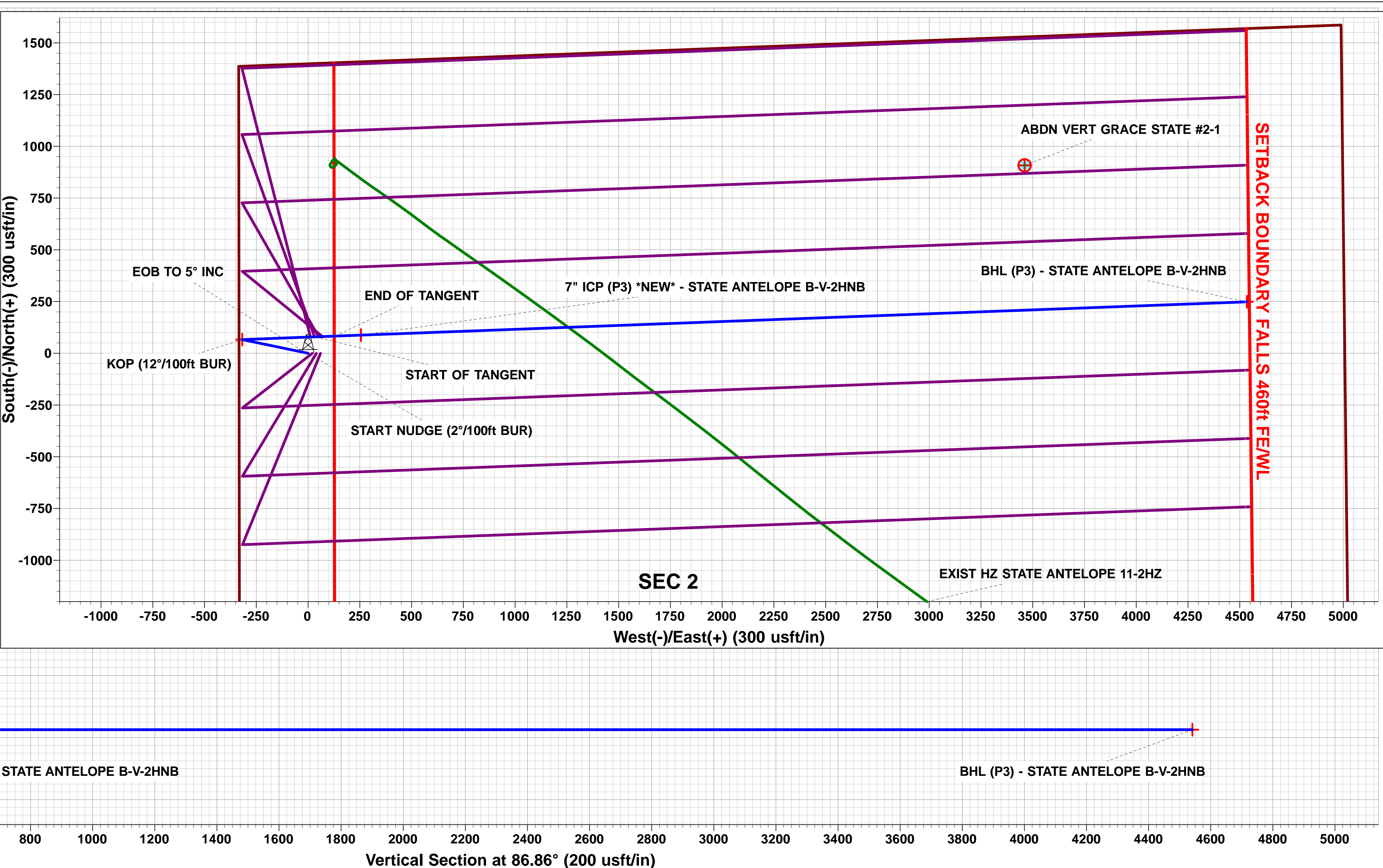
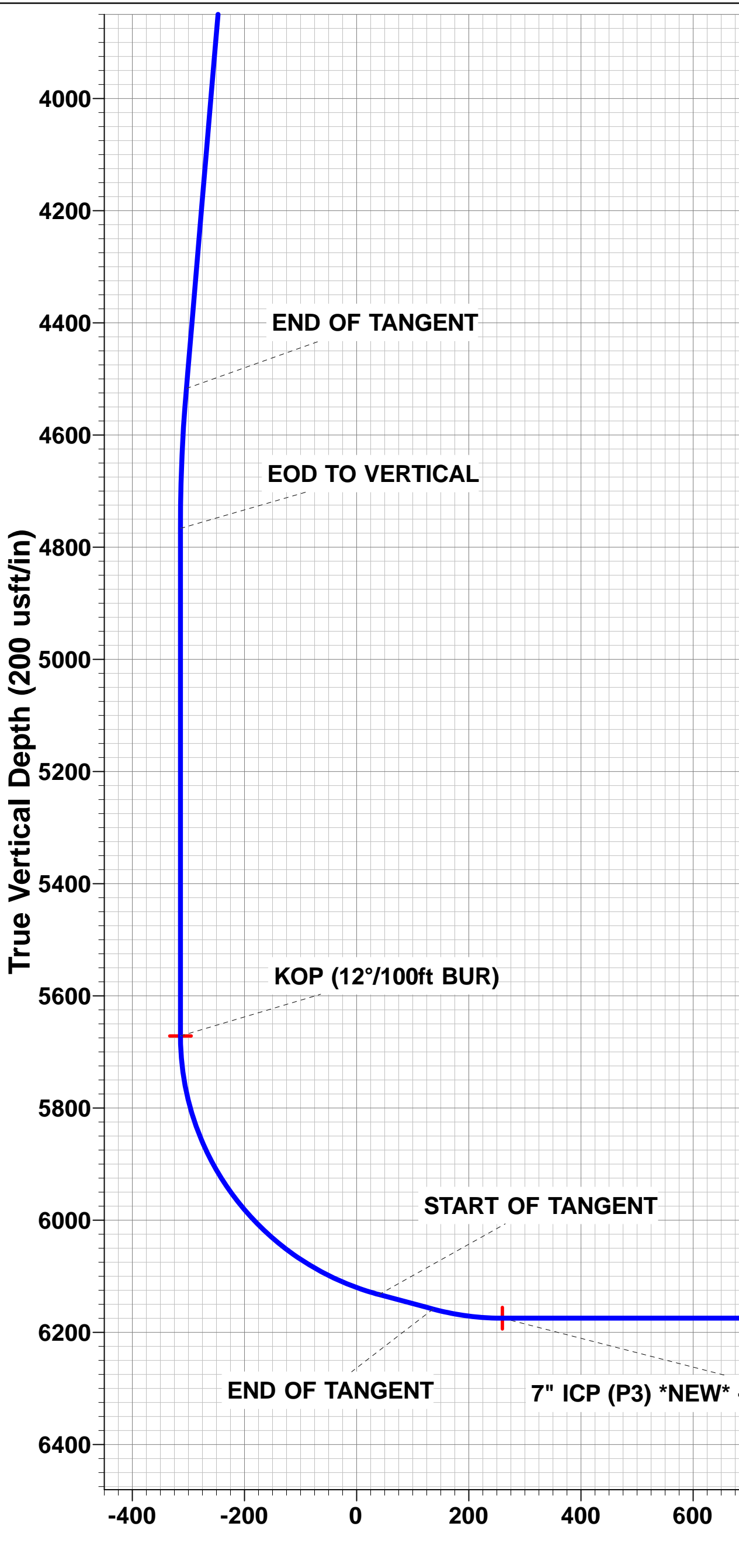
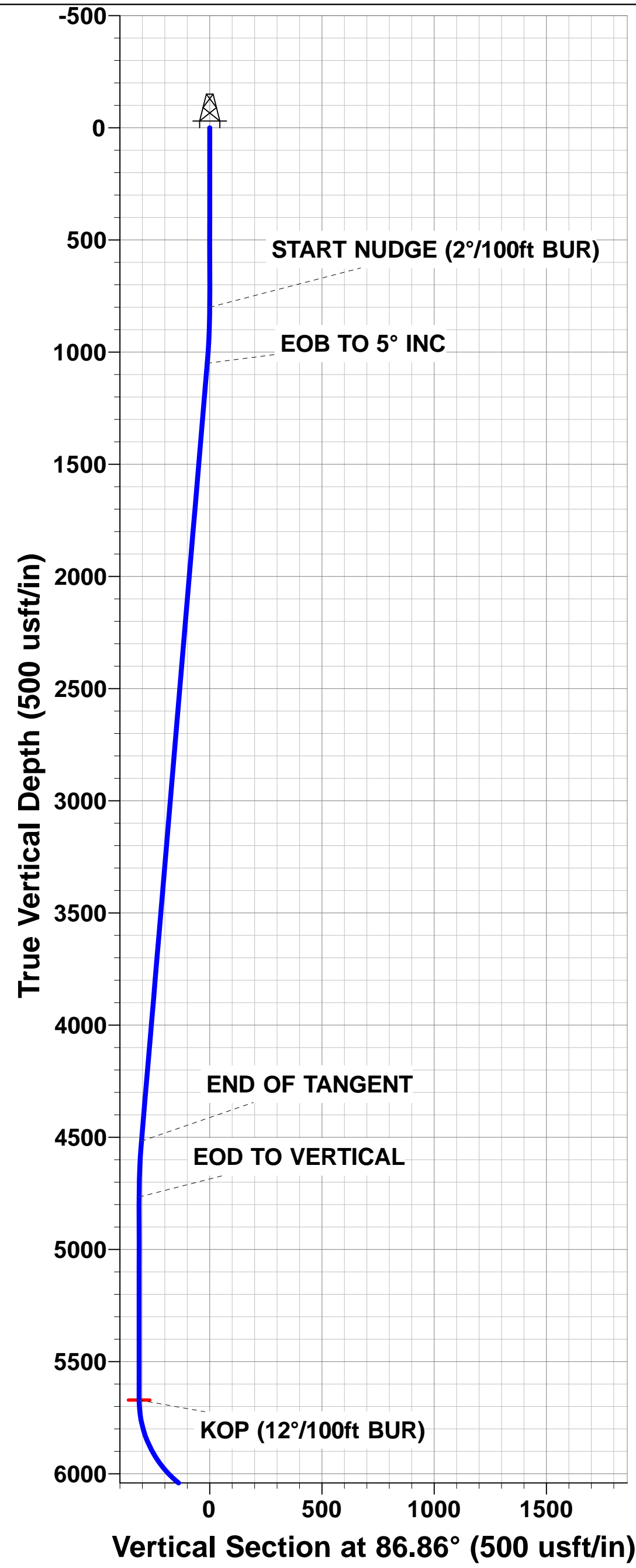
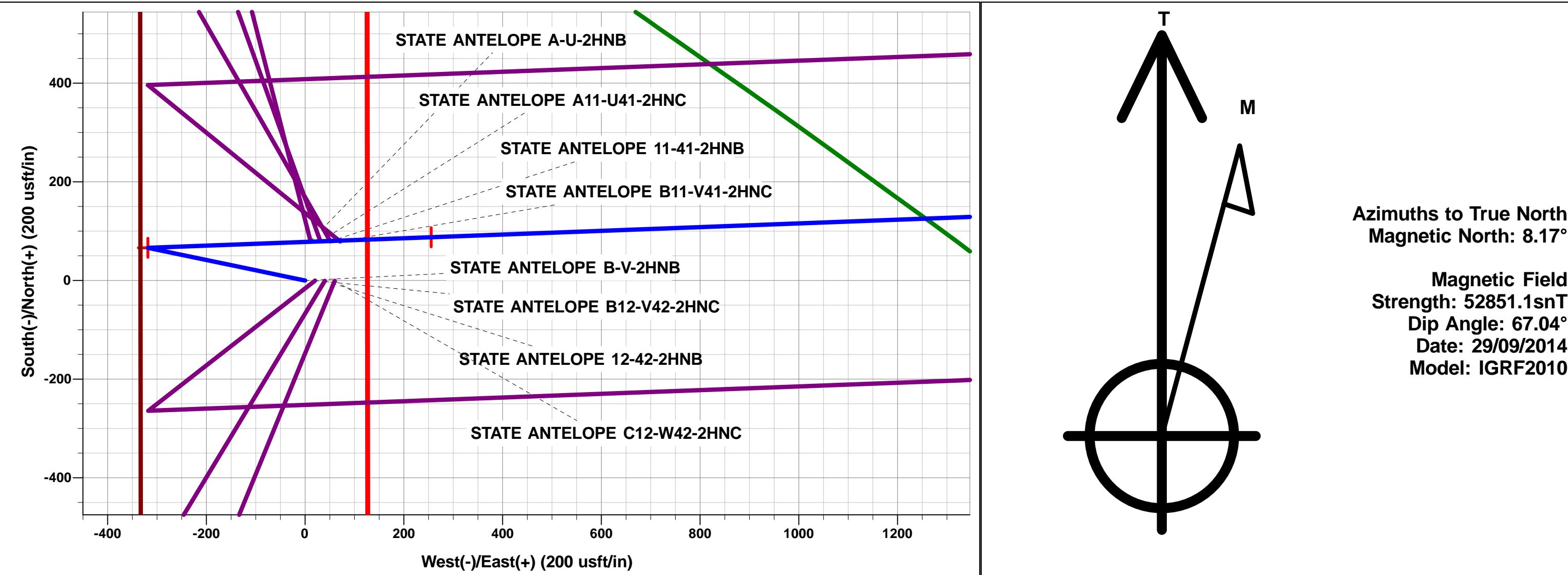

# Planning Report



<b>Database:</b>	EDM 5000.1 Single User Db	<b>Local Co-ordinate Reference:</b>	Well STATE ANTELOPE B-V-2HNB
<b>Company:</b>	BONANZA CREEK ENERGY INC.	<b>TVD Reference:</b>	KB-EST @ 4661.9usft (Original Well Elev)
<b>Project:</b>	WELD COUNTY, COLORADO (NAD 83)	<b>MD Reference:</b>	KB-EST @ 4661.9usft (Original Well Elev)
<b>Site:</b>	NW NW SEC. 2 T5N R62W 6th P.M.	<b>North Reference:</b>	True
<b>Well:</b>	STATE ANTELOPE B-V-2HNB	<b>Survey Calculation Method:</b>	Minimum Curvature
<b>Wellbore:</b>	ORIGINAL WELLBORE		
<b>Design:</b>	PROPOSAL #3		

<b>Project</b>	WELD COUNTY, COLORADO (NAD 83)		
<b>Map System:</b>	US State Plane 1983	<b>System Datum:</b>	Mean Sea Level
<b>Geo Datum:</b>	North American Datum 1983		
<b>Map Zone:</b>	Colorado Northern Zone		Using geodetic scale factor

Site		NW NW SEC. 2 T5N R62W 6th P.M.			
Site Position:		Northing:	1,402,899.64 usft	Latitude:	40.433143
From:	Lat/Long	Easting:	3,334,413.22 usft	Longitude:	-104.298655
Position Uncertainty:	0.0 usft	Slot Radius:	1.10000 ft	Grid Convergence:	0.78 °

Well	STATE ANTELOPE B-V-2HNB					
Well Position	+N-S	-79.4 usft	Northing:	1,402,819.52 usft	Latitude:	40.432925
	+E-W	-51.2 usft	Easting:	3,334,363.08 usft	Longitude:	-104.298839
Position Uncertainty		0.0 usft	Wellhead Elevation:	usft	Ground Level:	4,644.9 usft

<b>Wellbore</b>	ORIGINAL WELLBORE				
<b>Magnetics</b>	<b>Model Name</b>	<b>Sample Date</b>	<b>Declination (°)</b>	<b>Dip Angle (°)</b>	<b>Field Strength (nT)</b>
	IGRF2010	29/09/2014	8.17	67.04	52,851

<b>Design</b>	PROPOSAL #3			
<b>Audit Notes:</b>				
<b>Version:</b>	<b>Phase:</b>	PROTOTYPE	<b>Tie On Depth:</b>	0.0
<b>Vertical Section:</b>	<b>Depth From (TVD) (usft)</b>	<b>+N-S (usft)</b>	<b>+E-W (usft)</b>	<b>Direction (°)</b>
	6,174.9	0.0	0.0	86.86

<b>Plan Sections</b>											
MD (usft)	Inc (°)	Azi (°)	Vertical Depth	SS (usft)	+N-S (usft)	+E-W (usft)	Dogleg Rate (°/100usf)	Build Rate (°/100usf)	Turn Rate (°/100usf)	TFO (°)	Target
0.0	0.00	0.00	0.0	-4,661.9	0.0	0.0	0.00	0.00	0.00	0.00	
800.0	0.00	0.00	800.0	-3,861.9	0.0	0.0	0.00	0.00	0.00	0.00	
1,049.9	5.00	281.75	1,049.6	-3,612.3	2.2	-10.7	2.00	2.00	0.00	281.75	
4,530.6	5.00	281.75	4,517.0	-144.9	64.0	-307.5	0.00	0.00	0.00	0.00	
4,780.5	0.00	0.00	4,766.6	104.7	66.2	-318.2	2.00	-2.00	0.00	180.00	
5,685.5	0.00	0.00	5,671.6	1,009.7	66.2	-318.2	0.00	0.00	0.00	0.00	KOP (P3) - STATE
6,310.5	75.00	87.85	6,132.8	1,470.9	79.5	35.4	12.00	12.00	0.00	87.85	
6,410.5	75.00	87.85	6,158.7	1,496.8	83.1	132.0	0.00	0.00	0.00	0.00	
6,535.5	90.00	87.85	6,174.9	1,513.0	87.7	255.5	12.00	12.00	0.00	0.00	
10,817.3	90.00	87.85	6,174.9	1,513.0	248.5	4,534.3	0.00	0.00	0.00	-72.51	BHL (P3) - STATE

# Planning Report



<b>Database:</b>	EDM 5000.1 Single User Db	<b>Local Co-ordinate Reference:</b>	Well STATE ANTELOPE B-V-2HNB
<b>Company:</b>	BONANZA CREEK ENERGY INC.	<b>TVD Reference:</b>	KB-EST @ 4661.9usft (Original Well Elev)
<b>Project:</b>	WELD COUNTY, COLORADO (NAD 83)	<b>MD Reference:</b>	KB-EST @ 4661.9usft (Original Well Elev)
<b>Site:</b>	NW NW SEC. 2 T5N R62W 6th P.M.	<b>North Reference:</b>	True
<b>Well:</b>	STATE ANTELOPE B-V-2HNB	<b>Survey Calculation Method:</b>	Minimum Curvature
<b>Wellbore:</b>	ORIGINAL WELLBORE		
<b>Design:</b>	PROPOSAL #3		

Planned Survey										
MD (usft)	Inc (°)	Azi (°)	TVD (usft)	SS (usft)	+N/-S (usft)	+E/-W (usft)	Vertical Section (usft)	Dogleg Rate (°/100usft)	Build Rate (°/100usft)	Turn Rate (°/100usft)
0.0	0.00	0.00	0.0	4,661.90	0.0	0.0	0.0	0.00	0.00	0.00
100.0	0.00	0.00	100.0	4,561.90	0.0	0.0	0.0	0.00	0.00	0.00
200.0	0.00	0.00	200.0	4,461.90	0.0	0.0	0.0	0.00	0.00	0.00
300.0	0.00	0.00	300.0	4,361.90	0.0	0.0	0.0	0.00	0.00	0.00
400.0	0.00	0.00	400.0	4,261.90	0.0	0.0	0.0	0.00	0.00	0.00
500.0	0.00	0.00	500.0	4,161.90	0.0	0.0	0.0	0.00	0.00	0.00
600.0	0.00	0.00	600.0	4,061.90	0.0	0.0	0.0	0.00	0.00	0.00
700.0	0.00	0.00	700.0	3,961.90	0.0	0.0	0.0	0.00	0.00	0.00
START NUDGE (2°/100ft BUR)										
800.0	0.00	0.00	800.0	3,861.90	0.0	0.0	0.0	0.00	0.00	0.00
900.0	2.00	281.75	900.0	3,761.92	0.4	-1.7	-1.7	2.00	2.00	0.00
1,000.0	4.00	281.75	999.8	3,662.06	1.4	-6.8	-6.7	2.00	2.00	0.00
EOB TO 5° INC										
1,049.9	5.00	281.75	1,049.6	3,612.32	2.2	-10.7	-10.5	2.00	2.00	0.00
1,100.0	5.00	281.75	1,099.5	3,562.41	3.1	-14.9	-14.7	0.00	0.00	0.00
1,200.0	5.00	281.75	1,199.1	3,462.79	4.9	-23.5	-23.2	0.00	0.00	0.00
1,300.0	5.00	281.75	1,298.7	3,363.17	6.7	-32.0	-31.6	0.00	0.00	0.00
1,400.0	5.00	281.75	1,398.4	3,263.55	8.4	-40.5	-40.0	0.00	0.00	0.00
1,500.0	5.00	281.75	1,498.0	3,163.93	10.2	-49.1	-48.4	0.00	0.00	0.00
1,600.0	5.00	281.75	1,597.6	3,064.31	12.0	-57.6	-56.8	0.00	0.00	0.00
1,700.0	5.00	281.75	1,697.2	2,964.69	13.8	-66.1	-65.3	0.00	0.00	0.00
1,800.0	5.00	281.75	1,796.8	2,865.07	15.5	-74.6	-73.7	0.00	0.00	0.00
1,900.0	5.00	281.75	1,896.5	2,765.45	17.3	-83.2	-82.1	0.00	0.00	0.00
2,000.0	5.00	281.75	1,996.1	2,665.83	19.1	-91.7	-90.5	0.00	0.00	0.00
2,100.0	5.00	281.75	2,095.7	2,566.21	20.9	-100.2	-98.9	0.00	0.00	0.00
2,200.0	5.00	281.75	2,195.3	2,466.59	22.6	-108.8	-107.4	0.00	0.00	0.00
2,300.0	5.00	281.75	2,294.9	2,366.97	24.4	-117.3	-115.8	0.00	0.00	0.00
2,400.0	5.00	281.75	2,394.6	2,267.35	26.2	-125.8	-124.2	0.00	0.00	0.00
2,500.0	5.00	281.75	2,494.2	2,167.73	27.9	-134.3	-132.6	0.00	0.00	0.00
2,600.0	5.00	281.75	2,593.8	2,068.11	29.7	-142.9	-141.0	0.00	0.00	0.00
2,700.0	5.00	281.75	2,693.4	1,968.49	31.5	-151.4	-149.5	0.00	0.00	0.00
2,800.0	5.00	281.75	2,793.0	1,868.87	33.3	-159.9	-157.9	0.00	0.00	0.00
2,900.0	5.00	281.75	2,892.6	1,769.25	35.0	-168.5	-166.3	0.00	0.00	0.00
3,000.0	5.00	281.75	2,992.3	1,669.63	36.8	-177.0	-174.7	0.00	0.00	0.00
3,100.0	5.00	281.75	3,091.9	1,570.01	38.6	-185.5	-183.1	0.00	0.00	0.00
3,200.0	5.00	281.75	3,191.5	1,470.39	40.4	-194.0	-191.5	0.00	0.00	0.00
3,300.0	5.00	281.75	3,291.1	1,370.77	42.1	-202.6	-200.0	0.00	0.00	0.00
3,400.0	5.00	281.75	3,390.7	1,271.15	43.9	-211.1	-208.4	0.00	0.00	0.00
3,500.0	5.00	281.75	3,490.4	1,171.53	45.7	-219.6	-216.8	0.00	0.00	0.00
3,600.0	5.00	281.75	3,590.0	1,071.91	47.5	-228.2	-225.2	0.00	0.00	0.00
3,700.0	5.00	281.75	3,689.6	972.29	49.2	-236.7	-233.6	0.00	0.00	0.00
3,800.0	5.00	281.75	3,789.2	872.67	51.0	-245.2	-242.1	0.00	0.00	0.00
3,900.0	5.00	281.75	3,888.8	773.05	52.8	-253.8	-250.5	0.00	0.00	0.00
4,000.0	5.00	281.75	3,988.5	673.43	54.6	-262.3	-258.9	0.00	0.00	0.00
4,100.0	5.00	281.75	4,088.1	573.81	56.3	-270.8	-267.3	0.00	0.00	0.00
4,200.0	5.00	281.75	4,187.7	474.19	58.1	-279.3	-275.7	0.00	0.00	0.00
4,300.0	5.00	281.75	4,287.3	374.57	59.9	-287.9	-284.2	0.00	0.00	0.00
4,400.0	5.00	281.75	4,386.9	274.95	61.7	-296.4	-292.6	0.00	0.00	0.00
4,500.0	5.00	281.75	4,486.6	175.33	63.4	-304.9	-301.0	0.00	0.00	0.00
END OF TANGENT										
4,530.6	5.00	281.75	4,517.0	144.85	64.0	-307.5	-303.6	0.00	0.00	0.00
4,600.0	3.61	281.75	4,586.3	75.65	65.0	-312.6	-308.6	2.00	-2.00	0.00
4,700.0	1.61	281.75	4,686.1	-24.24	66.0	-317.1	-313.0	2.00	-2.00	0.00

# Planning Report



<b>Database:</b>	EDM 5000.1 Single User Db	<b>Local Co-ordinate Reference:</b>	Well STATE ANTELOPE B-V-2HNB
<b>Company:</b>	BONANZA CREEK ENERGY INC.	<b>TVD Reference:</b>	KB-EST @ 4661.9usft (Original Well Elev)
<b>Project:</b>	WELD COUNTY, COLORADO (NAD 83)	<b>MD Reference:</b>	KB-EST @ 4661.9usft (Original Well Elev)
<b>Site:</b>	NW NW SEC. 2 T5N R62W 6th P.M.	<b>North Reference:</b>	True
<b>Well:</b>	STATE ANTELOPE B-V-2HNB	<b>Survey Calculation Method:</b>	Minimum Curvature
<b>Wellbore:</b>	ORIGINAL WELLBORE		
<b>Design:</b>	PROPOSAL #3		

## Planned Survey

MD (usft)	Inc (°)	Azi (°)	TVD (usft)	SS (usft)	+N/-S (usft)	+E/-W (usft)	Vertical Section (usft)	Dogleg Rate (°/100usft)	Build Rate (°/100usft)	Turn Rate (°/100usft)
<b>EOD TO VERTICAL</b>										
4,780.5	0.00	0.00	4,766.6	-104.73	66.2	-318.2	-314.1	2.00	-2.00	0.00
4,800.0	0.00	0.00	4,786.1	-124.23	66.2	-318.2	-314.1	0.00	0.00	0.00
4,900.0	0.00	0.00	4,886.1	-224.23	66.2	-318.2	-314.1	0.00	0.00	0.00
5,000.0	0.00	0.00	4,986.1	-324.23	66.2	-318.2	-314.1	0.00	0.00	0.00
5,100.0	0.00	0.00	5,086.1	-424.23	66.2	-318.2	-314.1	0.00	0.00	0.00
5,200.0	0.00	0.00	5,186.1	-524.23	66.2	-318.2	-314.1	0.00	0.00	0.00
5,300.0	0.00	0.00	5,286.1	-624.23	66.2	-318.2	-314.1	0.00	0.00	0.00
5,400.0	0.00	0.00	5,386.1	-724.23	66.2	-318.2	-314.1	0.00	0.00	0.00
5,500.0	0.00	0.00	5,486.1	-824.23	66.2	-318.2	-314.1	0.00	0.00	0.00
5,600.0	0.00	0.00	5,586.1	-924.23	66.2	-318.2	-314.1	0.00	0.00	0.00
<b>KOP (12°/100ft BUR)</b>										
5,685.5	0.00	0.00	5,671.6	-1,009.73	66.2	-318.2	-314.1	0.00	0.00	0.00
5,700.0	1.74	87.85	5,686.1	-1,024.23	66.2	-318.0	-313.9	12.03	12.03	0.00
5,800.0	13.74	87.85	5,785.0	-1,123.14	66.7	-304.5	-300.4	12.00	12.00	0.00
5,900.0	25.74	87.85	5,879.0	-1,217.09	68.0	-270.8	-266.7	12.00	12.00	0.00
6,000.0	37.74	87.85	5,963.9	-1,301.97	69.9	-218.4	-214.2	12.00	12.00	0.00
6,100.0	49.74	87.85	6,036.0	-1,374.08	72.5	-149.4	-145.2	12.00	12.00	0.00
6,200.0	61.74	87.85	6,092.2	-1,430.27	75.6	-67.0	-62.7	12.00	12.00	0.00
6,300.0	73.74	87.85	6,130.0	-1,468.08	79.1	25.4	29.7	12.00	12.00	0.00
<b>START OF TANGENT</b>										
6,310.5	75.00	87.85	6,132.8	-1,470.90	79.5	35.5	39.8	11.96	11.96	0.00
6,400.0	75.00	87.85	6,156.0	-1,494.07	82.7	121.9	126.2	0.00	0.00	0.00
<b>END OF TANGENT</b>										
6,410.5	75.00	87.85	6,158.7	-1,496.79	83.1	132.0	136.3	0.00	0.00	0.00
6,500.0	85.74	87.85	6,173.6	-1,511.73	86.4	220.0	224.4	12.00	12.00	0.00
<b>7" ICP (P3) *NEW* - STATE ANTELOPE B-V-2HNB</b>										
6,535.5	90.00	87.85	6,174.9	-1,513.05	87.7	255.5	259.9	11.99	11.99	0.00
6,600.0	90.00	87.85	6,174.9	-1,513.05	90.2	319.9	324.4	0.00	0.00	0.00
6,700.0	90.00	87.85	6,174.9	-1,513.05	93.9	419.9	424.4	0.00	0.00	0.00
6,800.0	90.00	87.85	6,174.9	-1,513.05	97.7	519.8	524.4	0.00	0.00	0.00
6,900.0	90.00	87.85	6,174.9	-1,513.05	101.4	619.7	624.4	0.00	0.00	0.00
7,000.0	90.00	87.85	6,174.9	-1,513.05	105.2	719.7	724.3	0.00	0.00	0.00
7,100.0	90.00	87.85	6,174.9	-1,513.05	108.9	819.6	824.3	0.00	0.00	0.00
7,200.0	90.00	87.85	6,174.9	-1,513.05	112.7	919.5	924.3	0.00	0.00	0.00
7,300.0	90.00	87.85	6,174.9	-1,513.05	116.4	1,019.4	1,024.3	0.00	0.00	0.00
7,400.0	90.00	87.85	6,174.9	-1,513.04	120.2	1,119.4	1,124.3	0.00	0.00	0.00
7,500.0	90.00	87.85	6,174.9	-1,513.04	123.9	1,219.3	1,224.3	0.00	0.00	0.00
7,600.0	90.00	87.85	6,174.9	-1,513.04	127.7	1,319.2	1,324.2	0.00	0.00	0.00
7,700.0	90.00	87.85	6,174.9	-1,513.04	131.4	1,419.2	1,424.2	0.00	0.00	0.00
7,800.0	90.00	87.85	6,174.9	-1,513.04	135.2	1,519.1	1,524.2	0.00	0.00	0.00
7,900.0	90.00	87.85	6,174.9	-1,513.04	138.9	1,619.0	1,624.2	0.00	0.00	0.00
8,000.0	90.00	87.85	6,174.9	-1,513.04	142.7	1,719.0	1,724.2	0.00	0.00	0.00
8,100.0	90.00	87.85	6,174.9	-1,513.04	146.5	1,818.9	1,824.2	0.00	0.00	0.00
8,200.0	90.00	87.85	6,174.9	-1,513.04	150.2	1,918.8	1,924.2	0.00	0.00	0.00
8,300.0	90.00	87.85	6,174.9	-1,513.04	154.0	2,018.7	2,024.1	0.00	0.00	0.00
8,400.0	90.00	87.85	6,174.9	-1,513.04	157.7	2,118.7	2,124.1	0.00	0.00	0.00
8,500.0	90.00	87.85	6,174.9	-1,513.04	161.5	2,218.6	2,224.1	0.00	0.00	0.00
8,600.0	90.00	87.85	6,174.9	-1,513.04	165.2	2,318.5	2,324.1	0.00	0.00	0.00
8,700.0	90.00	87.85	6,174.9	-1,513.03	169.0	2,418.5	2,424.1	0.00	0.00	0.00
8,800.0	90.00	87.85	6,174.9	-1,513.03	172.7	2,518.4	2,524.1	0.00	0.00	0.00
8,900.0	90.00	87.85	6,174.9	-1,513.03	176.5	2,618.3	2,624.1	0.00	0.00	0.00
9,000.0	90.00	87.85	6,174.9	-1,513.03	180.2	2,718.2	2,724.0	0.00	0.00	0.00
9,100.0	90.00	87.85	6,174.9	-1,513.03	184.0	2,818.2	2,824.0	0.00	0.00	0.00



# Planning Report



<b>Database:</b>	EDM 5000.1 Single User Db	<b>Local Co-ordinate Reference:</b>	Well STATE ANTELOPE B-V-2HNB
<b>Company:</b>	BONANZA CREEK ENERGY INC.	<b>TVD Reference:</b>	KB-EST @ 4661.9usft (Original Well Elev)
<b>Project:</b>	WELD COUNTY, COLORADO (NAD 83)	<b>MD Reference:</b>	KB-EST @ 4661.9usft (Original Well Elev)
<b>Site:</b>	NW NW SEC. 2 T5N R62W 6th P.M.	<b>North Reference:</b>	True
<b>Well:</b>	STATE ANTELOPE B-V-2HNB	<b>Survey Calculation Method:</b>	Minimum Curvature
<b>Wellbore:</b>	ORIGINAL WELLBORE		
<b>Design:</b>	PROPOSAL #3		

Planned Survey										
MD (usft)	Inc (°)	Azi (°)	TVD (usft)	SS (usft)	+N/-S (usft)	+E/-W (usft)	Vertical Section (usft)	Dogleg Rate (°/100usft)	Build Rate (°/100usft)	Turn Rate (°/100usft)
9,200.0	90.00	87.85	6,174.9	-1,513.03	187.8	2,918.1	2,924.0	0.00	0.00	0.00
9,300.0	90.00	87.85	6,174.9	-1,513.03	191.5	3,018.0	3,024.0	0.00	0.00	0.00
9,400.0	90.00	87.85	6,174.9	-1,513.03	195.3	3,118.0	3,124.0	0.00	0.00	0.00
9,500.0	90.00	87.85	6,174.9	-1,513.02	199.0	3,217.9	3,224.0	0.00	0.00	0.00
9,600.0	90.00	87.85	6,174.9	-1,513.02	202.8	3,317.8	3,324.0	0.00	0.00	0.00
9,700.0	90.00	87.85	6,174.9	-1,513.02	206.5	3,417.8	3,423.9	0.00	0.00	0.00
9,800.0	90.00	87.85	6,174.9	-1,513.02	210.3	3,517.7	3,523.9	0.00	0.00	0.00
9,900.0	90.00	87.85	6,174.9	-1,513.02	214.1	3,617.6	3,623.9	0.00	0.00	0.00
10,000.0	90.00	87.85	6,174.9	-1,513.02	217.8	3,717.5	3,723.9	0.00	0.00	0.00
10,100.0	90.00	87.85	6,174.9	-1,513.01	221.6	3,817.5	3,823.9	0.00	0.00	0.00
10,200.0	90.00	87.85	6,174.9	-1,513.01	225.3	3,917.4	3,923.9	0.00	0.00	0.00
10,300.0	90.00	87.85	6,174.9	-1,513.01	229.1	4,017.3	4,023.8	0.00	0.00	0.00
10,400.0	90.00	87.85	6,174.9	-1,513.01	232.8	4,117.3	4,123.8	0.00	0.00	0.00
10,500.0	90.00	87.85	6,174.9	-1,513.01	236.6	4,217.2	4,223.8	0.00	0.00	0.00
10,600.0	90.00	87.85	6,174.9	-1,513.00	240.4	4,317.1	4,323.8	0.00	0.00	0.00
10,700.0	90.00	87.85	6,174.9	-1,513.00	244.1	4,417.0	4,423.8	0.00	0.00	0.00
10,800.0	90.00	87.85	6,174.9	-1,513.00	247.9	4,517.0	4,523.8	0.00	0.00	0.00
<b>BHL (P3) - STATE ANTELOPE B-V-2HNB</b>										
<b>10,817.3</b>	<b>90.00</b>	<b>87.85</b>	<b>6,174.9</b>	<b>-1,513.00</b>	<b>248.5</b>	<b>4,534.3</b>	<b>4,541.1</b>	<b>0.00</b>	<b>0.00</b>	<b>0.00</b>

Plan Annotations					
MD (usft)	TVD (usft)	Local Coordinates		Comment	
		+N/-S (usft)	+E/-W (usft)		
800.0	800.0	0.0	0.0	START NUDGE (2°/100ft BUR)	
1,049.9	1,049.6	2.2	-10.7	EOB TO 5° INC	
4,530.6	4,517.0	64.0	-307.5	END OF TANGENT	
4,780.5	4,766.6	66.2	-318.2	EOD TO VERTICAL	
5,685.5	5,671.6	66.2	-318.2	KOP (12°/100ft BUR)	
6,310.5	6,132.8	79.5	35.5	START OF TANGENT	
6,410.5	6,158.7	83.1	132.0	END OF TANGENT	
6,535.5	6,174.9	87.7	255.5	7" ICP (P3) *NEW* - STATE ANTELOPE B-V-2HNB	
10,817.3	6,174.9	248.5	4,534.3	BHL (P3) - STATE ANTELOPE B-V-2HNB	