

KERR-MCGEE OIL & GAS ONSHORE LP

Location: COLORADO Slot: SLOT#12 BURKHARDT 16C-3HZ (420'FNL & 1890'FEL, SEC.03)
 Field: WELD COUNTY (KERR MCGEE) Well: BURKHARDT 16C-3HZ
 Facility: SEC.03-T1N-R66W Wellbore: BURKHARDT 16C-3HZ PWB

Plot reference wellpath is BURKHARDT 16C-3HZ (REV-A.1) PWP

True vertical depths are referenced to XTREME 6 (16KB) (RKB)	Grid System: NAD83 / Lambert Colorado SP, Northern Zone (501), US feet
Measured depths are referenced to XTREME 6 (16KB) (RKB)	North Reference: True north
XTREME 6 (16KB) (RKB) to Mean Sea Level: 5076 feet	Scale: True distance
Mean Sea Level to Mud line (At Slot: SLOT#12 BURKHARDT 16C-3HZ (420'FNL & 1890'FEL, SEC.03)): 0 feet	Depths are in feet
Coordinates are in feet referenced to Slot	Created by: amarcas on 10/13/2014

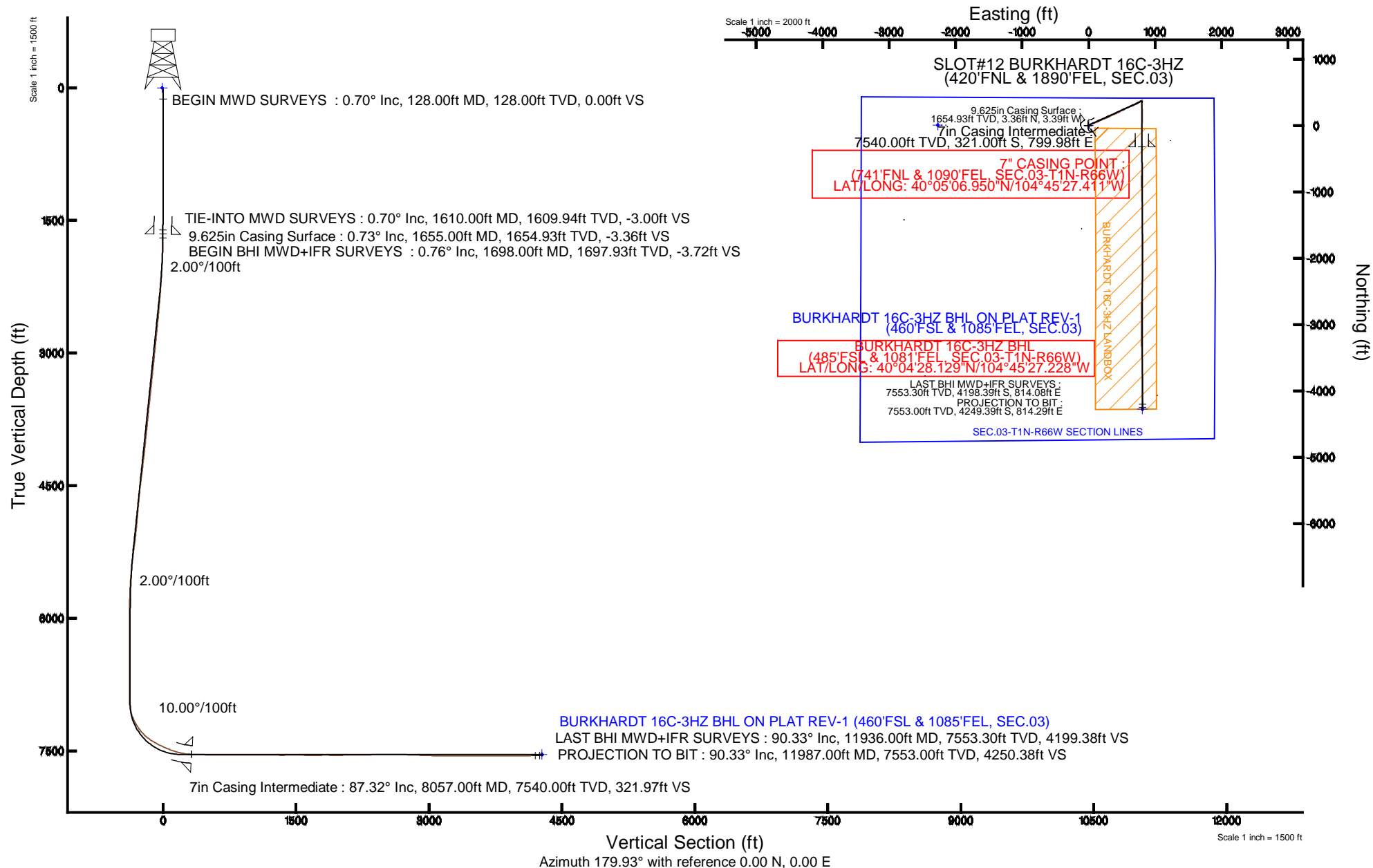

REFERENCE WELLPATH IDENTIFICATION

Operator	KERR-MCGEE OIL & GAS ONSHORE LP	Slot	SLOT#12 BURKHARDT 16C-3HZ (420'FNL & 1890'FEL, SEC.03)
Area	COLORADO	Well	BURKHARDT 16C-3HZ
Field	WELD COUNTY (KERR MCGEE)	Wellbore	BURKHARDT 16C-3HZ AWB
Facility	SEC.03-T1N-R66W		

REPORT SETUP INFORMATION

Projection System	NAD83 / Lambert Colorado SP, Northern Zone (501), US feet	Software System	WellArchitect® 4.0.0
North Reference	True	User	Amarcar
Scale	0.999961	Report Generated	10/13/2014 at 12:53:21 PM
Convergence at slot	n/a	Database/Source file	WellArchitectDB/BURKHARDT_16C-3HZ_AWB.xml

WELLPATH LOCATION

	Local coordinates		Grid coordinates		Geographic coordinates	
	North[ft]	East[ft]	Easting[US ft]	Northing[US ft]	Latitude	Longitude
Slot Location	-8.09	2269.81	3206917.02	1275090.17	40°05'10.122"N	104°45'37.703"W
Facility Reference Pt			3204647.32	1275079.54	40°05'10.203"N	104°46'06.906"W
Field Reference Pt			3197771.84	1268891.29	40°04'09.600"N	104°47'36.000"W

WELLPATH DATUM

Calculation method	Minimum curvature	XTREME 6 (16'KB) (RKB) to Facility Vertical Datum	5076.00ft
Horizontal Reference Pt	Slot	XTREME 6 (16'KB) (RKB) to Mean Sea Level	5076.00ft
Vertical Reference Pt	XTREME 6 (16'KB) (RKB)	XTREME 6 (16'KB) (RKB) to Mud Line at Slot (SLOT#12 BURKHARDT 16C-3HZ (420'FNL & 1890'FEL, SEC.03))	5076.00ft
MD Reference Pt	XTREME 6 (16'KB) (RKB)	Section Origin	N 0.00, E 0.00 ft
Field Vertical Reference	Mean Sea Level	Section Azimuth	179.93°

Actual Wellpath Report

BURKHARDT 16C-3HZ AWP

Page 2 of 6

REFERENCE WELLPATH IDENTIFICATION

Operator	KERR-MCGEE OIL & GAS ONSHORE LP	Slot	SLOT#12 BURKHARDT 16C-3HZ (420'FNL & 1890'FEL, SEC.03)
Area	COLORADO	Well	BURKHARDT 16C-3HZ
Field	WELD COUNTY (KERR MCGEE)	Wellbore	BURKHARDT 16C-3HZ AWB
Facility	SEC.03-T1N-R66W		

WELLPATH DATA (134 stations) † = interpolated/extrapolated station

MD [ft]	Inclination [°]	Azimuth [°]	TVD [ft]	Vert Sect [ft]	North [ft]	East [ft]	Latitude	Longitude	DLS [°/100ft]	Comments
0.00†	0.000	269.900	0.00	0.00	0.00	0.00	40°05'10.122"N	104°45'37.703"W	0.00	
16.00	0.000	269.900	16.00	0.00	0.00	0.00	40°05'10.122"N	104°45'37.703"W	0.00	
128.00	0.700	269.900	128.00	0.00	0.00	-0.68	40°05'10.122"N	104°45'37.712"W	0.63	BEGIN MWD SURVEYS
207.00	1.000	267.200	206.99	0.03	-0.04	-1.86	40°05'10.122"N	104°45'37.727"W	0.38	
284.00	0.500	278.400	283.98	0.02	-0.02	-2.86	40°05'10.122"N	104°45'37.740"W	0.67	
364.00	0.400	207.500	363.98	0.21	-0.22	-3.33	40°05'10.120"N	104°45'37.746"W	0.66	
444.00	0.500	207.100	443.98	0.77	-0.77	-3.62	40°05'10.114"N	104°45'37.750"W	0.13	
524.00	0.500	299.200	523.98	0.91	-0.92	-4.08	40°05'10.113"N	104°45'37.756"W	0.90	
604.00	0.700	276.000	603.97	0.69	-0.69	-4.88	40°05'10.115"N	104°45'37.766"W	0.39	
684.00	0.100	244.700	683.97	0.67	-0.67	-5.42	40°05'10.115"N	104°45'37.773"W	0.77	
764.00	0.500	253.700	763.97	0.79	-0.80	-5.82	40°05'10.114"N	104°45'37.778"W	0.50	
844.00	0.400	336.200	843.97	0.64	-0.64	-6.27	40°05'10.116"N	104°45'37.784"W	0.75	
924.00	0.400	258.600	923.96	0.43	-0.44	-6.66	40°05'10.118"N	104°45'37.789"W	0.63	
1004.00	0.400	293.200	1003.96	0.38	-0.39	-7.19	40°05'10.118"N	104°45'37.795"W	0.30	
1084.00	0.200	10.700	1083.96	0.13	-0.14	-7.42	40°05'10.121"N	104°45'37.798"W	0.51	
1164.00	0.700	68.000	1163.96	-0.19	0.18	-6.94	40°05'10.124"N	104°45'37.792"W	0.77	
1244.00	0.400	78.900	1243.96	-0.42	0.42	-6.21	40°05'10.126"N	104°45'37.783"W	0.40	
1324.00	0.400	21.900	1323.95	-0.74	0.73	-5.83	40°05'10.129"N	104°45'37.778"W	0.48	
1404.00	0.700	23.800	1403.95	-1.44	1.44	-5.53	40°05'10.136"N	104°45'37.774"W	0.38	
1484.00	0.600	59.900	1483.94	-2.10	2.09	-4.97	40°05'10.143"N	104°45'37.767"W	0.52	
1564.00	0.700	47.700	1563.94	-2.64	2.63	-4.25	40°05'10.148"N	104°45'37.758"W	0.21	
1610.00	0.700	50.900	1609.94	-3.00	3.00	-3.82	40°05'10.152"N	104°45'37.752"W	0.08	TIE-INTO MWD SURVEYS
1698.00	0.760	49.010	1697.93	-3.72	3.72	-2.97	40°05'10.159"N	104°45'37.741"W	0.07	BEGIN BHI MWD+IFR SURVEYS
1790.00	2.820	70.620	1789.88	-4.87	4.87	-0.37	40°05'10.170"N	104°45'37.708"W	2.32	
1881.00	4.270	51.130	1880.71	-7.74	7.74	4.38	40°05'10.198"N	104°45'37.647"W	2.05	
1971.00	5.040	67.530	1970.41	-11.34	11.35	10.64	40°05'10.234"N	104°45'37.566"W	1.70	
2063.00	7.260	62.530	2061.88	-15.56	15.58	19.54	40°05'10.276"N	104°45'37.452"W	2.48	
2154.00	8.910	66.280	2151.97	-21.03	21.07	31.09	40°05'10.330"N	104°45'37.303"W	1.90	
2244.00	11.020	69.000	2240.61	-26.90	26.96	45.50	40°05'10.388"N	104°45'37.118"W	2.40	
2336.00	12.750	71.260	2330.63	-33.29	33.37	63.33	40°05'10.452"N	104°45'36.888"W	1.95	
2426.00	14.720	69.770	2418.06	-40.41	40.51	83.46	40°05'10.522"N	104°45'36.629"W	2.22	
2517.00	14.340	69.010	2506.15	-48.42	48.55	104.83	40°05'10.602"N	104°45'36.354"W	0.47	
2609.00	13.770	67.890	2595.39	-56.60	56.75	125.61	40°05'10.683"N	104°45'36.087"W	0.69	
2785.00	14.760	67.260	2765.96	-73.10	73.30	165.70	40°05'10.846"N	104°45'35.571"W	0.57	
2955.00	13.150	64.450	2930.94	-89.77	90.01	203.12	40°05'11.012"N	104°45'35.090"W	1.03	
3126.00	15.300	68.300	3096.69	-106.45	106.75	241.64	40°05'11.177"N	104°45'34.594"W	1.37	
3296.00	14.430	65.630	3261.00	-123.44	123.78	281.77	40°05'11.345"N	104°45'34.078"W	0.65	
3467.00	13.120	63.590	3427.08	-140.82	141.21	318.56	40°05'11.517"N	104°45'33.604"W	0.82	
3637.00	13.880	64.220	3592.38	-158.22	158.66	354.21	40°05'11.690"N	104°45'33.146"W	0.46	
3807.00	15.020	68.520	3757.01	-175.11	175.59	393.07	40°05'11.857"N	104°45'32.646"W	0.92	
3979.00	12.540	63.210	3924.05	-191.65	192.17	430.48	40°05'12.021"N	104°45'32.164"W	1.62	
4147.00	13.200	62.510	4087.83	-208.68	209.25	463.78	40°05'12.190"N	104°45'31.736"W	0.40	
4317.00	14.810	63.560	4252.77	-227.27	227.88	500.46	40°05'12.374"N	104°45'31.264"W	0.96	
4488.00	16.000	63.790	4417.63	-247.36	248.02	541.17	40°05'12.573"N	104°45'30.740"W	0.70	
4658.00	12.710	61.390	4582.30	-266.62	267.33	578.62	40°05'12.764"N	104°45'30.259"W	1.97	

Actual Wellpath Report

BURKHARDT 16C-3HZ AWP

Page 3 of 6

REFERENCE WELLPATH IDENTIFICATION

Operator	KERR-MCGEE OIL & GAS ONSHORE LP	Slot	SLOT#12 BURKHARDT 16C-3HZ (420'FNL & 1890'FEL, SEC.03)
Area	COLORADO	Well	BURKHARDT 16C-3HZ
Field	WELD COUNTY (KERR MCGEE)	Wellbore	BURKHARDT 16C-3HZ AWP
Facility	SEC.03-T1N-R66W		

WELLPATH DATA (134 stations) † = interpolated/extrapolated station

MD [ft]	Inclination [°]	Azimuth [°]	TVD [ft]	Vert Sect [ft]	North [ft]	East [ft]	Latitude	Longitude	DLS [°/100ft]	Comments
4828.00	12.990	69.230	4748.05	-282.31	283.06	612.90	40°05'12.919"N	104°45'29.817"W	1.04	
4998.00	14.930	70.960	4913.02	-296.19	296.98	651.47	40°05'13.057"N	104°45'29.321"W	1.17	
5169.00	15.340	63.240	5078.11	-313.51	314.36	692.50	40°05'13.228"N	104°45'28.793"W	1.20	
5339.00	13.370	58.150	5242.80	-333.96	334.86	729.28	40°05'13.431"N	104°45'28.320"W	1.38	
5424.00	12.760	54.750	5325.60	-344.55	345.46	745.29	40°05'13.536"N	104°45'28.114"W	1.15	
5509.00	10.400	58.580	5408.87	-353.95	354.88	759.51	40°05'13.629"N	104°45'27.931"W	2.92	
5594.00	9.260	59.010	5492.62	-361.46	362.40	771.92	40°05'13.703"N	104°45'27.772"W	1.34	
5679.00	7.250	63.320	5576.33	-367.37	368.33	782.57	40°05'13.762"N	104°45'27.634"W	2.47	
5764.00	6.150	59.980	5661.15	-372.05	373.02	791.31	40°05'13.808"N	104°45'27.522"W	1.37	
5848.00	4.920	65.070	5744.76	-375.81	376.79	798.47	40°05'13.845"N	104°45'27.430"W	1.58	
5933.00	2.440	84.070	5829.58	-377.53	378.51	803.58	40°05'13.862"N	104°45'27.364"W	3.21	
6018.00	0.130	163.560	5914.55	-377.62	378.60	805.40	40°05'13.863"N	104°45'27.341"W	2.85	
6103.00	0.290	64.770	5999.55	-377.62	378.60	805.62	40°05'13.863"N	104°45'27.338"W	0.39	
6442.00	0.500	336.720	6338.55	-379.34	380.33	805.82	40°05'13.880"N	104°45'27.335"W	0.17	
6698.00	0.660	144.400	6594.54	-379.17	380.15	806.23	40°05'13.879"N	104°45'27.330"W	0.45	
6952.00	0.150	340.880	6848.54	-378.29	379.28	806.98	40°05'13.870"N	104°45'27.320"W	0.32	
7037.00	0.150	358.040	6933.54	-378.51	379.50	806.94	40°05'13.872"N	104°45'27.321"W	0.05	
7079.00	4.120	174.230	6975.50	-377.06	378.05	807.09	40°05'13.858"N	104°45'27.319"W	10.17	
7122.00	8.880	181.310	7018.21	-372.20	373.19	807.16	40°05'13.810"N	104°45'27.318"W	11.20	
7165.00	13.390	186.060	7060.39	-363.93	364.92	806.56	40°05'13.728"N	104°45'27.326"W	10.69	
7207.00	19.090	184.540	7100.70	-352.24	353.22	805.50	40°05'13.612"N	104°45'27.339"W	13.61	
7250.00	25.400	184.320	7140.48	-336.02	337.00	804.25	40°05'13.452"N	104°45'27.355"W	14.68	
7293.00	28.350	180.170	7178.84	-316.61	317.59	803.53	40°05'13.260"N	104°45'27.365"W	8.13	
7335.00	32.160	178.920	7215.11	-295.45	296.44	803.71	40°05'13.051"N	104°45'27.363"W	9.19	
7378.00	35.150	176.640	7250.90	-271.65	272.63	804.65	40°05'12.816"N	104°45'27.350"W	7.55	
7420.00	40.060	178.080	7284.16	-246.05	247.04	805.81	40°05'12.563"N	104°45'27.335"W	11.88	
7463.00	45.040	178.830	7315.83	-216.99	217.98	806.59	40°05'12.276"N	104°45'27.326"W	11.64	
7506.00	50.870	179.710	7344.62	-185.08	186.06	806.98	40°05'11.961"N	104°45'27.320"W	13.64	
7548.00	55.180	179.710	7369.87	-151.53	152.52	807.15	40°05'11.629"N	104°45'27.318"W	10.26	
7591.00	59.780	180.240	7392.98	-115.28	116.27	807.16	40°05'11.271"N	104°45'27.318"W	10.75	
7633.00	61.280	181.510	7413.65	-78.73	79.71	806.60	40°05'10.910"N	104°45'27.325"W	4.44	
7676.00	63.040	181.630	7433.73	-40.72	41.70	805.56	40°05'10.534"N	104°45'27.339"W	4.10	
7718.00	64.650	181.270	7452.24	-3.03	4.02	804.61	40°05'10.162"N	104°45'27.351"W	3.91	
7760.00	66.400	182.020	7469.64	35.17	-34.19	803.51	40°05'09.784"N	104°45'27.365"W	4.47	
7802.00	68.250	181.270	7485.83	73.91	-72.93	802.40	40°05'09.401"N	104°45'27.380"W	4.70	
7845.00	72.330	181.320	7500.33	114.37	-113.39	801.48	40°05'09.001"N	104°45'27.391"W	9.49	
7887.00	74.810	181.040	7512.21	154.64	-153.66	800.65	40°05'08.603"N	104°45'27.402"W	5.94	
7930.00	77.010	181.290	7522.68	196.33	-195.36	799.81	40°05'08.191"N	104°45'27.413"W	5.15	
7972.00	80.530	180.000	7530.85	237.52	-236.54	799.34	40°05'07.784"N	104°45'27.419"W	8.91	
8018.00	83.990	179.330	7537.05	283.09	-282.12	799.61	40°05'07.334"N	104°45'27.415"W	7.66	
8057.00†	87.323	179.580	7540.00	321.97	-321.00	799.98	40°05'06.950"N	104°45'27.411"W	8.57	7" CASING POINT
8071.00	88.520	179.670	7540.51	335.96	-334.99	800.07	40°05'06.811"N	104°45'27.410"W	8.57	
8156.00	88.580	180.110	7542.66	420.94	-419.96	800.24	40°05'05.972"N	104°45'27.407"W	0.52	
8241.00	88.890	179.460	7544.54	505.91	-504.94	800.55	40°05'05.132"N	104°45'27.403"W	0.85	
8327.00	89.220	180.640	7545.95	591.90	-590.92	800.48	40°05'04.282"N	104°45'27.404"W	1.42	

Actual Wellpath Report

BURKHARDT 16C-3HZ AWP

Page 4 of 6

REFERENCE WELLPATH IDENTIFICATION

Operator	KERR-MCGEE OIL & GAS ONSHORE LP	Slot	SLOT#12 BURKHARDT 16C-3HZ (420'FNL & 1890'FEL, SEC.03)
Area	COLORADO	Well	BURKHARDT 16C-3HZ
Field	WELD COUNTY (KERR MCGEE)	Wellbore	BURKHARDT 16C-3HZ AWB
Facility	SEC.03-T1N-R66W		

WELLPATH DATA (134 stations)

MD [ft]	Inclination [°]	Azimuth [°]	TVD [ft]	Vert Sect [ft]	North [ft]	East [ft]	Latitude	Longitude	DLS [°/100ft]	Comments
8412.00	90.830	180.500	7545.92	676.89	-675.92	799.63	40°05'03.442"N	104°45'27.415"W	1.90	
8497.00	90.310	180.720	7545.07	761.88	-760.91	798.73	40°05'02.602"N	104°45'27.427"W	0.66	
8583.00	90.860	179.960	7544.19	847.87	-846.90	798.22	40°05'01.753"N	104°45'27.434"W	1.09	
8667.00	89.690	179.290	7543.79	931.87	-930.90	798.77	40°05'00.923"N	104°45'27.427"W	1.61	
8753.00	89.750	177.550	7544.21	1017.84	-1016.86	801.14	40°05'00.073"N	104°45'27.396"W	2.02	
8837.00	89.870	178.570	7544.49	1101.79	-1100.81	803.98	40°04'59.243"N	104°45'27.360"W	1.22	
8923.00	88.270	177.510	7545.89	1187.73	-1186.74	806.92	40°04'58.394"N	104°45'27.322"W	2.23	
9008.00	88.690	179.220	7548.14	1272.66	-1271.68	809.35	40°04'57.555"N	104°45'27.291"W	2.07	
9093.00	90.460	179.720	7548.77	1357.65	-1356.67	810.13	40°04'56.715"N	104°45'27.281"W	2.16	
9178.00	91.230	180.490	7547.52	1442.64	-1441.65	809.98	40°04'55.875"N	104°45'27.283"W	1.28	
9263.00	88.820	179.160	7547.48	1527.64	-1526.65	810.24	40°04'55.035"N	104°45'27.279"W	3.24	
9349.00	88.820	178.870	7549.25	1613.61	-1612.62	811.72	40°04'54.186"N	104°45'27.260"W	0.34	
9432.00	90.180	179.070	7549.98	1696.59	-1695.60	813.21	40°04'53.366"N	104°45'27.241"W	1.66	
9518.00	91.510	180.010	7548.71	1782.57	-1781.58	813.90	40°04'52.516"N	104°45'27.232"W	1.89	
9602.00	88.790	178.780	7548.49	1866.56	-1865.57	814.79	40°04'51.686"N	104°45'27.221"W	3.55	
9688.00	90.000	179.140	7549.40	1952.54	-1951.55	816.35	40°04'50.836"N	104°45'27.201"W	1.47	
9773.00	90.930	179.190	7548.71	2037.53	-2036.53	817.59	40°04'49.996"N	104°45'27.185"W	1.10	
9858.00	91.510	179.910	7546.90	2122.51	-2121.51	818.25	40°04'49.157"N	104°45'27.176"W	1.09	
9944.00	89.630	181.460	7546.04	2208.49	-2207.49	817.22	40°04'48.307"N	104°45'27.190"W	2.83	
10029.00	91.630	182.700	7545.11	2293.42	-2292.43	814.14	40°04'47.468"N	104°45'27.229"W	2.77	
10114.00	91.820	183.010	7542.55	2378.27	-2377.28	809.91	40°04'46.629"N	104°45'27.284"W	0.43	
10199.00	91.420	183.400	7540.14	2463.10	-2462.12	805.16	40°04'45.791"N	104°45'27.345"W	0.66	
10285.00	88.640	182.050	7540.10	2548.98	-2548.01	801.07	40°04'44.942"N	104°45'27.398"W	3.59	
10370.00	89.190	180.540	7541.71	2633.94	-2632.97	799.15	40°04'44.102"N	104°45'27.422"W	1.89	
10455.00	89.010	180.490	7543.04	2718.93	-2717.95	798.39	40°04'43.263"N	104°45'27.432"W	0.22	
10540.00	88.360	180.170	7544.99	2803.90	-2802.93	797.90	40°04'42.423"N	104°45'27.439"W	0.85	
10625.00	86.830	180.320	7548.56	2888.82	-2887.85	797.53	40°04'41.584"N	104°45'27.443"W	1.81	
10710.00	88.230	179.660	7552.22	2973.74	-2972.77	797.55	40°04'40.744"N	104°45'27.443"W	1.82	
10795.00	89.230	180.140	7554.11	3058.72	-3057.75	797.70	40°04'39.905"N	104°45'27.441"W	1.30	
10881.00	90.550	179.320	7554.27	3144.72	-3143.74	798.10	40°04'39.055"N	104°45'27.436"W	1.81	
10966.00	90.060	180.860	7553.82	3229.71	-3228.74	797.97	40°04'38.215"N	104°45'27.438"W	1.90	
11051.00	89.350	178.490	7554.26	3314.70	-3313.73	798.45	40°04'37.375"N	104°45'27.432"W	2.91	
11136.00	88.420	177.450	7555.91	3399.64	-3398.66	801.46	40°04'36.536"N	104°45'27.393"W	1.64	
11222.00	89.560	177.940	7557.43	3485.56	-3484.57	804.92	40°04'35.687"N	104°45'27.349"W	1.44	
11307.00	90.400	178.970	7557.46	3570.53	-3569.54	807.21	40°04'34.847"N	104°45'27.319"W	1.56	
11391.00	89.960	178.420	7557.19	3654.50	-3653.52	809.12	40°04'34.017"N	104°45'27.295"W	0.84	
11476.00	89.280	177.810	7557.76	3739.46	-3738.47	811.92	40°04'33.178"N	104°45'27.259"W	1.07	
11561.00	89.960	179.570	7558.32	3824.43	-3823.44	813.86	40°04'32.338"N	104°45'27.234"W	2.22	
11646.00	90.270	179.840	7558.15	3909.43	-3908.44	814.30	40°04'31.498"N	104°45'27.228"W	0.48	
11731.00	91.360	179.850	7556.94	3994.42	-3993.43	814.53	40°04'30.658"N	104°45'27.225"W	1.28	
11816.00	91.140	180.610	7555.09	4079.40	-4078.41	814.19	40°04'29.818"N	104°45'27.230"W	0.93	
11902.00	90.800	179.730	7553.63	4165.39	-4164.40	813.93	40°04'28.969"N	104°45'27.233"W	1.10	
11936.00	90.330	179.770	7553.30	4199.38	-4198.39	814.08	40°04'28.633"N	104°45'27.231"W	1.39	LAST BHI MWD+IFR SURVEYS
11987.00	90.330	179.770	7553.00	4250.38	-4249.39	814.29	40°04'28.129"N	104°45'27.228"W	0.00	PROJECTION TO BIT

Actual Wellpath Report

BURKHARDT 16C-3HZ AWP

Page 5 of 6

REFERENCE WELLPATH IDENTIFICATION

Operator	KERR-MCGEE OIL & GAS ONSHORE LP	Slot	SLOT#12 BURKHARDT 16C-3HZ (420'FNL & 1890'FEL, SEC.03)
Area	COLORADO	Well	BURKHARDT 16C-3HZ
Field	WELD COUNTY (KERR MCGEE)	Wellbore	BURKHARDT 16C-3HZ AWB
Facility	SEC.03-T1N-R66W		

HOLE & CASING SECTIONS - Ref Wellbore: BURKHARDT 16C-3HZ AWB Ref Wellpath: BURKHARDT 16C-3HZ AWP

String/Diameter	Start MD [ft]	End MD [ft]	Interval [ft]	Start TVD [ft]	End TVD [ft]	Start N/S [ft]	Start E/W [ft]	End N/S [ft]	End E/W [ft]
13.5in Open Hole	16.00	1665.00	1649.00	16.00	1664.93	0.00	0.00	3.44	-3.29
9.625in Casing Surface	16.00	1655.00	1639.00	16.00	1654.93	0.00	0.00	3.36	-3.39
8.75in Open Hole	1665.00	8067.00	6402.00	1664.93	7540.39	3.44	-3.29	-330.99	800.05
7in Casing Intermediate	16.00	8057.00	8041.00	16.00	7540.00	0.00	0.00	-321.00	799.98
6.125in Open Hole	8067.00	11987.00	3920.00	7540.39	7553.00	-330.99	800.05	-4249.39	814.29

TARGETS

Name	MD [ft]	TVD [ft]	North [ft]	East [ft]	Grid East [US ft]	Grid North [US ft]	Latitude	Longitude	Shape
SEC.03-T1N-R66W SECTION LINES		0.00	8.30	-2269.81	3204647.31	1275079.54	40°05'10.203"N	104°46'06.906"W	polygon
BURKHARDT 16C-3HZ BHL ON PLAT REV-1 (460'FSL & 1085'FEL, SEC.03)		7541.00	-4274.25	809.96	3207762.57	1270823.00	40°04'27.883"N	104°45'27.284"W	point
BURKHARDT 16C-3HZ LANDBOX		7541.00	0.00	0.00	3206917.02	1275090.17	40°05'10.122"N	104°45'37.703"W	polygon

WELLPATH COMPOSITION - Ref Wellbore: BURKHARDT 16C-3HZ AWB Ref Wellpath: BURKHARDT 16C-3HZ AWP

Start MD [ft]	End MD [ft]	Positional Uncertainty Model	Log Name/Comment	Wellbore
16.00	1610.00	ISCWSA MWD, Rev. 2 (Standard)	CATHEDRAL ENERGY SERVICES MWD SURVEYS 13.5" <128-1610>	BURKHARDT 16C-3HZ AWB
1610.00	8018.00	NaviTrak (MAGCORR,IFR)	BHI MWD+IFR 8.75" <1698-8018>	BURKHARDT 16C-3HZ AWB
8018.00	11936.00	NaviTrak (MAGCORR,IFR)	BHI MWD+IFR 6.125" <8071-11936>	BURKHARDT 16C-3HZ AWB
11936.00	11987.00	Blind Drilling (std)	Projection to bit	BURKHARDT 16C-3HZ AWB

Actual Wellpath Report

BURKHARDT 16C-3HZ AWP

Page 6 of 6

REFERENCE WELLPATH IDENTIFICATION

Operator	KERR-MCGEE OIL & GAS ONSHORE LP	Slot	SLOT#12 BURKHARDT 16C-3HZ (420'FNL & 1890'FEL, SEC.03)
Area	COLORADO	Well	BURKHARDT 16C-3HZ
Field	WELD COUNTY (KERR MCGEE)	Wellbore	BURKHARDT 16C-3HZ AWB
Facility	SEC.03-T1N-R66W		

WELLPATH COMMENTS

MD [ft]	Inclination [°]	Azimuth [°]	TVD [ft]	Comment
128.00	0.700	269.900	128.00	BEGIN MWD SURVEYS
1610.00	0.700	50.900	1609.94	TIE-INTO MWD SURVEYS
1698.00	0.760	49.010	1697.93	BEGIN BHI MWD+IFR SURVEYS
8057.00	87.323	179.580	7540.00	7" CASING POINT
11936.00	90.330	179.770	7553.30	LAST BHI MWD+IFR SURVEYS
11987.00	90.330	179.770	7553.00	PROJECTION TO BIT