

BONANZA CREEK ENERGY INC.

WELD COUNTY, COLORADO (NAD 83)

NW NW SEC. 2 T5N R62W 6th P.M.

STATE ANTELOPE B12-V42-2HNC

ORIGINAL WELLBORE

19 November, 2014

Plan: PROPOSAL #2





Project: WELD COUNTY, COLORADO (NAD 83)
Site: NW NW SEC. 2 T5N R62W 6th P.M.
Well: STATE ANTELOPE B12-V42-2HNC
Wellbore: ORIGINAL WELLBORE
Design: PROPOSAL #2

ANNOTATIONS								
TVD	MD	Inc	Azi	+N/-S	+E/-W	Vsect	Dep	Annotation
1000.0	1000.0	0.00	0.00	0.0	0.0	0.0	0.0	START NUDGE (2°/100ft BUR)
1274.3	1274.7	5.49	232.00	-8.1	-10.4	-10.2	13.2	EOB TO 5.49° INC
5455.4	5475.1	5.49	232.00	-255.7	-327.3	-322.7	415.4	END OF TANGENT
5729.7	5749.8	0.00	0.00	-263.8	-337.7	-332.9	428.5	EOD TO VERTICAL
5759.7	5779.8	0.00	0.00	-263.8	-337.7	-332.9	428.5	KOP (12°/100ft BUR)
6220.9	6404.8	75.00	87.85	-250.5	15.9	20.4	782.4	START OF TANGENT
6246.8	6504.8	75.00	87.85	-246.9	112.5	116.9	879.0	END OF TANGENT
6263.0	6629.8	90.00	87.85	-242.3	236.0	240.3	1002.6	7" ICP (P2) *NEW* - STATE ANTELOPE B12-V42-2HNC
6263.0	10914.9	90.00	87.84	-81.2	4517.9	4518.7	5287.6	BHL (P2) - STATE ANTELOPE B12-V42-2HNC

WELLBORE TARGET DETAILS (LAT/LONG)					
Name	TVD	+N/-S	+E/-W	Latitude	Longitude
KOP (P2) - STATE ANTELOPE B12-V42-2HNC	5759.7	-263.8	-337.7	40.432200	-104.299980
BHL (P2) - STATE ANTELOPE B12-V42-2HNC	6263.0	-81.2	4517.9	40.432700	-104.282538
7" ICP (P2) *NEW* - STATE ANTELOPE B12-V42-2HNC	6263.0	-242.3	236.0	40.432259	-104.297919

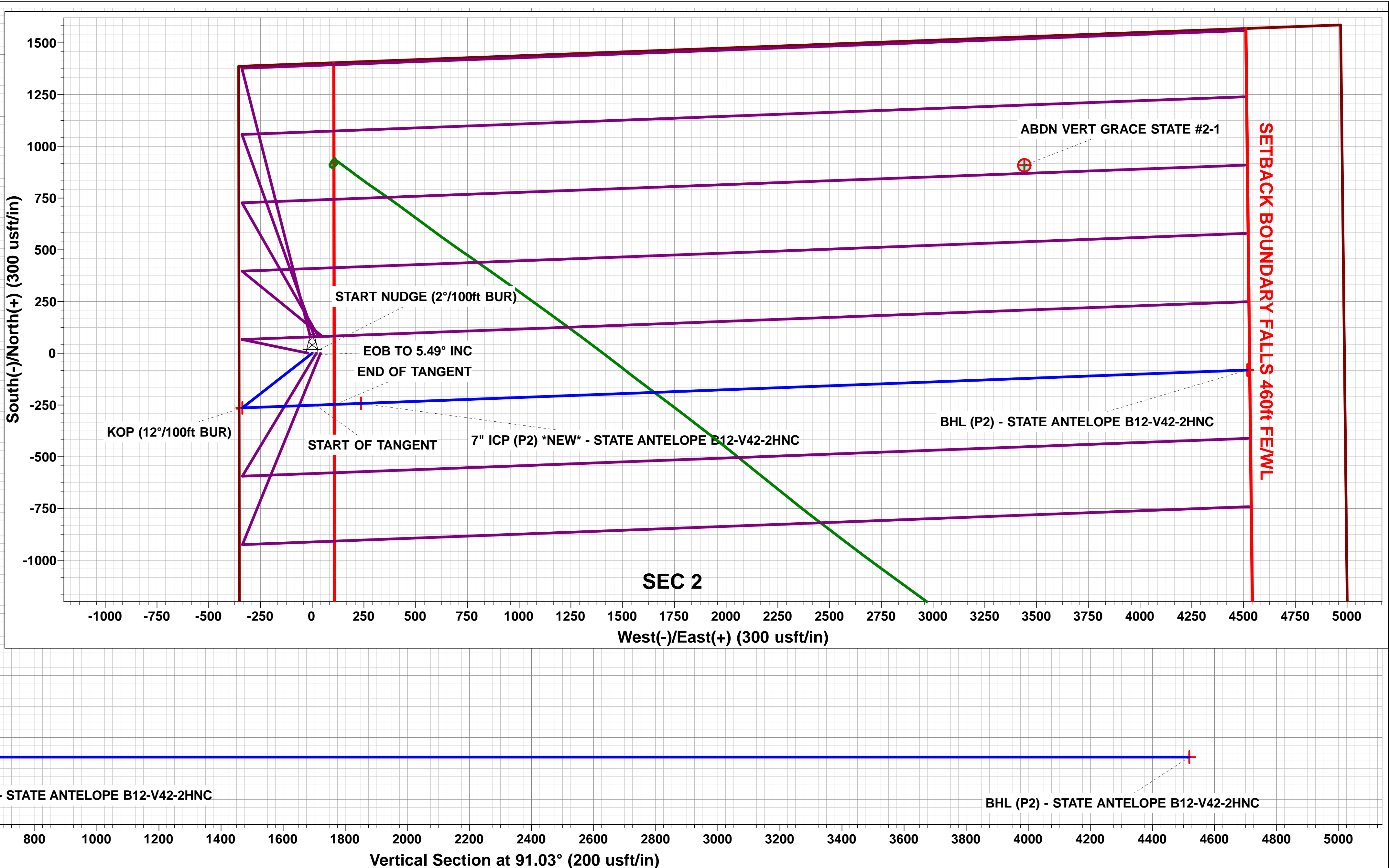
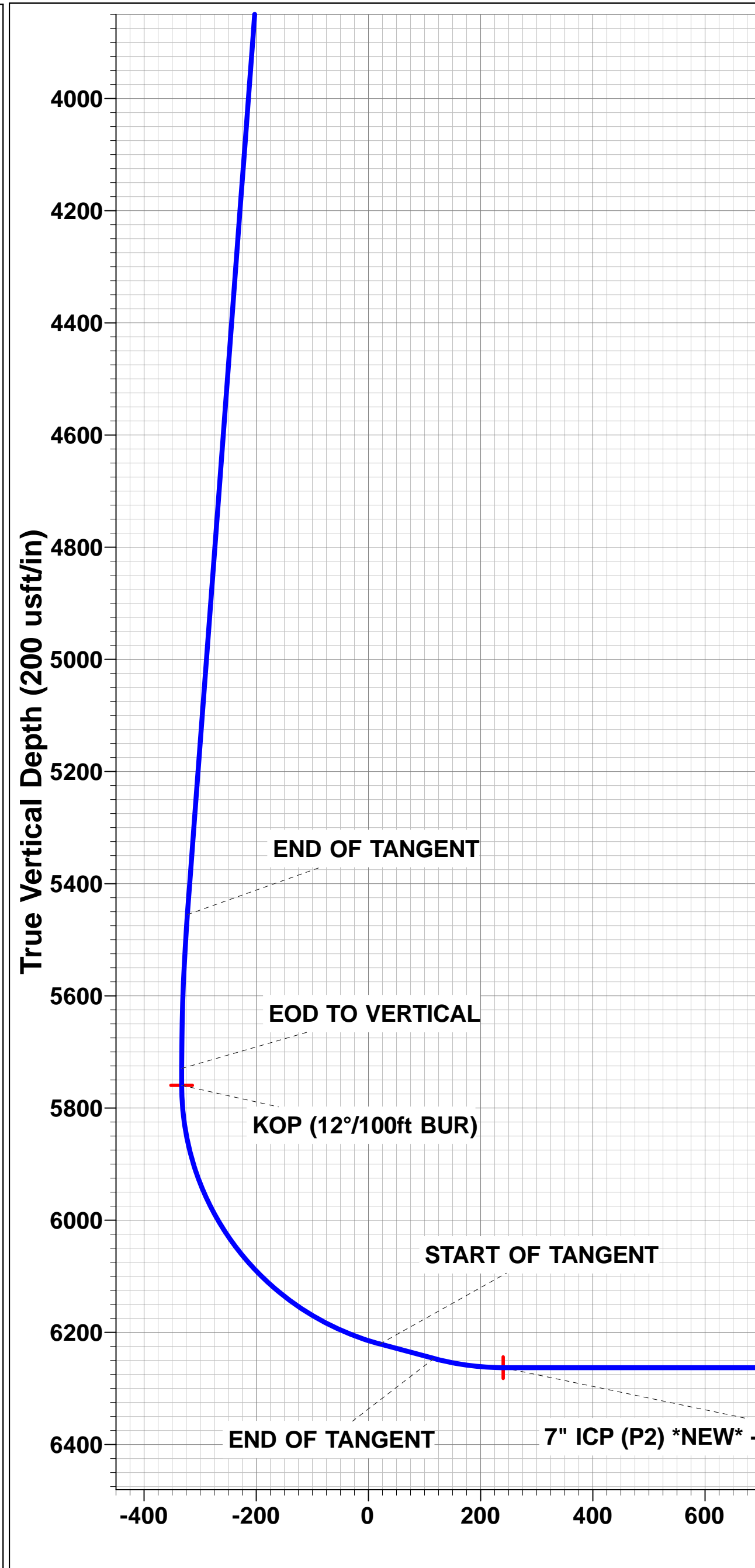
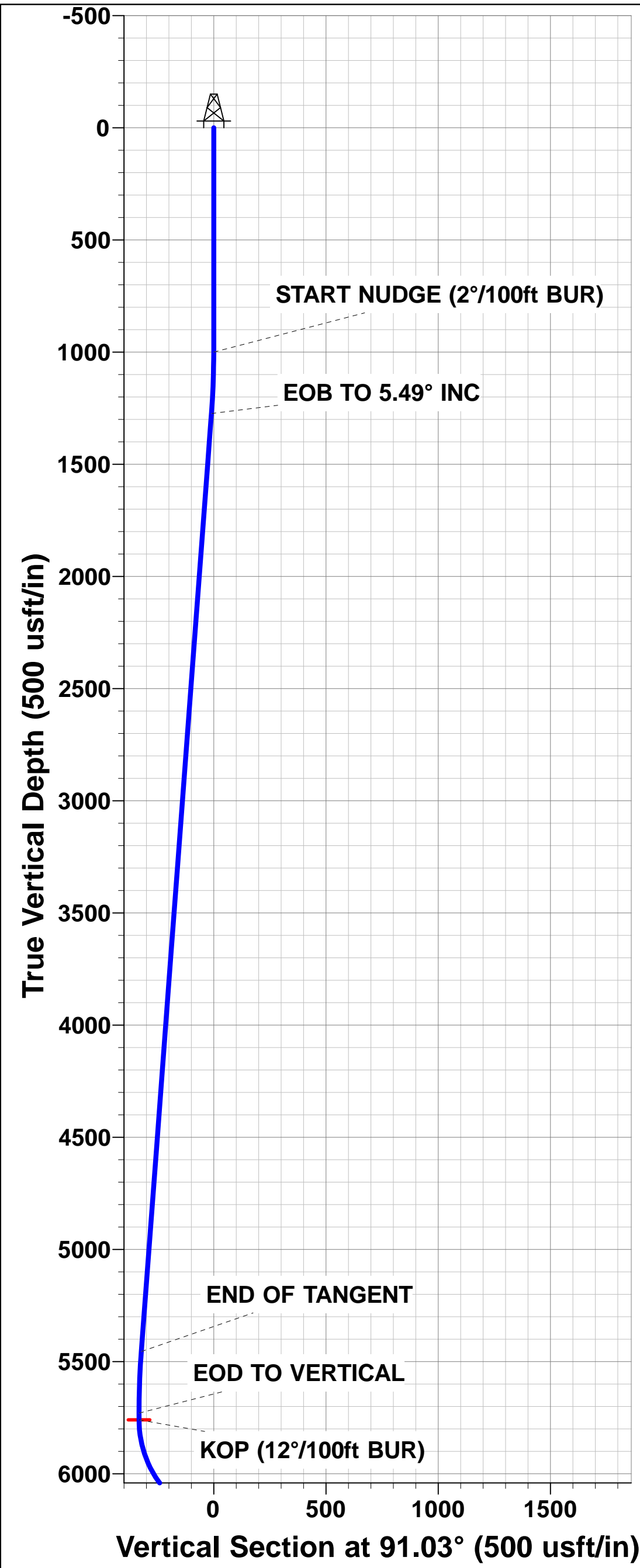
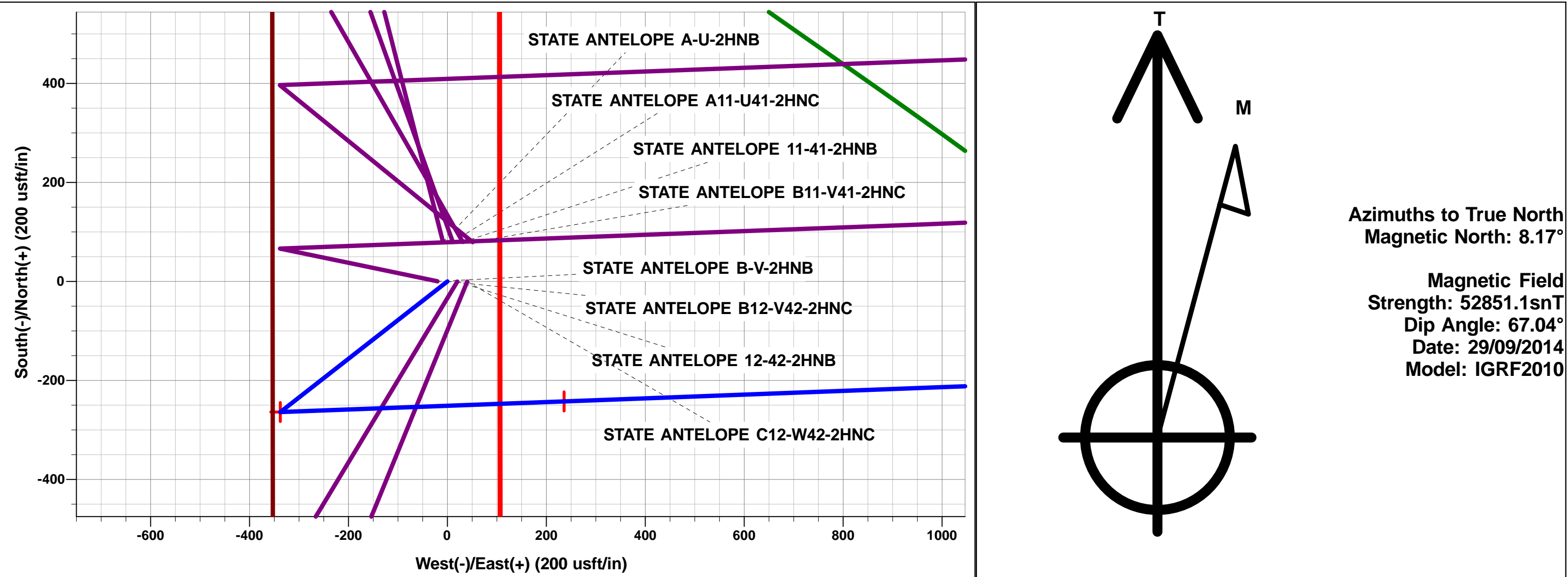

Planning Report



Database:	EDM 5000.1 Single User Db	Local Co-ordinate Reference:	Well STATE ANTELOPE B12-V42-2HNC
Company:	BONANZA CREEK ENERGY INC.	TVD Reference:	KB-EST @ 4663.0usft (Original Well Elev)
Project:	WELD COUNTY, COLORADO (NAD 83)	MD Reference:	KB-EST @ 4663.0usft (Original Well Elev)
Site:	NW NW SEC. 2 T5N R62W 6th P.M.	North Reference:	True
Well:	STATE ANTELOPE B12-V42-2HNC	Survey Calculation Method:	Minimum Curvature
Wellbore:	ORIGINAL WELLBORE		
Design:	PROPOSAL #2		

Project	WELD COUNTY, COLORADO (NAD 83)		
Map System:	US State Plane 1983	System Datum:	Mean Sea Level
Geo Datum:	North American Datum 1983		
Map Zone:	Colorado Northern Zone		Using geodetic scale factor

Site	NW NW SEC. 2 T5N R62W 6th P.M.		
Site Position:		Northing:	1,402,899.64 usft
From:	Lat/Long	Easting:	3,334,413.22 usft
Position Uncertainty:	0.0 usft	Slot Radius:	1.10000ft
		Latitude:	40.433143
		Longitude:	-104.298655
		Grid Convergence:	0.78 °

Well	STATE ANTELOPE B12-V42-2HNC		
Well Position	+N/-S	-79.8 usft	Northing: 1,402,819.43 usft
	+E/-W	-31.2 usft	Easting: 3,334,383.13 usft
Position Uncertainty	0.0 usft	Wellhead Elevation:	usft
		Latitude:	40.432924
		Longitude:	-104.298767
		Ground Level:	4,646.0 usft

Wellbore	ORIGINAL WELLBORE				
Magnetics	Model Name	Sample Date	Declination (°)	Dip Angle (°)	Field Strength (nT)
	IGRF2010	29/09/2014	8.17	67.04	52,851

Design	PROPOSAL #2			
Audit Notes:				
Version:	Phase:	PROTOTYPE	Tie On Depth:	0.0
Vertical Section:	Depth From (TVD) (usft)	+N/-S (usft)	+E/-W (usft)	Direction (°)
	6,263.0	0.0	0.0	91.03

Plan Sections											
MD (usft)	Inc (°)	Azi (°)	Vertical Depth	SS (usft)	+N/-S (usft)	+E/-W (usft)	Dogleg Rate (°/100usf)	Build Rate (°/100usf)	Turn Rate (°/100usf)	TFO (°)	Target
0.0	0.00	0.00	0.0	-4,663.0	0.0	0.0	0.00	0.00	0.00	0.00	
1,000.0	0.00	0.00	1,000.0	-3,663.0	0.0	0.0	0.00	0.00	0.00	0.00	
1,274.7	5.49	232.00	1,274.3	-3,388.7	-8.1	-10.4	2.00	2.00	0.00	232.00	
5,475.1	5.49	232.00	5,455.4	792.4	-255.7	-327.3	0.00	0.00	0.00	0.00	
5,749.8	0.00	0.00	5,729.7	1,066.7	-263.8	-337.7	2.00	-2.00	0.00	180.00	
5,779.8	0.00	0.00	5,759.7	1,096.7	-263.8	-337.7	0.00	0.00	0.00	0.00	KOP (P2) - STATE
6,404.8	75.00	87.85	6,220.9	1,557.9	-250.5	15.9	12.00	12.00	0.00	87.85	
6,504.8	75.00	87.85	6,246.8	1,583.8	-246.9	112.5	0.00	0.00	0.00	0.00	
6,629.8	90.00	87.85	6,263.0	1,600.0	-242.3	236.0	12.00	12.00	0.00	0.00	
10,914.9	90.00	87.84	6,263.0	1,600.0	-81.2	4,517.9	0.00	0.00	0.00	-81.79	BHL (P2) - STATE

Planning Report



Database:	EDM 5000.1 Single User Db	Local Co-ordinate Reference:	Well STATE ANTELOPE B12-V42-2HNC
Company:	BONANZA CREEK ENERGY INC.	TVD Reference:	KB-EST @ 4663.0usft (Original Well Elev)
Project:	WELD COUNTY, COLORADO (NAD 83)	MD Reference:	KB-EST @ 4663.0usft (Original Well Elev)
Site:	NW NW SEC. 2 T5N R62W 6th P.M.	North Reference:	True
Well:	STATE ANTELOPE B12-V42-2HNC	Survey Calculation Method:	Minimum Curvature
Wellbore:	ORIGINAL WELLBORE		
Design:	PROPOSAL #2		

Planned Survey

MD (usft)	Inc (°)	Azi (°)	TVD (usft)	SS (usft)	+N/-S (usft)	+E/-W (usft)	Vertical Section (usft)	Dogleg Rate (°/100usft)	Build Rate (°/100usft)	Turn Rate (°/100usft)
0.0	0.00	0.00	0.0	4,663.00	0.0	0.0	0.0	0.00	0.00	0.00
100.0	0.00	0.00	100.0	4,563.00	0.0	0.0	0.0	0.00	0.00	0.00
200.0	0.00	0.00	200.0	4,463.00	0.0	0.0	0.0	0.00	0.00	0.00
300.0	0.00	0.00	300.0	4,363.00	0.0	0.0	0.0	0.00	0.00	0.00
400.0	0.00	0.00	400.0	4,263.00	0.0	0.0	0.0	0.00	0.00	0.00
500.0	0.00	0.00	500.0	4,163.00	0.0	0.0	0.0	0.00	0.00	0.00
600.0	0.00	0.00	600.0	4,063.00	0.0	0.0	0.0	0.00	0.00	0.00
700.0	0.00	0.00	700.0	3,963.00	0.0	0.0	0.0	0.00	0.00	0.00
800.0	0.00	0.00	800.0	3,863.00	0.0	0.0	0.0	0.00	0.00	0.00
900.0	0.00	0.00	900.0	3,763.00	0.0	0.0	0.0	0.00	0.00	0.00
START NUDGE (2°/100ft BUR)										
1,000.0	0.00	0.00	1,000.0	3,663.00	0.0	0.0	0.0	0.00	0.00	0.00
1,100.0	2.00	232.00	1,100.0	3,563.02	-1.1	-1.4	-1.4	2.00	2.00	0.00
1,200.0	4.00	232.00	1,199.8	3,463.16	-4.3	-5.5	-5.4	2.00	2.00	0.00
EOB TO 5.49° INC										
1,274.7	5.49	232.00	1,274.3	3,388.68	-8.1	-10.4	-10.2	2.00	2.00	0.00
1,300.0	5.49	232.00	1,299.5	3,363.54	-9.6	-12.3	-12.1	0.00	0.00	0.00
1,400.0	5.49	232.00	1,399.0	3,264.00	-15.5	-19.8	-19.5	0.00	0.00	0.00
1,500.0	5.49	232.00	1,498.5	3,164.46	-21.4	-27.4	-27.0	0.00	0.00	0.00
1,600.0	5.49	232.00	1,598.1	3,064.92	-27.3	-34.9	-34.4	0.00	0.00	0.00
1,700.0	5.49	232.00	1,697.6	2,965.37	-33.2	-42.5	-41.9	0.00	0.00	0.00
1,800.0	5.49	232.00	1,797.2	2,865.83	-39.1	-50.0	-49.3	0.00	0.00	0.00
1,900.0	5.49	232.00	1,896.7	2,766.29	-45.0	-57.6	-56.7	0.00	0.00	0.00
2,000.0	5.49	232.00	1,996.2	2,666.75	-50.9	-65.1	-64.2	0.00	0.00	0.00
2,100.0	5.49	232.00	2,095.8	2,567.21	-56.7	-72.6	-71.6	0.00	0.00	0.00
2,200.0	5.49	232.00	2,195.3	2,467.67	-62.6	-80.2	-79.1	0.00	0.00	0.00
2,300.0	5.49	232.00	2,294.9	2,368.13	-68.5	-87.7	-86.5	0.00	0.00	0.00
2,400.0	5.49	232.00	2,394.4	2,268.59	-74.4	-95.3	-93.9	0.00	0.00	0.00
2,500.0	5.49	232.00	2,493.9	2,169.05	-80.3	-102.8	-101.4	0.00	0.00	0.00
2,600.0	5.49	232.00	2,593.5	2,069.51	-86.2	-110.4	-108.8	0.00	0.00	0.00
2,700.0	5.49	232.00	2,693.0	1,969.97	-92.1	-117.9	-116.2	0.00	0.00	0.00
2,800.0	5.49	232.00	2,792.6	1,870.43	-98.0	-125.5	-123.7	0.00	0.00	0.00
2,900.0	5.49	232.00	2,892.1	1,770.89	-103.9	-133.0	-131.1	0.00	0.00	0.00
3,000.0	5.49	232.00	2,991.7	1,671.35	-109.8	-140.6	-138.6	0.00	0.00	0.00
3,100.0	5.49	232.00	3,091.2	1,571.81	-115.7	-148.1	-146.0	0.00	0.00	0.00
3,200.0	5.49	232.00	3,190.7	1,472.27	-121.6	-155.7	-153.4	0.00	0.00	0.00
3,300.0	5.49	232.00	3,290.3	1,372.73	-127.5	-163.2	-160.9	0.00	0.00	0.00
3,400.0	5.49	232.00	3,389.8	1,273.19	-133.4	-170.7	-168.3	0.00	0.00	0.00
3,500.0	5.49	232.00	3,489.4	1,173.65	-139.3	-178.3	-175.8	0.00	0.00	0.00
3,600.0	5.49	232.00	3,588.9	1,074.11	-145.2	-185.8	-183.2	0.00	0.00	0.00
3,700.0	5.49	232.00	3,688.4	974.56	-151.1	-193.4	-190.6	0.00	0.00	0.00
3,800.0	5.49	232.00	3,788.0	875.02	-157.0	-200.9	-198.1	0.00	0.00	0.00
3,900.0	5.49	232.00	3,887.5	775.48	-162.9	-208.5	-205.5	0.00	0.00	0.00
4,000.0	5.49	232.00	3,987.1	675.94	-168.7	-216.0	-213.0	0.00	0.00	0.00
4,100.0	5.49	232.00	4,086.6	576.40	-174.6	-223.6	-220.4	0.00	0.00	0.00
4,200.0	5.49	232.00	4,186.1	476.86	-180.5	-231.1	-227.8	0.00	0.00	0.00
4,300.0	5.49	232.00	4,285.7	377.32	-186.4	-238.7	-235.3	0.00	0.00	0.00
4,400.0	5.49	232.00	4,385.2	277.78	-192.3	-246.2	-242.7	0.00	0.00	0.00
4,500.0	5.49	232.00	4,484.8	178.24	-198.2	-253.7	-250.1	0.00	0.00	0.00
4,600.0	5.49	232.00	4,584.3	78.70	-204.1	-261.3	-257.6	0.00	0.00	0.00
4,700.0	5.49	232.00	4,683.8	-20.84	-210.0	-268.8	-265.0	0.00	0.00	0.00
4,800.0	5.49	232.00	4,783.4	-120.38	-215.9	-276.4	-272.5	0.00	0.00	0.00
4,900.0	5.49	232.00	4,882.9	-219.92	-221.8	-283.9	-279.9	0.00	0.00	0.00
5,000.0	5.49	232.00	4,982.5	-319.46	-227.7	-291.5	-287.3	0.00	0.00	0.00

Planning Report



Database:	EDM 5000.1 Single User Db	Local Co-ordinate Reference:	Well STATE ANTELOPE B12-V42-2HNC
Company:	BONANZA CREEK ENERGY INC.	TVD Reference:	KB-EST @ 4663.0usft (Original Well Elev)
Project:	WELD COUNTY, COLORADO (NAD 83)	MD Reference:	KB-EST @ 4663.0usft (Original Well Elev)
Site:	NW NW SEC. 2 T5N R62W 6th P.M.	North Reference:	True
Well:	STATE ANTELOPE B12-V42-2HNC	Survey Calculation Method:	Minimum Curvature
Wellbore:	ORIGINAL WELLBORE		
Design:	PROPOSAL #2		

Planned Survey										
MD (usft)	Inc (°)	Azi (°)	TVD (usft)	SS (usft)	+N/-S (usft)	+E/-W (usft)	Vertical Section (usft)	Dogleg Rate (°/100usft)	Build Rate (°/100usft)	Turn Rate (°/100usft)
5,100.0	5.49	232.00	5,082.0	-419.00	-233.6	-299.0	-294.8	0.00	0.00	0.00
5,200.0	5.49	232.00	5,181.5	-518.54	-239.5	-306.6	-302.2	0.00	0.00	0.00
5,300.0	5.49	232.00	5,281.1	-618.08	-245.4	-314.1	-309.7	0.00	0.00	0.00
5,400.0	5.49	232.00	5,380.6	-717.62	-251.3	-321.7	-317.1	0.00	0.00	0.00
END OF TANGENT										
5,475.1	5.49	232.00	5,455.4	-792.38	-255.7	-327.3	-322.7	0.00	0.00	0.00
5,500.0	5.00	232.00	5,480.2	-817.17	-257.1	-329.1	-324.4	2.00	-2.00	0.00
5,600.0	3.00	232.00	5,579.9	-916.93	-261.4	-334.6	-329.9	2.00	-2.00	0.00
5,700.0	1.00	232.00	5,679.9	-1,016.86	-263.5	-337.4	-332.6	2.00	-2.00	0.00
EOD TO VERTICAL										
5,749.8	0.00	0.00	5,729.7	-1,066.70	-263.8	-337.7	-332.9	2.00	-2.00	0.00
KOP (12°/100ft BUR)										
5,779.8	0.00	0.00	5,759.7	-1,096.70	-263.8	-337.7	-332.9	0.00	0.00	0.00
5,800.0	2.42	87.85	5,779.9	-1,116.85	-263.8	-337.3	-332.5	12.00	12.00	0.00
5,900.0	14.42	87.85	5,878.6	-1,215.59	-263.2	-322.7	-317.9	12.00	12.00	0.00
6,000.0	26.42	87.85	5,972.1	-1,309.14	-261.9	-287.9	-283.1	12.00	12.00	0.00
6,100.0	38.42	87.85	6,056.4	-1,393.40	-259.9	-234.4	-229.7	12.00	12.00	0.00
6,200.0	50.42	87.85	6,127.7	-1,464.69	-257.3	-164.6	-159.9	12.00	12.00	0.00
6,300.0	62.42	87.85	6,182.9	-1,519.90	-254.2	-81.5	-76.9	12.00	12.00	0.00
6,400.0	74.42	87.85	6,219.6	-1,556.62	-250.7	11.3	15.8	12.00	12.00	0.00
START OF TANGENT										
6,404.8	75.00	87.85	6,220.9	-1,557.90	-250.5	15.9	20.4	12.00	12.00	0.00
6,500.0	75.00	87.85	6,245.5	-1,582.52	-247.1	107.8	112.2	0.00	0.00	0.00
END OF TANGENT										
6,504.8	75.00	87.85	6,246.8	-1,583.78	-246.9	112.5	116.9	0.00	0.00	0.00
6,600.0	86.42	87.85	6,262.1	-1,599.11	-243.4	206.2	210.5	12.00	12.00	0.00
7" ICP (P2) *NEW* - STATE ANTELOPE B12-V42-2HNC										
6,629.8	90.00	87.85	6,263.0	-1,600.05	-242.3	236.0	240.3	12.00	12.00	0.00
6,700.0	90.00	87.85	6,263.0	-1,600.05	-239.6	306.1	310.3	0.00	0.00	0.00
6,800.0	90.00	87.85	6,263.0	-1,600.05	-235.9	406.0	410.2	0.00	0.00	0.00
6,900.0	90.00	87.85	6,263.0	-1,600.05	-232.1	505.9	510.0	0.00	0.00	0.00
7,000.0	90.00	87.85	6,263.0	-1,600.05	-228.4	605.9	609.9	0.00	0.00	0.00
7,100.0	90.00	87.85	6,263.0	-1,600.05	-224.6	705.8	709.7	0.00	0.00	0.00
7,200.0	90.00	87.85	6,263.0	-1,600.05	-220.9	805.7	809.5	0.00	0.00	0.00
7,300.0	90.00	87.85	6,263.0	-1,600.05	-217.1	905.6	909.4	0.00	0.00	0.00
7,400.0	90.00	87.85	6,263.0	-1,600.05	-213.4	1,005.6	1,009.2	0.00	0.00	0.00
7,500.0	90.00	87.85	6,263.0	-1,600.04	-209.6	1,105.5	1,109.1	0.00	0.00	0.00
7,600.0	90.00	87.85	6,263.0	-1,600.04	-205.9	1,205.4	1,208.9	0.00	0.00	0.00
7,700.0	90.00	87.85	6,263.0	-1,600.04	-202.1	1,305.4	1,308.8	0.00	0.00	0.00
7,800.0	90.00	87.85	6,263.0	-1,600.04	-198.3	1,405.3	1,408.6	0.00	0.00	0.00
7,900.0	90.00	87.85	6,263.0	-1,600.04	-194.6	1,505.2	1,508.5	0.00	0.00	0.00
8,000.0	90.00	87.85	6,263.0	-1,600.04	-190.8	1,605.1	1,608.3	0.00	0.00	0.00
8,100.0	90.00	87.85	6,263.0	-1,600.04	-187.1	1,705.1	1,708.2	0.00	0.00	0.00
8,200.0	90.00	87.85	6,263.0	-1,600.04	-183.3	1,805.0	1,808.0	0.00	0.00	0.00
8,300.0	90.00	87.85	6,263.0	-1,600.04	-179.6	1,904.9	1,907.9	0.00	0.00	0.00
8,400.0	90.00	87.85	6,263.0	-1,600.04	-175.8	2,004.9	2,007.7	0.00	0.00	0.00
8,500.0	90.00	87.85	6,263.0	-1,600.04	-172.0	2,104.8	2,107.5	0.00	0.00	0.00
8,600.0	90.00	87.85	6,263.0	-1,600.04	-168.3	2,204.7	2,207.4	0.00	0.00	0.00
8,700.0	90.00	87.85	6,263.0	-1,600.04	-164.5	2,304.7	2,307.2	0.00	0.00	0.00
8,800.0	90.00	87.85	6,263.0	-1,600.03	-160.8	2,404.6	2,407.1	0.00	0.00	0.00
8,900.0	90.00	87.85	6,263.0	-1,600.03	-157.0	2,504.5	2,506.9	0.00	0.00	0.00
9,000.0	90.00	87.85	6,263.0	-1,600.03	-153.2	2,604.4	2,606.8	0.00	0.00	0.00
9,100.0	90.00	87.85	6,263.0	-1,600.03	-149.5	2,704.4	2,706.6	0.00	0.00	0.00

Planning Report



Database:	EDM 5000.1 Single User Db	Local Co-ordinate Reference:	Well STATE ANTELOPE B12-V42-2HNC
Company:	BONANZA CREEK ENERGY INC.	TVD Reference:	KB-EST @ 4663.0usft (Original Well Elev)
Project:	WELD COUNTY, COLORADO (NAD 83)	MD Reference:	KB-EST @ 4663.0usft (Original Well Elev)
Site:	NW NW SEC. 2 T5N R62W 6th P.M.	North Reference:	True
Well:	STATE ANTELOPE B12-V42-2HNC	Survey Calculation Method:	Minimum Curvature
Wellbore:	ORIGINAL WELLBORE		
Design:	PROPOSAL #2		

Planned Survey										
MD (usft)	Inc (°)	Azi (°)	TVD (usft)	SS (usft)	+N/-S (usft)	+E/-W (usft)	Vertical Section (usft)	Dogleg Rate (°/100usft)	Build Rate (°/100usft)	Turn Rate (°/100usft)
9,200.0	90.00	87.84	6,263.0	-1,600.03	-145.7	2,804.3	2,806.5	0.00	0.00	0.00
9,300.0	90.00	87.84	6,263.0	-1,600.03	-142.0	2,904.2	2,906.3	0.00	0.00	0.00
9,400.0	90.00	87.84	6,263.0	-1,600.03	-138.2	3,004.2	3,006.2	0.00	0.00	0.00
9,500.0	90.00	87.84	6,263.0	-1,600.03	-134.4	3,104.1	3,106.0	0.00	0.00	0.00
9,600.0	90.00	87.84	6,263.0	-1,600.02	-130.7	3,204.0	3,205.8	0.00	0.00	0.00
9,700.0	90.00	87.84	6,263.0	-1,600.02	-126.9	3,303.9	3,305.7	0.00	0.00	0.00
9,800.0	90.00	87.84	6,263.0	-1,600.02	-123.2	3,403.9	3,405.5	0.00	0.00	0.00
9,900.0	90.00	87.84	6,263.0	-1,600.02	-119.4	3,503.8	3,505.4	0.00	0.00	0.00
10,000.0	90.00	87.84	6,263.0	-1,600.02	-115.6	3,603.7	3,605.2	0.00	0.00	0.00
10,100.0	90.00	87.84	6,263.0	-1,600.02	-111.9	3,703.7	3,705.1	0.00	0.00	0.00
10,200.0	90.00	87.84	6,263.0	-1,600.01	-108.1	3,803.6	3,804.9	0.00	0.00	0.00
10,300.0	90.00	87.84	6,263.0	-1,600.01	-104.3	3,903.5	3,904.8	0.00	0.00	0.00
10,400.0	90.00	87.84	6,263.0	-1,600.01	-100.6	4,003.4	4,004.6	0.00	0.00	0.00
10,500.0	90.00	87.84	6,263.0	-1,600.01	-96.8	4,103.4	4,104.5	0.00	0.00	0.00
10,600.0	90.00	87.84	6,263.0	-1,600.01	-93.0	4,203.3	4,204.3	0.00	0.00	0.00
10,700.0	90.00	87.84	6,263.0	-1,600.00	-89.3	4,303.2	4,304.1	0.00	0.00	0.00
10,800.0	90.00	87.84	6,263.0	-1,600.00	-85.5	4,403.2	4,404.0	0.00	0.00	0.00
10,900.0	90.00	87.84	6,263.0	-1,600.00	-81.7	4,503.1	4,503.8	0.00	0.00	0.00
BHL (P2) - STATE ANTELOPE B12-V42-2HNC										
10,914.9	90.00	87.84	6,263.0	-1,600.00	-81.2	4,517.9	4,518.7	0.00	0.00	0.00

Plan Annotations				
MD (usft)	TVD (usft)	Local Coordinates		Comment
		+N/-S (usft)	+E/-W (usft)	
1,000.0	1,000.0	0.0	0.0	START NUDGE (2°/100ft BUR)
1,274.7	1,274.3	-8.1	-10.4	EOB TO 5.49° INC
5,475.1	5,455.4	-255.7	-327.3	END OF TANGENT
5,749.8	5,729.7	-263.8	-337.7	EOD TO VERTICAL
5,779.8	5,759.7	-263.8	-337.7	KOP (12°/100ft BUR)
6,404.8	6,220.9	-250.5	15.9	START OF TANGENT
6,504.8	6,246.8	-246.9	112.5	END OF TANGENT
6,629.8	6,263.0	-242.3	236.0	7" ICP (P2) *NEW* - STATE ANTELOPE B12-V42-2HNC
10,914.9	6,263.0	-81.2	4,517.9	BHL (P2) - STATE ANTELOPE B12-V42-2HNC