

BONANZA CREEK ENERGY INC.

WELD COUNTY, COLORADO (NAD 83)

NW NW SEC. 2 T5N R62W 6th P.M.

STATE ANTELOPE C12-W42-2HNC

ORIGINAL WELLBORE

19 November, 2014

Plan: PROPOSAL #2





Project: WELD COUNTY, COLORADO (NAD 83)
Site: NW NW SEC. 2 T5N R62W 6th P.M.
Well: STATE ANTELOPE C12-W42-2HNC
Wellbore: ORIGINAL WELLBORE
Design: PROPOSAL #2

ANNOTATIONS								
TVD	MD	Inc	Azi	+N/-S	+E/-W	Vsect	Dep	Annotation
1400.0	1400.0	0.00	0.00	0.0	0.0	0.0	0.0	START NUDGE (2°/100ft BUR)
2177.6	2187.5	15.75	202.20	-99.6	-40.6	-23.9	107.6	EOB TO 15.75° INC
4953.2	5071.4	15.75	202.20	-824.4	-336.4	-197.5	890.4	END OF TANGENT
5730.9	5858.9	0.00	202.20	-924.0	-377.0	-221.4	998.0	EOD TO VERTICAL
5760.9	5888.9	0.00	0.00	-924.0	-377.0	-221.4	998.0	KOP (12°/100ft BUR)
6222.1	6513.9	75.00	87.84	-910.7	-23.4	125.3	1351.8	START OF TANGENT
6248.0	6613.9	75.00	87.84	-907.0	73.1	220.0	1448.4	END OF TANGENT
6264.2	6738.9	90.00	87.84	-902.4	196.6	341.1	1572.0	7" ICP (P2) *NEW* - STATE ANTELOPE C12-W42-2HNC
6264.2	11030.8	90.00	87.85	-741.0	4485.5	4546.3	5863.9	BHL (P2) - STATE ANTELOPE C12-W42-2HNC

WELLBORE TARGET DETAILS (LAT/LONG)					
Name	TVD	+N/-S	+E/-W	Latitude	Longitude
KOP (P2) - STATE ANTELOPE C12-W42-2HNC	5760.9	-924.0	-377.0	40.430387	-104.299977
BHL (P2) - STATE ANTELOPE C12-W42-2HNC	6264.2	-741.0	4485.5	40.430888	-104.282511
7" ICP (P2) *NEW* - STATE ANTELOPE C12-W42-2HNC	6264.2	-902.4	196.6	40.430446	-104.297917

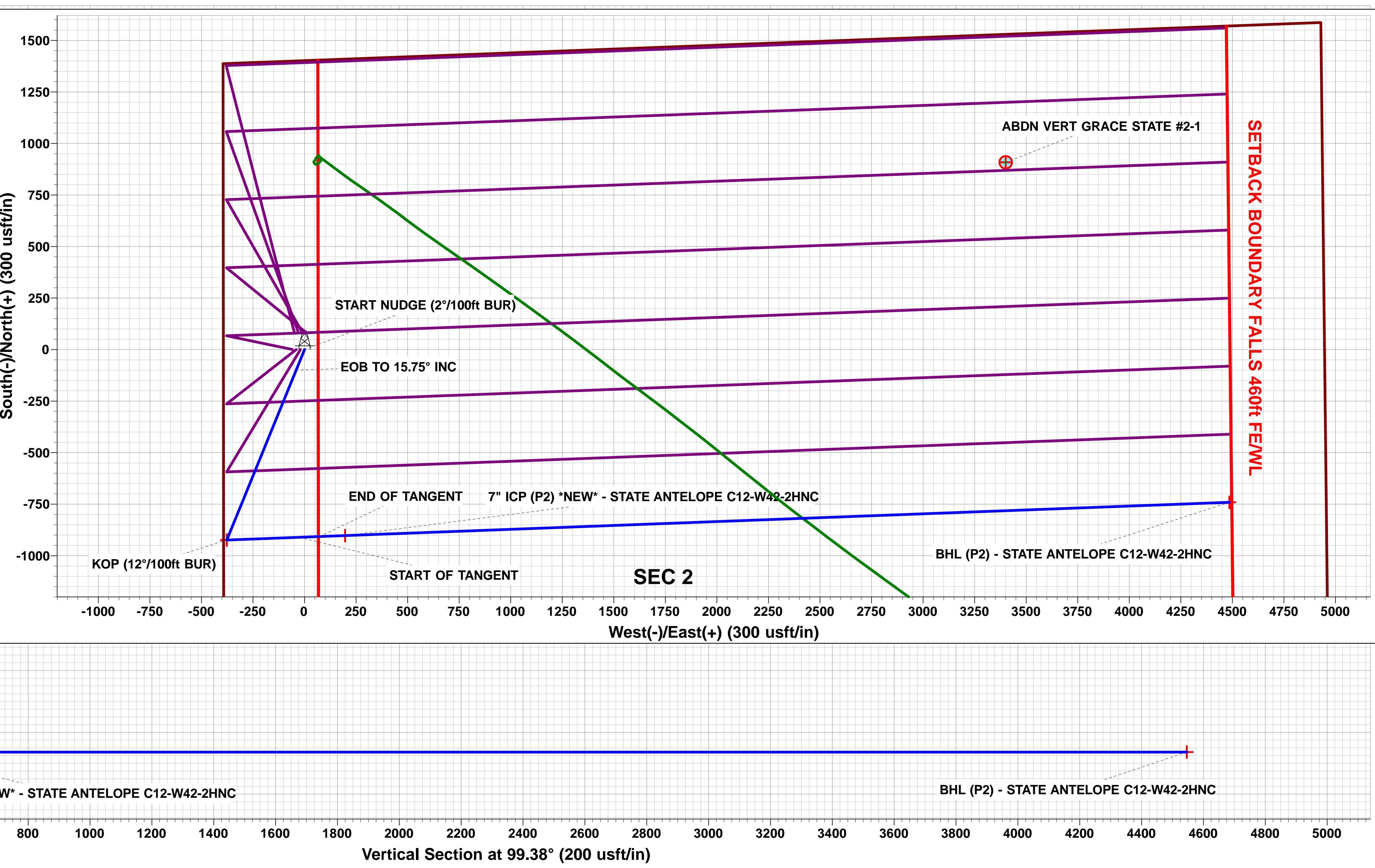
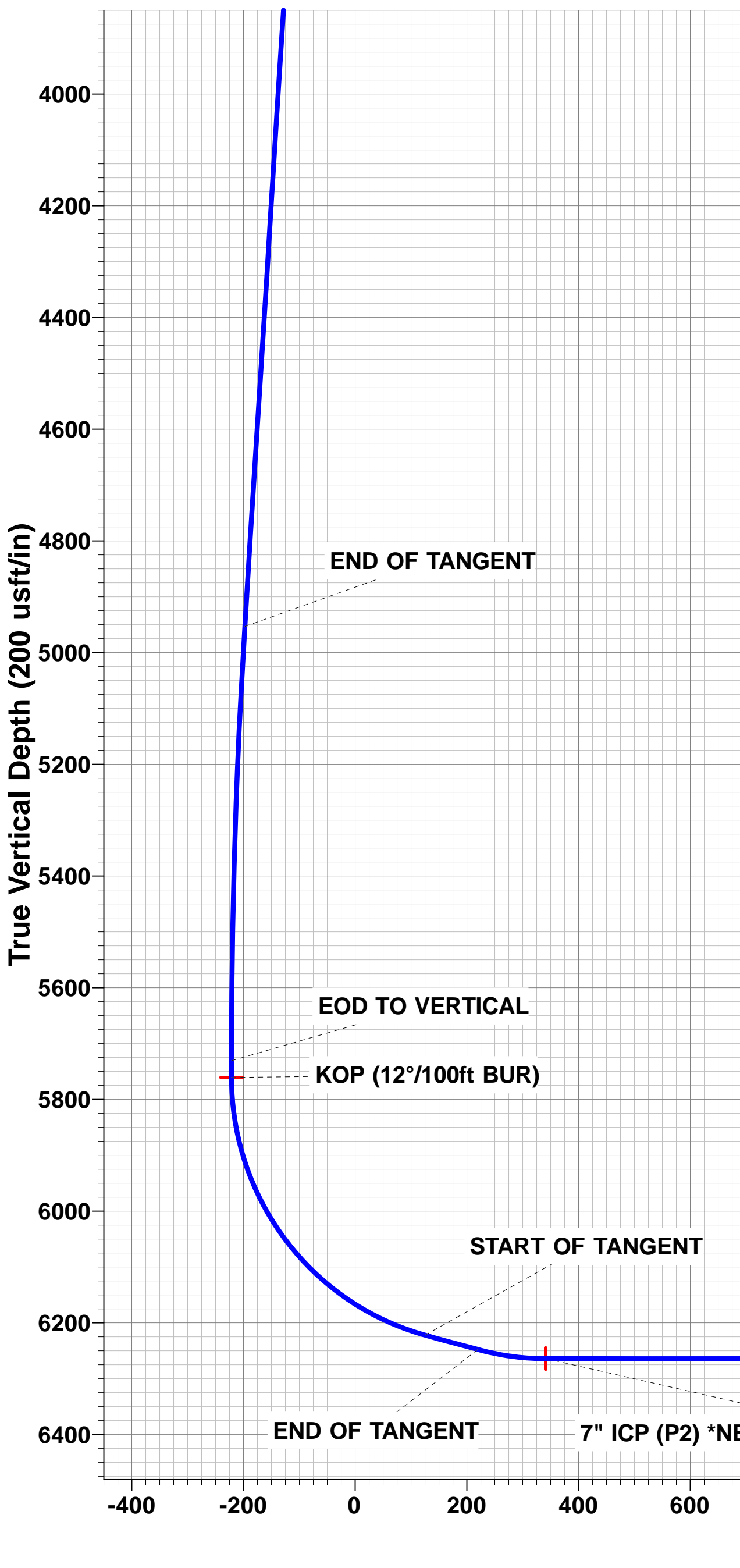
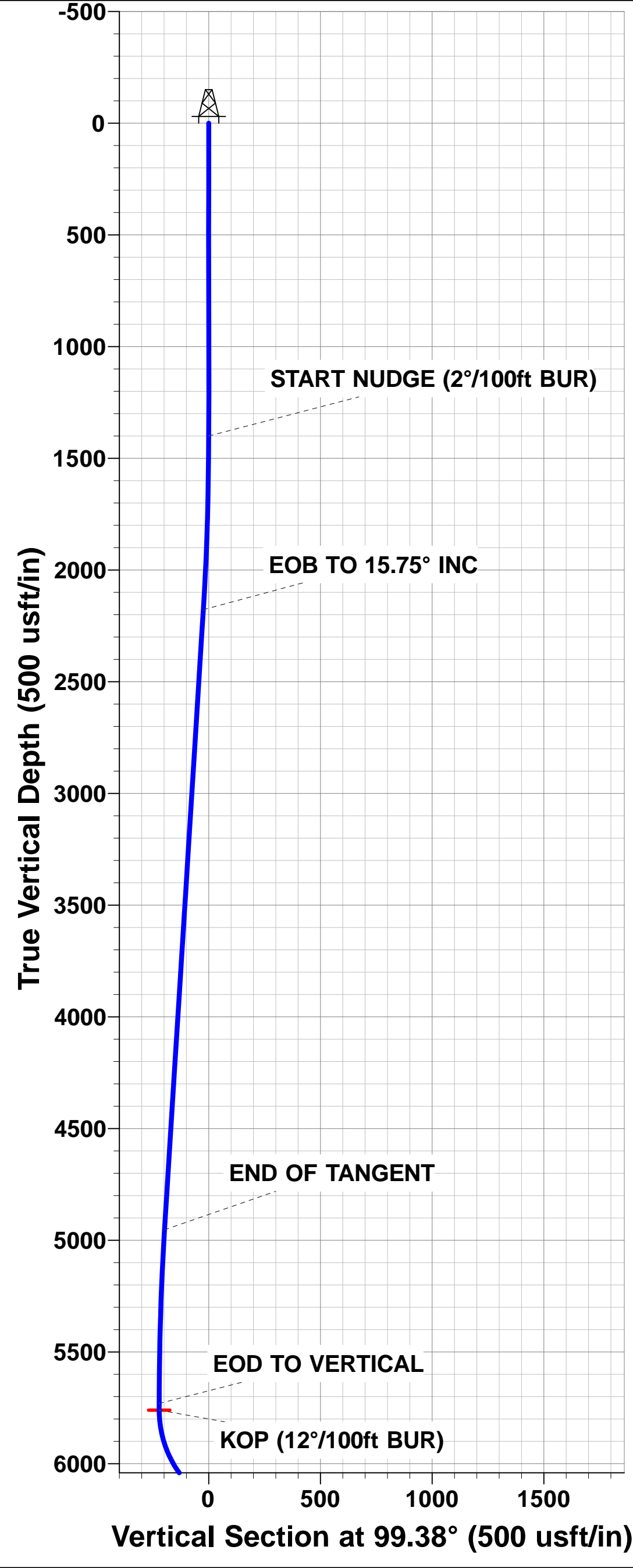
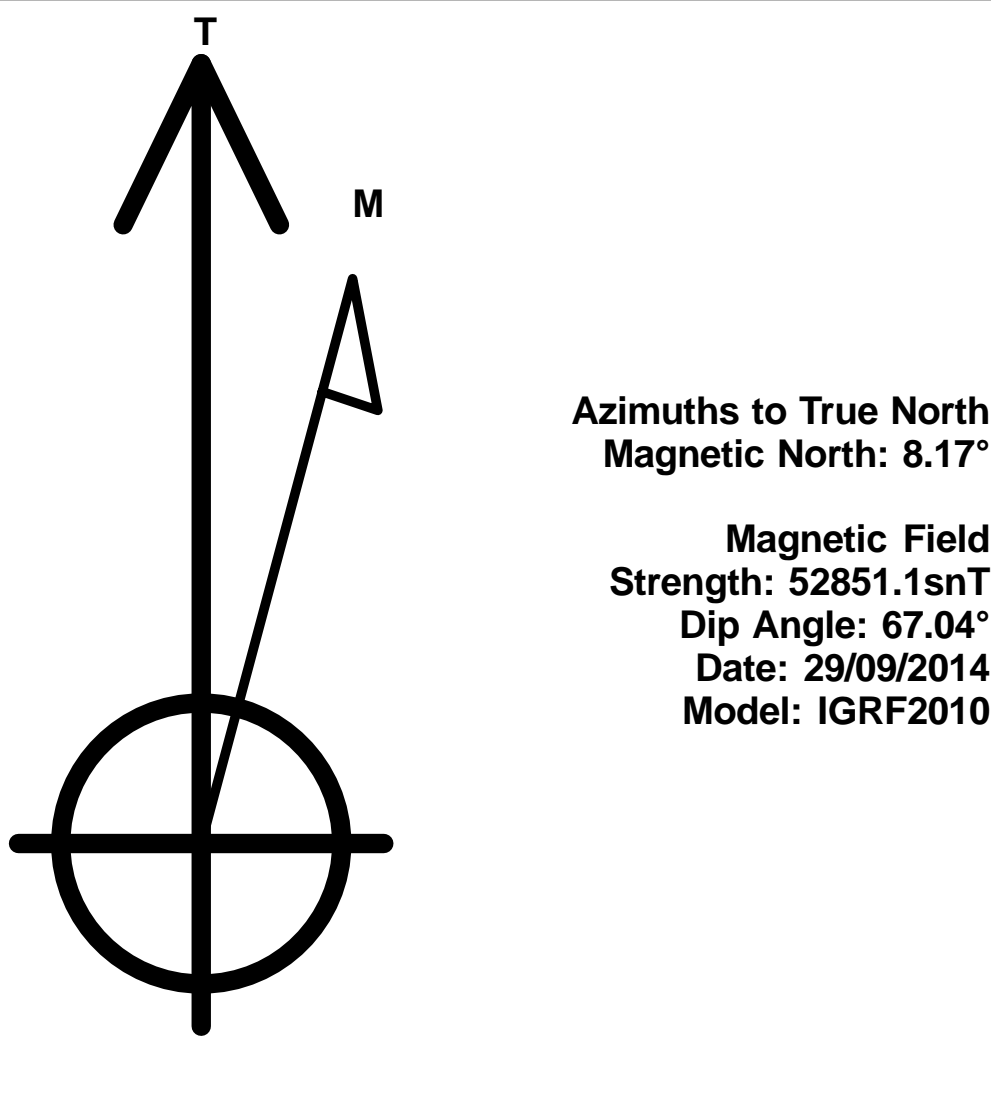
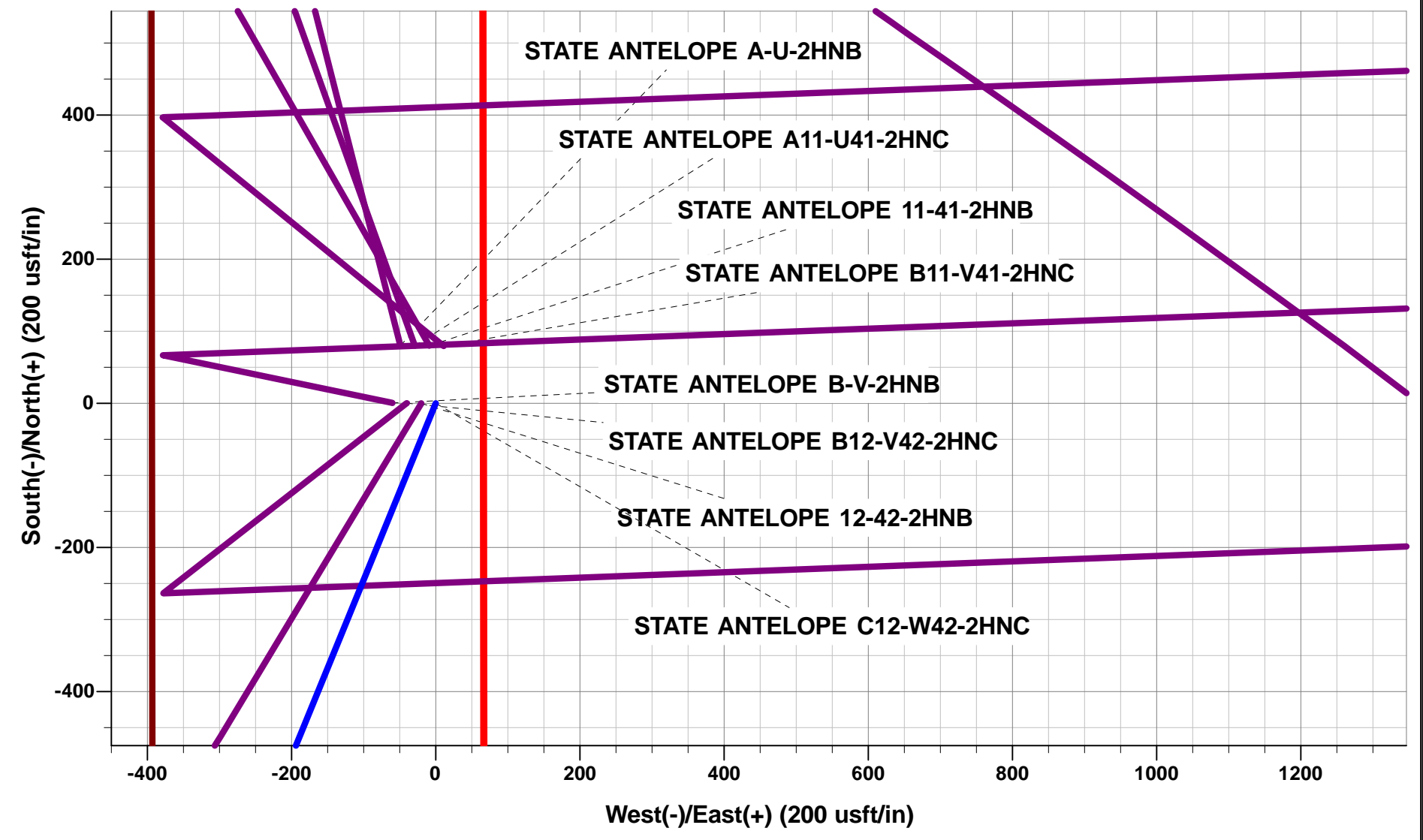

Planning Report



Database:	EDM 5000.1 Single User Db	Local Co-ordinate Reference:	Well STATE ANTELOPE C12-W42-2HNC
Company:	BONANZA CREEK ENERGY INC.	TVD Reference:	KB-EST @ 4664.2usft (Original Well Elev)
Project:	WELD COUNTY, COLORADO (NAD 83)	MD Reference:	KB-EST @ 4664.2usft (Original Well Elev)
Site:	NW NW SEC. 2 T5N R62W 6th P.M.	North Reference:	True
Well:	STATE ANTELOPE C12-W42-2HNC	Survey Calculation Method:	Minimum Curvature
Wellbore:	ORIGINAL WELLBORE		
Design:	PROPOSAL #2		

Project	WELD COUNTY, COLORADO (NAD 83)		
Map System:	US State Plane 1983	System Datum:	Mean Sea Level
Geo Datum:	North American Datum 1983		
Map Zone:	Colorado Northern Zone		Using geodetic scale factor

Site	NW NW SEC. 2 T5N R62W 6th P.M.		
Site Position:		Northing:	1,402,899.64 usft
From:	Lat/Long	Easting:	3,334,413.22 usft
Position Uncertainty:	0.0 usft	Slot Radius:	1.10000ft
		Latitude:	40.433143
		Longitude:	-104.298655
		Grid Convergence:	0.78 °

Well	STATE ANTELOPE C12-W42-2HNC		
Well Position	+N/-S	-80.2 usft	Northing:
	+E/-W	8.9 usft	Easting:
Position Uncertainty		0.0 usft	Wellhead Elevation:
			Latitude:
			Longitude:
			Ground Level:

Wellbore	ORIGINAL WELLBORE				
Magnetics	Model Name	Sample Date	Declination (°)	Dip Angle (°)	Field Strength (nT)
	IGRF2010	29/09/2014	8.17	67.04	52,851

Design	PROPOSAL #2			
Audit Notes:				
Version:	Phase:	PROTOTYPE	Tie On Depth:	0.0
Vertical Section:	Depth From (TVD) (usft)	+N/-S (usft)	+E/-W (usft)	Direction (°)
	6,264.2	0.0	0.0	99.38

Plan Sections											
MD (usft)	Inc (°)	Azi (°)	Vertical Depth	SS (usft)	+N/-S (usft)	+E/-W (usft)	Dogleg Rate (°/100usf)	Build Rate (°/100usf)	Turn Rate (°/100usf)	TFO (°)	Target
0.0	0.00	0.00	0.0	-4,664.2	0.0	0.0	0.00	0.00	0.00	0.00	
1,400.0	0.00	0.00	1,400.0	-3,264.2	0.0	0.0	0.00	0.00	0.00	0.00	
2,187.5	15.75	202.20	2,177.6	-2,486.6	-99.6	-40.6	2.00	2.00	0.00	202.20	
5,071.4	15.75	202.20	4,953.3	289.1	-824.4	-336.4	0.00	0.00	0.00	0.00	
5,858.9	0.00	0.00	5,730.9	1,066.7	-924.0	-377.0	2.00	-2.00	0.00	180.00	
5,888.9	0.00	0.00	5,760.9	1,096.7	-924.0	-377.0	0.00	0.00	0.00	0.00	KOP (P2) - STATE
6,513.9	75.00	87.84	6,222.1	1,557.9	-910.7	-23.4	12.00	12.00	0.00	87.84	
6,613.9	75.00	87.84	6,248.0	1,583.8	-907.0	73.2	0.00	0.00	0.00	0.00	
6,738.9	90.00	87.84	6,264.2	1,600.0	-902.4	196.6	12.00	12.00	0.00	0.00	
11,030.8	90.00	87.85	6,264.2	1,600.0	-741.0	4,485.5	0.00	0.00	0.00	82.60	BHL (P2) - STATE

Planning Report



Database:	EDM 5000.1 Single User Db	Local Co-ordinate Reference:	Well STATE ANTELOPE C12-W42-2HNC
Company:	BONANZA CREEK ENERGY INC.	TVD Reference:	KB-EST @ 4664.2usft (Original Well Elev)
Project:	WELD COUNTY, COLORADO (NAD 83)	MD Reference:	KB-EST @ 4664.2usft (Original Well Elev)
Site:	NW NW SEC. 2 T5N R62W 6th P.M.	North Reference:	True
Well:	STATE ANTELOPE C12-W42-2HNC	Survey Calculation Method:	Minimum Curvature
Wellbore:	ORIGINAL WELLBORE		
Design:	PROPOSAL #2		

Planned Survey										
MD (usft)	Inc (°)	Azi (°)	TVD (usft)	SS (usft)	+N/-S (usft)	+E/-W (usft)	Vertical Section (usft)	Dogleg Rate (°/100usft)	Build Rate (°/100usft)	Turn Rate (°/100usft)
0.0	0.00	0.00	0.0	4,664.20	0.0	0.0	0.0	0.00	0.00	0.00
100.0	0.00	0.00	100.0	4,564.20	0.0	0.0	0.0	0.00	0.00	0.00
200.0	0.00	0.00	200.0	4,464.20	0.0	0.0	0.0	0.00	0.00	0.00
300.0	0.00	0.00	300.0	4,364.20	0.0	0.0	0.0	0.00	0.00	0.00
400.0	0.00	0.00	400.0	4,264.20	0.0	0.0	0.0	0.00	0.00	0.00
500.0	0.00	0.00	500.0	4,164.20	0.0	0.0	0.0	0.00	0.00	0.00
600.0	0.00	0.00	600.0	4,064.20	0.0	0.0	0.0	0.00	0.00	0.00
700.0	0.00	0.00	700.0	3,964.20	0.0	0.0	0.0	0.00	0.00	0.00
800.0	0.00	0.00	800.0	3,864.20	0.0	0.0	0.0	0.00	0.00	0.00
900.0	0.00	0.00	900.0	3,764.20	0.0	0.0	0.0	0.00	0.00	0.00
1,000.0	0.00	0.00	1,000.0	3,664.20	0.0	0.0	0.0	0.00	0.00	0.00
1,100.0	0.00	0.00	1,100.0	3,564.20	0.0	0.0	0.0	0.00	0.00	0.00
1,200.0	0.00	0.00	1,200.0	3,464.20	0.0	0.0	0.0	0.00	0.00	0.00
1,300.0	0.00	0.00	1,300.0	3,364.20	0.0	0.0	0.0	0.00	0.00	0.00
START NUDGE (2°/100ft BUR)										
1,400.0	0.00	0.00	1,400.0	3,264.20	0.0	0.0	0.0	0.00	0.00	0.00
1,500.0	2.00	202.20	1,500.0	3,164.22	-1.6	-0.7	-0.4	2.00	2.00	0.00
1,600.0	4.00	202.20	1,599.8	3,064.36	-6.5	-2.6	-1.5	2.00	2.00	0.00
1,700.0	6.00	202.20	1,699.5	2,964.75	-14.5	-5.9	-3.5	2.00	2.00	0.00
1,800.0	8.00	202.20	1,798.7	2,865.50	-25.8	-10.5	-6.2	2.00	2.00	0.00
1,900.0	10.00	202.20	1,897.5	2,766.73	-40.3	-16.4	-9.7	2.00	2.00	0.00
2,000.0	12.00	202.20	1,995.6	2,668.58	-58.0	-23.6	-13.9	2.00	2.00	0.00
2,100.0	14.00	202.20	2,093.1	2,571.14	-78.8	-32.1	-18.9	2.00	2.00	0.00
EOB TO 15.75° INC										
2,187.5	15.75	202.20	2,177.6	2,486.58	-99.6	-40.6	-23.9	2.00	2.00	0.00
2,200.0	15.75	202.20	2,189.7	2,474.55	-102.7	-41.9	-24.6	0.00	0.00	0.00
2,300.0	15.75	202.20	2,285.9	2,378.30	-127.9	-52.2	-30.6	0.00	0.00	0.00
2,400.0	15.75	202.20	2,382.1	2,282.06	-153.0	-62.4	-36.7	0.00	0.00	0.00
2,500.0	15.75	202.20	2,478.4	2,185.81	-178.1	-72.7	-42.7	0.00	0.00	0.00
2,600.0	15.75	202.20	2,574.6	2,089.57	-203.3	-82.9	-48.7	0.00	0.00	0.00
2,700.0	15.75	202.20	2,670.9	1,993.32	-228.4	-93.2	-54.7	0.00	0.00	0.00
2,800.0	15.75	202.20	2,767.1	1,897.08	-253.5	-103.4	-60.7	0.00	0.00	0.00
2,900.0	15.75	202.20	2,863.4	1,800.83	-278.7	-113.7	-66.8	0.00	0.00	0.00
3,000.0	15.75	202.20	2,959.6	1,704.59	-303.8	-124.0	-72.8	0.00	0.00	0.00
3,100.0	15.75	202.20	3,055.9	1,608.34	-328.9	-134.2	-78.8	0.00	0.00	0.00
3,200.0	15.75	202.20	3,152.1	1,512.10	-354.1	-144.5	-84.8	0.00	0.00	0.00
3,300.0	15.75	202.20	3,248.3	1,415.85	-379.2	-154.7	-90.8	0.00	0.00	0.00
3,400.0	15.75	202.20	3,344.6	1,319.61	-404.3	-165.0	-96.9	0.00	0.00	0.00
3,500.0	15.75	202.20	3,440.8	1,223.36	-429.5	-175.2	-102.9	0.00	0.00	0.00
3,600.0	15.75	202.20	3,537.1	1,127.11	-454.6	-185.5	-108.9	0.00	0.00	0.00
3,700.0	15.75	202.20	3,633.3	1,030.87	-479.7	-195.7	-114.9	0.00	0.00	0.00
3,800.0	15.75	202.20	3,729.6	934.62	-504.9	-206.0	-120.9	0.00	0.00	0.00
3,900.0	15.75	202.20	3,825.8	838.38	-530.0	-216.2	-127.0	0.00	0.00	0.00
4,000.0	15.75	202.20	3,922.1	742.13	-555.1	-226.5	-133.0	0.00	0.00	0.00
4,100.0	15.75	202.20	4,018.3	645.89	-580.3	-236.8	-139.0	0.00	0.00	0.00
4,200.0	15.75	202.20	4,114.6	549.64	-605.4	-247.0	-145.0	0.00	0.00	0.00
4,300.0	15.75	202.20	4,210.8	453.40	-630.5	-257.3	-151.1	0.00	0.00	0.00
4,400.0	15.75	202.20	4,307.0	357.15	-655.7	-267.5	-157.1	0.00	0.00	0.00
4,500.0	15.75	202.20	4,403.3	260.91	-680.8	-277.8	-163.1	0.00	0.00	0.00
4,600.0	15.75	202.20	4,499.5	164.66	-705.9	-288.0	-169.1	0.00	0.00	0.00
4,700.0	15.75	202.20	4,595.8	68.42	-731.1	-298.3	-175.1	0.00	0.00	0.00
4,800.0	15.75	202.20	4,692.0	-27.83	-756.2	-308.5	-181.2	0.00	0.00	0.00
4,900.0	15.75	202.20	4,788.3	-124.08	-781.3	-318.8	-187.2	0.00	0.00	0.00
5,000.0	15.75	202.20	4,884.5	-220.32	-806.5	-329.0	-193.2	0.00	0.00	0.00

Planning Report



Database:	EDM 5000.1 Single User Db	Local Co-ordinate Reference:	Well STATE ANTELOPE C12-W42-2HNC
Company:	BONANZA CREEK ENERGY INC.	TVD Reference:	KB-EST @ 4664.2usft (Original Well Elev)
Project:	WELD COUNTY, COLORADO (NAD 83)	MD Reference:	KB-EST @ 4664.2usft (Original Well Elev)
Site:	NW NW SEC. 2 T5N R62W 6th P.M.	North Reference:	True
Well:	STATE ANTELOPE C12-W42-2HNC	Survey Calculation Method:	Minimum Curvature
Wellbore:	ORIGINAL WELLBORE		
Design:	PROPOSAL #2		

Planned Survey

MD (usft)	Inc (°)	Azi (°)	TVD (usft)	SS (usft)	+N/-S (usft)	+E/-W (usft)	Vertical Section (usft)	Dogleg Rate (°/100usft)	Build Rate (°/100usft)	Turn Rate (°/100usft)
END OF TANGENT										
5,071.4	15.75	202.20	4,953.2	-289.04	-824.4	-336.4	-197.5	0.00	0.00	0.00
5,100.0	15.18	202.20	4,980.8	-316.60	-831.5	-339.2	-199.2	2.00	-2.00	0.00
5,200.0	13.18	202.20	5,077.8	-413.55	-854.1	-348.5	-204.6	2.00	-2.00	0.00
5,300.0	11.18	202.20	5,175.5	-511.30	-873.7	-356.5	-209.3	2.00	-2.00	0.00
5,400.0	9.18	202.20	5,273.9	-609.72	-890.0	-363.1	-213.2	2.00	-2.00	0.00
5,500.0	7.18	202.20	5,372.9	-708.70	-903.2	-368.5	-216.4	2.00	-2.00	0.00
5,600.0	5.18	202.20	5,472.3	-808.11	-913.2	-372.6	-218.8	2.00	-2.00	0.00
5,700.0	3.18	202.20	5,572.0	-907.84	-919.9	-375.3	-220.4	2.00	-2.00	0.00
5,800.0	1.18	202.20	5,672.0	-1,007.76	-923.4	-376.8	-221.2	2.00	-2.00	0.00
EOD TO VERTICAL										
5,858.9	0.00	202.20	5,730.9	-1,066.67	-924.0	-377.0	-221.4	2.00	-2.00	0.00
KOP (12°/100ft BUR)										
5,888.9	0.00	0.00	5,760.9	-1,096.67	-924.0	-377.0	-221.4	0.00	0.00	0.00
5,900.0	1.33	87.84	5,772.0	-1,107.76	-924.0	-376.9	-221.2	11.97	11.97	0.00
6,000.0	13.33	87.84	5,871.0	-1,206.76	-923.5	-364.2	-208.8	12.00	12.00	0.00
6,100.0	25.33	87.84	5,965.2	-1,300.95	-922.3	-331.1	-176.4	12.00	12.00	0.00
6,200.0	37.33	87.84	6,050.4	-1,386.22	-920.3	-279.3	-125.6	12.00	12.00	0.00
6,300.0	49.33	87.84	6,123.0	-1,458.83	-917.7	-210.8	-58.4	12.00	12.00	0.00
6,400.0	61.33	87.84	6,179.8	-1,515.61	-914.6	-128.8	22.0	12.00	12.00	0.00
6,500.0	73.33	87.84	6,218.3	-1,554.09	-911.2	-36.8	112.2	12.00	12.00	0.00
START OF TANGENT										
6,513.9	75.00	87.84	6,222.1	-1,557.89	-910.7	-23.4	125.3	12.00	12.00	0.00
6,600.0	75.00	87.84	6,244.4	-1,580.17	-907.5	59.7	206.8	0.00	0.00	0.00
END OF TANGENT										
6,613.9	75.00	87.84	6,248.0	-1,583.77	-907.0	73.1	220.0	0.00	0.00	0.00
6,700.0	85.33	87.84	6,262.7	-1,598.46	-903.8	157.8	303.0	12.00	12.00	0.00
7" ICP (P2) *NEW* - STATE ANTELOPE C12-W42-2HNC										
6,738.9	90.00	87.84	6,264.2	-1,600.05	-902.4	196.6	341.1	12.00	12.00	0.00
6,800.0	90.00	87.84	6,264.2	-1,600.05	-900.1	257.7	400.9	0.00	0.00	0.00
6,900.0	90.00	87.84	6,264.2	-1,600.05	-896.3	357.6	498.9	0.00	0.00	0.00
7,000.0	90.00	87.84	6,264.2	-1,600.05	-892.5	457.5	596.9	0.00	0.00	0.00
7,100.0	90.00	87.84	6,264.2	-1,600.05	-888.8	557.5	694.8	0.00	0.00	0.00
7,200.0	90.00	87.84	6,264.2	-1,600.05	-885.0	657.4	792.8	0.00	0.00	0.00
7,300.0	90.00	87.84	6,264.2	-1,600.05	-881.2	757.3	890.8	0.00	0.00	0.00
7,400.0	90.00	87.84	6,264.2	-1,600.05	-877.5	857.2	988.8	0.00	0.00	0.00
7,500.0	90.00	87.84	6,264.2	-1,600.05	-873.7	957.2	1,086.8	0.00	0.00	0.00
7,600.0	90.00	87.84	6,264.2	-1,600.04	-869.9	1,057.1	1,184.7	0.00	0.00	0.00
7,700.0	90.00	87.84	6,264.2	-1,600.04	-866.2	1,157.0	1,282.7	0.00	0.00	0.00
7,800.0	90.00	87.84	6,264.2	-1,600.04	-862.4	1,257.0	1,380.7	0.00	0.00	0.00
7,900.0	90.00	87.84	6,264.2	-1,600.04	-858.6	1,356.9	1,478.7	0.00	0.00	0.00
8,000.0	90.00	87.84	6,264.2	-1,600.04	-854.9	1,456.8	1,576.7	0.00	0.00	0.00
8,100.0	90.00	87.84	6,264.2	-1,600.04	-851.1	1,556.7	1,674.6	0.00	0.00	0.00
8,200.0	90.00	87.84	6,264.2	-1,600.04	-847.3	1,656.7	1,772.6	0.00	0.00	0.00
8,300.0	90.00	87.84	6,264.2	-1,600.04	-843.6	1,756.6	1,870.6	0.00	0.00	0.00
8,400.0	90.00	87.84	6,264.2	-1,600.04	-839.8	1,856.5	1,968.6	0.00	0.00	0.00
8,500.0	90.00	87.84	6,264.2	-1,600.04	-836.0	1,956.5	2,066.6	0.00	0.00	0.00
8,600.0	90.00	87.84	6,264.2	-1,600.04	-832.3	2,056.4	2,164.5	0.00	0.00	0.00
8,700.0	90.00	87.84	6,264.2	-1,600.04	-828.5	2,156.3	2,262.5	0.00	0.00	0.00
8,800.0	90.00	87.84	6,264.2	-1,600.04	-824.8	2,256.2	2,360.5	0.00	0.00	0.00
8,900.0	90.00	87.84	6,264.2	-1,600.03	-821.0	2,356.2	2,458.5	0.00	0.00	0.00
9,000.0	90.00	87.85	6,264.2	-1,600.03	-817.2	2,456.1	2,556.5	0.00	0.00	0.00
9,100.0	90.00	87.85	6,264.2	-1,600.03	-813.5	2,556.0	2,654.4	0.00	0.00	0.00

Planning Report



Database:	EDM 5000.1 Single User Db	Local Co-ordinate Reference:	Well STATE ANTELOPE C12-W42-2HNC
Company:	BONANZA CREEK ENERGY INC.	TVD Reference:	KB-EST @ 4664.2usft (Original Well Elev)
Project:	WELD COUNTY, COLORADO (NAD 83)	MD Reference:	KB-EST @ 4664.2usft (Original Well Elev)
Site:	NW NW SEC. 2 T5N R62W 6th P.M.	North Reference:	True
Well:	STATE ANTELOPE C12-W42-2HNC	Survey Calculation Method:	Minimum Curvature
Wellbore:	ORIGINAL WELLBORE		
Design:	PROPOSAL #2		

Planned Survey										
MD (usft)	Inc (°)	Azi (°)	TVD (usft)	SS (usft)	+N/-S (usft)	+E/-W (usft)	Vertical Section (usft)	Dogleg Rate (°/100usft)	Build Rate (°/100usft)	Turn Rate (°/100usft)
9,200.0	90.00	87.85	6,264.2	-1,600.03	-809.7	2,656.0	2,752.4	0.00	0.00	0.00
9,300.0	90.00	87.85	6,264.2	-1,600.03	-806.0	2,755.9	2,850.4	0.00	0.00	0.00
9,400.0	90.00	87.85	6,264.2	-1,600.03	-802.2	2,855.8	2,948.4	0.00	0.00	0.00
9,500.0	90.00	87.85	6,264.2	-1,600.03	-798.4	2,955.8	3,046.4	0.00	0.00	0.00
9,600.0	90.00	87.85	6,264.2	-1,600.03	-794.7	3,055.7	3,144.3	0.00	0.00	0.00
9,700.0	90.00	87.85	6,264.2	-1,600.02	-790.9	3,155.6	3,242.3	0.00	0.00	0.00
9,800.0	90.00	87.85	6,264.2	-1,600.02	-787.2	3,255.5	3,340.3	0.00	0.00	0.00
9,900.0	90.00	87.85	6,264.2	-1,600.02	-783.4	3,355.5	3,438.3	0.00	0.00	0.00
10,000.0	90.00	87.85	6,264.2	-1,600.02	-779.7	3,455.4	3,536.3	0.00	0.00	0.00
10,100.0	90.00	87.85	6,264.2	-1,600.02	-775.9	3,555.3	3,634.2	0.00	0.00	0.00
10,200.0	90.00	87.85	6,264.2	-1,600.02	-772.1	3,655.3	3,732.2	0.00	0.00	0.00
10,300.0	90.00	87.85	6,264.2	-1,600.01	-768.4	3,755.2	3,830.2	0.00	0.00	0.00
10,400.0	90.00	87.85	6,264.2	-1,600.01	-764.6	3,855.1	3,928.2	0.00	0.00	0.00
10,500.0	90.00	87.85	6,264.2	-1,600.01	-760.9	3,955.0	4,026.2	0.00	0.00	0.00
10,600.0	90.00	87.85	6,264.2	-1,600.01	-757.1	4,055.0	4,124.2	0.00	0.00	0.00
10,700.0	90.00	87.85	6,264.2	-1,600.01	-753.4	4,154.9	4,222.1	0.00	0.00	0.00
10,800.0	90.00	87.85	6,264.2	-1,600.00	-749.6	4,254.8	4,320.1	0.00	0.00	0.00
10,900.0	90.00	87.85	6,264.2	-1,600.00	-745.9	4,354.8	4,418.1	0.00	0.00	0.00
11,000.0	90.00	87.85	6,264.2	-1,600.00	-742.1	4,454.7	4,516.1	0.00	0.00	0.00
BHL (P2) - STATE ANTELOPE C12-W42-2HNC										
11,030.8	90.00	87.85	6,264.2	-1,600.00	-741.0	4,485.5	4,546.3	0.00	0.00	0.00

Plan Annotations					
MD (usft)	TVD (usft)	Local Coordinates		Comment	
		+N/-S (usft)	+E/-W (usft)		
1,400.0	1,400.0	0.0	0.0	START NUDGE (2°/100ft BUR)	
2,187.5	2,177.6	-99.6	-40.6	EOB TO 15.75° INC	
5,071.4	4,953.2	-824.4	-336.4	END OF TANGENT	
5,858.9	5,730.9	-924.0	-377.0	EOD TO VERTICAL	
5,888.9	5,760.9	-924.0	-377.0	KOP (12°/100ft BUR)	
6,513.9	6,222.1	-910.7	-23.4	START OF TANGENT	
6,613.9	6,248.0	-907.0	73.1	END OF TANGENT	
6,738.9	6,264.2	-902.4	196.6	7" ICP (P2) *NEW* - STATE ANTELOPE C12-W42-2HNC	
11,030.8	6,264.2	-741.0	4,485.5	BHL (P2) - STATE ANTELOPE C12-W42-2HNC	