

WPX Energy Rocky Mountain, LLC
 PLAT #6_LOCATION DRAWING FOR MV 34-5
 SECTION 5, T7S, R96W, 6th P.M.

W 1/4 Cor. Sec. 4
 2012 Alum. Cap,
 1.0' High

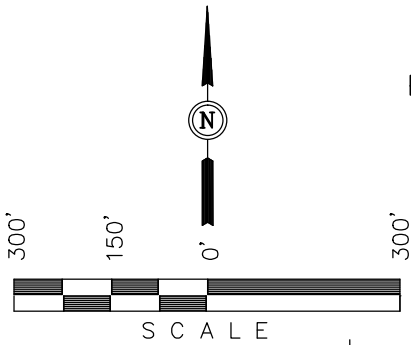
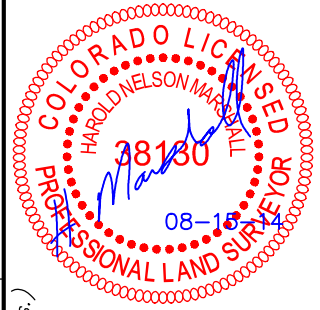

SCALE: 1" = 300'
 DATE: 07-02-14
 DRAWN BY: M.D.
 REVISED: 07-30-14
 REVISED: 08-11-14

5
 BLM
 (U.S.A.)

LOT 6
 BLM
 (U.S.A.)

LOT 7

500'
 BUFFER

WELL HEAD GM 705-34-8-HN1

(NAD 83)
 Latitude: 39.461131°
 Longitude: 108.125439°

Excess Stockpile

Proposed Road
 Re-Route

Excess Stockpile

Exist. Wetland

Exist.
 Pipeline

Exist. Road

S 1/4 Cor. Sec. 5
 1920 Brass Cap
 1.5' High

C.C.
 1920 Brass Cap,
 0.6' High, Stones

SW Cor. Sec. 4
 1920 Brass Cap,
 0.8' High, Pile
 of Stones

C.C. 1920 Brass Cap,
 1.0' High, Rebar

N89°50'05"W - 2492.44'
 (Meas. to C.C.)

N89°50'05"W - 2492.37'
 (Meas. to True)

BLM
 (U.S.A.)

LOT 1

LINE TABLE

LINE	DIRECTION	LENGTH
L1	N00°02'55"E	129.07'
L2	N89°51'16"W	115.68'

8

CURRENT LAND USE

<input type="checkbox"/> CROP LAND	<input checked="" type="checkbox"/> NON CROP LAND	<input type="checkbox"/> SUBDIVIDED
<input type="checkbox"/> IRRIGATED	<input checked="" type="checkbox"/> RANGELAND	<input type="checkbox"/> INDUSTRIAL
<input type="checkbox"/> DRY LAND	<input type="checkbox"/> TIMBER	<input type="checkbox"/> COMMERCIAL
<input type="checkbox"/> IMPROVE PASTURE	<input type="checkbox"/> RECREATIONAL	<input type="checkbox"/> RESIDENTIAL
<input type="checkbox"/> HAY MEADOW	<input type="checkbox"/> OTHER (Desc.):	
<input type="checkbox"/> CRP		

UINTAH ENGINEERING & LAND SURVEYING
 85 So. 200 East * Vernal, Utah 84078 * (435) 789-1017

WPX Energy Rocky Mountain, LLC

PLAT #6A_CURRENT FOOTAGE FOR MV 34-5
SECTION 5, T7S, R96W, 6th P.M.

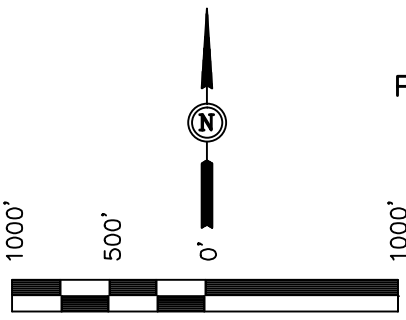

SCALE
SCALE: 1" = 1000'
DATE: 07-02-14
DRAWN BY: M.D.
REVISED: 07-30-14
REVISED: 08-11-14
REVISED: 10-10-14

LINE TABLE		
LINE	DIRECTION	LENGTH
L1	N00°02'55"E	129.07'
L2	N89°51'16"W	115.68'
L3	N01°59'39"W	49.05'

Section Corner
Re-Established by
Double Proportion
Method

**CHEVRON
USA INC**

WELL HEAD GM 705-34-8-HN1
(NAD 83)
Latitude: 39.461131°
Longitude: 108.125439°

GM 34-5
N Az. 280.7588°
1468 ft
GM 334-5
N Az. 268.0830°
1433 ft
GM 434-5
N Az. 255.8258°
1468 ft

**BLM
(U.S.A.)**

GM 43-5
N Az. 357.3213°
1751 ft
GM 343-5
N Az. 345.4977°
1390 ft

LOT 6

GM 443-5
N Az. 355.9183°
929 ft
GM 344-5
N Az. 10.8809°
439 ft

LOT 7

GM 444-5
N Az. 188.9147°
278 ft
MV 34-5
N Az. 186.6947°
41 ft

GM 544-5
N Az. 179.2097°
551 ft
GM 444-5
N Az. 188.9147°
278 ft

GM 705-34-8-HN2
N Az. 179.9178°
357 ft
End Of Completions
N Az. 179.9178°
6378 ft

GM 705-34-8-HN1
N Az. 180.1353°
6371 ft
GM 705-44-8-HN1
N Az. 179.7997°
6391 ft

GM 705-44-8-HN1
N Az. 179.7997°
347 ft

End Of Completions
N Az. 179.7997°
6391 ft

End Of Completions
N Az. 179.7997°
6391 ft

End Of Completions
N Az. 179.7997°
6391 ft

End Of Completions
N Az. 179.7997°
6391 ft

End Of Completions
N Az. 179.7997°
6391 ft

End Of Completions
N Az. 179.7997°
6391 ft

End Of Completions
N Az. 179.7997°
6391 ft

End Of Completions
N Az. 179.7997°
6391 ft

End Of Completions
N Az. 179.7997°
6391 ft

End Of Completions
N Az. 179.7997°
6391 ft

End Of Completions
N Az. 179.7997°
6391 ft

End Of Completions
N Az. 179.7997°
6391 ft

End Of Completions
N Az. 179.7997°
6391 ft

End Of Completions
N Az. 179.7997°
6391 ft

End Of Completions
N Az. 179.7997°
6391 ft

End Of Completions
N Az. 179.7997°
6391 ft

End Of Completions
N Az. 179.7997°
6391 ft

End Of Completions
N Az. 179.7997°
6391 ft

S89°57'09"W - 2645.43' (Meas.)

Landing Points (LP)
A: GM 705-34-8-HN1
Landing Point
N Az. 311.9525°
1384 ft
B: GM 705-34-8-HN2
Landing Point
N Az. 335.1153°
1006 ft
C: GM 705-44-8-HN1
Landing Point
N Az. 11.7386°
925 ft

Target Bottom Hole (TBH)
A: GM 544-5
N Az. 179.2097°
551 ft
B: GM 444-5
N Az. 188.9147°
278 ft
C: MV 34-5
N Az. 11.7386°
41 ft

N89°50'05"W - 2492.44' (Meas. to C.C.)
N89°50'05"W - 2492.37' (Meas. to True)

Proposed Road
Re-Route

LOT 1

N00°10'07"E - 5137.08' (Meas. to C.C.)
S00°10'07"W - 5138.03' (Meas. to True)

**PUCKETT
LAND
COMPANY**

**BLM
(U.S.A.)**

1920 Brass Cap,
0.1' High

N89°53'40"W - 2615.75' (Meas.)

Brass Cap

N88°57'42"W - 2640.43' (Meas.)

SW Cor. Sec. 9
1920 Brass Cap,
0.1' High
1920 Brass Cap,
1.0' High

CURRENT LAND USE

<input type="checkbox"/> CROP LAND	<input checked="" type="checkbox"/> NON CROP LAND	<input type="checkbox"/> SUBDIVIDED
<input type="checkbox"/> IRRIGATED	<input checked="" type="checkbox"/> RANGELAND	<input type="checkbox"/> INDUSTRIAL
<input type="checkbox"/> DRY LAND	<input type="checkbox"/> TIMBER	<input type="checkbox"/> COMMERCIAL
<input type="checkbox"/> IMPROVE PASTURE	<input type="checkbox"/> RECREATIONAL	<input type="checkbox"/> RESIDENTIAL
<input type="checkbox"/> HAY MEADOW	<input type="checkbox"/> OTHER (Desc.):	
<input type="checkbox"/> CRP		

UINTAH ENGINEERING & LAND SURVEYING
85 So. 200 East * Vernal, Utah 84078 * (435) 789-1017

WPX Energy Rocky Mountain, LLC

PLAT #6B_LOCATION TABLE FOR MV 34-5
SECTION 5, T7S, R96W, 6th P.M.

SCALE: 1" = 60'
DATE: 07-02-14
DRAWN BY: M.D.
REVISED: 07-30-14 M.D.
REVISED: 08-12-14 M.D.

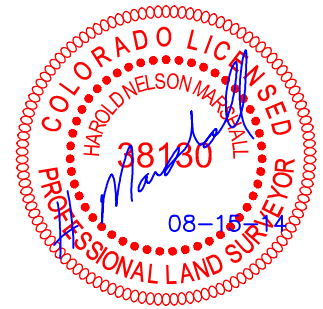

DISTANCES FROM WELL HEAD(S) (IN FEET)

Description	Building	Building Unit	High Occu. Building	DOAA	Public Road	Above Ground Utility	Railroad	Property Line
GM 705-44-8-HN1	>5280	>5280	>5280	>5280	>5280	>5280	>5280	WEST 1642
GM 705-34-8-HN2	>5280	>5280	>5280	>5280	>5280	>5280	>5280	WEST 1637
GM 705-34-8-HN1	>5280	>5280	>5280	>5280	>5280	>5280	>5280	WEST 1632
GM 43-5	>5280	>5280	>5280	>5280	>5280	>5280	>5280	WEST 1612
GM 443-5	>5280	>5280	>5280	>5280	>5280	>5280	>5280	WEST 1608
GM 343-5	>5280	>5280	>5280	>5280	>5280	>5280	>5280	WEST 1604
GM 333-5	>5280	>5280	>5280	>5280	>5280	>5280	>5280	WEST 1600
GM 433-5	>5280	>5280	>5280	>5280	>5280	>5280	>5280	WEST 1596
GM 533-5	>5280	>5280	>5280	>5280	>5280	>5280	>5280	WEST 1592
GM 34-5	>5280	>5280	>5280	>5280	>5280	>5280	>5280	WEST 1588
GM 334-5	>5280	>5280	>5280	>5280	>5280	>5280	>5280	WEST 1584
GM 434-5	>5280	>5280	>5280	>5280	>5280	>5280	>5280	WEST 1581
MV 34-5	>5280	>5280	>5280	>5280	>5280	>5280	>5280	WEST 1589
GM 33-5	>5280	>5280	>5280	>5280	>5280	>5280	>5280	WEST 1597
GM 344-5	>5280	>5280	>5280	>5280	>5280	>5280	>5280	WEST 1605
GM 544-5	>5280	>5280	>5280	>5280	>5280	>5280	>5280	WEST 1613
GM 444-5	>5280	>5280	>5280	>5280	>5280	>5280	>5280	WEST 1621

DISTANCES FROM PRODUCTION EQUIPMENT (IN FEET)

Description	Building	Building Unit	High Occu. Building	DOAA	Public Road	Above Ground Utility	Railroad	Property Line
TANKS	>5280	>5280	>5280	>5280	>5280	>5280	>5280	WEST 1625
SEPARATORS	>5280	>5280	>5280	>5280	>5280	>5280	>5280	WEST 1594