

# KERR-MCGEE OIL & GAS ONSHORE LP

Location: COLORADO Slot: SLOT#23 DOLPH 15C-1HZ (470°FNL & 2225°FWL, SEC.1)  
 Field: WELD COUNTY (KERR MCGEE) Well: DOLPH 15C-1HZ  
 Facility: SEC.01-T2N-R66W Wellbore: DOLPH 15C-1HZ PWB



Plot reference wellpath is DOLPH 15C-1HZ (REV-C.0) PWP

True vertical depths are referenced to ENSIGN 145 (13KB) (RKB)

Grid System: NAD83 / Lambert Colorado SP, Northern Zone (S01), US feet

Measured depths are referenced to ENSIGN 145 (13KB) (RKB)

North Reference: True north

ENSGN 145 (13KB) (RKB) to Mean Sea Level: 5026 feet

Scale: True distance

Mean Sea Level to Mud line (At Slot: SLOT#23 DOLPH 15C-1HZ (470°FNL & 2225°FWL, SEC.1): 0 feet

Depths are in feet

Coordinates are in feet referenced to Slot

Created by: precain on 14/Oct/2014

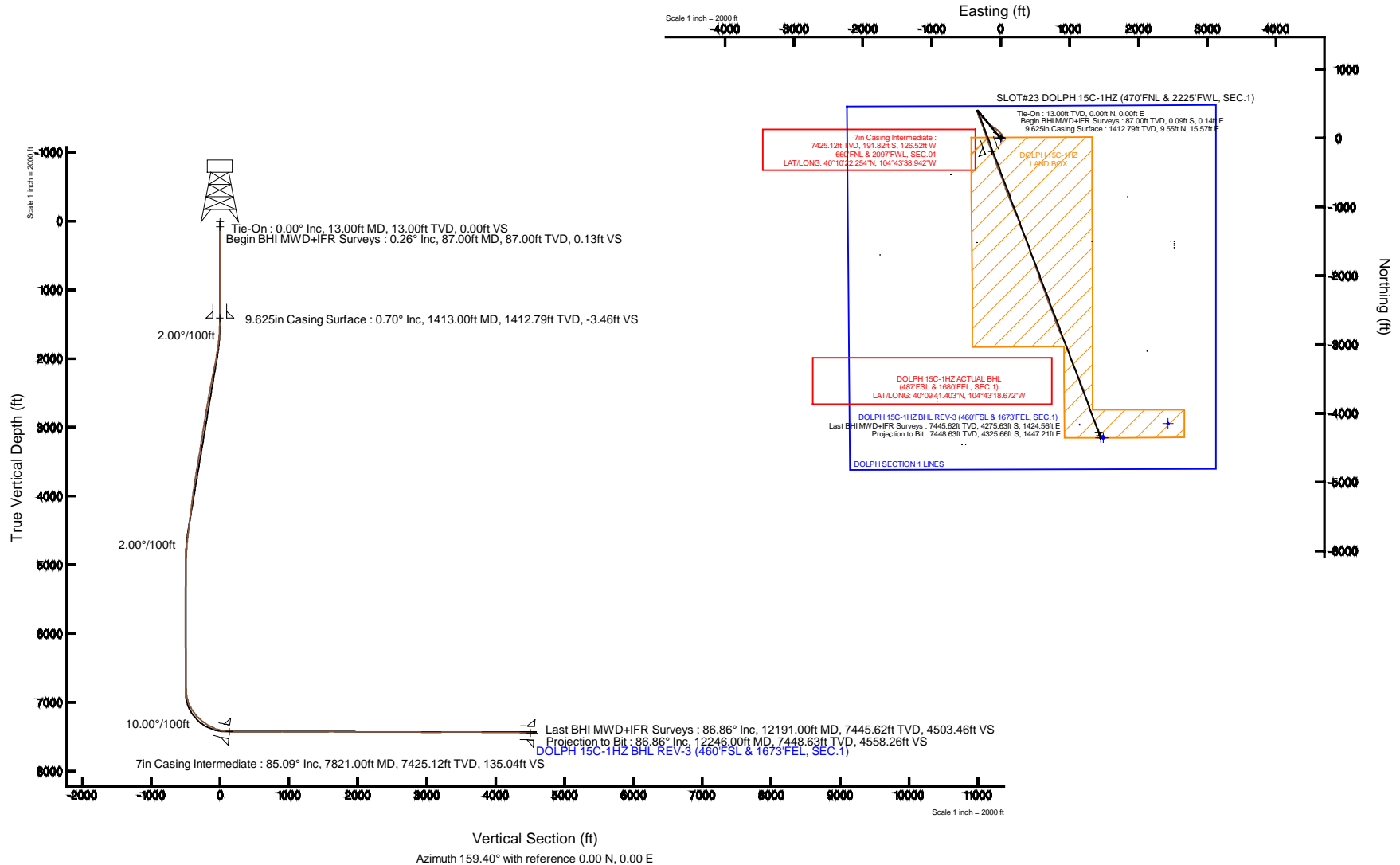

# Actual Wellpath Report

DOLPH 15C-1HZ AWP

Page 1 of 7

REFERENCE WELLPATH IDENTIFICATION			
Operator	KERR-MCGEE OIL & GAS ONSHORE LP	Slot	SLOT#23 DOLPH 15C-1HZ (470'FNL & 2225'FWL, SEC.1)
Area	COLORADO	Well	DOLPH 15C-1HZ
Field	WELD COUNTY (KERR MCGEE)	Wellbore	DOLPH 15C-1HZ AWB
Facility	SEC.01-T2N-R66W		

REPORT SETUP INFORMATION			
Projection System	NAD83 / Lambert Colorado SP, Northern Zone (501), US feet	Software System	WellArchitect® 4.0.0
North Reference	True	User	Precain
Scale	0.999958	Report Generated	14/Oct/2014 at 15:31
Convergence at slot	n/a	Database/Source file	WellArchitectDB/DOLPH_15C-1HZ_AWB.xml

WELLPATH LOCATION						
	Local coordinates		Grid coordinates		Geographic coordinates	
	North[ft]	East[ft]	Easting[US ft]	Northing[US ft]	Latitude	Longitude
Slot Location	3786.89	919.09	3215996.75	1306944.86	40°10'24.150"N	104°43'37.312"W
Facility Reference Pt			3215110.60	1303150.30	40°09'46.728"N	104°43'49.152"W
Field Reference Pt			3197771.84	1268891.29	40°04'09.600"N	104°47'36.000"W

WELLPATH DATUM			
Calculation method	Minimum curvature	ENSIGN 145 (13'KB) (RKB) to Facility Vertical Datum	5026.00ft
Horizontal Reference Pt	Slot	ENSIGN 145 (13'KB) (RKB) to Mean Sea Level	5026.00ft
Vertical Reference Pt	ENSIGN 145 (13'KB) (RKB)	ENSIGN 145 (13'KB) (RKB) to Mud Line at Slot (SLOT#23 DOLPH 15C-1HZ (470'FNL & 2225'FWL, SEC.1))	5026.00ft
MD Reference Pt	ENSIGN 145 (13'KB) (RKB)	Section Origin	N 0.00, E 0.00 ft
Field Vertical Reference	Mean Sea Level	Section Azimuth	159.40°

# Actual Wellpath Report

DOLPH 15C-1HZ AWP

Page 2 of 7

REFERENCE WELLPATH IDENTIFICATION			
Operator	KERR-MCGEE OIL & GAS ONSHORE LP	Slot	SLOT#23 DOLPH 15C-1HZ (470'FNL & 2225'FWL, SEC.1)
Area	COLORADO	Well	DOLPH 15C-1HZ
Field	WELD COUNTY (KERR MCGEE)	Wellbore	DOLPH 15C-1HZ AWB
Facility	SEC.01-T2N-R66W		

## WELLPATH DATA (148 stations) † = interpolated/extrapolated station

MD [ft]	Inclination [°]	Azimuth [°]	TVD [ft]	Vert Sect [ft]	North [ft]	East [ft]	Latitude	Longitude	DLS [°/100ft]	Comments
0.00†	0.000	121.250	0.00	0.00	0.00	0.00	40°10'24.150"N	104°43'37.312"W	0.00	
13.00	0.000	121.250	13.00	0.00	0.00	0.00	40°10'24.150"N	104°43'37.312"W	0.00	Tie-On
87.00	0.260	121.250	87.00	0.13	-0.09	0.14	40°10'24.149"N	104°43'37.310"W	0.35	Begin BHI MWD+IFR Surveys
178.00	0.510	98.090	178.00	0.49	-0.25	0.72	40°10'24.148"N	104°43'37.303"W	0.32	
270.00	0.710	94.610	269.99	0.93	-0.35	1.69	40°10'24.146"N	104°43'37.290"W	0.22	
361.00	0.460	126.040	360.99	1.47	-0.61	2.55	40°10'24.144"N	104°43'37.279"W	0.44	
453.00	0.680	114.080	452.98	2.17	-1.05	3.35	40°10'24.140"N	104°43'37.269"W	0.27	
545.00	0.660	92.720	544.98	2.76	-1.30	4.38	40°10'24.137"N	104°43'37.256"W	0.27	
637.00	1.620	54.020	636.96	2.62	-0.56	5.96	40°10'24.144"N	104°43'37.235"W	1.28	
729.00	2.130	46.040	728.91	1.60	1.39	8.24	40°10'24.164"N	104°43'37.206"W	0.62	
821.00	1.300	43.490	820.87	0.47	3.33	10.19	40°10'24.183"N	104°43'37.181"W	0.91	
913.00	1.540	55.810	912.84	-0.28	4.78	11.93	40°10'24.197"N	104°43'37.158"W	0.42	
974.00	1.410	49.890	973.82	-0.72	5.73	13.18	40°10'24.207"N	104°43'37.142"W	0.33	
1067.00	0.730	48.030	1066.80	-1.32	6.86	14.50	40°10'24.218"N	104°43'37.125"W	0.73	
1161.00	0.420	334.150	1160.80	-1.88	7.57	14.79	40°10'24.225"N	104°43'37.121"W	0.78	
1258.00	0.680	9.680	1257.79	-2.73	8.46	14.74	40°10'24.234"N	104°43'37.122"W	0.43	
1365.00	0.440	48.360	1364.79	-3.43	9.36	15.15	40°10'24.242"N	104°43'37.117"W	0.41	
1436.00	0.850	82.520	1435.79	-3.41	9.61	15.88	40°10'24.245"N	104°43'37.107"W	0.77	
1467.00	0.760	69.460	1466.78	-3.35	9.71	16.30	40°10'24.246"N	104°43'37.102"W	0.66	
1561.00	2.640	349.690	1560.74	-5.48	12.06	16.49	40°10'24.269"N	104°43'37.100"W	2.78	
1654.00	4.740	345.510	1653.55	-11.41	17.89	15.15	40°10'24.327"N	104°43'37.117"W	2.28	
1748.00	6.260	340.320	1747.11	-20.40	26.47	12.45	40°10'24.412"N	104°43'37.152"W	1.70	
1842.00	7.820	344.030	1840.40	-31.90	37.45	8.96	40°10'24.520"N	104°43'37.197"W	1.73	
1935.00	9.260	344.460	1932.37	-45.66	50.74	5.22	40°10'24.651"N	104°43'37.245"W	1.55	
2028.00	10.720	333.740	2023.96	-61.72	65.71	-0.61	40°10'24.799"N	104°43'37.320"W	2.54	
2122.00	11.660	325.230	2116.18	-79.63	81.35	-9.90	40°10'24.954"N	104°43'37.440"W	2.02	
2215.00	12.630	315.610	2207.11	-98.05	96.34	-22.37	40°10'25.102"N	104°43'37.600"W	2.41	
2309.00	13.560	310.010	2298.67	-117.06	110.77	-38.00	40°10'25.245"N	104°43'37.802"W	1.67	
2402.00	12.340	304.590	2389.30	-134.72	123.42	-54.54	40°10'25.370"N	104°43'38.015"W	1.85	
2496.00	12.310	303.610	2481.14	-151.09	134.67	-71.15	40°10'25.481"N	104°43'38.229"W	0.22	
2591.00	11.860	301.090	2574.03	-166.97	145.32	-87.95	40°10'25.586"N	104°43'38.445"W	0.73	
2684.00	11.240	304.510	2665.15	-181.90	155.39	-103.60	40°10'25.686"N	104°43'38.647"W	0.99	
2774.00	11.020	309.580	2753.46	-196.56	165.84	-117.46	40°10'25.789"N	104°43'38.825"W	1.11	
2864.00	11.190	307.700	2841.77	-211.45	176.66	-131.00	40°10'25.896"N	104°43'39.000"W	0.44	
2954.00	11.160	315.280	2930.07	-226.83	188.19	-144.03	40°10'26.010"N	104°43'39.168"W	1.63	
3044.00	9.640	314.690	3018.59	-241.63	199.68	-155.52	40°10'26.123"N	104°43'39.315"W	1.69	
3134.00	9.850	314.740	3107.29	-255.47	210.39	-166.35	40°10'26.229"N	104°43'39.455"W	0.23	
3224.00	9.850	312.910	3195.96	-269.36	221.05	-177.45	40°10'26.334"N	104°43'39.598"W	0.35	
3314.00	9.720	312.510	3284.66	-283.02	231.43	-188.69	40°10'26.437"N	104°43'39.743"W	0.16	
3404.00	9.590	319.340	3373.38	-296.84	242.25	-199.18	40°10'26.544"N	104°43'39.878"W	1.28	
3494.00	11.180	318.360	3461.91	-312.03	254.46	-209.86	40°10'26.665"N	104°43'40.016"W	1.78	
3584.00	10.980	313.190	3550.23	-327.86	266.85	-221.91	40°10'26.787"N	104°43'40.171"W	1.13	
3674.00	10.110	309.450	3638.71	-342.39	277.73	-234.26	40°10'26.895"N	104°43'40.330"W	1.23	
3764.00	9.570	312.840	3727.39	-355.93	287.84	-245.84	40°10'26.994"N	104°43'40.479"W	0.88	
3854.00	9.680	315.630	3816.12	-369.55	298.33	-256.62	40°10'27.098"N	104°43'40.618"W	0.53	

REFERENCE WELLPATH IDENTIFICATION			
Operator	KERR-MCGEE OIL & GAS ONSHORE LP	Slot	SLOT#23 DOLPH 15C-1HZ (470'FNL & 2225'FWL, SEC.1)
Area	COLORADO	Well	DOLPH 15C-1HZ
Field	WELD COUNTY (KERR MCGEE)	Wellbore	DOLPH 15C-1HZ AWB
Facility	SEC.01-T2N-R66W		

### WELLPATH DATA (148 stations)

MD [ft]	Inclination [°]	Azimuth [°]	TVD [ft]	Vert Sect [ft]	North [ft]	East [ft]	Latitude	Longitude	DLS [°/100ft]	Comments
3944.00	8.340	318.300	3905.01	-382.56	308.62	-266.25	40°10'27.200"N	104°43'40.742"W	1.56	
4034.00	7.990	326.880	3994.10	-394.76	318.73	-274.01	40°10'27.300"N	104°43'40.842"W	1.41	
4124.00	7.380	324.970	4083.29	-406.46	328.70	-280.75	40°10'27.398"N	104°43'40.929"W	0.73	
4214.00	7.310	323.660	4172.55	-417.57	338.05	-287.46	40°10'27.491"N	104°43'41.015"W	0.20	
4304.00	7.510	323.280	4261.80	-428.73	347.37	-294.37	40°10'27.583"N	104°43'41.104"W	0.23	
4394.00	7.440	322.170	4351.04	-439.95	356.69	-301.46	40°10'27.675"N	104°43'41.196"W	0.18	
4484.00	7.050	322.870	4440.32	-450.81	365.70	-308.37	40°10'27.764"N	104°43'41.285"W	0.44	
4574.00	6.740	324.820	4529.67	-461.22	374.42	-314.74	40°10'27.850"N	104°43'41.367"W	0.43	
4664.00	6.730	325.450	4619.05	-471.44	383.08	-320.78	40°10'27.936"N	104°43'41.444"W	0.08	
4754.00	5.190	312.660	4708.56	-480.20	390.18	-326.76	40°10'28.006"N	104°43'41.521"W	2.25	
4844.00	3.760	315.130	4798.28	-486.52	395.03	-331.84	40°10'28.054"N	104°43'41.587"W	1.60	
4934.00	3.730	306.170	4888.09	-491.66	398.85	-336.28	40°10'28.091"N	104°43'41.644"W	0.65	
5024.00	1.990	314.170	4977.98	-495.53	401.66	-339.77	40°10'28.119"N	104°43'41.689"W	1.98	
5114.00	1.250	259.220	5067.95	-497.11	402.57	-341.85	40°10'28.128"N	104°43'41.716"W	1.81	
5204.00	1.150	16.010	5157.94	-498.00	403.25	-342.57	40°10'28.135"N	104°43'41.725"W	2.27	
5294.00	0.430	359.580	5247.93	-499.04	404.46	-342.32	40°10'28.147"N	104°43'41.722"W	0.83	
5384.00	0.870	327.970	5337.92	-500.03	405.38	-342.69	40°10'28.156"N	104°43'41.727"W	0.61	
5474.00	0.850	299.650	5427.91	-501.21	406.29	-343.63	40°10'28.165"N	104°43'41.739"W	0.47	
5564.00	0.420	78.010	5517.91	-501.68	406.69	-343.89	40°10'28.169"N	104°43'41.742"W	1.33	
5654.00	0.260	13.150	5607.91	-501.80	406.95	-343.52	40°10'28.171"N	104°43'41.737"W	0.43	
5744.00	0.300	84.390	5697.91	-501.90	407.18	-343.24	40°10'28.174"N	104°43'41.734"W	0.36	
5924.00	0.150	173.130	5877.90	-501.55	406.99	-342.74	40°10'28.172"N	104°43'41.727"W	0.18	
6104.00	0.240	197.160	6057.90	-501.03	406.39	-342.82	40°10'28.166"N	104°43'41.728"W	0.07	
6284.00	0.790	137.430	6237.90	-499.58	405.12	-342.09	40°10'28.153"N	104°43'41.719"W	0.39	
6374.00	0.590	133.670	6327.89	-498.59	404.34	-341.34	40°10'28.146"N	104°43'41.709"W	0.23	
6554.00	1.140	129.820	6507.87	-496.19	402.56	-339.29	40°10'28.128"N	104°43'41.683"W	0.31	
6644.00	1.100	216.580	6597.86	-494.95	401.29	-339.12	40°10'28.116"N	104°43'41.681"W	1.71	
6734.00	1.100	201.340	6687.84	-493.84	399.79	-339.95	40°10'28.101"N	104°43'41.691"W	0.32	
6824.00	1.000	200.310	6777.83	-492.60	398.25	-340.54	40°10'28.085"N	104°43'41.699"W	0.11	
6869.00	1.980	183.480	6822.81	-491.59	397.10	-340.72	40°10'28.074"N	104°43'41.701"W	2.36	
6914.00	6.260	167.460	6867.68	-488.45	393.93	-340.23	40°10'28.043"N	104°43'41.695"W	9.76	
6959.00	10.430	165.830	6912.20	-481.97	387.59	-338.70	40°10'27.980"N	104°43'41.675"W	9.28	
7004.00	14.800	163.050	6956.10	-472.18	378.13	-336.03	40°10'27.887"N	104°43'41.641"W	9.80	
7049.00	19.470	160.470	6999.09	-458.94	365.56	-331.84	40°10'27.762"N	104°43'41.587"W	10.51	
7094.00	24.440	160.120	7040.82	-442.13	349.73	-326.17	40°10'27.606"N	104°43'41.514"W	11.05	
7139.00	29.280	159.130	7080.95	-421.80	330.68	-319.08	40°10'27.418"N	104°43'41.423"W	10.80	
7184.00	33.430	160.820	7119.37	-398.39	308.68	-311.08	40°10'27.200"N	104°43'41.319"W	9.43	
7229.00	37.040	159.840	7156.12	-372.44	284.24	-302.33	40°10'26.959"N	104°43'41.207"W	8.12	
7274.00	41.000	158.330	7191.08	-344.12	257.79	-292.21	40°10'26.697"N	104°43'41.076"W	9.05	
7319.00	45.650	159.060	7223.80	-313.25	229.03	-281.00	40°10'26.413"N	104°43'40.932"W	10.39	
7364.00	49.350	158.980	7254.20	-280.08	198.06	-269.12	40°10'26.107"N	104°43'40.779"W	8.22	
7409.00	52.780	159.580	7282.48	-245.08	165.32	-256.75	40°10'25.784"N	104°43'40.619"W	7.69	
7454.00	56.320	159.550	7308.57	-208.43	130.97	-243.95	40°10'25.444"N	104°43'40.455"W	7.87	
7499.00	60.240	160.130	7332.23	-170.16	95.05	-230.76	40°10'25.089"N	104°43'40.285"W	8.78	
7544.00	63.710	160.880	7353.37	-130.45	57.61	-217.51	40°10'24.719"N	104°43'40.114"W	7.85	

REFERENCE WELLPATH IDENTIFICATION			
Operator	KERR-MCGEE OIL & GAS ONSHORE LP	Slot	SLOT#23 DOLPH 15C-1HZ (470'FNL & 2225'FWL, SEC.1)
Area	COLORADO	Well	DOLPH 15C-1HZ
Field	WELD COUNTY (KERR MCGEE)	Wellbore	DOLPH 15C-1HZ AWB
Facility	SEC.01-T2N-R66W		

WELLPATH DATA (148 stations) † = interpolated/extrapolated station										
MD [ft]	Inclination [°]	Azimuth [°]	TVD [ft]	Vert Sect [ft]	North [ft]	East [ft]	Latitude	Longitude	DLS [°/100ft]	Comments
7589.00	66.800	161.080	7372.20	-89.60	18.97	-204.20	40°10'24.337"N	104°43'39.943"W	6.88	
7634.00	70.640	160.760	7388.53	-47.70	-20.65	-190.49	40°10'23.946"N	104°43'39.766"W	8.56	
7679.00	74.210	160.560	7402.11	-4.81	-61.12	-176.28	40°10'23.546"N	104°43'39.583"W	7.94	
7724.00	78.510	159.500	7412.72	38.90	-102.21	-161.35	40°10'23.140"N	104°43'39.391"W	9.83	
7769.00	83.040	158.450	7419.94	83.31	-143.66	-145.42	40°10'22.730"N	104°43'39.185"W	10.33	
7786.00	84.130	158.310	7421.84	100.20	-159.36	-139.19	40°10'22.575"N	104°43'39.105"W	6.46	
7821.00†	85.092	159.040	7425.12	135.04	-191.82	-126.52	40°10'22.254"N	104°43'38.942"W	3.45	7" Casing Point
7846.00	85.780	159.560	7427.11	159.96	-215.13	-117.71	40°10'22.024"N	104°43'38.828"W	3.45	
7891.00	87.680	159.480	7429.68	204.89	-257.22	-101.99	40°10'21.608"N	104°43'38.626"W	4.23	
7981.00	89.690	159.620	7431.74	294.86	-341.52	-70.56	40°10'20.775"N	104°43'38.221"W	2.24	
8071.00	89.750	159.180	7432.18	384.86	-425.76	-38.89	40°10'19.943"N	104°43'37.813"W	0.49	
8161.00	90.700	159.760	7431.83	474.85	-510.05	-7.33	40°10'19.110"N	104°43'37.406"W	1.24	
8251.00	90.180	159.310	7431.14	564.85	-594.36	24.14	40°10'18.276"N	104°43'37.001"W	0.76	
8341.00	91.750	159.750	7429.62	654.83	-678.66	55.61	40°10'17.443"N	104°43'36.596"W	1.81	
8431.00	91.170	159.490	7427.33	744.80	-763.00	86.94	40°10'16.610"N	104°43'36.192"W	0.71	
8521.00	90.860	158.610	7425.74	834.79	-847.04	119.11	40°10'15.780"N	104°43'35.778"W	1.04	
8611.00	89.840	157.910	7425.19	924.77	-930.63	152.45	40°10'14.953"N	104°43'35.348"W	1.37	
8701.00	89.620	157.410	7425.61	1014.72	-1013.88	186.65	40°10'14.131"N	104°43'34.908"W	0.61	
8791.00	89.410	157.810	7426.37	1104.68	-1097.09	220.93	40°10'13.309"N	104°43'34.466"W	0.50	
8881.00	89.840	158.200	7426.96	1194.65	-1180.54	254.64	40°10'12.484"N	104°43'34.032"W	0.65	
8971.00	90.640	158.880	7426.58	1284.64	-1264.30	287.57	40°10'11.656"N	104°43'33.608"W	1.17	
9060.00	90.270	158.870	7425.88	1373.63	-1347.31	319.64	40°10'10.836"N	104°43'33.195"W	0.42	
9151.00	89.870	159.370	7425.77	1464.63	-1432.34	352.08	40°10'09.996"N	104°43'32.777"W	0.70	
9241.00	90.610	159.940	7425.39	1554.62	-1516.72	383.37	40°10'09.162"N	104°43'32.374"W	1.04	
9331.00	89.720	159.620	7425.13	1644.62	-1601.17	414.47	40°10'08.327"N	104°43'31.973"W	1.05	
9421.00	89.200	159.530	7425.98	1734.62	-1685.51	445.88	40°10'07.494"N	104°43'31.568"W	0.59	
9511.00	89.810	160.480	7426.76	1824.61	-1770.08	476.65	40°10'06.658"N	104°43'31.172"W	1.25	
9601.00	90.060	161.580	7426.86	1914.57	-1855.19	505.91	40°10'05.817"N	104°43'30.795"W	1.25	
9691.00	90.400	161.070	7426.50	2004.52	-1940.45	534.72	40°10'04.974"N	104°43'30.424"W	0.68	
9781.00	89.750	159.850	7426.38	2094.50	-2025.27	564.83	40°10'04.136"N	104°43'30.036"W	1.54	
9871.00	89.290	159.500	7427.13	2184.49	-2109.66	596.08	40°10'03.302"N	104°43'29.634"W	0.64	
9961.00	89.260	160.500	7428.27	2274.48	-2194.22	626.86	40°10'02.467"N	104°43'29.237"W	1.11	
10051.00	88.950	159.430	7429.68	2364.46	-2278.77	657.69	40°10'01.631"N	104°43'28.840"W	1.24	
10141.00	90.000	160.300	7430.50	2454.46	-2363.26	688.67	40°10'00.796"N	104°43'28.441"W	1.52	
10231.00	89.870	159.290	7430.60	2544.45	-2447.72	719.76	40°09'59.961"N	104°43'28.041"W	1.13	
10321.00	89.500	158.850	7431.10	2634.45	-2531.78	751.91	40°09'59.131"N	104°43'27.627"W	0.64	
10411.00	90.180	159.850	7431.35	2724.45	-2616.00	783.64	40°09'58.299"N	104°43'27.218"W	1.34	
10501.00	89.470	158.850	7431.63	2814.44	-2700.21	815.38	40°09'57.466"N	104°43'26.809"W	1.36	
10591.00	89.380	157.360	7432.53	2904.41	-2783.71	848.94	40°09'56.641"N	104°43'26.377"W	1.66	
10681.00	88.700	156.420	7434.04	2994.31	-2866.48	884.26	40°09'55.823"N	104°43'25.922"W	1.29	
10771.00	90.490	156.970	7434.67	3084.21	-2949.13	919.86	40°09'55.006"N	104°43'25.463"W	2.08	
10861.00	91.170	157.100	7433.37	3174.12	-3031.99	954.98	40°09'54.188"N	104°43'25.011"W	0.77	
10951.00	92.330	158.290	7430.62	3264.04	-3115.21	989.12	40°09'53.365"N	104°43'24.572"W	1.85	
11041.00	91.110	157.180	7427.92	3353.95	-3198.46	1023.20	40°09'52.543"N	104°43'24.133"W	1.83	
11131.00	89.870	158.970	7427.15	3443.92	-3281.94	1056.80	40°09'51.718"N	104°43'23.700"W	2.42	

# Actual Wellpath Report

DOLPH 15C-1HZ AWP

Page 5 of 7

REFERENCE WELLPATH IDENTIFICATION			
Operator	KERR-MCGEE OIL & GAS ONSHORE LP	Slot	SLOT#23 DOLPH 15C-1HZ (470'FNL & 2225'FWL, SEC.1)
Area	COLORADO	Well	DOLPH 15C-1HZ
Field	WELD COUNTY (KERR MCGEE)	Wellbore	DOLPH 15C-1HZ AWB
Facility	SEC.01-T2N-R66W		

WELLPATH DATA (148 stations)										
MD [ft]	Inclination [°]	Azimuth [°]	TVD [ft]	Vert Sect [ft]	North [ft]	East [ft]	Latitude	Longitude	DLS [°/100ft]	Comments
11221.00	89.440	158.310	7427.69	3533.91	-3365.76	1089.58	40°09'50.889"N	104°43'23.278"W	0.88	
11311.00	89.690	158.770	7428.37	3623.90	-3449.52	1122.51	40°09'50.062"N	104°43'22.854"W	0.58	
11401.00	88.270	160.030	7429.98	3713.88	-3533.74	1154.17	40°09'49.229"N	104°43'22.446"W	2.11	
11491.00	87.680	159.660	7433.16	3803.82	-3618.18	1185.16	40°09'48.395"N	104°43'22.047"W	0.77	
11581.00	89.230	160.440	7435.58	3893.78	-3702.75	1215.85	40°09'47.559"N	104°43'21.651"W	1.93	
11671.00	89.720	160.830	7436.41	3983.75	-3787.65	1245.70	40°09'46.720"N	104°43'21.267"W	0.70	
11761.00	89.350	161.210	7437.14	4073.71	-3872.75	1274.97	40°09'45.879"N	104°43'20.890"W	0.59	
11851.00	89.030	160.870	7438.41	4163.67	-3957.86	1304.20	40°09'45.038"N	104°43'20.514"W	0.52	
11941.00	90.030	159.980	7439.15	4253.65	-4042.66	1334.36	40°09'44.200"N	104°43'20.125"W	1.49	
12032.00	88.950	159.750	7439.96	4344.64	-4128.09	1365.68	40°09'43.356"N	104°43'19.722"W	1.21	
12122.00	87.880	158.520	7442.45	4434.60	-4212.15	1397.72	40°09'42.525"N	104°43'19.309"W	1.81	
12191.00	86.860	155.640	7445.62	4503.46	-4275.63	1424.56	40°09'41.898"N	104°43'18.964"W	4.42	Last BHI MWD+IFR Surveys
12246.00	86.860	155.640	7448.63	4558.26	-4325.66	1447.21	40°09'41.403"N	104°43'18.672"W	0.00	Projection to Bit

HOLE & CASING SECTIONS - Ref Wellbore: DOLPH 15C-1HZ AWB      Ref Wellpath: DOLPH 15C-1HZ AWP									
String/Diameter	Start MD [ft]	End MD [ft]	Interval [ft]	Start TVD [ft]	End TVD [ft]	Start N/S [ft]	Start E/W [ft]	End N/S [ft]	End E/W [ft]
13.5in Open Hole	13.00	1423.00	1410.00	13.00	1422.79	0.00	0.00	9.58	15.69
9.625in Casing Surface	13.00	1413.00	1400.00	13.00	1412.79	0.00	0.00	9.55	15.57
8.75in Open Hole	1423.00	7835.00	6412.00	1422.79	7426.27	9.58	15.69	-204.86	-121.56
7in Casing Intermediate	13.00	7821.00	7808.00	13.00	7425.12	0.00	0.00	-191.82	-126.52
6.125in Open Hole	7835.00	12246.00	4411.00	7426.27	7448.63	-204.86	-121.56	-4325.66	1447.21

# Actual Wellpath Report

DOLPH 15C-1HZ AWP

Page 6 of 7

REFERENCE WELLPATH IDENTIFICATION			
Operator	KERR-MCGEE OIL & GAS ONSHORE LP	Slot	SLOT#23 DOLPH 15C-1HZ (470'FNL & 2225'FWL, SEC.1)
Area	COLORADO	Well	DOLPH 15C-1HZ
Field	WELD COUNTY (KERR MCGEE)	Wellbore	DOLPH 15C-1HZ AWB
Facility	SEC.01-T2N-R66W		

TARGETS									
Name	MD [ft]	TVD [ft]	North [ft]	East [ft]	Grid East [US ft]	Grid North [US ft]	Latitude	Longitude	Shape
DOLPH SECTION 1 LINES		7021.00	-4148.82	2431.42	3218464.13	1302817.57	40°09'43.150"N	104°43'05.995"W	polygon
DOLPH 15C-1HZ BHL ON PLAT REV-1 (460'FSL & 1638'FEL, SEC.1)		7406.00	-4352.95	1488.38	3217522.95	1302605.24	40°09'41.134"N	104°43'18.142"W	point
DOLPH 15C-1HZ BHL ON PLAT REV-2 (460'FSL & 1638'FEL, SEC.1)		7431.00	-4352.95	1488.38	3217522.94	1302605.24	40°09'41.134"N	104°43'18.142"W	point
DOLPH 15C-1HZ BHL REV-3 (460'FSL & 1673'FEL, SEC.1)		7431.00	-4352.95	1453.38	3217487.95	1302604.93	40°09'41.134"N	104°43'18.592"W	point
DOLPH 15C-1HZ LAND BOX		7446.00	0.00	0.00	3215996.74	1306944.86	40°10'24.150"N	104°43'37.312"W	polygon

WELLPATH COMPOSITION - Ref Wellbore: DOLPH 15C-1HZ AWB					Ref Wellpath: DOLPH 15C-1HZ AWP	
Start MD [ft]	End MD [ft]	Positional Uncertainty Model	Log Name/Comment		Wellbore	
13.00	1365.00	NaviTrak (MAGCORR,IFR)	BHI MWD+IFR SURVEYS 13 1/2" HOLE <87-1365>		DOLPH 15C-1HZ AWB	
1365.00	7786.00	NaviTrak (MAGCORR,IFR)	BHI MWD+IFR SURVEYS 8 3/4" HOLE <1436-7786>		DOLPH 15C-1HZ AWB	
7786.00	12191.00	NaviTrak (MAGCORR,IFR)	BHI MWD+IFR SURVEYS 6 1/8" HOLE <7846-12191>		DOLPH 15C-1HZ AWB	
12191.00	12246.00	Blind Drilling (std)	Projection to bit		DOLPH 15C-1HZ AWB	

# Actual Wellpath Report

DOLPH 15C-1HZ AWP

Page 7 of 7

REFERENCE WELLPATH IDENTIFICATION			
Operator	KERR-MCGEE OIL & GAS ONSHORE LP	Slot	SLOT#23 DOLPH 15C-1HZ (470'FNL & 2225'FWL, SEC.1)
Area	COLORADO	Well	DOLPH 15C-1HZ
Field	WELD COUNTY (KERR MCGEE)	Wellbore	DOLPH 15C-1HZ AWB
Facility	SEC.01-T2N-R66W		

WELLPATH COMMENTS				
MD [ft]	Inclination [°]	Azimuth [°]	TVD [ft]	Comment
13.00	0.000	121.250	13.00	Tie-On
87.00	0.260	121.250	87.00	Begin BHI MWD+IFR Surveys
7821.00	85.092	159.040	7425.12	7" Casing Point
12191.00	86.860	155.640	7445.62	Last BHI MWD+IFR Surveys
12246.00	86.860	155.640	7448.63	Projection to Bit