

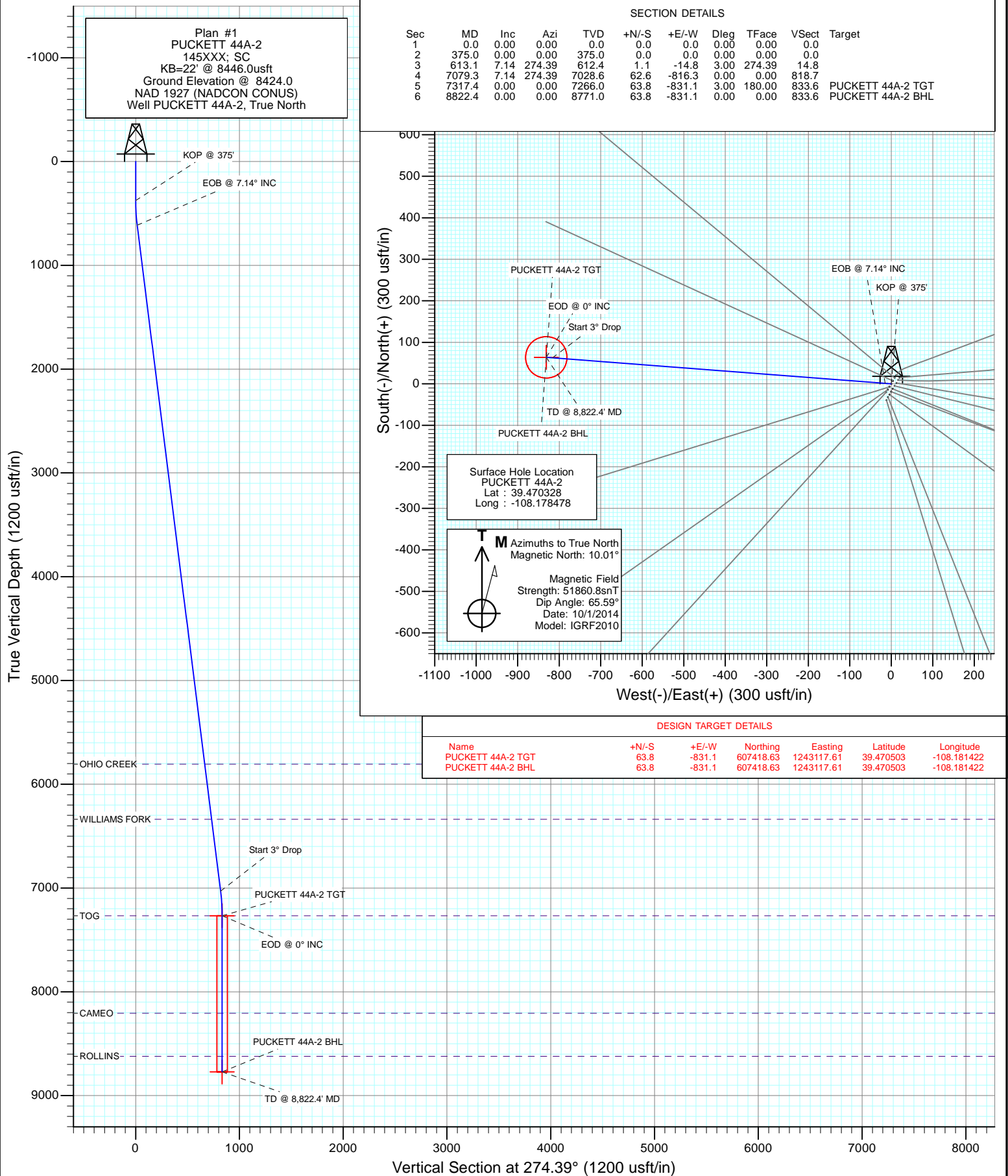

Project: Garfield County, CO
Site: S2-T7S-R97W (Puckett Pad P2)
Well: PUCKETT 44A-2
Wellbore: DD
Design: Plan #1

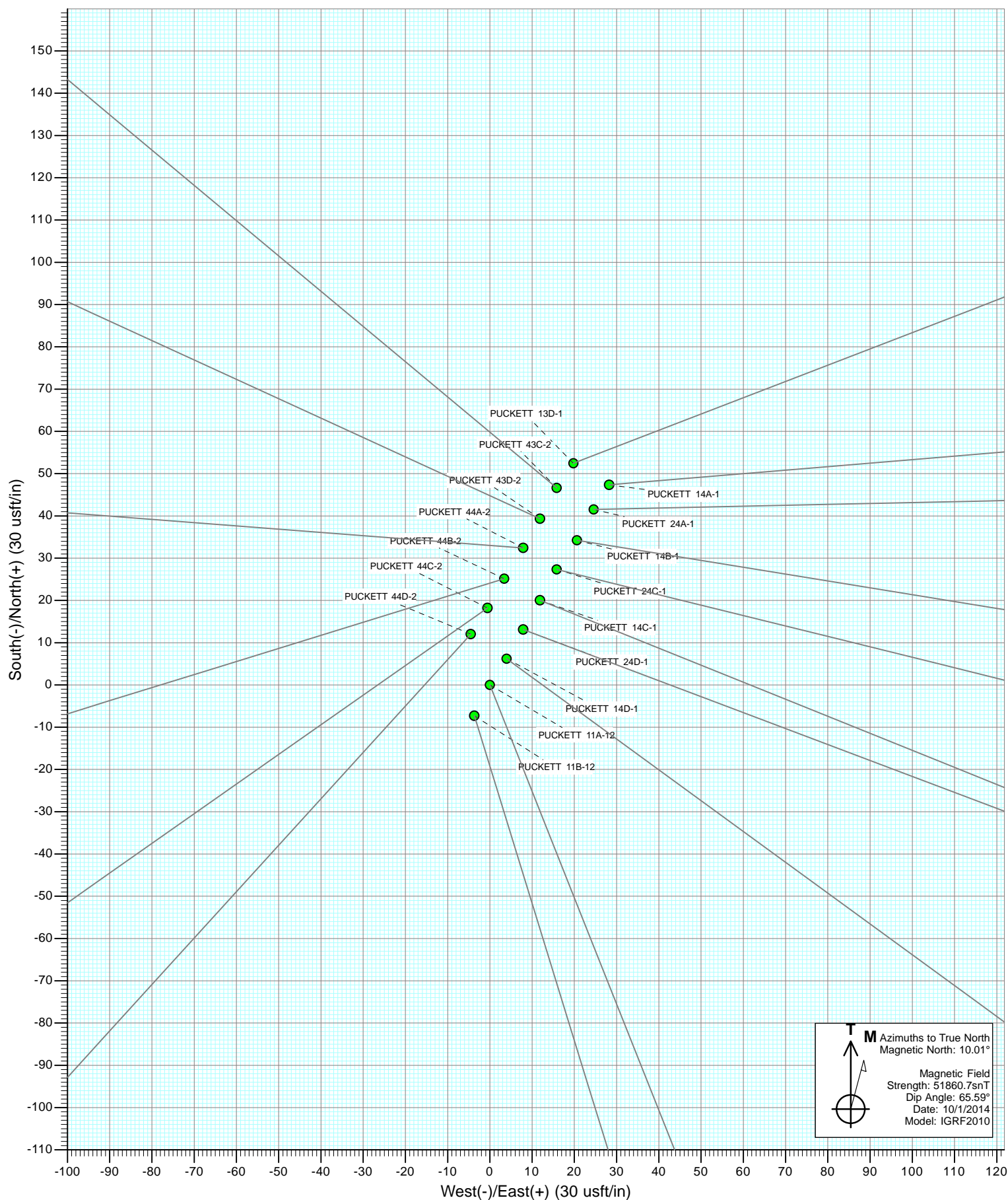

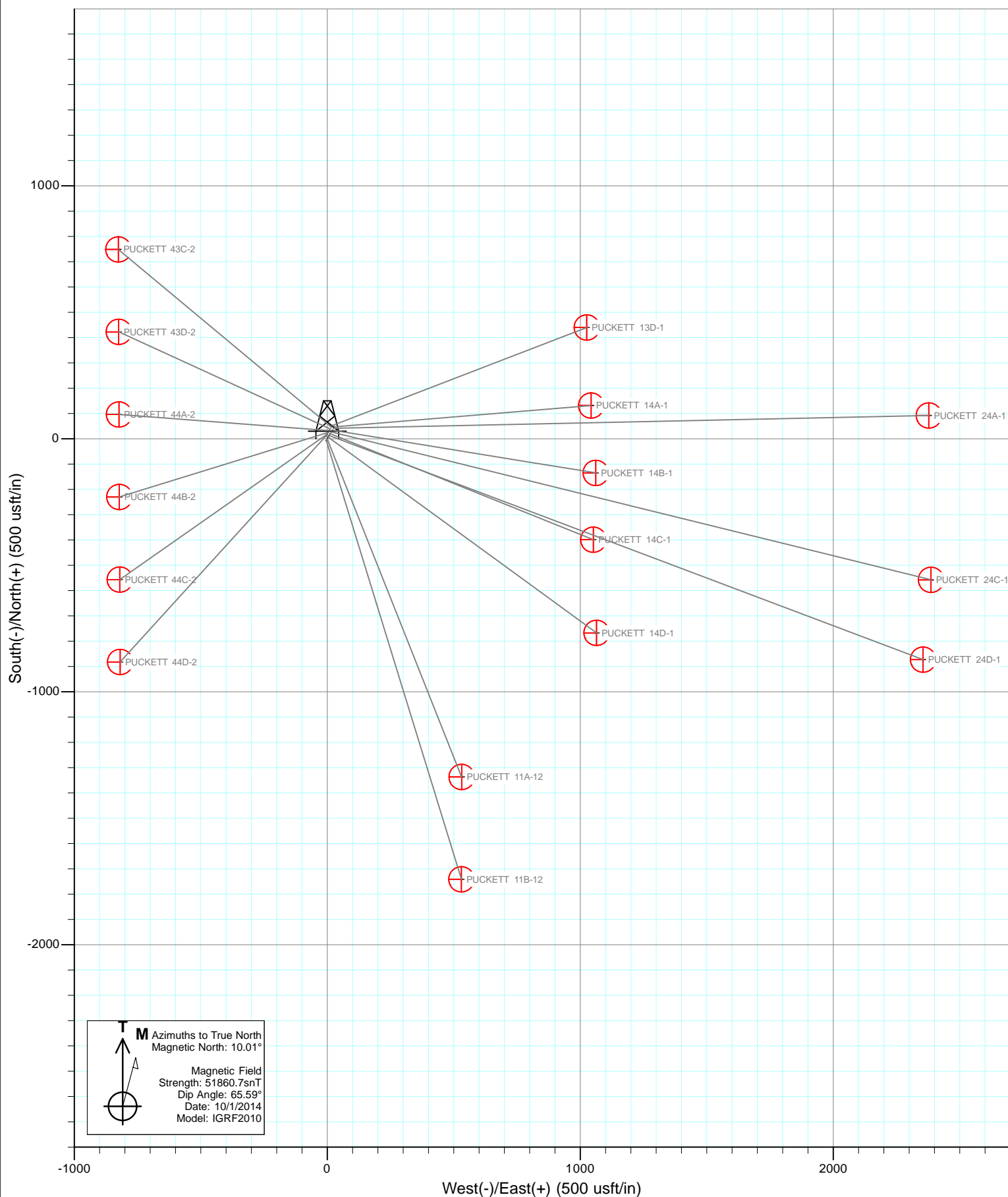



Cathedral Energy Services

Planning Report

Database:	USA EDM 5000 Multi Users DB	Local Co-ordinate Reference:	Well PUCKETT 44A-2
Company:	Caerus Oil & Gas (NAD 27)	TVD Reference:	KB=22' @ 8446.0usft
Project:	Garfield County, CO	MD Reference:	KB=22' @ 8446.0usft
Site:	S2-T7S-R97W (Puckett Pad P2)	North Reference:	True
Well:	PUCKETT 44A-2	Survey Calculation Method:	Minimum Curvature
Wellbore:	DD		
Design:	Plan #1		

Project	Garfield County, CO		
Map System:	US State Plane 1927 (Exact solution)	System Datum:	Mean Sea Level
Geo Datum:	NAD 1927 (NADCON CONUS)		
Map Zone:	Colorado Central 502		

Site		S2-T7S-R97W (Puckett Pad P2)			
Site Position:		Northing:	607,291.06 usft	Latitude:	39.470219
From:	Lat/Long	Easting:	1,243,933.75 usft	Longitude:	-108.178519
Position Uncertainty:	0.0 usft	Slot Radius:	13-3/16 "	Grid Convergence:	-1.69 °

Well	PUCKETT 44A-2					
Well Position	+N/-S	0.0 usft	Northing:	607,330.39 usft	Latitude:	39.470328
	+E/-W	0.0 usft	Easting:	1,243,946.49 usft	Longitude:	-108.178478
Position Uncertainty		0.0 usft	Wellhead Elevation:	0.0 usft	Ground Level:	8,424.0 usft

Wellbore	DD				
Magnetics	Model Name	Sample Date	Declination (°)	Dip Angle (°)	Field Strength (nT)
	IGRF2010	10/1/2014	10.00	65.59	51,861

Design	Plan #1				
Audit Notes:					
Version:	Phase:	PLAN	Tie On Depth:	0.0	
Vertical Section:	Depth From (TVD) (usft)	+N/-S (usft)	+E/-W (usft)	Direction (°)	
	0.0	0.0	0.0	274.39	

Plan Sections										
Measured Depth (usft)	Inclination (°)	Azimuth (°)	Vertical Depth (usft)	+N/-S (usft)	+E/-W (usft)	Dogleg Rate (°/100usft)	Build Rate (°/100usft)	Turn Rate (°/100usft)	TFO (°)	Target
0.0	0.00	0.00	0.0	0.0	0.0	0.00	0.00	0.00	0.00	
375.0	0.00	0.00	375.0	0.0	0.0	0.00	0.00	0.00	0.00	
613.1	7.14	274.39	612.4	1.1	-14.8	3.00	3.00	0.00	274.39	
7,079.3	7.14	274.39	7,028.6	62.6	-816.3	0.00	0.00	0.00	0.00	
7,317.4	0.00	0.00	7,266.0	63.8	-831.1	3.00	-3.00	0.00	180.00	PUCKETT 44A-2 TG1
8,822.4	0.00	0.00	8,771.0	63.8	-831.1	0.00	0.00	0.00	0.00	PUCKETT 44A-2 BHL

Cathedral Energy Services

Planning Report

Database:	USA EDM 5000 Multi Users DB	Local Co-ordinate Reference:	Well PUCKETT 44A-2
Company:	Caerus Oil & Gas (NAD 27)	TVD Reference:	KB=22' @ 8446.0usft
Project:	Garfield County, CO	MD Reference:	KB=22' @ 8446.0usft
Site:	S2-T7S-R97W (Puckett Pad P2)	North Reference:	True
Well:	PUCKETT 44A-2	Survey Calculation Method:	Minimum Curvature
Wellbore:	DD		
Design:	Plan #1		

Planned Survey

Measured Depth (usft)	Inclination (°)	Azimuth (°)	Vertical Depth (usft)	+N/-S (usft)	+E/-W (usft)	Vertical Section (usft)	Dogleg Rate (°/100usft)	Build Rate (°/100u)	Comments / Formations
0.0	0.00	0.00	0.0	0.0	0.0	0.0	0.00	0.00	
100.0	0.00	0.00	100.0	0.0	0.0	0.0	0.00	0.00	
200.0	0.00	0.00	200.0	0.0	0.0	0.0	0.00	0.00	
300.0	0.00	0.00	300.0	0.0	0.0	0.0	0.00	0.00	
375.0	0.00	0.00	375.0	0.0	0.0	0.0	0.00	0.00	KOP @ 375'
400.0	0.75	274.39	400.0	0.0	-0.2	0.2	3.00	3.00	
500.0	3.75	274.39	499.9	0.3	-4.1	4.1	3.00	3.00	
600.0	6.75	274.39	599.5	1.0	-13.2	13.2	3.00	3.00	
613.1	7.14	274.39	612.4	1.1	-14.8	14.8	3.00	3.00	EOB @ 7.14° INC
700.0	7.14	274.39	698.7	2.0	-25.6	25.6	0.00	0.00	
800.0	7.14	274.39	797.9	2.9	-37.9	38.1	0.00	0.00	
900.0	7.14	274.39	897.2	3.9	-50.3	50.5	0.00	0.00	
1,000.0	7.14	274.39	996.4	4.8	-62.7	62.9	0.00	0.00	
1,100.0	7.14	274.39	1,095.6	5.8	-75.1	75.4	0.00	0.00	
1,200.0	7.14	274.39	1,194.8	6.7	-87.5	87.8	0.00	0.00	
1,300.0	7.14	274.39	1,294.1	7.7	-99.9	100.2	0.00	0.00	
1,400.0	7.14	274.39	1,393.3	8.6	-112.3	112.7	0.00	0.00	
1,500.0	7.14	274.39	1,492.5	9.6	-124.7	125.1	0.00	0.00	
1,600.0	7.14	274.39	1,591.7	10.5	-137.1	137.5	0.00	0.00	
1,700.0	7.14	274.39	1,691.0	11.5	-149.5	150.0	0.00	0.00	
1,800.0	7.14	274.39	1,790.2	12.4	-161.9	162.4	0.00	0.00	
1,900.0	7.14	274.39	1,889.4	13.4	-174.3	174.8	0.00	0.00	
2,000.0	7.14	274.39	1,988.6	14.3	-186.7	187.3	0.00	0.00	
2,100.0	7.14	274.39	2,087.8	15.3	-199.1	199.7	0.00	0.00	
2,200.0	7.14	274.39	2,187.1	16.2	-211.5	212.1	0.00	0.00	
2,300.0	7.14	274.39	2,286.3	17.2	-223.9	224.5	0.00	0.00	
2,400.0	7.14	274.39	2,385.5	18.1	-236.3	237.0	0.00	0.00	
2,500.0	7.14	274.39	2,484.7	19.1	-248.7	249.4	0.00	0.00	
2,600.0	7.14	274.39	2,584.0	20.0	-261.1	261.8	0.00	0.00	
2,700.0	7.14	274.39	2,683.2	21.0	-273.5	274.3	0.00	0.00	
2,800.0	7.14	274.39	2,782.4	21.9	-285.9	286.7	0.00	0.00	
2,900.0	7.14	274.39	2,881.6	22.9	-298.3	299.1	0.00	0.00	
3,000.0	7.14	274.39	2,980.9	23.8	-310.7	311.6	0.00	0.00	
3,100.0	7.14	274.39	3,080.1	24.8	-323.1	324.0	0.00	0.00	
3,200.0	7.14	274.39	3,179.3	25.7	-335.5	336.4	0.00	0.00	
3,300.0	7.14	274.39	3,278.5	26.7	-347.9	348.9	0.00	0.00	
3,400.0	7.14	274.39	3,377.8	27.6	-360.2	361.3	0.00	0.00	
3,500.0	7.14	274.39	3,477.0	28.6	-372.6	373.7	0.00	0.00	
3,600.0	7.14	274.39	3,576.2	29.5	-385.0	386.2	0.00	0.00	
3,700.0	7.14	274.39	3,675.4	30.5	-397.4	398.6	0.00	0.00	
3,800.0	7.14	274.39	3,774.7	31.4	-409.8	411.0	0.00	0.00	
3,900.0	7.14	274.39	3,873.9	32.4	-422.2	423.5	0.00	0.00	
4,000.0	7.14	274.39	3,973.1	33.3	-434.6	435.9	0.00	0.00	
4,100.0	7.14	274.39	4,072.3	34.3	-447.0	448.3	0.00	0.00	
4,200.0	7.14	274.39	4,171.6	35.2	-459.4	460.8	0.00	0.00	
4,300.0	7.14	274.39	4,270.8	36.2	-471.8	473.2	0.00	0.00	
4,400.0	7.14	274.39	4,370.0	37.2	-484.2	485.6	0.00	0.00	
4,500.0	7.14	274.39	4,469.2	38.1	-496.6	498.1	0.00	0.00	
4,600.0	7.14	274.39	4,568.5	39.1	-509.0	510.5	0.00	0.00	
4,700.0	7.14	274.39	4,667.7	40.0	-521.4	522.9	0.00	0.00	
4,800.0	7.14	274.39	4,766.9	41.0	-533.8	535.4	0.00	0.00	
4,900.0	7.14	274.39	4,866.1	41.9	-546.2	547.8	0.00	0.00	

Cathedral Energy Services

Planning Report

Database:	USA EDM 5000 Multi Users DB	Local Co-ordinate Reference:	Well PUCKETT 44A-2
Company:	Caerus Oil & Gas (NAD 27)	TVD Reference:	KB=22' @ 8446.0usft
Project:	Garfield County, CO	MD Reference:	KB=22' @ 8446.0usft
Site:	S2-T7S-R97W (Puckett Pad P2)	North Reference:	True
Well:	PUCKETT 44A-2	Survey Calculation Method:	Minimum Curvature
Wellbore:	DD		
Design:	Plan #1		

Planned Survey									
Measured Depth (usft)	Inclination (°)	Azimuth (°)	Vertical Depth (usft)	+N/-S (usft)	+E/-W (usft)	Vertical Section (usft)	Dogleg Rate (°/100usft)	Build Rate (°/100u)	Comments / Formations
5,000.0	7.14	274.39	4,965.3	42.9	-558.6	560.2	0.00	0.00	
5,100.0	7.14	274.39	5,064.6	43.8	-571.0	572.7	0.00	0.00	
5,200.0	7.14	274.39	5,163.8	44.8	-583.4	585.1	0.00	0.00	
5,300.0	7.14	274.39	5,263.0	45.7	-595.8	597.5	0.00	0.00	
5,400.0	7.14	274.39	5,362.2	46.7	-608.2	610.0	0.00	0.00	
5,500.0	7.14	274.39	5,461.5	47.6	-620.6	622.4	0.00	0.00	
5,600.0	7.14	274.39	5,560.7	48.6	-633.0	634.8	0.00	0.00	
5,700.0	7.14	274.39	5,659.9	49.5	-645.4	647.3	0.00	0.00	
5,800.0	7.14	274.39	5,759.1	50.5	-657.8	659.7	0.00	0.00	
5,847.2	7.14	274.39	5,806.0	50.9	-663.6	665.6	0.00	0.00	OHIO CREEK
5,900.0	7.14	274.39	5,858.4	51.4	-670.2	672.1	0.00	0.00	
6,000.0	7.14	274.39	5,957.6	52.4	-682.5	684.6	0.00	0.00	
6,100.0	7.14	274.39	6,056.8	53.3	-694.9	697.0	0.00	0.00	
6,200.0	7.14	274.39	6,156.0	54.3	-707.3	709.4	0.00	0.00	
6,300.0	7.14	274.39	6,255.3	55.2	-719.7	721.9	0.00	0.00	
6,381.4	7.14	274.39	6,336.0	56.0	-729.8	732.0	0.00	0.00	WILLIAMS FORK
6,400.0	7.14	274.39	6,354.5	56.2	-732.1	734.3	0.00	0.00	
6,500.0	7.14	274.39	6,453.7	57.1	-744.5	746.7	0.00	0.00	
6,600.0	7.14	274.39	6,552.9	58.1	-756.9	759.2	0.00	0.00	
6,700.0	7.14	274.39	6,652.2	59.0	-769.3	771.6	0.00	0.00	
6,800.0	7.14	274.39	6,751.4	60.0	-781.7	784.0	0.00	0.00	
6,900.0	7.14	274.39	6,850.6	60.9	-794.1	796.4	0.00	0.00	
7,000.0	7.14	274.39	6,949.8	61.9	-806.5	808.9	0.00	0.00	
7,079.3	7.14	274.39	7,028.6	62.6	-816.3	818.7	0.00	0.00	Start 3° Drop
7,100.0	6.52	274.39	7,049.1	62.8	-818.8	821.2	3.00	-3.00	
7,200.0	3.52	274.39	7,148.7	63.5	-827.5	830.0	3.00	-3.00	
7,300.0	0.52	274.39	7,248.6	63.8	-831.0	833.5	3.00	-3.00	
7,317.4	0.00	0.00	7,266.0	63.8	-831.1	833.6	3.00	-3.00	EOD @ 0° INC - TOG
7,400.0	0.00	0.00	7,348.6	63.8	-831.1	833.6	0.00	0.00	
7,500.0	0.00	0.00	7,448.6	63.8	-831.1	833.6	0.00	0.00	
7,600.0	0.00	0.00	7,548.6	63.8	-831.1	833.6	0.00	0.00	
7,700.0	0.00	0.00	7,648.6	63.8	-831.1	833.6	0.00	0.00	
7,800.0	0.00	0.00	7,748.6	63.8	-831.1	833.6	0.00	0.00	
7,900.0	0.00	0.00	7,848.6	63.8	-831.1	833.6	0.00	0.00	
8,000.0	0.00	0.00	7,948.6	63.8	-831.1	833.6	0.00	0.00	
8,100.0	0.00	0.00	8,048.6	63.8	-831.1	833.6	0.00	0.00	
8,200.0	0.00	0.00	8,148.6	63.8	-831.1	833.6	0.00	0.00	
8,257.4	0.00	0.00	8,206.0	63.8	-831.1	833.6	0.00	0.00	CAMEO
8,300.0	0.00	0.00	8,248.6	63.8	-831.1	833.6	0.00	0.00	
8,400.0	0.00	0.00	8,348.6	63.8	-831.1	833.6	0.00	0.00	
8,500.0	0.00	0.00	8,448.6	63.8	-831.1	833.6	0.00	0.00	
8,600.0	0.00	0.00	8,548.6	63.8	-831.1	833.6	0.00	0.00	
8,672.4	0.00	0.00	8,621.0	63.8	-831.1	833.6	0.00	0.00	ROLLINS
8,700.0	0.00	0.00	8,648.6	63.8	-831.1	833.6	0.00	0.00	
8,800.0	0.00	0.00	8,748.6	63.8	-831.1	833.6	0.00	0.00	
8,822.4	0.00	0.00	8,771.0	63.8	-831.1	833.6	0.00	0.00	TD @ 8,822.4' MD

Cathedral Energy Services

Planning Report

Database:	USA EDM 5000 Multi Users DB	Local Co-ordinate Reference:	Well PUCKETT 44A-2
Company:	Caerus Oil & Gas (NAD 27)	TVD Reference:	KB=22' @ 8446.0usft
Project:	Garfield County, CO	MD Reference:	KB=22' @ 8446.0usft
Site:	S2-T7S-R97W (Puckett Pad P2)	North Reference:	True
Well:	PUCKETT 44A-2	Survey Calculation Method:	Minimum Curvature
Wellbore:	DD		
Design:	Plan #1		

Targets									
Target Name									
- hit/miss target	Dip Angle	Dip Dir.	TVD	+N/-S	+E/-W	Northing	Easting	Latitude	Longitude
- Shape	(°)	(°)	(usft)	(usft)	(usft)	(usft)	(usft)		
PUCKETT 44A-2 BHL	0.00	0.00	8,771.0	63.8	-831.1	607,418.63	1,243,117.61	39.470503	-108.181422
- plan hits target center									
- Circle (radius 50.0)									
PUCKETT 44A-2 TGT	0.00	0.00	7,266.0	63.8	-831.1	607,418.63	1,243,117.61	39.470503	-108.181422
- plan hits target center									
- Point									

Formations						
Measured Depth	Vertical Depth	Name	Lithology	Dip	Dip Direction	
(usft)	(usft)			(°)	(°)	
5,847.2	5,806.0	OHIO CREEK				
6,381.4	6,336.0	WILLIAMS FORK				
7,317.4	7,266.0	TOG				
8,257.4	8,206.0	CAMEO				
8,672.4	8,621.0	ROLLINS				

Plan Annotations					
Measured Depth	Vertical Depth	Local Coordinates			
(usft)	(usft)	+N/-S	+E/-W	Comment	
(usft)	(usft)	(usft)	(usft)		
375.0	375.0	0.0	0.0	KOP @ 375'	
613.1	612.4	1.1	-14.8	EOB @ 7.14° INC	
7,079.3	7,028.6	62.6	-816.3	Start 3° Drop	
7,317.4	7,266.0	63.8	-831.1	EOD @ 0° INC	
8,822.4	8,771.0	63.8	-831.1	TD @ 8,822.4' MD	

Caerus Oil & Gas (NAD 27)

Garfield County, CO

S2-T7S-R97W (Puckett Pad P2)

PUCKETT 44A-2

DD

Plan #1

Anticollision Report

01 October, 2014

Cathedral Energy Services

Anticollision Report

Company:	Caerus Oil & Gas (NAD 27)	Local Co-ordinate Reference:	Well PUCKETT 44A-2
Project:	Garfield County, CO	TVD Reference:	KB=22' @ 8446.0usft
Reference Site:	S2-T7S-R97W (Puckett Pad P2)	MD Reference:	KB=22' @ 8446.0usft
Site Error:	0.0usft	North Reference:	True
Reference Well:	PUCKETT 44A-2	Survey Calculation Method:	Minimum Curvature
Well Error:	0.0usft	Output errors are at	2.00 sigma
Reference Wellbore	DD	Database:	USA EDM 5000 Multi Users DB
Reference Design:	Plan #1	Offset TVD Reference:	Offset Datum

Reference	Plan #1		
Filter type:	NO GLOBAL FILTER: Using user defined selection & filtering criteria		
Interpolation Method:	MD Interval 100.0usft	Error Model:	ISCWSA
Depth Range:	Unlimited	Scan Method:	Closest Approach 3D
Results Limited by:	Maximum center-center distance of 200.0usft	Error Surface:	Elliptical Conic
Warning Levels Evaluated at:	2.00 Sigma		

Survey Tool Program		Date	10/1/2014		
From (usft)	To (usft)	Survey (Wellbore)	Tool Name	Description	
0.0	8,822.4	Plan #1 (DD)	ISCWSA MWD	MWD - Standard	

Cathedral Energy Services

Anticollision Report

Company:	Caerus Oil & Gas (NAD 27)	Local Co-ordinate Reference:	Well PUCKETT 44A-2
Project:	Garfield County, CO	TVD Reference:	KB=22' @ 8446.0usft
Reference Site:	S2-T7S-R97W (Puckett Pad P2)	MD Reference:	KB=22' @ 8446.0usft
Site Error:	0.0usft	North Reference:	True
Reference Well:	PUCKETT 44A-2	Survey Calculation Method:	Minimum Curvature
Well Error:	0.0usft	Output errors are at	2.00 sigma
Reference Wellbore	DD	Database:	USA EDM 5000 Multi Users DB
Reference Design:	Plan #1	Offset TVD Reference:	Offset Datum

Summary						
Site Name	Reference Measured Depth (usft)	Offset Measured Depth (usft)	Distance Between Centres (usft)	Distance Between Ellipses (usft)	Separation Factor	Warning
S2-T7S-R97W (Puckett Pad H2)						
PUCKETT 43B-2 - DD - Plan #1						Out of range
S2-T7S-R97W (Puckett Pad P2)						
PUCKETT 11A-12 - DD - Plan #1	233.6	233.6	33.4	32.6	43.003	CC, ES
PUCKETT 11A-12 - DD - Plan #1	500.0	494.8	47.7	45.7	24.501	SF
PUCKETT 11B-12 - DD - Plan #1	200.0	200.0	41.4	40.7	66.189	CC, ES
PUCKETT 11B-12 - DD - Plan #1	500.0	492.1	62.0	60.0	31.442	SF
PUCKETT 13D-1 - DD - Plan #1	200.0	200.0	23.3	22.6	37.249	CC, ES
PUCKETT 13D-1 - DD - Plan #1	400.0	397.4	31.2	29.6	20.179	SF
PUCKETT 14A-1 - DD - Plan #1	300.0	300.0	25.2	24.1	23.476	CC
PUCKETT 14A-1 - DD - Plan #1	400.0	400.0	25.3	23.8	16.641	ES
PUCKETT 14A-1 - DD - Plan #1	500.0	499.2	29.0	27.0	14.498	SF
PUCKETT 14B-1 - DD - Plan #1	300.0	300.0	12.8	11.8	11.946	CC
PUCKETT 14B-1 - DD - Plan #1	400.0	400.0	13.0	11.5	8.522	ES, SF
PUCKETT 14C-1 - DD - Plan #1	300.0	300.0	13.0	11.9	12.095	CC
PUCKETT 14C-1 - DD - Plan #1	336.2	336.2	13.0	11.8	10.538	ES
PUCKETT 14C-1 - DD - Plan #1	400.0	399.8	13.5	12.0	8.914	SF
PUCKETT 14D-1 - DD - Plan #1	300.0	300.0	26.5	25.4	24.680	CC, ES
PUCKETT 14D-1 - DD - Plan #1	500.0	497.6	33.7	31.8	17.285	SF
PUCKETT 24A-1 - DD - Plan #1	300.0	300.0	19.0	17.9	17.669	CC, ES
PUCKETT 24A-1 - DD - Plan #1	400.0	399.1	21.3	19.8	14.064	SF
PUCKETT 24C-1 - DD - Plan #1	233.6	233.6	9.4	8.6	12.124	CC, ES
PUCKETT 24C-1 - DD - Plan #1	300.0	299.8	10.0	9.0	9.401	SF
PUCKETT 24D-1 - DD - Plan #1	200.0	200.0	19.3	18.7	30.887	CC, ES
PUCKETT 24D-1 - DD - Plan #1	400.0	398.6	25.0	23.5	16.441	SF
PUCKETT 43C-2 - DD - Plan #1	255.9	255.9	16.3	15.4	18.553	CC
PUCKETT 43C-2 - DD - Plan #1	300.0	300.0	16.3	15.2	15.174	ES
PUCKETT 43C-2 - DD - Plan #1	500.0	498.9	22.4	20.4	11.286	SF
PUCKETT 43D-2 - DD - Plan #1	300.0	300.0	8.0	6.9	7.421	CC
PUCKETT 43D-2 - DD - Plan #1	400.0	400.0	8.0	6.5	5.289	ES
PUCKETT 43D-2 - DD - Plan #1	500.0	499.8	10.0	8.0	5.098	SF
PUCKETT 44B-2 - DD - Plan #1	300.0	300.0	8.6	7.5	7.978	CC, ES
PUCKETT 44B-2 - DD - Plan #1	400.0	399.7	9.6	8.1	6.378	SF
PUCKETT 44C-2 - DD - Plan #1	255.6	255.6	16.5	15.7	18.908	CC
PUCKETT 44C-2 - DD - Plan #1	300.0	299.8	16.7	15.6	15.615	ES
PUCKETT 44C-2 - DD - Plan #1	400.0	398.9	20.2	18.7	13.525	SF
PUCKETT 44D-2 - DD - Plan #1	200.0	200.0	23.9	23.3	38.213	CC, ES
PUCKETT 44D-2 - DD - Plan #1	500.0	495.1	41.1	39.2	20.959	SF

Cathedral Energy Services

Anticollision Report

Company:	Caerus Oil & Gas (NAD 27)	Local Co-ordinate Reference:	Well PUCKETT 44A-2
Project:	Garfield County, CO	TVD Reference:	KB=22' @ 8446.0usft
Reference Site:	S2-T7S-R97W (Puckett Pad P2)	MD Reference:	KB=22' @ 8446.0usft
Site Error:	0.0usft	North Reference:	True
Reference Well:	PUCKETT 44A-2	Survey Calculation Method:	Minimum Curvature
Well Error:	0.0usft	Output errors are at	2.00 sigma
Reference Wellbore	DD	Database:	USA EDM 5000 Multi Users DB
Reference Design:	Plan #1	Offset TVD Reference:	Offset Datum

Offset Design S2-T7S-R97W (Puckett Pad P2) - PUCKETT 11A-12 - DD - Plan #1													Offset Site Error:	0.0 usft
Survey Program: 0-ISWWSA MWD													Offset Well Error:	0.0 usft
Reference		Offset		Semi Major Axis			Distance							Warning
Measured Depth (usft)	Vertical Depth (usft)	Measured Depth (usft)	Vertical Depth (usft)	Reference (usft)	Offset (usft)	Highside Toolface (°)	Offset Wellbore Centre +N/-S (usft)	+E/-W (usft)	Between Centres (usft)	Between Ellipses (usft)	Total Uncertainty Axis	Separation Factor		
0.0	0.0	0.0	0.0	0.0	0.0	-166.29	-32.4	-7.9	33.4					
100.0	100.0	100.0	100.0	0.1	0.1	-166.29	-32.4	-7.9	33.4	33.2	0.18	190.294		
200.0	200.0	200.0	200.0	0.3	0.3	-166.29	-32.4	-7.9	33.4	32.7	0.62	53.392		
233.6	233.6	233.6	233.6	0.4	0.4	-166.29	-32.4	-7.9	33.4	32.6	0.78	43.003	CC, ES	
300.0	300.0	299.3	299.3	0.5	0.5	-166.92	-33.0	-7.7	33.9	32.8	1.06	31.963		
400.0	400.0	397.6	397.4	0.8	0.7	-85.84	-37.7	-5.8	38.2	36.7	1.49	25.675		
500.0	499.9	494.8	494.2	1.0	1.0	-96.29	-47.0	-2.1	47.7	45.7	1.95	24.501	SF	
600.0	599.5	589.9	588.1	1.2	1.3	-108.09	-60.4	3.2	64.6	62.1	2.48	26.078		
700.0	698.7	683.4	679.7	1.5	1.6	-116.92	-77.8	10.1	89.4	86.3	3.05	29.298		
800.0	797.9	779.2	773.3	1.8	2.0	-122.03	-96.7	17.6	116.7	113.2	3.59	32.519		
900.0	897.2	874.9	866.9	2.1	2.4	-125.21	-115.7	25.2	144.6	140.5	4.13	34.996		
1,000.0	996.4	970.7	960.5	2.4	2.9	-127.35	-134.6	32.7	172.8	168.1	4.69	36.871		

Cathedral Energy Services

Anticollision Report

Company:	Caerus Oil & Gas (NAD 27)	Local Co-ordinate Reference:	Well PUCKETT 44A-2
Project:	Garfield County, CO	TVD Reference:	KB=22' @ 8446.0usft
Reference Site:	S2-T7S-R97W (Puckett Pad P2)	MD Reference:	KB=22' @ 8446.0usft
Site Error:	0.0usft	North Reference:	True
Reference Well:	PUCKETT 44A-2	Survey Calculation Method:	Minimum Curvature
Well Error:	0.0usft	Output errors are at	2.00 sigma
Reference Wellbore	DD	Database:	USA EDM 5000 Multi Users DB
Reference Design:	Plan #1	Offset TVD Reference:	Offset Datum

Offset Design S2-T7S-R97W (Puckett Pad P2) - PUCKETT 11B-12 - DD - Plan #1													Offset Site Error:	0.0 usft
Survey Program: 0-ISWWSA MWD													Offset Well Error:	0.0 usft
Reference		Offset		Semi Major Axis			Distance						Warning	
Measured Depth (usft)	Vertical Depth (usft)	Measured Depth (usft)	Vertical Depth (usft)	Reference (usft)	Offset (usft)	Highside Toolface (°)	Offset Wellbore Centre +N/-S (usft)	+E/-W (usft)	Between Centres (usft)	Between Ellipses (usft)	Total Uncertainty Axis	Separation Factor		
0.0	0.0	0.0	0.0	0.0	0.0	-163.75	-39.7	-11.6	41.4					
100.0	100.0	100.0	100.0	0.1	0.1	-163.75	-39.7	-11.6	41.4	41.2	0.18	235.905		
200.0	200.0	200.0	200.0	0.3	0.3	-163.75	-39.7	-11.6	41.4	40.7	0.62	66.189 CC, ES		
300.0	300.0	298.1	298.1	0.5	0.5	-165.57	-42.1	-10.8	43.5	42.5	1.05	41.472		
400.0	400.0	395.8	395.4	0.8	0.7	-84.58	-49.3	-8.6	50.2	48.7	1.50	33.390		
500.0	499.9	492.1	490.9	1.0	1.0	-92.95	-61.0	-5.0	62.0	60.0	1.97	31.442 SF		
600.0	599.5	586.1	583.4	1.2	1.3	-102.48	-76.9	-0.1	80.6	78.1	2.50	32.246		
700.0	698.7	677.3	672.4	1.5	1.7	-110.25	-96.4	5.9	106.6	103.5	3.07	34.747		
800.0	797.9	769.5	761.3	1.8	2.2	-115.01	-119.6	13.0	137.7	134.0	3.65	37.715		
900.0	897.2	863.9	852.2	2.1	2.7	-118.09	-143.7	20.4	169.7	165.5	4.21	40.306		

Cathedral Energy Services

Anticollision Report

Company:	Caerus Oil & Gas (NAD 27)	Local Co-ordinate Reference:	Well PUCKETT 44A-2
Project:	Garfield County, CO	TVD Reference:	KB=22' @ 8446.0usft
Reference Site:	S2-T7S-R97W (Puckett Pad P2)	MD Reference:	KB=22' @ 8446.0usft
Site Error:	0.0usft	North Reference:	True
Reference Well:	PUCKETT 44A-2	Survey Calculation Method:	Minimum Curvature
Well Error:	0.0usft	Output errors are at	2.00 sigma
Reference Wellbore	DD	Database:	USA EDM 5000 Multi Users DB
Reference Design:	Plan #1	Offset TVD Reference:	Offset Datum

Offset Design												Offset Site Error:	0.0 usft
S2-T7S-R97W (Puckett Pad P2) - PUCKETT 13D-1 - DD - Plan #1												Offset Well Error:	0.0 usft
Survey Program: 0-ISWWSA MWD													
Reference		Offset		Semi Major Axis		Distance							
Measured Depth (usft)	Vertical Depth (usft)	Measured Depth (usft)	Vertical Depth (usft)	Reference (usft)	Offset (usft)	Highside Toolface (°)	Offset Wellbore Centre +N/-S (usft)	+E/-W (usft)	Between Centres (usft)	Between Ellipses (usft)	Total Uncertainty Axis	Separation Factor	Warning
0.0	0.0	0.0	0.0	0.0	0.0	30.63	20.0	11.9	23.3				
100.0	100.0	100.0	100.0	0.1	0.1	30.63	20.0	11.9	23.3	23.1	0.18	132.757	
200.0	200.0	200.0	200.0	0.3	0.3	30.63	20.0	11.9	23.3	22.6	0.62	37.249 CC, ES	
300.0	300.0	299.1	299.1	0.5	0.5	31.17	21.1	12.8	24.7	23.6	1.07	23.082	
400.0	400.0	397.4	397.2	0.8	0.8	118.79	26.0	16.9	31.2	29.6	1.55	20.179 SF	
500.0	499.9	495.5	494.6	1.0	1.0	126.14	33.3	24.6	44.0	42.0	2.04	21.537	
600.0	599.5	591.7	589.9	1.2	1.3	137.24	39.3	36.7	63.6	61.0	2.60	24.499	
700.0	698.7	687.9	684.9	1.5	1.6	145.62	44.6	50.9	88.6	85.5	3.09	28.699	
800.0	797.9	784.1	779.9	1.8	1.9	150.33	49.9	65.1	114.7	111.2	3.55	32.312	
900.0	897.2	880.3	874.9	2.1	2.3	153.30	55.3	79.3	141.2	137.2	4.01	35.189	
1,000.0	996.4	976.5	969.9	2.4	2.6	155.32	60.6	93.5	168.0	163.5	4.48	37.486	
1,100.0	1,095.6	1,072.7	1,064.9	2.7	3.0	156.79	65.9	107.7	194.9	190.0	4.95	39.349	

Cathedral Energy Services

Anticollision Report

Company:	Caerus Oil & Gas (NAD 27)	Local Co-ordinate Reference:	Well PUCKETT 44A-2
Project:	Garfield County, CO	TVD Reference:	KB=22' @ 8446.0usft
Reference Site:	S2-T7S-R97W (Puckett Pad P2)	MD Reference:	KB=22' @ 8446.0usft
Site Error:	0.0usft	North Reference:	True
Reference Well:	PUCKETT 44A-2	Survey Calculation Method:	Minimum Curvature
Well Error:	0.0usft	Output errors are at	2.00 sigma
Reference Wellbore	DD	Database:	USA EDM 5000 Multi Users DB
Reference Design:	Plan #1	Offset TVD Reference:	Offset Datum

Offset Design S2-T7S-R97W (Puckett Pad P2) - PUCKETT 14A-1 - DD - Plan #1													Offset Site Error:	0.0 usft
Survey Program: 0-ISCSWA MWD													Offset Well Error:	0.0 usft
Reference		Offset		Semi Major Axis			Distance						Warning	
Measured Depth (usft)	Vertical Depth (usft)	Measured Depth (usft)	Vertical Depth (usft)	Reference (usft)	Offset (usft)	Highside Toolface (°)	Offset Wellbore Centre +N/-S (usft)	+E/-W (usft)	Between Centres (usft)	Between Ellipses (usft)	Total Uncertainty Axis	Separation Factor		
0.0	0.0	0.0	0.0	0.0	0.0	53.70	14.9	20.3	25.2					
100.0	100.0	100.0	100.0	0.1	0.1	53.70	14.9	20.3	25.2	25.0	0.18	143.867		
200.0	200.0	200.0	200.0	0.3	0.3	53.70	14.9	20.3	25.2	24.6	0.62	40.366		
300.0	300.0	300.0	300.0	0.5	0.5	53.70	14.9	20.3	25.2	24.1	1.07	23.476 CC		
355.6	355.6	355.6	355.6	0.7	0.7	139.61	14.9	20.3	25.4	24.1	1.32	19.175		
400.0	400.0	400.0	400.0	0.8	0.8	139.55	14.9	20.3	25.3	23.8	1.52	16.641 ES		
500.0	499.9	499.2	499.2	1.0	1.0	145.13	15.0	21.0	29.0	27.0	2.00	14.498 SF		
600.0	599.5	596.5	596.4	1.2	1.2	155.06	15.4	25.9	41.8	39.2	2.56	16.336		
700.0	698.7	691.5	690.8	1.5	1.4	162.09	16.2	35.5	63.2	60.2	3.04	20.800		
800.0	797.9	785.9	784.3	1.8	1.7	165.85	17.3	49.2	89.4	85.9	3.51	25.507		
900.0	897.2	882.1	879.3	2.1	2.0	167.97	18.6	64.0	116.6	112.7	3.95	29.545		
1,000.0	996.4	978.2	974.3	2.4	2.3	169.29	19.8	78.7	143.9	139.5	4.39	32.744		
1,100.0	1,095.6	1,074.4	1,069.3	2.7	2.6	170.19	21.0	93.4	171.2	166.4	4.85	35.307		
1,200.0	1,194.8	1,170.6	1,164.3	3.0	2.9	170.84	22.2	108.1	198.6	193.3	5.31	37.396		

Cathedral Energy Services

Anticollision Report

Company:	Caerus Oil & Gas (NAD 27)	Local Co-ordinate Reference:	Well PUCKETT 44A-2
Project:	Garfield County, CO	TVD Reference:	KB=22' @ 8446.0usft
Reference Site:	S2-T7S-R97W (Puckett Pad P2)	MD Reference:	KB=22' @ 8446.0usft
Site Error:	0.0usft	North Reference:	True
Reference Well:	PUCKETT 44A-2	Survey Calculation Method:	Minimum Curvature
Well Error:	0.0usft	Output errors are at	2.00 sigma
Reference Wellbore	DD	Database:	USA EDM 5000 Multi Users DB
Reference Design:	Plan #1	Offset TVD Reference:	Offset Datum

Offset Design S2-T7S-R97W (Puckett Pad P2) - PUCKETT 14B-1 - DD - Plan #1													Offset Site Error:	0.0 usft
Survey Program: 0-ISCWSA MWD													Offset Well Error:	0.0 usft
Reference		Offset		Semi Major Axis			Distance						Warning	
Measured Depth (usft)	Vertical Depth (usft)	Measured Depth (usft)	Vertical Depth (usft)	Reference (usft)	Offset (usft)	Highside Toolface (°)	Offset Wellbore Centre +N/-S (usft)	+E/-W (usft)	Between Centres (usft)	Between Ellipses (usft)	Total Uncertainty Axis	Separation Factor		
0.0	0.0	0.0	0.0	0.0	0.0	81.82	1.8	12.7	12.8					
100.0	100.0	100.0	100.0	0.1	0.1	81.82	1.8	12.7	12.8	12.7	0.18	73.207		
200.0	200.0	200.0	200.0	0.3	0.3	81.82	1.8	12.7	12.8	12.2	0.62	20.540		
300.0	300.0	300.0	300.0	0.5	0.5	81.82	1.8	12.7	12.8	11.8	1.07	11.946 CC		
355.6	355.6	355.6	355.6	0.7	0.7	167.63	1.8	12.7	13.0	11.7	1.32	9.844		
400.0	400.0	400.0	400.0	0.8	0.8	167.59	1.8	12.7	13.0	11.5	1.52	8.522 ES, SF		
500.0	499.9	499.0	498.9	1.0	1.0	172.31	1.4	15.2	19.4	17.3	2.03	9.562		
600.0	599.5	596.2	595.8	1.2	1.2	176.83	0.2	22.6	36.0	33.4	2.61	13.822		
700.0	698.7	690.6	689.5	1.5	1.4	179.09	-1.7	34.5	60.9	57.8	3.07	19.803		
800.0	797.9	786.3	784.0	1.8	1.7	-179.77	-4.1	49.4	88.7	85.2	3.52	25.191		
900.0	897.2	882.3	878.8	2.1	2.0	-179.17	-6.6	64.3	116.6	112.6	3.96	29.423		
1,000.0	996.4	978.3	973.6	2.4	2.4	-178.80	-9.0	79.3	144.5	140.1	4.41	32.746		
1,100.0	1,095.6	1,074.4	1,068.4	2.7	2.7	-178.56	-11.4	94.3	172.4	167.6	4.87	35.393		

Cathedral Energy Services

Anticollision Report

Company:	Caerus Oil & Gas (NAD 27)	Local Co-ordinate Reference:	Well PUCKETT 44A-2
Project:	Garfield County, CO	TVD Reference:	KB=22' @ 8446.0usft
Reference Site:	S2-T7S-R97W (Puckett Pad P2)	MD Reference:	KB=22' @ 8446.0usft
Site Error:	0.0usft	North Reference:	True
Reference Well:	PUCKETT 44A-2	Survey Calculation Method:	Minimum Curvature
Well Error:	0.0usft	Output errors are at	2.00 sigma
Reference Wellbore	DD	Database:	USA EDM 5000 Multi Users DB
Reference Design:	Plan #1	Offset TVD Reference:	Offset Datum

Offset Design S2-T7S-R97W (Puckett Pad P2) - PUCKETT 14C-1 - DD - Plan #1													Offset Site Error:	0.0 usft
Survey Program: 0-ISCSWA MWD													Offset Well Error:	0.0 usft
Reference		Offset		Semi Major Axis			Distance							Warning
Measured Depth (usft)	Vertical Depth (usft)	Measured Depth (usft)	Vertical Depth (usft)	Reference (usft)	Offset (usft)	Highside Toolface (°)	Offset Wellbore Centre +N/-S (usft)	+E/-W (usft)	Between Centres (usft)	Between Ellipses (usft)	Total Uncertainty Axis	Separation Factor		
0.0	0.0	0.0	0.0	0.0	0.0	162.29	-12.4	4.0	13.0					
100.0	100.0	100.0	100.0	0.1	0.1	162.29	-12.4	4.0	13.0	12.8	0.18	74.122		
200.0	200.0	200.0	200.0	0.3	0.3	162.29	-12.4	4.0	13.0	12.4	0.62	20.797		
300.0	300.0	300.0	300.0	0.5	0.5	162.29	-12.4	4.0	13.0	11.9	1.07	12.095 CC		
336.2	336.2	336.2	336.2	0.6	0.6	-112.44	-12.4	4.0	13.0	11.8	1.24	10.538 ES		
400.0	400.0	399.8	399.8	0.8	0.8	-114.85	-12.6	4.6	13.5	12.0	1.51	8.914 SF		
500.0	499.9	498.7	498.5	1.0	1.0	-136.19	-14.5	9.3	20.0	18.1	1.98	10.103		
600.0	599.5	595.4	594.7	1.2	1.2	-152.57	-18.3	18.6	37.5	34.9	2.58	14.495		
700.0	698.7	689.9	688.1	1.5	1.5	-159.81	-23.6	31.8	63.7	60.6	3.09	20.610		
800.0	797.9	785.7	782.6	1.8	1.8	-162.90	-29.6	46.7	91.9	88.4	3.54	25.977		
900.0	897.2	881.6	877.1	2.1	2.1	-164.53	-35.6	61.5	120.3	116.3	3.99	30.133		
1,000.0	996.4	977.4	971.6	2.4	2.5	-165.55	-41.5	76.4	148.7	144.3	4.46	33.375		
1,100.0	1,095.6	1,073.3	1,066.1	2.7	2.8	-166.23	-47.5	91.2	177.1	172.2	4.93	35.955		

Cathedral Energy Services

Anticollision Report

Company:	Caerus Oil & Gas (NAD 27)	Local Co-ordinate Reference:	Well PUCKETT 44A-2
Project:	Garfield County, CO	TVD Reference:	KB=22' @ 8446.0usft
Reference Site:	S2-T7S-R97W (Puckett Pad P2)	MD Reference:	KB=22' @ 8446.0usft
Site Error:	0.0usft	North Reference:	True
Reference Well:	PUCKETT 44A-2	Survey Calculation Method:	Minimum Curvature
Well Error:	0.0usft	Output errors are at	2.00 sigma
Reference Wellbore	DD	Database:	USA EDM 5000 Multi Users DB
Reference Design:	Plan #1	Offset TVD Reference:	Offset Datum

Offset Design S2-T7S-R97W (Puckett Pad P2) - PUCKETT 14D-1 - DD - Plan #1													Offset Site Error:	0.0 usft
Survey Program: 0-ISWWSA MWD													Offset Well Error:	0.0 usft
Reference		Offset		Semi Major Axis			Distance							Warning
Measured Depth (usft)	Vertical Depth (usft)	Measured Depth (usft)	Vertical Depth (usft)	Reference (usft)	Offset (usft)	Highside Toolface (°)	Offset Wellbore Centre +N/-S (usft)	+E/-W (usft)	Between Centres (usft)	Between Ellipses (usft)	Total Uncertainty Axis	Separation Factor		
0.0	0.0	0.0	0.0	0.0	0.0	-171.43	-26.2	-4.0	26.5					
100.0	100.0	100.0	100.0	0.1	0.1	-171.43	-26.2	-4.0	26.5	26.3	0.18	151.246		
200.0	200.0	200.0	200.0	0.3	0.3	-171.43	-26.2	-4.0	26.5	25.9	0.62	42.436		
300.0	300.0	300.0	300.0	0.5	0.5	-171.43	-26.2	-4.0	26.5	25.4	1.07	24.680	CC, ES	
400.0	400.0	399.3	399.2	0.8	0.7	-90.85	-27.7	-1.9	27.8	26.3	1.50	18.503		
500.0	499.9	497.6	497.2	1.0	1.0	-108.49	-32.2	4.3	33.7	31.8	1.95	17.285	SF	
600.0	599.5	593.5	592.4	1.2	1.2	-127.53	-39.5	14.2	49.4	46.9	2.52	19.594		
700.0	698.7	686.8	684.2	1.5	1.5	-139.32	-49.2	27.6	75.2	72.1	3.08	24.416		
800.0	797.9	782.1	777.6	1.8	1.9	-145.31	-60.1	42.6	104.2	100.7	3.57	29.222		
900.0	897.2	877.4	871.1	2.1	2.3	-148.67	-71.1	57.5	133.9	129.9	4.05	33.092		
1,000.0	996.4	972.6	964.5	2.4	2.7	-150.82	-82.0	72.5	163.8	159.3	4.53	36.137		
1,100.0	1,095.6	1,067.9	1,058.0	2.7	3.1	-152.30	-92.9	87.5	193.9	188.9	5.03	38.565		

Cathedral Energy Services

Anticollision Report

Company:	Caerus Oil & Gas (NAD 27)	Local Co-ordinate Reference:	Well PUCKETT 44A-2
Project:	Garfield County, CO	TVD Reference:	KB=22' @ 8446.0usft
Reference Site:	S2-T7S-R97W (Puckett Pad P2)	MD Reference:	KB=22' @ 8446.0usft
Site Error:	0.0usft	North Reference:	True
Reference Well:	PUCKETT 44A-2	Survey Calculation Method:	Minimum Curvature
Well Error:	0.0usft	Output errors are at	2.00 sigma
Reference Wellbore	DD	Database:	USA EDM 5000 Multi Users DB
Reference Design:	Plan #1	Offset TVD Reference:	Offset Datum

Offset Design S2-T7S-R97W (Puckett Pad P2) - PUCKETT 24A-1 - DD - Plan #1													Offset Site Error:	0.0 usft
Survey Program: 0-ISCSWA MWD													Offset Well Error:	0.0 usft
Reference		Offset		Semi Major Axis			Distance							Warning
Measured Depth (usft)	Vertical Depth (usft)	Measured Depth (usft)	Vertical Depth (usft)	Reference (usft)	Offset (usft)	Highside Toolface (°)	Offset Wellbore Centre +N/-S (usft)	+E/-W (usft)	Between Centres (usft)	Between Ellipses (usft)	Total Uncertainty Axis	Separation Factor		
0.0	0.0	0.0	0.0	0.0	0.0	61.34	9.1	16.7	19.0					
100.0	100.0	100.0	100.0	0.1	0.1	61.34	9.1	16.7	19.0	18.8	0.18	108.277		
200.0	200.0	200.0	200.0	0.3	0.3	61.34	9.1	16.7	19.0	18.4	0.62	30.380		
300.0	300.0	300.0	300.0	0.5	0.5	61.34	9.1	16.7	19.0	17.9	1.07	17.669 CC, ES		
400.0	400.0	399.1	399.0	0.8	0.8	151.00	8.9	19.2	21.3	19.8	1.52	14.064 SF		
500.0	499.9	497.1	496.8	1.0	1.0	161.09	8.2	26.8	32.0	30.0	2.04	15.669		
600.0	599.5	592.6	591.5	1.2	1.2	168.23	7.5	38.9	53.2	50.5	2.65	20.060		
700.0	698.7	684.9	682.3	1.5	1.5	171.69	7.1	55.2	82.5	79.4	3.13	26.358		
800.0	797.9	774.2	769.4	1.8	1.9	173.26	7.0	75.0	116.6	113.0	3.60	32.398		
900.0	897.2	860.4	852.4	2.1	2.3	174.05	7.2	98.0	155.0	150.9	4.07	38.059		
1,000.0	996.4	943.3	931.3	2.4	2.8	174.46	7.6	123.7	197.5	192.9	4.55	43.394		

Cathedral Energy Services

Anticollision Report

Company:	Caerus Oil & Gas (NAD 27)	Local Co-ordinate Reference:	Well PUCKETT 44A-2
Project:	Garfield County, CO	TVD Reference:	KB=22' @ 8446.0usft
Reference Site:	S2-T7S-R97W (Puckett Pad P2)	MD Reference:	KB=22' @ 8446.0usft
Site Error:	0.0usft	North Reference:	True
Reference Well:	PUCKETT 44A-2	Survey Calculation Method:	Minimum Curvature
Well Error:	0.0usft	Output errors are at	2.00 sigma
Reference Wellbore	DD	Database:	USA EDM 5000 Multi Users DB
Reference Design:	Plan #1	Offset TVD Reference:	Offset Datum

Offset Design												Offset Site Error:	0.0 usft
S2-T7S-R97W (Puckett Pad P2) - PUCKETT 24C-1 - DD - Plan #1												Offset Well Error:	0.0 usft
Survey Program: 0-ISCSWA MWD													
Reference		Offset		Semi Major Axis		Distance							
Measured Depth (usft)	Vertical Depth (usft)	Measured Depth (usft)	Vertical Depth (usft)	Reference (usft)	Offset (usft)	Highside Toolface (°)	Offset Wellbore Centre +N/-S (usft)	+E/-W (usft)	Between Centres (usft)	Between Ellipses (usft)	Total Uncertainty Axis	Separation Factor	Warning
0.0	0.0	0.0	0.0	0.0	0.0	122.80	-5.1	7.9	9.4				
100.0	100.0	100.0	100.0	0.1	0.1	122.80	-5.1	7.9	9.4	9.2	0.18	53.641	
200.0	200.0	200.0	200.0	0.3	0.3	122.80	-5.1	7.9	9.4	8.8	0.62	15.050	
233.6	233.6	233.6	233.6	0.4	0.4	122.80	-5.1	7.9	9.4	8.6	0.78	12.124 CC, ES	
300.0	300.0	299.8	299.8	0.5	0.5	121.60	-5.2	8.5	10.0	9.0	1.07	9.401 SF	
400.0	400.0	399.0	398.8	0.8	0.7	-159.00	-6.5	13.5	15.2	13.7	1.52	10.020	
500.0	499.9	496.8	496.2	1.0	1.0	-165.66	-8.9	23.4	29.2	27.1	2.07	14.122	
600.0	599.5	591.8	590.0	1.2	1.3	-169.27	-12.4	37.5	53.3	50.6	2.68	19.882	
700.0	698.7	683.2	679.5	1.5	1.6	-171.01	-16.8	55.4	85.3	82.1	3.17	26.917	
800.0	797.9	771.6	765.1	1.8	2.1	-171.75	-22.0	76.6	121.8	118.1	3.65	33.403	
900.0	897.2	856.6	846.5	2.1	2.5	-172.10	-28.0	100.7	162.4	158.3	4.13	39.341	

Cathedral Energy Services

Anticollision Report

Company:	Caerus Oil & Gas (NAD 27)	Local Co-ordinate Reference:	Well PUCKETT 44A-2
Project:	Garfield County, CO	TVD Reference:	KB=22' @ 8446.0usft
Reference Site:	S2-T7S-R97W (Puckett Pad P2)	MD Reference:	KB=22' @ 8446.0usft
Site Error:	0.0usft	North Reference:	True
Reference Well:	PUCKETT 44A-2	Survey Calculation Method:	Minimum Curvature
Well Error:	0.0usft	Output errors are at	2.00 sigma
Reference Wellbore	DD	Database:	USA EDM 5000 Multi Users DB
Reference Design:	Plan #1	Offset TVD Reference:	Offset Datum

Offset Design S2-T7S-R97W (Puckett Pad P2) - PUCKETT 24D-1 - DD - Plan #1												Offset Site Error:	0.0 usft
Survey Program: 0-ISCSWA MWD												Offset Well Error:	0.0 usft
Reference		Offset		Semi Major Axis		Distance							
Measured Depth (usft)	Vertical Depth (usft)	Measured Depth (usft)	Vertical Depth (usft)	Reference (usft)	Offset (usft)	Highside Toolface (°)	Offset Wellbore Centre +N/-S (usft)	+E/-W (usft)	Between Centres (usft)	Between Ellipses (usft)	Total Uncertainty Axis	Separation Factor	Warning
0.0	0.0	0.0	0.0	0.0	0.0	180.00	-19.3	0.0	19.3				
100.0	100.0	100.0	100.0	0.1	0.1	180.00	-19.3	0.0	19.3	19.1	0.18	110.084	
200.0	200.0	200.0	200.0	0.3	0.3	180.00	-19.3	0.0	19.3	18.7	0.62	30.887 CC, ES	
300.0	300.0	299.6	299.5	0.5	0.5	173.15	-20.2	2.4	20.4	19.3	1.06	19.157	
400.0	400.0	398.6	398.2	0.8	0.8	-117.48	-22.9	9.6	25.0	23.5	1.52	16.441 SF	
500.0	499.9	495.8	494.7	1.0	1.0	-136.58	-27.4	21.4	38.0	35.9	2.06	18.469	
600.0	599.5	589.9	587.2	1.2	1.4	-149.22	-33.3	37.1	62.1	59.4	2.68	23.219	
700.0	698.7	680.3	675.2	1.5	1.8	-156.03	-40.5	56.2	95.1	91.9	3.19	29.784	
800.0	797.9	767.4	759.1	1.8	2.2	-159.47	-48.8	78.3	133.0	129.3	3.69	36.093	
900.0	897.2	851.1	838.6	2.1	2.7	-161.42	-58.1	102.8	175.3	171.1	4.18	41.948	

Cathedral Energy Services

Anticollision Report

Company:	Caerus Oil & Gas (NAD 27)	Local Co-ordinate Reference:	Well PUCKETT 44A-2
Project:	Garfield County, CO	TVD Reference:	KB=22' @ 8446.0usft
Reference Site:	S2-T7S-R97W (Puckett Pad P2)	MD Reference:	KB=22' @ 8446.0usft
Site Error:	0.0usft	North Reference:	True
Reference Well:	PUCKETT 44A-2	Survey Calculation Method:	Minimum Curvature
Well Error:	0.0usft	Output errors are at	2.00 sigma
Reference Wellbore	DD	Database:	USA EDM 5000 Multi Users DB
Reference Design:	Plan #1	Offset TVD Reference:	Offset Datum

Offset Design S2-T7S-R97W (Puckett Pad P2) - PUCKETT 43C-2 - DD - Plan #1													Offset Site Error: 0.0 usft	
Survey Program: 0-ISCSWA MWD													Offset Well Error: 0.0 usft	
Reference		Offset		Semi Major Axis			Distance							Warning
Measured Depth (usft)	Vertical Depth (usft)	Measured Depth (usft)	Vertical Depth (usft)	Reference (usft)	Offset (usft)	Highside Toolface (°)	Offset Wellbore Centre +N/-S (usft)	+E/-W (usft)	Between Centres (usft)	Between Ellipses (usft)	Total Uncertainty Axis	Separation Factor		
0.0	0.0	0.0	0.0	0.0	0.0	29.09	14.2	7.9	16.3					
100.0	100.0	100.0	100.0	0.1	0.1	29.09	14.2	7.9	16.3	16.1	0.18	92.725		
200.0	200.0	200.0	200.0	0.3	0.3	29.09	14.2	7.9	16.3	15.6	0.62	26.016		
255.9	255.9	255.9	255.9	0.4	0.4	29.09	14.2	7.9	16.3	15.4	0.88	18.553 CC		
300.0	300.0	300.0	300.0	0.5	0.5	28.53	14.3	7.8	16.3	15.2	1.07	15.174 ES		
400.0	400.0	399.6	399.5	0.8	0.8	102.00	16.8	4.8	17.5	16.0	1.52	11.518		
500.0	499.9	498.9	498.4	1.0	1.0	90.26	22.6	-2.2	22.4	20.4	1.99	11.286 SF		
600.0	599.5	597.8	596.3	1.2	1.3	85.38	31.6	-13.0	30.8	28.2	2.52	12.222		
700.0	698.7	697.4	694.5	1.5	1.6	85.23	41.9	-25.3	40.2	37.1	3.09	12.984		
800.0	797.9	796.9	792.8	1.8	2.0	85.21	52.2	-37.7	49.6	45.9	3.70	13.400		
900.0	897.2	896.5	891.0	2.1	2.3	85.20	62.5	-50.0	59.0	54.7	4.32	13.644		
1,000.0	996.4	996.1	989.3	2.4	2.7	85.19	72.8	-62.4	68.4	63.4	4.96	13.798		
1,100.0	1,095.6	1,095.6	1,087.5	2.7	3.0	85.18	83.1	-74.8	77.8	72.2	5.60	13.899		
1,200.0	1,194.8	1,195.2	1,185.8	3.0	3.4	85.18	93.5	-87.1	87.2	81.0	6.24	13.970		
1,300.0	1,294.1	1,294.7	1,284.0	3.3	3.8	85.18	103.8	-99.5	96.6	89.7	6.89	14.020		
1,400.0	1,393.3	1,394.3	1,382.3	3.6	4.2	85.17	114.1	-111.8	106.0	98.5	7.54	14.057		
1,500.0	1,492.5	1,493.8	1,480.5	4.0	4.5	85.17	124.4	-124.2	115.4	107.2	8.20	14.085		
1,600.0	1,591.7	1,593.4	1,578.8	4.3	4.9	85.17	134.7	-136.5	124.8	116.0	8.85	14.107		
1,700.0	1,691.0	1,692.9	1,677.0	4.6	5.3	85.16	145.0	-148.9	134.2	124.7	9.50	14.125		
1,800.0	1,790.2	1,792.5	1,775.3	4.9	5.6	85.16	155.3	-161.3	143.7	133.5	10.16	14.139		
1,900.0	1,889.4	1,892.1	1,873.5	5.2	6.0	85.16	165.6	-173.6	153.1	142.2	10.82	14.151		
2,000.0	1,988.6	1,991.6	1,971.8	5.6	6.4	85.16	175.9	-186.0	162.5	151.0	11.47	14.160		
2,100.0	2,087.8	2,091.2	2,070.0	5.9	6.7	85.16	186.2	-198.3	171.9	159.7	12.13	14.169		
2,200.0	2,187.1	2,190.7	2,168.3	6.2	7.1	85.16	196.5	-210.7	181.3	168.5	12.79	14.176		
2,300.0	2,286.3	2,290.3	2,266.5	6.5	7.5	85.16	206.8	-223.1	190.7	177.2	13.45	14.183		

Cathedral Energy Services

Anticollision Report

Company:	Caerus Oil & Gas (NAD 27)	Local Co-ordinate Reference:	Well PUCKETT 44A-2
Project:	Garfield County, CO	TVD Reference:	KB=22' @ 8446.0usft
Reference Site:	S2-T7S-R97W (Puckett Pad P2)	MD Reference:	KB=22' @ 8446.0usft
Site Error:	0.0usft	North Reference:	True
Reference Well:	PUCKETT 44A-2	Survey Calculation Method:	Minimum Curvature
Well Error:	0.0usft	Output errors are at	2.00 sigma
Reference Wellbore	DD	Database:	USA EDM 5000 Multi Users DB
Reference Design:	Plan #1	Offset TVD Reference:	Offset Datum

Offset Design S2-T7S-R97W (Puckett Pad P2) - PUCKETT 43D-2 - DD - Plan #1													Offset Site Error:	0.0 usft
Survey Program: 0-ISCWSA MWD													Offset Well Error:	0.0 usft
Reference		Offset		Semi Major Axis		Highside Toolface (°)	Distance		Total Uncertainty Axis	Separation Factor	Warning			
Measured Depth (usft)	Vertical Depth (usft)	Measured Depth (usft)	Vertical Depth (usft)	Reference (usft)	Offset (usft)		Offset Wellbore Centre +N/-S (usft)	+E/-W (usft)						
0.0	0.0	0.0	0.0	0.0	0.0	29.72	6.9	4.0	8.0					
100.0	100.0	100.0	100.0	0.1	0.1	29.72	6.9	4.0	8.0	7.8	0.18	45.480		
200.0	200.0	200.0	200.0	0.3	0.3	29.72	6.9	4.0	8.0	7.3	0.62	12.761		
300.0	300.0	300.0	300.0	0.5	0.5	29.72	6.9	4.0	8.0	6.9	1.07	7.421 CC		
360.0	360.0	360.0	360.0	0.7	0.7	114.57	7.1	3.7	8.0	6.7	1.34	6.003		
400.0	400.0	400.0	400.0	0.8	0.8	105.86	7.5	2.6	8.0	6.5	1.52	5.289 ES		
500.0	499.9	499.8	499.6	1.0	1.0	89.87	10.3	-3.3	10.0	8.0	1.96	5.098 SF		
600.0	599.5	599.5	598.6	1.2	1.2	82.37	15.1	-13.9	14.2	11.7	2.47	5.740		
700.0	698.7	699.4	697.5	1.5	1.5	83.01	20.8	-26.3	18.9	15.9	3.03	6.238		
800.0	797.9	799.3	796.5	1.8	1.9	83.51	26.5	-38.7	23.6	20.0	3.62	6.522		
900.0	897.2	899.2	895.4	2.1	2.2	83.84	32.2	-51.0	28.4	24.1	4.23	6.697		
1,000.0	996.4	999.1	994.4	2.4	2.5	84.08	37.8	-63.4	33.1	28.2	4.86	6.812		
1,100.0	1,095.6	1,099.0	1,093.4	2.7	2.8	84.26	43.5	-75.8	37.8	32.3	5.49	6.892		
1,200.0	1,194.8	1,198.8	1,192.3	3.0	3.2	84.39	49.2	-88.2	42.6	36.4	6.12	6.949		
1,300.0	1,294.1	1,298.7	1,291.3	3.3	3.5	84.51	54.9	-100.5	47.3	40.5	6.76	6.992		
1,400.0	1,393.3	1,398.6	1,390.2	3.6	3.8	84.60	60.5	-112.9	52.0	44.6	7.40	7.025		
1,500.0	1,492.5	1,498.5	1,489.2	4.0	4.2	84.67	66.2	-125.3	56.8	48.7	8.05	7.051		
1,600.0	1,591.7	1,598.4	1,588.1	4.3	4.5	84.74	71.9	-137.7	61.5	52.8	8.69	7.072		
1,700.0	1,691.0	1,698.3	1,687.1	4.6	4.8	84.79	77.6	-150.0	66.2	56.9	9.34	7.089		
1,800.0	1,790.2	1,798.2	1,786.0	4.9	5.2	84.84	83.3	-162.4	71.0	61.0	9.99	7.103		
1,900.0	1,889.4	1,898.1	1,885.0	5.2	5.5	84.88	88.9	-174.8	75.7	65.1	10.64	7.115		
2,000.0	1,988.6	1,997.9	1,984.0	5.6	5.8	84.92	94.6	-187.2	80.4	69.1	11.29	7.126		
2,100.0	2,087.8	2,097.8	2,082.9	5.9	6.2	84.95	100.3	-199.5	85.2	73.2	11.94	7.134		
2,200.0	2,187.1	2,197.7	2,181.9	6.2	6.5	84.98	106.0	-211.9	89.9	77.3	12.59	7.142		
2,300.0	2,286.3	2,297.6	2,280.8	6.5	6.8	85.00	111.6	-224.3	94.6	81.4	13.24	7.149		
2,400.0	2,385.5	2,397.5	2,379.8	6.9	7.2	85.03	117.3	-236.7	99.4	85.5	13.89	7.155		
2,500.0	2,484.7	2,497.4	2,478.7	7.2	7.5	85.05	123.0	-249.0	104.1	89.6	14.54	7.161		
2,600.0	2,584.0	2,597.3	2,577.7	7.5	7.9	85.07	128.7	-261.4	108.8	93.6	15.19	7.165		
2,700.0	2,683.2	2,697.2	2,676.6	7.8	8.2	85.09	134.4	-273.8	113.6	97.7	15.84	7.170		
2,800.0	2,782.4	2,797.1	2,775.6	8.1	8.5	85.10	140.0	-286.1	118.3	101.8	16.49	7.174		
2,900.0	2,881.6	2,896.9	2,874.6	8.5	8.9	85.12	145.7	-298.5	123.0	105.9	17.14	7.178		
3,000.0	2,980.9	2,996.8	2,973.5	8.8	9.2	85.13	151.4	-310.9	127.8	110.0	17.79	7.181		
3,100.0	3,080.1	3,096.7	3,072.5	9.1	9.5	85.15	157.1	-323.3	132.5	114.1	18.44	7.184		
3,200.0	3,179.3	3,196.6	3,171.4	9.4	9.9	85.16	162.8	-335.6	137.2	118.1	19.10	7.187		
3,300.0	3,278.5	3,296.5	3,270.4	9.8	10.2	85.17	168.4	-348.0	142.0	122.2	19.75	7.190		
3,400.0	3,377.8	3,396.4	3,369.3	10.1	10.6	85.18	174.1	-360.4	146.7	126.3	20.40	7.193		
3,500.0	3,477.0	3,496.3	3,468.3	10.4	10.9	85.19	179.8	-372.8	151.4	130.4	21.05	7.195		
3,600.0	3,576.2	3,596.2	3,567.2	10.7	11.2	85.20	185.5	-385.1	156.2	134.5	21.70	7.197		
3,700.0	3,675.4	3,696.0	3,666.2	11.1	11.6	85.21	191.1	-397.5	160.9	138.6	22.35	7.199		
3,800.0	3,774.7	3,795.9	3,765.2	11.4	11.9	85.22	196.8	-409.9	165.6	142.6	23.00	7.202		
3,900.0	3,873.9	3,895.8	3,864.1	11.7	12.3	85.23	202.5	-422.3	170.4	146.7	23.65	7.204		
4,000.0	3,973.1	3,995.7	3,963.1	12.0	12.6	85.23	208.2	-434.6	175.1	150.8	24.30	7.205		
4,100.0	4,072.3	4,095.6	4,062.0	12.4	12.9	85.24	213.9	-447.0	179.9	154.9	24.95	7.207		
4,200.0	4,171.6	4,195.5	4,161.0	12.7	13.3	85.25	219.5	-459.4	184.6	159.0	25.61	7.209		
4,300.0	4,270.8	4,295.4	4,259.9	13.0	13.6	85.25	225.2	-471.8	189.3	163.1	26.26	7.211		
4,400.0	4,370.0	4,395.3	4,358.9	13.3	13.9	85.26	230.9	-484.1	194.1	167.1	26.91	7.212		
4,500.0	4,469.2	4,495.1	4,457.8	13.7	14.3	85.26	236.6	-496.5	198.8	171.2	27.56	7.214		

CC - Min centre to center distance or convergent point, SF - min separation factor, ES - min ellipse separation

Cathedral Energy Services

Anticollision Report

Company:	Caerus Oil & Gas (NAD 27)	Local Co-ordinate Reference:	Well PUCKETT 44A-2
Project:	Garfield County, CO	TVD Reference:	KB=22' @ 8446.0usft
Reference Site:	S2-T7S-R97W (Puckett Pad P2)	MD Reference:	KB=22' @ 8446.0usft
Site Error:	0.0usft	North Reference:	True
Reference Well:	PUCKETT 44A-2	Survey Calculation Method:	Minimum Curvature
Well Error:	0.0usft	Output errors are at	2.00 sigma
Reference Wellbore	DD	Database:	USA EDM 5000 Multi Users DB
Reference Design:	Plan #1	Offset TVD Reference:	Offset Datum

Offset Design S2-T7S-R97W (Puckett Pad P2) - PUCKETT 44B-2 - DD - Plan #1													Offset Site Error:	0.0 usft
Survey Program: 0-ISCWSA MWD													Offset Well Error:	0.0 usft
Reference		Offset		Semi Major Axis		Highside Toolface (°)	Distance		Total Uncertainty Axis	Separation Factor	Warning			
Measured Depth (usft)	Vertical Depth (usft)	Measured Depth (usft)	Vertical Depth (usft)	Reference (usft)	Offset (usft)		Offset Wellbore Centre +N/-S (usft)	+E/-W (usft)						
0.0	0.0	0.0	0.0	0.0	0.0	-148.20	-7.3	-4.5	8.6					
100.0	100.0	100.0	100.0	0.1	0.1	-148.20	-7.3	-4.5	8.6	8.4	0.18	48.891		
200.0	200.0	200.0	200.0	0.3	0.3	-148.20	-7.3	-4.5	8.6	7.9	0.62	13.717		
300.0	300.0	300.0	300.0	0.5	0.5	-148.20	-7.3	-4.5	8.6	7.5	1.07	7.978 CC, ES		
400.0	400.0	399.7	399.7	0.8	0.8	-57.72	-7.7	-5.9	9.6	8.1	1.51	6.378 SF		
500.0	499.9	499.2	498.9	1.0	1.0	-55.30	-9.6	-12.1	12.8	10.9	1.95	6.563		
600.0	599.5	598.6	597.7	1.2	1.2	-58.96	-13.0	-23.0	17.2	14.8	2.45	7.032		
700.0	698.7	698.5	696.8	1.5	1.5	-66.63	-16.8	-35.2	21.2	18.2	2.96	7.158		
800.0	797.9	798.4	795.9	1.8	1.8	-71.91	-20.5	-47.5	25.4	21.9	3.52	7.209		
900.0	897.2	898.3	894.9	2.1	2.1	-75.66	-24.3	-59.7	29.8	25.7	4.12	7.228		
1,000.0	996.4	998.2	994.0	2.4	2.4	-78.45	-28.1	-71.9	34.2	29.5	4.73	7.234		
1,100.0	1,095.6	1,098.1	1,093.1	2.7	2.8	-80.59	-31.9	-84.1	38.8	33.4	5.36	7.235		
1,200.0	1,194.8	1,198.0	1,192.1	3.0	3.1	-82.28	-35.6	-96.3	43.4	37.4	5.99	7.234		
1,300.0	1,294.1	1,297.9	1,291.2	3.3	3.4	-83.64	-39.4	-108.5	48.0	41.3	6.63	7.233		
1,400.0	1,393.3	1,397.7	1,390.3	3.6	3.7	-84.77	-43.2	-120.8	52.6	45.3	7.27	7.232		
1,500.0	1,492.5	1,497.6	1,489.3	4.0	4.1	-85.71	-47.0	-133.0	57.2	49.3	7.91	7.232		
1,600.0	1,591.7	1,597.5	1,588.4	4.3	4.4	-86.51	-50.7	-145.2	61.9	53.3	8.56	7.231		
1,700.0	1,691.0	1,697.4	1,687.5	4.6	4.7	-87.20	-54.5	-157.4	66.6	57.4	9.21	7.230		
1,800.0	1,790.2	1,797.3	1,786.5	4.9	5.1	-87.80	-58.3	-169.6	71.2	61.4	9.85	7.230		
1,900.0	1,889.4	1,897.2	1,885.6	5.2	5.4	-88.32	-62.1	-181.9	75.9	65.4	10.50	7.230		
2,000.0	1,988.6	1,997.1	1,984.7	5.6	5.7	-88.79	-65.8	-194.1	80.6	69.5	11.15	7.230		
2,100.0	2,087.8	2,097.0	2,083.7	5.9	6.0	-89.20	-69.6	-206.3	85.3	73.5	11.80	7.230		
2,200.0	2,187.1	2,196.9	2,182.8	6.2	6.4	-89.57	-73.4	-218.5	90.0	77.6	12.45	7.231		
2,300.0	2,286.3	2,296.7	2,281.9	6.5	6.7	-89.90	-77.2	-230.7	94.7	81.6	13.10	7.231		
2,400.0	2,385.5	2,396.6	2,380.9	6.9	7.0	-90.20	-80.9	-243.0	99.4	85.7	13.75	7.231		
2,500.0	2,484.7	2,496.5	2,480.0	7.2	7.4	-90.48	-84.7	-255.2	104.1	89.7	14.40	7.232		
2,600.0	2,584.0	2,596.4	2,579.1	7.5	7.7	-90.73	-88.5	-267.4	108.8	93.8	15.05	7.232		
2,700.0	2,683.2	2,696.3	2,678.1	7.8	8.0	-90.96	-92.3	-279.6	113.5	97.8	15.70	7.233		
2,800.0	2,782.4	2,796.2	2,777.2	8.1	8.4	-91.17	-96.0	-291.8	118.2	101.9	16.35	7.234		
2,900.0	2,881.6	2,896.1	2,876.3	8.5	8.7	-91.37	-99.8	-304.0	123.0	106.0	17.00	7.234		
3,000.0	2,980.9	2,996.0	2,975.3	8.8	9.0	-91.55	-103.6	-316.3	127.7	110.0	17.65	7.235		
3,100.0	3,080.1	3,095.8	3,074.4	9.1	9.4	-91.71	-107.4	-328.5	132.4	114.1	18.30	7.235		
3,200.0	3,179.3	3,195.7	3,173.5	9.4	9.7	-91.87	-111.1	-340.7	137.1	118.2	18.95	7.236		
3,300.0	3,278.5	3,295.6	3,272.5	9.8	10.0	-92.02	-114.9	-352.9	141.8	122.2	19.60	7.237		
3,400.0	3,377.8	3,395.5	3,371.6	10.1	10.3	-92.15	-118.7	-365.1	146.5	126.3	20.25	7.238		
3,500.0	3,477.0	3,495.4	3,470.6	10.4	10.7	-92.28	-122.5	-377.4	151.3	130.4	20.90	7.238		
3,600.0	3,576.2	3,595.3	3,569.7	10.7	11.0	-92.40	-126.2	-389.6	156.0	134.4	21.55	7.239		
3,700.0	3,675.4	3,695.2	3,668.8	11.1	11.3	-92.51	-130.0	-401.8	160.7	138.5	22.20	7.240		
3,800.0	3,774.7	3,795.1	3,767.8	11.4	11.7	-92.62	-133.8	-414.0	165.4	142.6	22.85	7.240		
3,900.0	3,873.9	3,894.9	3,866.9	11.7	12.0	-92.72	-137.6	-426.2	170.2	146.7	23.50	7.241		
4,000.0	3,973.1	3,994.8	3,966.0	12.0	12.3	-92.82	-141.3	-438.5	174.9	150.7	24.15	7.242		
4,100.0	4,072.3	4,094.7	4,065.0	12.4	12.7	-92.91	-145.1	-450.7	179.6	154.8	24.80	7.243		
4,200.0	4,171.6	4,194.6	4,164.1	12.7	13.0	-92.99	-148.9	-462.9	184.3	158.9	25.45	7.243		
4,300.0	4,270.8	4,294.5	4,263.2	13.0	13.3	-93.08	-152.7	-475.1	189.0	163.0	26.10	7.244		
4,400.0	4,370.0	4,394.4	4,362.2	13.3	13.7	-93.15	-156.4	-487.3	193.8	167.0	26.75	7.245		
4,500.0	4,469.2	4,494.3	4,461.3	13.7	14.0	-93.23	-160.2	-499.5	198.5	171.1	27.40	7.246		

Cathedral Energy Services

Anticollision Report

Company:	Caerus Oil & Gas (NAD 27)	Local Co-ordinate Reference:	Well PUCKETT 44A-2
Project:	Garfield County, CO	TVD Reference:	KB=22' @ 8446.0usft
Reference Site:	S2-T7S-R97W (Puckett Pad P2)	MD Reference:	KB=22' @ 8446.0usft
Site Error:	0.0usft	North Reference:	True
Reference Well:	PUCKETT 44A-2	Survey Calculation Method:	Minimum Curvature
Well Error:	0.0usft	Output errors are at	2.00 sigma
Reference Wellbore	DD	Database:	USA EDM 5000 Multi Users DB
Reference Design:	Plan #1	Offset TVD Reference:	Offset Datum

Offset Design S2-T7S-R97W (Puckett Pad P2) - PUCKETT 44C-2 - DD - Plan #1													Offset Site Error: 0.0 usft	
Survey Program: 0-ISCSWA MWD													Offset Well Error: 0.0 usft	
Reference		Offset		Semi Major Axis			Distance						Warning	
Measured Depth (usft)	Vertical Depth (usft)	Measured Depth (usft)	Vertical Depth (usft)	Reference (usft)	Offset (usft)	Highside Toolface (°)	Offset Wellbore Centre +N/-S (usft)	+E/-W (usft)	Between Centres (usft)	Between Ellipses (usft)	Total Uncertainty Axis	Separation Factor		
0.0	0.0	0.0	0.0	0.0	0.0	-149.20	-14.2	-8.5	16.5					
100.0	100.0	100.0	100.0	0.1	0.1	-149.20	-14.2	-8.5	16.5	16.4	0.18	94.333		
200.0	200.0	200.0	200.0	0.3	0.3	-149.20	-14.2	-8.5	16.5	15.9	0.62	26.467		
255.6	255.6	255.6	255.6	0.4	0.4	-149.20	-14.2	-8.5	16.5	15.7	0.87	18.908 CC		
300.0	300.0	299.8	299.8	0.5	0.5	-148.97	-14.3	-8.6	16.7	15.6	1.07	15.615 ES		
400.0	400.0	398.9	398.8	0.8	0.7	-59.29	-16.5	-11.8	20.2	18.7	1.50	13.525 SF		
500.0	499.9	497.5	497.0	1.0	1.0	-59.75	-21.6	-19.1	26.7	24.8	1.95	13.724		
600.0	599.5	596.2	594.8	1.2	1.3	-64.52	-29.5	-30.2	35.2	32.8	2.45	14.383		
700.0	698.7	695.8	693.2	1.5	1.6	-70.91	-37.9	-42.3	43.6	40.6	2.98	14.648		
800.0	797.9	795.3	791.7	1.8	1.9	-75.27	-46.4	-54.3	52.3	48.8	3.55	14.740		
900.0	897.2	894.9	890.2	2.1	2.3	-78.38	-54.8	-66.4	61.2	57.1	4.15	14.756		
1,000.0	996.4	994.4	988.6	2.4	2.6	-80.69	-63.3	-78.4	70.3	65.5	4.77	14.742		
1,100.0	1,095.6	1,094.0	1,087.1	2.7	3.0	-82.48	-71.7	-90.5	79.4	74.0	5.40	14.718		
1,200.0	1,194.8	1,193.6	1,185.5	3.0	3.3	-83.89	-80.2	-102.5	88.7	82.6	6.03	14.692		
1,300.0	1,294.1	1,293.1	1,284.0	3.3	3.7	-85.04	-88.6	-114.6	97.9	91.2	6.68	14.667		
1,400.0	1,393.3	1,392.7	1,382.5	3.6	4.0	-85.99	-97.1	-126.6	107.2	99.9	7.32	14.643		
1,500.0	1,492.5	1,492.2	1,480.9	4.0	4.4	-86.78	-105.5	-138.7	116.5	108.5	7.97	14.622		
1,600.0	1,591.7	1,591.8	1,579.4	4.3	4.7	-87.46	-114.0	-150.7	125.8	117.2	8.62	14.603		
1,700.0	1,691.0	1,691.3	1,677.8	4.6	5.1	-88.05	-122.4	-162.8	135.2	125.9	9.27	14.586		
1,800.0	1,790.2	1,790.9	1,776.3	4.9	5.5	-88.56	-130.9	-174.8	144.5	134.6	9.92	14.571		
1,900.0	1,889.4	1,890.4	1,874.8	5.2	5.8	-89.00	-139.3	-186.9	153.9	143.3	10.57	14.557		
2,000.0	1,988.6	1,990.0	1,973.2	5.6	6.2	-89.40	-147.8	-198.9	163.3	152.0	11.23	14.545		
2,100.0	2,087.8	2,089.5	2,071.7	5.9	6.5	-89.75	-156.2	-211.0	172.7	160.8	11.88	14.535		
2,200.0	2,187.1	2,189.1	2,170.1	6.2	6.9	-90.07	-164.7	-223.0	182.0	169.5	12.53	14.526		
2,300.0	2,286.3	2,288.6	2,268.6	6.5	7.3	-90.36	-173.1	-235.1	191.4	178.2	13.19	14.517		

Cathedral Energy Services

Anticollision Report

Company:	Caerus Oil & Gas (NAD 27)	Local Co-ordinate Reference:	Well PUCKETT 44A-2
Project:	Garfield County, CO	TVD Reference:	KB=22' @ 8446.0usft
Reference Site:	S2-T7S-R97W (Puckett Pad P2)	MD Reference:	KB=22' @ 8446.0usft
Site Error:	0.0usft	North Reference:	True
Reference Well:	PUCKETT 44A-2	Survey Calculation Method:	Minimum Curvature
Well Error:	0.0usft	Output errors are at	2.00 sigma
Reference Wellbore	DD	Database:	USA EDM 5000 Multi Users DB
Reference Design:	Plan #1	Offset TVD Reference:	Offset Datum

Offset Design S2-T7S-R97W (Puckett Pad P2) - PUCKETT 44D-2 - DD - Plan #1													Offset Site Error: 0.0 usft	
Survey Program: 0-ISCSWA MWD													Offset Well Error: 0.0 usft	
Reference		Offset		Semi Major Axis			Distance						Warning	
Measured Depth (usft)	Vertical Depth (usft)	Measured Depth (usft)	Vertical Depth (usft)	Reference (usft)	Offset (usft)	Highside Toolface (°)	Offset Wellbore Centre +N/-S (usft)	+E/-W (usft)	Between Centres (usft)	Between Ellipses (usft)	Total Uncertainty Axis	Separation Factor		
0.0	0.0	0.0	0.0	0.0	0.0	-148.65	-20.4	-12.4	23.9					
100.0	100.0	100.0	100.0	0.1	0.1	-148.65	-20.4	-12.4	23.9	23.7	0.18	136.197		
200.0	200.0	200.0	200.0	0.3	0.3	-148.65	-20.4	-12.4	23.9	23.3	0.62	38.213 CC, ES		
300.0	300.0	299.1	299.0	0.5	0.5	-148.03	-21.5	-13.4	25.3	24.2	1.06	23.939		
400.0	400.0	397.4	397.2	0.8	0.7	-60.55	-26.1	-17.7	31.6	30.1	1.50	21.012		
500.0	499.9	495.1	494.2	1.0	1.0	-62.65	-34.5	-25.3	41.1	39.2	1.96	20.959 SF		
600.0	599.5	592.6	590.4	1.2	1.3	-67.68	-46.3	-36.1	53.4	50.9	2.47	21.586		
700.0	698.7	691.6	687.8	1.5	1.7	-73.32	-59.4	-47.9	66.2	63.2	3.01	22.017		
800.0	797.9	790.6	785.2	1.8	2.1	-77.18	-72.4	-59.8	79.5	75.9	3.58	22.174		
900.0	897.2	889.6	882.6	2.1	2.5	-79.92	-85.4	-71.7	93.0	88.8	4.19	22.199		
1,000.0	996.4	988.6	980.0	2.4	2.8	-81.97	-98.5	-83.5	106.6	101.8	4.81	22.169		
1,100.0	1,095.6	1,087.6	1,077.4	2.7	3.2	-83.55	-111.5	-95.4	120.4	114.9	5.44	22.119		
1,200.0	1,194.8	1,186.6	1,174.9	3.0	3.6	-84.80	-124.5	-107.3	134.2	128.1	6.08	22.065		
1,300.0	1,294.1	1,285.6	1,272.3	3.3	4.0	-85.83	-137.6	-119.1	148.1	141.4	6.73	22.010		
1,400.0	1,393.3	1,384.6	1,369.7	3.6	4.4	-86.67	-150.6	-131.0	162.0	154.7	7.38	21.960		
1,500.0	1,492.5	1,483.6	1,467.1	4.0	4.8	-87.38	-163.6	-142.9	176.0	168.0	8.03	21.913		
1,600.0	1,591.7	1,582.6	1,564.5	4.3	5.2	-87.99	-176.7	-154.7	190.0	181.3	8.69	21.872		

Cathedral Energy Services

Anticollision Report

Company:	Caerus Oil & Gas (NAD 27)	Local Co-ordinate Reference:	Well PUCKETT 44A-2
Project:	Garfield County, CO	TVD Reference:	KB=22' @ 8446.0usft
Reference Site:	S2-T7S-R97W (Puckett Pad P2)	MD Reference:	KB=22' @ 8446.0usft
Site Error:	0.0usft	North Reference:	True
Reference Well:	PUCKETT 44A-2	Survey Calculation Method:	Minimum Curvature
Well Error:	0.0usft	Output errors are at	2.00 sigma
Reference Wellbore	DD	Database:	USA EDM 5000 Multi Users DB
Reference Design:	Plan #1	Offset TVD Reference:	Offset Datum

Reference Depths are relative to KB=22' @ 8446.0usft
Offset Depths are relative to Offset Datum
Central Meridian is -105.500000 °

Coordinates are relative to: PUCKETT 44A-2
Coordinate System is US State Plane 1927 (Exact solution), Colorado Central 502
Grid Convergence at Surface is: -1.69°

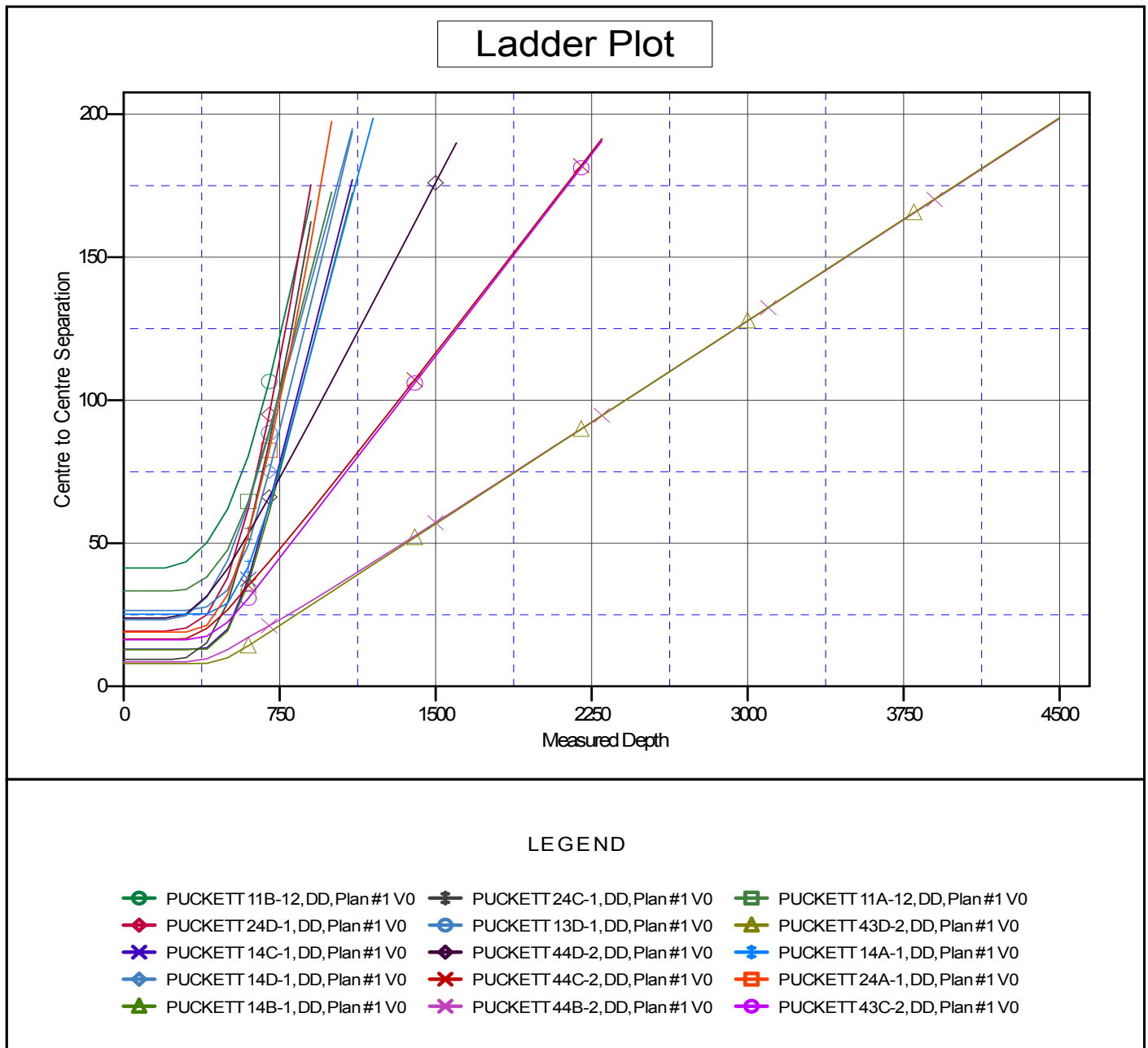

CC - Min centre to center distance or convergent point, SF - min separation factor, ES - min ellipse separation