

27

Rev 6/99

01761415

State of Colorado

Oil and Gas Conservation Commission



1120 Lincoln Street, Suite 801, Denver, Colorado 80203 (303)894-2100 Fax:(303)894-2109

SITE INVESTIGATION AND REMEDIATION WORKPLAN

This form shall be submitted to the Director for approval prior to the initiation of site investigation and remediation activities. Form 27 is intended to be used whenever possible. Additional documentation will be required when large volumes of soil and groundwater have been impacted or involve large facilities with multiple source areas. See Rule 910. Attach as many pages as needed to fully describe the proposed work.

CAUSE OF CONDITION BEING INVESTIGATED AND REMEDIATED

☒ Spill or Release ☒ Plug & Abandon ☐ Central Facility Closure ☐ Site/Facility Closure ☐ Other (describe):

OGCC Operator Number: 27635

Name of Operator: Don Robuck

Address: Po Box 1896

City: Edwards State: CO Zip: 81632

Contact Name and Telephone:
Brett Robuck

No: 308-340-3243

Fax: rpllc@msn.com

API Number: 001-08788

County: Adams

Facility Name: WIERMAN Lease

Facility Number: 203279

Well Name: WIERMAN 6

Well Number: 6

Location: (QtrQtr, Sec, Twp, Rng, Meridian): SWSE, 7-1S-67W, 6TH PM Latitude: 39.97401 Longitude: 104.9291

TECHNICAL CONDITIONS

Type of Waste Causing Impact (crude oil, condensate, produced water, etc.): Crude Oil

Site Conditions: Is location within a sensitive area (according to Rule 901e)? ☐ Y ☒ N If yes, attach evaluation.

Adjacent land use (cultivated, irrigated, dry land farming, industrial, residential, etc.): Dry Land Farming

Soil type, if not previously identified on Form 2A or Federal Surface Use Plan: Top Soil

Potential receptors (water wells within 1/4 mi, surface waters, etc.): unknown

Description of Impact (if previously provided, refer to that form or document):

Impacted Media (check):



Soils



Vegetation



Groundwater



Surface Water

Extent of Impact:

Motor Oil and Stuffing Box Leaks

How Determined:

Visual Inspection and NOV's

REMEDIALATION WORKPLAN

Describe initial action taken (if previously provided, refer to that form or document):

We brought in a winch truck from ATP out of Hudson CO, and moved all pumping units on site. Barron's Oilfield Service Inc. Out of Fort Lupton CO brought in a backhoe and dump trucks and removed all contaminated dirt under pumping units and at wellhead. Refer to diagrams. All dirt was taken to Buffalo Ridge 11655 CR 59 Keenesburg, CO, 80643 Refer to Ticket 910837.

Describe how source is to be removed:

All Contaminated dirt was dug up by shovel and backhoe, put in dump truck and taken to Buffalo Ridge 11655 CR 59 Keenesburg, CO, 80643.

Describe how remediation of existing impacts is to be accomplished, including removal and disposal at an injection well or licensed facility, land treatment on site, removal of impacted groundwater, insitu bioremediation, burning of oily vegetation, etc.:

Wierman 4, 5, 6 and Sauvage 3-A are all in the first stages of being plugged and abandon. All Contaminated dirt was dug up by shovel and backhoe, put in dump truck and taken to Buffalo Ridge 11655 CR 59 Keenesburg, CO, 80643. New top soil will be brought in when plugging is complete. Plugging first well begins Monday October 6, 2014.

Submit Page 2 with Page 1

RECEIVED

OCT 02 2014

COGCC

☐ Spill ☐ Complaint
☐ Inspection ☒ NOAV

Tracking No: 200407200



Tracking Number: NOAV #200407200

Name of Operator: Energy Search

OGCC Operator No: 27635

Received Date: 10/2/14

Well Name & No: Wierman 6

Facility Name & No: _____

Page 2

REMEDIAL WORKPLAN (Cont.)

OGCC Employee: John Axelsson

If groundwater has been impacted, describe proposed monitoring plan (# of wells or sample points, sampling schedule, analytical methods, etc.):
N/A

Describe reclamation plan. Discuss existing and new grade recontouring; method and testing of compaction alleviation; and reseeding program, including location of new seed, seed mix and noxious weed prevention. Attach diagram or drawing. Use additional sheet for description if required.
We have been in contact with Justin Solomon with LT Environmental as well as Mark and Mike Stonehocker the land owners. We have put in place a plan to plug all Wierman well's 4, 5, 6 and Sauvage 3-A well. Plugging begins monday October 6, 2014. LT Environmental is set to take samples same day and come up with remediation plan that will be done to COGCC requirements. As soon LT has processed dirt sample they are to send result to us and to COGCC.

Attach samples and analytical results taken to verify remediation of impacts. Show locations of samples on an onsite schematic or drawing.

Is further site investigation required? ☐ Y ☒ N If yes, describe:
Evaluations of dirt samples from LT Environmental will be sent to you from LT Environment as soon samples are evaluated. We will follow up as well and sent any report we receive from LT Environmental.

Final disposition of E&P waste (landtreated and disposed onsite, name of licensed disposal facility, recycling, reuse, etc.):
All Contaminated dirt was dug up by shovel and backhoe, put in dump truck and taken to Buffalo Ridge 11655 CR 59 Keenesburg, CO, 80643.
Wierman 4, 5, 6 and Sauvage 3-A are all in the first stages of being plugged and abandon. All Contaminated dirt was dug up by shovel and backhoe, put in dump truck and taken to Buffalo Ridge 11655 CR 59 Keenesburg, CO, 80643. New top soil will be brought in when plugging is complete. Plugging first well begins Monday October 6, 2014.

IMPLEMENTATION SCHEDULE

Date Site Investigation Began: <u>12/16/13</u>	Date Site Investigation Completed: <u>12/17/13</u>	Date Remediation Plan Submitted: <u>10/2/14</u>
Remediation Start Date: <u>9/3/14</u>	Anticipated Completion Date: <u>9/26/14</u>	Actual Completion Date: <u>9/29/14</u>

I hereby certify that the statements made in this form are, to the best of my knowledge, true, correct, and complete.

Print Name: Brett Robuck

Title: Energy Search

Signed: [Signature]

Date: 10/2/14

OGCC Approved: [Signature]

Title: EPS

Date: 10/21/14

WIERMAN 4, 5, 6 and Sauvage 3-A:

All signage on Weirman 4, 5, 6 and Sauvage 3-A has been fixed and has proper facility names and numbers to comply with rule 210. Battery sign does now list all wells serviced by facilities to comply with rule 210. All water tanks now have the required capacity signage to comply with rule 210.

We brought in a winch truck from ATP out of Hudson CO, and moved all pumping units on site. Barron's Oilfield Service Inc. Out of Fort Lupton CO brought in a backhoe and dump trucks and removed all contaminated dirt under pumping units and at wellhead. Refer to diagrams. All dirt was taken to Buffalo Ridge 11655 CR 59 Keenesburg, CO, 80643 Refer to Ticket's.

All Contaminated dirt was dug up by shovel and backhoe, put in dump truck and taken to Buffalo Ridge 11655 CR 59 Keenesburg, CO, 80643. Wierman 4, 5, 6 and Sauvage 3-A are all in the first stages of being plugged and abandon. All Contaminated dirt was dug up by shovel and backhoe, put in dump truck and taken to Buffalo Ridge 11655 CR 59 Keenesburg, CO, 80643. New top soil will be brought in when plugging is complete. Plugging first well begins Monday October 6, 2014.

Wierman #6

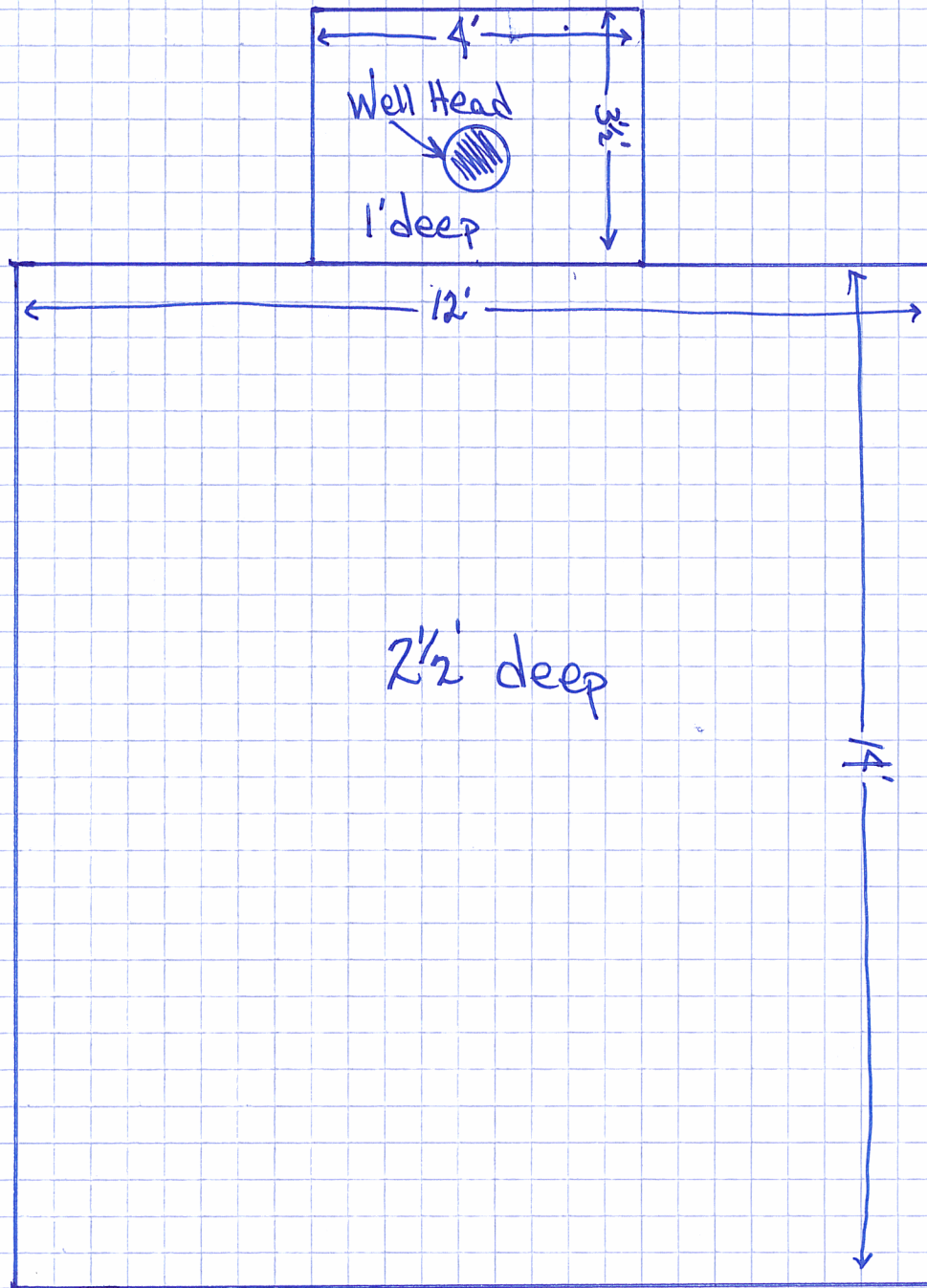

Energy Search contaminated dirt removal.

Wierman 6:

We moved pumping unit and removed all contaminated dirt from under the engine and under pumping unit an area equal to:

Width= 12 ft.

Length= 14 ft.

Depth= 2 ½ ft.

Wierman 6:

We also removed all contaminated dirt around wellhead an area equal to:

Width= 3 ½ ft.

Length= 4 ft.

Depth= 1 ft.

All dirt was removed by shovel and backhoe into a dump truck and taken to Waste Management Buffalo Ridge Landfill 11655 WCR 59 Keenesburg CO 80643

Total amount of NON REGULATED SOLID (Contaminated Soil- Crude oil)
Was equal to:

11.26 Tons



7888873

Buffalo Ridge
11655 CR 59
Keenesburg, CO, 80643
Ph: (303)732-0218

Original
Ticket# 910837

Customer Name ENERGYSEARCHCO ENERGY SEARCH Carrier BARRONS BARRONS OIL FIELD SERVICES
Ticket Date 09/04/2014 Vehicle# 45 Volume
Payment Type Credit Card Container
Manual Ticket# Driver
Hauling Ticket# Check# 03783E
Route Billing # 0000399
State Waste Code Gen EPA ID
Manifest 139840
Destination Grid
PO Wierman#4-#5
Profile 114289CD (CONTAMINATED SOIL - CRUDE OIL)
Generator 125-ENERGYSEARCHCOMPANY ENERGY SEARCH COMPANY

	Time	Scale	Operator	Inbound	Gross	
In	09/04/2014 12:50:22	Scale 1	shaddock		Tare	44680 lb
Out	09/04/2014 12:50:22		shaddock		Net	22160 lb
Comments					Tons	22520 lb
						11.26

Hours: M-F 7AM-4PM, Sat: 8AM-1PM

Product	LD%	Qty	UOM	Rate	Tax	Amount	Origin
1 Cont Soil Pet-Tons	100	11.26	Tons				WIERMAN 6,
2 RCR-P-Regulatory C	100		%				WIERMAN 6,
3 FUEL-Fuel Surcharg	100		%				WIERMAN 6,
4 EVF-L-Standard Env	100	1	Load				WIERMAN 6,

Amt \$264.73, Amt Tendered \$264.73, Chg Due \$0.00

Total Tax
Total Ticket



NON-HAZARDOUS WASTE MANIFEST		1. Generator ID Number N / A		2. Page 1 of 1		3. Emergency Response Phone (800) 424-8300		4. Waste Tracking Number 139840	
		5. Generator's Name and Mailing Address ENERGY SEARCH CO 13600 TRENTON PLACE BRIGHTON CO 80602		Generator's Site Address (if different than mailing address) W. J. R. M. A. N. H. C. Y.					
Generator's Phone: (303) 320-6546									
6. Transporter 1 Company Name		U.S. EPA ID Number							
7. Transporter 2 Company Name		U.S. EPA ID Number							
8. Designated Facility Name and Site Address Buffalo Ridge Landfill 11655 WCR 59 Keenesburg CO 80643		U.S. EPA ID Number							
Facility's Phone: (303) 732-0218									
9. Waste Shipping Name and Description		10. Containers		11. Total Quantity		12. Unit Wt./Vol.			
		No.	Type						
1. NON REGULATED SOLID (CONTAMINATED SOIL - CRUDE OIL) 114289CO				10		cy		NONE	
2.				11-20		16m			
3.									
4.									
13. Special Handling Instructions and Additional Information Customer Acct #: BR 300 Customer Name: ENERGY SEARCH CO Transporter 1 address & phone #: Transporter 2 address & phone #:									
14. GENERATOR'S/OFFEROR'S CERTIFICATION: I hereby declare that the contents of this consignment are fully and accurately described above by the proper shipping name, and are classified, packaged, marked and labeled/placarded, and are in all respects in proper condition for transport according to applicable international and governmental regulations.									
Generator's/Offoror's Printed/Typed Name Carson Robison		Signature Carson Robison		Month 9		Day 3		Year 14	
15. International Shipments <input type="checkbox"/> Import to U.S. <input type="checkbox"/> Export from U.S.		Port of entry/exit:		Date leaving U.S.:					
16. Transporter Acknowledgement of Receipt of Materials									
Transporter 1 Printed/Typed Name		Signature		Month		Day		Year	
Transporter 2 Printed/Typed Name		Signature		Month		Day		Year	
17. Discrepancy									
17a. Discrepancy Indication Space <input type="checkbox"/> Quantity <input type="checkbox"/> Type <input type="checkbox"/> Residue <input type="checkbox"/> Partial Rejection <input type="checkbox"/> Full Rejection									
17b. Alternate Facility (or Generator) Manifest Reference Number: U.S. EPA ID Number									
Facility's Phone:									
17c. Signature of Alternate Facility (or Generator) Month Day Year									
18. Designated Facility Owner or Operator: Certification of receipt of materials covered by the manifest except as noted in Item 17a Printed/Typed Name Signature Month Day Year									

NON-HAZARDOUS WASTE MANIFEST		1. Generator ID Number N/A		2. Page 1 of 1	3. Emergency Response Phone (800) 424-9300	4. Waste Tracking Number 139844		
		5. Generator's Name and Mailing Address ENERGY SEARCH CO 13600 TRENTON PLACE BRIGHTON CO 80602						
		Generator's Site Address (if different than mailing address)						
		Generator's Phone: (303) 320-6546 SAVAGE						
		6. Transporter 1 Company Name BARRETT-GILFIELD SERVICE INC				U.S. EPA ID Number		
		7. Transporter 2 Company Name				U.S. EPA ID Number		
		8. Designated Facility Name and Site Address Buffalo Ridge Landfill 11655 WCR 59 Keenesburg CO 80643				U.S. EPA ID Number		
		Facility's Phone: (303) 732-0218						
GENERATOR	9. Waste Shipping Name and Description				10. Containers		11. Total Quantity	12. Unit Wt./Vol.
					No.	Type		
	1. NON REGULATED SOLID (CONTAMINATED SOIL - CRUDE OIL) 114289CO							NONE
	2.							
	3.							
4.								
13. Special Handling Instructions and Additional Information Customer Acct # BR 300 Customer Name ENERGY SEARCH CO Transporter 1 address & phone # 12345 DUNGEON AVE BRIGHTON CO 80602 Transporter 2 address & phone # 31557-0899 Wiscann S								
14. GENERATOR'S/OFFEROR'S CERTIFICATION: I hereby declare that the contents of this consignment are fully and accurately described above by the proper shipping name, and are classified, packaged, marked and labeled/placarded, and are in all respects in proper condition for transport according to applicable international and governmental regulations.								
Generator's/Offeror's Printed/Typed Name				Signature		Month Day Year		
INT'L	15. International Shipments <input type="checkbox"/> Import to U.S. <input type="checkbox"/> Export from U.S.				Port of entry/exit:			
	Transporter Signature (for exports only):				Date leaving U.S.:			
TRANSPORTER	16. Transporter Acknowledgement of Receipt of Materials							
	Transporter 1 Printed/Typed Name				Signature		Month Day Year	
	Transporter 2 Printed/Typed Name				Signature		Month Day Year	
DESIGNATED FACILITY	17. Discrepancy							
	17a. Discrepancy Indication Space <input type="checkbox"/> Quantity <input type="checkbox"/> Type <input type="checkbox"/> Residue <input type="checkbox"/> Partial Rejection <input type="checkbox"/> Full Rejection							
	17b. Alternate Facility (or Generator)				Manifest Reference Number:			
	Facility's Phone:				U.S. EPA ID Number			
	17c. Signature of Alternate Facility (or Generator)				Month Day Year			
18. Designated Facility Owner or Operator: Certification of receipt of materials covered by the manifest except as noted in Item 17a								
Printed/Typed Name				Signature		Month Day Year		

Radio ID 100*22*22933



SHOP: 1235 DENVER AVENUE, FORT LUPTON

CUSTOMER Energy Search

ADDRESS

INVOICE 34979

PLEASE WIKI

WELL NO. 106

CUSTOMER
P.O. NO.

DATE _____
CONTRACTOR _____
JOB NO. _____

Carson

[illegible]

EMPLOYEES TIME		HOURS	RATE	AMOUNT	EQUIPMENT	UNIT #	HOURS	RATE	AMOUNT
Operator/Foreman	Lupe	3	32.00	96.00	Pickup				
Helpers	Michael	3	30.00	90.00	Truck (1) Ton	39	3	24.00	102.00
	Alfonso	3	30.00	90.00	Backhoe	5	2	60.00	120.00
	Jose	3	30.00	90.00	Trencher				
	Oriley	4			Trailer				
TOTALS				360.00	Dump Truck	45	4	70.00	280.00
MATERIALS BOUGHT OUT				AMOUNT	Hotsty				
					Water Truck				
					Welder				
					Bush Hog				
TOTAL					TOTAL				502.00
					TOTAL INVOICE AMOUNT				812.80

APPROVED

For Customer

APPROVED

For Contractor

WHITE - Original + YELLOW - Office + PINK - Customer

BARRON'S OILFIELD SERVICE, INC.
P.O. BOX 212 • FORT WORTH, TEXAS 76101

Phone 303-857-0899 • Fax 303-857-0905

Cell 303-503-8922 • 303-961-3260

Radio ID 100*22*22933



CUSTOMER Energy Search

INVOICE **34974**

PLEASE W. Gorman

WELL NO. No. 6

CUSTOMER

P.O. NO.

DATE 9-3-2014

CONTRACTOR
JOB NO. 40502

[illegible]

EMPLOYEES TIME		HOURS	RATE	AMOUNT	EQUIPMENT	UNIT #	HOURS	RATE	AMOUNT
Operator/Foreman	Lupe	3	32.00	96.00	Pickup				
Helpers	Michael	3	30.00	90.00	Truck (1) Ton	39	3	34.00	102.00
	Alfredo	3	30.00	90.00	Backhoe	5	1	60.00	60.00
	Jose	3	30.00	90.00	Trencher				
	Alfonso				Trailer				
TOTALS				320.00	Dump Truck	8	3	70.00	210.00
MATERIALS BOUGHT OUT				AMOUNT	Hotsy				
					Water Truck				
					Welder				
					Bush Hog				
TOTAL					TOTAL				372.00
					TOTAL INVOICE AMOUNT				738.00

APPROVED [Signature]
For Customer

APPROVED Rita Barron
For Contractor

WHITE - Original ♦ YELLOW - Office ♦ PINK - Customer

BARRON'S OILFIELD SERVICE, INC.
P.O. BOX 240, FORT MYERS, FL 33902

Radio ID 100*22*22933



CUSTOMER Energy Search

ADDRESS

INVOICE 34978

LEASE Wierman

WELL NO. 146

CUSTOMER

P.O. NO. _____

DATE 9-4-2014

CONTRACTOR
JOB NO. Carson

[illegible]

EMPLOYEES TIME		HOURS	RATE	AMOUNT	EQUIPMENT	UNIT #	HOURS	RATE	AMOUNT
Operator/Foreman	Cupe	3	32.00	96.00	Pickup				
Helpers	Michael	3	30.00	90.00	Truck (1) Ton	39	3	34.00	102.00
	Alfonso	3	30.00	90.00	Backhoe	5	2	60.00	120.00
	Jose	3	30.00	90.00	Trencher				
	Shirley	3			Trailer				
TOTALS				360.00	Dump Truck	45	3	70.00	210.00
MATERIALS BOUGHT OUT				AMOUNT	Hotsy				
					Water Truck				
					Welder				
					Bush Hog				
TOTAL					TOTAL				432.00
					TOTAL INVOICE AMOUNT				798.00

APPROVED

For Customer

APPROVED

For Contractor

WHITE - Original ♦ YELLOW - Office ♦ PINK - Customer

BARRON'S OILFIELD SERVICE, INC.
P.O. BOX 248 FORT WORTH, TEXAS 76101

Radio ID 100*22*22933



CUSTOMER Energy Search

ADDRESS

INVOICE 34975

LEASE Leeman

WELL NO. 46

CUSTOMER
P.O. NO.

DATE 9-3-2014
CONTRACTOR
JOB NO.

FROM	TO	HOURS	WORK PERFORMED	TOTAL AMOUNT
11/1/11	12/1/11	2	Excavated with shovel all contaminated dirt all around pumping unit and all of the inside of the pumping unit as well contaminated dirt was being dumped onto dump truck. Fencing was removed in order to be able to clean	

EMPLOYEES TIME		HOURS	RATE	AMOUNT	EQUIPMENT	UNIT #	HOURS	RATE	AMOUNT
Operator/Foreman	Cupe	2	32.00	64.00	Pickup				
Helpers	Michael	2	30.00	60.00	Truck (1) Ton	39	2	31.00	62.00
	Alfonso	2	30.00	60.00	Backhoe	5	2	60.00	120.00
	Jesse	2	30.00	60.00	Trencher				
	Alfonso				Trailer				
TOTALS				244.00	Dump Truck	8	2	70.00	140.00
MATERIALS BOUGHT OUT				AMOUNT	Hotsy				
					Water Truck				
					Welder				
					Bush Hog				
					TOTAL				328.00
TOTAL					TOTAL INVOICE AMOUNT				572.00

APPROVED

For Customer

APPROVED

For Contractor

WHITE - Original ♦ YELLOW - Office ♦ PINK - Customer

BARRON'S OILFIELD SERVICE, INC.
P.O. BOX 210, FORT MYERS, FL 33902

Radio ID 100*22*22933



CUSTOMER Craig Search

ADDRESS

INVOICE 34976

LEASE WATERGATE

WELL NO. No. 4

CUSTOMER

DATE 9-3-2014

P.O. NO.

CONTRACTOR
JOB NO.

JOB NO. _____

Carson

FROM	TO	HOURS	WORK PERFORMED	TOTAL AMOUNT
6pm	3pm	3	Removed some of the fencing around pumping unit. started excavating with shovel all the contaminated dirt around pumping unit and inside as well. Contaminated was being dumped onto dump truck	

EMPLOYEES TIME				EQUIPMENT								
	HOURS	RATE	AMOUNT		UNIT #	HOURS	RATE	AMOUNT				
Operator/Foreman	Lupe	3	32.00	96	00	Pickup						
Helpers	Michael	3	30.00	90	00	Truck (1) Ton	39	3	34.00	102	00	
	Alfonso	3	30.00	90	00	Backhoe	5	2	60.00	120	00	
	Jesse	3	30.00	90	00	Trencher						
	Alfonso					Trailer						
TOTALS				366		00	Dump Truck	8	3	70.00	210	00
MATERIALS BOUGHT OUT				AMOUNT		Hotsy						
						Water Truck						
						Welder						
						Bush Hog						
						TOTAL						
TOTAL						TOTAL INVOICE AMOUNT						
						432						00
						798						00

APPROVED

Lucy Brown

For Customer

APPROVED

Rita Barron

For Contractor

WHITE - Original ♦ YELLOW - Office ♦ PINK - Customer

Radio ID 100*22*22933



SHOP: 1235 DENVER AVENUE, FORT LUPTON

CUSTOMER Energy Search

INVOICE 34977

ADDRESS

DATE 9-3-2014

PLEASE Savage

WELL NO. 7-15-67w

CUSTOMER
P.O. NO. _____

CONTRACTOR
JOB NO. _____

JOB NO.

[illegible]

EMPLOYEES TIME	HOURS	RATE	AMOUNT	EQUIPMENT	UNIT #	HOURS	RATE	AMOUNT
Operator/Foreman <i>Lupe</i>	3	<i>32.00</i>	<i>96.00</i>	Pickup				
Helpers <i>Michael</i>	3	<i>30.00</i>	<i>90.00</i>	Truck (1) Ton	<i>39</i>	<i>3</i>	<i>34</i>	<i>102.00</i>
<i>AK 150</i>	3	<i>30.00</i>	<i>90.00</i>	Backhoe	<i>5</i>	<i>2</i>	<i>60.00</i>	<i>120.00</i>
<i>Jose</i>	3	<i>30.00</i>	<i>90.00</i>	Trencher				
<i>AK 150</i>				Trailer				
TOTALS			<i>366.00</i>	Dump Truck	<i>8</i>	<i>3</i>	<i>70.00</i>	<i>210.00</i>
MATERIALS BOUGHT OUT			AMOUNT	Hotsy				
				Water Truck				
				Welder				
				Bush Hog				
				TOTAL				<i>432.00</i>
TOTAL				TOTAL INVOICE AMOUNT				<i>798.00</i>

APPROVED

For Customer

APPROVED

For Contractor

WHITE - Original ♦ YELLOW - Office ♦ PINK - Customer



Wierman #6

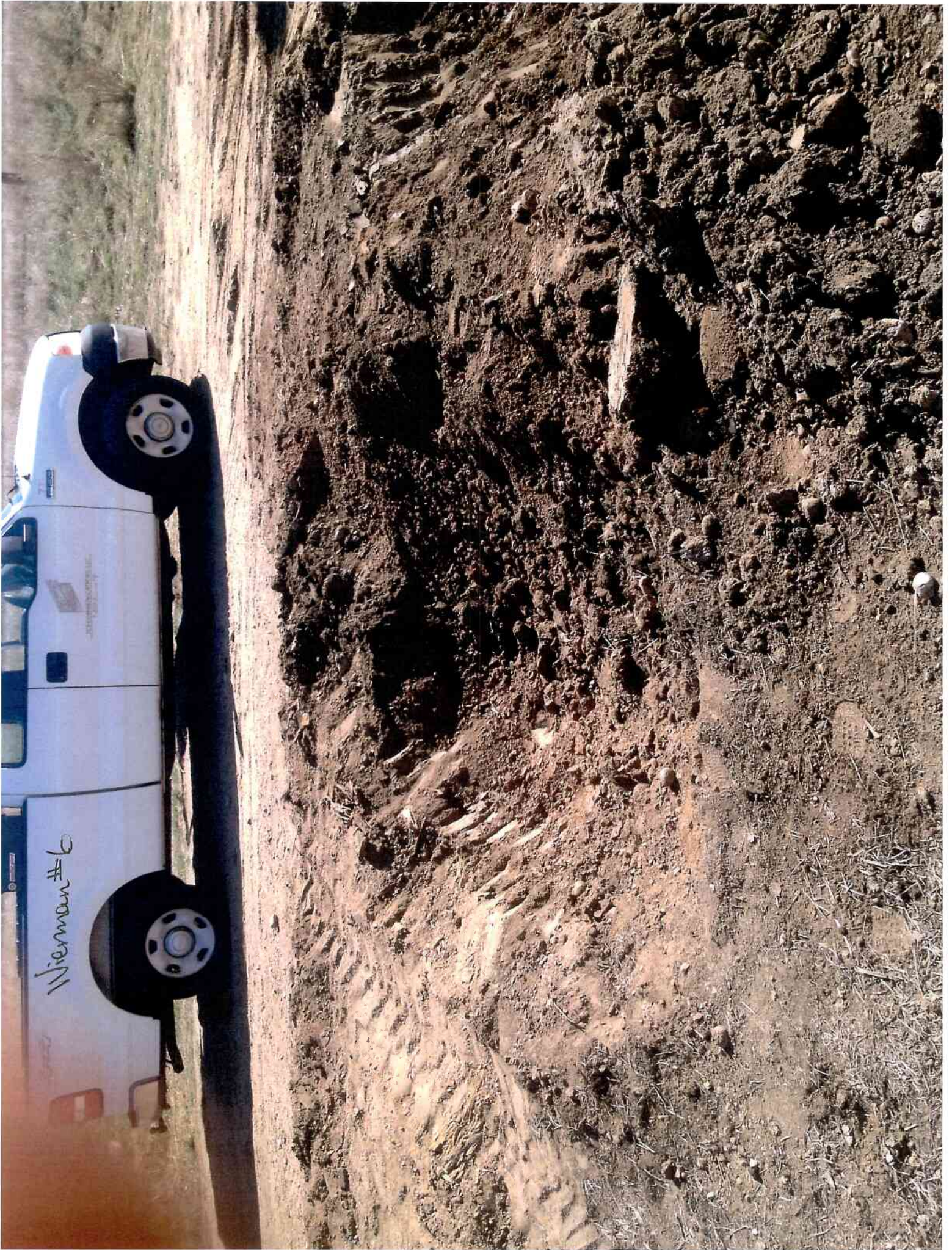

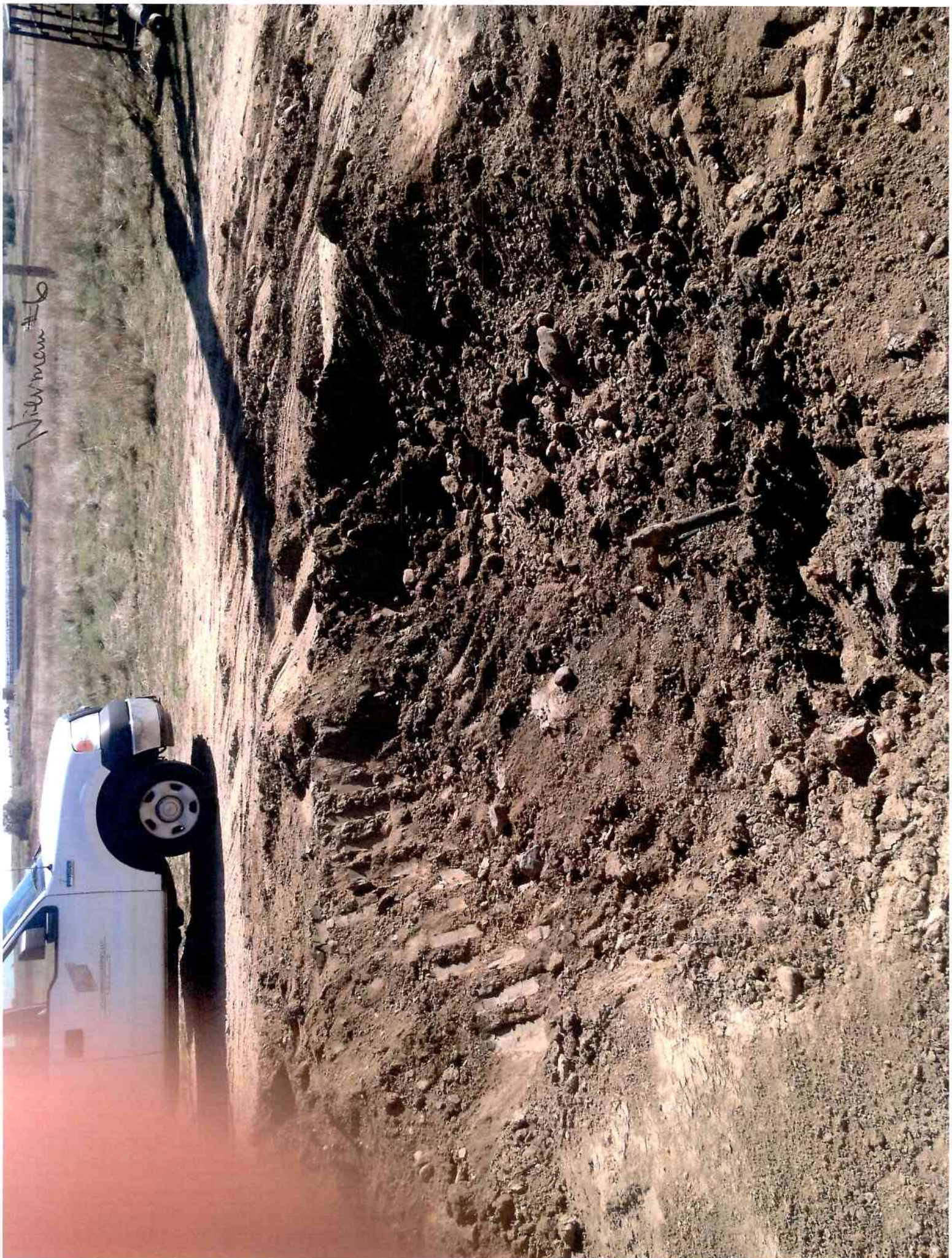



Wierman #6

Wierman #6



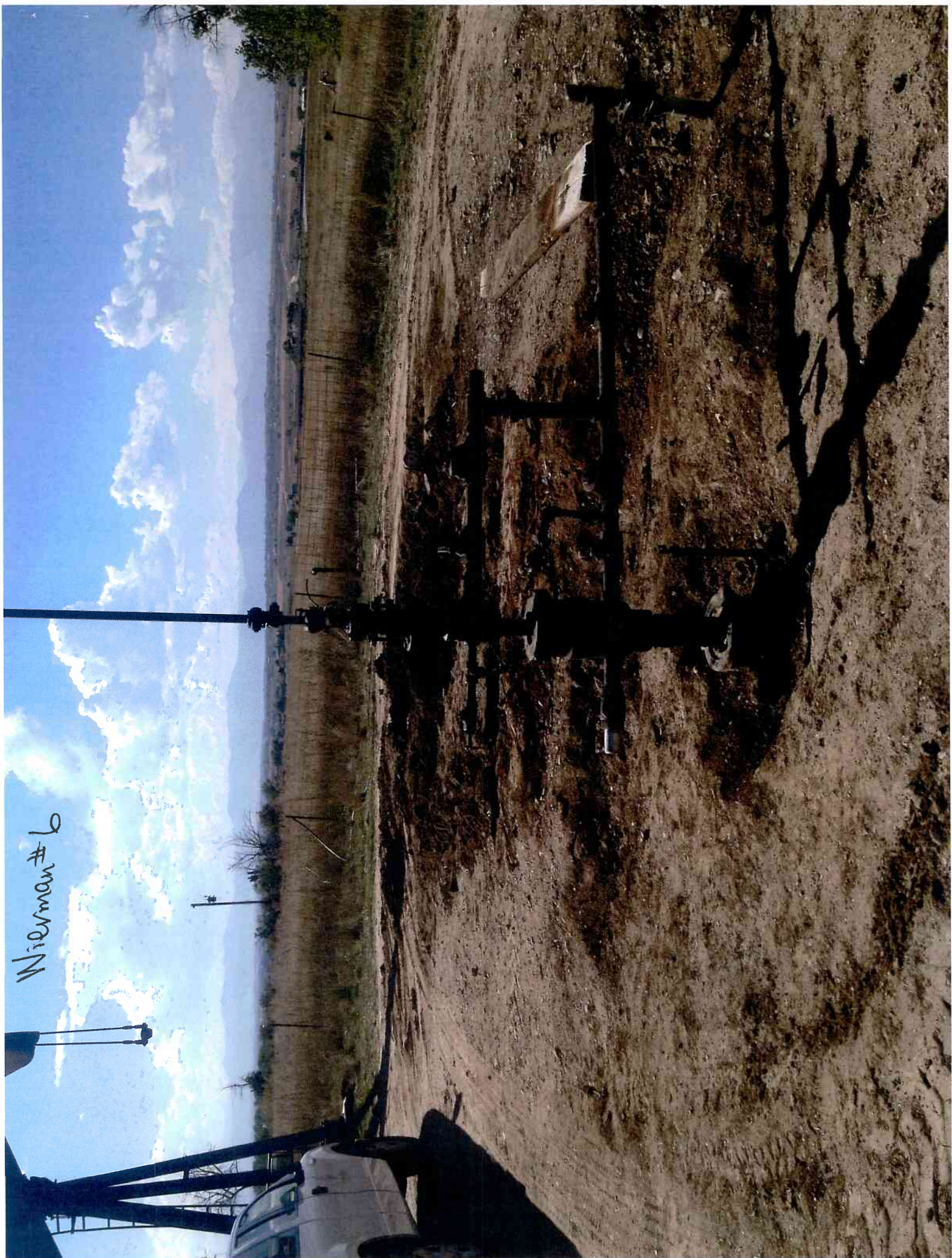

Wierman #6