



7535 Hilltop Circle  
Denver, CO 80221  
[www.petro-fs.com](http://www.petro-fs.com)

October 17, 2014

Mr. Matt Lepore, Director  
Colorado Oil and Gas Conservation Commission  
1120 Lincoln Street, Suite 801  
Denver, Colorado 80203

**RE: COGCC Rule 318A.e.: Proposed Wellbore Spacing Unit  
Matrix J-29HN Well: SESW, Section 29, Township 6 North, Range 65 West  
Weld County, Colorado**

Dear Mr. Lepore:

Bayswater Exploration & Production, LLC (Bayswater) is planning to drill the above referenced well in accordance with the provisions set out in COGCC Rule 318A.e. Bayswater's proposed wellbore spacing unit consists of:

W½E½ and E½W½ of Section 29, Township 6 North, Range 65 West  
Containing 320 acres more or less

Bayswater is not the only owner within the proposed wellbore spacing unit and has provided notice to the remaining owners within this spacing unit, as required by COGCC Rule 318A.e.(6). Copies of the required notification letters are on file at Bayswater's office. The required thirty (30) day notice period has elapsed absent the receipt by Bayswater of any objection to their proposal by the owners within the proposed spacing unit for the subject well.

Enclosed is the Proposed Spacing Unit Plat to assist in your review and approval of Bayswater's proposed Application for Permit to Drill (APD) for the Matrix J-29HN well. Many thanks for your attention to this matter.

Respectfully,

Jeff Annable  
Regulatory Technician  
Agent for Bayswater Exploration & Production, LLC

:ja

Enclosure: Proposed Spacing Unit Plat

*We are what we repeatedly do. Excellence, then, is not an act, but a habit.*

*-Aristotle*

# PROPOSED 318A.e. SPACING UNIT

## SECTION 29, TOWNSHIP 6 NORTH, RANGE 65 WEST, 6TH P.M.

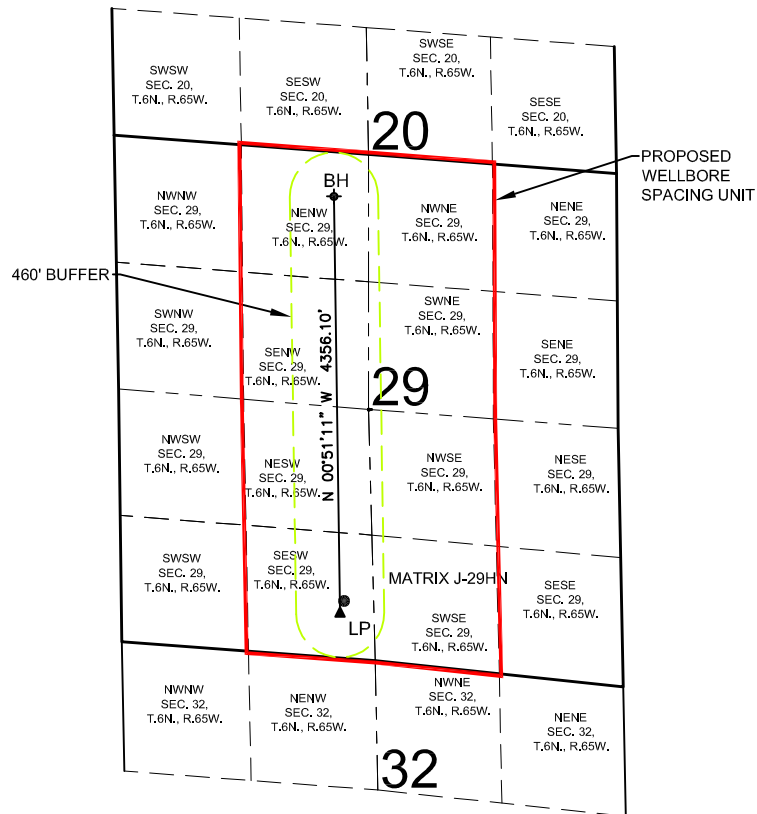

WELL **MATRIX J-29HN** TO BE LOCATED 502' FSL AND 2186' FWL, SEC. 29, T6N, R65W

### SURFACE LOCATION

NAD83

LATITUDE= 40.452836°

LONGITUDE= 104.688864°

### LANDING POINT LOCATION

NAD83

LATITUDE= 40.452672°

LONGITUDE= 104.687913°

### BOTTOM HOLE LOCATION

NAD83

LATITUDE= 40.464629°

LONGITUDE= 104.688003°

### LEGEND

- = PROPOSED WELL
- ▲ = LANDING POINT
- ✦ = BOTTOM HOLE
- LP = LANDING POINT
- BH = BOTTOM HOLE

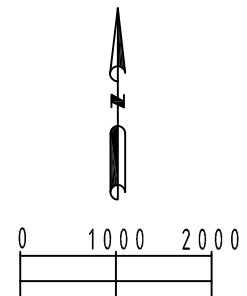

PREPARED BY: <b>PFS</b> Petroleum Field Services, LLC 7535 Hilltop Circle Denver, CO 80221	FIELD DATE:	SURFACE LOCATION:
	07-10-14	
	DRAWING DATE:	SE 1/4 SW 1/4, SEC. 29, T6N, R65W, 6TH P.M.
	10-03-14	
BY:	CHECKED:	WELD COUNTY, COLORADO
KAD	TJR	