

# **LEGEND:**

 **PROPOSED LOCATION**

**ConocoPhillips Company**

**BEAVER #5-65 34-35 2H**  
**SECTION 35, T5S, R65W, 6th P.M.**  
**1373' FNL 2278' FEL**



**UELS, LLC**  
Corporate Office \* 85 South 200 East  
Vernal, UT 84078 \* (435) 789-1017

DRAWN BY: T.W.	DATE DRAWN: 07-09-14
SCALE: 1:100,000	REVISED: 00-00-00
<b>ACCESS ROAD MAP</b>	<b>TOPO A</b>



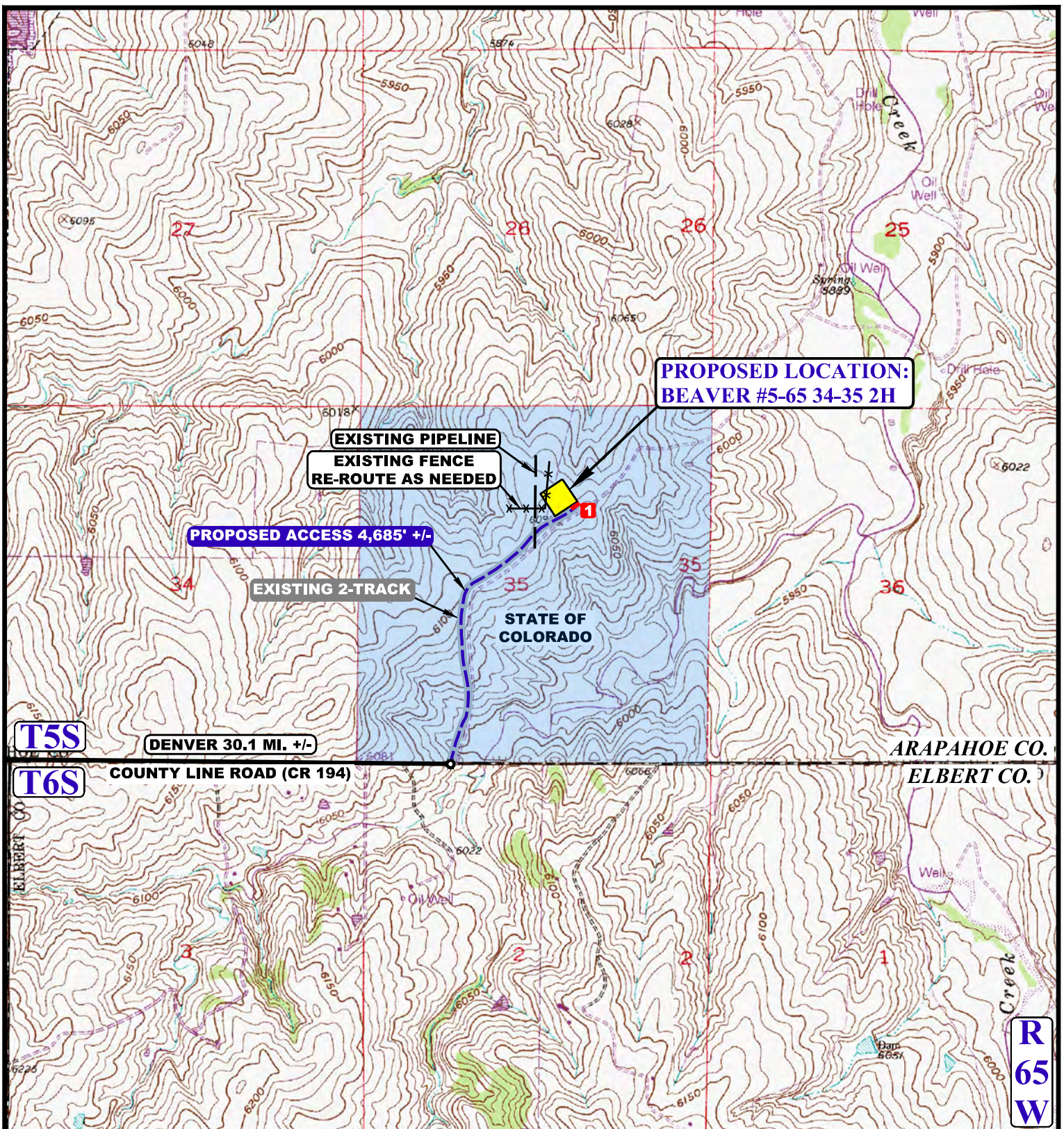

NOTE: PARCEL DATA SHOWN HAS BEEN OBTAINED FROM VARIOUS SOURCES AND SHOULD BE USED FOR MAPPING, GRAPHIC AND PLANNING PURPOSES ONLY. NO WARRANTY IS MADE BY UINTAH ENGINEERING AND LAND SURVEYING (UELS) FOR ACCURACY OF THE PARCEL DATA.

#### LEGEND:

- EXISTING ROAD
- PROPOSED ROAD
- x x EXISTING FENCE
- EXISTING PIPELINE
- EXISTING 2-TRACK
- 1 18" CULVERT REQUIRED



#### ConocoPhillips Company

BEAVER #5-65 34-35 2H  
SECTION 35, T5S, R65W, 6th P.M.  
1373' FNL 2278' FEL

DRAWN BY: T.W.

DATE DRAWN: 07-09-14

SCALE: 1" = 2000'

REVISED: 00-00-00

ACCESS ROAD MAP

TOPO B



UELS, LLC  
Corporate Office \* 85 South 200 East  
Vernal, UT 84078 \* (435) 789-1017