

Project: Weld County, CO (NAD 83)
 Site: Sec. 20-T4N-R64W (Klingenberg C20-780)
 Well: Klingenberg C20-780
 Wellbore: ST 2
 Design: Rev B0

Noble Energy

HALLIBURTON
 Sperry Drilling

Name	TVD	+N/-S	+E/-W	Northing	Easting	Latitude	Longitude
Klingenberg C20-780_BHL	7230.00	4477.37	-38.45	1354796.43	3255960.98	40.303681	-104.582252
MD	Inc	Azi	TVD	+N/-S	+E/-W	Dleg	Vsect
8596.00	89.57	1.44	7264.10	1623.27	-9.94	0.00	1623.29
8650.00	87.00	2.85	7265.71	1677.20	-7.92	5.43	1677.20
8691.00	87.00	2.85	7267.86	1718.09	-5.89	0.00	1718.08
8785.00	87.00	2.85	7272.78	1811.85	-1.22	0.00	1811.79
8880.00	89.10	2.85	7276.01	1906.67	3.50	2.21	1906.57
9060.00	90.10	2.85	7277.27	2086.44	12.45	0.56	2086.26
9400.00	90.10	358.45	7276.67	2426.33	16.31	1.29	2426.11
11450.00	90.10	358.50	7273.10	4475.60	-38.25	0.00	4475.77

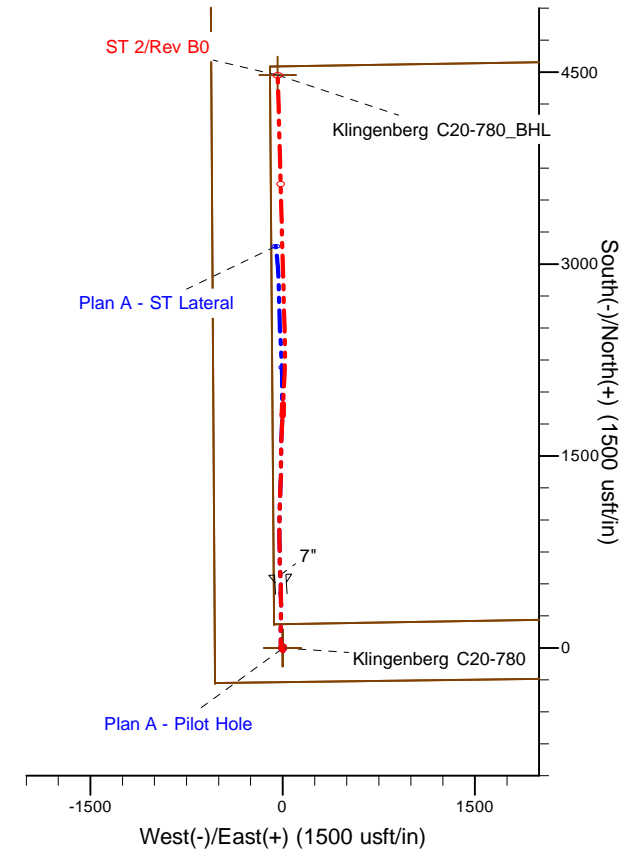
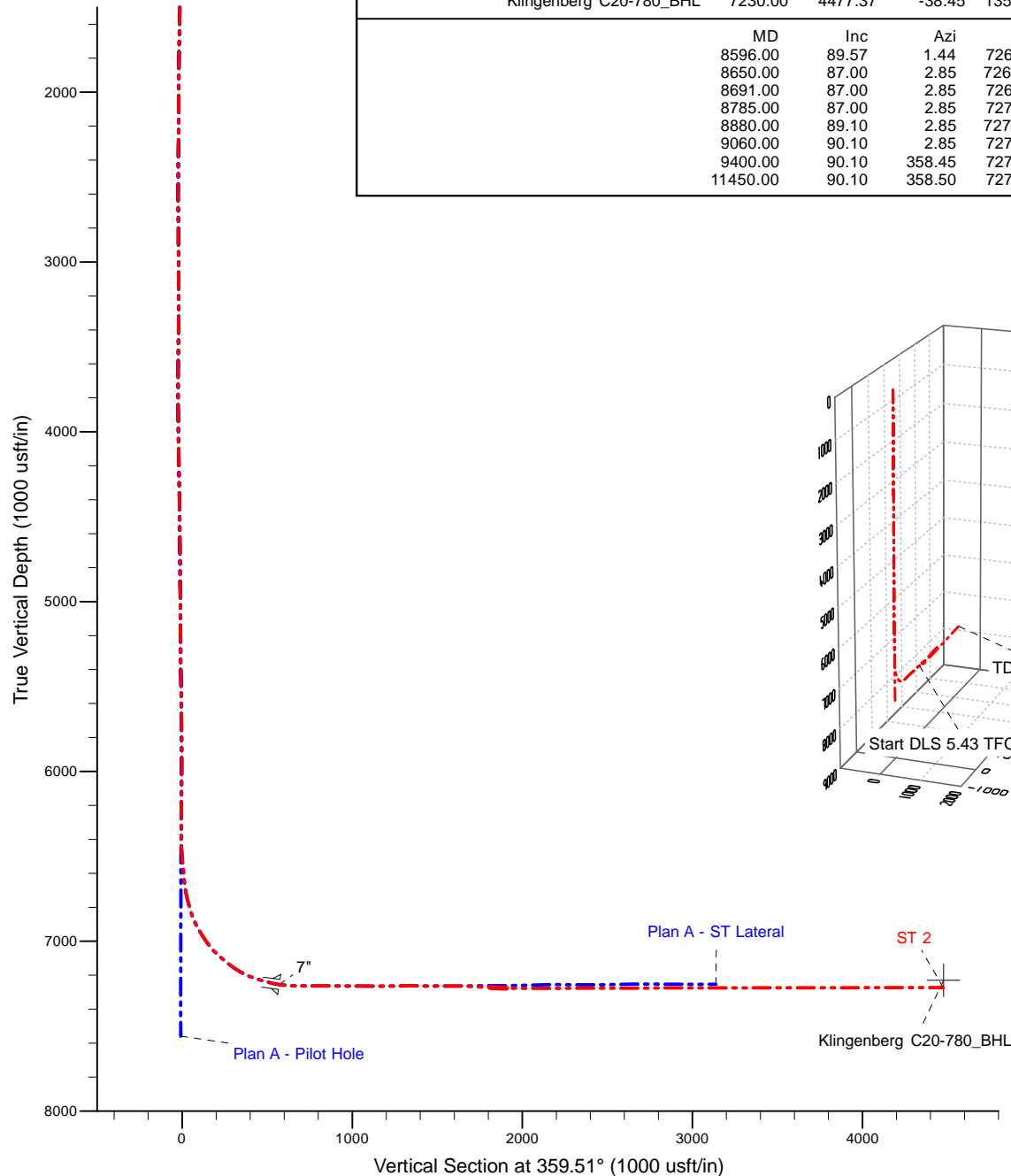

WELL DETAILS: Klingenberg C20-780	
Ground Level: 4782.00 KB = 24' @ 4806.00usft (H&P 322)	
Plan: Rev B0 (Klingenberg C20-780/ST 2)	
Created By: Gordy Roth	Date: 10/9/2014