



Lat40°, Inc. 1635 Foxtrail Drive, Suite 325 Loveland, CO 970-776-3321

NOTIFICATION ZONE DRAWING

TIGERTAIL FEDERAL 2-3

SECTION: 2
TOWNSHIP: 7N
RANGE: 64W

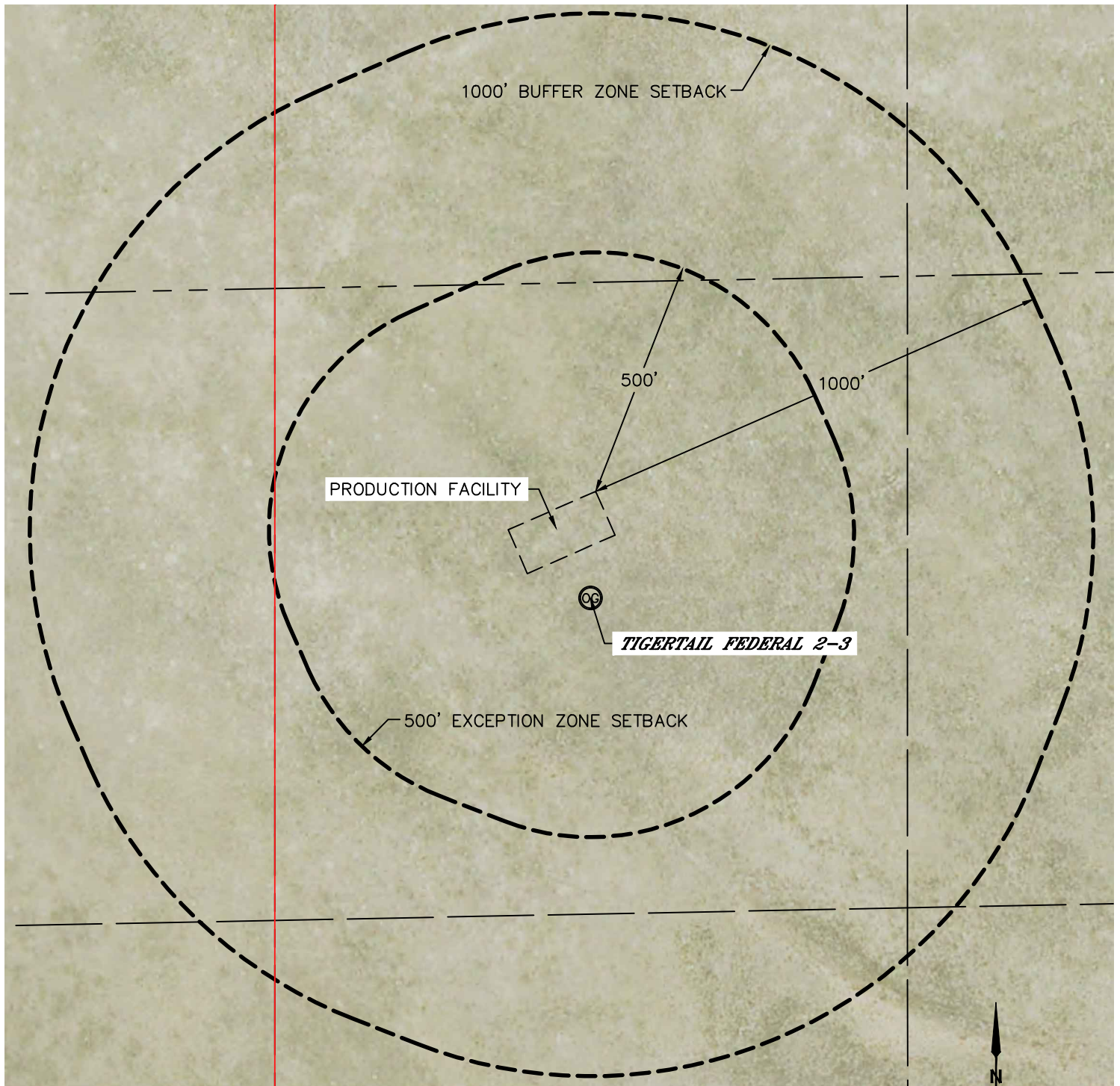

LEGEND

— PROPERTY LINE



BUILDING



BUILDING UNIT

EXCEPTION ZONE:

NO EXISTING BUILDING UNITS WITHIN EXCEPTION ZONE

BUFFER ZONE:

NO EXISTING BUILDING UNITS WITHIN BUFFER ZONE

MEASURED FROM THE	BUILDING	BUILDING UNIT	HIGH OCCUPANCY BUILDING UNIT	DESIGNATED OUTSIDE ACTIVITY AREA	PUBLIC ROAD	ABOVEGROUND UTILITY	RAILROAD	PROPERTY LINE
PROPOSED TIGERTAIL FEDERAL 2-3	5280'+	5280'+	5280'+	5280'+	±1.6 MILES N (CR 88) ±1964' E ACCESS RD	±1945' S	5280'+	±660' W
NEAREST EDGE OF PRODUCTION FACILITY	5280'+	5280'+	5280'+	5280'+	±1.6 MILES N (CR 88) ±1913' E ACCESS RD	±1999' S	5280'+	±448' W

DATE: 10/7/2014
PROJECT#: 2014081