



Lat40°, Inc. 1635 Foxtrail Drive, Suite 325 Loveland, CO 970-776-3321

CUT & FILL DIAGRAM

TIGERTAIL FEDERAL 2-3

SECTION: 2
TOWNSHIP: 7N
RANGE: 64W

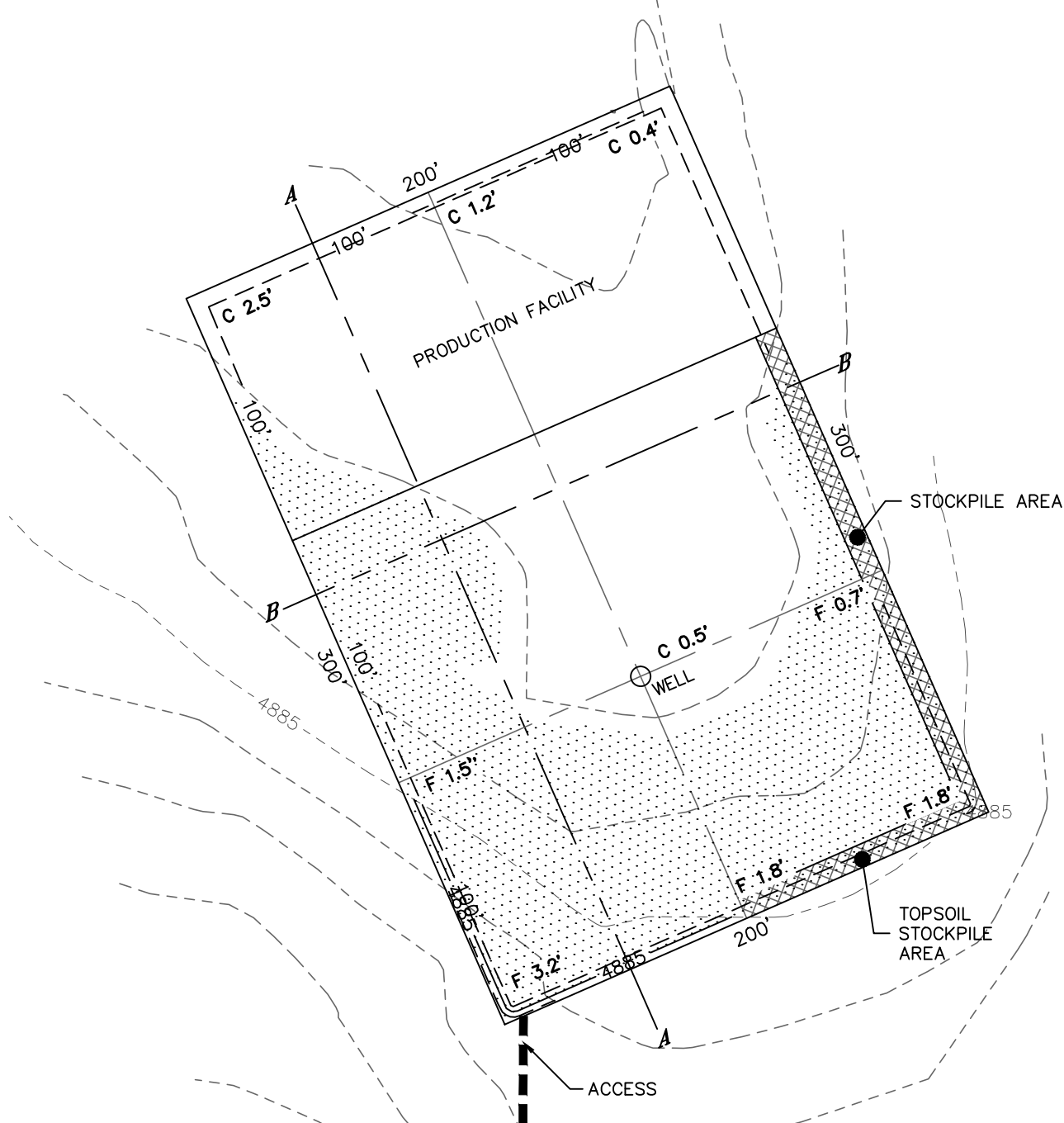

OPERATOR: GRYNBERG PETROLEUM COMPANY

LOCATION: 1982' FSL, 1985' FEL

EXISTING ELEV= 4887.4'

PROPOSED ELEV= 4886.9'

DISTURBANCE= 1.3 ACRES

ESTIMATED EARTHWORK:

TOPSOIL= 2,070 CY

CUT= 802 CY

FILL= 792 CY

STOCKPILE:

EXCESS= 10 CY

NOTE:

- 1) Ground elevations are based on an observed GPS elevation (NAVD 1988 DATUM).
- 2) No allowance has been made for soil expansion or compaction.
- 3) Proposed elevation does not account for top soil removal.
- 4) Top soil volume assumes 12" depth across entire location.
- 5) Fill slopes 2:1
- 6) Cut slopes 1.5:1

LEGEND

EX. CONTOUR	---
PRO. CONTOUR	- - -
FILL AREA	

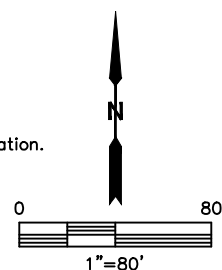

DATE: 6/5/2014
PROJECT#: 2014081



CROSS SECTION DIAGRAM
TIGERTAIL FEDERAL 2-3

SECTION: 2
TOWNSHIP: 7N
RANGE: 64W

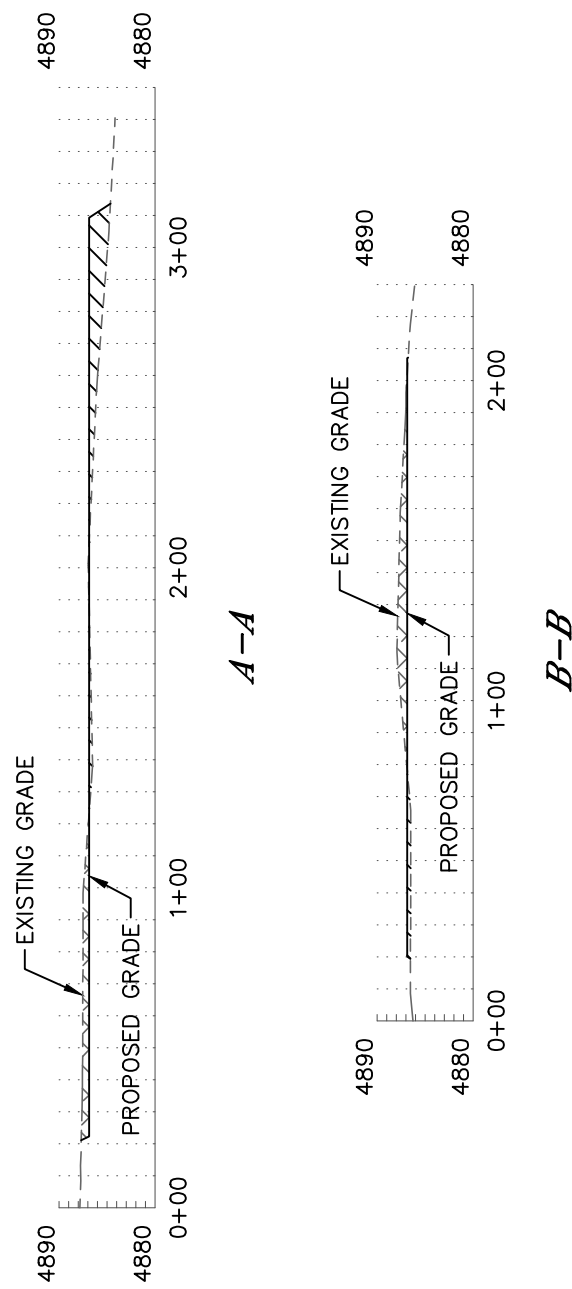

HORIZONTAL SCALE: 1"=60', VERTICAL SCALE: 1"=20'