

# DOCHEFF 12N-13HZ MULTI-WELL PLAN

SECTION 14, TOWNSHIP 3 NORTH, RANGE 68 WEST, 6TH P.M.

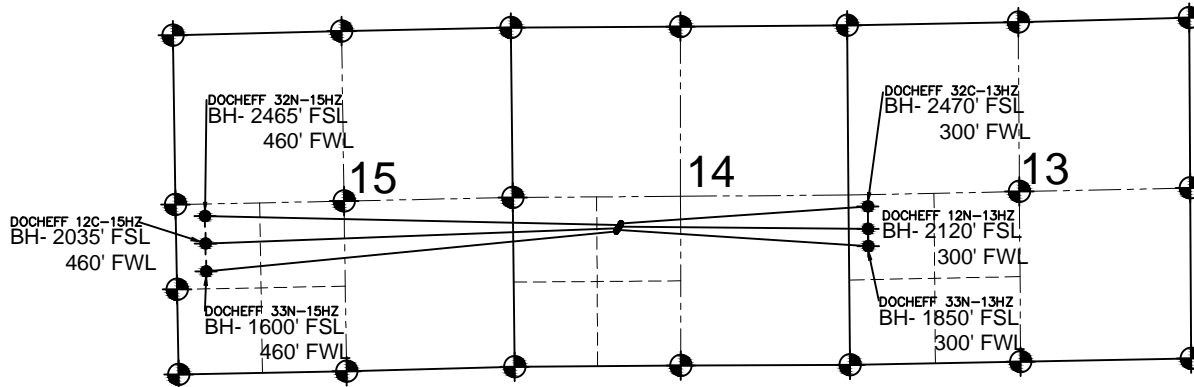

## NOTES:

DOCHEFF 32C-13HZ TO BE AT 2228' FSL, 1694' FWL.  
 BOTTOM HOLE AT 2470' FSL & 300' FWL, SEC. 13, T3N, R68W.  
 DOCHEFF 32N-15HZ TO BE AT 2203' FSL, 1678' FWL.  
 BOTTOM HOLE AT 2465' FSL & 460' FWL, SEC. 15, T3N, R68W.  
 DOCHEFF 12N-13HZ TO BE AT 2177' FSL, 1662' FWL.  
 BOTTOM HOLE AT 2120' FSL & 300' FWL, SEC. 13, T3N, R68W.  
 DOCHEFF 12C-15HZ TO BE AT 2152' FSL, 1646' FWL.  
 BOTTOM HOLE AT 2035' FSL & 460' FWL, SEC. 15, T3N, R68W.  
 DOCHEFF 33N-13HZ TO BE AT 2127' FSL, 1629' FWL.  
 BOTTOM HOLE AT 1850' FSL & 300' FWL, SEC. 13, T3N, R68W.  
 DOCHEFF 33N-15HZ TO BE AT 2101' FSL, 1613' FWL.  
 BOTTOM HOLE AT 1600' FSL & 460' FWL, SEC. 15, T3N, R68W.

## LEGEND

= EXISTING MONUMENT    
 = BOTTOM HOLE    
 BH= BOTTOM HOLE  
 = PROPOSED WELL    
 = EXISTING WELL

PREPARED BY:



KERR-MCGEE OIL & GAS ONSHORE LP

FIELD DATE:

05-09-14

DRAWING DATE:

05-28-14

SURFACE LOCATION:

NE 1/4 SW 1/4, SEC. 14, T3N, R68W, 6TH P.M.  
 WELD COUNTY, COLORADO

