

KERR-MCGEE OIL & GAS ONSHORE LP

Location: COLORADO Slot: SLOT#31 BAREFOOT 31C-25HZ (599'FNL & 514'FEL, SEC.25)
 Field: WELD COUNTY (KERR MCGEE) Well: BAREFOOT 31C-25HZ
 Facility: SEC.25-T3N-R68W Wellbore: BAREFOOT 31C-25HZ PWB

Plot reference wellpath is BAREFOOT 31C-25HZ PWP (REV-A.1)

True vertical depths are referenced to XTREME 8 (17KB) (RKB)	Grid System: NAD83 / Lambert Colorado SP, Northern Zone (501), US feet
Measured depths are referenced to XTREME 8 (17KB) (RKB)	North Reference: True north
XTREME 8 (17KB) (RKB) to Mean Sea Level: 4908 feet	Scale: True distance
Mean Sea Level to Mud line (At Slot: SLOT#31 BAREFOOT 31C-25HZ (599'FNL & 514'FEL, SEC.25)): 0 feet	Depths are in feet
Coordinates are in feet referenced to Slot	Created by: amarcar on 9/29/2014

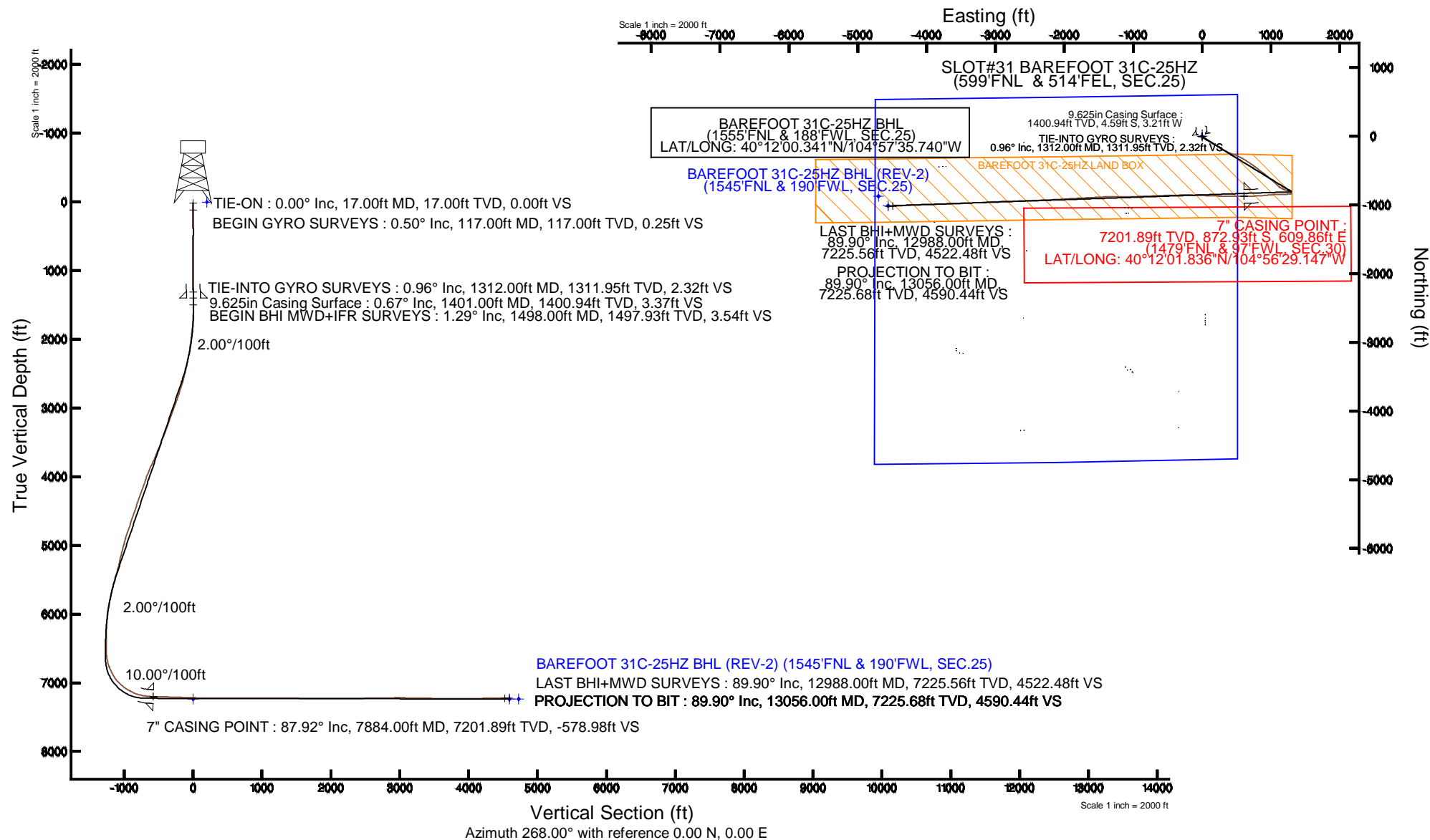

Actual Wellpath Report

BAREFOOT 31C-25HZ AWP

Page 1 of 7

REFERENCE WELLPATH IDENTIFICATION

Operator	KERR-MCGEE OIL & GAS ONSHORE LP	Slot	SLOT#31 BAREFOOT 31C-25HZ (599'FNL & 514'FEL, SEC.25)
Area	COLORADO	Well	BAREFOOT 31C-25HZ
Field	WELD COUNTY (KERR MCGEE)	Wellbore	BAREFOOT 31C-25HZ AWB
Facility	SEC.25-T3N-R68W		

REPORT SETUP INFORMATION

Projection System	NAD83 / Lambert Colorado SP, Northern Zone (501), US feet	Software System	WellArchitect® 4.0.0
North Reference	True	User	Amarcar
Scale	0.999957	Report Generated	9/28/2014 at 12:38:51 PM
Convergence at slot	n/a	Database/Source file	WellArchitectDB/_BAREFOOT_31C-25HZ_AWB.xml

WELLPATH LOCATION

	Local coordinates		Grid coordinates		Geographic coordinates	
	North[ft]	East[ft]	Easting[US ft]	Northing[US ft]	Latitude	Longitude
Slot Location	1029.58	1015.92	3155409.01	1317248.66	40°12'10.462"N	104°56'37.007"W
Facility Reference Pt			3154399.57	1316212.82	40°12'00.288"N	104°56'50.100"W
Field Reference Pt			3197771.84	1268891.29	40°04'09.600"N	104°47'36.000"W

WELLPATH DATUM

Calculation method	Minimum curvature	XTREME 8 (17'KB) (RKB) to Facility Vertical Datum	4908.00ft
Horizontal Reference Pt	Slot	XTREME 8 (17'KB) (RKB) to Mean Sea Level	4908.00ft
Vertical Reference Pt	XTREME 8 (17'KB) (RKB)	XTREME 8 (17'KB) (RKB) to Mud Line at Slot (SLOT#31 BAREFOOT 31C-25HZ (599'FNL & 514'FEL, SEC.25))	4908.00ft
MD Reference Pt	XTREME 8 (17'KB) (RKB)	Section Origin	N 0.00, E 0.00 ft
Field Vertical Reference	Mean Sea Level	Section Azimuth	268.00°

Actual Wellpath Report

BAREFOOT 31C-25HZ AWP

Page 2 of 7

REFERENCE WELLPATH IDENTIFICATION

Operator	KERR-MCGEE OIL & GAS ONSHORE LP	Slot	SLOT#31 BAREFOOT 31C-25HZ (599'FNL & 514'FEL, SEC.25)
Area	COLORADO	Well	BAREFOOT 31C-25HZ
Field	WELD COUNTY (KERR MCGEE)	Wellbore	BAREFOOT 31C-25HZ AWB
Facility	SEC.25-T3N-R68W		

WELLPATH DATA (147 stations) † = interpolated/extrapolated station

MD [ft]	Inclination [°]	Azimuth [°]	TVD [ft]	Vert Sect [ft]	North [ft]	East [ft]	Latitude	Longitude	DLS [°/100ft]	Comments
0.00†	0.000	213.240	0.00	0.00	0.00	0.00	40°12'10.462"N	104°56'37.007"W	0.00	
17.00	0.000	213.240	17.00	0.00	0.00	0.00	40°12'10.462"N	104°56'37.007"W	0.00	TIE-ON
117.00	0.500	213.240	117.00	0.25	-0.36	-0.24	40°12'10.458"N	104°56'37.010"W	0.50	BEGIN GYRO SURVEYS
217.00	0.670	216.060	216.99	0.86	-1.20	-0.82	40°12'10.450"N	104°56'37.018"W	0.17	
317.00	0.580	216.180	316.99	1.54	-2.08	-1.47	40°12'10.441"N	104°56'37.026"W	0.09	
417.00	0.570	185.630	416.98	1.92	-2.99	-1.81	40°12'10.432"N	104°56'37.030"W	0.30	
517.00	0.570	156.180	516.98	1.80	-3.94	-1.66	40°12'10.423"N	104°56'37.028"W	0.29	
617.00	0.500	156.160	616.97	1.45	-4.79	-1.28	40°12'10.415"N	104°56'37.024"W	0.07	
717.00	0.470	128.920	716.97	0.98	-5.45	-0.79	40°12'10.408"N	104°56'37.017"W	0.23	
817.00	0.350	117.110	816.97	0.40	-5.85	-0.20	40°12'10.404"N	104°56'37.010"W	0.15	
917.00	0.180	56.850	916.97	0.00	-5.90	0.21	40°12'10.404"N	104°56'37.004"W	0.30	
1017.00	0.290	352.430	1016.97	-0.11	-5.56	0.30	40°12'10.407"N	104°56'37.003"W	0.27	
1117.00	0.460	305.200	1116.96	0.23	-5.08	-0.06	40°12'10.412"N	104°56'37.008"W	0.34	
1217.00	0.660	297.600	1216.96	1.06	-4.58	-0.90	40°12'10.417"N	104°56'37.019"W	0.21	
1312.00	0.960	276.200	1311.95	2.32	-4.24	-2.17	40°12'10.420"N	104°56'37.035"W	0.44	TIE-INTO GYRO SURVEYS
1498.00	1.290	169.180	1497.93	3.54	-6.13	-3.33	40°12'10.401"N	104°56'37.050"W	0.98	BEGIN BHI MWD+IFR SURVEYS
1589.00	2.950	157.560	1588.86	2.57	-9.30	-2.24	40°12'10.370"N	104°56'37.036"W	1.88	
1691.00	4.160	140.210	1690.67	-0.62	-14.57	1.13	40°12'10.318"N	104°56'36.992"W	1.57	
1782.00	5.420	126.380	1781.35	-6.01	-19.66	6.70	40°12'10.268"N	104°56'36.921"W	1.87	
1874.00	6.370	118.870	1872.87	-13.80	-24.70	14.67	40°12'10.218"N	104°56'36.818"W	1.33	
1965.00	7.990	116.980	1963.15	-23.66	-30.00	24.73	40°12'10.166"N	104°56'36.688"W	1.80	
2057.00	9.380	115.220	2054.09	-35.92	-36.10	37.21	40°12'10.105"N	104°56'36.527"W	1.54	
2149.00	10.020	113.920	2144.78	-49.79	-42.54	51.31	40°12'10.042"N	104°56'36.346"W	0.74	
2241.00	11.420	113.440	2235.17	-65.21	-49.41	66.98	40°12'09.974"N	104°56'36.144"W	1.52	
2332.00	12.860	118.890	2324.13	-82.04	-57.88	84.11	40°12'09.890"N	104°56'35.923"W	2.02	
2424.00	14.240	120.550	2413.57	-100.36	-68.58	102.82	40°12'09.784"N	104°56'35.682"W	1.56	
2516.00	16.090	122.470	2502.36	-120.41	-81.18	123.33	40°12'09.660"N	104°56'35.418"W	2.08	
2608.00	18.600	121.920	2590.17	-143.10	-95.78	146.54	40°12'09.515"N	104°56'35.118"W	2.73	
2700.00	20.800	123.390	2676.78	-168.60	-112.53	172.63	40°12'09.350"N	104°56'34.782"W	2.45	
2791.00	22.050	121.050	2761.50	-196.09	-130.24	200.76	40°12'09.175"N	104°56'34.420"W	1.66	
2883.00	23.310	121.760	2846.38	-225.69	-148.73	231.03	40°12'08.992"N	104°56'34.029"W	1.40	
2975.00	23.840	122.310	2930.70	-256.18	-168.25	262.22	40°12'08.799"N	104°56'33.628"W	0.62	

3067.00	22.650	119.420	3015.23	-286.66	-186.89	293.37	40°12'08.615"N	104°56'33.226"W	1.79	
3158.00	21.620	121.740	3099.53	-315.55	-204.31	322.89	40°12'08.443"N	104°56'32.846"W	1.48	
3250.00	22.140	120.220	3184.90	-344.31	-221.95	352.29	40°12'08.269"N	104°56'32.467"W	0.84	
3342.00	22.050	113.750	3270.16	-374.54	-237.64	383.08	40°12'08.114"N	104°56'32.070"W	2.65	
3427.00	23.390	112.010	3348.56	-404.32	-250.39	413.32	40°12'07.988"N	104°56'31.680"W	1.76	
3512.00	23.880	105.700	3426.44	-436.13	-261.37	445.54	40°12'07.879"N	104°56'31.265"W	3.03	
3597.00	23.710	109.860	3504.22	-468.38	-271.83	478.17	40°12'07.776"N	104°56'30.844"W	1.98	
3685.00	23.030	117.040	3585.02	-499.86	-285.67	510.15	40°12'07.639"N	104°56'30.432"W	3.33	
3770.00	24.160	116.700	3662.91	-529.65	-301.04	540.50	40°12'07.487"N	104°56'30.041"W	1.34	
3855.00	27.230	119.420	3739.50	-561.51	-318.42	572.99	40°12'07.315"N	104°56'29.622"W	3.87	
3941.00	28.970	118.830	3815.36	-596.19	-338.13	608.38	40°12'07.121"N	104°56'29.166"W	2.05	
4028.00	28.730	124.500	3891.58	-631.09	-360.13	644.07	40°12'06.903"N	104°56'28.706"W	3.16	
4115.00	25.620	124.610	3968.97	-663.01	-382.67	676.80	40°12'06.680"N	104°56'28.285"W	3.58	

Actual Wellpath Report

BAREFOOT 31C-25HZ AWP

Page 3 of 7

REFERENCE WELLPATH IDENTIFICATION

Operator	KERR-MCGEE OIL & GAS ONSHORE LP	Slot	SLOT#31 BAREFOOT 31C-25HZ (599'FNL & 514'FEL, SEC.25)
Area	COLORADO	Well	BAREFOOT 31C-25HZ
Field	WELD COUNTY (KERR MCGEE)	Wellbore	BAREFOOT 31C-25HZ AWP
Facility	SEC.25-T3N-R68W		

WELLPATH DATA (147 stations)

MD [ft]	Inclination [°]	Azimuth [°]	TVD [ft]	Vert Sect [ft]	North [ft]	East [ft]	Latitude	Longitude	DLS [°/100ft]	Comments
4200.00	22.850	124.150	4046.47	-691.09	-402.37	705.58	40°12'06.486"N	104°56'27.914"W	3.27	
4288.00	24.830	125.550	4126.96	-719.54	-422.71	734.76	40°12'06.285"N	104°56'27.538"W	2.34	
4373.00	24.690	126.640	4204.14	-747.55	-443.68	763.53	40°12'06.077"N	104°56'27.167"W	0.56	
4460.00	23.920	127.230	4283.43	-775.41	-465.19	792.15	40°12'05.865"N	104°56'26.798"W	0.93	
4546.00	22.870	127.570	4362.36	-801.79	-485.93	819.28	40°12'05.660"N	104°56'26.448"W	1.23	
4631.00	23.320	125.390	4440.55	-827.89	-505.75	846.09	40°12'05.464"N	104°56'26.103"W	1.14	
4716.00	24.000	127.620	4518.40	-854.57	-526.04	873.49	40°12'05.263"N	104°56'25.750"W	1.32	
4801.00	23.160	128.750	4596.31	-880.55	-547.06	900.22	40°12'05.056"N	104°56'25.405"W	1.12	
4886.00	24.930	129.180	4673.93	-906.70	-568.84	927.15	40°12'04.841"N	104°56'25.058"W	2.09	
4972.00	24.910	129.690	4751.92	-933.86	-591.86	955.13	40°12'04.613"N	104°56'24.698"W	0.25	
5057.00	23.260	129.720	4829.52	-959.76	-614.02	981.82	40°12'04.394"N	104°56'24.354"W	1.94	
5144.00	20.840	129.370	4910.15	-984.20	-634.81	1007.00	40°12'04.189"N	104°56'24.029"W	2.79	
5229.00	19.350	129.640	4989.97	-1006.07	-653.39	1029.53	40°12'04.005"N	104°56'23.739"W	1.76	
5315.00	21.410	133.370	5070.59	-1027.75	-673.26	1051.92	40°12'03.809"N	104°56'23.450"W	2.83	
5400.00	20.380	135.090	5150.00	-1048.72	-694.40	1073.65	40°12'03.600"N	104°56'23.170"W	1.41	
5485.00	17.560	135.850	5230.37	-1067.41	-714.08	1093.03	40°12'03.405"N	104°56'22.921"W	3.33	
5571.00	18.510	130.920	5312.15	-1086.11	-732.34	1112.38	40°12'03.225"N	104°56'22.671"W	2.09	
5656.00	18.170	118.760	5392.86	-1107.38	-747.56	1134.21	40°12'03.074"N	104°56'22.390"W	4.51	
5741.00	19.140	116.630	5473.40	-1131.00	-760.18	1158.28	40°12'02.950"N	104°56'22.080"W	1.39	
5826.00	17.160	115.050	5554.17	-1154.41	-771.74	1182.10	40°12'02.835"N	104°56'21.773"W	2.40	
5911.00	14.280	113.820	5635.98	-1175.01	-781.28	1203.06	40°12'02.741"N	104°56'21.503"W	3.41	
5996.00	12.920	108.040	5718.60	-1193.38	-788.46	1221.68	40°12'02.670"N	104°56'21.263"W	2.26	
6082.00	12.760	107.910	5802.45	-1211.34	-794.36	1239.86	40°12'02.612"N	104°56'21.028"W	0.19	
6167.00	11.100	116.900	5885.61	-1227.33	-800.95	1256.09	40°12'02.547"N	104°56'20.819"W	2.93	
6252.00	9.540	127.160	5969.24	-1239.96	-808.90	1269.01	40°12'02.468"N	104°56'20.653"W	2.83	
6337.00	7.030	133.430	6053.35	-1249.07	-816.73	1278.40	40°12'02.391"N	104°56'20.532"W	3.13	
6423.00	5.730	137.250	6138.82	-1255.57	-823.51	1285.13	40°12'02.324"N	104°56'20.445"W	1.59	
6508.00	3.920	143.670	6223.51	-1259.97	-828.96	1289.74	40°12'02.270"N	104°56'20.386"W	2.22	
6593.00	2.510	163.250	6308.38	-1262.09	-833.09	1291.99	40°12'02.229"N	104°56'20.357"W	2.08	
6678.00	2.070	206.950	6393.32	-1261.82	-836.24	1291.83	40°12'02.198"N	104°56'20.359"W	2.06	
6764.00	1.130	257.360	6479.29	-1260.23	-837.81	1290.30	40°12'02.182"N	104°56'20.378"W	1.87	
6849.00	1.250	238.630	6564.27	-1258.60	-838.47	1288.69	40°12'02.176"N	104°56'20.399"W	0.48	

6892.00	4.250	263.840	6607.22	-1256.60	-838.89	1286.71	40°12'02.172"N	104°56'20.425"W	7.36	
6934.00	9.100	268.360	6648.92	-1251.73	-839.15	1281.84	40°12'02.169"N	104°56'20.487"W	11.61	
6977.00	15.040	264.550	6690.95	-1242.75	-839.78	1272.88	40°12'02.163"N	104°56'20.603"W	13.93	
7019.00	18.600	262.980	6731.15	-1230.63	-841.12	1260.80	40°12'02.150"N	104°56'20.759"W	8.54	
7062.00	21.090	263.190	6771.59	-1216.09	-842.87	1246.31	40°12'02.132"N	104°56'20.945"W	5.79	
7105.00	23.320	264.370	6811.40	-1199.88	-844.62	1230.16	40°12'02.115"N	104°56'21.153"W	5.29	
7150.00	26.660	265.850	6852.18	-1180.90	-846.23	1211.22	40°12'02.099"N	104°56'21.398"W	7.55	
7192.00	29.050	269.810	6889.32	-1161.29	-846.94	1191.62	40°12'02.092"N	104°56'21.650"W	7.19	
7277.00	37.200	270.210	6960.44	-1114.91	-846.92	1145.21	40°12'02.093"N	104°56'22.248"W	9.59	
7363.00	49.330	267.270	7022.96	-1056.09	-848.38	1086.41	40°12'02.078"N	104°56'23.006"W	14.29	
7448.00	54.680	266.800	7075.26	-989.14	-851.86	1019.54	40°12'02.044"N	104°56'23.868"W	6.31	
7533.00	62.520	263.940	7119.52	-916.74	-857.78	947.30	40°12'01.985"N	104°56'24.799"W	9.66	
7619.00	69.410	264.820	7154.53	-838.40	-865.45	869.18	40°12'01.909"N	104°56'25.806"W	8.07	

Actual Wellpath Report

BAREFOOT 31C-25HZ AWP

Page 4 of 7

REFERENCE WELLPATH IDENTIFICATION

Operator	KERR-MCGEE OIL & GAS ONSHORE LP	Slot	SLOT#31 BAREFOOT 31C-25HZ (599'FNL & 514'FEL, SEC.25)
Area	COLORADO	Well	BAREFOOT 31C-25HZ
Field	WELD COUNTY (KERR MCGEE)	Wellbore	BAREFOOT 31C-25HZ AWB
Facility	SEC.25-T3N-R68W		

WELLPATH DATA (147 stations) † = interpolated/extrapolated station

MD [ft]	Inclination [°]	Azimuth [°]	TVD [ft]	Vert Sect [ft]	North [ft]	East [ft]	Latitude	Longitude	DLS [°/100ft]	Comments
7661.00	72.220	266.550	7168.33	-798.77	-868.43	829.63	40°12'01.880"N	104°56'26.315"W	7.74	
7703.00	77.050	268.630	7179.45	-758.28	-870.13	789.18	40°12'01.863"N	104°56'26.837"W	12.45	
7746.00	80.380	269.330	7187.87	-716.13	-870.87	747.02	40°12'01.856"N	104°56'27.380"W	7.91	
7789.00	82.490	269.300	7194.27	-673.62	-871.38	704.51	40°12'01.851"N	104°56'27.928"W	4.91	
7830.00	85.220	269.360	7198.66	-632.87	-871.86	663.75	40°12'01.846"N	104°56'28.453"W	6.66	
7884.00†	87.920	268.363	7201.89	-578.98	-872.93	609.86	40°12'01.836"N	104°56'29.147"W	5.33	7" CASING POINT
7907.00	89.070	267.940	7202.49	-555.99	-873.67	586.88	40°12'01.828"N	104°56'29.444"W	5.33	
7992.00	89.100	270.710	7203.85	-471.03	-874.67	501.91	40°12'01.818"N	104°56'30.539"W	3.26	
8077.00	88.610	270.700	7205.55	-386.14	-873.63	416.93	40°12'01.829"N	104°56'31.634"W	0.58	
8252.00	87.990	271.290	7210.74	-211.46	-870.59	242.04	40°12'01.859"N	104°56'33.888"W	0.49	
8338.00	87.870	271.880	7213.85	-125.68	-868.21	156.13	40°12'01.882"N	104°56'34.995"W	0.70	
8423.00	87.750	272.740	7217.10	-40.99	-864.79	71.26	40°12'01.916"N	104°56'36.089"W	1.02	
8507.00	88.580	272.060	7219.79	42.72	-861.27	-12.62	40°12'01.951"N	104°56'37.170"W	1.28	
8593.00	89.720	272.080	7221.06	128.49	-858.17	-98.56	40°12'01.982"N	104°56'38.277"W	1.33	
8678.00	90.090	270.810	7221.20	213.34	-856.03	-183.53	40°12'02.003"N	104°56'39.372"W	1.56	
8761.00	89.100	269.340	7221.79	296.28	-855.92	-266.52	40°12'02.004"N	104°56'40.442"W	2.14	
8847.00	89.470	267.870	7222.86	382.26	-858.01	-352.49	40°12'01.983"N	104°56'41.550"W	1.76	
8932.00	90.210	268.580	7223.10	467.26	-860.64	-437.45	40°12'01.957"N	104°56'42.645"W	1.21	
9017.00	90.030	268.190	7222.92	552.26	-863.04	-522.41	40°12'01.933"N	104°56'43.740"W	0.51	
9105.00	89.750	268.090	7223.09	640.26	-865.89	-610.37	40°12'01.905"N	104°56'44.873"W	0.34	
9190.00	89.780	267.900	7223.44	725.26	-868.87	-695.31	40°12'01.876"N	104°56'45.968"W	0.23	
9275.00	89.440	267.650	7224.02	810.25	-872.17	-780.25	40°12'01.843"N	104°56'47.062"W	0.50	
9360.00	90.210	268.100	7224.28	895.25	-875.32	-865.19	40°12'01.812"N	104°56'48.157"W	1.05	
9448.00	90.430	268.920	7223.79	983.25	-877.61	-953.15	40°12'01.789"N	104°56'49.291"W	0.96	
9535.00	90.430	269.380	7223.13	1070.23	-878.90	-1040.14	40°12'01.777"N	104°56'50.412"W	0.53	
9620.00	90.430	269.600	7222.50	1155.19	-879.66	-1125.14	40°12'01.769"N	104°56'51.507"W	0.26	
9708.00	90.090	269.730	7222.10	1243.16	-880.17	-1213.13	40°12'01.764"N	104°56'52.641"W	0.41	
9880.00	89.320	268.650	7222.98	1415.11	-882.60	-1385.11	40°12'01.740"N	104°56'54.857"W	0.77	
9965.00	88.120	267.070	7224.88	1500.09	-885.77	-1470.03	40°12'01.708"N	104°56'55.952"W	2.33	
10050.00	88.950	266.930	7227.05	1585.05	-890.22	-1554.88	40°12'01.664"N	104°56'57.045"W	0.99	
10136.00	89.470	266.960	7228.24	1671.02	-894.80	-1640.75	40°12'01.619"N	104°56'58.152"W	0.61	
10221.00	89.500	267.250	7229.00	1756.01	-899.10	-1725.64	40°12'01.577"N	104°56'59.246"W	0.34	

10306.00	89.100	266.450	7230.04	1840.98	-903.77	-1810.50	40°12'01.530"N	104°57'00.340"W	1.05	
10391.00	89.320	266.750	7231.21	1925.95	-908.81	-1895.34	40°12'01.480"N	104°57'01.433"W	0.44	
10477.00	90.360	266.840	7231.46	2011.93	-913.62	-1981.21	40°12'01.433"N	104°57'02.540"W	1.21	
10564.00	90.150	266.790	7231.07	2098.91	-918.45	-2068.07	40°12'01.385"N	104°57'03.659"W	0.25	
10649.00	90.000	267.100	7230.96	2183.90	-922.98	-2152.95	40°12'01.340"N	104°57'04.753"W	0.41	
10734.00	91.130	267.640	7230.12	2268.89	-926.88	-2237.86	40°12'01.302"N	104°57'05.847"W	1.47	
10820.00	90.980	267.400	7228.53	2354.87	-930.60	-2323.76	40°12'01.265"N	104°57'06.954"W	0.33	
10905.00	90.920	267.290	7227.13	2439.85	-934.54	-2408.66	40°12'01.226"N	104°57'08.048"W	0.15	
11075.00	90.860	268.200	7224.49	2609.83	-941.23	-2578.51	40°12'01.160"N	104°57'10.237"W	0.54	
11246.00	90.950	268.490	7221.78	2780.80	-946.16	-2749.41	40°12'01.111"N	104°57'12.440"W	0.18	
11331.00	90.950	268.410	7220.37	2865.79	-948.46	-2834.37	40°12'01.088"N	104°57'13.535"W	0.09	
11416.00	90.150	268.010	7219.56	2950.78	-951.12	-2919.32	40°12'01.061"N	104°57'14.629"W	1.05	
11501.00	89.930	267.570	7219.50	3035.78	-954.40	-3004.26	40°12'01.029"N	104°57'15.724"W	0.58	

Actual Wellpath Report

BAREFOOT 31C-25HZ AWP

Page 5 of 7

REFERENCE WELLPATH IDENTIFICATION

Operator	KERR-MCGEE OIL & GAS ONSHORE LP	Slot	SLOT#31 BAREFOOT 31C-25HZ (599'FNL & 514'FEL, SEC.25)
Area	COLORADO	Well	BAREFOOT 31C-25HZ
Field	WELD COUNTY (KERR MCGEE)	Wellbore	BAREFOOT 31C-25HZ AWB
Facility	SEC.25-T3N-R68W		

WELLPATH DATA (147 stations)

MD [ft]	Inclination [°]	Azimuth [°]	TVD [ft]	Vert Sect [ft]	North [ft]	East [ft]	Latitude	Longitude	DLS [°/100ft]	Comments
11672.00	89.130	266.720	7220.90	3206.75	-962.91	-3175.04	40°12'00.945"N	104°57'17.925"W	0.68	
11842.00	88.610	267.560	7224.25	3376.70	-971.39	-3344.79	40°12'00.860"N	104°57'20.113"W	0.58	
12013.00	88.730	267.320	7228.22	3547.65	-979.03	-3515.57	40°12'00.785"N	104°57'22.313"W	0.16	
12183.00	89.290	268.130	7231.16	3717.62	-985.78	-3685.41	40°12'00.718"N	104°57'24.502"W	0.58	
12354.00	90.670	268.470	7231.22	3888.61	-990.85	-3856.33	40°12'00.667"N	104°57'26.705"W	0.83	
12524.00	90.950	268.040	7228.82	4058.59	-996.02	-4026.24	40°12'00.616"N	104°57'28.895"W	0.30	
12612.00	90.980	268.040	7227.34	4146.58	-999.03	-4114.17	40°12'00.586"N	104°57'30.028"W	0.03	
12697.00	91.040	267.270	7225.84	4231.56	-1002.51	-4199.09	40°12'00.552"N	104°57'31.122"W	0.91	
12782.00	89.930	267.070	7225.12	4316.55	-1006.71	-4283.98	40°12'00.510"N	104°57'32.216"W	1.33	
12868.00	89.840	266.570	7225.29	4402.53	-1011.48	-4369.85	40°12'00.463"N	104°57'33.323"W	0.59	
12988.00	89.900	266.100	7225.56	4522.48	-1019.15	-4489.60	40°12'00.387"N	104°57'34.866"W	0.39	LAST BHI+MWD SURVEYS
13056.00	89.900	266.100	7225.68	4590.44	-1023.77	-4557.44	40°12'00.341"N	104°57'35.740"W	0.00	PROJECTION TO BIT

HOLE & CASING SECTIONS - Ref Wellbore: BAREFOOT 31C-25HZ AWB Ref Wellpath: BAREFOOT 31C-25HZ AWP

String/Diameter	Start MD [ft]	End MD [ft]	Interval [ft]	Start TVD [ft]	End TVD [ft]	Start N/S [ft]	Start E/W [ft]	End N/S [ft]	End E/W [ft]
13.5in Open Hole	17.00	1411.00	1394.00	17.00	1410.94	0.00	0.00	-4.69	-3.27
9.625in Casing Surface	17.00	1401.00	1384.00	17.00	1400.94	0.00	0.00	-4.59	-3.21
8.75in Open Hole	1411.00	7894.00	6483.00	1410.94	7202.21	-4.69	-3.27	-873.23	599.87
7in Casing Intermediate	17.00	7884.00	7867.00	17.00	7201.89	0.00	0.00	-872.93	609.86
6.125in Open Hole	7894.00	13056.00	5162.00	7202.21	7225.68	-873.23	599.87	-1023.77	-4557.44

Actual Wellpath Report

BAREFOOT 31C-25HZ AWP

Page 6 of 7

REFERENCE WELLPATH IDENTIFICATION

Operator	KERR-MCGEE OIL & GAS ONSHORE LP	Slot	SLOT#31 BAREFOOT 31C-25HZ (599'FNL & 514'FEL, SEC.25)
Area	COLORADO	Well	BAREFOOT 31C-25HZ
Field	WELD COUNTY (KERR MCGEE)	Wellbore	BAREFOOT 31C-25HZ AWB
Facility	SEC.25-T3N-R68W		

TARGETS

Name	MD [ft]	TVD [ft]	North [ft]	East [ft]	Grid East [US ft]	Grid North [US ft]	Latitude	Longitude	Shape
SEC.25-T3N-R68W SECTION LINES		4.00	-1466.31	-149.45	3155268.77	1315781.51	40°11'55.972"N	104°56'38.933"W	polygon
BAREFOOT 31C-25HZ BHL (REV-2) (1545'FNL & 190'FWL, SEC.25)		7236.00	-1013.55	-4558.80	3150856.86	1316206.58	40°12'00.442"N	104°57'35.758"W	point
BAREFOOT 31C-25HZ BHL ON PLAT (REV-1) (1405'FNL & 50'FWL, SEC.25)		7236.00	-873.55	-4698.80	3150715.99	1316345.69	40°12'01.825"N	104°57'37.562"W	point
BAREFOOT 31C-25HZ LAND BOX		7236.00	0.00	0.00	3155409.01	1317248.66	40°12'10.462"N	104°56'37.007"W	polygon

WELLPATH COMPOSITION - Ref Wellbore: BAREFOOT 31C-25HZ AWB Ref Wellpath: BAREFOOT 31C-25HZ AWP

Start MD [ft]	End MD [ft]	Positional Uncertainty Model	Log Name/Comment	Wellbore
17.00	1312.00	Generic gyro - continuous (Standard)	MS ENERGY GYRO SURVEYS 13.5" HOLE <117-1312>	BAREFOOT 31C-25HZ AWB
1312.00	7830.00	NaviTrak (IFR)	BHI MWD+IFR SURVEYS 8 3/4" HOLE <1498-7830>	BAREFOOT 31C-25HZ AWB
7830.00	12988.00	NaviTrak (IFR)	BHI MWD+IFR SURVEYS 6 1/8" HOLE <7907-12988>	BAREFOOT 31C-25HZ AWB
12988.00	13056.00	Blind Drilling (std)	Projection to bit	BAREFOOT 31C-25HZ AWB

Actual Wellpath Report

BAREFOOT 31C-25HZ AWP

Page 7 of 7

REFERENCE WELLPATH IDENTIFICATION

Operator	KERR-MCGEE OIL & GAS ONSHORE LP	Slot	SLOT#31 BAREFOOT 31C-25HZ (599'FNL & 514'FEL, SEC.25)
Area	COLORADO	Well	BAREFOOT 31C-25HZ
Field	WELD COUNTY (KERR MCGEE)	Wellbore	BAREFOOT 31C-25HZ AWB
Facility	SEC.25-T3N-R68W		

WELLPATH COMMENTS

MD [ft]	Inclination [°]	Azimuth [°]	TVD [ft]	Comment
17.00	0.000	213.240	17.00	TIE-ON
117.00	0.500	213.240	117.00	BEGIN GYRO SURVEYS
1312.00	0.960	276.200	1311.95	TIE-INTO GYRO SURVEYS
1498.00	1.290	169.180	1497.93	BEGIN BHI MWD+IFR SURVEYS
7884.00	87.920	268.363	7201.89	7" CASING POINT
12988.00	89.900	266.100	7225.56	LAST BHI+MWD SURVEYS
13056.00	89.900	266.100	7225.68	PROJECTION TO BIT