



Lat40°, Inc. 1635 Foxtrail Drive, Suite 325 Loveland, CO 970-776-3321

# HYDROLOGY MAP

DENNEY STATE 5-36-7-45

SECTION: 36  
TOWNSHIP: 7N  
RANGE: 45W

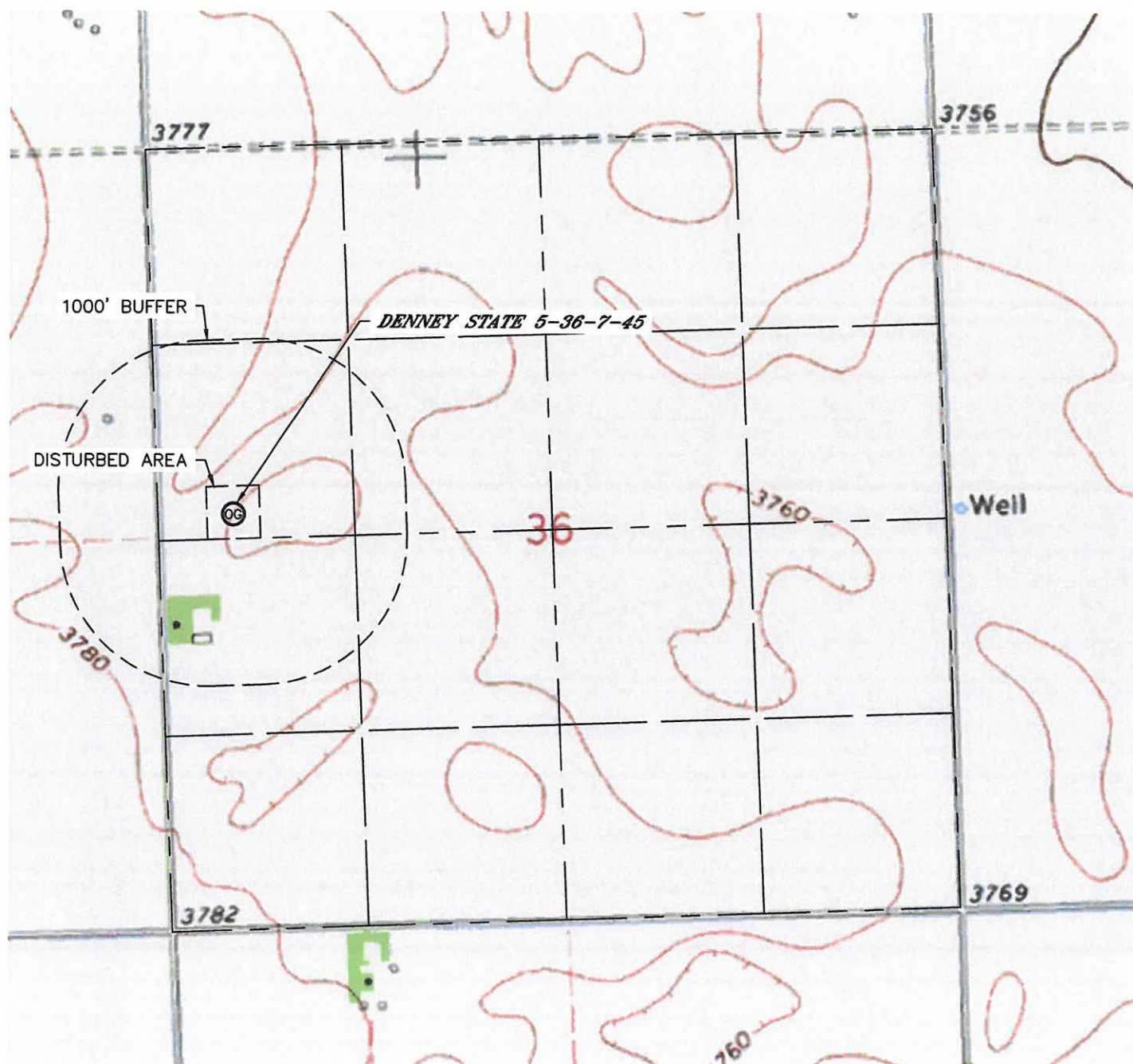

NO VISIBLE SURFACE WATER WITHIN 1000'

DATE: 1/27/2014  
PROJECT#: 2013175