

2.5" AC LS13895  
LAT 40.39358°N  
LONG 104.20443°W

N87°46'56"E - 5332.48'

2.5" AC LS37897  
LAT 40.39394°N  
LONG 104.18530°W

SURFACE LOCATION

S78°13'16"E  
738.09'

TARGET 1  
531'FNL; 2000'FWL

1279'

S00°30'13"E - 2650.73

NOTE: Under Colorado law,  
you must commence any legal  
action based upon any defect  
in this certificate within three  
years after defect is  
discovered. In no event, may  
any action based upon any  
defect in this survey be  
commenced more than ten  
years after date of this  
certificate shown hereon.  
(13-80105 C.R.S.)

N00°23'48"W - 5369.15'

T5N R6W  
22

S00°23'48"E - 4340.53'  
FROM TARGET TO BH

3" AC LS37897  
LAT 40.38666°N  
LONG 104.18536°W

S00°30'46"E - 2650.57'

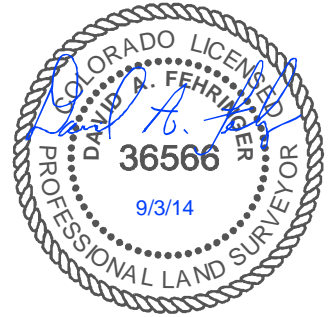

BOTTOM HOLE LOCATION

2000'

S87°03'31"W - 5345.38'

2.5" AC LS13895  
LAT 40.37885°N  
LONG 104.20458°W

3" AC LS37897  
LAT 40.37939°N  
LONG 104.18541°W

#### CERTIFICATE OF SURVEYOR

I, David A. Fehring of Lander, Wyoming hereby certify that this well location certificate was prepared from notes taken during an actual survey on AUGUST 27, 2014; and that it correctly shows the drilling location of BONANZA CREEK ENERGY, INC., PRONGHORN 21-24-22HNB as staked during said survey. This map does not represent a boundary survey or an improvement location plat and should not be used for the establishment of boundary lines.

#### WELL COORDINATES

	NAD 83		COLORADO NORTH NAD83	
	LATITUDE	LONGITUDE	NORTHING	EASTING
21-24-22HNB	40.392700	104.199850	1388556	3362130
SURFACE	40.392260	104.197270	1388405	3362853
TARGET 1	40.380340	104.197390	1384065	3362883
BOTTOM HOLE				

#### NOTES:

- All bearings are GRID based upon the Colorado State Plane Coordinate System, North Zone, NAD83(2011) derived from post-processed static GPS observations.
- Distances are at GROUND
- Vertical Datum is NAVD88 based upon GPS observations
- PDOP value equals 2.1.
- GPS operator: John Stoddard.
- Undisturbed ground elevation at wellhead = 4661.7'
- (M) Measured distance; (R) Record distance
- Nearest Cultural Distances
  - Buildings: 5280+
  - Building Unit: 5280+
  - High Occupancy Building Unit: 5280'+
  - Designated Outside Activity Area: 5280'+
  - Public Road: 267' north
  - Above Ground Utility: 5280'+
  - Railroad: 5280'+
  - Property Line: 352' north

SHEET NO:

1 of 1

#### WELL LOCATION CERTIFICATE

PRONGHORN 21-24-22HNB  
352' FNL, 1279' FWL  
NW $\frac{1}{4}$ NW $\frac{1}{4}$ , SECTION 22,  
T.5N., R.61W., 6th PM  
WELD COUNTY, COLORADO



410 17th Street  
Denver, CO 80202  
(720) 440-6100



ENGINEERING & SURVEYING  
64 COAL MINE RD.  
LANDER, WY 82520  
307-349-0840  
fes@wyoming.com

Drawn By: DAF  
Checked By: MAM  
Date: 3/14/14  
Revision: #2  
Date: 9/5/14  
Explanation: change  
well configuration

