

2.5" AC LS13895
LAT 40.39358°N
LONG 104.20443°W

N87°46'56"E - 5332.48'

2.5" AC LS37897
LAT 40.39394°N
LONG 104.18530°W

SURFACE LOCATION

S86°29'24"E
1388.38'

TARGET 1
531'FNL; 2666'FEL

NOTE: Under Colorado law,
you must commence any legal
action based upon any defect
in this certificate within three
years after defect is
discovered. In no event, may
any action based upon any
defect in this survey be
commenced more than ten
years after date of this
certificate shown hereon.
(13-80105 C.R.S.)

S00°30'13"E - 2650.73

N00°23'48"W - 5369.15'

22

S00°30'30"E - 4331.68'
FROM TARGET TO BH

3" AC LS37897
LAT 40.38666°N
LONG 104.18536°W

S00°30'46"E - 2650.57'

BOTTOM HOLE LOCATION

470'

2672'

2666'

S87°03'31"W - 5345.38'

2.5" AC LS13895
LAT 40.37885°N
LONG 104.20458°W

3" AC LS37897
LAT 40.37939°N
LONG 104.18541°W

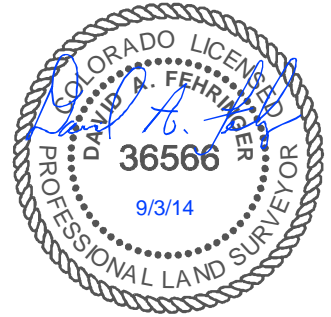

CERTIFICATE OF SURVEYOR

I, David A. Fehring of Lander, Wyoming hereby certify that this well location certificate was prepared from notes taken during an actual survey on AUGUST 27, 2014; and that it correctly shows the drilling location of BONANZA CREEK ENERGY, INC., PRONGHORN K-O-22HNB as staked during said survey. This map does not represent a boundary survey or an improvement location plat and should not be used for the establishment of boundary lines.

WELL COORDINATES

	NAD 83		COLORADO NORTH NAD83	
	LATITUDE	LONGITUDE	NORTHING	EASTING
K-O-22HNB	40.392590	104.199850	1388516	3362131
SURFACE	40.392300	104.194880	1388431	3363516
TARGET 1	40.380410	104.194980	1384100	3363555
BOTTOM HOLE				

NOTES:

- All bearings are GRID based upon the Colorado State Plane Coordinate System, North Zone, NAD83(2011) derived from post-processed static GPS observations.
- Distances are at GROUND
- Vertical Datum is NAVD88 based upon GPS observations
- PDOP value equals 2.1.
- GPS operator: John Stoddard.
- Undisturbed ground elevation at wellhead = 4661.7'
- (M) Measured distance; (R) Record distance
- Nearest Cultural Distances
 - Buildings: 5280+
 - Building Unit: 5280+
 - High Occupancy Building Unit: 5280'+
 - Designated Outside Activity Area: 5280'+
 - Public Road: 307' north
 - Above Ground Utility: 5280'+
 - Railroad: 5280'+
 - Property Line: 392' north

SHEET NO:

1 of 1

WELL LOCATION CERTIFICATE

PRONGHORN K-O-22HNB
392' FNL, 1278' FWL
NW $\frac{1}{4}$ NW $\frac{1}{4}$, SECTION 22,
T.5N., R.61W., 6th PM
WELD COUNTY, COLORADO



410 17th Street
Denver, CO 80202
(720) 440-6100



ENGINEERING & SURVEYING
64 COAL MINE RD.
LANDER, WY 82520
307-349-0840
fes@wyoming.com

Drawn By: DAF
Checked By: MAM
Date: 3/14/14
Revision: #2
Date: 9/5/14
Explanation: change
well configuration



0 500 1000
1" = 1000'