

KERR-MCGEE OIL & GAS ONSHORE LP

Location: COLORADO Slot: SLOT#03 DUGITE 13N-35HZ (1020'FSL & 590'FWL, SEC.23)
 Field: WELD COUNTY (KERR MCGEE) Well: DUGITE 13N-35HZ
 Facility: SEC.23-T2N-R67W Wellbore: DUGITE 13N-35HZ PWB

Plot reference wellpath is DUGITE 13N-35HZ (REV-A.0) PWP

True vertical depths are referenced to H&P 307 (25KB) (RKB)	Grid System: NAD83 / Lambert Colorado SP, Northern Zone (501), US feet
Measured depths are referenced to H&P 307 (25KB) (RKB)	North Reference: True north
H&P 307 (25KB) (RKB) to Mean Sea Level: 4994 feet	Scale: True distance
Mean Sea Level to Mud line (At Slot: SLOT#03 DUGITE 13N-35HZ (1020'FSL & 590'FWL, SEC.23)): 0 feet	Depths are in feet
Coordinates are in feet referenced to Slot	Created by: robale01 on 27/Jun/2014

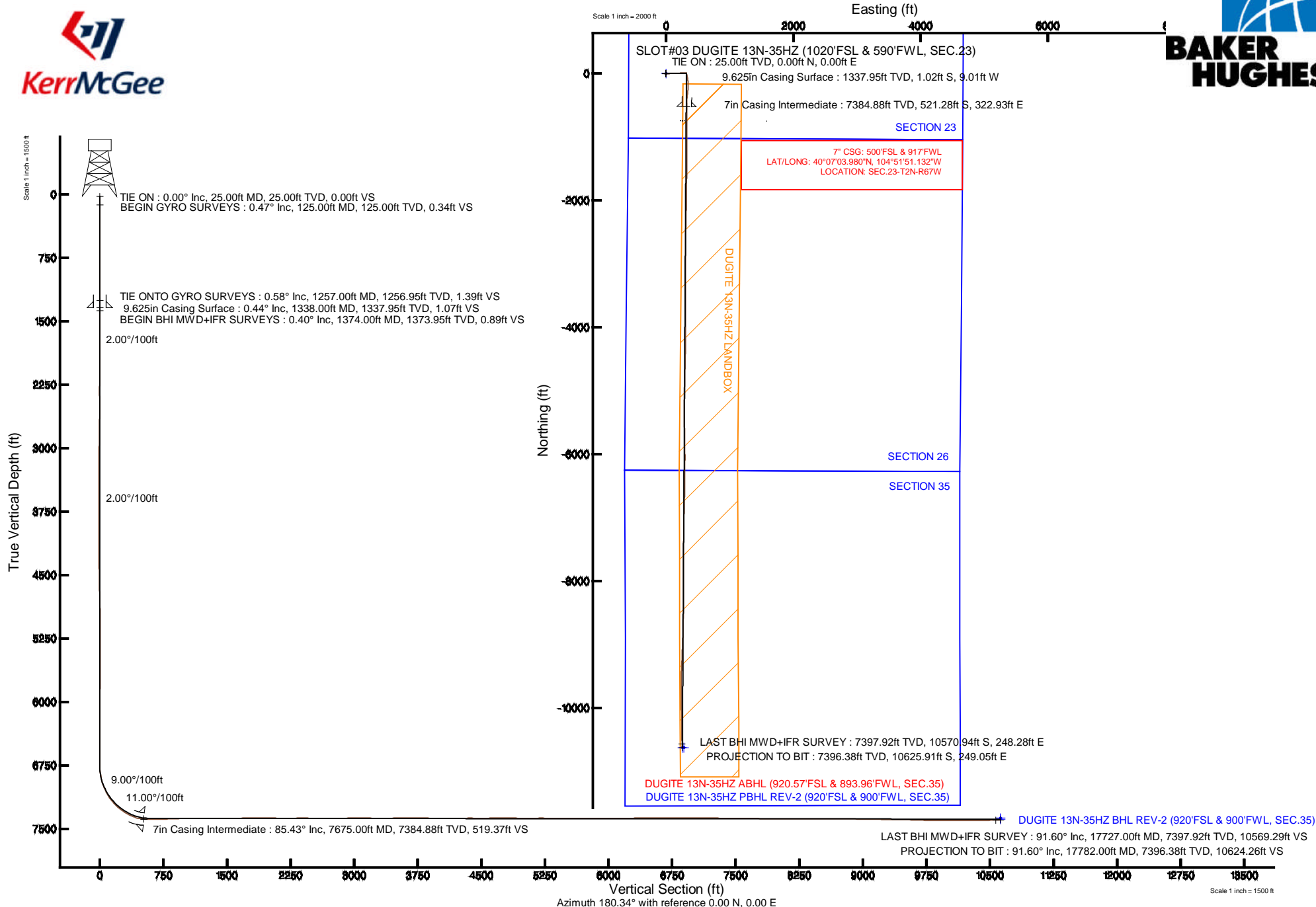

Actual Wellpath Report

DUGITE 13N-35HZ AWP

Page 1 of 7

REFERENCE WELLPATH IDENTIFICATION

Operator	KERR-MCGEE OIL & GAS ONSHORE LP	Slot	SLOT#03 DUGITE 13N-35HZ (1020'FSL & 590'FWL, SEC.23)
Area	COLORADO	Well	DUGITE 13N-35HZ
Field	WELD COUNTY (KERR MCGEE)	Wellbore	DUGITE 13N-35HZ AWB
Facility	SEC.23-T2N-R67W		

REPORT SETUP INFORMATION

Projection System	NAD83 / Lambert Colorado SP, Northern Zone (501), US feet	Software System	WellArchitect® 4.0.0
North Reference	True	User	Robiale01
Scale	0.999959	Report Generated	27/Jun/2014 at 09:33
Convergence at slot	n/a	Database/Source file	WellArchitectDB/DUGITE_13N-35HZ_AWB.xml

WELLPATH LOCATION

	Local coordinates		Grid coordinates		Geographic coordinates	
	North[ft]	East[ft]	Easting[US ft]	Northing[US ft]	Latitude	Longitude
Slot Location	-0.30	60.13	3177484.93	1286904.80	40°07'09.131"N	104°51'55.289"W
Facility Reference Pt			3177424.80	1286904.67	40°07'09.134"N	104°51'56.063"W
Field Reference Pt			3197771.84	1268891.29	40°04'09.600"N	104°47'36.000"W

WELLPATH DATUM

Calculation method	Minimum curvature	H&P 307 (25'KB) (RKB) to Facility Vertical Datum	4994.00ft
Horizontal Reference Pt	Slot	H&P 307 (25'KB) (RKB) to Mean Sea Level	4994.00ft
Vertical Reference Pt	H&P 307 (25'KB) (RKB)	H&P 307 (25'KB) (RKB) to Mud Line at Slot (SLOT#03 DUGITE 13N-35HZ (1020'FSL & 590'FWL, SEC.23))	4994.00ft
MD Reference Pt	H&P 307 (25'KB) (RKB)	Section Origin	N 0.00, E 0.00 ft
Field Vertical Reference	Mean Sea Level	Section Azimuth	178.66°

Actual Wellpath Report

DUGITE 13N-35HZ AWP

Page 2 of 7

REFERENCE WELLPATH IDENTIFICATION

Operator	KERR-MCGEE OIL & GAS ONSHORE LP	Slot	SLOT#03 DUGITE 13N-35HZ (1020'FSL & 590'FWL, SEC.23)
Area	COLORADO	Well	DUGITE 13N-35HZ
Field	WELD COUNTY (KERR MCGEE)	Wellbore	DUGITE 13N-35HZ AWB
Facility	SEC.23-T2N-R67W		

WELLPATH DATA (179 stations) † = interpolated/extrapolated station

MD [ft]	Inclination [°]	Azimuth [°]	TVD [ft]	Vert Sect [ft]	North [ft]	East [ft]	Latitude	Longitude	DLS [°/100ft]	Comments
0.00†	0.000	213.480	0.00	0.00	0.00	0.00	40°07'09.131"N	104°51'55.289"W	0.00	
25.00	0.000	213.480	25.00	0.00	0.00	0.00	40°07'09.131"N	104°51'55.289"W	0.00	TIE ON
125.00	0.470	213.480	125.00	0.34	-0.34	-0.23	40°07'09.128"N	104°51'55.292"W	0.47	BEGIN GYRO SURVEYS
225.00	0.620	256.000	224.99	0.79	-0.82	-0.98	40°07'09.123"N	104°51'55.302"W	0.42	
325.00	0.830	272.860	324.99	0.86	-0.91	-2.23	40°07'09.122"N	104°51'55.318"W	0.30	
425.00	0.720	304.780	424.98	0.43	-0.52	-3.47	40°07'09.126"N	104°51'55.334"W	0.44	
525.00	0.440	334.780	524.97	-0.29	0.19	-4.14	40°07'09.133"N	104°51'55.342"W	0.40	
625.00	0.110	274.680	624.97	-0.65	0.55	-4.40	40°07'09.136"N	104°51'55.346"W	0.40	
725.00	0.120	198.370	724.97	-0.56	0.45	-4.53	40°07'09.135"N	104°51'55.347"W	0.14	
825.00	0.430	219.230	824.97	-0.18	0.06	-4.80	40°07'09.132"N	104°51'55.351"W	0.32	
925.00	0.600	226.830	924.97	0.46	-0.58	-5.42	40°07'09.125"N	104°51'55.359"W	0.18	
1025.00	0.680	240.590	1024.96	1.09	-1.23	-6.32	40°07'09.119"N	104°51'55.370"W	0.17	
1125.00	0.510	262.630	1124.95	1.41	-1.58	-7.28	40°07'09.115"N	104°51'55.383"W	0.28	
1225.00	0.490	295.270	1224.95	1.27	-1.46	-8.11	40°07'09.117"N	104°51'55.393"W	0.28	
1257.00	0.580	289.470	1256.95	1.15	-1.35	-8.38	40°07'09.118"N	104°51'55.397"W	0.33	TIE ONTO GYRO SURVEYS
1374.00	0.400	320.340	1373.95	0.62	-0.83	-9.20	40°07'09.123"N	104°51'55.407"W	0.27	BEGIN BHI MWD+IFR SURVEYS
1466.00	1.480	80.820	1465.94	0.20	-0.40	-8.24	40°07'09.127"N	104°51'55.395"W	1.87	
1572.00	2.990	85.780	1571.85	-0.12	0.03	-4.13	40°07'09.131"N	104°51'55.342"W	1.43	
1664.00	3.980	98.030	1663.68	0.28	-0.24	1.43	40°07'09.129"N	104°51'55.271"W	1.34	
1756.00	5.260	92.480	1755.38	1.08	-0.87	8.80	40°07'09.122"N	104°51'55.176"W	1.47	
1848.00	7.160	92.890	1846.84	1.78	-1.34	18.74	40°07'09.118"N	104°51'55.048"W	2.07	
1940.00	9.700	87.980	1937.84	2.11	-1.36	32.22	40°07'09.118"N	104°51'54.874"W	2.87	
2031.00	10.680	85.570	2027.40	1.57	-0.44	48.29	40°07'09.127"N	104°51'54.667"W	1.17	
2123.00	9.900	83.460	2117.92	0.39	1.12	64.64	40°07'09.142"N	104°51'54.457"W	0.94	
2215.00	10.330	89.400	2208.49	-0.22	2.11	80.75	40°07'09.152"N	104°51'54.250"W	1.23	
2307.00	9.410	87.780	2299.13	-0.22	2.49	96.51	40°07'09.156"N	104°51'54.047"W	1.04	
2399.00	10.640	94.400	2389.73	0.51	2.13	112.50	40°07'09.152"N	104°51'53.841"W	1.83	
2490.00	9.820	92.610	2479.28	1.89	1.13	128.63	40°07'09.142"N	104°51'53.633"W	0.97	
2584.00	10.360	87.570	2571.83	2.28	1.12	145.08	40°07'09.142"N	104°51'53.422"W	1.10	
2677.00	9.490	85.800	2663.44	1.74	2.04	161.08	40°07'09.151"N	104°51'53.216"W	0.99	
2770.00	10.790	87.310	2754.98	1.15	3.01	177.42	40°07'09.161"N	104°51'53.005"W	1.43	
2863.00	9.820	85.170	2846.48	0.46	4.08	194.02	40°07'09.171"N	104°51'52.792"W	1.12	
2957.00	10.420	83.500	2939.02	-0.79	5.72	210.46	40°07'09.188"N	104°51'52.580"W	0.71	
3049.00	9.840	85.630	3029.58	-1.95	7.26	226.56	40°07'09.203"N	104°51'52.373"W	0.75	
3143.00	10.140	90.910	3122.16	-2.05	7.74	242.84	40°07'09.207"N	104°51'52.163"W	1.02	
3236.00	8.940	90.360	3213.87	-1.51	7.57	258.25	40°07'09.206"N	104°51'51.965"W	1.29	
3330.00	8.390	89.390	3306.80	-1.21	7.59	272.42	40°07'09.206"N	104°51'51.782"W	0.61	
3424.00	6.400	87.280	3400.01	-1.25	7.92	284.51	40°07'09.209"N	104°51'51.627"W	2.14	
3519.00	5.410	88.360	3494.51	-1.40	8.29	294.27	40°07'09.213"N	104°51'51.501"W	1.05	
3613.00	4.540	88.820	3588.15	-1.41	8.50	302.42	40°07'09.215"N	104°51'51.396"W	0.93	
3708.00	4.180	91.570	3682.88	-1.22	8.48	309.64	40°07'09.215"N	104°51'51.303"W	0.44	
3802.00	2.950	91.880	3776.69	-0.91	8.31	315.49	40°07'09.213"N	104°51'51.228"W	1.31	
3896.00	0.770	82.850	3870.64	-0.84	8.31	318.53	40°07'09.213"N	104°51'51.189"W	2.33	
3991.00	1.070	262.330	3965.63	-0.81	8.27	318.28	40°07'09.213"N	104°51'51.192"W	1.94	
4085.00	1.330	259.810	4059.61	-0.54	7.96	316.34	40°07'09.210"N	104°51'51.217"W	0.28	

Actual Wellpath Report

DUGITE 13N-35HZ AWP

Page 3 of 7

REFERENCE WELLPATH IDENTIFICATION			
Operator	KERR-MCGEE OIL & GAS ONSHORE LP	Slot	SLOT#03 DUGITE 13N-35HZ (1020'FSL & 590'FWL, SEC.23)
Area	COLORADO	Well	DUGITE 13N-35HZ
Field	WELD COUNTY (KERR MCGEE)	Wellbore	DUGITE 13N-35HZ AWP
Facility	SEC.23-T2N-R67W		

WELLPATH DATA (179 stations) † = interpolated/extrapolated station										
MD [ft]	Inclination [°]	Azimuth [°]	TVD [ft]	Vert Sect [ft]	North [ft]	East [ft]	Latitude	Longitude	DLS [°/100ft]	Comments
4179.00	0.210	282.250	4153.60	-0.42	7.80	315.10	40°07'09.208"N	104°51'51.233"W	1.21	
4557.00	1.080	168.730	4531.58	2.93	4.45	315.12	40°07'09.175"N	104°51'51.233"W	0.31	
4934.00	1.590	182.750	4908.48	11.65	-4.25	315.56	40°07'09.089"N	104°51'51.227"W	0.16	
5029.00	0.390	146.540	5003.46	13.24	-5.84	315.68	40°07'09.073"N	104°51'51.226"W	1.36	
5406.00	0.180	320.940	5380.46	13.85	-6.45	316.01	40°07'09.067"N	104°51'51.221"W	0.15	
5783.00	0.430	348.380	5757.46	11.99	-4.61	315.35	40°07'09.085"N	104°51'51.230"W	0.07	
6161.00	0.330	343.470	6135.45	9.55	-2.17	314.76	40°07'09.110"N	104°51'51.237"W	0.03	
6538.00	0.400	32.370	6512.44	7.41	-0.02	315.15	40°07'09.131"N	104°51'51.232"W	0.08	
6633.00	0.260	353.790	6607.44	6.91	0.47	315.31	40°07'09.136"N	104°51'51.230"W	0.27	
6727.00	0.400	166.850	6701.44	7.02	0.37	315.36	40°07'09.135"N	104°51'51.230"W	0.70	
6774.00	2.110	161.650	6748.43	8.01	-0.61	315.67	40°07'09.125"N	104°51'51.226"W	3.64	
6821.00	5.250	165.040	6795.32	10.93	-3.51	316.50	40°07'09.096"N	104°51'51.215"W	6.69	
6868.00	8.530	163.510	6841.98	16.38	-8.94	318.04	40°07'09.043"N	104°51'51.195"W	6.99	
6916.00	11.410	160.560	6889.25	24.34	-16.83	320.63	40°07'08.965"N	104°51'51.162"W	6.09	
6963.00	15.000	161.930	6935.00	34.58	-27.00	324.07	40°07'08.864"N	104°51'51.118"W	7.67	
7010.00	19.620	165.860	6979.86	48.11	-40.44	327.88	40°07'08.731"N	104°51'51.068"W	10.13	
7057.00	24.270	168.290	7023.44	65.32	-57.56	331.77	40°07'08.562"N	104°51'51.018"W	10.08	
7105.00	28.290	170.330	7066.47	86.28	-78.44	335.69	40°07'08.356"N	104°51'50.968"W	8.58	
7152.00	30.640	172.650	7107.39	109.22	-101.30	339.09	40°07'08.130"N	104°51'50.924"W	5.56	
7199.00	35.990	173.660	7146.66	134.91	-126.92	342.15	40°07'07.877"N	104°51'50.885"W	11.44	
7246.00	40.740	176.140	7183.50	164.00	-155.97	344.71	40°07'07.590"N	104°51'50.852"W	10.62	
7293.00	45.240	179.770	7217.87	196.03	-187.98	345.81	40°07'07.273"N	104°51'50.838"W	10.92	
7340.00	48.680	184.720	7249.96	230.29	-222.28	344.42	40°07'06.934"N	104°51'50.856"W	10.62	
7388.00	54.310	184.100	7279.83	267.64	-259.71	341.54	40°07'06.564"N	104°51'50.893"W	11.77	
7435.00	57.560	186.450	7306.16	306.31	-298.47	337.95	40°07'06.181"N	104°51'50.939"W	8.06	
7483.00	61.110	187.170	7330.63	347.17	-339.46	333.05	40°07'05.776"N	104°51'51.002"W	7.51	
7533.00	66.170	186.310	7352.83	391.51	-383.94	327.80	40°07'05.337"N	104°51'51.070"W	10.24	
7577.00	72.520	182.700	7368.34	432.44	-424.96	324.60	40°07'04.932"N	104°51'51.111"W	16.34	
7609.00	77.860	180.770	7376.52	463.32	-455.87	323.67	40°07'04.626"N	104°51'51.123"W	17.68	
7640.00	83.550	180.710	7381.53	493.88	-486.44	323.27	40°07'04.324"N	104°51'51.128"W	18.36	
7675.00†	85.434	180.433	7384.88	528.70	-521.28	322.93	40°07'03.980"N	104°51'51.132"W	5.44	7" CASING POINT
7734.00	88.610	179.970	7387.95	587.59	-580.19	322.72	40°07'03.397"N	104°51'51.135"W	5.44	
7829.00	90.950	179.460	7388.31	682.57	-675.18	323.19	40°07'02.459"N	104°51'51.129"W	2.52	
7923.00	92.120	179.280	7385.80	776.53	-769.14	324.22	40°07'01.530"N	104°51'51.116"W	1.26	
8017.00	92.090	179.290	7382.34	870.46	-863.07	325.40	40°07'00.602"N	104°51'51.101"W	0.03	
8111.00	91.690	179.810	7379.24	964.39	-957.02	326.13	40°06'59.674"N	104°51'51.091"W	0.70	
8206.00	90.830	179.330	7377.15	1059.36	-1051.99	326.85	40°06'58.735"N	104°51'51.082"W	1.04	
8300.00	90.460	180.170	7376.10	1153.33	-1145.98	327.26	40°06'57.806"N	104°51'51.077"W	0.98	
8395.00	89.560	180.270	7376.08	1248.30	-1240.98	326.89	40°06'56.867"N	104°51'51.081"W	0.95	
8583.00	90.490	180.460	7376.00	1436.21	-1428.97	325.69	40°06'55.010"N	104°51'51.097"W	0.50	
8678.00	90.580	181.380	7375.11	1531.13	-1523.96	324.17	40°06'54.071"N	104°51'51.117"W	0.97	
8772.00	89.750	181.360	7374.84	1625.03	-1617.93	321.92	40°06'53.142"N	104°51'51.145"W	0.88	
8866.00	91.040	181.240	7374.19	1718.92	-1711.90	319.79	40°06'52.214"N	104°51'51.173"W	1.38	
8960.00	90.030	180.860	7373.31	1812.84	-1805.88	318.07	40°06'51.285"N	104°51'51.195"W	1.15	
9149.00	89.630	180.830	7373.88	2001.70	-1994.86	315.28	40°06'49.418"N	104°51'51.231"W	0.21	

REFERENCE WELLPATH IDENTIFICATION

Operator	KERR-MCGEE OIL & GAS ONSHORE LP	Slot	SLOT#03 DUGITE 13N-35HZ (1020'FSL & 590'FWL, SEC.23)
Area	COLORADO	Well	DUGITE 13N-35HZ
Field	WELD COUNTY (KERR MCGEE)	Wellbore	DUGITE 13N-35HZ AWP
Facility	SEC.23-T2N-R67W		

WELLPATH DATA (179 stations)

MD [ft]	Inclination [°]	Azimuth [°]	TVD [ft]	Vert Sect [ft]	North [ft]	East [ft]	Latitude	Longitude	DLS [°/100ft]	Comments
9244.00	89.070	179.970	7374.95	2096.64	-2089.85	314.62	40°06'48.479"N	104°51'51.240"W	1.08	
9338.00	89.840	181.400	7375.85	2190.58	-2183.83	313.49	40°06'47.550"N	104°51'51.254"W	1.73	
9432.00	90.860	180.840	7375.27	2284.49	-2277.81	311.66	40°06'46.621"N	104°51'51.278"W	1.24	
9527.00	90.550	181.900	7374.10	2379.37	-2372.78	309.38	40°06'45.683"N	104°51'51.307"W	1.16	
9621.00	88.390	180.830	7374.97	2473.26	-2466.74	307.15	40°06'44.754"N	104°51'51.336"W	2.56	
9715.00	89.720	180.960	7376.52	2567.17	-2560.71	305.68	40°06'43.826"N	104°51'51.355"W	1.42	
9810.00	89.720	180.690	7376.99	2662.10	-2655.70	304.31	40°06'42.887"N	104°51'51.372"W	0.28	
9998.00	91.070	179.890	7375.69	2850.01	-2843.69	303.36	40°06'41.029"N	104°51'51.385"W	0.83	
10093.00	90.150	180.240	7374.68	2944.98	-2938.68	303.25	40°06'40.091"N	104°51'51.386"W	1.04	
10187.00	90.740	179.650	7373.95	3038.95	-3032.68	303.34	40°06'39.162"N	104°51'51.385"W	0.89	
10281.00	89.220	180.150	7373.98	3132.93	-3126.67	303.50	40°06'38.233"N	104°51'51.383"W	1.70	
10376.00	89.630	180.450	7374.94	3227.88	-3221.67	303.01	40°06'37.294"N	104°51'51.389"W	0.53	
10470.00	90.000	179.930	7375.24	3321.85	-3315.67	302.70	40°06'36.365"N	104°51'51.393"W	0.68	
10564.00	90.180	179.860	7375.09	3415.83	-3409.67	302.87	40°06'35.436"N	104°51'51.391"W	0.21	
10656.00	91.010	180.060	7374.14	3507.80	-3501.66	302.93	40°06'34.527"N	104°51'51.390"W	0.93	
10748.00	89.590	180.270	7373.66	3599.76	-3593.66	302.67	40°06'33.618"N	104°51'51.394"W	1.56	
10840.00	89.810	179.840	7374.14	3691.73	-3685.65	302.58	40°06'32.709"N	104°51'51.395"W	0.53	
10932.00	89.960	179.240	7374.32	3783.72	-3777.65	303.32	40°06'31.800"N	104°51'51.385"W	0.67	
11024.00	89.660	178.500	7374.63	3875.72	-3869.63	305.13	40°06'30.891"N	104°51'51.362"W	0.87	
11115.00	89.840	179.740	7375.02	3966.71	-3960.62	306.53	40°06'29.992"N	104°51'51.344"W	1.38	
11207.00	89.130	180.010	7375.85	4058.69	-4052.61	306.73	40°06'29.083"N	104°51'51.341"W	0.83	
11299.00	90.610	180.580	7376.06	4150.65	-4144.61	306.26	40°06'28.173"N	104°51'51.348"W	1.72	
11391.00	89.960	181.140	7375.60	4242.58	-4236.60	304.88	40°06'27.264"N	104°51'51.365"W	0.93	
11483.00	90.920	181.210	7374.90	4334.48	-4328.57	302.99	40°06'26.355"N	104°51'51.390"W	1.05	
11574.00	89.130	181.380	7374.86	4425.38	-4419.55	300.93	40°06'25.456"N	104°51'51.416"W	1.98	
11668.00	90.090	181.920	7375.50	4519.25	-4513.50	298.23	40°06'24.528"N	104°51'51.451"W	1.17	
11761.00	91.110	181.370	7374.52	4612.12	-4606.46	295.56	40°06'23.609"N	104°51'51.485"W	1.25	
11854.00	89.900	182.090	7373.70	4704.98	-4699.41	292.75	40°06'22.691"N	104°51'51.521"W	1.51	
11947.00	90.830	181.420	7373.11	4797.84	-4792.36	289.90	40°06'21.772"N	104°51'51.558"W	1.23	
12041.00	88.420	180.760	7373.72	4891.75	-4886.34	288.11	40°06'20.844"N	104°51'51.581"W	2.66	
12227.00	90.270	181.000	7375.85	5077.59	-5072.29	285.26	40°06'19.006"N	104°51'51.618"W	1.00	
12320.00	90.890	180.560	7374.91	5170.52	-5165.28	283.99	40°06'18.087"N	104°51'51.634"W	0.82	
12414.00	89.070	179.330	7374.94	5264.49	-5259.27	284.08	40°06'17.158"N	104°51'51.633"W	2.34	
12508.00	89.900	179.640	7375.79	5358.47	-5353.27	284.93	40°06'16.229"N	104°51'51.622"W	0.94	
12602.00	90.640	179.780	7375.34	5452.46	-5447.26	285.40	40°06'15.300"N	104°51'51.616"W	0.80	
12697.00	88.580	178.770	7375.99	5547.44	-5542.25	286.60	40°06'14.362"N	104°51'51.601"W	2.41	
12791.00	89.350	179.150	7377.69	5641.42	-5636.22	288.31	40°06'13.433"N	104°51'51.579"W	0.91	
12886.00	89.840	178.730	7378.36	5736.42	-5731.20	290.07	40°06'12.495"N	104°51'51.556"W	0.68	
12980.00	90.830	178.560	7377.81	5830.42	-5825.17	292.29	40°06'11.566"N	104°51'51.528"W	1.07	
13074.00	90.060	179.880	7377.08	5924.41	-5919.15	293.57	40°06'10.637"N	104°51'51.511"W	1.63	
13169.00	90.550	179.390	7376.57	6019.39	-6014.15	294.17	40°06'09.698"N	104°51'51.503"W	0.73	
13263.00	90.000	180.960	7376.12	6113.35	-6108.14	293.89	40°06'08.770"N	104°51'51.507"W	1.77	
13357.00	90.460	180.950	7375.75	6207.28	-6202.13	292.32	40°06'07.841"N	104°51'51.527"W	0.49	
13451.00	90.770	180.890	7374.74	6301.20	-6296.11	290.81	40°06'06.912"N	104°51'51.547"W	0.34	
13546.00	89.690	180.380	7374.36	6396.14	-6391.10	289.76	40°06'05.973"N	104°51'51.560"W	1.26	

REFERENCE WELLPATH IDENTIFICATION

Operator	KERR-MCGEE OIL & GAS ONSHORE LP	Slot	SLOT#03 DUGITE 13N-35HZ (1020'FSL & 590'FWL, SEC.23)
Area	COLORADO	Well	DUGITE 13N-35HZ
Field	WELD COUNTY (KERR MCGEE)	Wellbore	DUGITE 13N-35HZ AWP
Facility	SEC.23-T2N-R67W		

WELLPATH DATA (179 stations)

MD [ft]	Inclination [°]	Azimuth [°]	TVD [ft]	Vert Sect [ft]	North [ft]	East [ft]	Latitude	Longitude	DLS [°/100ft]	Comments
13640.00	90.430	180.390	7374.26	6490.10	-6485.10	289.13	40°06'05.044"N	104°51'51.568"W	0.79	
13734.00	90.400	180.530	7373.58	6584.05	-6579.10	288.37	40°06'04.116"N	104°51'51.578"W	0.15	
13829.00	90.920	180.430	7372.48	6678.99	-6674.09	287.58	40°06'03.177"N	104°51'51.588"W	0.56	
13923.00	89.560	181.710	7372.09	6772.90	-6768.06	285.82	40°06'02.248"N	104°51'51.611"W	1.99	
14018.00	90.460	181.810	7372.07	6867.76	-6863.02	282.90	40°06'01.310"N	104°51'51.648"W	0.95	
14112.00	88.980	180.940	7372.53	6961.65	-6956.99	280.65	40°06'00.381"N	104°51'51.678"W	1.83	
14207.00	89.500	181.250	7373.79	7056.56	-7051.96	278.83	40°05'59.443"N	104°51'51.701"W	0.64	
14301.00	89.780	180.930	7374.38	7150.47	-7145.94	277.04	40°05'58.514"N	104°51'51.724"W	0.45	
14395.00	90.000	180.500	7374.56	7244.41	-7239.93	275.87	40°05'57.585"N	104°51'51.739"W	0.51	
14489.00	89.590	181.140	7374.90	7338.34	-7333.92	274.53	40°05'56.656"N	104°51'51.756"W	0.81	
14583.00	90.030	181.120	7375.21	7432.25	-7427.90	272.67	40°05'55.727"N	104°51'51.780"W	0.47	
14678.00	90.460	181.100	7374.80	7527.17	-7522.89	270.83	40°05'54.789"N	104°51'51.804"W	0.45	
14772.00	88.480	180.250	7375.67	7621.10	-7616.87	269.72	40°05'53.860"N	104°51'51.818"W	2.29	
14866.00	88.700	180.300	7377.99	7715.03	-7710.84	269.27	40°05'52.931"N	104°51'51.824"W	0.24	
14960.00	88.790	180.170	7380.05	7808.97	-7804.82	268.89	40°05'52.003"N	104°51'51.829"W	0.17	
15055.00	89.010	180.030	7381.87	7903.93	-7899.80	268.72	40°05'51.064"N	104°51'51.831"W	0.27	
15149.00	89.590	180.140	7383.02	7997.89	-7993.79	268.58	40°05'50.135"N	104°51'51.833"W	0.63	
15243.00	90.090	179.930	7383.28	8091.86	-8087.79	268.52	40°05'49.206"N	104°51'51.834"W	0.58	
15338.00	90.610	179.970	7382.70	8186.84	-8182.79	268.61	40°05'48.268"N	104°51'51.833"W	0.55	
15432.00	89.100	180.010	7382.94	8280.81	-8276.79	268.62	40°05'47.339"N	104°51'51.832"W	1.61	
15527.00	89.780	179.870	7383.87	8375.78	-8371.78	268.72	40°05'46.400"N	104°51'51.831"W	0.73	
15621.00	90.580	180.310	7383.57	8469.75	-8465.78	268.58	40°05'45.471"N	104°51'51.833"W	0.97	
15716.00	89.100	180.610	7383.84	8564.70	-8560.77	267.81	40°05'44.532"N	104°51'51.843"W	1.59	
15810.00	89.930	180.930	7384.63	8658.63	-8654.76	266.55	40°05'43.603"N	104°51'51.859"W	0.95	
15905.00	90.770	180.760	7384.05	8753.56	-8749.75	265.15	40°05'42.665"N	104°51'51.877"W	0.90	
15999.00	89.190	182.230	7384.08	8847.44	-8843.71	262.70	40°05'41.736"N	104°51'51.909"W	2.30	
16094.00	89.960	182.390	7384.79	8942.24	-8938.63	258.87	40°05'40.798"N	104°51'51.958"W	0.83	
16188.00	89.630	181.550	7385.13	9036.08	-9032.57	255.64	40°05'39.870"N	104°51'52.000"W	0.96	
16283.00	87.900	182.120	7387.17	9130.91	-9127.50	252.60	40°05'38.932"N	104°51'52.039"W	1.92	
16377.00	88.640	182.070	7390.01	9224.70	-9221.39	249.16	40°05'38.004"N	104°51'52.083"W	0.79	
16471.00	89.160	182.360	7391.82	9318.50	-9315.30	245.53	40°05'37.076"N	104°51'52.130"W	0.63	
16566.00	89.840	182.500	7392.64	9413.29	-9410.21	241.50	40°05'36.138"N	104°51'52.182"W	0.73	
16756.00	87.990	179.610	7396.24	9603.06	-9600.12	238.00	40°05'34.261"N	104°51'52.227"W	1.81	
16850.00	88.610	179.910	7399.03	9697.00	-9694.07	238.40	40°05'33.333"N	104°51'52.222"W	0.73	
16945.00	89.290	179.690	7400.77	9791.96	-9789.06	238.73	40°05'32.394"N	104°51'52.217"W	0.75	
17040.00	89.290	179.280	7401.95	9886.95	-9884.05	239.58	40°05'31.456"N	104°51'52.206"W	0.43	
17134.00	89.660	179.680	7402.81	9980.93	-9978.04	240.43	40°05'30.527"N	104°51'52.195"W	0.58	
17227.00	90.520	179.530	7402.66	10073.92	-10071.04	241.07	40°05'29.608"N	104°51'52.187"W	0.94	
17322.00	91.100	179.460	7401.32	10168.90	-10166.02	241.91	40°05'28.669"N	104°51'52.176"W	0.61	
17417.00	89.590	178.960	7400.75	10263.89	-10261.01	243.22	40°05'27.730"N	104°51'52.160"W	1.67	
17512.00	90.030	178.990	7401.06	10358.89	-10355.99	244.92	40°05'26.792"N	104°51'52.138"W	0.46	
17607.00	90.770	179.100	7400.40	10453.88	-10450.98	246.50	40°05'25.853"N	104°51'52.117"W	0.79	
17727.00	91.600	179.200	7397.92	10573.85	-10570.94	248.28	40°05'24.668"N	104°51'52.094"W	0.70	LAST BHI MWD+IFR SURVEY
17782.00	91.600	179.200	7396.38	10628.83	-10625.91	249.05	40°05'24.124"N	104°51'52.085"W	0.00	PROJECTION TO BIT

Actual Wellpath Report

DUGITE 13N-35HZ AWP

Page 6 of 7

REFERENCE WELLPATH IDENTIFICATION

Operator	KERR-MCGEE OIL & GAS ONSHORE LP	Slot	SLOT#03 DUGITE 13N-35HZ (1020'FSL & 590'FWL, SEC.23)
Area	COLORADO	Well	DUGITE 13N-35HZ
Field	WELD COUNTY (KERR MCGEE)	Wellbore	DUGITE 13N-35HZ AWB
Facility	SEC.23-T2N-R67W		

HOLE & CASING SECTIONS - Ref Wellbore: DUGITE 13N-35HZ AWB Ref Wellpath: DUGITE 13N-35HZ AWP

String/Diameter	Start MD [ft]	End MD [ft]	Interval [ft]	Start TVD [ft]	End TVD [ft]	Start N/S [ft]	Start E/W [ft]	End N/S [ft]	End E/W [ft]
13.5in Open Hole	25.00	1338.00	1313.00	25.00	1337.95	0.00	0.00	-1.02	-9.01
9.625in Casing Surface	25.00	1338.00	1313.00	25.00	1337.95	0.00	0.00	-1.02	-9.01
8.75in Open Hole	1338.00	7682.00	6344.00	1337.95	7385.42	-1.02	-9.01	-528.26	322.88
7in Casing Intermediate	25.00	7675.00	7650.00	25.00	7384.88	0.00	0.00	-521.28	322.93
6.125in Open Hole	7682.00	17782.00	10100.00	7385.42	7396.38	-528.26	322.88	-10625.91	249.05

WELLPATH COMPOSITION - Ref Wellbore: DUGITE 13N-35HZ AWB Ref Wellpath: DUGITE 13N-35HZ AWP

Start MD [ft]	End MD [ft]	Positional Uncertainty Model	Log Name/Comment	Wellbore
25.00	1257.00	Generic gyro - continuous (Standard)	MS GYRO SURVEYS FROM ANADARKO <125-1257>	DUGITE 13N-35HZ AWB
1257.00	7640.00	NaviTrak (MAGCORR,IFR)	BHI NAVITRAK MWD+IFR 8 3/4" <1374-7640>	DUGITE 13N-35HZ AWB
7640.00	17727.00	NaviTrak (MAGCORR,IFR)	BHI NAVITRAK MWD+IFR 6 1/8" <7734-17727>	DUGITE 13N-35HZ AWB
17727.00	17782.00	Blind Drilling (std)	Projection to bit	DUGITE 13N-35HZ AWB

Actual Wellpath Report

DUGITE 13N-35HZ AWP

Page 7 of 7

REFERENCE WELLPATH IDENTIFICATION

Operator	KERR-MCGEE OIL & GAS ONSHORE LP	Slot	SLOT#03 DUGITE 13N-35HZ (1020'FSL & 590'FWL, SEC.23)
Area	COLORADO	Well	DUGITE 13N-35HZ
Field	WELD COUNTY (KERR MCGEE)	Wellbore	DUGITE 13N-35HZ AWP
Facility	SEC.23-T2N-R67W		

WELLPATH COMMENTS

MD [ft]	Inclination [°]	Azimuth [°]	TVD [ft]	Comment
25.00	0.000	213.480	25.00	TIE ON
125.00	0.470	213.480	125.00	BEGIN GYRO SURVEYS
1257.00	0.580	289.470	1256.95	TIE ONTO GYRO SURVEYS
1374.00	0.400	320.340	1373.95	BEGIN BHI MWD+IFR SURVEYS
7675.00	85.434	180.433	7384.88	7" CASING POINT
17727.00	91.600	179.200	7397.92	LAST BHI MWD+IFR SURVEY
17782.00	91.600	179.200	7396.38	PROJECTION TO BIT