



Lat40°, Inc. 1635 Foxtrail Drive, Suite 325 Loveland, CO 970-776-3321





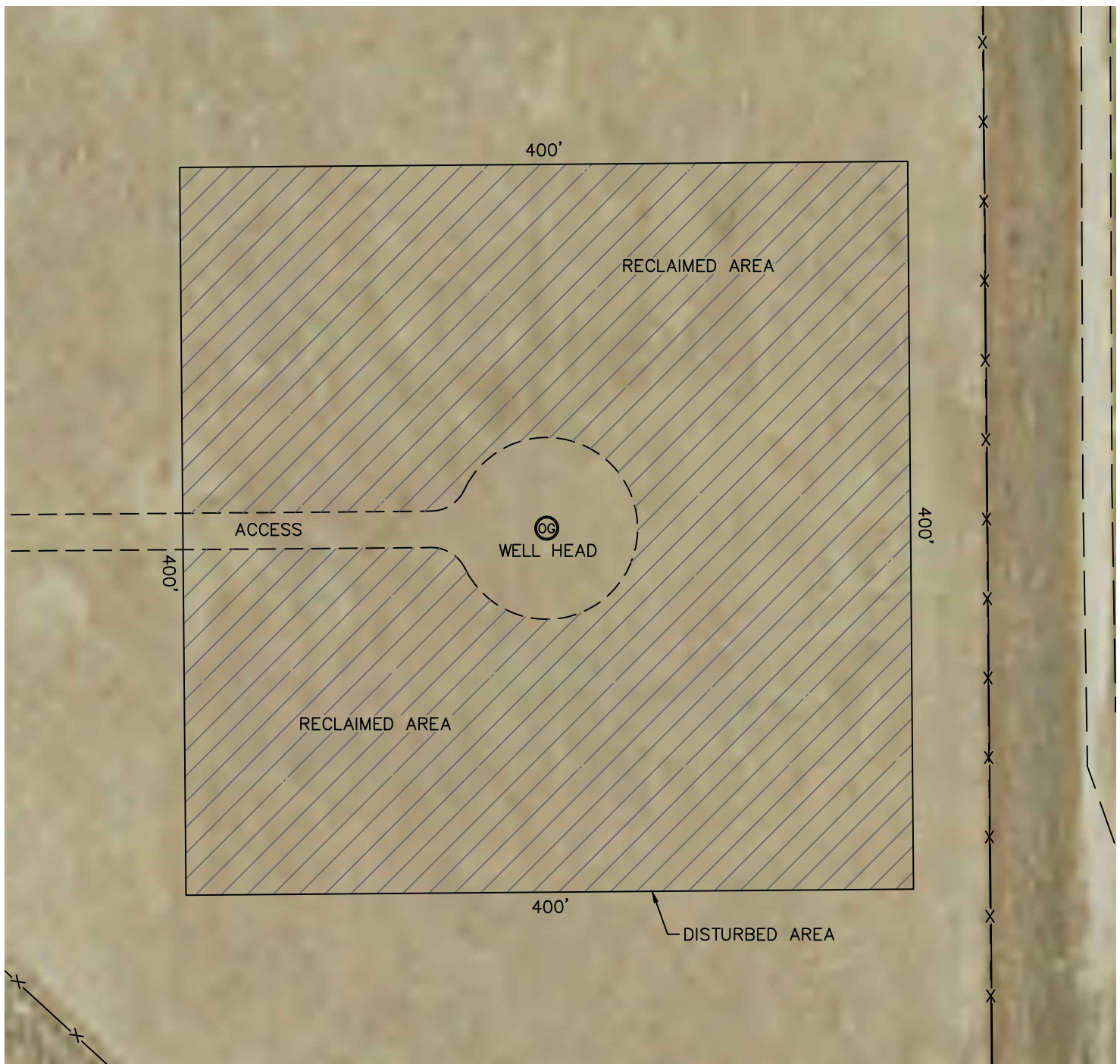

PROPOSED SCALED FACILITY DRAWING

HPD PLATTEVILLE 2

SECTION: 24
TOWNSHIP: 3N
RANGE: 66W



LEGEND

-  PROPOSED WELL HEAD
-  TANK BATTERY
-  WATER TANK
-  WATER VAULT
-  SEPARATOR
-  ECD
-  METER
- VRU- VAPOR RECOVERY UNIT

TOTAL DISTURBED AREA OF LOCATION: ±3.7 ACRES
TOTAL SIZE OF LOCATION AFTER RECLAMATION: ±0.3 ACRES

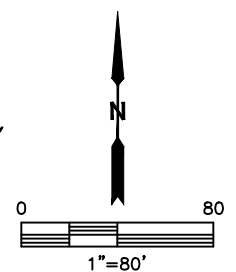

DATE: 7/28/2014
PROJECT#: 2014050