

NGL WATER SOLUTIONS DJ			
Location	Windsor	Slot	C-1-C
Field	Wattenberg	Well	C-1-C
Installation	C1C	Wellbore	C-1-C (PWB)

Slot	C-1-C
Well	C-1-C
Wellbore	C-1-C (PWB)

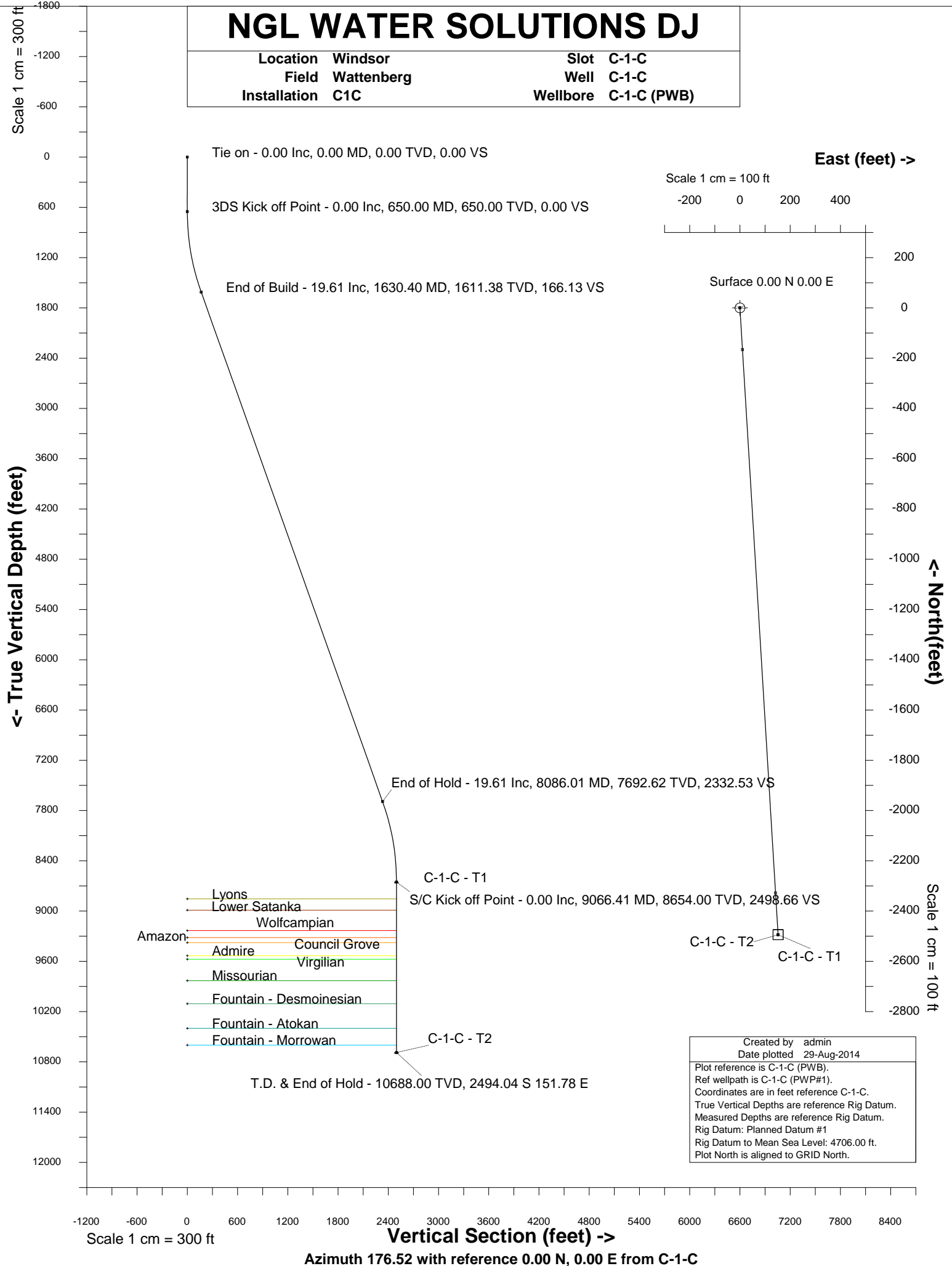



INTEGRATED PETROLEUM TECHNOLOGIES, INC
SYSDRILL
Well Design Combined Report
Wellbore: C-1-C (PWB)

Wellhead Details							
Name	Northing	Easting	Latitude	Longitude	North	East	Elevation Above Inst.
C-1-C	1361003.9166	3260481.5340	40.32059000	-104.56581000	0.00N	0.00E	-0.00

Declination			
Date	Source	Time	
29-Aug-2014	IGRF Model [1900.0-2015.0]		08:25

Site Details				
Name	Northing	Easting	Coord System Name	North Alignment
C1C	1361003.9166	3260481.5340	CO83-NF on NORTH AMERICAN DATUM 1983 datum	Grid

Summary Wellpath									
MD[ft]	Inc[deg]	Azi[deg]	TVD[ft]	North[ft]	East[ft]	Dogleg [deg/100ft]	Vertical Section[ft]	Northing	Easting
0.00	0.00	0.000	0.00	0.00N	0.00E		0.00	1361003.92	3260481.53
650.00	0.00	0.000	650.00	0.00N	0.00E	==>	0.00	1361003.92	3260481.53
1630.40	19.61	176.520	1611.38	165.82S	10.09E	2.00	166.13	1360838.10	3260491.62
8086.01	19.61	176.520	7692.62	2328.22S	141.69E	==>	2332.53	1358675.80	3260623.21
9066.41	0.00	0.000	8654.00	2494.04S	151.78E	2.00	2498.66	1358509.99	3260633.30
11100.41	0.00	0.000	10688.00	2494.04S	151.78E	==>	2498.66	1358509.99	3260633.30

Interpolated Wellpath									
MD[ft]	Inc[deg]	Azi[deg]	TVD[ft]	North[ft]	East[ft]	Dogleg [deg/100ft]	Vertical Section[ft]	Northing	Easting
0.00	0.00	0.000	0.00	0.00N	0.00E		0.00	1361003.92	3260481.53
100.00	0.00	0.000	100.00	0.00N	0.00E	==>	0.00	1361003.92	3260481.53
200.00	0.00	0.000	200.00	0.00N	0.00E	==>	0.00	1361003.92	3260481.53
300.00	0.00	0.000	300.00	0.00N	0.00E	==>	0.00	1361003.92	3260481.53
400.00	0.00	0.000	400.00	0.00N	0.00E	==>	0.00	1361003.92	3260481.53
500.00	0.00	0.000	500.00	0.00N	0.00E	==>	0.00	1361003.92	3260481.53
600.00	0.00	0.000	600.00	0.00N	0.00E	==>	0.00	1361003.92	3260481.53
650.00	0.00	0.000	650.00	0.00N	0.00E	==>	0.00	1361003.92	3260481.53
750.00	2.00	176.520	749.98	1.74S	0.11E	2.00	1.75	1361002.17	3260481.64
850.00	4.00	176.520	849.84	6.97S	0.42E	2.00	6.98	1360996.95	3260481.96
950.00	6.00	176.520	949.45	15.66S	0.95E	2.00	15.69	1360988.25	3260482.49
1050.00	8.00	176.520	1048.70	27.83S	1.69E	2.00	27.88	1360976.09	3260483.23
1150.00	10.00	176.520	1147.47	43.44S	2.64E	2.00	43.52	1360960.48	3260484.18
1250.00	12.00	176.520	1245.62	62.49S	3.80E	2.00	62.60	1360941.43	3260485.34
1350.00	14.00	176.520	1343.06	84.94S	5.17E	2.00	85.10	1360918.98	3260486.70
1450.00	16.00	176.520	1439.64	110.77S	6.74E	2.00	110.98	1360893.15	3260488.27
1550.00	18.00	176.520	1535.27	139.95S	8.52E	2.00	140.21	1360863.97	3260490.05
1630.40	19.61	176.520	1611.38	165.82S	10.09E	2.00	166.13	1360838.10	3260491.62
1700.00	19.61	176.520	1676.94	189.13S	11.51E	==>	189.48	1360814.79	3260493.04
1800.00	19.61	176.520	1771.14	222.63S	13.55E	==>	223.04	1360781.30	3260495.08
1900.00	19.61	176.520	1865.34	256.13S	15.59E	==>	256.60	1360747.80	3260497.12
2000.00	19.61	176.520	1959.54	289.62S	17.63E	==>	290.16	1360714.31	3260499.16
2100.00	19.61	176.520	2053.74	323.12S	19.66E	==>	323.72	1360680.81	3260501.20
2200.00	19.61	176.520	2147.94	356.62S	21.70E	==>	357.28	1360647.32	3260503.24
2300.00	19.61	176.520	2242.14	390.11S	23.74E	==>	390.83	1360613.82	3260505.27
2400.00	19.61	176.520	2336.35	423.61S	25.78E	==>	424.39	1360580.33	3260507.31
2500.00	19.61	176.520	2430.55	457.11S	27.82E	==>	457.95	1360546.83	3260509.35
2600.00	19.61	176.520	2524.75	490.60S	29.86E	==>	491.51	1360513.34	3260511.39
2700.00	19.61	176.520	2618.95	524.10S	31.89E	==>	525.07	1360479.84	3260513.43
2800.00	19.61	176.520	2713.15	557.60S	33.93E	==>	558.63	1360446.35	3260515.47
2900.00	19.61	176.520	2807.35	591.09S	35.97E	==>	592.19	1360412.85	3260517.50
3000.00	19.61	176.520	2901.55	624.59S	38.01E	==>	625.74	1360379.36	3260519.54
3100.00	19.61	176.520	2995.75	658.08S	40.05E	==>	659.30	1360345.86	3260521.58
3200.00	19.61	176.520	3089.95	691.58S	42.09E	==>	692.86	1360312.37	3260523.62
3300.00	19.61	176.520	3184.16	725.08S	44.13E	==>	726.42	1360278.87	3260525.66
3400.00	19.61	176.520	3278.36	758.57S	46.16E	==>	759.98	1360245.38	3260527.70
3500.00	19.61	176.520	3372.56	792.07S	48.20E	==>	793.54	1360211.88	3260529.73
3600.00	19.61	176.520	3466.76	825.57S	50.24E	==>	827.09	1360178.39	3260531.77

All data is in Feet unless otherwise stated
Coordinates are from Slot MD's are from Rig and TVD's are from Rig (Planned Datum #1 4706.0ft above Mean Sea Level)
Vertical Section is from 0.00N 0.00E on azimuth 176.520 degrees
Bottom hole distance is 2498.66 Feet on azimuth 176.52 degrees from Wellhead
Calculation method uses Minimum Curvature method
Prepared by Integrated Petroleum Technologies, Inc.
Date Printed: 29-Aug-2014



INTEGRATED PETROLEUM TECHNOLOGIES, INC
SYSDRILL
Well Design Combined Report
Wellbore: C-1-C (PWB)

Interpolated Wellpath									
MD[ft]	Inc[deg]	Azi[deg]	TVD[ft]	North[ft]	East[ft]	Dogleg [deg/100ft]	Vertical Section[ft]	Northing	Easting
3700.00	19.61	176.520	3560.96	859.06S	52.28E	==>	860.65	1360144.89	3260533.81
3800.00	19.61	176.520	3655.16	892.56S	54.32E	==>	894.21	1360111.40	3260535.85
3900.00	19.61	176.520	3749.36	926.06S	56.36E	==>	927.77	1360077.90	3260537.89
4000.00	19.61	176.520	3843.56	959.55S	58.39E	==>	961.33	1360044.41	3260539.93
4100.00	19.61	176.520	3937.76	993.05S	60.43E	==>	994.89	1360010.91	3260541.96
4200.00	19.61	176.520	4031.96	1026.55S	62.47E	==>	1028.44	1359977.42	3260544.00
4300.00	19.61	176.520	4126.17	1060.04S	64.51E	==>	1062.00	1359943.92	3260546.04
4400.00	19.61	176.520	4220.37	1093.54S	66.55E	==>	1095.56	1359910.43	3260548.08
4500.00	19.61	176.520	4314.57	1127.03S	68.59E	==>	1129.12	1359876.93	3260550.12
4600.00	19.61	176.520	4408.77	1160.53S	70.63E	==>	1162.68	1359843.44	3260552.16
4700.00	19.61	176.520	4502.97	1194.03S	72.66E	==>	1196.24	1359809.94	3260554.19
4800.00	19.61	176.520	4597.17	1227.52S	74.70E	==>	1229.79	1359776.45	3260556.23
4900.00	19.61	176.520	4691.37	1261.02S	76.74E	==>	1263.35	1359742.95	3260558.27
5000.00	19.61	176.520	4785.57	1294.52S	78.78E	==>	1296.91	1359709.46	3260560.31
5100.00	19.61	176.520	4879.77	1328.01S	80.82E	==>	1330.47	1359675.96	3260562.35
5200.00	19.61	176.520	4973.97	1361.51S	82.86E	==>	1364.03	1359642.47	3260564.39
5300.00	19.61	176.520	5068.18	1395.01S	84.89E	==>	1397.59	1359608.97	3260566.42
5400.00	19.61	176.520	5162.38	1428.50S	86.93E	==>	1431.15	1359575.48	3260568.46
5500.00	19.61	176.520	5256.58	1462.00S	88.97E	==>	1464.70	1359541.98	3260570.50
5600.00	19.61	176.520	5350.78	1495.50S	91.01E	==>	1498.26	1359508.49	3260572.54
5700.00	19.61	176.520	5444.98	1528.99S	93.05E	==>	1531.82	1359474.99	3260574.58
5800.00	19.61	176.520	5539.18	1562.49S	95.09E	==>	1565.38	1359441.50	3260576.62
5900.00	19.61	176.520	5633.38	1595.98S	97.13E	==>	1598.94	1359408.00	3260578.65
6000.00	19.61	176.520	5727.58	1629.48S	99.16E	==>	1632.50	1359374.51	3260580.69
6100.00	19.61	176.520	5821.78	1662.98S	101.20E	==>	1666.05	1359341.01	3260582.73
6200.00	19.61	176.520	5915.98	1696.47S	103.24E	==>	1699.61	1359307.52	3260584.77
6300.00	19.61	176.520	6010.19	1729.97S	105.28E	==>	1733.17	1359274.02	3260586.81
6400.00	19.61	176.520	6104.39	1763.47S	107.32E	==>	1766.73	1359240.53	3260588.85
6500.00	19.61	176.520	6198.59	1796.96S	109.36E	==>	1800.29	1359207.03	3260590.89
6600.00	19.61	176.520	6292.79	1830.46S	111.39E	==>	1833.85	1359173.54	3260592.92
6700.00	19.61	176.520	6386.99	1863.96S	113.43E	==>	1867.40	1359140.04	3260594.96
6800.00	19.61	176.520	6481.19	1897.45S	115.47E	==>	1900.96	1359106.55	3260597.00
6900.00	19.61	176.520	6575.39	1930.95S	117.51E	==>	1934.52	1359073.05	3260599.04
7000.00	19.61	176.520	6669.59	1964.45S	119.55E	==>	1968.08	1359039.56	3260601.08
7100.00	19.61	176.520	6763.79	1997.94S	121.59E	==>	2001.64	1359006.06	3260603.12
7200.00	19.61	176.520	6857.99	2031.44S	123.63E	==>	2035.20	1358972.57	3260605.15
7300.00	19.61	176.520	6952.20	2064.94S	125.66E	==>	2068.76	1358939.07	3260607.19
7400.00	19.61	176.520	7046.40	2098.43S	127.70E	==>	2102.31	1358905.58	3260609.23
7500.00	19.61	176.520	7140.60	2131.93S	129.74E	==>	2135.87	1358872.08	3260611.27
7600.00	19.61	176.520	7234.80	2165.42S	131.78E	==>	2169.43	1358838.59	3260613.31
7700.00	19.61	176.520	7329.00	2198.92S	133.82E	==>	2202.99	1358805.09	3260615.35
7800.00	19.61	176.520	7423.20	2232.42S	135.86E	==>	2236.55	1358771.60	3260617.38
7900.00	19.61	176.520	7517.40	2265.91S	137.89E	==>	2270.11	1358738.10	3260619.42
8000.00	19.61	176.520	7611.60	2299.41S	139.93E	==>	2303.66	1358704.61	3260621.46
8086.01	19.61	176.520	7692.62	2328.22S	141.69E	==>	2332.53	1358675.80	3260623.21
8186.01	17.61	176.520	7787.39	2360.07S	143.62E	2.00	2364.43	1358643.95	3260625.15
8286.01	15.61	176.520	7883.21	2388.60S	145.36E	2.00	2393.02	1358615.43	3260626.89
8386.01	13.61	176.520	7979.98	2413.77S	146.89E	2.00	2418.23	1358590.25	3260628.42
8486.01	11.61	176.520	8077.56	2435.56S	148.22E	2.00	2440.06	1358568.47	3260629.75
8586.01	9.61	176.520	8175.85	2453.93S	149.34E	2.00	2458.47	1358550.10	3260630.86
8686.01	7.61	176.520	8274.71	2468.87S	150.25E	2.00	2473.44	1358535.16	3260631.77
8786.01	5.61	176.520	8374.04	2480.35S	150.94E	2.00	2484.94	1358523.67	3260632.47
8886.01	3.61	176.520	8473.72	2488.37S	151.43E	2.00	2492.98	1358515.65	3260632.96
8986.01	1.61	176.520	8573.61	2492.91S	151.71E	2.00	2497.53	1358511.11	3260633.24
9066.41	0.00	0.000	8654.00	2494.04S	151.78E	2.00	2498.66	1358509.99	3260633.30
9100.00	0.00	0.000	8687.59	2494.04S	151.78E	==>	2498.66	1358509.99	3260633.30
9200.00	0.00	0.000	8787.59	2494.04S	151.78E	==>	2498.66	1358509.99	3260633.30
9300.00	0.00	0.000	8887.59	2494.04S	151.78E	==>	2498.66	1358509.99	3260633.30
9400.00	0.00	0.000	8987.59	2494.04S	151.78E	==>	2498.66	1358509.99	3260633.30
9500.00	0.00	0.000	9087.59	2494.04S	151.78E	==>	2498.66	1358509.99	3260633.30
9600.00	0.00	0.000	9187.59	2494.04S	151.78E	==>	2498.66	1358509.99	3260633.30

All data is in Feet unless otherwise stated
Coordinates are from Slot MD's are from Rig and TVD's are from Rig (Planned Datum #1 4706.0ft above Mean Sea Level)
Vertical Section is from 0.00N 0.00E on azimuth 176.520 degrees
Bottom hole distance is 2498.66 Feet on azimuth 176.52 degrees from Wellhead
Calculation method uses Minimum Curvature method
Prepared by Integrated Petroleum Technologies, Inc.
Date Printed: 29-Aug-2014



INTEGRATED PETROLEUM TECHNOLOGIES, INC
SYSDRILL
Well Design Combined Report
Wellbore: C-1-C (PWB)

Interpolated Wellpath									
MD[ft]	Inc[deg]	Azi[deg]	TVD[ft]	North[ft]	East[ft]	Dogleg [deg/100ft] ==>	Vertical Section[ft] 2498.66	Northing	Easting
9700.00	0.00	0.000	9287.59	2494.04S	151.78E			1358509.99	3260633.30
9800.00	0.00	0.000	9387.59	2494.04S	151.78E	==>	2498.66	1358509.99	3260633.30
9900.00	0.00	0.000	9487.59	2494.04S	151.78E	==>	2498.66	1358509.99	3260633.30
10000.00	0.00	0.000	9587.59	2494.04S	151.78E	==>	2498.66	1358509.99	3260633.30
10100.00	0.00	0.000	9687.59	2494.04S	151.78E	==>	2498.66	1358509.99	3260633.30
10200.00	0.00	0.000	9787.59	2494.04S	151.78E	==>	2498.66	1358509.99	3260633.30
10300.00	0.00	0.000	9887.59	2494.04S	151.78E	==>	2498.66	1358509.99	3260633.30
10400.00	0.00	0.000	9987.59	2494.04S	151.78E	==>	2498.66	1358509.99	3260633.30
10500.00	0.00	0.000	10087.59	2494.04S	151.78E	==>	2498.66	1358509.99	3260633.30
10600.00	0.00	0.000	10187.59	2494.04S	151.78E	==>	2498.66	1358509.99	3260633.30
10700.00	0.00	0.000	10287.59	2494.04S	151.78E	==>	2498.66	1358509.99	3260633.30
10800.00	0.00	0.000	10387.59	2494.04S	151.78E	==>	2498.66	1358509.99	3260633.30
10900.00	0.00	0.000	10487.59	2494.04S	151.78E	==>	2498.66	1358509.99	3260633.30
11000.00	0.00	0.000	10587.59	2494.04S	151.78E	==>	2498.66	1358509.99	3260633.30
11100.00	0.00	0.000	10687.59	2494.04S	151.78E	==>	2498.66	1358509.99	3260633.30
11100.41	0.00	0.000	10688.00	2494.04S	151.78E	==>	2498.66	1358509.99	3260633.30

All data is in Feet unless otherwise stated
Coordinates are from Slot MD's are from Rig and TVD's are from Rig (Planned Datum #1 4706.0ft above Mean Sea Level)
Vertical Section is from 0.00N 0.00E on azimuth 176.520 degrees
Bottom hole distance is 2498.66 Feet on azimuth 176.52 degrees from Wellhead
Calculation method uses Minimum Curvature method
Prepared by Integrated Petroleum Technologies, Inc.
Date Printed: 29-Aug-2014



INTEGRATED PETROLEUM TECHNOLOGIES, INC
SYSDRILL
Well Design Combined Report
Wellbore: C-1-C (PWB)

Targets								
Name	North[ft]	East[ft]	TVD[ft]	Latitude	Longitude	Northing	Easting	Last Revised
C-1-C - T1	2494.04S	151.78E	8654.00	40.31374000	-104.56536000	1358509.99	3260633.30	2-Jun-2014
C-1-C - T2	2494.04S	151.78E	10688.00	40.31374000	-104.56536000	1358509.99	3260633.30	2-Jun-2014

Formations			
Formation Name	Formation MD	Formation TVD	
Lyons	9266.41	8854.00	
Lower Satanka	9401.41	8989.00	
Wolfcampian	9644.41	9232.00	
Amazon	9728.41	9316.00	
Council Grove	9788.41	9376.00	
Admire	9945.41	9533.00	
Virgilian	9987.41	9575.00	
Missourian	10242.41	9830.00	
Fountain - Desmoinesian	10518.41	10106.00	
Fountain - Atokan	10812.41	10400.00	
Fountain - Morrowan	11012.41	10600.00	

Survey Tool Program					
Reference	Survey Name	MD[ft]	TVD[ft]	Survey Tool	Error Model
302075	Planned	11100.41	10688.00	WdW Rate Gyro	Standard

Notes

SYSDRILL
Minimum Distance Report
Wellbore: C-1-C (PWB)

Ellipse separations are reported ONLY if BOTH wells have uncertainty data
Only Depth and Magnetic Reference Field error terms are correlated across tie points
Proximities beyond 5000.00ft with expansion rate of 0.00ft/1000ft are not reported
Scan limit is calculated on CENTRE to CENTRE distance

Summary data uses Closest Approach clearance calculation for all minima
Hole size/Casings ARE included
Hole size/Casings are NOT subtracted from Centre-Centre distance
Confidence limit of 95.00% / 2.80 SD.

Wellbore		
Name	Created	Last Revised
C-1-C (PWB)	29-Aug-2014	29-Aug-2014

Well		
Name	Government ID	Last Revised
C-1-C		29-Aug-2014

Clearance Summary				
Offset Wellbore	MD[ft]	Separation [ft]	Ellipse Separation [ft]	Clearance Factor
SWD #1-8A (AWB)	1415.40	103.95	91.31	8.12
Conquest SWD 1-8 (AWB)	650.00	182.91	174.62	19.70
SWD #1-8B (AWB)	650.00	186.31	177.62	18.20
Mark Alter #C16-79HN (AWB)	7076.01	228.14	154.78	3.11
Gehring #1 (AWB)	650.00	400.75	393.44	44.88
W CPC-HARLESS #17-1 (AWB)	3764.75	623.46	599.08	24.31
W HARLESS PM C #17-8 (AWB)	7507.73	773.41	732.64	18.95
Alter C #09-33D (AWB)	1377.95	898.74	894.64	88.83
W JOHNSON #9-13 (AWB)	656.17	924.70	917.32	66.58
W FRICK PC C #17-65HN (AWB)	7490.39	1206.66	1015.44	6.20
W MORIAH #17-15 (AWB)	6463.25	1229.12	1191.58	30.75
W OCOMA #C17-9 (AWB)	7868.70	1578.65	1544.59	46.22
Gehring #8-1514 (AWB)	656.17	1589.33	1581.59	90.95
W CPC-HARLESS #17-2 (AWB)	7480.31	1750.17	1708.19	41.51
W HARLESS PM C #17-2 (AWB)	4400.00	1851.45	1823.78	53.08
Franklin #C17-69HN (AWB)	6514.15	1930.28	1788.17	13.16
W Franklin #C17-69HN (AWB)	6600.81	1957.40	1812.54	13.11
W OCOMA C #17-23 (AWB)	8045.82	2328.58	2292.26	63.81
Franklin #C08-62HNZ (AWB)	6271.47	2379.62	2228.36	15.26
W OCOMA C #17-10 (AWB)	7965.94	2414.96	2374.63	59.42
Franklin #C08-62HNZ ST (AWB)	6324.75	2448.62	2295.40	15.52
W Franklin #C08-62HNX (AWB)	6414.04	2477.36	2321.84	15.48
W OCOMA #C17-16 (AWB)	8235.27	2749.80	2717.29	84.34
Northrup C #08-73HN (AWB)	6153.85	2952.87	2912.23	69.81
Northrup C #08-75HN (AWB)	6118.77	3726.96	3641.90	43.55
W FRICK C #17-79HN (AWB)	6727.03	5021.02	4954.28	74.62



SYSDRILL
Closest Approach + Clearance Factor Summary Report
Wellbore: C-1-C (PWB)

Ellipse separations are reported ONLY if BOTH wells have uncertainty data
Only Depth and Magnetic Reference Field error terms are correlated across tie points
Proximities beyond 2500.00ft with expansion rate of 0.00ft/1000ft are not reported
Scan limit is calculated on CENTRE to CENTRE distance

Summary data uses Closest Approach clearance calculation for all minima
Hole size/Casings ARE included
Hole size/Casings are NOT subtracted from Centre-Centre distance
Confidence limit of 95.00% / 2.80 SD.

Wellbore			
Name		Created	Last Revised
C-1-C (PWB)		29-Aug-2014	29-Aug-2014

Well			
Name		Government ID	Last Revised
C-1-C			29-Aug-2014

Slot						
Name	Grid Northing	Grid Easting	Latitude	Longitude	North	East
C-1-C	1361003.9166	3260481.5340	40.32059000	-104.56581000	0.00N	0.00E

Installation					
Name	Easting	Northing	Coord System Name	North Alignment	
C1C	3260481.5340	1361003.9166	CO83-NF on NORTH AMERICAN DATUM 1983 datum	Grid	

Field					
Name	Easting	Northing	Coord System Name	North Alignment	
Wattenberg	3224065.1116	1343637.7116	CO83-NF on NORTH AMERICAN DATUM 1983 datum	Grid	

Clearance Summary								
Offset WellName	Offset Wellbore	Separation [ft]	MD[ft]	Diverging From[ft]	Ellipse Separation [ft]	Ellipse MD[ft]	Clearance Factor	Clearance MD[ft]
SWD #1-8A	SWD #1-8A (AWB)	103.95	1415.40	9416.01	91.31	1427.17	8.12	1476.38
Conquest SWD 1-8	Conquest SWD 1-8 (AWB)	182.91	650.00	650.00	174.62	672.57	19.70	967.85
SWD #1-8B	SWD #1-8B (AWB)	186.31	650.00	650.00	177.62	688.98	18.20	1115.49
Mark Alter #C16-79HN	Mark Alter #C16-79HN (AWB)	228.14	7076.01	7076.01	154.78	7076.01	3.11	7076.01
Gehring #1	Gehring #1 (AWB)	400.75	650.00	650.00	393.44	672.57	44.88	1230.31
W CPC-HARLES S #17-1	W CPC-HARLESS #17-1 (AWB)	623.46	3764.75	3764.75	599.08	3789.37	24.31	4297.90
W HARLESS PM C #17-8	W HARLESS PM C #17-8 (AWB)	773.41	7507.73	7507.73	732.64	7513.12	18.95	7545.93
Alter C #09-33D	Alter C #09-33D (AWB)	898.74	1377.95	1377.95	894.64	1394.36	88.83	3690.94
W JOHNSON #9-13	W JOHNSON #9-13 (AWB)	924.70	656.17	656.17	917.32	705.38	66.58	3264.44
W FRICK PC C #17-65HN	W FRICK PC C #17-65HN (AWB)	1206.66	7490.39	7490.39	1015.44	7431.10	6.20	7300.00
W MORIAH #17-15	W MORIAH #17-15 (AWB)	1229.12	6463.25	6463.25	1191.58	6512.47	30.75	7496.72
W OCOMA	W OCOMA	1578.65	7868.70	7868.70	1544.59	7874.02	46.22	7972.44

All data is in Feet unless otherwise stated
Coordinates are from Slot MD's are from Rig and TVD's are from Rig (Planned Datum #1 4706.0ft above Mean Sea Level)
Vertical Section is from 0.00N 0.00E on azimuth 176.520 degrees
Prepared by Integrated Petroleum Technologies, Inc.
Date Printed: 29-Aug-2014



SYSDRILL
Closest Approach + Clearance Factor Summary Report
Wellbore: C-1-C (PWB)

Clearance Summary								
Offset WellName	Offset Wellbore	Separation [ft]	MD[ft]	Diverging From[ft]	Ellipse Separation [ft]	Ellipse MD[ft]	Clearance Factor	Clearance MD[ft]
#C17-9	#C17-9 (AWB)							
Gehring #8-1514	Gehring #8-1514 (AWB)	1589.33	656.17	656.17	1581.59	688.98	91.04	5183.73
W CPC-HARLESS #17-2	W CPC-HARLESS #17-2 (AWB)	1750.17	7480.31	7480.31	1708.19	7480.31	41.51	7611.55
W HARLESS PM C #17-2	W HARLESS PM C #17-2 (AWB)	1851.45	4400.00	4400.00	1823.78	4478.35	53.08	7480.31
Franklin #C17-69HN	Franklin #C17-69HN (AWB)	1930.28	6514.15	6514.15	1788.17	6561.68	13.16	6889.76
W Franklin #C17-69HN	W Franklin #C17-69HN (AWB)	1957.40	6600.81	6600.81	1812.54	6643.70	13.11	6971.78
W OCOMA C #17-23	W OCOMA C #17-23 (AWB)	2328.58	8045.82	8045.82	2292.26	8054.46	63.81	8186.01
Franklin #C08-62HNZ	Franklin #C08-62HNZ (AWB)	2379.62	6271.47	6271.47	2228.36	6332.02	15.26	6725.72
W OCOMA C #17-10	W OCOMA C #17-10 (AWB)	2414.96	7965.94	7965.94	2374.63	7972.44	59.42	8185.70
Franklin #C08-62HNZ ST	Franklin #C08-62HNZ ST (AWB)	2448.62	6324.75	6324.75	2295.40	6381.23	15.52	6774.93
W Franklin #C08-62HNX	W Franklin #C08-62HNX (AWB)	2477.36	6414.04	6414.04	2321.84	6463.25	15.48	6873.36