

K:\BONANZA CREEK\2013_04_2014_WELL_STAKING\GIS\Maps_ABC\NorthPlatte A-33\NorthPlatte A-33 Access.mxd 9/4/2014 6:02:42 PM

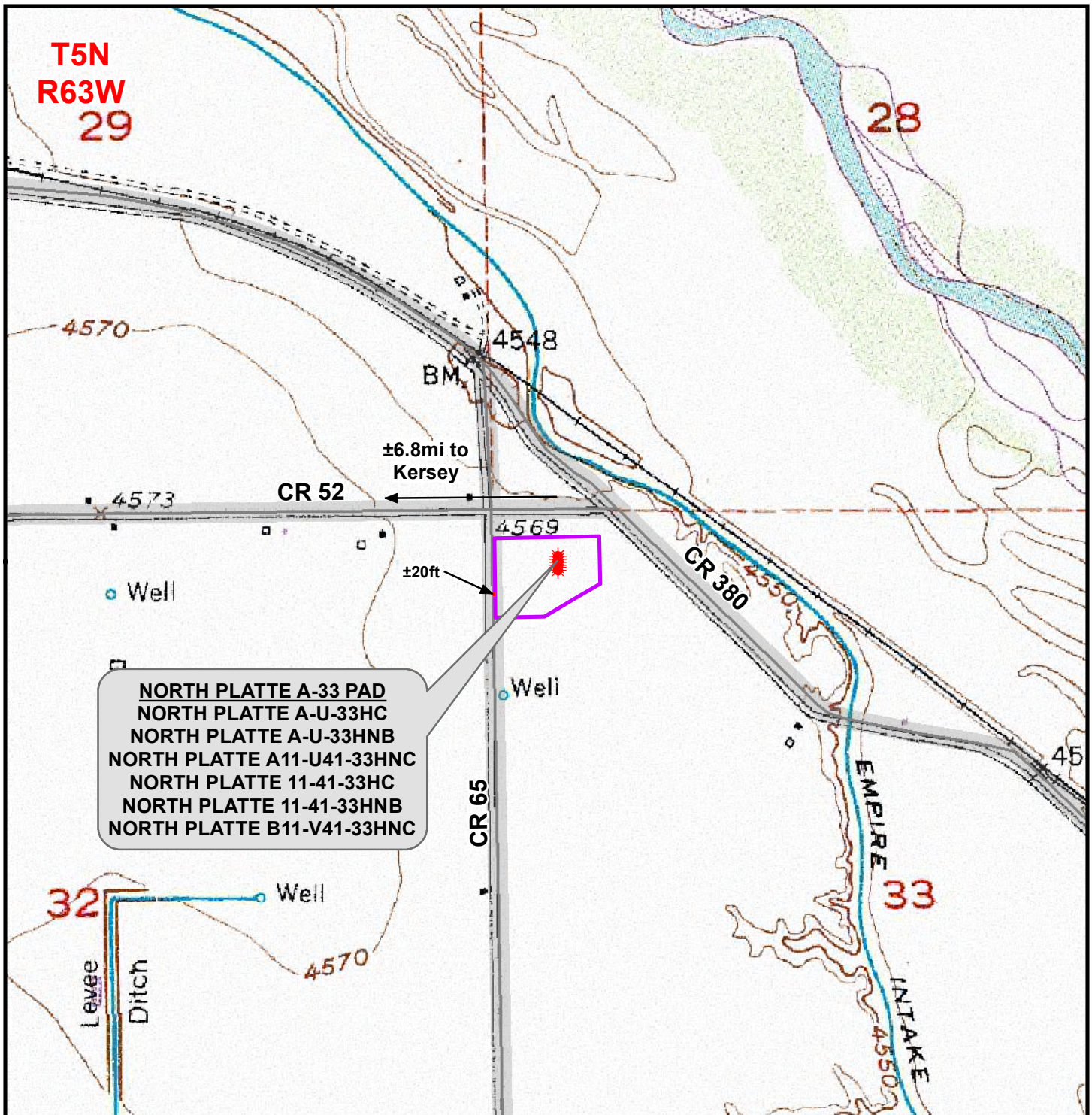

Legend

- ★ Well - Fee - Proposed Access Road === Road - Primitive - Existing ——— Road - County - Existing
□ Disturbance Area ——— Road - Improved - Existing ——— Road - Highway - Existing

WELL PAD - NORTH PLATTE A-33

ACCESS ROAD MAP
NORTH PLATTE A-U-33HC, NORTH PLATTE A-U-33HNB
NORTH PLATTE A11-U41-33HNC, NORTH PLATTE 11-41-33HC
NORTH PLATTE 11-41-33HNB & NORTH PLATTE B11-V41-33HNC
LOCATED IN NW1/4 NW1/4
SECTION 33, T5N, R63W, 6th P.M.
WELD COUNTY, COLORADO



410 17th Street, Suite 1400
Denver, Colorado 80202



CONSULTING, LLC

SHERIDAN OFFICE 2155 North Main Street
Sheridan, Wyoming 82801
Phone 307-674-0609
LOVELAND OFFICE 1635 Foxtail Drive, Suite 204
Loveland, Colorado 80538
Phone 970-776-4331



SCALE: 1" = 1,000ft

NAD83 CO-Nft

DRAWN: JELO

DATE: 8 Nov 2013

REVISED: JELO

DATE: 5 Sept 2014



PHOTOGRAPH OF NORTH PLATTE A-33 PROPOSED ACCESS ROAD - CAMERA ANGLE NORTH



PHOTOGRAPH OF NORTH PLATTE A-33 PROPOSED ACCESS ROAD - CAMERA ANGLE EAST

WELL PAD - NORTH PLATTE A-33

PROPOSED ACCESS ROAD PHOTOGRAPHS
 NORTH PLATTE A-U-33HC, NORTH PLATTE A-U-33HNB,
 NORTH PLATTE A11-U41-33HNC, NORTH PLATTE 11-41-33HC,
 NORTH PLATTE 11-41-33HNB & NORTH PLATTE B11-V41-33HNC
 LOCATED IN SECTION 33, T5N, R63W, 6TH P.M.
 WELD COUNTY, COLORADO

 **BONANZA
CREEK**
 410 17th Street, Suite 1400
 Denver, Colorado 80202



CONSULTING, LLC

SHERIDAN OFFICE
 2155 North Main Street
 Sheridan, Wyoming 82801
 Phone 307-674-0609

LOVELAND OFFICE
 1635 Foxtrail Drive, Suite 204
 Loveland, Colorado 80538
 Phone 970-776-4331

SCALE: NTS	DATE: 11/8/13
REVISED:	BJB 4/17/14

SHEET NO:
1
1 OF 2



PHOTOGRAPH OF NORTH PLATTE A-33 PROPOSED ACCESS ROAD - CAMERA ANGLE SOUTH



PHOTOGRAPH OF NORTH PLATTE A-33 PROPOSED ACCESS ROAD - CAMERA ANGLE WEST

WELL PAD - NORTH PLATTE A-33

PROPOSED ACCESS ROAD PHOTOGRAPHS
 NORTH PLATTE A-U-33HC, NORTH PLATTE A-U-33HNB,
 NORTH PLATTE A11-U41-33HNC, NORTH PLATTE 11-41-33HC,
 NORTH PLATTE 11-41-33HNB & NORTH PLATTE B11-V41-33HNC
 LOCATED IN SECTION 33, T5N, R63W, 6TH P.M.
 WELD COUNTY, COLORADO

 **BONANZA
CREEK**
 410 17th Street, Suite 1400
 Denver, Colorado 80202



CONSULTING, LLC

SHERIDAN OFFICE
 2155 North Main Street
 Sheridan, Wyoming 82801
 Phone 307-674-0609

LOVELAND OFFICE
 1635 Foxtrail Drive, Suite 204
 Loveland, Colorado 80538
 Phone 970-776-4331

SCALE: NTS	DATE: 11/8/13
REVISED:	BJB 4/17/14

SHEET NO:
2
2 OF 2