



Mr. Matt Lepore  
Colorado Oil & Gas Conservation Commission  
1120 Lincoln Street, Suite 801  
Denver, CO 80203

August 26, 2014

RE: Application for Permit to Drill: Proposed Spacing Unit  
Ward Petroleum Corporation  
**Todd Creek Farms 14-4-1HC**  
SHL: 1,587' FNL 353' FWL (SW/4 NW/4)  
TOP: 0' FNL 460' FWL (NW/4 NW/4)  
BHL:  $\pm 0'$  FNL  $\pm 460'$  FEL (NE/4 NE/4)  
Sec. 14 T1S R67W  
Adams County, Colorado  
Surface: Fee  
Mineral Lease: Fee

Dear Mr. Lepore:

Ward Petroleum Corporation (Ward) intends to permit, drill and operate the above referenced Codell formation Horizontal Well. As defined by Colorado Oil and Gas Conservation Commission (COGCC) Rule 318A.a.(4)D., Ward proposed the following wellbore spacing unit:

N2/N2 of Sec. 14; S2S2 of Sec. 11 T1S R67W – 320 acres.

Ward has notified the other owners in the unit and no objections were received. Copies of the notifications are maintained in the Ward's files.

Please review the attached Proposed Spacing Unit Map.

Please send a copy of all correspondence to Upstream Petroleum Management, Inc. at 7000 S. Yosemite St., Suite 290B, Englewood, CO 80112. Please contact me at 303-942-0506 or at [agross@upstreampm.com](mailto:agross@upstreampm.com) if you have any questions.

Sincerely,

Andrea J. Gross  
Permit Agent for Ward Petroleum Corporation

AJG:ajg

**Your Assets / Our Expertise**

- Regulatory
- Storm-water Management Plans
- Project Coordination
- Permitting
- Government Relations
- EA/EIS Assistance

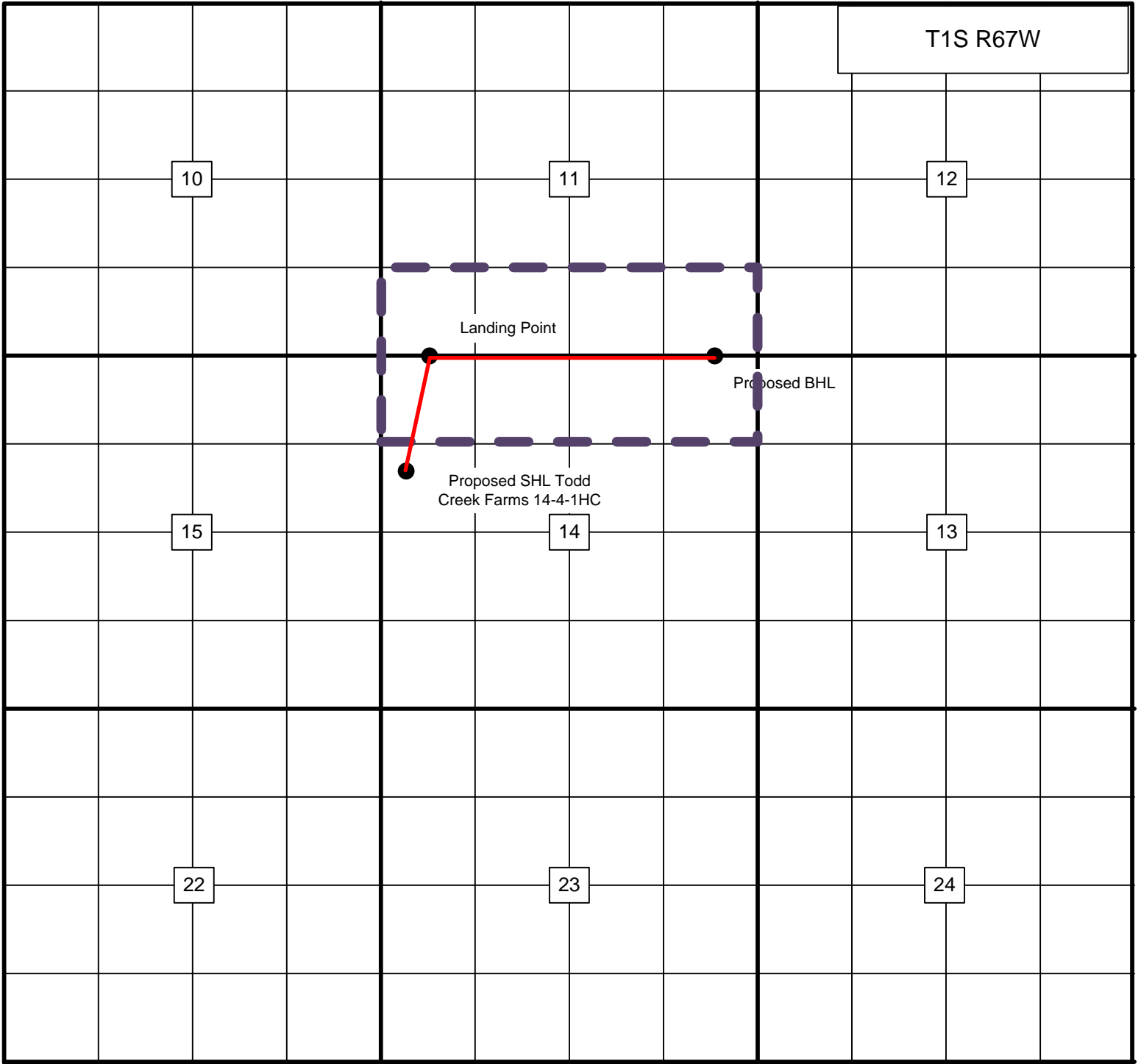

Ward Petroleum Corporation  
**Todd Creek Farms 14-4-1HC**  
SHL: 1,587' FNL 353' FWL (SW/4 NW/4)  
TOP: 0' FNL 460' FWL (NW/4 NW/4)  
BHL:  $\pm 0'$  FNL  $\pm 460'$  FEL (NE/4 NE/4)  
Sec. 14 T1S R67W  
Adams County, Colorado  
Surface: Fee  
Mineral Lease: Fee



**Proposed Wellbore Spacing Unit Outline**