

# NARRATIVE ATTACHMENT

## FORM 4 (SUNDRY NOTICE)

---

### Earthen Pit (Steel Tank) Closure (Cathedral Federal Unit #27-1)

---

Document Date-8/6/2014

---

#### Introduction

Encana Oil & Gas (USA) Inc. (Encana) is submitting this Form 4 Sundry Notice to request final closure status for the earthen pit associated with the Cathedral Federal Unit #27-1 (COGCC facility #314987, COGCC remediation #8467). The site investigation was conducted by a third party contractor as authorized by Encana personnel and in accordance with the approved Form 27 previously submitted for this location. All samples were collected in accordance with Encana's Environmental Compliance Group's Sampling Procedures. The analytical results for the respective soil samples are provided in Table 1 and Attachment A of this submittal. The text below provides the details of the site investigation. For a visual description of the site please refer to Figures 1, 2, and 3 – Site Maps.

#### Assessment Activities

June 10, 2014 - The excavated soil surrounding the earthen pit was screened utilizing a photoionization detector (PID) prior to collecting soil samples for laboratory analysis. The steel tank was carefully removed using a trackhoe and placed onsite for later recycling or disposal. It should be noted that the steel tank was pumped out prior to removal. grab sample was collected directly from the lowest point of the pit after excavation. In addition, four (4) grab samples were collected, one from each excavated sidewall. Approximately 47 cubic yards of excavated material was removed from the pit and laid out in 2 foot tall (45' x 12') lift for evaluation of impacts. The excavated material was sampled by way of a nine (9) point composite sample. Four (4) background samples were collected from approximately six (6) inches beneath the grounds surface for analysis with regards to arsenic.

#### Analytical Review

Sample results indicate that soil within the earthen pit (w/steel tank) footprint on Encana's Cathedral Federal Unit #27-1 well pad, had organic constituent concentrations of the excavated area below or within COGCC Table 910-1 except for benzene collected from the base of the pit. Analytical results indicated the excavated material exceeded COGCC Table 910-1 allowable concentrations for arsenic (4.9 ppm) and Total Petroleum Hydrocarbons (TPH) (880 ppm). Though the arsenic concentration in the soil is above the allowable concentration identified in Table 910-1, the concentration is close to the range of arsenic background values (Non Detect – 2.0 ppm) in this area. Based on these results and footnote 1 to COGCC Table 910-1, Encana requests that the COGCC consider the higher range of background arsenic value(s) as the allowable concentration for this constituent. Please see Table 1 and Attachment A for the analytical results.

Though the elevated arsenic level of the returned spoil material within the excavated footprint area is above the allowable levels identified in Table 910-1; it will be buried greater than three feet bgs of existing pad footprint material to assure that material with elevated level of arsenic will have no adverse effect on future re-vegetation efforts and receptors in the area. Please see Table 1 and Attachment A for analytical results.



# NARRATIVE ATTACHMENT

## FORM 4 (SUNDRY NOTICE)

---

### Earthen Pit (Steel Tank) Closure (Cathedral Federal Unit #27-1)

---

Document Date-8/6/2014

---

The excavated material that exceeded COGCC Table 910-1 allowable concentration for TPH was landfarmed and amended with water, fertilizer, and turned. The excavated material was re-sampled July 23, 2014 and the results are below or within allowable COGCC Table 910-1 concentrations. The sample collected from the base of the excavated pit that exceeded the allowable limit for benzene was also resampled at this time and the result was within allowable COGCC Table 910-1 concentrations.

#### **Conclusion**

Based on the site investigation and analytical results, the earthen pit associated with the Cathedral Federal Unit #27-1 is in compliance with the standards specified within COGCC Table 910-1. Encana respectfully requests that final closure be granted for the respective pit, COGCC remediation #8467.

#### **Notification of Completion**

This Sundry Notice is also being submitted as the Notification of Completion for Remediation #8467. If the information provided here is satisfactory, please provide documentation of the closure of this remediation project.

#### **Attachments**

Topographic Location Map (Figure 1)  
27-1 Aerial map with sample locations (Figure 2)  
27-1 Site Diagram of Excavation and sample locations (Figure 3)  
Laboratory Results Summary Table 1 – 27-1 Site Investigation (Table 1)  
Attachment A- Laboratory Reports



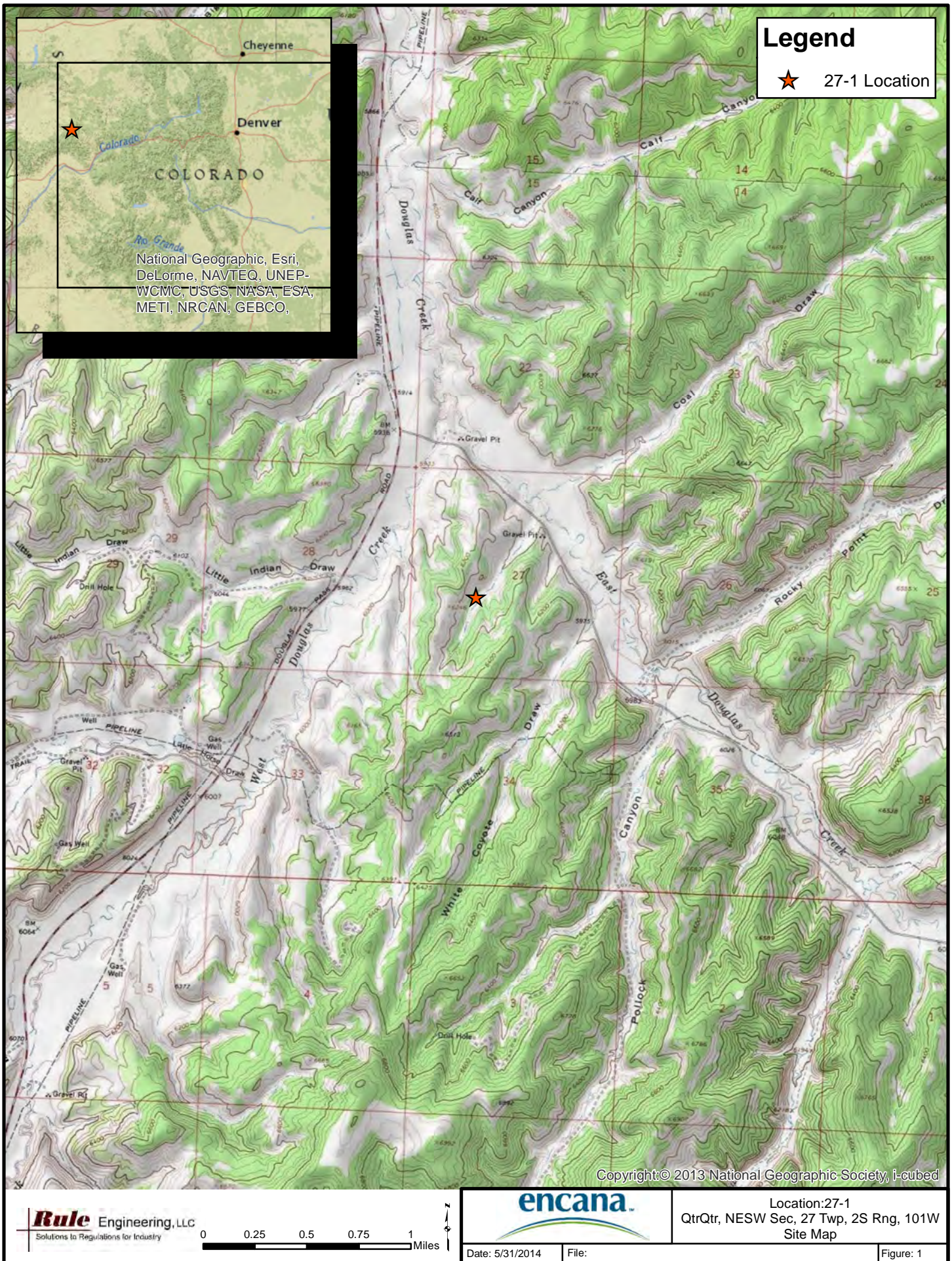

**Legend**

★ 27-1 Location

National Geographic, Esri,  
DeLorme, NAVTEQ, UNEP-  
WCMC, USGS, NASA, ESA,  
METI, NRCAN, GEBCO,

Copyright: © 2013 National Geographic Society, i-cubed

**Rule Engineering, LLC**  
Solutions to Regulations for Industry

0 0.25 0.5 0.75 1 Miles



Location: 27-1  
QtrQtr, NESW Sec, 27 Twp, 2S Rng, 101W  
Site Map

Date: 5/31/2014

File:

Figure: 1



## Legend

★ Soil Sample Location

0 37.5 75 150 225 Feet



**Rule** Engineering, LLC  
Solutions to Regulations for Industry



**27-1**  
**Sample Location Map**

DATE: 7/30/2014 JG FILE:

FIGURE: 2

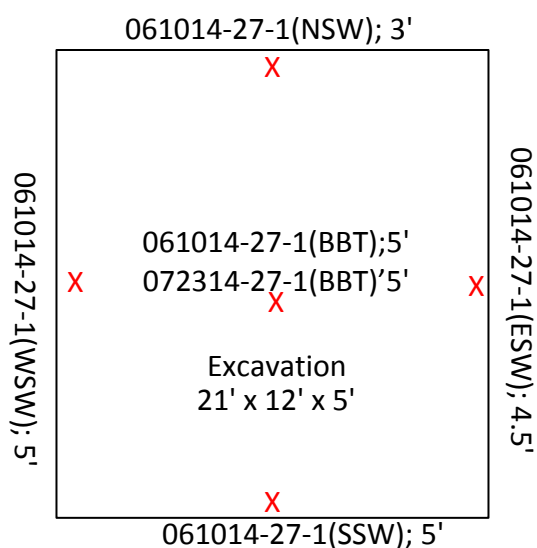
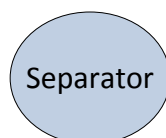
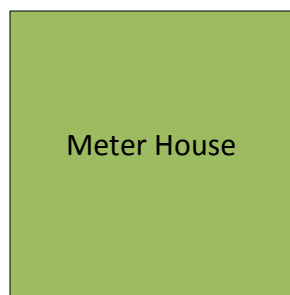

Direction of  
Flow

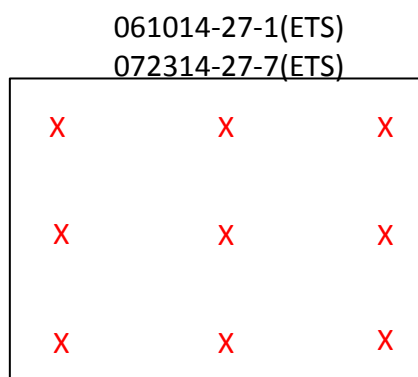

Lift  
45' x 12' x 2'



Legend  
X-Sample



Well: Figure 3. 27-1 Site Diagram

Area: Cathedral Federal Unit

Legal: NESW, Sec 27, 02S, 101W, 6<sup>th</sup> PM

Date: 07/23/14

Drawn By: Shad Johnson

Revision Date:

Scale: None



# **APPENDIX A**



12065 Lebanon Rd.  
Mt. Juliet, TN 37122  
(615) 758-5858  
1-800-767-5859  
Fax (615) 758-5859

Tax I.D. 62-0814289

Est. 1970

Charles Jensen  
EnCana Oil & Gas - Rangely, CO  
1125 Escalante Drive  
Rangely, CO 81648-3600

## Report Summary

Wednesday June 18, 2014

Report Number: L704024

Samples Received: 06/11/14

Client Project: 27-1

Description: 27-1 Site Clearance

The analytical results in this report are based upon information supplied by you, the client, and are for your exclusive use. If you have any questions regarding this data package, please do not hesitate to call.

Entire Report Reviewed By:

  
Jared Willis, ESC Representative

### Laboratory Certification Numbers

A2LA - 1461-01, AIHA - 100789, AL - 40660, CA - 01157CA, CT - PH-0197,  
FL - E87487, GA - 923, IN - C-IN-01, KY - 90010, KYUST - 0016,  
NC - ENV375/DW21704/BIO041, ND - R-140, NJ - TN002, NJ NELAP - TN002,  
SC - 84004, TN - 2006, VA - 460132, WV - 233, AZ - 0612,  
MN - 047-999-395, NY - 11742, WI - 998093910, NV - TN000032011-1,  
TX - T104704245-11-3, OK - 9915, PA - 68-02979, IA Lab #364, EPA - TN002

Accreditation is only applicable to the test methods specified on each scope of accreditation held by ESC Lab Sciences.

This report may not be reproduced, except in full, without written approval from ESC Lab Sciences. Where applicable, sampling conducted by ESC is performed per guidance provided in laboratory standard operating procedures: 060302, 060303, and 060304.



12065 Lebanon Rd.  
Mt. Juliet, TN 37122  
(615) 758-5858  
1-800-767-5859  
Fax (615) 758-5859

Tax I.D. 62-0814289

Est. 1970

# REPORT OF ANALYSIS

Charles Jensen  
EnCana Oil & Gas - Rangely, CO  
1125 Escalante Drive  
Rangely, CO 81648-3600

June 18, 2014

Date Received : June 11, 2014  
Description : 27-1 Site Clearance  
Sample ID : 061014-27-1 (NSW) 3 FT  
Collected By : Shad Johnson  
Collection Date : 06/10/14 11:00

ESC Sample # : L704024-01

Site ID : 27-1

Project # : 27-1

| Parameter                   | Result | Det. Limit | Units  | Method    | Date     | Dil. |
|-----------------------------|--------|------------|--------|-----------|----------|------|
| Benzene                     | BDL    | 0.0025     | mg/kg  | 8021/8015 | 06/12/14 | 5    |
| Toluene                     | BDL    | 0.025      | mg/kg  | 8021/8015 | 06/12/14 | 5    |
| Ethylbenzene                | BDL    | 0.0025     | mg/kg  | 8021/8015 | 06/12/14 | 5    |
| Total Xylene                | BDL    | 0.0075     | mg/kg  | 8021/8015 | 06/12/14 | 5    |
| TPH (GC/FID) Low Fraction   | BDL    | 0.50       | mg/kg  | GRO       | 06/12/14 | 5    |
| Surrogate Recovery-%        |        |            |        |           |          |      |
| a,a,a-Trifluorotoluene(FID) | 98.4   |            | % Rec. | 8021/8015 | 06/12/14 | 5    |
| a,a,a-Trifluorotoluene(PID) | 98.8   |            | % Rec. | 8021/8015 | 06/12/14 | 5    |
| TPH (GC/FID) High Fraction  | BDL    | 4.0        | mg/kg  | 3546/DRO  | 06/17/14 | 1    |
| Surrogate recovery(%)       |        |            |        |           |          |      |
| o-Terphenyl                 | 72.1   |            | % Rec. | 3546/DRO  | 06/17/14 | 1    |

BDL - Below Detection Limit

Det. Limit - Practical Quantitation Limit(PQL)

Note:

The reported analytical results relate only to the sample submitted.

This report shall not be reproduced, except in full, without the written approval from ESC.

Reported: 06/18/14 12:46 Printed: 06/18/14 12:47



12065 Lebanon Rd.  
Mt. Juliet, TN 37122  
(615) 758-5858  
1-800-767-5859  
Fax (615) 758-5859

Tax I.D. 62-0814289

Est. 1970

# REPORT OF ANALYSIS

Charles Jensen  
EnCana Oil & Gas - Rangely, CO  
1125 Escalante Drive  
Rangely, CO 81648-3600

June 18, 2014

Date Received : June 11, 2014  
Description : 27-1 Site Clearance  
Sample ID : 061014-27-1 (ESW) 4.5 FT  
Collected By : Shad Johnson  
Collection Date : 06/10/14 11:15

ESC Sample # : L704024-02

Site ID : 27-1

Project # : 27-1

| Parameter                   | Result | Det. Limit | Units  | Method    | Date     | Dil. |
|-----------------------------|--------|------------|--------|-----------|----------|------|
| Benzene                     | BDL    | 0.0025     | mg/kg  | 8021/8015 | 06/12/14 | 5    |
| Toluene                     | BDL    | 0.025      | mg/kg  | 8021/8015 | 06/12/14 | 5    |
| Ethylbenzene                | BDL    | 0.0025     | mg/kg  | 8021/8015 | 06/12/14 | 5    |
| Total Xylene                | BDL    | 0.0075     | mg/kg  | 8021/8015 | 06/12/14 | 5    |
| TPH (GC/FID) Low Fraction   | BDL    | 0.50       | mg/kg  | GRO       | 06/12/14 | 5    |
| Surrogate Recovery-%        |        |            |        |           |          |      |
| a,a,a-Trifluorotoluene(FID) | 98.3   |            | % Rec. | 8021/8015 | 06/12/14 | 5    |
| a,a,a-Trifluorotoluene(PID) | 98.8   |            | % Rec. | 8021/8015 | 06/12/14 | 5    |
| TPH (GC/FID) High Fraction  | BDL    | 4.0        | mg/kg  | 3546/DRO  | 06/17/14 | 1    |
| Surrogate recovery(%)       |        |            |        |           |          |      |
| o-Terphenyl                 | 73.1   |            | % Rec. | 3546/DRO  | 06/17/14 | 1    |

BDL - Below Detection Limit

Det. Limit - Practical Quantitation Limit(PQL)

Note:

The reported analytical results relate only to the sample submitted.

This report shall not be reproduced, except in full, without the written approval from ESC.

Reported: 06/18/14 12:46 Printed: 06/18/14 12:47



12065 Lebanon Rd.  
Mt. Juliet, TN 37122  
(615) 758-5858  
1-800-767-5859  
Fax (615) 758-5859

Tax I.D. 62-0814289

Est. 1970

REPORT OF ANALYSIS

Charles Jensen  
EnCana Oil & Gas - Rangely, CO  
1125 Escalante Drive  
Rangely, CO 81648-3600

June 18, 2014

Date Received : June 11, 2014  
Description : 27-1 Site Clearance  
Sample ID : 061014-27-1 (SSW) 5 FT  
Collected By : Shad Johnson  
Collection Date : 06/10/14 10:45

ESC Sample # : L704024-03

Site ID : 27-1

Project # : 27-1

| Parameter                   | Result | Det. Limit | Units  | Method    | Date     | Dil. |
|-----------------------------|--------|------------|--------|-----------|----------|------|
| Benzene                     | BDL    | 0.0025     | mg/kg  | 8021/8015 | 06/12/14 | 5    |
| Toluene                     | BDL    | 0.025      | mg/kg  | 8021/8015 | 06/12/14 | 5    |
| Ethylbenzene                | BDL    | 0.0025     | mg/kg  | 8021/8015 | 06/12/14 | 5    |
| Total Xylene                | BDL    | 0.0075     | mg/kg  | 8021/8015 | 06/12/14 | 5    |
| TPH (GC/FID) Low Fraction   | BDL    | 0.50       | mg/kg  | GRO       | 06/12/14 | 5    |
| Surrogate Recovery-%        |        |            |        |           |          |      |
| a,a,a-Trifluorotoluene(FID) | 99.0   |            | % Rec. | 8021/8015 | 06/12/14 | 5    |
| a,a,a-Trifluorotoluene(PID) | 99.4   |            | % Rec. | 8021/8015 | 06/12/14 | 5    |
| TPH (GC/FID) High Fraction  | BDL    | 4.0        | mg/kg  | 3546/DRO  | 06/17/14 | 1    |
| Surrogate recovery(%)       |        |            |        |           |          |      |
| o-Terphenyl                 | 79.9   |            | % Rec. | 3546/DRO  | 06/17/14 | 1    |

BDL - Below Detection Limit

Det. Limit - Practical Quantitation Limit(PQL)

Note:

The reported analytical results relate only to the sample submitted.

This report shall not be reproduced, except in full, without the written approval from ESC.

Reported: 06/18/14 12:46 Printed: 06/18/14 12:47



12065 Lebanon Rd.  
Mt. Juliet, TN 37122  
(615) 758-5858  
1-800-767-5859  
Fax (615) 758-5859

Tax I.D. 62-0814289

Est. 1970

REPORT OF ANALYSIS

Charles Jensen  
EnCana Oil & Gas - Rangely, CO  
1125 Escalante Drive  
Rangely, CO 81648-3600

June 18, 2014

Date Received : June 11, 2014  
Description : 27-1 Site Clearance  
Sample ID : 061014-27-1 (WSW) 5 FT  
Collected By : Shad Johnson  
Collection Date : 06/10/14 11:25

ESC Sample # : L704024-04

Site ID : 27-1

Project # : 27-1

| Parameter                   | Result | Det. Limit | Units  | Method    | Date     | Dil. |
|-----------------------------|--------|------------|--------|-----------|----------|------|
| Benzene                     | BDL    | 0.0025     | mg/kg  | 8021/8015 | 06/12/14 | 5    |
| Toluene                     | BDL    | 0.025      | mg/kg  | 8021/8015 | 06/12/14 | 5    |
| Ethylbenzene                | BDL    | 0.0025     | mg/kg  | 8021/8015 | 06/12/14 | 5    |
| Total Xylene                | BDL    | 0.0075     | mg/kg  | 8021/8015 | 06/12/14 | 5    |
| TPH (GC/FID) Low Fraction   | BDL    | 0.50       | mg/kg  | GRO       | 06/12/14 | 5    |
| Surrogate Recovery-%        |        |            |        |           |          |      |
| a,a,a-Trifluorotoluene(FID) | 98.9   |            | % Rec. | 8021/8015 | 06/12/14 | 5    |
| a,a,a-Trifluorotoluene(PID) | 99.5   |            | % Rec. | 8021/8015 | 06/12/14 | 5    |
| TPH (GC/FID) High Fraction  | BDL    | 4.0        | mg/kg  | 3546/DRO  | 06/17/14 | 1    |
| Surrogate recovery(%)       |        |            |        |           |          |      |
| o-Terphenyl                 | 64.3   |            | % Rec. | 3546/DRO  | 06/17/14 | 1    |

BDL - Below Detection Limit

Det. Limit - Practical Quantitation Limit(PQL)

Note:

The reported analytical results relate only to the sample submitted.

This report shall not be reproduced, except in full, without the written approval from ESC.

Reported: 06/18/14 12:46 Printed: 06/18/14 12:47



12065 Lebanon Rd.  
Mt. Juliet, TN 37122  
(615) 758-5858  
1-800-767-5859  
Fax (615) 758-5859

Tax I.D. 62-0814289

Est. 1970

REPORT OF ANALYSIS

Charles Jensen  
EnCana Oil & Gas - Rangely, CO  
1125 Escalante Drive  
Rangely, CO 81648-3600

June 18, 2014

Date Received : June 11, 2014  
Description : 27-1 Site Clearance  
Sample ID : 061014-27-1 (BBT) 5 FT  
Collected By : Shad Johnson  
Collection Date : 06/10/14 11:45

ESC Sample # : L704024-05

Site ID : 27-1

Project # : 27-1

| Parameter                   | Result | Det. Limit | Units  | Method    | Date     | Dil. |
|-----------------------------|--------|------------|--------|-----------|----------|------|
| Benzene                     | 2.2    | 0.12       | mg/kg  | 8021/8015 | 06/12/14 | 250  |
| Toluene                     | 2.0    | 1.2        | mg/kg  | 8021/8015 | 06/12/14 | 250  |
| Ethylbenzene                | 2.5    | 0.12       | mg/kg  | 8021/8015 | 06/12/14 | 250  |
| Total Xylene                | 8.4    | 0.38       | mg/kg  | 8021/8015 | 06/12/14 | 250  |
| TPH (GC/FID) Low Fraction   | 270    | 25.        | mg/kg  | GRO       | 06/12/14 | 250  |
| Surrogate Recovery-%        |        |            |        |           |          |      |
| a,a,a-Trifluorotoluene(FID) | 99.2   |            | % Rec. | 8021/8015 | 06/12/14 | 250  |
| a,a,a-Trifluorotoluene(PID) | 100.   |            | % Rec. | 8021/8015 | 06/12/14 | 250  |
| TPH (GC/FID) High Fraction  | 32.    | 4.0        | mg/kg  | 3546/DRO  | 06/17/14 | 1    |
| Surrogate recovery(%)       |        |            |        |           |          |      |
| o-Terphenyl                 | 77.0   |            | % Rec. | 3546/DRO  | 06/17/14 | 1    |

BDL - Below Detection Limit

Det. Limit - Practical Quantitation Limit(PQL)

Note:

The reported analytical results relate only to the sample submitted.

This report shall not be reproduced, except in full, without the written approval from ESC.

Reported: 06/18/14 12:46 Printed: 06/18/14 12:47



12065 Lebanon Rd.  
Mt. Juliet, TN 37122  
(615) 758-5858  
1-800-767-5859  
Fax (615) 758-5859

Tax I.D. 62-0814289

Est. 1970

# REPORT OF ANALYSIS

Charles Jensen  
EnCana Oil & Gas - Rangely, CO  
1125 Escalante Drive  
Rangely, CO 81648-3600

June 18, 2014

Date Received : June 11, 2014  
Description : 27-1 Site Clearance  
Sample ID : 061014-27-1 (ETS) 3-9 IN  
Collected By : Shad Johnson  
Collection Date : 06/10/14 12:30

ESC Sample # : L704024-06

Site ID : 27-1

Project # : 27-1

| Parameter                         | Result | Det. Limit | Units    | Method      | Date     | Dil. |
|-----------------------------------|--------|------------|----------|-------------|----------|------|
| Chromium, Hexavalent              | BDL    | 2.0        | mg/kg    | 3060A/7196A | 06/13/14 | 1    |
| Chromium, Trivalent               | 9.5    | 2.0        | mg/kg    | Calc.       | 06/17/14 | 1    |
| ORP                               | 20.    |            | mV       | 2580 B-2011 | 06/13/14 | 1    |
| pH                                | 7.1    |            | su       | 9045D       | 06/13/14 | 1    |
| Sodium Adsorption Ratio           | 2.4    |            |          | Calc.       | 06/18/14 | 1    |
| Specific Conductance              | 1800   |            | umhos/cm | 9050AMod    | 06/13/14 | 1    |
| Mercury                           | BDL    | 0.020      | mg/kg    | 7471        | 06/13/14 | 1    |
| Arsenic                           | 4.9    | 2.0        | mg/kg    | 6010B       | 06/12/14 | 1    |
| Barium                            | 190    | 0.50       | mg/kg    | 6010B       | 06/12/14 | 1    |
| Cadmium                           | 0.64   | 0.50       | mg/kg    | 6010B       | 06/12/14 | 1    |
| Chromium                          | 9.5    | 1.0        | mg/kg    | 6010B       | 06/12/14 | 1    |
| Copper                            | 4.6    | 2.0        | mg/kg    | 6010B       | 06/12/14 | 1    |
| Lead                              | 8.8    | 0.50       | mg/kg    | 6010B       | 06/12/14 | 1    |
| Nickel                            | 5.7    | 2.0        | mg/kg    | 6010B       | 06/13/14 | 1    |
| Selenium                          | BDL    | 2.0        | mg/kg    | 6010B       | 06/12/14 | 1    |
| Silver                            | BDL    | 1.0        | mg/kg    | 6010B       | 06/12/14 | 1    |
| Zinc                              | 36.    | 3.0        | mg/kg    | 6010B       | 06/12/14 | 1    |
| Benzene                           | 0.024  | 0.012      | mg/kg    | 8021/8015   | 06/12/14 | 25   |
| Toluene                           | BDL    | 0.12       | mg/kg    | 8021/8015   | 06/12/14 | 25   |
| Ethylbenzene                      | 0.21   | 0.012      | mg/kg    | 8021/8015   | 06/12/14 | 25   |
| Total Xylene                      | 1.5    | 0.038      | mg/kg    | 8021/8015   | 06/12/14 | 25   |
| TPH (GC/FID) Low Fraction         | 580    | 10.        | mg/kg    | GRO         | 06/17/14 | 100  |
| Surrogate Recovery-%              |        |            |          |             |          |      |
| a,a,a-Trifluorotoluene(FID)       | 94.4   |            | % Rec.   | 8021/8015   | 06/17/14 | 100  |
| a,a,a-Trifluorotoluene(PID)       | 102.   |            | % Rec.   | 8021/8015   | 06/12/14 | 25   |
| TPH (GC/FID) High Fraction        | 300    | 4.0        | mg/kg    | 3546/DRO    | 06/17/14 | 1    |
| Surrogate recovery(%)             |        |            |          |             |          |      |
| o-Terphenyl                       | 60.0   |            | % Rec.   | 3546/DRO    | 06/17/14 | 1    |
| Polynuclear Aromatic Hydrocarbons |        |            |          |             |          |      |
| Anthracene                        | BDL    | 0.0060     | mg/kg    | 8270C-SIM   | 06/14/14 | 1    |
| Acenaphthene                      | BDL    | 0.0060     | mg/kg    | 8270C-SIM   | 06/14/14 | 1    |
| Acenaphthylene                    | BDL    | 0.0060     | mg/kg    | 8270C-SIM   | 06/14/14 | 1    |
| Benzo(a)anthracene                | BDL    | 0.0060     | mg/kg    | 8270C-SIM   | 06/14/14 | 1    |
| Benzo(a)pyrene                    | BDL    | 0.0060     | mg/kg    | 8270C-SIM   | 06/14/14 | 1    |

BDL - Below Detection Limit  
Det. Limit - Practical Quantitation Limit(PQL)  
L704024-06 (PH) - 7.1 @ 21.4c



12065 Lebanon Rd.  
Mt. Juliet, TN 37122  
(615) 758-5858  
1-800-767-5859  
Fax (615) 758-5859

Tax I.D. 62-0814289

Est. 1970

# REPORT OF ANALYSIS

Charles Jensen  
EnCana Oil & Gas - Rangely, CO  
1125 Escalante Drive  
Rangely, CO 81648-3600

June 18, 2014

Date Received : June 11, 2014  
Description : 27-1 Site Clearance  
Sample ID : 061014-27-1 (ETS) 3-9 IN  
Collected By : Shad Johnson  
Collection Date : 06/10/14 12:30

ESC Sample # : L704024-06

Site ID : 27-1

Project # : 27-1

| Parameter              | Result | Det. Limit | Units  | Method    | Date     | Dil. |
|------------------------|--------|------------|--------|-----------|----------|------|
| Benzo(b)fluoranthene   | BDL    | 0.0060     | mg/kg  | 8270C-SIM | 06/14/14 | 1    |
| Benzo(g,h,i)perylene   | BDL    | 0.0060     | mg/kg  | 8270C-SIM | 06/14/14 | 1    |
| Benzo(k)fluoranthene   | BDL    | 0.0060     | mg/kg  | 8270C-SIM | 06/14/14 | 1    |
| Chrysene               | BDL    | 0.0060     | mg/kg  | 8270C-SIM | 06/14/14 | 1    |
| Dibenz(a,h)anthracene  | BDL    | 0.0060     | mg/kg  | 8270C-SIM | 06/14/14 | 1    |
| Fluoranthene           | BDL    | 0.0060     | mg/kg  | 8270C-SIM | 06/14/14 | 1    |
| Fluorene               | BDL    | 0.0060     | mg/kg  | 8270C-SIM | 06/14/14 | 1    |
| Indeno(1,2,3-cd)pyrene | BDL    | 0.0060     | mg/kg  | 8270C-SIM | 06/14/14 | 1    |
| Naphthalene            | 0.22   | 0.020      | mg/kg  | 8270C-SIM | 06/14/14 | 1    |
| Phenanthrene           | BDL    | 0.0060     | mg/kg  | 8270C-SIM | 06/14/14 | 1    |
| Pyrene                 | BDL    | 0.0060     | mg/kg  | 8270C-SIM | 06/14/14 | 1    |
| 1-Methylnaphthalene    | 0.12   | 0.020      | mg/kg  | 8270C-SIM | 06/14/14 | 1    |
| 2-Methylnaphthalene    | 0.13   | 0.020      | mg/kg  | 8270C-SIM | 06/14/14 | 1    |
| 2-Chloronaphthalene    | BDL    | 0.020      | mg/kg  | 8270C-SIM | 06/14/14 | 1    |
| Surrogate Recovery     |        |            |        |           |          |      |
| p-Terphenyl-d14        | 81.9   |            | % Rec. | 8270C-SIM | 06/14/14 | 1    |
| Nitrobenzene-d5        | 193.   |            | % Rec. | 8270C-SIM | 06/14/14 | 1    |
| 2-Fluorobiphenyl       | 76.6   |            | % Rec. | 8270C-SIM | 06/14/14 | 1    |

BDL - Below Detection Limit

Det. Limit - Practical Quantitation Limit(PQL)

Note:

The reported analytical results relate only to the sample submitted.

This report shall not be reproduced, except in full, without the written approval from ESC.

Reported: 06/18/14 12:46 Printed: 06/18/14 12:47  
L704024-06 (PH) - 7.1 @ 21.4c

Attachment A  
List of Analytes with QC Qualifiers

| Sample<br>Number | Work<br>Group | Sample<br>Type | Analyte         | Run<br>ID | Qualifier |
|------------------|---------------|----------------|-----------------|-----------|-----------|
| L704024-06       | WG726363      | SAMP           | Nitrobenzene-d5 | R2941665  | J1        |

Attachment B  
Explanation of QC Qualifier Codes

| Qualifier | Meaning   |
|-----------|---|
| J1        | Surrogate recovery limits have been exceeded; values are outside upper control limits |

Qualifier Report Information

ESC utilizes sample and result qualifiers as set forth by the EPA Contract Laboratory Program and as required by most certifying bodies including NELAC. In addition to the EPA qualifiers adopted by ESC, we have implemented ESC qualifiers to provide more information pertaining to our analytical results. Each qualifier is designated in the qualifier explanation as either EPA or ESC. Data qualifiers are intended to provide the ESC client with more detailed information concerning the potential bias of reported data. Because of the wide range of constituents and variety of matrices incorporated by most EPA methods, it is common for some compounds to fall outside of established ranges. These exceptions are evaluated and all reported data is valid and useable "unless qualified as 'R' (Rejected)."

Definitions

- Accuracy - The relationship of the observed value of a known sample to the true value of a known sample. Represented by percent recovery and relevant to samples such as: control samples, matrix spike recoveries, surrogate recoveries, etc.
- Precision - The agreement between a set of samples or between duplicate samples. Relates to how close together the results are and is represented by Relative Percent Difference.
- Surrogate - Organic compounds that are similar in chemical composition, extraction, and chromatography to analytes of interest. The surrogates are used to determine the probable response of the group of analytes that are chemically related to the surrogate compound. Surrogates are added to the sample and carried through all stages of preparation and analyses.
- TIC - Tentatively Identified Compound: Compounds detected in samples that are not target compounds, internal standards, system monitoring compounds, or surrogates.

Summary of Remarks For Samples Printed  
06/18/14 at 12:47:23

TSR Signing Reports: 358  
R5 - Desired TAT

Sample: L704024-01 Account: ENCANRCO Received: 06/11/14 09:00 Due Date: 06/18/14 00:00 RPT Date: 06/18/14 12:46  
Sample: L704024-02 Account: ENCANRCO Received: 06/11/14 09:00 Due Date: 06/18/14 00:00 RPT Date: 06/18/14 12:46  
Sample: L704024-03 Account: ENCANRCO Received: 06/11/14 09:00 Due Date: 06/18/14 00:00 RPT Date: 06/18/14 12:46  
Sample: L704024-04 Account: ENCANRCO Received: 06/11/14 09:00 Due Date: 06/18/14 00:00 RPT Date: 06/18/14 12:46  
Sample: L704024-05 Account: ENCANRCO Received: 06/11/14 09:00 Due Date: 06/18/14 00:00 RPT Date: 06/18/14 12:46  
Sample: L704024-06 Account: ENCANRCO Received: 06/11/14 09:00 Due Date: 06/18/14 00:00 RPT Date: 06/18/14 12:46

Encana Oil & Gas (USA)  
143 Diamond Ave.  
Parachute, CO 81635  
\*ENCANRCO-RULEENG\*

Billing Information:  
Charlie Jensen  
143 Diamond Ave  
Parachute, CO 81635

Report to: Charlie Jensen

Email to: charles.jensen@encana.com

Project Description: 27-1 - SITE CLEARANCE

City/State Collected: CO

Phone: 970-285-2735  
FAX:

Client Project #: 27-1

ESC Key: ENCANRCO-RULEENG

Collected by: Shad Johnson

Site/Facility ID#: 27-1

P.O.#:

Collected by (signature):

**Rush?** (Lab MUST Be Notified)

Same Day.....200%  
Next Day.....100%  
Two Day.....50%  
Three Day.....25%

Date Results Needed:

Email? ☐ No ☒ Yes

FAX? ☒ No ☐ Yes

Immediately Packed on Ice N

| Sample ID              | Comp/Grab | Matrix* | Depth | Date    | Time | No. of Cntrs | BTEXGRO / DRO - 8021/8015 | SV8270PAHSIM - 8270SIM | SPCON - 9050AMod | SAR - Calc. | RCRA8 Metals + Cu, Ni, and Zn - 6010/7470 | CR6SS - 3060A/7196 | CR3 - Calc. | Arsenic |
|------------------------|-----------|---------|-------|---------|------|--------------|---------------------------|------------------------|------------------|-------------|---|--------------------|-------------|---------|
| 061014-27-1(NSW); 3'   | Grab      | SS      | 3'    | 6-10-14 | 1100 | 2            | X                         |                        |                  |             |   |                    |             |         |
| 061014-27-1(ESW); 4.5' | Grab      | SS      | 4.5'  | 6-10-14 | 1115 | 2            | X                         |                        |                  |             |   |                    |             |         |
| 061014-27-1(SSW); 5'   | Grab      | SS      | 5'    | 6-10-14 | 1045 | 2            | X                         |                        |                  |             |   |                    |             |         |
| 061014-27-1(WSW); 5'   | Grab      | SS      | 5'    | 6-10-14 | 1125 | 2            | X                         |                        |                  |             |   |                    |             |         |
| 061014-27-1(BBT); 5'   | Grab      | SS      | 5'    | 6-10-14 | 1145 | 2            | X                         |                        |                  |             |   |                    |             |         |
| 061014-27-1(ETS); 3-9" | Comp      | SS      | 3-9"  | 6-10-14 | 1230 | 3            | X                         | X                      | X                | X           | X   | X                  | X           | X       |

**ESC**  
L.A.B S.C.I.E.N.C.E.S

12065 Lebanon Road  
Mt. Juliet, TN 37122

Phone: (800) 767-5859  
Phone: (615) 758-5858  
Fax: (615) 758-5859

CoCode ENCANRCO (lab use only)

Template/Prelogin

Shipped Via: T70530

Remarks/Contaminant Sample # (lab only)

0704024-01 0704020

pH Temp

\*Matrix: SS - Soil/Solid GW - Groundwater WW - WasteWater DW - Drinking Water OT - Other

Remarks:

5939 9648 2893

|                              |               |            |                                  |   |  |
|------------------------------|---------------|------------|----------------------------------|---|--|
| Relinquished by: (Signature) | Date: 6-10-14 | Time: 1500 | Received by: (Signature)         | Samples returned via: <input checked="" type="checkbox"/> UPS <input type="checkbox"/> FedEx <input type="checkbox"/> Courier | Condition: (lab use only) <input checked="" type="checkbox"/> AN |
| Relinquished by: (Signature) | Date:         | Time:      | Received by: (Signature)         | Temp: 31.2  | Bottles Received: 13 = 40  |
| Relinquished by: (Signature) | Date:         | Time:      | Received for lab by: (Signature) | Date: 6-11-14   | Time: 0900   |
|                              |               |            |                                  | pH Checked:   | NCF:   |



12065 Lebanon Rd.  
Mt. Juliet, TN 37122  
(615) 758-5858  
1-800-767-5859  
Fax (615) 758-5859

Tax I.D. 62-0814289

Est. 1970

Chris Hines  
EnCana Oil & Gas - Parachute, CO  
143 Diamond Avenue  
Parachute, CO 81635

## Report Summary

Monday June 16, 2014

Report Number: L704032

Samples Received: 06/11/14

Client Project: 27-1

Description: 27-1 - Site Clearance

The analytical results in this report are based upon information supplied by you, the client, and are for your exclusive use. If you have any questions regarding this data package, please do not hesitate to call.

Entire Report Reviewed By:

T. Alan Harvill , ESC Representative

### Laboratory Certification Numbers

A2LA - 1461-01, AIHA - 100789, AL - 40660, CA - 01157CA, CT - PH-0197,  
FL - E87487, GA - 923, IN - C-TN-01, KY - 90010, KYUST - 0016,  
NC - ENV375/DW21704/BIO041, ND - R-140, NJ - TN002, NJ NELAP - TN002,  
SC - 84004, TN - 2006, VA - 460132, WV - 233, AZ - 0612,  
MN - 047-999-395, NY - 11742, WI - 998093910, NV - TN000032011-1,  
TX - T104704245-11-3, OK - 9915, PA - 68-02979, IA Lab #364, EPA - TN002

Accreditation is only applicable to the test methods specified on each scope of accreditation held by ESC Lab Sciences.

This report may not be reproduced, except in full, without written approval from ESC Lab Sciences. Where applicable, sampling conducted by ESC is performed per guidance provided in laboratory standard operating procedures: 060302, 060303, and 060304.



12065 Lebanon Rd.  
Mt. Juliet, TN 37122  
(615) 758-5858  
1-800-767-5859  
Fax (615) 758-5859

Tax I.D. 62-0814289

Est. 1970

REPORT OF ANALYSIS

June 16, 2014

Chris Hines  
EnCana Oil & Gas - Parachute, CO  
143 Diamond Avenue  
Parachute, CO 81635

Date Received : June 11, 2014  
Description : 27-1 - Site Clearance  
Sample ID : 061014-27-1 (BG1N) 6IN  
Collected By : Shad Johnson  
Collection Date : 06/10/14 09:00

ESC Sample # : L704032-01

Site ID : 27-1

Project # : 27-1

| Parameter | Result | Det. Limit | Units | Method | Date     | Dil. |
|-----------|--------|------------|-------|--------|----------|------|
| Arsenic   | BDL    | 2.0        | mg/kg | 6010B  | 06/14/14 | 1    |

BDL - Below Detection Limit

Det. Limit - Practical Quantitation Limit(PQL)

Note:

The reported analytical results relate only to the sample submitted.

This report shall not be reproduced, except in full, without the written approval from ESC.

Reported: 06/16/14 12:01 Printed: 06/16/14 12:01



12065 Lebanon Rd.  
Mt. Juliet, TN 37122  
(615) 758-5858  
1-800-767-5859  
Fax (615) 758-5859

Tax I.D. 62-0814289

Est. 1970

REPORT OF ANALYSIS

June 16, 2014

Chris Hines  
EnCana Oil & Gas - Parachute, CO  
143 Diamond Avenue  
Parachute, CO 81635

Date Received : June 11, 2014  
Description : 27-1 - Site Clearance  
Sample ID : 061014-27-1 (BG2E) 6IN  
Collected By : Shad Johnson  
Collection Date : 06/10/14 09:10

ESC Sample # : L704032-02

Site ID : 27-1

Project # : 27-1

| Parameter | Result | Det. Limit | Units | Method | Date     | Dil. |
|-----------|--------|------------|-------|--------|----------|------|
| Arsenic   | 2.0    | 2.0        | mg/kg | 6010B  | 06/14/14 | 1    |

BDL - Below Detection Limit

Det. Limit - Practical Quantitation Limit(PQL)

Note:

The reported analytical results relate only to the sample submitted.

This report shall not be reproduced, except in full, without the written approval from ESC.

Reported: 06/16/14 12:01 Printed: 06/16/14 12:01



12065 Lebanon Rd.  
Mt. Juliet, TN 37122  
(615) 758-5858  
1-800-767-5859  
Fax (615) 758-5859

Tax I.D. 62-0814289

Est. 1970

REPORT OF ANALYSIS

June 16, 2014

Chris Hines  
EnCana Oil & Gas - Parachute, CO  
143 Diamond Avenue  
Parachute, CO 81635

Date Received : June 11, 2014  
Description : 27-1 - Site Clearance  
Sample ID : 061014-27-1 (BG3S) 6IN  
Collected By : Shad Johnson  
Collection Date : 06/10/14 09:20

ESC Sample # : L704032-03

Site ID : 27-1

Project # : 27-1

| Parameter | Result | Det. Limit | Units | Method | Date     | Dil. |
|-----------|--------|------------|-------|--------|----------|------|
| Arsenic   | BDL    | 2.0        | mg/kg | 6010B  | 06/15/14 | 1    |

BDL - Below Detection Limit

Det. Limit - Practical Quantitation Limit(PQL)

Note:

The reported analytical results relate only to the sample submitted.

This report shall not be reproduced, except in full, without the written approval from ESC.

Reported: 06/16/14 12:01 Printed: 06/16/14 12:01



12065 Lebanon Rd.  
Mt. Juliet, TN 37122  
(615) 758-5858  
1-800-767-5859  
Fax (615) 758-5859

Tax I.D. 62-0814289

Est. 1970

# REPORT OF ANALYSIS

June 16, 2014

Chris Hines  
EnCana Oil & Gas - Parachute, CO  
143 Diamond Avenue  
Parachute, CO 81635

Date Received : June 11, 2014  
Description : 27-1 - Site Clearance  
Sample ID : 061014-27-1 (BG4W) 6IN  
Collected By : Shad Johnson  
Collection Date : 06/10/14 09:30

ESC Sample # : L704032-04

Site ID : 27-1

Project # : 27-1

| Parameter | Result | Det. Limit | Units | Method | Date     | Dil. |
|-----------|--------|------------|-------|--------|----------|------|
| Arsenic   | BDL    | 2.0        | mg/kg | 6010B  | 06/15/14 | 1    |

BDL - Below Detection Limit

Det. Limit - Practical Quantitation Limit(PQL)

Note:

The reported analytical results relate only to the sample submitted.

This report shall not be reproduced, except in full, without the written approval from ESC.

Reported: 06/16/14 12:01 Printed: 06/16/14 12:01

Summary of Remarks For Samples Printed  
06/16/14 at 12:01:39

TSR Signing Reports: 358  
R5 - Desired TAT

Log all PAHs as PAHSIM. Log all BTEX waters by 8260. Log ALL samples for EDD (COGCC EDD).

Sample: L704032-01 Account: ENCANACO Received: 06/11/14 09:00 Due Date: 06/18/14 00:00 RPT Date: 06/16/14 12:01

Sample: L704032-02 Account: ENCANACO Received: 06/11/14 09:00 Due Date: 06/18/14 00:00 RPT Date: 06/16/14 12:01

Sample: L704032-03 Account: ENCANACO Received: 06/11/14 09:00 Due Date: 06/18/14 00:00 RPT Date: 06/16/14 12:01

Sample: L704032-04 Account: ENCANACO Received: 06/11/14 09:00 Due Date: 06/18/14 00:00 RPT Date: 06/16/14 12:01

Encana Oil & Gas (USA)  
143 Diamond Ave.  
Parachute, CO 81635  
\*ENCANRCO-RULEENG\*

Billing Information:  
Charlie Jensen  
143 Diamond Ave  
Parachute, CO 81635

Report to: Charlie Jensen  
Email to: charles.jensen@encana.com

## Analysis/Container/Preservative

Chain of Custody  
Page 1 of 1



12065 Lebanon Road  
Mt. Juliet, TN 37122

Phone: (800) 767-5859  
Phone: (615) 758-5858  
Fax: (615) 758-5859

Project Description: 27-1 - SITE CLEARANCE  
City/State Collected: CO  
Phone: 970-285-2735  
FAX: 970-285-2735  
Client Project #: 27-1  
ESC Key: ENCANRCO-RULEENG

Collected by: Shad Johnson  
Site/Facility ID#: 27-1  
P.O.#:

Collected by (signature): *[Signature]*  
Immediately Packed on Ice N *[Initials]*  
**Rush?** (Lab MUST Be Notified)  
\_\_\_\_ Same Day.....200%  
\_\_\_\_ Next Day.....100%  
\_\_\_\_ Two Day.....50%  
\_\_\_\_ Three Day.....25%  
Date Results Needed:  
Email? ☐ No ☒ Yes  
FAX? ☒ No ☐ Yes

| Sample ID             | Comp/Grab | Matrix* | Depth | Date    | Time | No. of Cntrs | BTEXGRO / DRO - 8021/8015 | SV8270PAHSIM - 8270SIM | SPCON - 9050AMod | SAR - Calc. | RCRA8 Metals + Cu, Ni, and Zn - 6010/7470 | CR6SS - 3060A/7196 | CR3 - Calc. | Arsenic | Remarks/Contaminant | Sample # (lab only) |
|-----------------------|-----------|---------|-------|---------|------|--------------|---------------------------|------------------------|------------------|-------------|---|--------------------|-------------|---------|---------------------|---------------------|
| 061014-27-1(BG1N); 6" | Grab      | SS      | 6"    | 6-10-14 | 0900 | 1            |                           |                        |                  |             |   |                    |             | X       |                     | -01                 |
| 061014-27-1(BG2E); 6" | Grab      | SS      | 6"    | 6-10-14 | 0910 | 1            |                           |                        |                  |             |   |                    |             | X       |                     | -02                 |
| 061014-27-1(BG3S); 6" | Grab      | SS      | 6"    | 6-10-14 | 0920 | 1            |                           |                        |                  |             |   |                    |             | X       |                     | -03                 |
| 061014-27-1(BG4W); 6" | Grab      | SS      | 6"    | 6-10-14 | 0930 | 1            |                           |                        |                  |             |   |                    |             | X       |                     | -04                 |
|                       |           |         |       |         |      |              |                           |                        |                  |             |   |                    |             |         |                     |                     |
|                       |           |         |       |         |      |              |                           |                        |                  |             |   |                    |             |         |                     |                     |
|                       |           |         |       |         |      |              |                           |                        |                  |             |   |                    |             |         |                     |                     |
|                       |           |         |       |         |      |              |                           |                        |                  |             |   |                    |             |         |                     |                     |
|                       |           |         |       |         |      |              |                           |                        |                  |             |   |                    |             |         |                     |                     |
|                       |           |         |       |         |      |              |                           |                        |                  |             |   |                    |             |         |                     |                     |
|                       |           |         |       |         |      |              |                           |                        |                  |             |   |                    |             |         |                     |                     |

\*Matrix: SS - Soil/Solid GW - Groundwater WW - WasteWater DW - Drinking Water OT - Other \_\_\_\_\_

pH \_\_\_\_\_ Temp \_\_\_\_\_

Remarks: \_\_\_\_\_

5939 9648 2893

Flow \_\_\_\_\_ Other \_\_\_\_\_

|   |               |            |   |   |                                     |
|---|---------------|------------|---|---|-------------------------------------|
| Relinquished by: (Signature) <i>[Signature]</i> | Date: 6-10-14 | Time: 1500 | Received by: (Signature) <i>[Signature]</i>         | Samples returned via: <input checked="" type="checkbox"/> UPS <input type="checkbox"/> FedEx <input type="checkbox"/> Courier | Condition: (lab use only) <i>OK</i> |
| Relinquished by: (Signature) <i>[Signature]</i> | Date:         | Time:      | Received by: (Signature) <i>[Signature]</i>         | Temp: 3.1   | Bottles Received: 4 = 4oz           |
| Relinquished by: (Signature) <i>[Signature]</i> | Date:         | Time:      | Received for lab by: (Signature) <i>[Signature]</i> | Date: 6-11-14   | Time: 0900                          |
|   |               |            |   | pH Checked:   | NCF:                                |

CoC Seals Intact: *1* Y *0* N *0* NA *OK*



12065 Lebanon Rd.  
Mt. Juliet, TN 37122  
(615) 758-5858  
1-800-767-5859  
Fax (615) 758-5859

Tax I.D. 62-0814289

Est. 1970

Charles Jensen  
EnCana Oil & Gas - Parachute, CO  
143 Diamond Avenue  
Parachute, CO 81635

## Report Summary

Friday August 01, 2014

Report Number: L712252

Samples Received: 07/25/14

Client Project: 27-1

Description: 27-1 SITE CLEARANCE

The analytical results in this report are based upon information supplied by you, the client, and are for your exclusive use. If you have any questions regarding this data package, please do not hesitate to call.

Entire Report Reviewed By:

  
Jared Willis, ESC Representative

### Laboratory Certification Numbers

A2LA - 1461-01, AIHA - 100789, AL - 40660, CA - 01157CA, CT - PH-0197,  
FL - E87487, GA - 923, IN - C-IN-01, KY - 90010, KYUST - 0016,  
NC - ENV375/DW21704/BIO041, ND - R-140, NJ - TN002, NJ NELAP - TN002,  
SC - 84004, TN - 2006, VA - 460132, WV - 233, AZ - 0612,  
MN - 047-999-395, NY - 11742, WI - 998093910, NV - TN000032011-1,  
TX - T104704245-11-3, OK - 9915, PA - 68-02979, IA Lab #364, EPA - TN002

Accreditation is only applicable to the test methods specified on each scope of accreditation held by ESC Lab Sciences.

This report may not be reproduced, except in full, without written approval from ESC Lab Sciences. Where applicable, sampling conducted by ESC is performed per guidance provided in laboratory standard operating procedures: 060302, 060303, and 060304.



12065 Lebanon Rd.  
Mt. Juliet, TN 37122  
(615) 758-5858  
1-800-767-5859  
Fax (615) 758-5859

Tax I.D. 62-0814289

Est. 1970

# REPORT OF ANALYSIS

Charles Jensen  
EnCana Oil & Gas - Parachute, CO  
143 Diamond Avenue  
Parachute, CO 81635

August 01, 2014

Date Received : July 25, 2014  
Description : 27-1 SITE CLEARANCE  
Sample ID : 072314-27-1 ETS 3-9IN  
Collected By : Chris Bak  
Collection Date : 07/23/14 10:10

ESC Sample # : L712252-01

Site ID : 27-1

Project # : 27-1

| Parameter                   | Result | Det. Limit | Units  | Method    | Date     | Dil. |
|-----------------------------|--------|------------|--------|-----------|----------|------|
| TPH (GC/FID) Low Fraction   | 28.    | 25.        | mg/kg  | 8015D/GRO | 07/30/14 | 250  |
| Surrogate Recovery (70-130) |        |            |        |           |          |      |
| a,a,a-Trifluorotoluene(FID) | 95.7   |            | % Rec. | 8015D/GRO | 07/30/14 | 250  |
| TPH (GC/FID) High Fraction  | 210    | 4.0        | mg/kg  | 8015D/DRO | 08/01/14 | 1    |
| Surrogate recovery(%)       |        |            |        |           |          |      |
| o-Terphenyl                 | 75.6   |            | % Rec. | 8015D/DRO | 08/01/14 | 1    |

BDL - Below Detection Limit

Det. Limit - Practical Quantitation Limit(PQL)

Note:

The reported analytical results relate only to the sample submitted.

This report shall not be reproduced, except in full, without the written approval from ESC.

Reported: 08/01/14 11:54 Printed: 08/01/14 13:28



12065 Lebanon Rd.  
Mt. Juliet, TN 37122  
(615) 758-5858  
1-800-767-5859  
Fax (615) 758-5859

Tax I.D. 62-0814289

Est. 1970

# REPORT OF ANALYSIS

Charles Jensen  
EnCana Oil & Gas - Parachute, CO  
143 Diamond Avenue  
Parachute, CO 81635

August 01, 2014

Date Received : July 25, 2014  
Description : 27-1 SITE CLEARANCE  
Sample ID : 072314-27-1 BBT 5FT  
Collected By : Chris Bak  
Collection Date : 07/23/14 09:45

ESC Sample # : L712252-02

Site ID : 27-1

Project # : 27-1

| Parameter                   | Result | Det. Limit | Units  | Method | Date     | Dil. |
|-----------------------------|--------|------------|--------|--------|----------|------|
| Benzene                     | BDL    | 0.0025     | mg/kg  | 8021B  | 07/26/14 | 5    |
| Toluene                     | BDL    | 0.025      | mg/kg  | 8021B  | 07/26/14 | 5    |
| Ethylbenzene                | BDL    | 0.0025     | mg/kg  | 8021B  | 07/26/14 | 5    |
| Total Xylene                | BDL    | 0.0075     | mg/kg  | 8021B  | 07/26/14 | 5    |
| Surrogate Recovery(%)       |        |            |        |        |          |      |
| a,a,a-Trifluorotoluene(PID) | 97.1   |            | % Rec. | 8021B  | 07/26/14 | 5    |

BDL - Below Detection Limit

Det. Limit - Practical Quantitation Limit(PQL)

Note:

The reported analytical results relate only to the sample submitted.

This report shall not be reproduced, except in full, without the written approval from ESC.

Reported: 08/01/14 11:54 Printed: 08/01/14 13:28

Encana Oil & Gas (USA)  
143 Diamond Ave.  
Parachute, CO 81635  
\*ENCANR-ENG\*

**Billing Information:**  
Charlie Jensen  
143 Diamond Ave  
Parachute, CO 81635

Report to: Charlie Jensen  
Email to: charles.jensen@encana.com

|                      |                       |
|----------------------|-----------------------|
| Project Description: | 27-1 - SITE CLEARANCE |
|----------------------|-----------------------|

Phone: 970-285-2735  
FAX:

Client Project #: 27-1

City/State  
Collected *Rangely, CO*

ESC Key: ENCANRCO-RULEENG

Collected by Chris Bak

Site/Facility ID#: 27-1

P.O.#:

Collected by (signature):

**Rush?** ( Lab MUST Be Notified )

**Date Results Needed:**

|                       |      |
|-----------------------|------|
| _____ Same Day.....   | 200% |
| _____ Next Day.....   | 100% |
| _____ Two Day .....   | 50%  |
| _____ Three Day ..... | 25%  |

Email? ☐ No ☒ Yes

FAX? ☒ No ☐ Yes

Immediately Packed on Ice N

[illegible]

\*Matrix: SS - Sol/Solid GW - Groundwater WW - WasteWater DW - Drinking Water OT - Other

Remarks:

6051 2428 2922

pH \_\_\_\_\_ Temp \_\_\_\_\_

Flow \_\_\_\_\_ Other \_\_\_\_\_

| Relinquished by: (Signature) |  | Date:   | Time: | Received by: (Signature)         | Samples returned via: <input type="checkbox"/> UPS<br><input checked="" type="checkbox"/> FedEx <input type="checkbox"/> Courier <input type="checkbox"/> | Condition: (lab use only)  |
|------------------------------|--|---------|-------|----------------------------------|---|--|
| [Signature]                  |  | 7/23/14 |       |                                  |   |  |
| Relinquished by: (Signature) |  | Date:   | Time: | Received by: (Signature)         | Temp: 25°C  | Bottles Received: 4-402  |
| Relinquished by: (Signature) |  | Date:   | Time: | Received for lab by: (Signature) | Date: 7-24-14   | Time: 8900   |
|                              |  |         |       |                                  |   | CoC Seals Intact: <input type="checkbox"/> Y <input checked="" type="checkbox"/> N <input type="checkbox"/> NA |
|                              |  |         |       |                                  |   | pH Checked: <input type="checkbox"/> NCF: <input checked="" type="checkbox"/>                                  |

4

**Subject:**

**FSC Lab Sciences**

ogin #: L712252

Date: 7/24/14

**Evaluated by:** Dustin Cornelison

| Sample Integrity                |   | Chain of Custody Clarification                   |  |  |
|---------------------------------|---|--|--|--|
| Parameter(s) past holding time  | X | Login Clarification Needed                       |  |  |
| Improper temperature            |   | Chain of custody is incomplete                   |  | If Broken Container:                             |
| Improper container type         |   | Please specify Metals requested.                 |  |  |
| Improper preservation           |   | Please specify TCLP requested.                   |  |  |
| Insufficient sample volume.     |   | Received additional samples not listed on coc.   |  | Improper handling by carrier (FedEx / UPS / Cour |
| Sample is biphasic.             |   | Sample ids on containers do not match ids on coc |  | Sample was frozen                                |
| Viials received with headspace. |   | Trip Blank not received.                         |  | Container lid not intact                         |
| Broken container                |   | Client did not "X" analysis.                     |  | If no Chain of Custody:                          |
| Broken container:               |   | Chain of Custody is missing                      |  | Received by:                                     |
| Sufficient sample remains       |   |  |  | Date/Time:                                       |
|                                 |   |  |  | Temp./Cont Rec./pH:                              |
|                                 |   |  |  | Carrier:   |
|                                 |   |  |  | Tracking#  |

Client informed by:

## Voice Mail

Date: 7/25/14

Time: 1028

TSR Initials: JW

**Client Contact:** Charlie Jensen

1