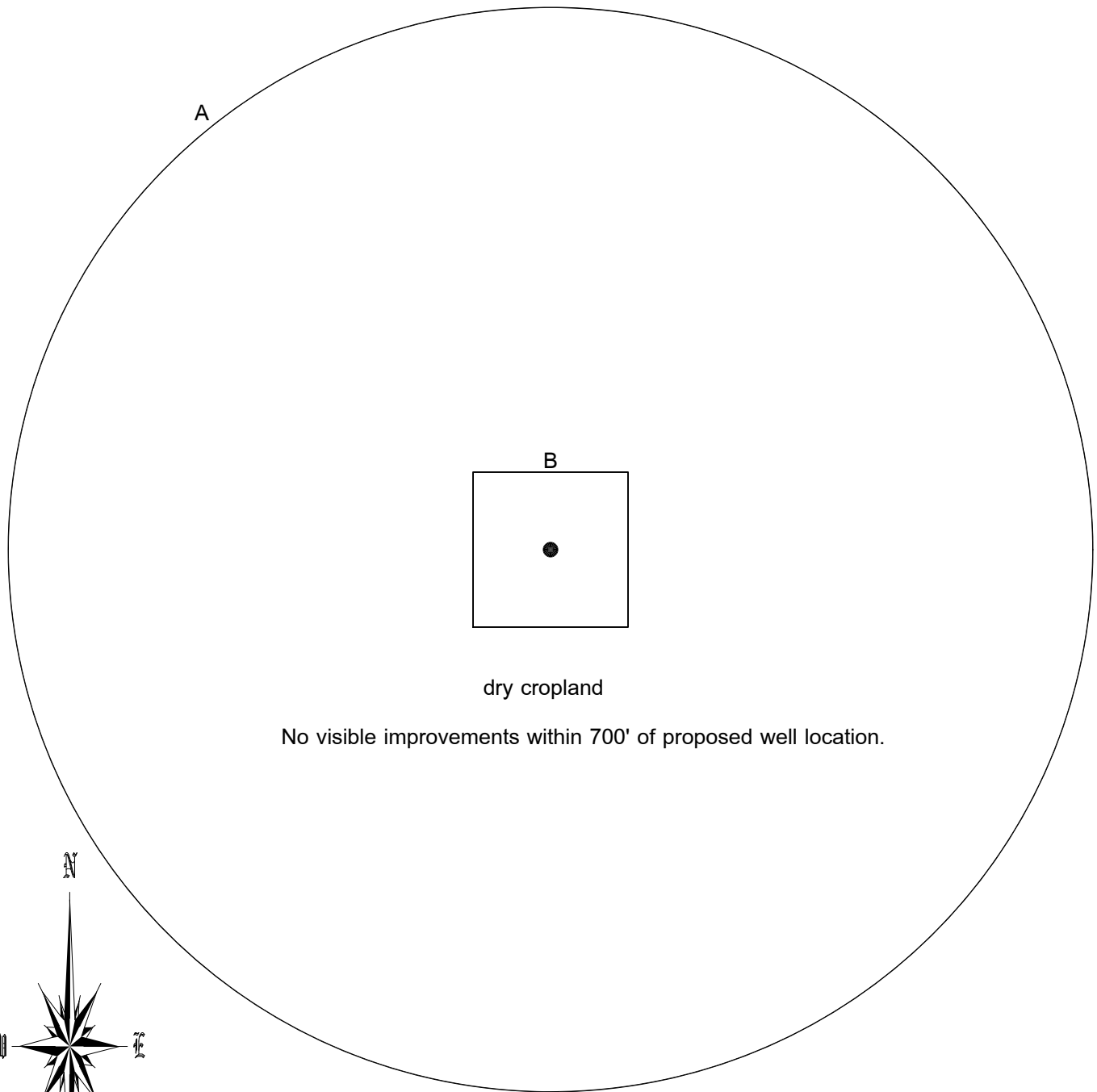
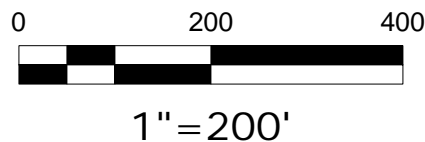
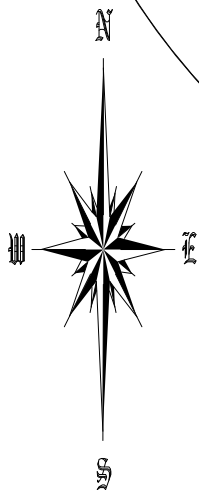

DIAGRAM OF VISIBLE IMPROVEMENTS

Schobe 14-14



No visible improvements within 700' of proposed well location.



- Proposed Well Location
- A = 700' Radius from Well Location
- B = 200'x200' disturbance area

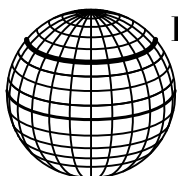

FORTY NORTH, LLC
LAND SURVEYING

53575 County Road NN
 Wray, CO 80758
 (970) 466-0552
 fortynorthllc@gmail.com

DATE OF FIELD WORK
 7/23/14

DATE OF DRAWING
 7/24/14

PROJECT NO.
 1083.036

Augustus Energy Resources, LLC
 Schobe 14-14 1S44W

SW1/4 SW1/4 SEC 14, T1S, R44W, 6PM, Yuma County, Colo.