

Tekton Energy

Well Name: Diamond Valley East #4					
Surface Location: Diamond Valley East Pad Sec.23-T6N-R67W					
North American Datum 1983 , US State Plane 1983 , Colorado Northern Zone					
Ground Elevation: 4769.0					
+N/-S	+E/-W	Northing	Easting	Latitude	Longitude Slot
0.0	0.0	1413784.58	3175338.13	40.467530	-104.869810
RKB - 22.5' WELL @ 4791.5ft (RKB - 22.5')					

FINAL SURVEY

Projected Bottom Hole Location
11915MD 7164'TVD 192 'S & 4906'W of SHL
90.5 degree Incl @ 270.5 degree AZM

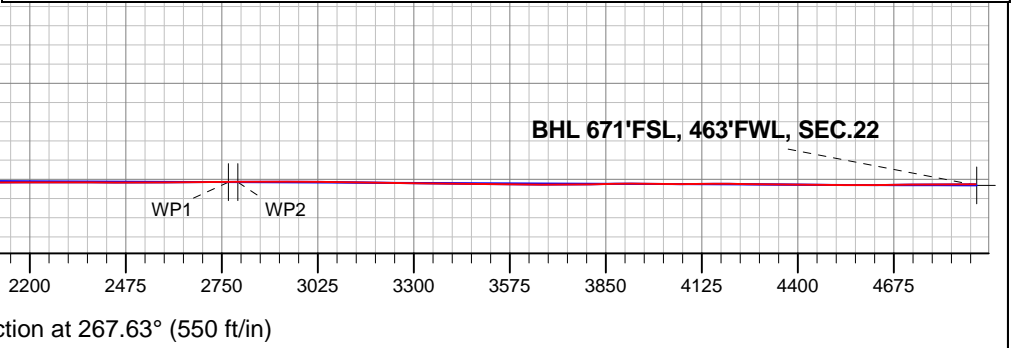
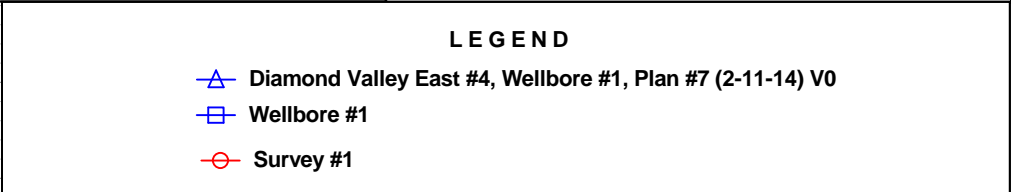
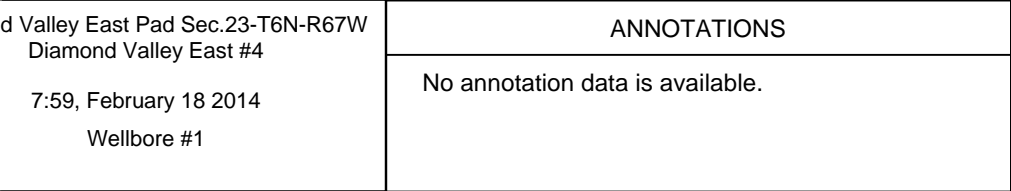



Tekton Energy

SEC.23-T6N-R67W

Diamond Valley East Pad Sec.23-T6N-R67W

Diamond Valley East #4

Wellbore #1

Survey: Survey #1

Standard Survey Report

18 February, 2014

Company:	Tekton Energy	Local Co-ordinate Reference:	Well Diamond Valley East #4
Project:	SEC.23-T6N-R67W	TVD Reference:	WELL @ 4791.5ft (RKB - 22.5')
Site:	Diamond Valley East Pad Sec.23-T6N-R67W	MD Reference:	WELL @ 4791.5ft (RKB - 22.5')
Well:	Diamond Valley East #4	North Reference:	True
Wellbore:	Wellbore #1	Survey Calculation Method:	Minimum Curvature
Design:	Wellbore #1	Database:	Landmark

Survey

Measured Depth (ft)	Inclination (°)	Azimuth (°)	Vertical Depth (ft)	+N/-S (ft)	+E/-W (ft)	Vertical Section (ft)	Dogleg Rate (°/100ft)	Build Rate (°/100ft)	Turn Rate (°/100ft)
1,117.0	2.70	151.50	1,115.2	-6.3	53.3	-53.0	2.02	-1.35	26.35
1,212.0	2.30	146.90	1,210.1	-9.9	55.4	-55.0	0.47	-0.42	-4.84
1,304.0	2.10	148.70	1,302.1	-12.9	57.3	-56.7	0.23	-0.22	1.96
1,395.0	1.90	153.40	1,393.0	-15.6	58.8	-58.1	0.28	-0.22	5.16
1,485.0	3.30	139.50	1,482.9	-18.9	61.2	-60.4	1.69	1.56	-15.44
1,577.0	3.70	161.90	1,574.8	-23.8	63.8	-62.8	1.54	0.43	24.35
1,669.0	3.10	159.60	1,666.6	-28.9	65.6	-64.4	0.67	-0.65	-2.50
1,761.0	2.70	157.50	1,758.5	-33.3	67.3	-65.9	0.45	-0.43	-2.28
1,851.0	2.90	148.20	1,848.4	-37.2	69.3	-67.7	0.55	0.22	-10.33
1,942.0	4.00	140.60	1,939.2	-41.6	72.6	-70.8	1.31	1.21	-8.35
2,034.0	3.30	153.60	2,031.0	-46.4	75.8	-73.8	1.17	-0.76	14.13
2,126.0	3.70	138.50	2,122.8	-51.0	78.9	-76.7	1.09	0.43	-16.41
2,221.0	3.30	126.90	2,217.7	-55.0	83.1	-80.8	0.85	-0.42	-12.21
2,316.0	3.90	135.30	2,312.5	-58.9	87.6	-85.1	0.84	0.63	8.84
2,411.0	3.30	131.80	2,407.3	-63.0	91.9	-89.2	0.67	-0.63	-3.68
2,506.0	4.10	151.30	2,502.1	-67.8	95.6	-92.7	1.56	0.84	20.53
2,601.0	3.60	156.90	2,596.9	-73.5	98.4	-95.2	0.66	-0.53	5.89
2,696.0	2.50	151.30	2,691.7	-78.1	100.5	-97.2	1.20	-1.16	-5.89
2,791.0	2.50	148.00	2,786.7	-81.7	102.6	-99.2	0.15	0.00	-3.47
2,886.0	3.30	150.10	2,881.5	-85.8	105.1	-101.5	0.85	0.84	2.21
2,981.0	3.70	153.60	2,976.4	-90.9	107.8	-104.0	0.48	0.42	3.68
3,076.0	2.90	138.10	3,071.2	-95.5	110.8	-106.7	1.25	-0.84	-16.32
3,171.0	2.90	138.80	3,166.1	-99.0	114.0	-109.8	0.04	0.00	0.74
3,266.0	3.90	142.20	3,260.9	-103.4	117.5	-113.2	1.07	1.05	3.58
3,361.0	4.50	145.20	3,355.7	-109.0	121.7	-117.0	0.67	0.63	3.16
3,457.0	3.30	150.60	3,451.4	-114.5	125.2	-120.3	1.31	-1.25	5.63
3,552.0	4.60	166.60	3,546.2	-120.6	127.4	-122.3	1.78	1.37	16.84
3,647.0	4.70	165.60	3,640.9	-128.1	129.2	-123.8	0.14	0.11	-1.05
3,742.0	4.80	167.00	3,735.6	-135.7	131.1	-125.4	0.16	0.11	1.47
3,837.0	4.50	165.60	3,830.3	-143.2	132.9	-126.9	0.34	-0.32	-1.47
3,933.0	4.40	167.30	3,926.0	-150.5	134.7	-128.3	0.17	-0.10	1.77
4,028.0	3.50	166.60	4,020.7	-156.8	136.1	-129.5	0.95	-0.95	-0.74
4,123.0	3.00	151.80	4,115.6	-161.8	138.0	-131.2	1.02	-0.53	-15.58
4,218.0	2.40	152.70	4,210.5	-165.8	140.1	-133.1	0.63	-0.63	0.95
4,314.0	2.10	149.60	4,306.4	-169.1	141.9	-134.8	0.34	-0.31	-3.23
4,409.0	2.00	157.10	4,401.3	-172.1	143.4	-136.2	0.30	-0.11	7.89
4,504.0	2.10	167.50	4,496.3	-175.4	144.4	-137.0	0.40	0.11	10.95
4,599.0	1.60	179.40	4,591.2	-178.4	144.8	-137.3	0.66	-0.53	12.53
4,695.0	1.50	167.10	4,687.2	-180.9	145.1	-137.5	0.36	-0.10	-12.81
4,790.0	1.10	144.50	4,782.2	-182.9	145.9	-138.2	0.68	-0.42	-23.79
4,885.0	1.10	145.20	4,877.2	-184.4	147.0	-139.2	0.01	0.00	0.74
4,981.0	0.80	144.30	4,973.1	-185.7	147.9	-140.1	0.31	-0.31	-0.94
5,076.0	0.70	139.90	5,068.1	-186.7	148.6	-140.8	0.12	-0.11	-4.63
5,171.0	0.50	176.30	5,163.1	-187.5	149.0	-141.2	0.44	-0.21	38.32
5,266.0	0.50	152.50	5,258.1	-188.3	149.3	-141.3	0.22	0.00	-25.05
5,361.0	0.40	244.50	5,353.1	-188.8	149.2	-141.2	0.69	-0.11	96.84
5,456.0	0.80	154.80	5,448.1	-189.6	149.1	-141.2	0.94	0.42	-94.42
5,551.0	1.00	131.30	5,543.1	-190.7	150.0	-142.0	0.44	0.21	-24.74
5,647.0	1.10	128.80	5,639.1	-191.8	151.4	-143.3	0.11	0.10	-2.60
5,742.0	1.00	144.60	5,734.1	-193.1	152.6	-144.5	0.32	-0.11	16.63
5,837.0	0.20	106.00	5,829.1	-193.8	153.2	-145.1	0.90	-0.84	-40.63
5,932.0	0.30	58.50	5,924.1	-193.7	153.6	-145.4	0.23	0.11	-50.00
6,027.0	0.70	108.60	6,019.1	-193.8	154.4	-146.2	0.59	0.42	52.74
6,122.0	0.90	118.60	6,114.1	-194.3	155.6	-147.4	0.26	0.21	10.53

Company: Tekton Energy
Project: SEC.23-T6N-R67W
Site: Diamond Valley East Pad Sec.23-T6N-R67W
Well: Diamond Valley East #4
Wellbore: Wellbore #1
Design: Wellbore #1

Local Co-ordinate Reference: Well Diamond Valley East #4
TVD Reference: WELL @ 4791.5ft (RKB - 22.5')
MD Reference: WELL @ 4791.5ft (RKB - 22.5')
North Reference: True
Survey Calculation Method: Minimum Curvature
Database: Landmark

Survey

Measured Depth (ft)	Inclination (°)	Azimuth (°)	Vertical Depth (ft)	+N/-S (ft)	+E/-W (ft)	Vertical Section (ft)	Dogleg Rate (°/100ft)	Build Rate (°/100ft)	Turn Rate (°/100ft)
6,217.0	0.80	99.10	6,209.1	-194.8	156.9	-148.7	0.32	-0.11	-20.53
6,312.0	0.80	99.10	6,304.0	-195.0	158.2	-150.0	0.00	0.00	0.00
6,407.0	0.90	120.90	6,399.0	-195.5	159.5	-151.2	0.35	0.11	22.95
6,454.0	1.40	254.70	6,446.0	-195.8	159.2	-151.0	4.52	1.06	284.68
6,502.0	6.20	273.80	6,493.9	-195.8	156.1	-147.8	10.21	10.00	39.79
6,549.0	8.80	278.10	6,540.5	-195.1	150.0	-141.8	5.66	5.53	9.15
6,598.0	11.30	273.00	6,588.8	-194.4	141.5	-133.3	5.41	5.10	-10.41
6,645.0	15.20	267.90	6,634.5	-194.3	130.7	-122.6	8.65	8.30	-10.85
6,693.0	19.10	262.80	6,680.4	-195.6	116.6	-108.4	8.70	8.13	-10.63
6,740.0	22.70	262.90	6,724.3	-197.6	100.0	-91.7	7.66	7.66	0.21
6,788.0	26.30	265.30	6,767.9	-199.7	80.2	-71.9	7.78	7.50	5.00
6,835.0	30.30	268.90	6,809.3	-200.7	58.0	-49.6	9.25	8.51	7.66
6,883.0	35.40	268.60	6,849.6	-201.3	31.9	-23.6	10.63	10.63	-0.63
6,930.0	39.80	268.40	6,886.8	-202.1	3.3	5.1	9.37	9.36	-0.43
6,978.0	42.70	269.80	6,922.9	-202.6	-28.4	36.7	6.34	6.04	2.92
7,025.0	46.90	271.70	6,956.3	-202.1	-61.5	69.8	9.38	8.94	4.04
7,074.0	51.10	271.90	6,988.4	-200.9	-98.4	106.6	8.58	8.57	0.41
7,121.0	57.80	272.40	7,015.7	-199.5	-136.6	144.7	14.28	14.26	1.06
7,169.0	63.40	271.00	7,039.3	-198.3	-178.4	186.4	11.94	11.67	-2.92
7,216.0	66.00	270.50	7,059.4	-197.7	-220.9	228.9	5.61	5.53	-1.06
7,264.0	70.30	270.70	7,077.2	-197.2	-265.4	273.3	8.97	8.96	0.42
7,311.0	72.90	270.70	7,092.1	-196.7	-310.0	317.9	5.53	5.53	0.00
7,359.0	75.10	270.10	7,105.3	-196.4	-356.1	364.0	4.74	4.58	-1.25
7,406.0	75.60	269.80	7,117.2	-196.4	-401.6	409.4	1.23	1.06	-0.64
7,454.0	78.20	268.60	7,128.0	-197.1	-448.3	456.1	5.94	5.42	-2.50
7,501.0	80.90	268.90	7,136.6	-198.1	-494.5	502.3	5.78	5.74	0.64
7,549.0	84.60	269.60	7,142.6	-198.7	-542.2	549.9	7.84	7.71	1.46
7,596.0	87.80	269.80	7,145.7	-199.0	-589.0	596.8	6.82	6.81	0.43
7,615.0	88.30	269.80	7,146.4	-199.0	-608.0	615.8	2.63	2.63	0.00
7,622.0	88.31	270.02	7,146.6	-199.0	-615.0	622.8	3.10	0.10	3.10
T2 660'FSL, 460'FEL, SEC.22									
7,683.0	88.37	271.91	7,148.4	-198.0	-676.0	683.6	3.10	0.10	3.10
7,778.0	88.99	272.27	7,150.6	-194.5	-770.9	778.3	0.75	0.65	0.38
7,872.0	89.60	272.23	7,151.7	-190.8	-864.8	872.0	0.65	0.65	-0.04
7,965.0	89.96	271.82	7,152.1	-187.6	-957.8	964.7	0.59	0.39	-0.44
8,059.0	89.78	271.26	7,152.3	-185.0	-1,051.7	1,058.5	0.63	-0.19	-0.60
8,154.0	90.57	272.04	7,152.0	-182.3	-1,146.7	1,153.3	1.17	0.83	0.82
8,247.0	90.13	272.20	7,151.4	-178.9	-1,239.6	1,246.0	0.50	-0.47	0.17
8,342.0	90.40	272.76	7,151.0	-174.8	-1,334.5	1,340.6	0.65	0.28	0.59
8,436.0	89.43	271.41	7,151.1	-171.3	-1,428.5	1,434.3	1.77	-1.03	-1.44
8,530.0	89.43	271.33	7,152.1	-169.1	-1,522.4	1,528.1	0.09	0.00	-0.09
8,624.0	89.16	271.12	7,153.2	-167.1	-1,616.4	1,621.9	0.36	-0.29	-0.22
8,719.0	89.34	270.73	7,154.5	-165.5	-1,711.4	1,716.8	0.45	0.19	-0.41
8,813.0	88.99	271.90	7,155.8	-163.4	-1,805.3	1,810.6	1.30	-0.37	1.24
8,907.0	89.34	273.07	7,157.2	-159.3	-1,899.2	1,904.2	1.30	0.37	1.24
9,001.0	89.34	272.78	7,158.3	-154.5	-1,993.1	1,997.8	0.31	0.00	-0.31
9,095.0	89.78	272.77	7,159.0	-150.0	-2,087.0	2,091.4	0.47	0.47	-0.01
9,189.0	90.04	272.76	7,159.2	-145.4	-2,180.9	2,185.0	0.28	0.28	-0.01
9,284.0	90.04	272.21	7,159.1	-141.3	-2,275.8	2,279.7	0.58	0.00	-0.58
9,378.0	90.22	271.52	7,158.9	-138.2	-2,369.8	2,373.4	0.76	0.19	-0.73
9,472.0	89.52	269.91	7,159.1	-137.1	-2,463.7	2,467.3	1.87	-0.74	-1.71
9,567.0	90.22	269.85	7,159.3	-137.3	-2,558.7	2,562.2	0.74	0.74	-0.06
9,661.0	90.48	269.45	7,158.7	-137.8	-2,652.7	2,656.2	0.51	0.28	-0.43
9,755.0	90.40	268.64	7,158.0	-139.4	-2,746.7	2,750.1	0.87	-0.09	-0.86

Company:	Tekton Energy	Local Co-ordinate Reference:	Well Diamond Valley East #4
Project:	SEC.23-T6N-R67W	TVD Reference:	WELL @ 4791.5ft (RKB - 22.5')
Site:	Diamond Valley East Pad Sec.23-T6N-R67W	MD Reference:	WELL @ 4791.5ft (RKB - 22.5')
Well:	Diamond Valley East #4	North Reference:	True
Wellbore:	Wellbore #1	Survey Calculation Method:	Minimum Curvature
Design:	Wellbore #1	Database:	Landmark

Survey

Measured Depth (ft)	Inclination (°)	Azimuth (°)	Vertical Depth (ft)	+N/-S (ft)	+E/-W (ft)	Vertical Section (ft)	Dogleg Rate (°/100ft)	Build Rate (°/100ft)	Turn Rate (°/100ft)
9,773.4	90.35	268.51	7,157.9	-139.9	-2,765.1	2,768.5	0.74	-0.29	-0.68
WP1									
9,800.2	90.27	268.33	7,157.7	-140.6	-2,791.9	2,795.3	0.74	-0.29	-0.68
WP2									
9,849.0	90.13	268.00	7,157.6	-142.2	-2,840.7	2,844.1	0.74	-0.29	-0.68
9,944.0	89.96	267.31	7,157.5	-146.1	-2,935.6	2,939.1	0.75	-0.18	-0.73
10,038.0	89.43	265.88	7,158.0	-151.6	-3,029.4	3,033.1	1.62	-0.56	-1.52
10,132.0	89.16	266.38	7,159.2	-158.0	-3,123.2	3,127.1	0.60	-0.29	0.53
10,226.0	89.25	266.88	7,160.5	-163.5	-3,217.0	3,221.0	0.54	0.10	0.53
10,320.0	89.25	268.16	7,161.7	-167.6	-3,310.9	3,315.0	1.36	0.00	1.36
10,414.0	89.43	268.29	7,162.8	-170.5	-3,404.9	3,409.0	0.24	0.19	0.14
10,508.0	89.25	268.15	7,163.9	-173.4	-3,498.8	3,503.0	0.24	-0.19	-0.15
10,602.0	89.43	268.13	7,164.9	-176.5	-3,592.8	3,597.0	0.19	0.19	-0.02
10,695.0	89.96	268.95	7,165.4	-178.8	-3,685.7	3,690.0	1.05	0.57	0.88
10,788.0	90.84	269.24	7,164.8	-180.3	-3,778.7	3,783.0	1.00	0.95	0.31
10,881.0	90.84	268.88	7,163.4	-181.8	-3,871.7	3,875.9	0.39	0.00	-0.39
10,974.0	89.43	268.62	7,163.2	-183.9	-3,964.7	3,968.9	1.54	-1.52	-0.28
11,068.0	89.78	268.68	7,163.8	-186.1	-4,058.7	4,062.9	0.38	0.37	0.06
11,162.0	90.57	268.78	7,163.6	-188.1	-4,152.6	4,156.9	0.85	0.84	0.11
11,256.0	89.25	268.67	7,163.7	-190.2	-4,246.6	4,250.8	1.41	-1.40	-0.12
11,350.0	89.34	268.83	7,164.9	-192.3	-4,340.6	4,344.8	0.20	0.10	0.17
11,444.0	89.43	268.83	7,165.9	-194.2	-4,434.6	4,438.8	0.10	0.10	0.00
11,538.0	89.60	269.34	7,166.7	-195.7	-4,528.5	4,532.8	0.57	0.18	0.54
11,633.0	90.66	270.71	7,166.5	-195.7	-4,623.5	4,627.7	1.82	1.12	1.44
11,728.0	90.31	270.82	7,165.6	-194.4	-4,718.5	4,722.5	0.39	-0.37	0.12
11,833.0	90.48	270.51	7,164.9	-193.2	-4,823.5	4,827.4	0.34	0.16	-0.30
11,915.0	90.48	270.51	7,164.2	-192.5	-4,905.5	4,909.3	0.00	0.00	0.00
BHL 660'FSL, 460'FWL, SEC.22									

Checked By: _____ Approved By: _____ Date: _____