

EE3 LLC

LOCATION OVERVIEW DRAWING
SURPRISE CENTRAL FACILITY
SECTION 4, T6N, R80W, 6th PM
SW1/4

Brass Cap 1941
0.5' above ground



GRAPHIC SCALE

1"=500'

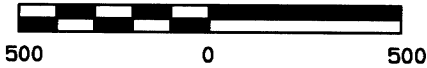

NW1/4SW1/4

NE1/4SW1/4

SURPRISE CENTRAL FACILITY

40.515287°N (NAD83)
106.387483°W

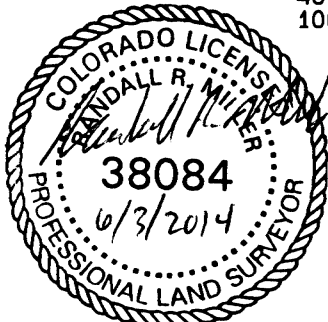

Brass Cap 1941
0.4' above ground
Elev.=8222'

Overhead Power
(Future)

SW1/4SW1/4

SE1/4SW1/4

JACKSON COUNTY
ROAD 11

FENCE (TYP)

Sec 5

Sec 4

Sec 8

Sec 9

SURPRISE 2-08H

Surface Location (NAD 83)
Lat: 40.511158°N
Long: 106.391600°W

NE1/4NE1/4

CULTURAL FEATURE TABLE

EXISTING FEATURE	DIRECTION	LENGTH
PUBLIC ROAD (JCR 11)	N67°01'E	200'
RAILROAD		+5280'
PROPERTY LINE	WEST	350'
PROPERTY LINE	EAST	1382'
FUTURE POWER LINE	N66°56'E	253'
BUILDING (BARN)		+5280'
BUILDING UNIT		+5280'
HO BUILDING UNIT		+5280'
DESIGNATED OUTSIDE AREA		+5280'

DISTURBED AREA FOR PRODUCTION PAD

PAD AREA=10.0 Ac
NEW ACCESS ROAD=(40'x200')/43560=0.22 Ac (PLUS FLARE)
TOTAL= 10.22 Ac

PLANT COMMUNITY

- ☐ DISTURBED GRASSLAND
- ☒ NATIVE GRASSLAND
- ☐ SHRUB LAND
- ☐ PLAINS RIPARIAN
- ☐ MOUNTAIN RIPARIAN
- ☐ FOREST LAND
- ☐ WETLANDS AQUATIC
- ☐ ALPINE
- ☐ OTHER (Describe):

CURRENT LAND USE

- | | | | | | |
|--|---|-------------------------------------|---|---|------------------------------|
| <input type="checkbox"/> CROP LAND | <input type="checkbox"/> IRRIGATED | <input type="checkbox"/> DRY LAND | <input type="checkbox"/> IMPROVED PASTURE | <input type="checkbox"/> HAY MEADOW | <input type="checkbox"/> CRP |
| <input type="checkbox"/> NON-CROP LAND | <input checked="" type="checkbox"/> RANGELAND | <input type="checkbox"/> TIMBER | <input type="checkbox"/> RECREATIONAL | <input type="checkbox"/> OTHER (Describe) | |
| <input type="checkbox"/> SUBDIVIDED | <input type="checkbox"/> INDUSTRIAL | <input type="checkbox"/> COMMERCIAL | <input type="checkbox"/> RESIDENTIAL | | |

FUTURE LAND USE

- | | | | | | |
|--|-------------------------------------|-------------------------------------|---|---|------------------------------|
| <input type="checkbox"/> CROP LAND | <input type="checkbox"/> IRRIGATED | <input type="checkbox"/> DRY LAND | <input type="checkbox"/> IMPROVED PASTURE | <input type="checkbox"/> HAY MEADOW | <input type="checkbox"/> CRP |
| <input type="checkbox"/> NON-CROP LAND | <input type="checkbox"/> RANGELAND | <input type="checkbox"/> TIMBER | <input type="checkbox"/> RECREATIONAL | <input type="checkbox"/> OTHER (Describe) | |
| <input type="checkbox"/> SUBDIVIDED | <input type="checkbox"/> INDUSTRIAL | <input type="checkbox"/> COMMERCIAL | <input type="checkbox"/> RESIDENTIAL | | |

EE3 LLC
 SURPRISE CENTRAL FACILITY
 LOCATED IN SW1/4
 SECTION 4, T6N, R80W, 6th PM

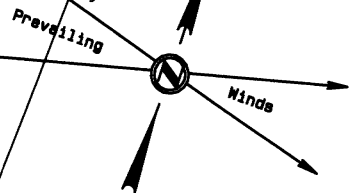

GPS LOCATION

40.515287103°N
 106.387483264°W
 Undisturbed Ground
 Elev.=8247.3'
 PDOP=1.801 (NAD83)
 Meas by R. Shaw 6/3/14

OPTIONAL EXPANSION
 (5.0 AC)

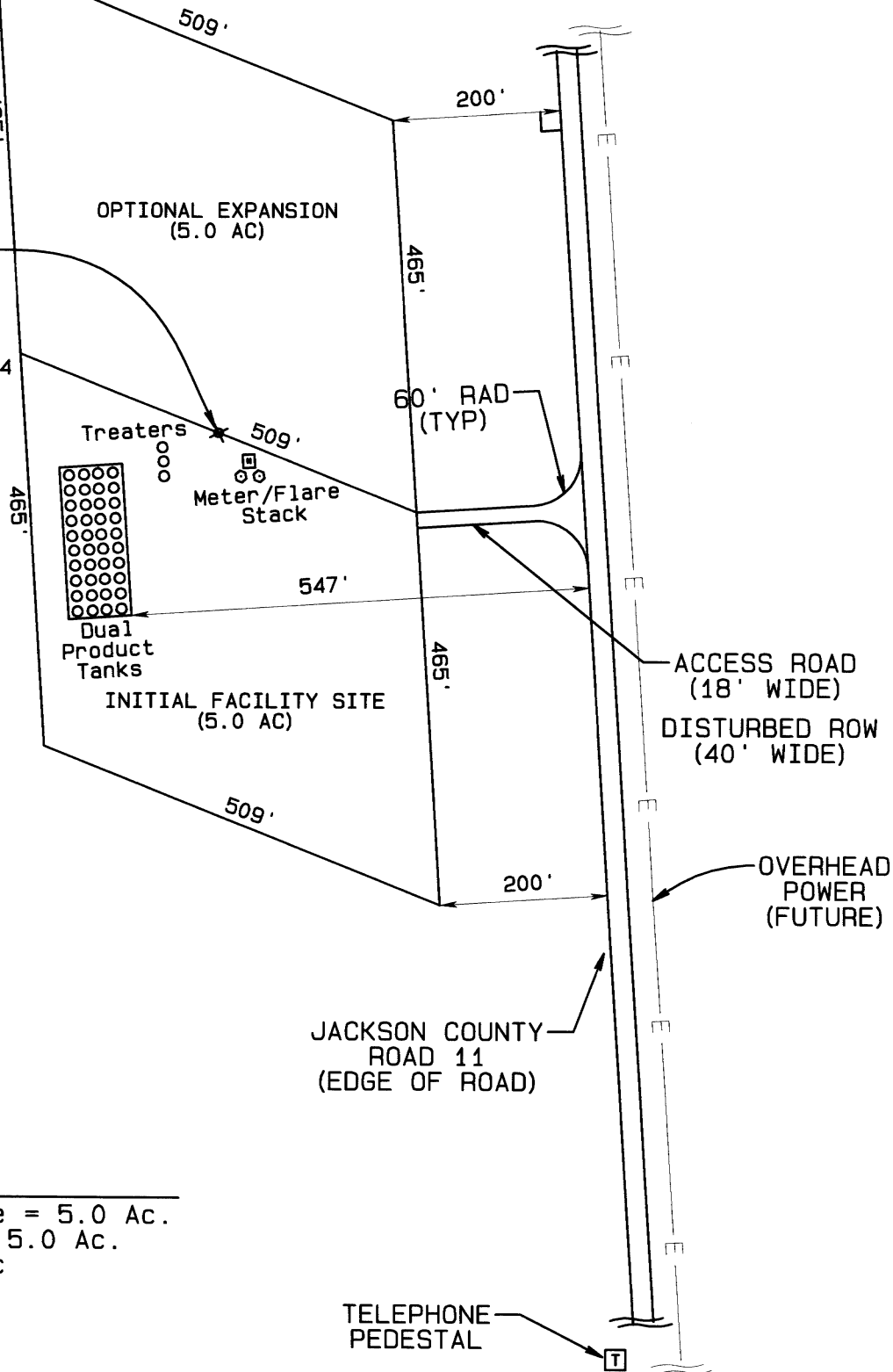

DISTURBED AREA

Initial Facility Site = 5.0 Ac.
 Optional Expansion = 5.0 Ac.
 Access Road = 0.22 Ac
 TOTAL = 10.22 Ac

BASIS OF ELEVATION

SPOT ELEVATION AT THE SE CORNER OF SECTION 4,
 T6N, R80W, 6TH PM. TAKEN FROM THE COALMONT
 QUADRANGLE, USGS 7.5 MIN QUAD (TOPOGRAPHIC MAP)
 WITH SAID ELEVATION MARKED AS BEING 8222 FEET.

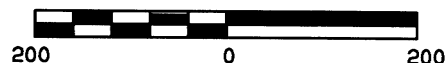

GRAPHIC SCALE 1"=200'

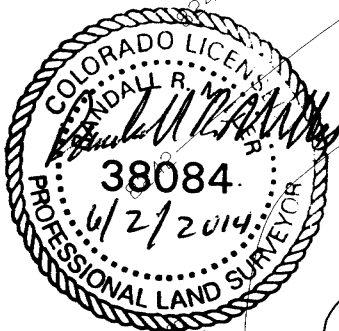
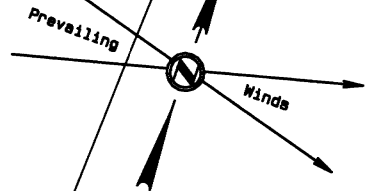

EE3 LLC

CONSTRUCTION LAYOUT
SURPRISE CENTRAL FACILITY
LOCATED IN SW1/4
SECTION 4, T6N, R80W, 6th PM



CUT AREA 
FILL AREA 

DISTURBED AREA

Initial Facility Site = 5.0 Ac.
Optional Expansion = 5.0 Ac.
Access Road w/ 40 Disturbed ROW = 0.22 Ac
TOTAL = 10.22 Ac

BASIS OF ELEVATION

SPOT ELEVATION AT THE SE CORNER OF
SECTION 4, T6N, R80W, 6TH PM. TAKEN
FROM THE COALMONT QUADRANGLE,
USGS 7.5 MIN QUAD (TOPOGRAPHIC MAP)
WITH SAID ELEVATION MARKED
AS BEING 8222 FEET.

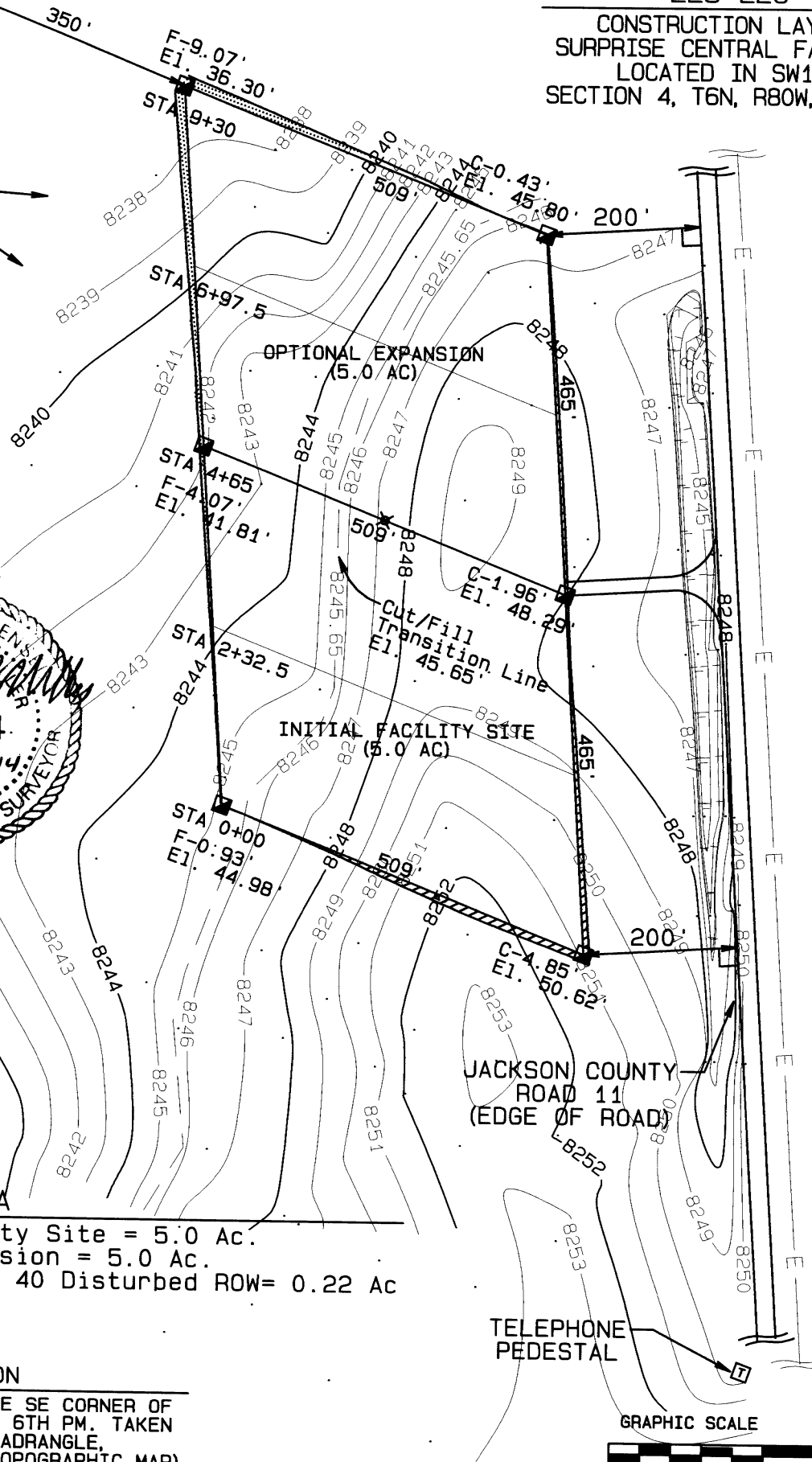

GRAPHIC SCALE 1"=200'

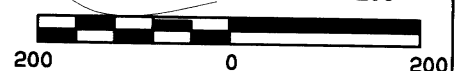

EE3 LLC
CONSTRUCTION LAYOUT CROSS SECTION
SURPRISE CENTRAL FACILITY
LOCATED IN SW1/4
SECTION 4, T6N, R80W, 6th PM

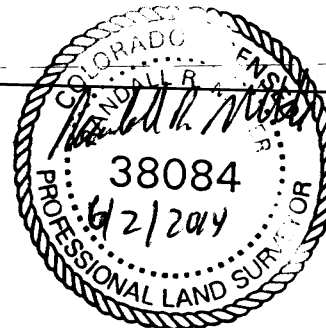
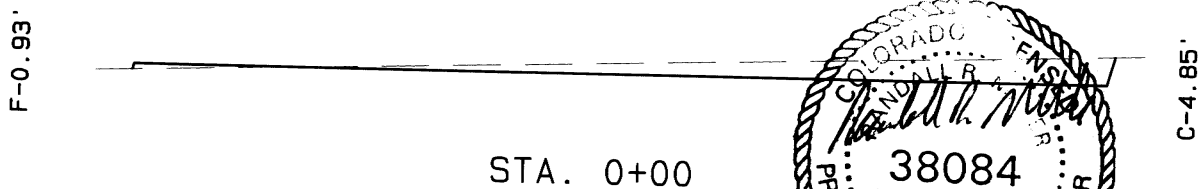
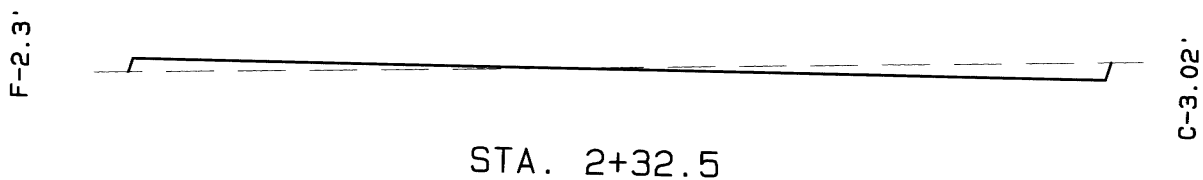
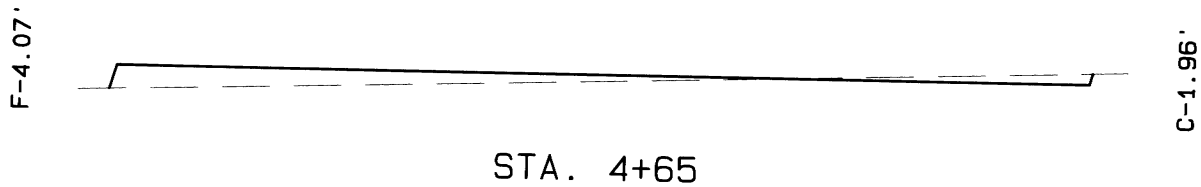
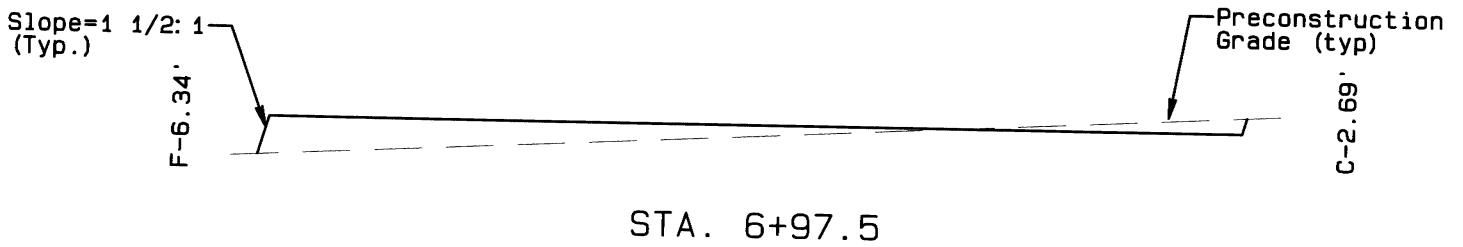
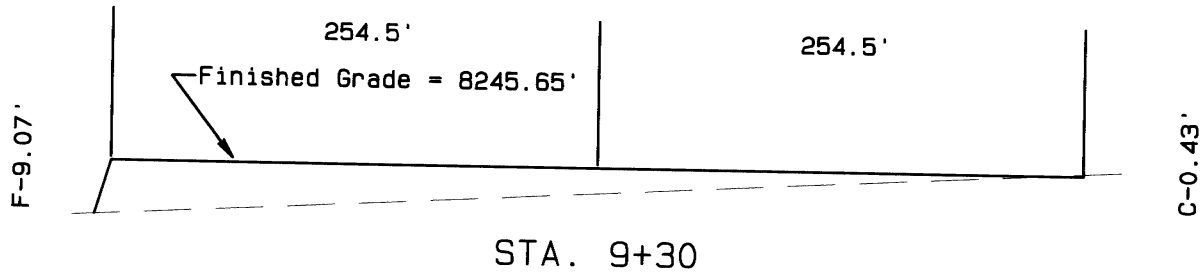

VERTICAL EXAGGERATION = 3 times

