



Physical Address: 345 Comanche St.
Mail to: Box 384, Kiowa, CO 80117
Ph. 303-621-8672 - Fax 303-621-7749
www.highprairiesurvey.com

Job # 13171 Big Wampur #10

Inv # 3293

High Prairie Surveying of Kiowa, Colorado, in accordance with a request from **Wiepking Fullerton**, has determined the location of **Big Wampur #10** to be **1980 feet FSL**, and **1980 feet FWL**, (90° off Section lines) of **SECTION 23**, Township **10s**, Range **56w** of the 6th Principal Meridian, **Lincoln County**, Colorado.

Date: Staked on 07/2/14 drawn on 7/21/14.

Re: Staked by Elijah Frane
Drawn: Drawn by Dustin Cotter

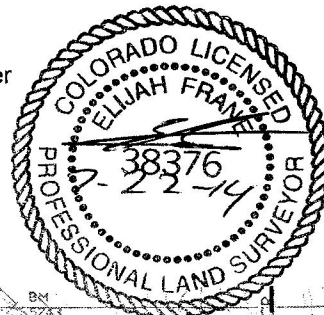

Access Road Map

