

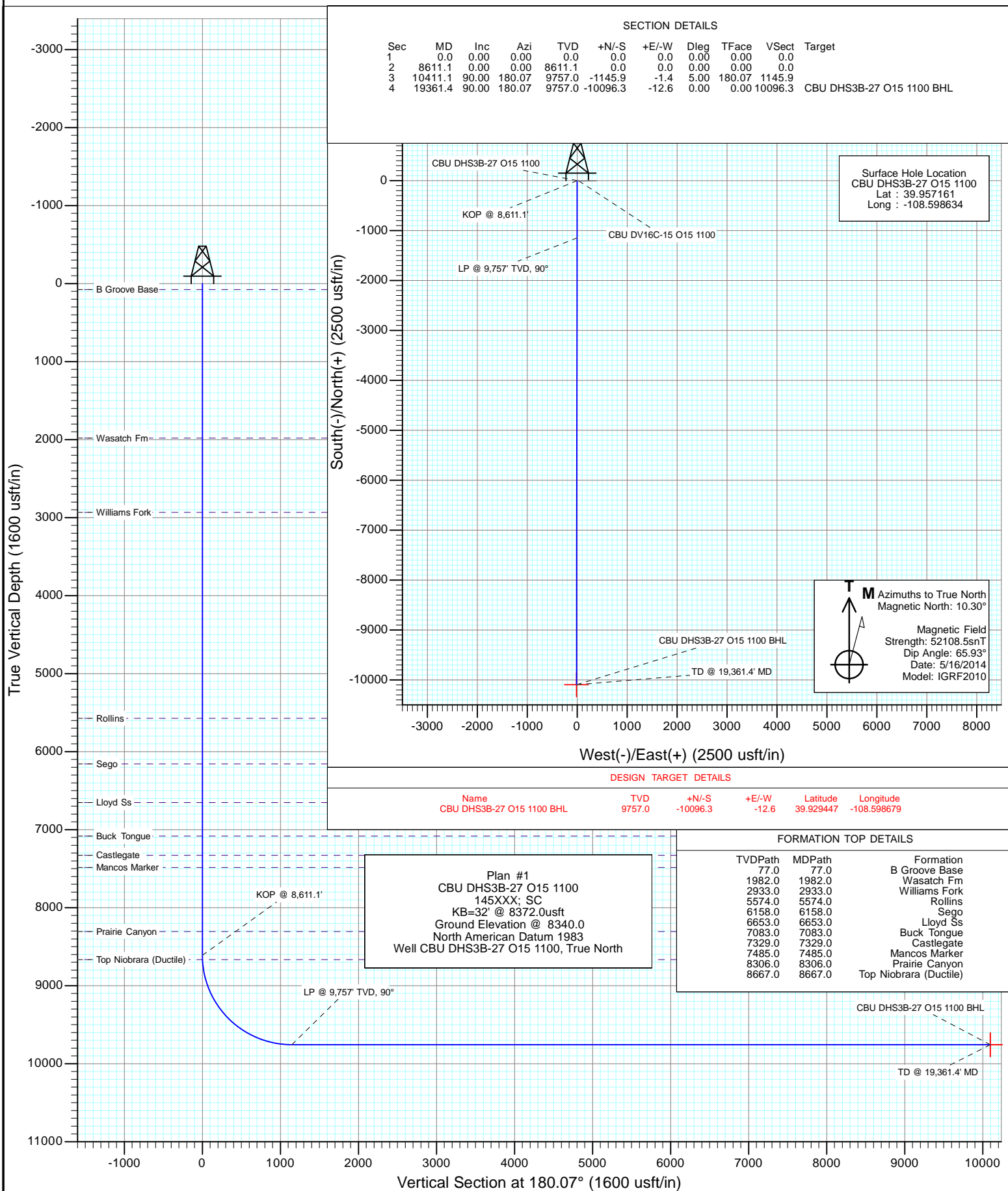

Project: Cathedral Bluffs
Site: O15 Pad (Sec 15-1S-100W)
Well: CBU DHS3B-27 O15 1100
Wellbore: HZ
Design: Plan #1



Cathedral Energy Services

Planning Report

| | | | |
|------------------|-----------------------------|-------------------------------------|----------------------------|
| Database: | USA EDM 5000 Multi Users DB | Local Co-ordinate Reference: | Well CBU DHS3B-27 O15 1100 |
| Company: | EnCana Oil & Gas (USA) Inc | TVD Reference: | KB=32' @ 8372.0usft |
| Project: | Cathedral Bluffs | MD Reference: | KB=32' @ 8372.0usft |
| Site: | O15 Pad (Sec 15-1S-100W) | North Reference: | True |
| Well: | CBU DHS3B-27 O15 1100 | Survey Calculation Method: | Minimum Curvature |
| Wellbore: | HZ | | |
| Design: | Plan #1 | | |

| | | | |
|--------------------|---------------------------|----------------------|----------------|
| Project | Cathedral Bluffs | | |
| Map System: | US State Plane 1983 | System Datum: | Mean Sea Level |
| Geo Datum: | North American Datum 1983 | | |
| Map Zone: | Colorado Central Zone | | |

| | | | | | |
|-----------------------|----------|---------------------------|-------------------|-------------------|-------------|
| Site | | O15 Pad (Sec 15-1S-100W) | | | |
| Site Position: | | Northing: | 1,788,339.37 usft | Latitude: | 39.957144 |
| From: | Lat/Long | Easting: | 2,131,496.27 usft | Longitude: | -108.598512 |
| Position Uncertainty: | 0.0 usft | Slot Radius: | 13-3/16" | Grid Convergence: | -1.95 ° |

| | | | | | | |
|----------------------|-----------------------|----------|---------------------|-------------------|---------------|--------------|
| Well | CBU DHS3B-27 O15 1100 | | | | | |
| Well Position | +N/-S | 0.0 usft | Northing: | 1,788,346.81 usft | Latitude: | 39.957161 |
| | +E/-W | 0.0 usft | Easting: | 2,131,462.09 usft | Longitude: | -108.598634 |
| Position Uncertainty | | 0.0 usft | Wellhead Elevation: | 0.0 usft | Ground Level: | 8,340.0 usft |

| | | | | | |
|------------------|-------------------|--------------------|------------------------|----------------------|----------------------------|
| Wellbore | HZ | | | | |
| Magnetics | Model Name | Sample Date | Declination (°) | Dip Angle (°) | Field Strength (nT) |
| | IGRF2010 | 5/16/2014 | 10.30 | 65.93 | 52,109 |

| | | | | | |
|--------------------------|--------------------------------|---------------------|----------------------|----------------------|--|
| Design | Plan #1 | | | | |
| Audit Notes: | | | | | |
| Version: | Phase: | PLAN | Tie On Depth: | 0.0 | |
| Vertical Section: | Depth From (TVD) (usft) | +N/-S (usft) | +E/-W (usft) | Direction (°) | |
| | 0.0 | 0.0 | 0.0 | 180.07 | |

| Plan Sections | | | | | | | | | | |
|-----------------------|-----------------|-------------|-----------------------|--------------|--------------|-------------------------|------------------------|-----------------------|---------|------------------|
| Measured Depth (usft) | Inclination (°) | Azimuth (°) | Vertical Depth (usft) | +N/-S (usft) | +E/-W (usft) | Dogleg Rate (°/100usft) | Build Rate (°/100usft) | Turn Rate (°/100usft) | TFO (°) | Target |
| 0.0 | 0.00 | 0.00 | 0.0 | 0.0 | 0.0 | 0.00 | 0.00 | 0.00 | 0.00 | |
| 8,611.1 | 0.00 | 0.00 | 8,611.1 | 0.0 | 0.0 | 0.00 | 0.00 | 0.00 | 0.00 | |
| 10,411.1 | 90.00 | 180.07 | 9,757.0 | -1,145.9 | -1.4 | 5.00 | 5.00 | 0.00 | 180.07 | |
| 19,361.4 | 90.00 | 180.07 | 9,757.0 | -10,096.3 | -12.6 | 0.00 | 0.00 | 0.00 | 0.00 | CBU DHS3B-27 O15 |

Cathedral Energy Services

Planning Report

| | | | |
|------------------|-----------------------------|-------------------------------------|----------------------------|
| Database: | USA EDM 5000 Multi Users DB | Local Co-ordinate Reference: | Well CBU DHS3B-27 O15 1100 |
| Company: | EnCana Oil & Gas (USA) Inc | TVD Reference: | KB=32' @ 8372.0usft |
| Project: | Cathedral Bluffs | MD Reference: | KB=32' @ 8372.0usft |
| Site: | O15 Pad (Sec 15-1S-100W) | North Reference: | True |
| Well: | CBU DHS3B-27 O15 1100 | Survey Calculation Method: | Minimum Curvature |
| Wellbore: | HZ | | |
| Design: | Plan #1 | | |

Planned Survey

| Measured Depth (usft) | Inclination (°) | Azimuth (°) | Vertical Depth (usft) | +N/-S (usft) | +E/-W (usft) | Vertical Section (usft) | Dogleg Rate (°/100usft) | Build Rate (°/100u) | Comments / Formations |
|-----------------------|-----------------|-------------|-----------------------|--------------|--------------|-------------------------|-------------------------|---------------------|-----------------------|
| 0.0 | 0.00 | 0.00 | 0.0 | 0.0 | 0.0 | 0.0 | 0.00 | 0.00 | |
| 77.0 | 0.00 | 0.00 | 77.0 | 0.0 | 0.0 | 0.0 | 0.00 | 0.00 | B Groove Base |
| 100.0 | 0.00 | 0.00 | 100.0 | 0.0 | 0.0 | 0.0 | 0.00 | 0.00 | |
| 200.0 | 0.00 | 0.00 | 200.0 | 0.0 | 0.0 | 0.0 | 0.00 | 0.00 | |
| 300.0 | 0.00 | 0.00 | 300.0 | 0.0 | 0.0 | 0.0 | 0.00 | 0.00 | |
| 400.0 | 0.00 | 0.00 | 400.0 | 0.0 | 0.0 | 0.0 | 0.00 | 0.00 | |
| 500.0 | 0.00 | 0.00 | 500.0 | 0.0 | 0.0 | 0.0 | 0.00 | 0.00 | |
| 600.0 | 0.00 | 0.00 | 600.0 | 0.0 | 0.0 | 0.0 | 0.00 | 0.00 | |
| 700.0 | 0.00 | 0.00 | 700.0 | 0.0 | 0.0 | 0.0 | 0.00 | 0.00 | |
| 800.0 | 0.00 | 0.00 | 800.0 | 0.0 | 0.0 | 0.0 | 0.00 | 0.00 | |
| 900.0 | 0.00 | 0.00 | 900.0 | 0.0 | 0.0 | 0.0 | 0.00 | 0.00 | |
| 1,000.0 | 0.00 | 0.00 | 1,000.0 | 0.0 | 0.0 | 0.0 | 0.00 | 0.00 | |
| 1,100.0 | 0.00 | 0.00 | 1,100.0 | 0.0 | 0.0 | 0.0 | 0.00 | 0.00 | |
| 1,200.0 | 0.00 | 0.00 | 1,200.0 | 0.0 | 0.0 | 0.0 | 0.00 | 0.00 | |
| 1,300.0 | 0.00 | 0.00 | 1,300.0 | 0.0 | 0.0 | 0.0 | 0.00 | 0.00 | |
| 1,400.0 | 0.00 | 0.00 | 1,400.0 | 0.0 | 0.0 | 0.0 | 0.00 | 0.00 | |
| 1,500.0 | 0.00 | 0.00 | 1,500.0 | 0.0 | 0.0 | 0.0 | 0.00 | 0.00 | |
| 1,600.0 | 0.00 | 0.00 | 1,600.0 | 0.0 | 0.0 | 0.0 | 0.00 | 0.00 | |
| 1,700.0 | 0.00 | 0.00 | 1,700.0 | 0.0 | 0.0 | 0.0 | 0.00 | 0.00 | |
| 1,800.0 | 0.00 | 0.00 | 1,800.0 | 0.0 | 0.0 | 0.0 | 0.00 | 0.00 | |
| 1,900.0 | 0.00 | 0.00 | 1,900.0 | 0.0 | 0.0 | 0.0 | 0.00 | 0.00 | |
| 1,982.0 | 0.00 | 0.00 | 1,982.0 | 0.0 | 0.0 | 0.0 | 0.00 | 0.00 | Wasatch Fm |
| 2,000.0 | 0.00 | 0.00 | 2,000.0 | 0.0 | 0.0 | 0.0 | 0.00 | 0.00 | |
| 2,100.0 | 0.00 | 0.00 | 2,100.0 | 0.0 | 0.0 | 0.0 | 0.00 | 0.00 | |
| 2,200.0 | 0.00 | 0.00 | 2,200.0 | 0.0 | 0.0 | 0.0 | 0.00 | 0.00 | |
| 2,300.0 | 0.00 | 0.00 | 2,300.0 | 0.0 | 0.0 | 0.0 | 0.00 | 0.00 | |
| 2,400.0 | 0.00 | 0.00 | 2,400.0 | 0.0 | 0.0 | 0.0 | 0.00 | 0.00 | |
| 2,500.0 | 0.00 | 0.00 | 2,500.0 | 0.0 | 0.0 | 0.0 | 0.00 | 0.00 | |
| 2,600.0 | 0.00 | 0.00 | 2,600.0 | 0.0 | 0.0 | 0.0 | 0.00 | 0.00 | |
| 2,700.0 | 0.00 | 0.00 | 2,700.0 | 0.0 | 0.0 | 0.0 | 0.00 | 0.00 | |
| 2,800.0 | 0.00 | 0.00 | 2,800.0 | 0.0 | 0.0 | 0.0 | 0.00 | 0.00 | |
| 2,900.0 | 0.00 | 0.00 | 2,900.0 | 0.0 | 0.0 | 0.0 | 0.00 | 0.00 | |
| 2,933.0 | 0.00 | 0.00 | 2,933.0 | 0.0 | 0.0 | 0.0 | 0.00 | 0.00 | Williams Fork |
| 3,000.0 | 0.00 | 0.00 | 3,000.0 | 0.0 | 0.0 | 0.0 | 0.00 | 0.00 | |
| 3,100.0 | 0.00 | 0.00 | 3,100.0 | 0.0 | 0.0 | 0.0 | 0.00 | 0.00 | |
| 3,200.0 | 0.00 | 0.00 | 3,200.0 | 0.0 | 0.0 | 0.0 | 0.00 | 0.00 | |
| 3,300.0 | 0.00 | 0.00 | 3,300.0 | 0.0 | 0.0 | 0.0 | 0.00 | 0.00 | |
| 3,400.0 | 0.00 | 0.00 | 3,400.0 | 0.0 | 0.0 | 0.0 | 0.00 | 0.00 | |
| 3,500.0 | 0.00 | 0.00 | 3,500.0 | 0.0 | 0.0 | 0.0 | 0.00 | 0.00 | |
| 3,600.0 | 0.00 | 0.00 | 3,600.0 | 0.0 | 0.0 | 0.0 | 0.00 | 0.00 | |
| 3,700.0 | 0.00 | 0.00 | 3,700.0 | 0.0 | 0.0 | 0.0 | 0.00 | 0.00 | |
| 3,800.0 | 0.00 | 0.00 | 3,800.0 | 0.0 | 0.0 | 0.0 | 0.00 | 0.00 | |
| 3,900.0 | 0.00 | 0.00 | 3,900.0 | 0.0 | 0.0 | 0.0 | 0.00 | 0.00 | |
| 4,000.0 | 0.00 | 0.00 | 4,000.0 | 0.0 | 0.0 | 0.0 | 0.00 | 0.00 | |
| 4,100.0 | 0.00 | 0.00 | 4,100.0 | 0.0 | 0.0 | 0.0 | 0.00 | 0.00 | |
| 4,200.0 | 0.00 | 0.00 | 4,200.0 | 0.0 | 0.0 | 0.0 | 0.00 | 0.00 | |
| 4,300.0 | 0.00 | 0.00 | 4,300.0 | 0.0 | 0.0 | 0.0 | 0.00 | 0.00 | |
| 4,400.0 | 0.00 | 0.00 | 4,400.0 | 0.0 | 0.0 | 0.0 | 0.00 | 0.00 | |
| 4,500.0 | 0.00 | 0.00 | 4,500.0 | 0.0 | 0.0 | 0.0 | 0.00 | 0.00 | |
| 4,600.0 | 0.00 | 0.00 | 4,600.0 | 0.0 | 0.0 | 0.0 | 0.00 | 0.00 | |
| 4,700.0 | 0.00 | 0.00 | 4,700.0 | 0.0 | 0.0 | 0.0 | 0.00 | 0.00 | |
| 4,800.0 | 0.00 | 0.00 | 4,800.0 | 0.0 | 0.0 | 0.0 | 0.00 | 0.00 | |

Cathedral Energy Services

Planning Report

| | | | |
|------------------|-----------------------------|-------------------------------------|----------------------------|
| Database: | USA EDM 5000 Multi Users DB | Local Co-ordinate Reference: | Well CBU DHS3B-27 O15 1100 |
| Company: | EnCana Oil & Gas (USA) Inc | TVD Reference: | KB=32' @ 8372.0usft |
| Project: | Cathedral Bluffs | MD Reference: | KB=32' @ 8372.0usft |
| Site: | O15 Pad (Sec 15-1S-100W) | North Reference: | True |
| Well: | CBU DHS3B-27 O15 1100 | Survey Calculation Method: | Minimum Curvature |
| Wellbore: | HZ | | |
| Design: | Plan #1 | | |

Planned Survey

| Measured Depth (usft) | Inclination (°) | Azimuth (°) | Vertical Depth (usft) | +N/-S (usft) | +E/-W (usft) | Vertical Section (usft) | Dogleg Rate (°/100usft) | Build Rate (°/100u) | Comments / Formations |
|-----------------------|-----------------|-------------|-----------------------|--------------|--------------|-------------------------|-------------------------|---------------------|------------------------|
| 4,900.0 | 0.00 | 0.00 | 4,900.0 | 0.0 | 0.0 | 0.0 | 0.00 | 0.00 | |
| 5,000.0 | 0.00 | 0.00 | 5,000.0 | 0.0 | 0.0 | 0.0 | 0.00 | 0.00 | |
| 5,100.0 | 0.00 | 0.00 | 5,100.0 | 0.0 | 0.0 | 0.0 | 0.00 | 0.00 | |
| 5,200.0 | 0.00 | 0.00 | 5,200.0 | 0.0 | 0.0 | 0.0 | 0.00 | 0.00 | |
| 5,300.0 | 0.00 | 0.00 | 5,300.0 | 0.0 | 0.0 | 0.0 | 0.00 | 0.00 | |
| 5,400.0 | 0.00 | 0.00 | 5,400.0 | 0.0 | 0.0 | 0.0 | 0.00 | 0.00 | |
| 5,500.0 | 0.00 | 0.00 | 5,500.0 | 0.0 | 0.0 | 0.0 | 0.00 | 0.00 | |
| 5,574.0 | 0.00 | 0.00 | 5,574.0 | 0.0 | 0.0 | 0.0 | 0.00 | 0.00 | Rollins |
| 5,600.0 | 0.00 | 0.00 | 5,600.0 | 0.0 | 0.0 | 0.0 | 0.00 | 0.00 | |
| 5,700.0 | 0.00 | 0.00 | 5,700.0 | 0.0 | 0.0 | 0.0 | 0.00 | 0.00 | |
| 5,800.0 | 0.00 | 0.00 | 5,800.0 | 0.0 | 0.0 | 0.0 | 0.00 | 0.00 | |
| 5,900.0 | 0.00 | 0.00 | 5,900.0 | 0.0 | 0.0 | 0.0 | 0.00 | 0.00 | |
| 6,000.0 | 0.00 | 0.00 | 6,000.0 | 0.0 | 0.0 | 0.0 | 0.00 | 0.00 | |
| 6,100.0 | 0.00 | 0.00 | 6,100.0 | 0.0 | 0.0 | 0.0 | 0.00 | 0.00 | |
| 6,158.0 | 0.00 | 0.00 | 6,158.0 | 0.0 | 0.0 | 0.0 | 0.00 | 0.00 | Sego |
| 6,200.0 | 0.00 | 0.00 | 6,200.0 | 0.0 | 0.0 | 0.0 | 0.00 | 0.00 | |
| 6,300.0 | 0.00 | 0.00 | 6,300.0 | 0.0 | 0.0 | 0.0 | 0.00 | 0.00 | |
| 6,400.0 | 0.00 | 0.00 | 6,400.0 | 0.0 | 0.0 | 0.0 | 0.00 | 0.00 | |
| 6,500.0 | 0.00 | 0.00 | 6,500.0 | 0.0 | 0.0 | 0.0 | 0.00 | 0.00 | |
| 6,600.0 | 0.00 | 0.00 | 6,600.0 | 0.0 | 0.0 | 0.0 | 0.00 | 0.00 | |
| 6,653.0 | 0.00 | 0.00 | 6,653.0 | 0.0 | 0.0 | 0.0 | 0.00 | 0.00 | Lloyd Ss |
| 6,700.0 | 0.00 | 0.00 | 6,700.0 | 0.0 | 0.0 | 0.0 | 0.00 | 0.00 | |
| 6,800.0 | 0.00 | 0.00 | 6,800.0 | 0.0 | 0.0 | 0.0 | 0.00 | 0.00 | |
| 6,900.0 | 0.00 | 0.00 | 6,900.0 | 0.0 | 0.0 | 0.0 | 0.00 | 0.00 | |
| 7,000.0 | 0.00 | 0.00 | 7,000.0 | 0.0 | 0.0 | 0.0 | 0.00 | 0.00 | |
| 7,083.0 | 0.00 | 0.00 | 7,083.0 | 0.0 | 0.0 | 0.0 | 0.00 | 0.00 | Buck Tongue |
| 7,100.0 | 0.00 | 0.00 | 7,100.0 | 0.0 | 0.0 | 0.0 | 0.00 | 0.00 | |
| 7,200.0 | 0.00 | 0.00 | 7,200.0 | 0.0 | 0.0 | 0.0 | 0.00 | 0.00 | |
| 7,300.0 | 0.00 | 0.00 | 7,300.0 | 0.0 | 0.0 | 0.0 | 0.00 | 0.00 | |
| 7,329.0 | 0.00 | 0.00 | 7,329.0 | 0.0 | 0.0 | 0.0 | 0.00 | 0.00 | Castlegate |
| 7,400.0 | 0.00 | 0.00 | 7,400.0 | 0.0 | 0.0 | 0.0 | 0.00 | 0.00 | |
| 7,485.0 | 0.00 | 0.00 | 7,485.0 | 0.0 | 0.0 | 0.0 | 0.00 | 0.00 | Mancos Marker |
| 7,500.0 | 0.00 | 0.00 | 7,500.0 | 0.0 | 0.0 | 0.0 | 0.00 | 0.00 | |
| 7,600.0 | 0.00 | 0.00 | 7,600.0 | 0.0 | 0.0 | 0.0 | 0.00 | 0.00 | |
| 7,700.0 | 0.00 | 0.00 | 7,700.0 | 0.0 | 0.0 | 0.0 | 0.00 | 0.00 | |
| 7,800.0 | 0.00 | 0.00 | 7,800.0 | 0.0 | 0.0 | 0.0 | 0.00 | 0.00 | |
| 7,900.0 | 0.00 | 0.00 | 7,900.0 | 0.0 | 0.0 | 0.0 | 0.00 | 0.00 | |
| 8,000.0 | 0.00 | 0.00 | 8,000.0 | 0.0 | 0.0 | 0.0 | 0.00 | 0.00 | |
| 8,100.0 | 0.00 | 0.00 | 8,100.0 | 0.0 | 0.0 | 0.0 | 0.00 | 0.00 | |
| 8,200.0 | 0.00 | 0.00 | 8,200.0 | 0.0 | 0.0 | 0.0 | 0.00 | 0.00 | |
| 8,300.0 | 0.00 | 0.00 | 8,300.0 | 0.0 | 0.0 | 0.0 | 0.00 | 0.00 | |
| 8,306.0 | 0.00 | 0.00 | 8,306.0 | 0.0 | 0.0 | 0.0 | 0.00 | 0.00 | Prairie Canyon |
| 8,400.0 | 0.00 | 0.00 | 8,400.0 | 0.0 | 0.0 | 0.0 | 0.00 | 0.00 | |
| 8,500.0 | 0.00 | 0.00 | 8,500.0 | 0.0 | 0.0 | 0.0 | 0.00 | 0.00 | |
| 8,600.0 | 0.00 | 0.00 | 8,600.0 | 0.0 | 0.0 | 0.0 | 0.00 | 0.00 | |
| 8,611.1 | 0.00 | 0.00 | 8,611.1 | 0.0 | 0.0 | 0.0 | 0.00 | 0.00 | KOP @ 8,611.1' |
| 8,667.0 | 2.80 | 180.07 | 8,667.0 | -1.4 | 0.0 | 1.4 | 5.00 | 5.00 | Top Niobrara (Ductile) |
| 8,700.0 | 4.45 | 180.07 | 8,699.9 | -3.4 | 0.0 | 3.4 | 5.00 | 5.00 | |
| 8,800.0 | 9.45 | 180.07 | 8,799.1 | -15.5 | 0.0 | 15.5 | 5.00 | 5.00 | |
| 8,900.0 | 14.45 | 180.07 | 8,896.9 | -36.2 | 0.0 | 36.2 | 5.00 | 5.00 | |
| 9,000.0 | 19.45 | 180.07 | 8,992.6 | -65.4 | -0.1 | 65.4 | 5.00 | 5.00 | |
| 9,100.0 | 24.45 | 180.07 | 9,085.3 | -102.7 | -0.1 | 102.7 | 5.00 | 5.00 | |

Cathedral Energy Services

Planning Report

| | | | |
|------------------|-----------------------------|-------------------------------------|----------------------------|
| Database: | USA EDM 5000 Multi Users DB | Local Co-ordinate Reference: | Well CBU DHS3B-27 O15 1100 |
| Company: | EnCana Oil & Gas (USA) Inc | TVD Reference: | KB=32' @ 8372.0usft |
| Project: | Cathedral Bluffs | MD Reference: | KB=32' @ 8372.0usft |
| Site: | O15 Pad (Sec 15-1S-100W) | North Reference: | True |
| Well: | CBU DHS3B-27 O15 1100 | Survey Calculation Method: | Minimum Curvature |
| Wellbore: | HZ | | |
| Design: | Plan #1 | | |

Planned Survey

| Measured Depth (usft) | Inclination (°) | Azimuth (°) | Vertical Depth (usft) | +N/-S (usft) | +E/-W (usft) | Vertical Section (usft) | Dogleg Rate (°/100usft) | Build Rate (°/100u) | Comments / Formations |
|-----------------------|-----------------|-------------|-----------------------|--------------|--------------|-------------------------|-------------------------|---------------------|-----------------------|
| 9,200.0 | 29.45 | 180.07 | 9,174.4 | -148.0 | -0.2 | 148.0 | 5.00 | 5.00 | |
| 9,300.0 | 34.45 | 180.07 | 9,259.2 | -200.9 | -0.2 | 200.9 | 5.00 | 5.00 | |
| 9,400.0 | 39.45 | 180.07 | 9,339.1 | -261.0 | -0.3 | 261.0 | 5.00 | 5.00 | |
| 9,500.0 | 44.45 | 180.07 | 9,413.5 | -327.8 | -0.4 | 327.8 | 5.00 | 5.00 | |
| 9,600.0 | 49.45 | 180.07 | 9,481.7 | -400.9 | -0.5 | 400.9 | 5.00 | 5.00 | |
| 9,700.0 | 54.45 | 180.07 | 9,543.4 | -479.6 | -0.6 | 479.6 | 5.00 | 5.00 | |
| 9,800.0 | 59.45 | 180.07 | 9,597.9 | -563.4 | -0.7 | 563.4 | 5.00 | 5.00 | |
| 9,900.0 | 64.45 | 180.07 | 9,644.9 | -651.6 | -0.8 | 651.6 | 5.00 | 5.00 | |
| 10,000.0 | 69.45 | 180.07 | 9,684.1 | -743.6 | -0.9 | 743.6 | 5.00 | 5.00 | |
| 10,100.0 | 74.45 | 180.07 | 9,715.0 | -838.6 | -1.0 | 838.6 | 5.00 | 5.00 | |
| 10,200.0 | 79.45 | 180.07 | 9,737.6 | -936.0 | -1.2 | 936.0 | 5.00 | 5.00 | |
| 10,300.0 | 84.45 | 180.07 | 9,751.6 | -1,035.0 | -1.3 | 1,035.0 | 5.00 | 5.00 | |
| 10,400.0 | 89.45 | 180.07 | 9,756.9 | -1,134.8 | -1.4 | 1,134.8 | 5.00 | 5.00 | |
| 10,411.1 | 90.00 | 180.07 | 9,757.0 | -1,145.9 | -1.4 | 1,145.9 | 5.00 | 5.00 | LP @ 9,757' TVD, 90° |
| 10,500.0 | 90.00 | 180.07 | 9,757.0 | -1,234.8 | -1.5 | 1,234.8 | 0.00 | 0.00 | |
| 10,600.0 | 90.00 | 180.07 | 9,757.0 | -1,334.8 | -1.7 | 1,334.8 | 0.00 | 0.00 | |
| 10,700.0 | 90.00 | 180.07 | 9,757.0 | -1,434.8 | -1.8 | 1,434.8 | 0.00 | 0.00 | |
| 10,800.0 | 90.00 | 180.07 | 9,757.0 | -1,534.8 | -1.9 | 1,534.8 | 0.00 | 0.00 | |
| 10,900.0 | 90.00 | 180.07 | 9,757.0 | -1,634.8 | -2.0 | 1,634.8 | 0.00 | 0.00 | |
| 11,000.0 | 90.00 | 180.07 | 9,757.0 | -1,734.8 | -2.2 | 1,734.8 | 0.00 | 0.00 | |
| 11,100.0 | 90.00 | 180.07 | 9,757.0 | -1,834.8 | -2.3 | 1,834.8 | 0.00 | 0.00 | |
| 11,200.0 | 90.00 | 180.07 | 9,757.0 | -1,934.8 | -2.4 | 1,934.8 | 0.00 | 0.00 | |
| 11,300.0 | 90.00 | 180.07 | 9,757.0 | -2,034.8 | -2.5 | 2,034.8 | 0.00 | 0.00 | |
| 11,400.0 | 90.00 | 180.07 | 9,757.0 | -2,134.8 | -2.7 | 2,134.8 | 0.00 | 0.00 | |
| 11,500.0 | 90.00 | 180.07 | 9,757.0 | -2,234.8 | -2.8 | 2,234.8 | 0.00 | 0.00 | |
| 11,600.0 | 90.00 | 180.07 | 9,757.0 | -2,334.8 | -2.9 | 2,334.8 | 0.00 | 0.00 | |
| 11,700.0 | 90.00 | 180.07 | 9,757.0 | -2,434.8 | -3.0 | 2,434.8 | 0.00 | 0.00 | |
| 11,800.0 | 90.00 | 180.07 | 9,757.0 | -2,534.8 | -3.2 | 2,534.8 | 0.00 | 0.00 | |
| 11,900.0 | 90.00 | 180.07 | 9,757.0 | -2,634.8 | -3.3 | 2,634.8 | 0.00 | 0.00 | |
| 12,000.0 | 90.00 | 180.07 | 9,757.0 | -2,734.8 | -3.4 | 2,734.8 | 0.00 | 0.00 | |
| 12,100.0 | 90.00 | 180.07 | 9,757.0 | -2,834.8 | -3.5 | 2,834.8 | 0.00 | 0.00 | |
| 12,200.0 | 90.00 | 180.07 | 9,757.0 | -2,934.8 | -3.7 | 2,934.8 | 0.00 | 0.00 | |
| 12,300.0 | 90.00 | 180.07 | 9,757.0 | -3,034.8 | -3.8 | 3,034.8 | 0.00 | 0.00 | |
| 12,400.0 | 90.00 | 180.07 | 9,757.0 | -3,134.8 | -3.9 | 3,134.8 | 0.00 | 0.00 | |
| 12,500.0 | 90.00 | 180.07 | 9,757.0 | -3,234.8 | -4.0 | 3,234.8 | 0.00 | 0.00 | |
| 12,600.0 | 90.00 | 180.07 | 9,757.0 | -3,334.8 | -4.1 | 3,334.8 | 0.00 | 0.00 | |
| 12,700.0 | 90.00 | 180.07 | 9,757.0 | -3,434.8 | -4.3 | 3,434.8 | 0.00 | 0.00 | |
| 12,800.0 | 90.00 | 180.07 | 9,757.0 | -3,534.8 | -4.4 | 3,534.8 | 0.00 | 0.00 | |
| 12,900.0 | 90.00 | 180.07 | 9,757.0 | -3,634.8 | -4.5 | 3,634.8 | 0.00 | 0.00 | |
| 13,000.0 | 90.00 | 180.07 | 9,757.0 | -3,734.8 | -4.6 | 3,734.8 | 0.00 | 0.00 | |
| 13,100.0 | 90.00 | 180.07 | 9,757.0 | -3,834.8 | -4.8 | 3,834.8 | 0.00 | 0.00 | |
| 13,200.0 | 90.00 | 180.07 | 9,757.0 | -3,934.8 | -4.9 | 3,934.8 | 0.00 | 0.00 | |
| 13,300.0 | 90.00 | 180.07 | 9,757.0 | -4,034.8 | -5.0 | 4,034.8 | 0.00 | 0.00 | |
| 13,400.0 | 90.00 | 180.07 | 9,757.0 | -4,134.8 | -5.1 | 4,134.8 | 0.00 | 0.00 | |
| 13,500.0 | 90.00 | 180.07 | 9,757.0 | -4,234.8 | -5.3 | 4,234.8 | 0.00 | 0.00 | |
| 13,600.0 | 90.00 | 180.07 | 9,757.0 | -4,334.8 | -5.4 | 4,334.8 | 0.00 | 0.00 | |
| 13,700.0 | 90.00 | 180.07 | 9,757.0 | -4,434.8 | -5.5 | 4,434.8 | 0.00 | 0.00 | |
| 13,800.0 | 90.00 | 180.07 | 9,757.0 | -4,534.8 | -5.6 | 4,534.8 | 0.00 | 0.00 | |
| 13,900.0 | 90.00 | 180.07 | 9,757.0 | -4,634.8 | -5.8 | 4,634.8 | 0.00 | 0.00 | |
| 14,000.0 | 90.00 | 180.07 | 9,757.0 | -4,734.8 | -5.9 | 4,734.8 | 0.00 | 0.00 | |
| 14,100.0 | 90.00 | 180.07 | 9,757.0 | -4,834.8 | -6.0 | 4,834.8 | 0.00 | 0.00 | |
| 14,200.0 | 90.00 | 180.07 | 9,757.0 | -4,934.8 | -6.1 | 4,934.8 | 0.00 | 0.00 | |

Cathedral Energy Services

Planning Report

| | | | |
|------------------|-----------------------------|-------------------------------------|----------------------------|
| Database: | USA EDM 5000 Multi Users DB | Local Co-ordinate Reference: | Well CBU DHS3B-27 O15 1100 |
| Company: | EnCana Oil & Gas (USA) Inc | TVD Reference: | KB=32' @ 8372.0usft |
| Project: | Cathedral Bluffs | MD Reference: | KB=32' @ 8372.0usft |
| Site: | O15 Pad (Sec 15-1S-100W) | North Reference: | True |
| Well: | CBU DHS3B-27 O15 1100 | Survey Calculation Method: | Minimum Curvature |
| Wellbore: | HZ | | |
| Design: | Plan #1 | | |

Planned Survey

| Measured Depth (usft) | Inclination (°) | Azimuth (°) | Vertical Depth (usft) | +N/-S (usft) | +E/-W (usft) | Vertical Section (usft) | Dogleg Rate (°/100usft) | Build Rate (°/100u) | Comments / Formations |
|-----------------------|-----------------|-------------|-----------------------|--------------|--------------|-------------------------|-------------------------|---------------------|-----------------------|
| 14,300.0 | 90.00 | 180.07 | 9,757.0 | -5,034.8 | -6.3 | 5,034.8 | 0.00 | 0.00 | |
| 14,400.0 | 90.00 | 180.07 | 9,757.0 | -5,134.8 | -6.4 | 5,134.8 | 0.00 | 0.00 | |
| 14,500.0 | 90.00 | 180.07 | 9,757.0 | -5,234.8 | -6.5 | 5,234.8 | 0.00 | 0.00 | |
| 14,600.0 | 90.00 | 180.07 | 9,757.0 | -5,334.8 | -6.6 | 5,334.8 | 0.00 | 0.00 | |
| 14,700.0 | 90.00 | 180.07 | 9,757.0 | -5,434.8 | -6.8 | 5,434.8 | 0.00 | 0.00 | |
| 14,800.0 | 90.00 | 180.07 | 9,757.0 | -5,534.8 | -6.9 | 5,534.8 | 0.00 | 0.00 | |
| 14,900.0 | 90.00 | 180.07 | 9,757.0 | -5,634.8 | -7.0 | 5,634.8 | 0.00 | 0.00 | |
| 15,000.0 | 90.00 | 180.07 | 9,757.0 | -5,734.8 | -7.1 | 5,734.8 | 0.00 | 0.00 | |
| 15,100.0 | 90.00 | 180.07 | 9,757.0 | -5,834.8 | -7.3 | 5,834.8 | 0.00 | 0.00 | |
| 15,200.0 | 90.00 | 180.07 | 9,757.0 | -5,934.8 | -7.4 | 5,934.8 | 0.00 | 0.00 | |
| 15,300.0 | 90.00 | 180.07 | 9,757.0 | -6,034.8 | -7.5 | 6,034.8 | 0.00 | 0.00 | |
| 15,400.0 | 90.00 | 180.07 | 9,757.0 | -6,134.8 | -7.6 | 6,134.8 | 0.00 | 0.00 | |
| 15,500.0 | 90.00 | 180.07 | 9,757.0 | -6,234.8 | -7.8 | 6,234.8 | 0.00 | 0.00 | |
| 15,600.0 | 90.00 | 180.07 | 9,757.0 | -6,334.8 | -7.9 | 6,334.8 | 0.00 | 0.00 | |
| 15,700.0 | 90.00 | 180.07 | 9,757.0 | -6,434.8 | -8.0 | 6,434.8 | 0.00 | 0.00 | |
| 15,800.0 | 90.00 | 180.07 | 9,757.0 | -6,534.8 | -8.1 | 6,534.8 | 0.00 | 0.00 | |
| 15,900.0 | 90.00 | 180.07 | 9,757.0 | -6,634.8 | -8.3 | 6,634.8 | 0.00 | 0.00 | |
| 16,000.0 | 90.00 | 180.07 | 9,757.0 | -6,734.8 | -8.4 | 6,734.8 | 0.00 | 0.00 | |
| 16,100.0 | 90.00 | 180.07 | 9,757.0 | -6,834.8 | -8.5 | 6,834.8 | 0.00 | 0.00 | |
| 16,200.0 | 90.00 | 180.07 | 9,757.0 | -6,934.8 | -8.6 | 6,934.8 | 0.00 | 0.00 | |
| 16,300.0 | 90.00 | 180.07 | 9,757.0 | -7,034.8 | -8.8 | 7,034.8 | 0.00 | 0.00 | |
| 16,400.0 | 90.00 | 180.07 | 9,757.0 | -7,134.8 | -8.9 | 7,134.8 | 0.00 | 0.00 | |
| 16,500.0 | 90.00 | 180.07 | 9,757.0 | -7,234.8 | -9.0 | 7,234.8 | 0.00 | 0.00 | |
| 16,600.0 | 90.00 | 180.07 | 9,757.0 | -7,334.8 | -9.1 | 7,334.8 | 0.00 | 0.00 | |
| 16,700.0 | 90.00 | 180.07 | 9,757.0 | -7,434.8 | -9.2 | 7,434.8 | 0.00 | 0.00 | |
| 16,800.0 | 90.00 | 180.07 | 9,757.0 | -7,534.8 | -9.4 | 7,534.8 | 0.00 | 0.00 | |
| 16,900.0 | 90.00 | 180.07 | 9,757.0 | -7,634.8 | -9.5 | 7,634.8 | 0.00 | 0.00 | |
| 17,000.0 | 90.00 | 180.07 | 9,757.0 | -7,734.8 | -9.6 | 7,734.8 | 0.00 | 0.00 | |
| 17,100.0 | 90.00 | 180.07 | 9,757.0 | -7,834.8 | -9.7 | 7,834.8 | 0.00 | 0.00 | |
| 17,200.0 | 90.00 | 180.07 | 9,757.0 | -7,934.8 | -9.9 | 7,934.8 | 0.00 | 0.00 | |
| 17,300.0 | 90.00 | 180.07 | 9,757.0 | -8,034.8 | -10.0 | 8,034.8 | 0.00 | 0.00 | |
| 17,400.0 | 90.00 | 180.07 | 9,757.0 | -8,134.8 | -10.1 | 8,134.8 | 0.00 | 0.00 | |
| 17,500.0 | 90.00 | 180.07 | 9,757.0 | -8,234.8 | -10.2 | 8,234.8 | 0.00 | 0.00 | |
| 17,600.0 | 90.00 | 180.07 | 9,757.0 | -8,334.8 | -10.4 | 8,334.8 | 0.00 | 0.00 | |
| 17,700.0 | 90.00 | 180.07 | 9,757.0 | -8,434.8 | -10.5 | 8,434.8 | 0.00 | 0.00 | |
| 17,800.0 | 90.00 | 180.07 | 9,757.0 | -8,534.8 | -10.6 | 8,534.8 | 0.00 | 0.00 | |
| 17,900.0 | 90.00 | 180.07 | 9,757.0 | -8,634.8 | -10.7 | 8,634.8 | 0.00 | 0.00 | |
| 18,000.0 | 90.00 | 180.07 | 9,757.0 | -8,734.8 | -10.9 | 8,734.8 | 0.00 | 0.00 | |
| 18,100.0 | 90.00 | 180.07 | 9,757.0 | -8,834.8 | -11.0 | 8,834.8 | 0.00 | 0.00 | |
| 18,200.0 | 90.00 | 180.07 | 9,757.0 | -8,934.8 | -11.1 | 8,934.8 | 0.00 | 0.00 | |
| 18,300.0 | 90.00 | 180.07 | 9,757.0 | -9,034.8 | -11.2 | 9,034.8 | 0.00 | 0.00 | |
| 18,400.0 | 90.00 | 180.07 | 9,757.0 | -9,134.8 | -11.4 | 9,134.8 | 0.00 | 0.00 | |
| 18,500.0 | 90.00 | 180.07 | 9,757.0 | -9,234.8 | -11.5 | 9,234.8 | 0.00 | 0.00 | |
| 18,600.0 | 90.00 | 180.07 | 9,757.0 | -9,334.8 | -11.6 | 9,334.8 | 0.00 | 0.00 | |
| 18,700.0 | 90.00 | 180.07 | 9,757.0 | -9,434.8 | -11.7 | 9,434.8 | 0.00 | 0.00 | |
| 18,800.0 | 90.00 | 180.07 | 9,757.0 | -9,534.8 | -11.9 | 9,534.8 | 0.00 | 0.00 | |
| 18,900.0 | 90.00 | 180.07 | 9,757.0 | -9,634.8 | -12.0 | 9,634.8 | 0.00 | 0.00 | |
| 19,000.0 | 90.00 | 180.07 | 9,757.0 | -9,734.8 | -12.1 | 9,734.8 | 0.00 | 0.00 | |
| 19,100.0 | 90.00 | 180.07 | 9,757.0 | -9,834.8 | -12.2 | 9,834.8 | 0.00 | 0.00 | |
| 19,200.0 | 90.00 | 180.07 | 9,757.0 | -9,934.8 | -12.4 | 9,934.8 | 0.00 | 0.00 | |
| 19,300.0 | 90.00 | 180.07 | 9,757.0 | -10,034.8 | -12.5 | 10,034.8 | 0.00 | 0.00 | |
| 19,361.4 | 90.00 | 180.07 | 9,757.0 | -10,096.3 | -12.6 | 10,096.3 | 0.00 | 0.00 | TD @ 19,361.4' MD |

Cathedral Energy Services

Planning Report

| | | | |
|------------------|-----------------------------|-------------------------------------|----------------------------|
| Database: | USA EDM 5000 Multi Users DB | Local Co-ordinate Reference: | Well CBU DHS3B-27 O15 1100 |
| Company: | EnCana Oil & Gas (USA) Inc | TVD Reference: | KB=32' @ 8372.0usft |
| Project: | Cathedral Bluffs | MD Reference: | KB=32' @ 8372.0usft |
| Site: | O15 Pad (Sec 15-1S-100W) | North Reference: | True |
| Well: | CBU DHS3B-27 O15 1100 | Survey Calculation Method: | Minimum Curvature |
| Wellbore: | HZ | | |
| Design: | Plan #1 | | |

| Targets | | | | | | | | | |
|---------------------------|-----------|----------|---------|-----------|--------|--------------|--------------|-----------|-------------|
| Target Name | | | | | | | | | |
| - hit/miss target | Dip Angle | Dip Dir. | TVD | +N/-S | +E/-W | Northing | Easting | Latitude | Longitude |
| - Shape | (°) | (°) | (usft) | (usft) | (usft) | (usft) | (usft) | | |
| CBU DHS3B-27 O15 1100 | 0.00 | 0.00 | 9,757.0 | -10,096.3 | -12.6 | 1,778,256.84 | 2,131,105.23 | 39.929447 | -108.598679 |
| - plan hits target center | | | | | | | | | |
| - Point | | | | | | | | | |

| Formations | | | | | | |
|----------------|----------------|------------------------|-----------|-----|---------------|--|
| Measured Depth | Vertical Depth | Name | Lithology | Dip | Dip Direction | |
| (usft) | (usft) | | | (°) | (°) | |
| 77.0 | 77.0 | B Groove Base | | | | |
| 1,982.0 | 1,982.0 | Wasatch Fm | | | | |
| 2,933.0 | 2,933.0 | Williams Fork | | | | |
| 5,574.0 | 5,574.0 | Rollins | | | | |
| 6,158.0 | 6,158.0 | Sego | | | | |
| 6,653.0 | 6,653.0 | Lloyd Ss | | | | |
| 7,083.0 | 7,083.0 | Buck Tongue | | | | |
| 7,329.0 | 7,329.0 | Castlegate | | | | |
| 7,485.0 | 7,485.0 | Mancos Marker | | | | |
| 8,306.0 | 8,306.0 | Prairie Canyon | | | | |
| 8,667.0 | 8,667.0 | Top Niobrara (Ductile) | | | | |

| Plan Annotations | | | | |
|------------------|----------------|-------------------|--------------|----------------------|
| Measured Depth | Vertical Depth | Local Coordinates | | Comment |
| (usft) | (usft) | +N/-S (usft) | +E/-W (usft) | |
| 8,611.1 | 8,611.1 | 0.0 | 0.0 | KOP @ 8,611.1' |
| 10,411.1 | 9,757.0 | -1,145.9 | -1.4 | LP @ 9,757' TVD, 90° |
| 19,361.4 | 9,757.0 | -10,096.3 | -12.6 | TD @ 19,361.4' MD |