



Physical Address: 345 Comanche St.
Mail to: Box 384, Kiowa, CO 80117
Ph. 303-621-8672 - Fax 303-621-7749
www.highprairiesurvey.com

Job # 14193 Chapman #13-19-1s44w

Inv # 3237

High Prairie Surveying of Kiowa, Colorado, in accordance with a request from **Augustus Energy Resources LLC**, has determined the location of **Chapman #13-19-1s44w** to be **2286 feet FSL**, and **594 feet FWL**, (90° off Section lines) of **SECTION 19**, Township **1s**, Range **44w** of the 6th Principal Meridian, **Yuma County**, Colorado.

Date: Staked on 06/12/14 drawn on 06/17/14.

Rev: 06/23014 (Add structures)

Re: Staked by Elijah Frane

Drawn: Drawn by Dustin Cotter

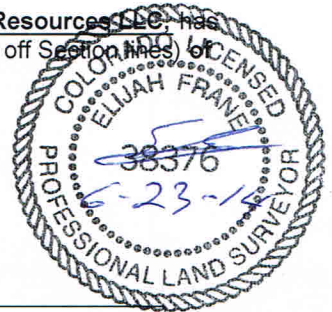

Location Drawing

There are overhead power lines and The Easterly Right-of-way line of C.R. AA is approximately 468' West of the proposed well pad. There are circular irrigation wheel tracks approximately 99' Northeast and 58' Southwest of the proposed well head. The following 3 structures exist within 500' of the proposed well pad and are located to the Southwest of the proposed well head at the following distances: a Garage at 495', a Shop at 553' and a House at 530'.

