

State of Colorado
Oil and Gas Conservation Commission

1120 Lincoln Street, Suite 801, Denver, Colorado 80203 Phone: (303)894-2100 Fax: (303)894-2109

SUNDRY NOTICE

Submit original plus one copy. This form is to be used for general, technical and environmental sundry information. For proposed or completed operations, describe in full on Technical Information Page (Page 2 of this form.) Identify well or other facility by API Number or by OGCC Facility ID. Operator shall send an informational copy of all sundry notices for wells located in High Density Areas to the Local Government Designee (Rule 603b.)

RECEIVED
10/15/2013

1. OGCC Operator Number: 69175	4. Contact Name: Brandon Bruns	Complete the Attachment Checklist
2. Name of Operator: PDC Energy, Inc.	Phone: 303-831-3971	
3. Address: 1775 Sherman Street, Suite 3000	Fax: 303-860-5838	OP OGCC
City: Denver State: CO Zip: 80203		
5. API Number 05-123-12583	OGCC Facility ID Number	Survey Plat
6. Well/Facility Name: Caesar 2-21	Well/Facility Number	Directional Survey
8. Location (Qtr/Qtr, Sec, Twp, Rng, Meridian): SENE Sec 21 T5N R65W, 6th PM		Surface Eqpm Diagram
9. County: Weld	10. Field Name:	Technical Info Page
11. Federal, Indian or State Lease Number:		Other

General Notice

<input type="checkbox"/> CHANGE OF LOCATION: Attach New Survey Plat (a change of surface qtr/qtr is substantive and requires a new permit)	
Change of Surface Footage from Exterior Section Lines:	<input type="checkbox"/> FNL/FSL <input type="checkbox"/> FEL/FWL
Change of Surface Footage to Exterior Section Lines:	<input type="checkbox"/> <input type="checkbox"/>
Change of Bottomhole Footage from Exterior Section Lines:	<input type="checkbox"/> <input type="checkbox"/>
Change of Bottomhole Footage to Exterior Section Lines:	<input type="checkbox"/> <input type="checkbox"/> attach directional survey
Bottomhole location Qtr/Qtr, Sec, Twp, Rng, Mer	
Latitude	Distance to nearest property line
Longitude	Distance to nearest bldg, public rd, utility or RR
Ground Elevation	Distance to nearest lease line
	Is location in a High Density Area (rule 603b)? Yes/No
	Distance to nearest well same formation
	Surface owner consultation date:
GPS DATA:	
Date of Measurement PDOP Reading Instrument Operator's Name	
<input type="checkbox"/> CHANGE SPACING UNIT	
Formation	Formation Code
Spacing order number	Unit Acreage
Unit configuration	
<input type="checkbox"/> Remove from surface bond	
Signed surface use agreement attached	
<input type="checkbox"/> CHANGE OF OPERATOR (prior to drilling):	
Effective Date:	
Plugging Bond: <input type="checkbox"/> Blanket <input type="checkbox"/> Individual	
<input type="checkbox"/> CHANGE WELL NAME	
From:	
To:	
Effective Date:	
<input type="checkbox"/> ABANDONED LOCATION:	
Was location ever built? <input type="checkbox"/> Yes <input type="checkbox"/> No	
Is site ready for inspection? <input type="checkbox"/> Yes <input type="checkbox"/> No	
Date Ready for Inspection:	
<input type="checkbox"/> NOTICE OF CONTINUED SHUT IN STATUS	
Date well shut in or temporarily abandoned:	
Has Production Equipment been removed from site? <input type="checkbox"/> Yes <input type="checkbox"/> No	
MIT required if shut in longer than two years. Date of last MIT	
<input type="checkbox"/> SPUD DATE:	
<input type="checkbox"/> REQUEST FOR CONFIDENTIAL STATUS (6 mos from date casing set)	
<input type="checkbox"/> SUBSEQUENT REPORT OF STAGE, SQUEEZE OR REMEDIAL CEMENT WORK	
*submit cbl and cement job summaries	
Method used	Cementing tool setting/perf depth
Cement volume	Cement top
Cement bottom	Date
<input type="checkbox"/> RECLAMATION: Attach technical page describing final reclamation procedures per Rule 1004.	
Final reclamation will commence on approximately	
<input type="checkbox"/> Final reclamation is completed and site is ready for inspection.	

Technical Engineering/Environmental Notice

<input type="checkbox"/> Notice of Intent		<input type="checkbox"/> Report of Work Done	
Approximate Start Date:		Date Work Completed:	
Details of work must be described in full on Technical Information Page (Page 2 must be submitted.)			
<input type="checkbox"/> Intent to Recomplete (submit form 2)	<input type="checkbox"/> Request to Vent or Flare	<input type="checkbox"/> E&P Waste Disposal	
<input type="checkbox"/> Change Drilling Plans	<input type="checkbox"/> Repair Well	<input type="checkbox"/> Beneficial Reuse of E&P Waste	
<input type="checkbox"/> Gross Interval Changed?	<input type="checkbox"/> Rule 502 variance requested	<input checked="" type="checkbox"/> Status Update/Change of Remediation Plans	
<input type="checkbox"/> Casing/Cementing Program Change	<input type="checkbox"/> Other:	for Spills and Releases	

I hereby certify that the statements made in this form are, to the best of my knowledge, true, correct and complete.

Signed: Brandon Bruns Date: 10-14-13 Email: brandon.bruns@pdce.com
Print Name: Brandon Bruns Title: EHS Professional

COGCC Approved: _____ Title _____ Date: _____

CONDITIONS OF APPROVAL, IF ANY:

TECHNICAL INFORMATION PAGE



FOR OGCC USE ONLY

1. OGCC Operator Number: 69175 API Number: 05-123-12583
2. Name of Operator: PDC Energy, Inc. OGCC Facility ID #
3. Well/Facility Name: Caesar 2-21
4. Location (QtrQtr, Sec, Twp, Rng, Meridian): SENE Sec 21 T5N R65W, 6th PM

This form is to be completed whenever a Sundry Notice is submitted requiring detailed report of work to be performed or completed. This form shall be transmitted within 30 days of work completed as a "subsequent" report and must accompany Form 4, page 1.

5. **DESCRIBE PROPOSED OR COMPLETED OPERATIONS**

PDC Energy, Inc. (PDC) submitted a Form 19 - Spill/Release Report to the COGCC on October 1, 2013 for this facility. Spill #2146399 was assigned for this project. At the time the Form 19 was submitted, PDC had not confirmed the amount of oil that was lost from the oil tank. On October 11, 2013, PDC personnel were able to stand the oil tank back up and determine that approximately 127 barrels of oil were lost. In the Form 19, PDC initially estimated that up to 120 barrels of oil were likely lost. No sheen or soil staining were observed at the location on October 11, 2013. When PDC begins rebuilding the location, soil screening measurements will be collected using a photoionization detector. If elevated vapor phase hydrocarbon concentrations are detected, follow-up soil samples will be collected and submitted for analytical laboratory testing. Soil sample results along with a summary of the activities that were completed at the facility will be submitted to the COGCC in subsequent documentation, which will include a description of any further remediation activities planned.

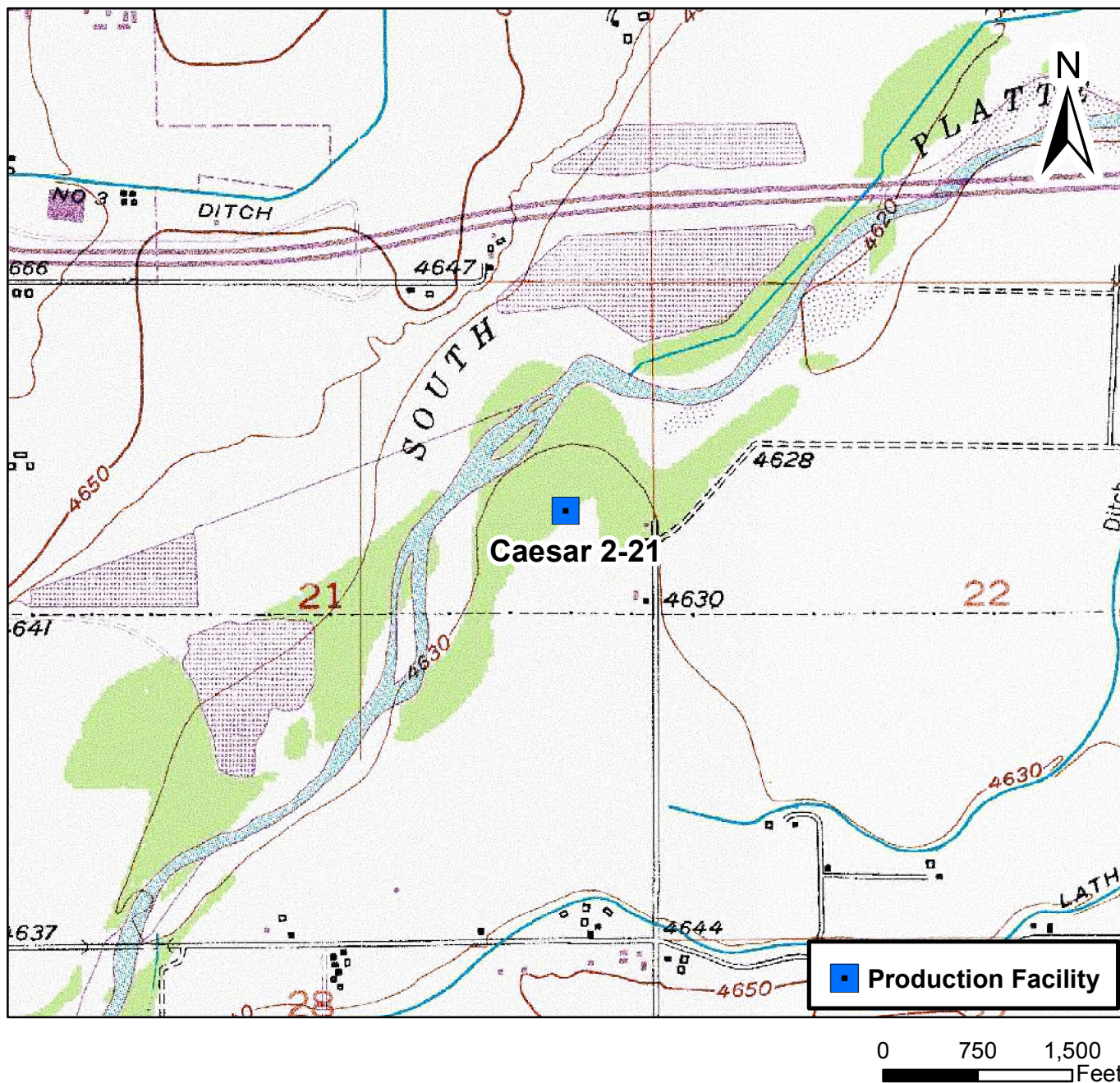

Figure 1
 Site Location Map
 Caesar 2-21
 SENE S21 T5N R65W
 Weld County, Colorado

Drawn By: DBA
 Date: 09/26/2013



Pasture

Separator



Produced Water Tank



Condensate Tank

Scale: 1-inch equals 50 feet

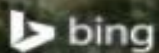

PROJECT
NO:

DRAWN BY: BDH

DATE: 9/27/13

Facility Diagram
PDC Energy, Inc.
Caesar 2-21
SENE S21 T5N R65W
Weld County, CO



6899 Pecos Street, Unit C
Denver, CO 80221

LEGEND

— Earthen Berm

Figure 2

Site Layout