

K:\BONANZA CREEK\2013\_04\_2014\_WELL\_STAKING\GIS\Maps\_ABC\NorthPlatte A-33\NorthPlatte A-33 Access.mxd 6/5/2014 3:43:10 PM

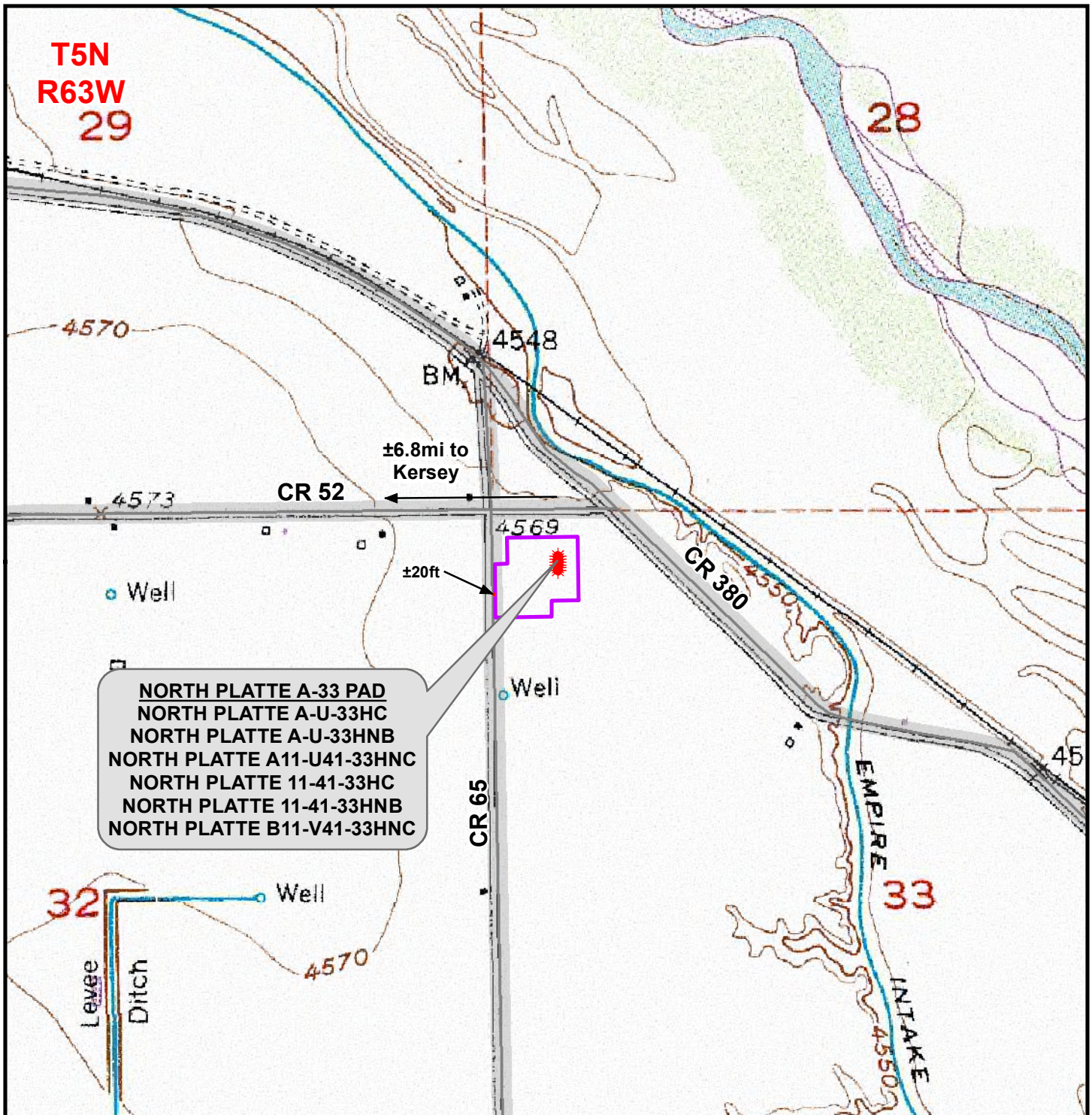

### Legend

- ★ Well - Fee - Proposed    ..... Access Road    === Road - Primitive - Existing    ——— Road - County - Existing  
□ Disturbance Area    ——— Road - Improved - Existing    ——— Road - Highway - Existing

### WELL PAD - NORTH PLATTE A-33

ACCESS ROAD MAP  
NORTH PLATTE A-U-33HC, NORTH PLATTE A-U-33HNB  
NORTH PLATTE A11-U41-33HNC, NORTH PLATTE 11-41-33HC  
NORTH PLATTE 11-41-33HNB & NORTH PLATTE B11-V41-33HNC  
LOCATED IN NW1/4 NW1/4  
SECTION 33, T5N, R63W, 6th P.M.  
WELD COUNTY, COLORADO



410 17th Street, Suite 1400  
Denver, Colorado 80202



### CONSULTING, LLC

SHERIDAN OFFICE 2155 North Main Street  
Sheridan, Wyoming 82801  
Phone 307-674-0609  
LOVELAND OFFICE 1635 Foxtail Drive, Suite 204  
Loveland, Colorado 80538  
Phone 970-776-4331



SCALE: 1" = 1,000ft

NAD83 CO-Nft

DRAWN: JELO

DATE: 8 Nov 2013

REVISED: TL

DATE: 6 June 2014





PHOTOGRAPH OF NORTH PLATTE A-33 PROPOSED ACCESS ROAD - CAMERA ANGLE NORTH



PHOTOGRAPH OF NORTH PLATTE A-33 PROPOSED ACCESS ROAD - CAMERA ANGLE EAST

#### WELL PAD - NORTH PLATTE A-33

PROPOSED ACCESS ROAD PHOTOGRAPHS  
 NORTH PLATTE A-U-33HC, NORTH PLATTE A-U-33HNB,  
 NORTH PLATTE A11-U41-33HNC, NORTH PLATTE 11-41-33HC,  
 NORTH PLATTE 11-41-33HNB & NORTH PLATTE B11-V41-33HNC  
 LOCATED IN SECTION 33, T5N, R63W, 6TH P.M.  
 WELD COUNTY, COLORADO

 **BONANZA  
CREEK**  
 410 17th Street, Suite 1400  
 Denver, Colorado 80202



#### CONSULTING, LLC

SHERIDAN OFFICE  
 2155 North Main Street  
 Sheridan, Wyoming 82801  
 Phone 307-674-0609

LOVELAND OFFICE  
 1635 Foxtrail Drive, Suite 204  
 Loveland, Colorado 80538  
 Phone 970-776-4331

SCALE: NTS	DATE: 11/8/13
REVISED:	BJB 4/17/14

SHEET NO:	<b>1</b>	1 OF 2
-----------	----------	--------



PHOTOGRAPH OF NORTH PLATTE A-33 PROPOSED ACCESS ROAD - CAMERA ANGLE SOUTH



PHOTOGRAPH OF NORTH PLATTE A-33 PROPOSED ACCESS ROAD - CAMERA ANGLE WEST

## WELL PAD - NORTH PLATTE A-33

PROPOSED ACCESS ROAD PHOTOGRAPHS  
NORTH PLATTE A-U-33HC, NORTH PLATTE A-U-33HNB,  
NORTH PLATTE A11-U41-33HNC, NORTH PLATTE 11-41-33HC,  
NORTH PLATTE 11-41-33HNB & NORTH PLATTE B11-V41-33HNC  
LOCATED IN SECTION 33, T5N, R63W, 6TH P.M.  
WELD COUNTY, COLORADO

 **BONANZA  
CREEK**  
410 17th Street, Suite 1400  
Denver, Colorado 80202



## CONSULTING, LLC

SHERIDAN OFFICE  
2155 North Main Street  
Sheridan, Wyoming 82801  
Phone 307-674-0609

LOVELAND OFFICE  
1635 Foxtrail Drive, Suite 204  
Loveland, Colorado 80538  
Phone 970-776-4331

SCALE: NTS	DATE: 11/8/13
REVISED:	BJB 4/17/14

SHEET NO:
<b>2</b>
2 OF 2