



Physical Address: 345 Comanche St.
Mail to: Box 384 Kiowa, CO 80117
Ph. 303-621-8672 - Fax 303-621-7749
www.highprairiesurvey.com

Job # 14123 SALEN #14-35

Inv # 3105

High Prairie Surveying of Kiowa, Colorado, in accordance with a request from **Nighthawk Production LLC**, has determined the location of **SALEN #14-35 (Surface Location)** to be **792 feet FSL**, and **2214 feet FWL**, and **SALEN #14-35 (Bottom Hole Location)** to be **620 feet FSL**, and **2027 feet FWL** (90° off Section lines) of Section **35**, Township **5s**, Range **54w** of the 6th Principal Meridian, **Washington County**, Colorado.

Date: Staked on 04/18/14 drawn on 04/24/14.

Re: Staked by Elijah Frane
Drawn: Drawn by Dustin Cotter

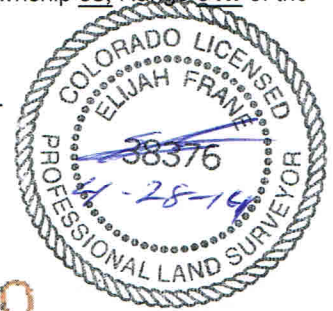

1000' Hydrology Map

There is an indicated surface water area approximately 299' Southwest of the proposed well pad and 514' Southwest of the proposed well head at its closest point.

