

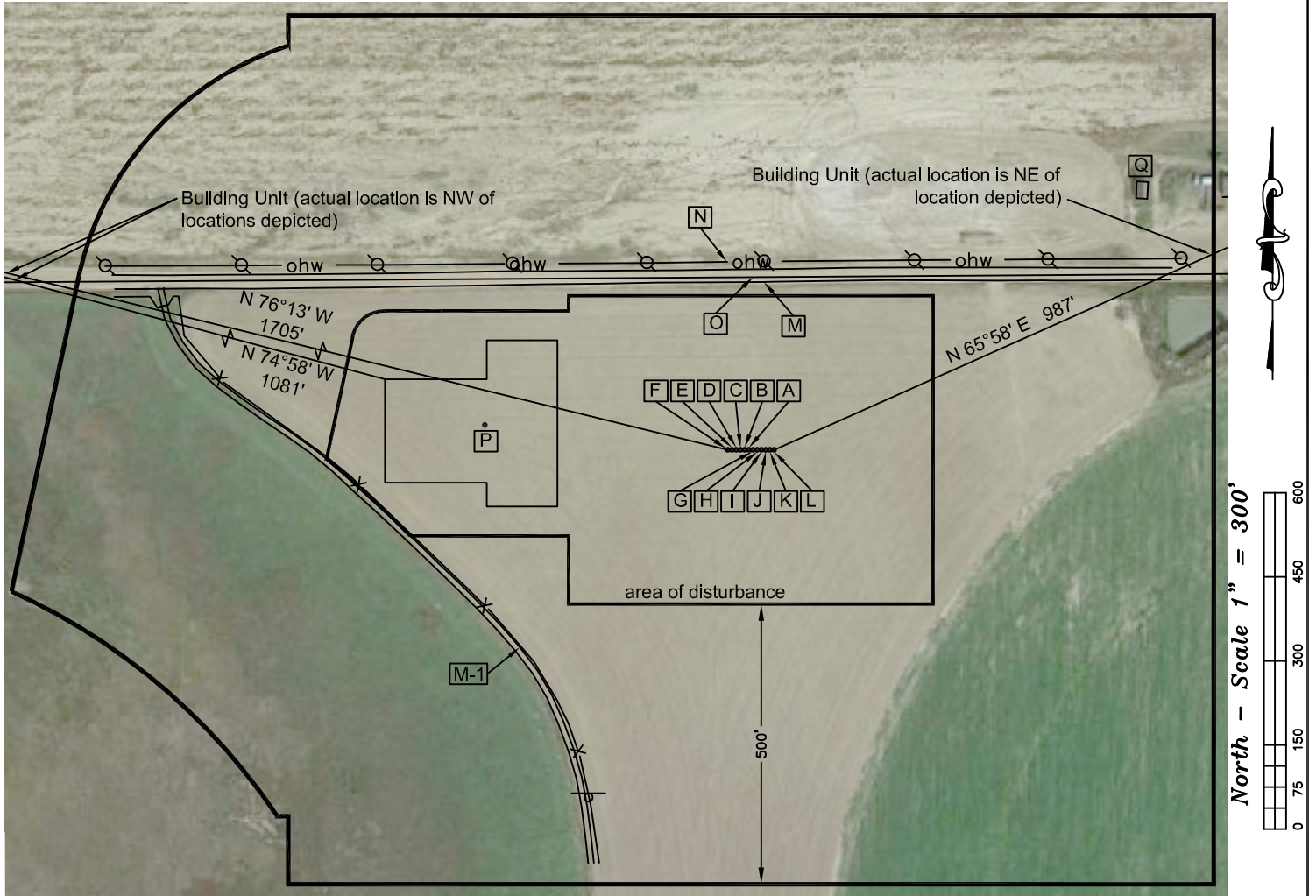

Washburn Land Surveying
www.WashburnSurveying.com
970-232-9645

Location Drawing



Distances listed below are measured from the proposed Newnam 2F-32H-C264 well

- [A] proposed Newnam 2F-32H-C264
- [B] proposed Newnam 2E-32H-C264, 7.5' west
- [C] proposed Newnam 2D-32H-C264, 15' west
- [D] proposed Newnam 2C-32H-C264, 22.5' west
- [E] proposed Newnam 2B-32H-C264, 30' west
- [F] proposed Newnam 2A-32H-C264, 37.5' west
- [G] proposed Newnam 2G-32H-C264, 7.5' east
- [H] proposed Newnam 2H-32H-C264, 15' east
- [I] proposed Newnam 2I-32H-C264, 22.5' east
- [J] proposed Newnam 2J-32H-C264, 30' east
- [K] proposed Newnam 2K-32H-C264, 37.5' east
- [L] proposed Newnam 2L-32H-C264, 45' east
- [M] access (WCR 16) 299' north
- [M-1] access 539 southwest
- [N] overhead power line 336' north
- [O] property line 308' north
- [P] center proposed facility pads 473' northwest
- [Q] building 824' northeast

Proposed Well Data:
Newnam 2F-32H-C264
Latitude: N 40.101467°
Longitude: W 104.578526°
FNL: 308'
FWL: 1598'
ELEV: 4,954'
PDOP: 1.2

Proposed Facility Data:
Center of facility pad
Latitude: N 40.101602°
Longitude: W 104.580206°
FNL: 260'
FWL: 1128'
ELEV: 4,941'
PDOP: 2.2

Legend:
 - power pole
 - utility/gas sign
 - fence line
 - overhead power line

Nearest: (from proposed Newnam 2F-32H-C264 well)

Building: 824' northeast
Building Unit: 1,028' northeast
Above Ground Utility: 336' north
Railroad: 2,288' northwest
Public Road: 299' north
Property Line: 308' north

Nearest: (from center proposed facility pad)

Building: 1,230' northeast
Building Unit: 1,275' northwest
Above Ground Utility: 287' north
Railroad: 2,100' northwest
Public Road: 249' north
Property Line: 260' north

Newnam 32H-C264
Location Drawing

Improvements extending
500' from disturbance

Township 2 North, Range 64 West,
Section 32: N $\frac{1}{2}$ NW $\frac{1}{4}$
Weld County, Colorado

April 21, 2014

Field observations taken
on 3/14/14 by operator
Chris Bettencourt