

Location Drawing

LONG VIEW FARM 44-18-16-53

SE¼ SE¼ SECTION 18, TOWNSHIP 16 SOUTH, RANGE 53 WEST OF THE 6TH PRINCIPAL MERIDIAN

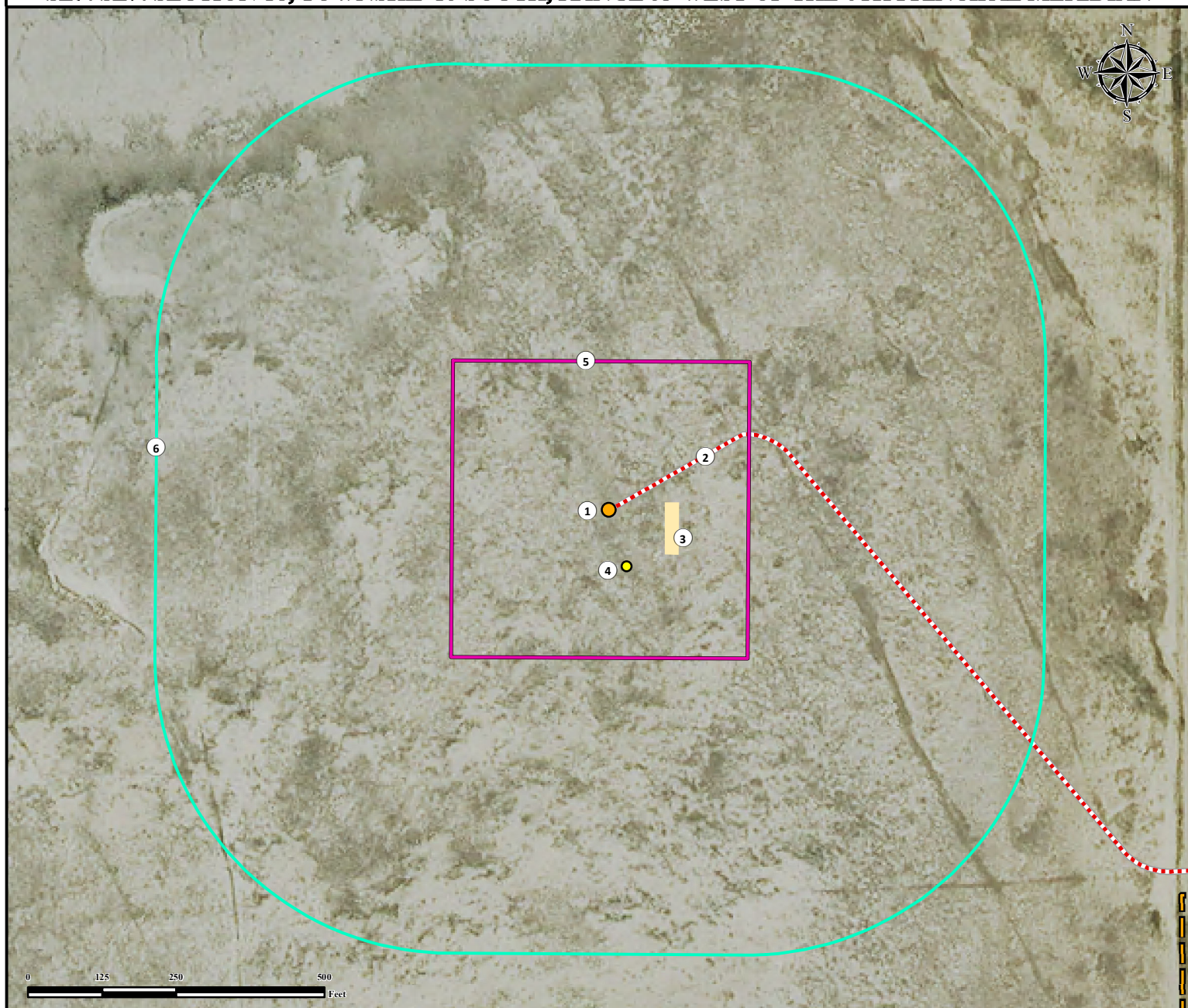

1. Proposed Well LONG VIEW FARM 44-18-16-53.
2. Proposed Access Road.
3. Proposed Tank Battery.
4. Proposed Heater Treater.
5. Operational Disturbance Area.
6. 500' Radius.

Legend

- | | | | |
|--|-------------------------|--|-----------------------|
| | Proposed Well | | Proposed Tank Battery |
| | Proposed Heater Treater | | Disturbance Area |
| | Proposed Access Road | | 500' Radius |

Measured from Nearest Well or Facility Edge

Building -	>5280' SW
Building Unit -	>5280' SW

Measured from Reference Location

Public Road - (CR 39)	>5280' E
Prop. Line (Parker, Michael Dean)	±962' E
Utility (Power Line) -	>5280' E
Surface Water (Pond) -	±1119' NW
Railroad -	>5280' SE

Reference Location

** LONG VIEW FARM 44-18-16-53 **
 Lat: 38.655688° Long: -103.377919° (NAD83)
 Elevation: 4845 Feet

Disturbance Acreage:

5.74 Acres Drilling Operations
 2.87 Acres Interim Reclaim

Current Surface Use: Rangeland
 Future Surface Use: Rangeland



Use our resources to find yours!
www.petro-fs.com
 (303) 928-7128

Field Date: 04/17/2014
 Drafting Date: 05/23/2014
 Drafted by: CSG
 Checked by: DRF
 Revision: 1

Data Sources:
 - Aerial courtesy of NAIP (2013)

Water Well - ±4995' NW	SWL = 0'
Permit: 1838,	Receipt: 0900161
Water Well - ±9760' NW	SWL = 24'
Permit: 3097,	Receipt: 9089881

Prepared for: **PIONEER NATURAL RESOURCES USA INC.**