

WELL LOCATION CERTIFICATE

Hays 32-03

Found #6 rebar and
3.25" aluminum cap
PLS 34995.

N 89°34'40" E 2637.80' N 89°34'45" E 2604.49'

Set #6 rebar and
2.5" aluminum cap
PLS 38321.

Found #6 rebar and
3.25" aluminum cap
PLS 36571.

NAD 83 Decimal Degrees
Lat: 39.91335° N
Lon: 102.287319° W
PDOP: 1.61
Operator: John Thompson
Ground elevation: 3846'
Ground slope <10%

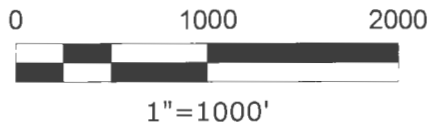

2629.52'
N 00°13'23" E 5312.70'
2683.18'

2668.36'
S 00°20'29" E 5356.89'
2688.53'

Hays 32-03
326' 2297'
351'

Section 3
T2S R44W

Legend

- Found monument as described
- ⊕ Set monument as described
- Proposed well

Set #6 rebar and
2.5" aluminum cap
PLS 38321.

2647.37'

2647.37'

Found #5 rebar and
1.5" aluminum cap
LS 3643.

N 89°56'23" W 5294.75'

Notes

Hays 32-03 is to be located at a point 2300' from the NORTH line and 2297' from the EAST line, measured at right angles, of the NE Quarter of Section 3, Township 2 South, Range 44 West of the Sixth Principal Meridian, Yuma County, Colorado.

Latitude, Longitude, and Elevation are derived from RTK-GPS observations, and are based on published coordinates for NGS Station U385 MP234.73, located approximately 4.2 miles northeast of the proposed well location. Horizontal Datum: NAD83(2011) Vertical Datum: NAVD88

Distances shown hereon are at ground level and are field-measured.

Bearings of this survey are based on the assumption that the north line of the Northeast Quarter of Section 3, Township 2 South, Range 44 West of the 6th Principal Meridian, between monuments described hereon bears N 89°34'45" E as shown hereon.

This well location certificate is not a land survey plat or improvement survey plat and it is not to be relied upon for the establishment of fence, building, or other future improvement lines.

I hereby state that this survey and well location certificate were made under my responsible charge and are in accordance with applicable standards of practice, that the monuments shown hereon actually exist and that this plat and the notes shown hereon accurately represent said survey to the best of my knowledge, information and belief.

John W. Thompson
Colorado PLS 38321
For and on behalf of
Forty North, LLC

NOTICE: According to Colorado law you must commence any legal action based upon any defect in this survey within three years after you first discover such defect. In no event may any action based upon any defect in this survey be commenced more than ten years from the date of the certification shown hereon.

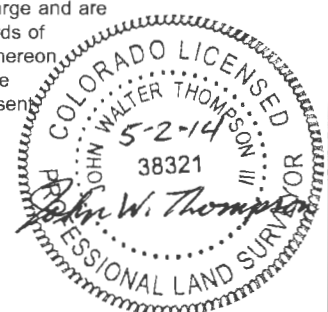

FORTY NORTH, LLC
LAND SURVEYING

53575 County Road NN
Wray, CO 80758
(970) 466-0552
fortynorthllc@gmail.com

DATE OF FIELD WORK
4/30/2014

DATE OF DRAWING
5/2/2014

PROJECT NO.
1083.018A

Augustus Energy Resources, LLC
Hays 32-03 2S44W

SW1/4 NE1/4 SEC. 3, T2S, R44W, 6PM, Yuma County, Colo.