

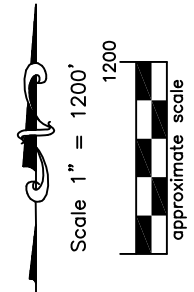

THIS MAP DOES NOT REPRESENT A BOUNDARY SURVEY

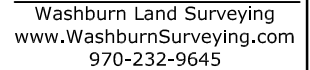

Jillson #6
Latitude: N 40.11869°
Longitude: W 104.99165°
FSL: 661'
FWL: 1994'
ELEV: 4975'
PDOP: 2.5

LEGEND
 — found survey monument
 (c) — calculated dimension

position
established by
"RM's"
Reference Markers
LS 29430
Nearest:
Building: 632' southeast
Building Unit: 716' southeast
Above Ground Utility: 303' southeast
Public Road: 250' south
Railroad: 20,092' southwest
Property Line: 261' south
Well Window: SHL is 204' outside
Existing Well: Jillson #6, 416' northwest
High Occupancy Building Unit: 1,980' southeast

I hereby certify that this Well Location Certificate was prepared by me or under my direct supervision on 4/28/2014 for and on behalf of EnCana Oil & Gas (USA) Inc. That it is not a Land Survey Plat or an Improvement Survey Plat and that it is not to be relied upon for establishment of fences, buildings, or other future improvement lines.

John Robert McGehee LS#38219
Well: Jillson-East Rinn 3I-22H-N268 WLC