

# WPX ENERGY ROCKY MOUNTAIN, LLC

EXISTING: GM 21-12, GM 321-12, PROPOSED: GM 43-12, GM 542-12, GM 342-12,  
GM 32-12, GM 531-12, GM 443-12, GM 343-12, GM 332-12 & GM 411-12

LOCATED IN GARFIELD COUNTY, COLORADO  
SECTION 12, T7S, R96W, 6th P.M.

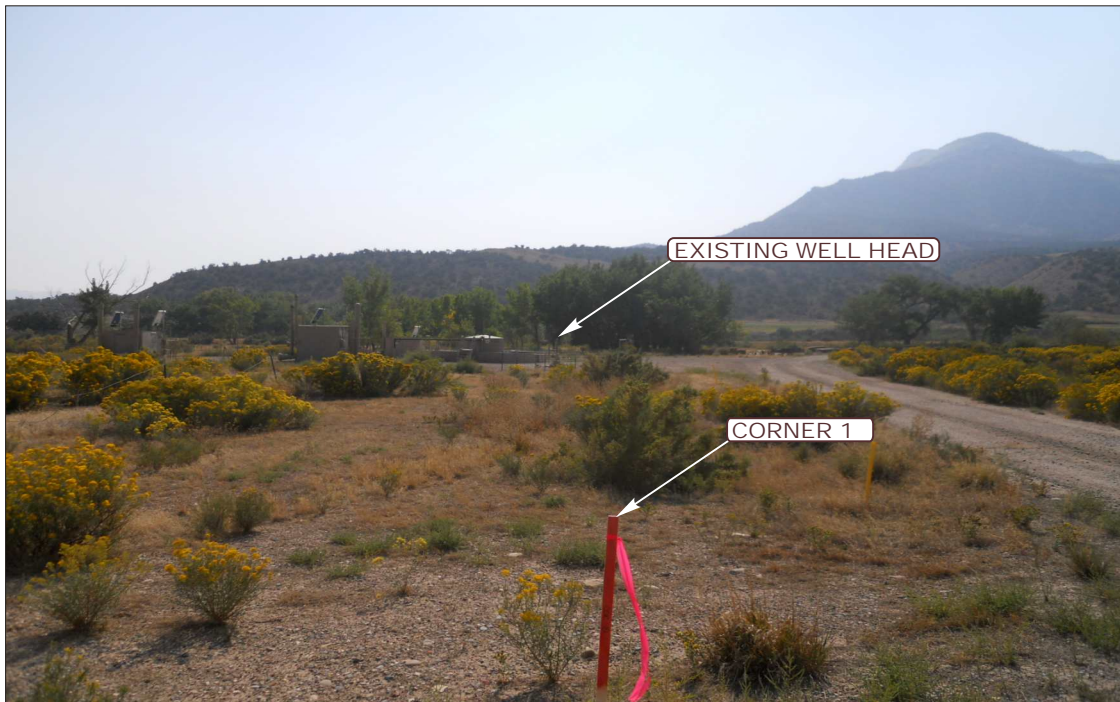

PHOTO: VIEW FROM CORNER 1 TO EXISTING WELL HEAD

CAMERA ANGLE: SOUTHWESTERLY



PHOTO: VIEW FROM BEGINNING OF EXISTING ACCESS

CAMERA ANGLE: NORTHWESTERLY



- Since 1964 -



Uintah Engineering & Land Surveying

85 South 200 East Vernal, Utah 84078  
(435) 789-1017 \* FAX (435) 789-1813

LOCATION PHOTOS

02 05 13  
MONTH DAY YEAR

PHOTO

P1

TAKEN BY: B.B.

DRAWN BY: J.L.H.

REV: 05-05-14 JMF

# WPX ENERGY ROCKY MOUNTAIN, LLC

EXISTING: GM 21-12, GM 321-12, PROPOSED: GM 43-12, GM 542-12, GM 342-12,  
GM 32-12, GM 531-12, GM 443-12, GM 343-12, GM 332-12 & GM 411-12

LOCATED IN GARFIELD COUNTY, COLORADO  
SECTION 12, T7S, R96W, 6th P.M.



PHOTO: VIEW OF EXISTING WELL HEAD

CAMERA ANGLE: NORTHERLY

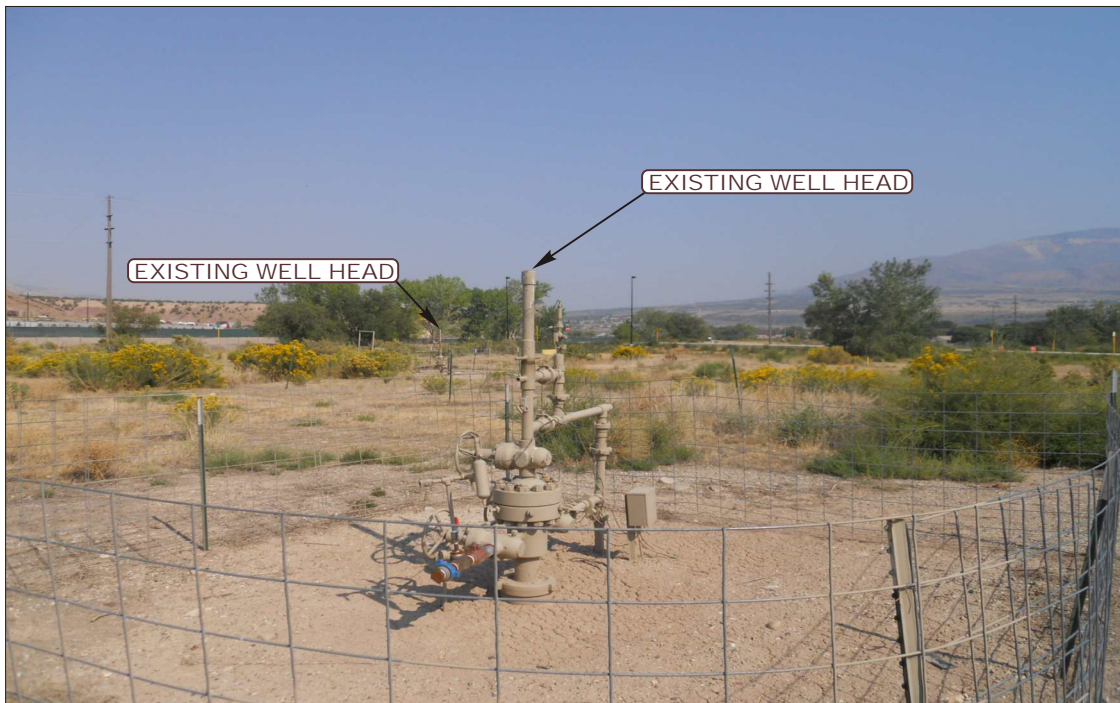

PHOTO: VIEW OF EXISTING WELL HEAD

CAMERA ANGLE: EASTERLY



- Since 1964 -

**UELS**

Uintah Engineering & Land Surveying

85 South 200 East Vernal, Utah 84078  
(435) 789-1017 \* FAX (435) 789-1813

**LOCATION PHOTOS**

**02** **05** **13**  
MONTH DAY YEAR

TAKEN BY: B.B.

DRAWN BY: J.L.H.

REV: 05-05-14 JMF

**PHOTO**

**P2**



# WPX ENERGY ROCKY MOUNTAIN, LLC

EXISTING: GM 21-12, GM 321-12, PROPOSED: GM 43-12, GM 542-12, GM 342-12,  
GM 32-12, GM 531-12, GM 443-12, GM 343-12, GM 332-12 & GM 411-12

LOCATED IN GARFIELD COUNTY, COLORADO  
SECTION 12, T7S, R96W, 6th P.M.



PHOTO: VIEW OF EXISTING WELL HEAD

CAMERA ANGLE: SOUTHERLY



PHOTO: VIEW OF EXISTING WELL HEAD

CAMERA ANGLE: WESTERLY



- Since 1964 -

**UELS**

Uintah Engineering & Land Surveying

85 South 200 East Vernal, Utah 84078  
(435) 789-1017 \* FAX (435) 789-1813

**LOCATION PHOTOS**

**02** **05** **13**  
MONTH DAY YEAR

TAKEN BY: B.B.

DRAWN BY: J.L.H.

REV: 05-05-14 JMF

**PHOTO**

**P3**