

BILL BARRETT CORPORATION

CONSTRUCTION LAYOUT FOR

FIDUCIAL 6-62-34_35 SWNW PAD #6-62-34-3225BH2, 1724BH2 & 1609BH2
SECTION 34, T6N, R62W, 6th P.M.
SW 1/4 NW 1/4

FIGURE #1

SCALE: 1" = 100'
DATE: 03-03-14
DRAWN BY: J.S.
REV: 03-25-14

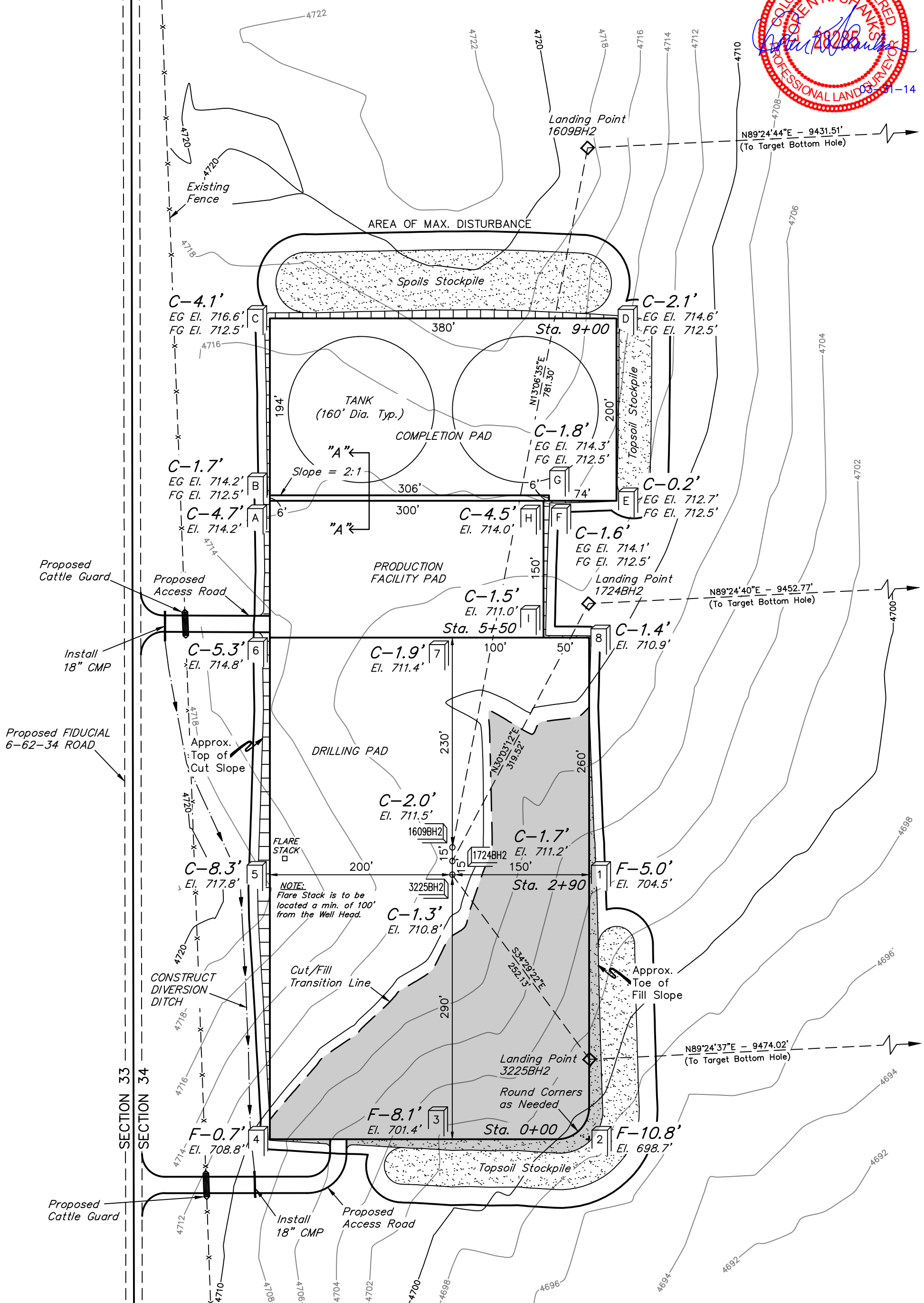
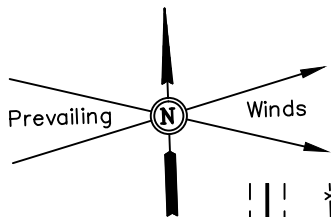

Elev. Ungraded Ground At #6-62-34-3225BH2 Loc. Stake = 4710.8'
FINISHED GRADE ELEV. AT #6-62-34-3225BH2 LOC. STAKE = 4709.5'

UINTAH ENGINEERING & LAND SURVEYING
85 So. 200 East * Vernal, Utah 84078 * (435) 789-1017