

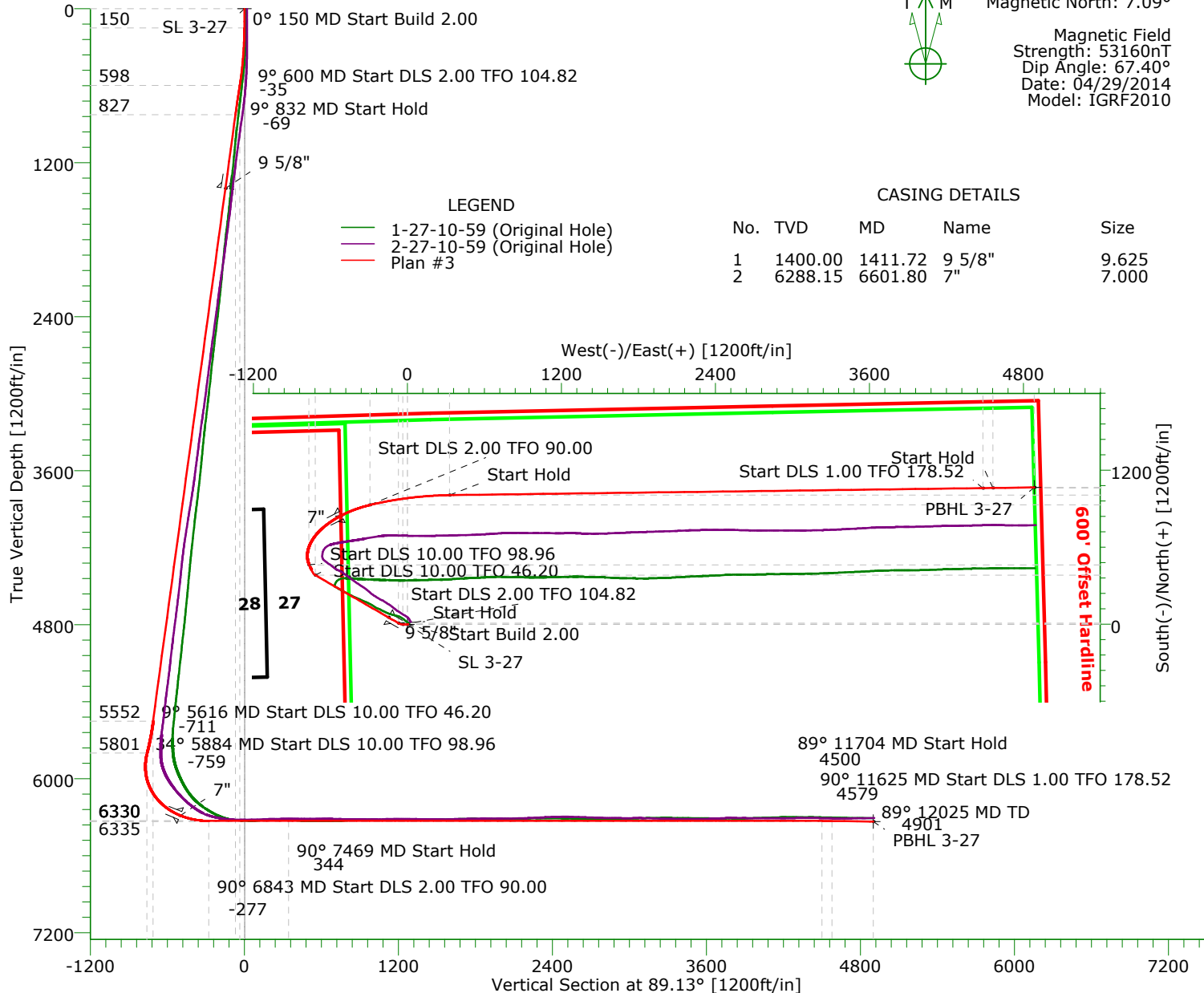

Azimuths to Grid North  
True North: -0.99°  
Magnetic North: 7.09°

Magnetic Field  
Strength: 53160nT  
Dip Angle: 67.40°  
Date: 04/29/2014  
Model: IGRF2010



## TARGET DETAILS

Name	TVD	+N/-S	+E/-W	Northing	Easting	Latitude	Longitude	Shape
SL 3-27	0.00	0.00	0.00	1541558.11	3421935.55	40°48'35.986N	103°58'32.731W	Point
PBHL 3-27	6335.00	1066.68	4884.90	1542624.79	3426820.45	40°48'45.689N	103°57'28.974W	Point

## SECTION DETAILS

Sec	MD	Inc	Azi	TVD	+N/-S	+E/-W	DLeg	TFace	VSec	Target
1	0.00	0.00	0.00	0.00	0.00	0.00	0.00	0.00	0.00	
2	150.00	0.00	0.00	150.00	0.00	0.00	0.00	0.00	0.00	
3	600.00	9.00	270.00	598.15	0.00	-35.27	2.00	270.00	-35.27	
4	832.04	9.00	300.00	827.46	9.08	-69.16	2.00	104.82	-69.01	
5	5615.95	9.00	300.00	5552.47	383.26	-717.26	0.00	0.00	-711.36	
6	5883.80	33.60	336.00	5800.84	462.90	-766.45	10.00	46.20	-759.33	
7	6842.88	90.00	76.72	6330.00	930.02	-291.13	10.00	98.96	-276.97	
8	7468.88	90.00	89.24	6330.00	1006.37	328.95	2.00	90.00	344.19	
9	11624.70	90.00	89.24	6330.00	1061.50	4484.40	0.00	0.00	4500.00	
10	11704.12	89.21	89.26	6330.55	1062.54	4563.81	1.00	178.52	4579.42	
11	12025.27	89.21	89.26	6335.00	1066.68	4884.90	0.00	0.00	4900.53	PBHL 3-27

# Precision Directional Services, Inc.

## Planning Report

<b>Company:</b> CARRIZO OIL & GAS, INC. <b>Field:</b> Niobrara CONZ'83 <b>Site:</b> Nelson Ranches 1-27-10-59 Pad <b>Well:</b> 3-27-10-59 <b>Wellpath:</b> Original Hole	<b>Date:</b> 04/25/2014 <b>Co-ordinate(NE) Reference:</b> Well: 3-27-10-59, Grid North <b>Vertical (TVD) Reference:</b> 5167'GL+17'KB 5184.0 <b>Section (VS) Reference:</b> Well (0.00N,0.00E,89.13Azi) <b>Plan:</b> Plan #3	<b>Time:</b> 12:55:39 <b>Page:</b> 1
--	--	---

<b>Field:</b> Niobrara CONZ'83  <b>Map System:</b> US State Plane Coordinate System 1983 <b>Geo Datum:</b> GRS 1980 <b>Sys Datum:</b> Mean Sea Level	<b>Map Zone:</b> Colorado, Northern Zone <b>Coordinate System:</b> Well Centre <b>Geomagnetic Model:</b> IGRF2010
--	---

<b>Site:</b> Nelson Ranches 1-27-10-59 Pad			
Weld County, CO			
<b>Site Position:</b>	<b>Northing:</b> 1541002.63 ft	<b>Latitude:</b> 40 48 30.396 N	
<b>From:</b> Map	<b>Easting:</b> 3422535.10 ft	<b>Longitude:</b> 103 58 25.060 W	
<b>Position Uncertainty:</b> 0.00 ft		<b>North Reference:</b> Grid	
<b>Ground Level:</b> 5167.00 ft		<b>Grid Convergence:</b> 0.99 deg	

<b>Well:</b> 3-27-10-59	<b>Slot Name:</b> 3-27
<b>Well Position:</b> +N/-S 555.48 ft	<b>Latitude:</b> 40 48 35.986 N
+E/-W -599.55 ft	<b>Longitude:</b> 103 58 32.731 W
<b>Position Uncertainty:</b> 0.00 ft	

<b>Wellpath:</b> Original Hole	<b>Drilled From:</b> Surface
<b>Current Datum:</b> 5167'GL+17'KB	<b>Tie-on Depth:</b> 0.00 ft
<b>Magnetic Data:</b> 04/29/2014	<b>Above System Datum:</b> Mean Sea Level
<b>Field Strength:</b> 53160 nT	<b>Declination:</b> 8.08 deg
<b>Vertical Section:</b> Depth From (TVD)	<b>Mag Dip Angle:</b> 67.40 deg
ft	<b>+E/-W</b> ft
	<b>Direction</b> bearing
0.00	0.00
0.00	89.13

<b>Plan:</b> Plan #3	<b>Date Composed:</b> 04/25/2014
<b>Principal:</b> No	<b>Version:</b> 1
	<b>Tied-to:</b> From Surface

Plan Section Information										
MD ft	Incl deg	Azim bearing	TVD ft	+N/-S ft	+E/-W ft	DLS deg/100ft	Build deg/100ft	Turn deg/100ft	TFO deg	Target
0.00	0.00	0.00	0.00	0.00	0.00	0.00	0.00	0.00	0.00	
150.00	0.00	0.00	150.00	0.00	0.00	0.00	0.00	0.00	0.00	
600.00	9.00	270.00	598.15	0.00	-35.27	2.00	2.00	0.00	270.00	
832.04	9.00	300.00	827.46	9.08	-69.16	2.00	0.00	12.93	104.82	
5615.95	9.00	300.00	5552.47	383.26	-717.26	0.00	0.00	0.00	0.00	
5883.80	33.60	336.00	5800.84	462.90	-766.45	10.00	9.18	13.44	46.20	
6842.88	90.00	76.72	6330.00	930.02	-291.13	10.00	5.88	10.50	98.96	
7468.88	90.00	89.24	6330.00	1006.37	328.95	2.00	0.00	2.00	90.00	
11624.70	90.00	89.24	6330.00	1061.50	4484.40	0.00	0.00	0.00	0.00	
11704.12	89.21	89.26	6330.55	1062.54	4563.81	1.00	-1.00	0.03	178.52	
12025.27	89.21	89.26	6335.00	1066.68	4884.90	0.00	0.00	0.00	0.00	PBHL 3-27

Survey										
MD ft	Incl deg	Azim bearing	TVD ft	+N/-S ft	+E/-W ft	VS ft	DLS deg/100ft	Build deg/100ft	Turn deg/100ft	Tool/Comment
0.00	0.00	0.00	0.00	0.00	0.00	0.00	0.00	0.00	0.00	
100.00	0.00	0.00	100.00	0.00	0.00	0.00	0.00	0.00	0.00	
150.00	0.00	0.00	150.00	0.00	0.00	0.00	0.00	0.00	0.00	
200.00	1.00	270.00	200.00	0.00	-0.44	-0.44	2.00	2.00	0.00	
300.00	3.00	270.00	299.93	0.00	-3.93	-3.93	2.00	2.00	0.00	
400.00	5.00	270.00	399.68	0.00	-10.90	-10.90	2.00	2.00	0.00	
500.00	7.00	270.00	499.13	0.00	-21.35	-21.35	2.00	2.00	0.00	
600.00	9.00	270.00	598.15	0.00	-35.27	-35.27	2.00	2.00	0.00	
700.00	8.70	282.88	696.97	1.69	-50.47	-50.44	2.00	-0.30	12.88	
800.00	8.86	295.97	795.81	6.75	-64.77	-64.66	2.00	0.15	13.09	
832.04	9.00	300.00	827.46	9.08	-69.16	-69.01	2.00	0.44	12.57	

# Precision Directional Services, Inc.

## Planning Report

**Company:** CARRIZO OIL & GAS, INC.  
**Field:** Niobrara CONZ'83  
**Site:** Nelson Ranches 1-27-10-59 Pad  
**Well:** 3-27-10-59  
**Wellpath:** Original Hole

**Date:** 04/25/2014  
**Co-ordinate(NE) Reference:** Well: 3-27-10-59, Grid North  
**Vertical (TVD) Reference:** 5167'GL+17'KB 5184.0  
**Section (VS) Reference:** Well (0.00N,0.00E,89.13Azi)  
**Plan:** Plan #3

**Page:** 2

### Survey

MD ft	Incl deg	Azim bearing	TVD ft	+N/-S ft	+E/-W ft	VS ft	DLS deg/100ft	Build deg/100ft	Turn deg/100ft	Tool/Comment
900.00	9.00	300.00	894.58	14.40	-78.36	-78.14	0.00	0.00	0.00	
1000.00	9.00	300.00	993.35	22.22	-91.91	-91.56	0.00	0.00	0.00	
1100.00	9.00	300.00	1092.12	30.04	-105.46	-104.99	0.00	0.00	0.00	
1200.00	9.00	300.00	1190.89	37.86	-119.01	-118.42	0.00	0.00	0.00	
1300.00	9.00	300.00	1289.66	45.68	-132.55	-131.84	0.00	0.00	0.00	
1400.00	9.00	300.00	1388.43	53.50	-146.10	-145.27	0.00	0.00	0.00	
1411.72	9.00	300.00	1400.00	54.42	-147.69	-146.85	0.00	0.00	0.00	9 5/8"
1500.00	9.00	300.00	1487.20	61.33	-159.65	-158.70	0.00	0.00	0.00	
1600.00	9.00	300.00	1585.97	69.15	-173.20	-172.13	0.00	0.00	0.00	
1700.00	9.00	300.00	1684.73	76.97	-186.74	-185.55	0.00	0.00	0.00	
1800.00	9.00	300.00	1783.50	84.79	-200.29	-198.98	0.00	0.00	0.00	
1900.00	9.00	300.00	1882.27	92.61	-213.84	-212.41	0.00	0.00	0.00	
2000.00	9.00	300.00	1981.04	100.43	-227.39	-225.84	0.00	0.00	0.00	
2100.00	9.00	300.00	2079.81	108.26	-240.93	-239.26	0.00	0.00	0.00	
2200.00	9.00	300.00	2178.58	116.08	-254.48	-252.69	0.00	0.00	0.00	
2300.00	9.00	300.00	2277.35	123.90	-268.03	-266.12	0.00	0.00	0.00	
2400.00	9.00	300.00	2376.12	131.72	-281.58	-279.55	0.00	0.00	0.00	
2500.00	9.00	300.00	2474.88	139.54	-295.13	-292.97	0.00	0.00	0.00	
2600.00	9.00	300.00	2573.65	147.36	-308.67	-306.40	0.00	0.00	0.00	
2700.00	9.00	300.00	2672.42	155.19	-322.22	-319.83	0.00	0.00	0.00	
2800.00	9.00	300.00	2771.19	163.01	-335.77	-333.25	0.00	0.00	0.00	
2900.00	9.00	300.00	2869.96	170.83	-349.32	-346.68	0.00	0.00	0.00	
3000.00	9.00	300.00	2968.73	178.65	-362.86	-360.11	0.00	0.00	0.00	
3100.00	9.00	300.00	3067.50	186.47	-376.41	-373.54	0.00	0.00	0.00	
3200.00	9.00	300.00	3166.27	194.29	-389.96	-386.96	0.00	0.00	0.00	
3300.00	9.00	300.00	3265.04	202.12	-403.51	-400.39	0.00	0.00	0.00	
3400.00	9.00	300.00	3363.80	209.94	-417.05	-413.82	0.00	0.00	0.00	
3500.00	9.00	300.00	3462.57	217.76	-430.60	-427.25	0.00	0.00	0.00	
3600.00	9.00	300.00	3561.34	225.58	-444.15	-440.67	0.00	0.00	0.00	
3700.00	9.00	300.00	3660.11	233.40	-457.70	-454.10	0.00	0.00	0.00	
3800.00	9.00	300.00	3758.88	241.23	-471.24	-467.53	0.00	0.00	0.00	
3900.00	9.00	300.00	3857.65	249.05	-484.79	-480.95	0.00	0.00	0.00	
4000.00	9.00	300.00	3956.42	256.87	-498.34	-494.38	0.00	0.00	0.00	
4100.00	9.00	300.00	4055.19	264.69	-511.89	-507.81	0.00	0.00	0.00	
4200.00	9.00	300.00	4153.96	272.51	-525.43	-521.24	0.00	0.00	0.00	
4300.00	9.00	300.00	4252.72	280.33	-538.98	-534.66	0.00	0.00	0.00	
4400.00	9.00	300.00	4351.49	288.16	-552.53	-548.09	0.00	0.00	0.00	
4500.00	9.00	300.00	4450.26	295.98	-566.08	-561.52	0.00	0.00	0.00	
4600.00	9.00	300.00	4549.03	303.80	-579.63	-574.95	0.00	0.00	0.00	
4700.00	9.00	300.00	4647.80	311.62	-593.17	-588.37	0.00	0.00	0.00	
4800.00	9.00	300.00	4746.57	319.44	-606.72	-601.80	0.00	0.00	0.00	
4900.00	9.00	300.00	4845.34	327.26	-620.27	-615.23	0.00	0.00	0.00	
5000.00	9.00	300.00	4944.11	335.09	-633.82	-628.65	0.00	0.00	0.00	
5100.00	9.00	300.00	5042.87	342.91	-647.36	-642.08	0.00	0.00	0.00	
5200.00	9.00	300.00	5141.64	350.73	-660.91	-655.51	0.00	0.00	0.00	
5300.00	9.00	300.00	5240.41	358.55	-674.46	-668.94	0.00	0.00	0.00	
5400.00	9.00	300.00	5339.18	366.37	-688.01	-682.36	0.00	0.00	0.00	
5500.00	9.00	300.00	5437.95	374.19	-701.55	-695.79	0.00	0.00	0.00	
5600.00	9.00	300.00	5536.72	382.02	-715.10	-709.22	0.00	0.00	0.00	
5615.95	9.00	300.00	5552.47	383.26	-717.26	-711.36	0.00	0.00	0.00	
5650.00	11.62	312.29	5585.97	386.90	-722.11	-716.15	10.00	7.69	36.10	
5700.00	16.00	322.50	5634.52	395.76	-730.03	-723.94	10.00	8.77	20.42	
5750.00	20.66	328.31	5681.98	408.75	-738.87	-732.57	10.00	9.32	11.61	
5800.00	25.45	332.03	5727.97	425.75	-748.54	-741.99	10.00	9.57	7.44	

# Precision Directional Services, Inc.

## Planning Report

**Company:** CARRIZO OIL & GAS, INC.  
**Field:** Niobrara CONZ'83  
**Site:** Nelson Ranches 1-27-10-59 Pad  
**Well:** 3-27-10-59  
**Wellpath:** Original Hole

**Date:** 04/25/2014  
**Co-ordinate(NE) Reference:** Well: 3-27-10-59, Grid North  
**Vertical (TVD) Reference:** 5167'GL+17'KB 5184.0  
**Section (VS) Reference:** Well (0.00N,0.00E,89.13Azi)  
**Plan:** Plan #3

**Page:** 3

### Survey

MD ft	Incl deg	Azim bearing	TVD ft	+N/-S ft	+E/-W ft	VS ft	DLS deg/100ft	Build deg/100ft	Turn deg/100ft	Tool/Comment
5850.00	30.30	334.63	5772.16	446.65	-758.99	-752.12	10.00	9.70	5.20	
5883.80	33.60	336.00	5800.84	462.90	-766.45	-759.33	10.00	9.77	4.04	
5900.00	33.38	338.91	5814.35	471.15	-769.88	-762.63	10.00	-1.35	17.96	
5950.00	33.14	348.02	5856.18	497.38	-777.67	-770.03	10.00	-0.48	18.23	
6000.00	33.57	357.09	5897.97	524.57	-781.21	-773.15	10.00	0.85	18.13	
6050.00	34.64	5.81	5939.40	552.53	-780.47	-771.99	10.00	2.13	17.44	
6100.00	36.29	13.95	5980.15	581.04	-775.46	-766.55	10.00	3.30	16.29	
6150.00	38.44	21.39	6019.90	609.89	-766.22	-756.87	10.00	4.31	14.88	
6200.00	41.02	28.10	6058.37	638.86	-752.82	-743.03	10.00	5.16	13.41	
6250.00	43.95	34.10	6095.25	667.72	-735.35	-725.13	10.00	5.86	12.01	
6300.00	47.16	39.47	6130.27	696.26	-713.96	-703.30	10.00	6.42	10.74	
6350.00	50.60	44.29	6163.16	724.25	-688.80	-677.72	10.00	6.87	9.65	
6400.00	54.22	48.65	6193.67	751.50	-660.06	-648.57	10.00	7.23	8.72	
6450.00	57.98	52.62	6221.56	777.78	-627.97	-616.09	10.00	7.52	7.94	
6500.00	61.85	56.28	6246.62	802.90	-592.77	-580.51	10.00	7.75	7.31	
6550.00	65.82	59.67	6268.67	826.67	-554.73	-542.11	10.00	7.93	6.79	
6600.00	69.85	62.86	6287.53	848.90	-514.13	-501.18	10.00	8.07	6.38	
6601.80	70.00	62.97	6288.15	849.67	-512.62	-499.66	10.00	8.13	6.20	7"
6650.00	73.94	65.89	6303.07	869.43	-471.29	-458.03	10.00	8.18	6.05	
6700.00	78.07	68.79	6315.16	888.11	-426.52	-412.99	10.00	8.26	5.81	
6750.00	82.23	71.61	6323.71	904.78	-380.19	-366.40	10.00	8.32	5.63	
6800.00	86.41	74.37	6328.66	919.32	-332.62	-318.62	10.00	8.36	5.52	
6842.88	90.00	76.72	6330.00	930.02	-291.13	-276.97	10.00	8.37	5.47	
6900.00	90.00	77.86	6330.00	942.58	-235.41	-221.07	2.00	0.00	2.00	
7000.00	90.00	79.86	6330.00	961.90	-137.30	-122.68	2.00	0.00	2.00	
7100.00	90.00	81.86	6330.00	977.78	-38.57	-23.72	2.00	0.00	2.00	
7200.00	90.00	83.86	6330.00	990.20	60.65	75.68	2.00	0.00	2.00	
7300.00	90.00	85.86	6330.00	999.16	160.24	175.40	2.00	0.00	2.00	
7400.00	90.00	87.86	6330.00	1004.63	260.09	275.31	2.00	0.00	2.00	
7468.88	90.00	89.24	6330.00	1006.37	328.95	344.19	2.00	0.00	2.00	
7500.00	90.00	89.24	6330.00	1006.79	360.06	375.31	0.00	0.00	0.00	
7600.00	90.00	89.24	6330.00	1008.11	460.05	475.31	0.00	0.00	0.00	
7700.00	90.00	89.24	6330.00	1009.44	560.04	575.31	0.00	0.00	0.00	
7800.00	90.00	89.24	6330.00	1010.76	660.03	675.31	0.00	0.00	0.00	
7900.00	90.00	89.24	6330.00	1012.09	760.03	775.31	0.00	0.00	0.00	
8000.00	90.00	89.24	6330.00	1013.42	860.02	875.31	0.00	0.00	0.00	
8100.00	90.00	89.24	6330.00	1014.74	960.01	975.31	0.00	0.00	0.00	
8200.00	90.00	89.24	6330.00	1016.07	1060.00	1075.31	0.00	0.00	0.00	
8300.00	90.00	89.24	6330.00	1017.40	1159.99	1175.31	0.00	0.00	0.00	
8400.00	90.00	89.24	6330.00	1018.72	1259.98	1275.30	0.00	0.00	0.00	
8500.00	90.00	89.24	6330.00	1020.05	1359.97	1375.30	0.00	0.00	0.00	
8600.00	90.00	89.24	6330.00	1021.38	1459.96	1475.30	0.00	0.00	0.00	
8700.00	90.00	89.24	6330.00	1022.70	1559.96	1575.30	0.00	0.00	0.00	
8800.00	90.00	89.24	6330.00	1024.03	1659.95	1675.30	0.00	0.00	0.00	
8900.00	90.00	89.24	6330.00	1025.36	1759.94	1775.30	0.00	0.00	0.00	
9000.00	90.00	89.24	6330.00	1026.68	1859.93	1875.30	0.00	0.00	0.00	
9100.00	90.00	89.24	6330.00	1028.01	1959.92	1975.30	0.00	0.00	0.00	
9200.00	90.00	89.24	6330.00	1029.33	2059.91	2075.30	0.00	0.00	0.00	
9300.00	90.00	89.24	6330.00	1030.66	2159.90	2175.30	0.00	0.00	0.00	
9400.00	90.00	89.24	6330.00	1031.99	2259.89	2275.30	0.00	0.00	0.00	
9500.00	90.00	89.24	6330.00	1033.31	2359.89	2375.30	0.00	0.00	0.00	
9600.00	90.00	89.24	6330.00	1034.64	2459.88	2475.30	0.00	0.00	0.00	
9700.00	90.00	89.24	6330.00	1035.97	2559.87	2575.30	0.00	0.00	0.00	

# Precision Directional Services, Inc.

## Planning Report

**Company:** CARRIZO OIL & GAS, INC.  
**Field:** Niobrara CONZ'83  
**Site:** Nelson Ranches 1-27-10-59 Pad  
**Well:** 3-27-10-59  
**Wellpath:** Original Hole

**Date:** 04/25/2014  
**Co-ordinate(NE) Reference:** Well: 3-27-10-59, Grid North  
**Vertical (TVD) Reference:** 5167'GL+17'KB 5184.0  
**Section (VS) Reference:** Well (0.00N,0.00E,89.13Azi)  
**Plan:** Plan #3

**Page:** 4

### Survey

MD ft	Incl deg	Azim bearing	TVD ft	+N/-S ft	+E/-W ft	VS ft	DLS deg/100ft	Build deg/100ft	Turn deg/100ft	Tool/Comment
9800.00	90.00	89.24	6330.00	1037.29	2659.86	2675.30	0.00	0.00	0.00	
9900.00	90.00	89.24	6330.00	1038.62	2759.85	2775.30	0.00	0.00	0.00	
10000.00	90.00	89.24	6330.00	1039.95	2859.84	2875.30	0.00	0.00	0.00	
10100.00	90.00	89.24	6330.00	1041.27	2959.83	2975.30	0.00	0.00	0.00	
10200.00	90.00	89.24	6330.00	1042.60	3059.82	3075.30	0.00	0.00	0.00	
10300.00	90.00	89.24	6330.00	1043.93	3159.81	3175.30	0.00	0.00	0.00	
10400.00	90.00	89.24	6330.00	1045.25	3259.81	3275.30	0.00	0.00	0.00	
10500.00	90.00	89.24	6330.00	1046.58	3359.80	3375.30	0.00	0.00	0.00	
10600.00	90.00	89.24	6330.00	1047.90	3459.79	3475.30	0.00	0.00	0.00	
10700.00	90.00	89.24	6330.00	1049.23	3559.78	3575.30	0.00	0.00	0.00	
10800.00	90.00	89.24	6330.00	1050.56	3659.77	3675.30	0.00	0.00	0.00	
10900.00	90.00	89.24	6330.00	1051.88	3759.76	3775.30	0.00	0.00	0.00	
11000.00	90.00	89.24	6330.00	1053.21	3859.75	3875.30	0.00	0.00	0.00	
11100.00	90.00	89.24	6330.00	1054.54	3959.74	3975.30	0.00	0.00	0.00	
11200.00	90.00	89.24	6330.00	1055.86	4059.74	4075.30	0.00	0.00	0.00	
11300.00	90.00	89.24	6330.00	1057.19	4159.73	4175.30	0.00	0.00	0.00	
11400.00	90.00	89.24	6330.00	1058.52	4259.72	4275.30	0.00	0.00	0.00	
11500.00	90.00	89.24	6330.00	1059.84	4359.71	4375.30	0.00	0.00	0.00	
11600.00	90.00	89.24	6330.00	1061.17	4459.70	4475.30	0.00	0.00	0.00	
11624.70	90.00	89.24	6330.00	1061.50	4484.40	4500.00	0.00	0.00	0.00	
11704.12	89.21	89.26	6330.55	1062.54	4563.81	4579.42	1.00	-1.00	0.03	
11800.00	89.21	89.26	6331.88	1063.77	4659.67	4675.29	0.00	0.00	0.00	
11900.00	89.21	89.26	6333.26	1065.06	4759.65	4775.28	0.00	0.00	0.00	
12000.00	89.21	89.26	6334.65	1066.35	4859.64	4875.27	0.00	0.00	0.00	
12025.27	89.21	89.26	6335.00	1066.68	4884.90	4900.53	0.00	0.00	0.00	PBHL 3-27

### Targets

Name	Description Dip.	Dir.	TVD ft	+N/-S ft	+E/-W ft	Map Northing ft	Map Easting ft	<--- Latitude --->			<--- Longitude --->		
SL 3-27			0.00	0.00	0.00	1541558.11	3421935.55	40	48	35.986 N	103	58	32.731 W
PBHL 3-27			6335.00	1066.68	4884.90	1542624.79	3426820.45	40	48	45.689 N	103	57	28.974 W

### Casing Points

MD ft	TVD ft	Diameter in	Hole Size in	Name
1411.72	1400.00	9.625	12.250	9 5/8"
6601.80	6288.15	7.000	8.500	7"